

STATE OF SOUTH DAKOTA  
DEPARTMENT OF TRANSPORTATION  
PLANS FOR PROPOSED

|                       |   |       |              |
|-----------------------|---|-------|--------------|
| STATE OF SOUTH DAKOTA | PROJECT                                       | SHEET | TOTAL SHEETS |
|                       | NH 0085(00)54, NH 0212(00)13 & NH 0085(114)54 | 1     | 123          |

Plotting Date: 02/17/2021 Revised 2/17/2021 NJF

INDEX OF SECTIONS

- Section A: Estimate of Quantities and Environmental Commitments
- Section B: Grading & Surfacing Plans
- Section C: Traffic Control Plans
- Section D: Erosion and Sediment Control Plans
- Section L: Signal and Lighting Plans
- Section M: Pavement Marking Plans
- Section X: Cross Sections

PROJECTS NH 0085(00)54,  
NH 0212(00)13, and NH 0085(114)54  
US HIGHWAYS 85 & 212  
SD HIGHWAY 34  
BUTTE COUNTY

INTERSECTION IMPROVEMENTS, ADA UPGRADES, ROW

PCN 04P9, 04PA, and 05V0

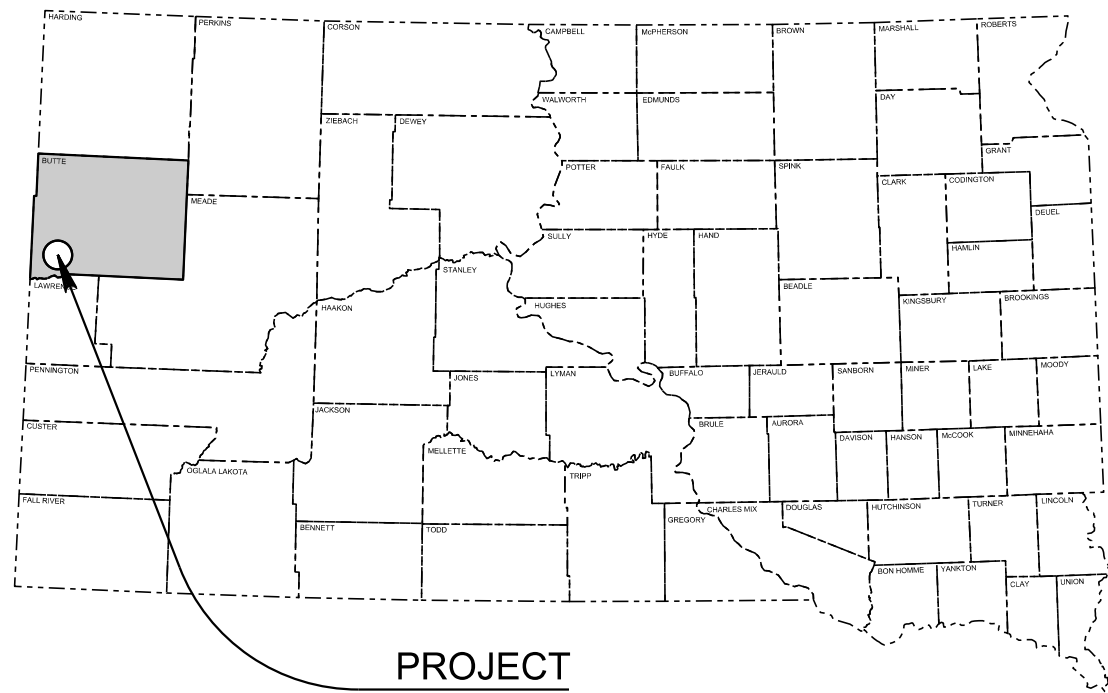

PROJECT

**BEGIN NH 0212(00)13**

Station 704+07 = Station 704+07 on NH 0212(61)7 located approximately 1846 feet North and 1475 feet West of the southeast corner of Section 3 - Township 8 North - Range 2 East. MRM 13.35

**END NH 0085(00)54**

Station 92+32 = Station 5+37 on F 0212(68)13 located approximately 1490 feet North and 1030 feet West of the southeast corner of Section 3 - Township 8 North - Range 2 East. MRM 56.57

**BEGIN NH 0085(00)54**

Station 468+00 = 468+00 on NH 0085(00)54, PCN 371N located approximately 2414 feet North and 613 feet East of the north quarter corner of Section 22 - Township 8 North - Range 2 East. MRM 54.73

**Project NH 0085(114)54**

Station 442+18.16 = Station 442+18.16 on NH 0085(40)45 located approximately 24 feet South and 17 feet East of the north quarter corner of Section 22 - Township 8 North - Range 2 East. MRM 54.24

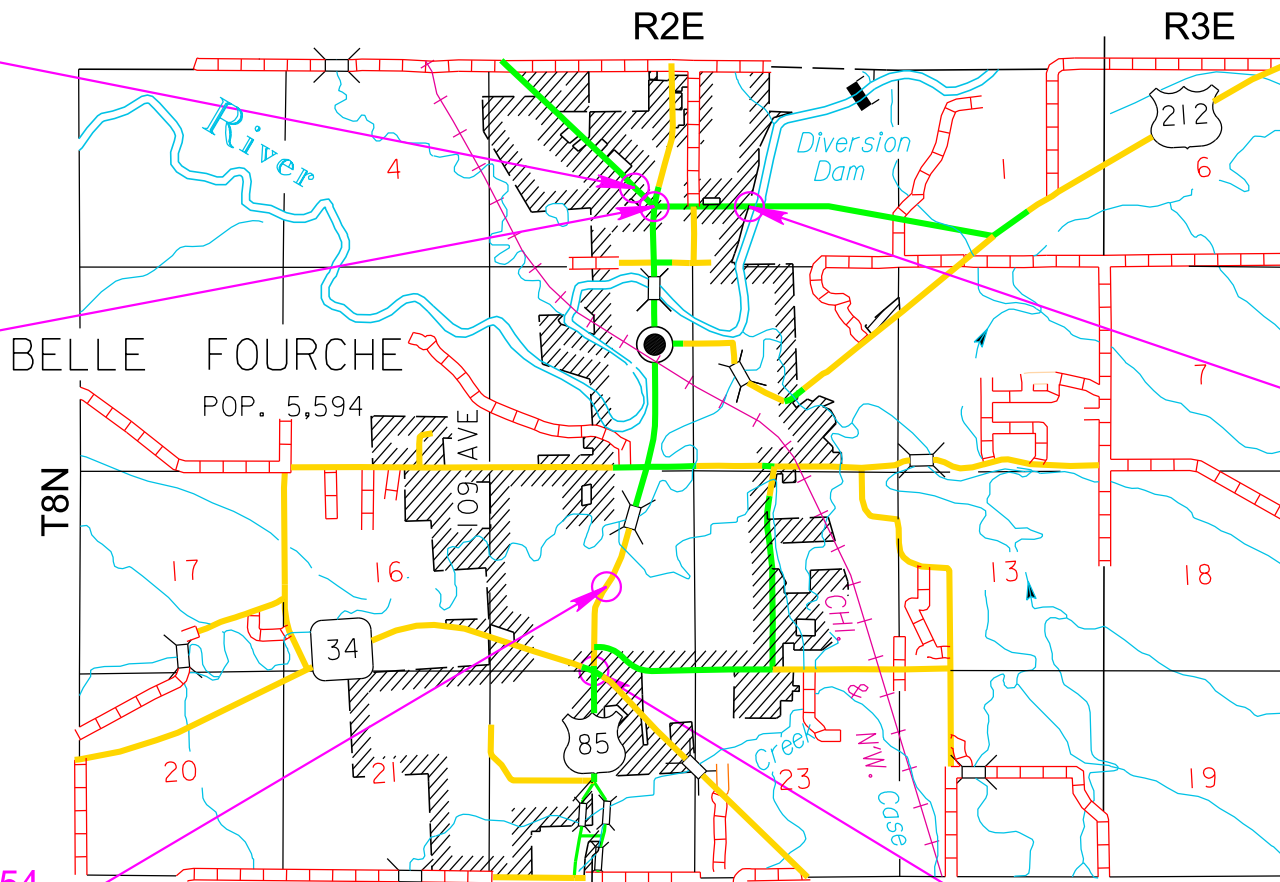

**END NH 0212(00)13**

Station 725+45 = 15+58.5 on F 0212(68)13 located approximately 1460 feet North and 873 feet East of the southwest corner of Section 2 - Township 8 North - Range 2 East. MRM 13.82

STORM WATER PERMIT

Major Receiving Body of Water: Belle Fourche River  
Area Disturbed: 1.65 acres  
Total Project Area: 2.23 acres  
Approx. Begin Lat,Long: 44.648016, -103.859671

DESIGN DESIGNATION

|             | US85        | US212  | SD34   |
|-------------|-------------|--------|--------|
| AADT (2017) | 11,112      | 2792   | 2916   |
| AADT (2037) | 12,512      | 3144   | 3284   |
| DHV         | 1439        | 490    | 371    |
| D           | 51%         | 50%    | 52%    |
| DHV T%      | 5.5%        | 6.2%   | 5.5%   |
| AAADT T%    | 12.1%       | 13.6%  | 12.0%  |
| V           | 35 & 45 mph | 35 mph | 50 mph |

# ESTIMATE OF QUANTITIES AND ENVIRONMENTAL COMMITMENTS

|                       |   |             |                    |
|-----------------------|---|-------------|--------------------|
| STATE OF SOUTH DAKOTA | PROJECT<br>NH 0085(00)54, NH 0212(00)13<br>& NH 0085(114)54 | SHEET<br>A1 | TOTAL SHEETS<br>A4 |
|-----------------------|---|-------------|--------------------|

Revised 2/19/2021 NJF

## Section B – Grading

### PCN 05V0 (US85 & SD34 Intersection)

| BID ITEM NUMBER | ITEM                                | QUANTITY | UNIT |
|-----------------|-------------------------------------|----------|------|
| 009E0010        | Mobilization                        | Lump Sum | LS   |
| 110E0300        | Remove Concrete Curb and/or Gutter  | 161      | Ft   |
| 110E1010        | Remove Asphalt Concrete Pavement    | 3,600.0  | SqYd |
| 110E1100        | Remove Concrete Pavement            | 189.0    | SqYd |
| 120E3000        | Placing Embankment                  | 675      | CuYd |
| 240E0010        | Obliterate Old Road                 | 7        | Sta  |
| 250E0020        | Incidental Work, Grading            | Lump Sum | LS   |
| 260E2010        | Gravel Cushion                      | 72.9     | Ton  |
| 380E0060        | 8.5" Nonreinforced PCC Pavement     | 303.3    | SqYd |
| 380E1040        | 8.5" Miscellaneous PCC Pavement     | 470.1    | SqYd |
| 380E6110        | Insert Steel Bar in PCC Pavement    | 539      | Each |
| 450E0122        | 18" RCP Class 2, Furnish            | 36       | Ft   |
| 450E0130        | 18" RCP, Install                    | 36       | Ft   |
| 450E2008        | 18" RCP Flared End, Furnish         | 2        | Each |
| 450E2009        | 18" RCP Flared End, Install         | 2        | Each |
| 462E0100        | Class M6 Concrete                   | 3.0      | CuYd |
| 480E0100        | Reinforcing Steel                   | 460      | Lb   |
| 650E1085        | Type F68.5 Concrete Curb and Gutter | 1,309    | Ft   |
| 650E4060        | Type C6 Concrete Gutter             | 114      | Ft   |
| 670E1200        | Type B Frame and Grate Assembly     | 2        | Each |
| 670E5400        | Precast Drop Inlet Collar           | 2        | Each |

### PCN 04P9 (US85)

| BID ITEM NUMBER | ITEM                                  | QUANTITY | UNIT |
|-----------------|---------------------------------------|----------|------|
| 009E0010        | Mobilization                          | Lump Sum | LS   |
| 110E0300        | Remove Concrete Curb and/or Gutter    | 76       | Ft   |
| 110E1100        | Remove Concrete Pavement              | 259.7    | SqYd |
| 110E1140        | Remove Concrete Sidewalk              | 225.8    | SqYd |
| 110E7150        | Remove Sign for Reset                 | 10       | Each |
| 260E2010        | Gravel Cushion                        | 1.5      | Ton  |
| 380E2708        | 8" Mountable Type Median PCC Pavement | 36.9     | SqYd |
| 380E4080        | 9.5" PCC Fillet Section               | 195.4    | SqYd |
| 380E6110        | Insert Steel Bar in PCC Pavement      | 101      | Each |
| 632E3500        | Reset Sign                            | 10       | Each |
| 650E0080        | Type B68 Concrete Curb and Gutter     | 57       | Ft   |
| 650E0095        | Type B69.5 Concrete Curb and Gutter   | 114      | Ft   |
| 651E0040        | 4" Concrete Sidewalk                  | 2,311    | SqFt |
| 651E7000        | Type 1 Detectable Warnings            | 290      | SqFt |

### PCN 04PA (US212)

| BID ITEM NUMBER | ITEM                              | QUANTITY | UNIT |
|-----------------|-----------------------------------|----------|------|
| 009E0010        | Mobilization                      | Lump Sum | LS   |
| 110E1010        | Remove Asphalt Concrete Pavement  | 15.8     | SqYd |
| 110E1100        | Remove Concrete Pavement          | 375.2    | SqYd |
| 110E1140        | Remove Concrete Sidewalk          | 269.6    | SqYd |
| 110E7150        | Remove Sign for Reset             | 10       | Each |
| 110E7800        | Remove Chain Link Fence for Reset | 104      | Ft   |
| 380E4050        | 8" PCC Fillet Section             | 339.8    | SqYd |
| 380E6110        | Insert Steel Bar in PCC Pavement  | 46       | Each |
| 621E0520        | Reset Chain Link Fence            | 104      | Ft   |
| 632E3500        | Reset Sign                        | 10       | Each |
| 650E0090        | Type B69 Concrete Curb and Gutter | 113      | Ft   |
| 651E0040        | 4" Concrete Sidewalk              | 2,179    | SqFt |
| 651E0080        | 8" Concrete Sidewalk              | 224      | SqFt |
| 651E7000        | Type 1 Detectable Warnings        | 140      | SqFt |

### INDEX OF SHEETS

A1 and A3 Estimate of Quantities for Sections B, C, D, L, and M  
A4 to A10 Environmental Commitments

## Section C - Traffic Control

### PCN 05V0 (US85 & SD34 Intersection)

| BID ITEM NUMBER | ITEM  | QUANTITY | UNIT |
|-----------------|---|----------|------|
| 634E0010        | Flagging  | 200.0    | Hour |
| 634E0110        | Traffic Control Signs                                 | 334.2    | SqFt |
| 634E0120        | Traffic Control, Miscellaneous                        | Lump Sum | LS   |
| 634E0275        | Type 3 Barricade                                      | 4        | Each |
| 634E0310        | Temporary Flexible Vertical Markers (Tabs)            | 3,600    | Ft   |
| 634E0420        | Type C Advance Warning Arrow Board                    | 2        | Each |
| 634E0900        | Portable Temporary Traffic Control Signal             | 4        | Unit |
| 634E1215        | Contractor Furnished Portable Changeable Message Sign | 4        | Each |

### PCN 04P9 (US85)

| BID ITEM NUMBER | ITEM                                       | QUANTITY | UNIT |
|-----------------|--|----------|------|
| 634E0010        | Flagging                                   | 200.0    | Hour |
| 634E0110        | Traffic Control Signs                      | 547.1    | SqFt |
| 634E0120        | Traffic Control, Miscellaneous             | Lump Sum | LS   |
| 634E0275        | Type 3 Barricade                           | 9        | Each |
| 634E0310        | Temporary Flexible Vertical Markers (Tabs) | 3,440    | Ft   |
| 634E0420        | Type C Advance Warning Arrow Board         | 2        | Each |
| 634E2000        | Longitudinal Pedestrian Barricade          | 200      | Ft   |
| 634E2015        | Temporary Pedestrian Access Route          | Lump Sum | LS   |
| 634E2020        | Temporary Curb Ramp                        | 4        | Each |
| 634E2025        | Longitudinal Pedestrian Barrier            | 200      | Ft   |
| 900E1080        | Orange Plastic Safety Fence                | 100      | Ft   |

### PCN 04PA (US212)

| BID ITEM NUMBER | ITEM                                       | QUANTITY | UNIT |
|-----------------|--|----------|------|
| 634E0010        | Flagging                                   | 200.0    | Hour |
| 634E0110        | Traffic Control Signs                      | 511.5    | SqFt |
| 634E0120        | Traffic Control, Miscellaneous             | Lump Sum | LS   |
| 634E0275        | Type 3 Barricade                           | 7        | Each |
| 634E0310        | Temporary Flexible Vertical Markers (Tabs) | 1,940    | Ft   |
| 634E0420        | Type C Advance Warning Arrow Board         | 3        | Each |
| 634E2000        | Longitudinal Pedestrian Barricade          | 200      | Ft   |
| 634E2015        | Temporary Pedestrian Access Route          | Lump Sum | LS   |
| 634E2020        | Temporary Curb Ramp                        | 4        | Each |
| 634E2025        | Longitudinal Pedestrian Barrier            | 200      | Ft   |
| 900E1080        | Orange Plastic Safety Fence                | 100      | Ft   |

### Section D - Erosion and Sediment Control

#### PCN 05V0 (US85 & SD34 Intersection)

| BID ITEM NUMBER | ITEM   | QUANTITY | UNIT |
|-----------------|--|----------|------|
| 120E6300        | Water for Vegetation                           | 138.0    | MGal |
| 230E0020        | Contractor Furnished Topsoil                   | 477      | CuYd |
| 230E0100        | Remove and Replace Topsoil                     | Lump Sum | LS   |
| 730E0210        | Type F Permanent Seed Mixture                  | 45       | Lb   |
| 731E0200        | Fertilizing                                    | 1.30     | Ton  |
| 732E0200        | Fiber Mulching                                 | 1.7      | Ton  |
| 734E0154        | 12" Diameter Erosion Control Wattle            | 300      | Ft   |
| 734E0845        | Sediment Control at Inlet with Frame and Grate | 2        | Each |
| 734E5010        | Sweeping                                       | 20       | Hour |

#### PCN 04P9 (US85)

| BID ITEM NUMBER | ITEM  | QUANTITY | UNIT |
|-----------------|---|----------|------|
| 120E6300        | Water for Vegetation                                      | 2.4      | MGal |
| 230E0100        | Remove and Replace Topsoil                                | Lump Sum | LS   |
| 731E0100        | Fertilizing   | 45       | Lb   |
| 733E0100        | Sodding   | 145      | SqYd |
| 734E0845        | Sediment Control at Inlet with Frame and Grate            | 4        | Each |
| 734E0847        | Sediment Control at Type S Reinforced Concrete Drop Inlet | 24       | Ft   |
| 734E5010        | Sweeping  | 20       | Hour |

#### PCN 04PA (US212)

| BID ITEM NUMBER | ITEM   | QUANTITY | UNIT |
|-----------------|--|----------|------|
| 120E6300        | Water for Vegetation                           | 3.6      | MGal |
| 230E0100        | Remove and Replace Topsoil                     | Lump Sum | LS   |
| 731E0100        | Fertilizing                                    | 68       | Lb   |
| 733E0100        | Sodding  | 219      | SqYd |
| 734E0845        | Sediment Control at Inlet with Frame and Grate | 4        | Each |
| 734E5010        | Sweeping                                       | 20       | Hour |

### Section L - Signal and Lighting

#### PCN 05V0 (US85 & SD34 Intersection)

| BID ITEM NUMBER | ITEM  | QUANTITY | UNIT |
|-----------------|---|----------|------|
| 110E1510        | Remove Luminaire Pole                           | 3        | Each |
| 110E1520        | Remove Signal Equipment                         | Lump Sum | LS   |
| 110E1540        | Remove Luminaire Pole Footing                   | 3        | Each |
| 110E1570        | Remove Pedestrian Push Button Pole              | 8        | Each |
| 635E2000        | Pedestal Signal Pole                            | 2        | Each |
| 635E2160        | Signal Pole with 60' Mast Arm and Luminaire Arm | 3        | Each |
| 635E2165        | Signal Pole with 65' Mast Arm and Luminaire Arm | 1        | Each |
| 635E3700        | Roadway Luminaire, LED with Photoelectric Cell  | 4        | Each |
| 635E4030        | 3 Section Vehicle Signal Head                   | 11       | Each |
| 635E4040        | 4 Section Vehicle Signal Head                   | 2        | Each |
| 635E4080        | 3 Section Directional Vehicle Signal Head       | 8        | Each |
| 635E5020        | 2' Diameter Footing                             | 12.0     | Ft   |
| 635E5030        | 3' Diameter Footing                             | 52.0     | Ft   |
| 635E5301        | Type 1 Electrical Junction Box                  | 8        | Each |
| 635E5302        | Type 2 Electrical Junction Box                  | 7        | Each |
| 635E5303        | Type 3 Electrical Junction Box                  | 1        | Each |
| 635E5400        | Electrical Service Cabinet                      | 1        | Each |
| 635E5430        | Traffic Signal Controller                       | 1        | Each |
| 635E5520        | Video Detection System                          | 1        | Each |
| 635E5535        | Sawed-In, Preformed Detector Loop               | 32       | Each |
| 635E5560        | Emergency Vehicle Preemption Unit               | 1        | Each |
| 635E5570        | Optical Detector                                | 4        | Each |
| 635E5880        | Accessible Pedestrian Signal                    | 8        | Each |
| 635E5910        | Pedestrian Push Button Pole                     | 8        | Each |
| 635E5922        | Pedestrian Signal Head with Countdown Timer     | 8        | Each |
| 635E5930        | Pedestrian Crossing Sign                        | 8        | Each |
| 635E6200        | Miscellaneous, Electrical                       | Lump Sum | LS   |
| 635E6603        | Backplate for 3 Section Signal Head             | 19       | Each |
| 635E6604        | Backplate for 4 Section Signal Head             | 2        | Each |
| 635E8120        | 2" Rigid Conduit, Schedule 40                   | 2,545    | Ft   |
| 635E8140        | 4" Rigid Conduit, Schedule 40                   | 55       | Ft   |
| 635E8220        | 2" Rigid Conduit, Schedule 80                   | 230      | Ft   |
| 635E8230        | 3" Rigid Conduit, Schedule 80                   | 255      | Ft   |
| 635E9016        | 1/C #6 AWG Copper Wire                          | 3,325    | Ft   |
| 635E9502        | 2/C #14 AWG Copper Tray Cable, K2               | 1,435    | Ft   |
| 635E9504        | 4/C #14 AWG Copper Tray Cable, K2               | 890      | Ft   |
| 635E9507        | 7/C #14 AWG Copper Tray Cable, K2               | 310      | Ft   |
| 635E9520        | 20/C #14 AWG Copper Tray Cable, K2              | 885      | Ft   |
| 635E9600        | #16 AWG Copper Twisted Shielded Pair            | 4,560    | Ft   |
| 635E9710        | 2/C #10 AWG Copper Pole and Bracket Cable       | 260      | Ft   |

### Section M - Pavement Marking

#### PCN 05V0 (US85 & SD34 Intersection)

| BID ITEM NUMBER | ITEM  | QUANTITY | UNIT |
|-----------------|---|----------|------|
| 633E0010        | Cold Applied Plastic Pavement Marking, 4"               | 1,930    | Ft   |
| 633E0030        | Cold Applied Plastic Pavement Marking, 24"              | 705      | Ft   |
| 633E5000        | Grooving for Cold Applied Plastic Pavement Marking, 4"  | 1,235    | Ft   |
| 633E5015        | Grooving for Cold Applied Plastic Pavement Marking, 24" | 705      | Ft   |
| 633E5050        | Surface Preparation for Pavement Marking                | 695      | Ft   |
| 634E0560        | Remove Pavement Marking, 4" or Equivalent               | 500      | Ft   |

#### SPECIFICATIONS

Standard Specifications for Roads and Bridges, 2015 Edition and Required Provisions, Supplemental Specifications, and Special Provisions as included in the Proposal.

|                       |   |             |                    |
|-----------------------|---|-------------|--------------------|
| STATE OF SOUTH DAKOTA | PROJECT<br>NH 0085(00)54, NH 0212(00)13<br>& P 0034(191)9 | SHEET<br>A3 | TOTAL SHEETS<br>A4 |
|-----------------------|---|-------------|--------------------|

## **ENVIRONMENTAL COMMITMENTS**

The SDDOT is committed to protecting the environment and uses Section A Environmental Commitments as a communication tool for the Engineer and Contractor to ensure that attention is given to avoid, minimize, and/or mitigate an environmental impact. Environmental commitments to various agencies and the public have been made to secure approval of this project. An agency with permitting authority can delay a project if identified environmental impacts have not been adequately addressed. Unless otherwise designated, the Contractor's primary contact regarding matters associated with these commitments will be the Project Engineer. These environmental commitments are not subject to change without prior written approval from the SDDOT Environmental Office.

Additional guidance on SDDOT's Environmental Commitments can be accessed through the Environmental Procedures Manual found at: <https://dot.sd.gov/media/documents/EnvironmentalProceduresManual.pdf> >

For questions regarding change orders in the field that may have an effect on an Environmental Commitment, the Project Engineer will contact the Environmental Office at 605-773-3098 or 605-773-4336 to determine whether an environmental analysis and/or resource agency coordination is necessary.

### **COMMITMENT C: WATER SOURCE**

The Contractor will not withdraw water with equipment previously used outside the State of South Dakota or previously used in aquatic invasive species waters within South Dakota without prior approval from the SDDOT Environmental Office. Thoroughly wash all construction equipment to prevent and control the introduction and spread of invasive species into the project vicinity.

#### **Action Taken/Required:**

The Contractor will obtain the necessary permits from the regulatory agencies such as the South Dakota Department of Environment and Natural Resources (DENR) and the United States Army Corps of Engineers (USACE) prior to water extraction activities.

Additional information and mapping of Aquatic Invasive Species in South Dakota can be accessed at: <http://sdleastwanted.com/maps/default.aspx>.

### **COMMITMENT D: WATER QUALITY STANDARDS**

#### **COMMITMENT D2: SURFACE WATER DISCHARGE**

The DENR General Permit for Temporary Discharge is required for temporary dewatering and discharges to waters of the state. The effluent limit for total suspended solids will be 90 mg/L 30-day average. The effluent limit applies to discharges to all waters of the state except discharges to waters classified as cold water permanent fish life propagation waters according to the ARSD 74:51:01:45. For discharges to waters of the state classified as cold water permanent fish life propagation waters, the effluent limit for total suspended solids will be 53 mg/L daily maximum.

The permittee has the option of completing effluent testing or implementing a pollution prevention plan for compliance with this permit. If the permittee

develops a pollution prevention plan instead of total suspended solids sampling, the plan must be developed and implemented prior to discontinuing total suspended solids sampling. Refer to section 3.0 of the permit. If any pollutants are suspected of being discharged, a sample must be taken for those parameters listed in section 2.2 of the permit.

Refer to Commitment D1: Surface Water Quality for stream classification.

#### **Action Taken/Required:**

If construction dewatering is required, the Contractor will obtain the General Permit for Temporary Discharge Activities from the DENR Surface Water Program, 605-773-3351.  
< <http://denr.sd.gov/des/sw/swqformsandpermits.aspx> >

The Contractor will provide a copy of the approved permit to the Project Engineer prior to proceeding with any dewatering activities. The approved permit must be kept on-site and as part of the project records.

Effluent monitoring, as a result of dewatering activities, will be summarized for each month and recorded on a separate Discharge Monitoring Report (DMR) and submitted to DENR monthly. Additional information can be found at < <http://denr.sd.gov/des/sw/WhatisaDMR.aspx> >

### **COMMITMENT E: STORM WATER**

Construction activities constitute 1 acre or more of earth disturbance and/or work in a waterway.

#### **Action Taken/Required:**

The DENR General Permit for Storm Water Discharges Associated with Construction Activities is required for construction activity disturbing one or more acres of earth and work in a waterway. The SDDOT is the owner of this permit and will submit the NOI to DENR 15 days prior to project start in order to obtain coverage under the General Permit. Work can begin once the DENR letter of approval is received.

The Contractor must adhere to the "Special Provision Regarding Storm Water Discharges to Waters of the State."

The Contractor will complete the DENR Contractor Certification Form prior to the pre-construction meeting. The form certifies under penalty of law that the Contractor understands and will comply with the terms and conditions of the permit for this project. Work may not begin on this project until this form is signed and submitted to DENR.

The form can be found at:

<https://denr.sd.gov/des/sw/eforms/CGPAppendixCCA2018Fillable.pdf>

The Contractor is advised that permit coverage may also be required for off-site activities, such as borrow and staging areas, which are the responsibility of the Contractor.

### **Storm Water Pollution Prevention Plan**

The Storm Water Pollution Prevention Plan (SWPPP) will be developed prior to the submittal of the NOI and will be implemented for all construction activities for compliance with the permit. The SWPPP must be kept on-site and updated as site conditions change. Erosion control measures and best management practices will be implemented in accordance with the SWPPP.

The Storm Water, Erosion, and Sediment Control Inspection Report Form DOT 298, will be used for site inspections and to document changes to the SWPPP. A copy of the completed inspection form will be filed with the SWPPP documents and retained for a minimum of three years.

The inspection will include disturbed areas of the construction site that have not been finally stabilized, areas used for storage materials, structural control measures, and locations where vehicles enter or exit the site. These areas will be inspected for evidence of, or the potential for, pollutants entering the drainage system. Erosion and sediment control measures identified in the SWPPP will be observed to ensure that they are operating correctly and sediment is not tracked off of the site.

Information on storm water permits and SWPPPs are available on the following websites:

SDDOT: <https://dot.sd.gov/doing-business/environmental/stormwater>

DENR: <http://denr.sd.gov/des/sw/stormwater.aspx>

EPA: <https://www.epa.gov/npdes>

**COMMITMENT H: WASTE DISPOSAL SITE**

The Contractor will furnish a site(s) for the disposal of construction and/or demolition debris generated by this project.

**Action Taken/Required:**

Construction and/or demolition debris may not be disposed of within the Public ROW.

The waste disposal site(s) will be managed and reclaimed in accordance with the following from the General Permit for Construction/Demolition Debris Disposal Under the South Dakota Waste Management Program issued by the Department of Environment and Natural Resources.

The waste disposal site(s) will not be located in a wetland, within 200 feet of surface water, or in an area that adversely affects wildlife, recreation, aesthetic value of an area, or any threatened or endangered species, as approved by the Environmental Office and the Project Engineer.

If the waste disposal site(s) is located such that it is within view of any ROW, the following additional requirements will apply:

1. Construction and/or demolition debris consisting of concrete, asphalt concrete, or other similar materials will be buried in a trench completely separate from wood debris. The final cover over the construction and/or demolition debris will consist of a minimum of 1 foot of soil capable of supporting vegetation. Waste disposal sites provided outside of the Public ROW will be seeded in accordance with Natural Resources Conservation Service recommendations. The seeding recommendations may be obtained through the appropriate County NRCS Office. The Contractor will control the access to waste disposal sites not within the Public ROW with fences, gates, and placement of a sign or signs at the entrance to the site stating "No Dumping Allowed".
2. Concrete and asphalt concrete debris may be stockpiled within view of the ROW for a period of time not to exceed the duration of the project. Prior to project completion, the waste will be removed from view of the ROW or buried and the waste disposal site reclaimed as noted above.

The above requirements will not apply to waste disposal sites that are covered by an individual solid waste permit as specified in SDCL 34A-6-58, SDCL 34A-6-1.13, and ARSD 74:27:10:06.

Failure to comply with the requirements stated above may result in civil penalties in accordance with South Dakota Solid Waste Law, SDCL 34A-6-1.31.

All costs associated with furnishing waste disposal site(s), disposing of waste, maintaining control of access (fence, gates, and signs), and reclamation of the waste disposal site(s) will be incidental to the various contract items.

**COMMITMENT I: HISTORICAL PRESERVATION OFFICE CLEARANCES**

The SDDOT has obtained concurrence with the State Historical Preservation Office (SHPO or THPO) for all work included within the project limits and all department designated sources and designated option material sources, stockpile sites, storage areas, and waste sites provided within the plans.

**Action Taken/Required:**

All earth disturbing activities not designated within the plans require a cultural resource review prior to scheduling the pre-construction meeting. This work includes, but is not limited to: Contractor furnished material sources, material processing sites, stockpile sites, storage areas, plant sites, and waste areas.

The Contractor will arrange and pay for a record search and when necessary, a cultural resource survey. The Contractor has the option to contact the state Archaeological Research Center (ARC) at 605-394-1936 or another qualified archaeologist, to obtain either a records search or a cultural resources survey. A record search might be sufficient for review if the site was previously surveyed; however, a cultural resources survey may need to be conducted by a qualified archaeologist.

The Contractor will provide ARC with the following: a topographical map or aerial view of which the site is clearly outlined, site dimensions, project number, and PCN. If applicable, provide evidence that the site has been previously disturbed by farming, mining, or construction activities with a landowner statement that artifacts have not been found on the site.

The Contractor will submit the cultural resources survey report to SDDOT Environmental Office, 700 East Broadway Avenue, Pierre, SD 57501-2586. SDDOT will submit the information to the appropriate SHPO/THPO. Allow **30 Days** from the date this information is submitted to the Environmental Engineer for SHPO/THPO review.

In the event of an inadvertent discovery of human remains, funerary objects, or if evidence of cultural resources is identified during project construction activities, then such activities will immediately cease and the Project Engineer will be immediately notified. The Project Engineer will contact the SDDOT Environmental Office to determine an appropriate course of action.

SHPO/THPO review does not relieve the Contractor of the responsibility for obtaining any additional permits and clearances for Contractor furnished material sources, material processing sites, stockpile sites, storage areas, plant sites, and waste areas that affect wetlands, threatened and endangered species, or waterways. The Contractor will not utilize a site known or suspected of having contaminated soil or water. The Contractor will provide the required permits and clearances to the Project Engineer at the preconstruction meeting.