

March 2, 2026

**ADDENDUM NO. 2**

**RE: Item #3, March 4, 2026 Letting - NH 0037(166)73, CR 0907(91)330, PCN 06WT, 09HU,  
Davison County - Curb Ramps, Sidewalk, Signal & Lighting**

**TO WHOM IT MAY CONCERN:**

The following addenda to the plans shall be inserted and made a part of your proposal for the referenced project.

**SPECIAL PROVISIONS:** NO CHANGE

**SDEBS BID PROPOSAL:** *The electronic bid proposal for this contract has been revised to include the changes associated with this addendum. Bidders must log in to the SDEBS to retrieve and incorporate these changes into their bid.*

**Quantities for Bid Items were changed:**

Bid Item 635E3700 "Roadway Luminaire, LED with Photoelectric Cell" changed from 180 to 181 Each

**PLANS:** Please destroy sheets A2, L3, L18, L39 & L47 and replace with the enclosed sheets, dated 2/27/26.

**Sheets A2 & L3:** Quantity for Bid Item 635E3700 "Roadway Luminaire, LED with Photoelectric Cell" changed from 100 to 101 Each.

**Sheet L18:** ESTIMATE OF QUANTITIES table was revised.

**Sheet L39:** CONDUIT LAYOUT was revised to show L45.

**Sheet L47:** CONDUIT LAYOUT was revised to show L49.

Sincerely,

Sam Weisgram  
Engineering Supervisor

SW/gp

CC: Travis Dressen, Mitchell Region Engineer  
Jay Peppel, Mitchell Area Engineer

# ESTIMATE OF QUANTITIES AND ENVIRONMENTAL COMMITMENTS

STATE OF SOUTH DAKOTA	PROJECT	SHEET	TOTAL SHEETS
	NH 0037(166)73 CR 0907 (91)330	A2	A5

Plotting Date: 10/21/2025 Rev 2/27/2026 RJM

## Signal and Lighting – Section L PCN 06WT

## PCN 09HU

BID ITEM NUMBER	ITEM	QUANTITY	UNIT
110E1530	Remove Signal Pole Footing	5	Each
110E5110	Salvage Signal Equipment	Lump Sum	LS
635E2065	Signal Pole with 65' Mast Arm	1	Each
635E2150	Signal Pole with 50' Mast Arm and Luminaire Arm	2	Each
635E2155	Signal Pole with 55' Mast Arm and Luminaire Arm	1	Each
635E3700	Roadway Luminaire, LED with Photoelectric Cell	80	Each
635E4030	3 Section Vehicle Signal Head	12	Each
635E4090	4 Section Directional Vehicle Signal Head	8	Each
635E5030	3' Diameter Footing	49.0	Ft
635E5302	Type 2 Electrical Junction Box	4	Each
635E5304	Type 4 Electrical Junction Box	1	Each
635E5400	Electrical Service Cabinet	1	Each
635E5430	Traffic Signal Controller	1	Each
635E5515	Battery Backup System for Traffic Signal	1	Each
635E5520	Video Detection System	1	Each
635E5560	Emergency Vehicle Preemption Unit	1	Each
635E5570	Optical Detector	4	Each
635E5880	Accessible Pedestrian Signal	8	Each
635E5910	Pedestrian Push Button Pole	8	Each
635E5922	Pedestrian Signal Head with Countdown Timer	8	Each
635E6200	Miscellaneous, Electrical	Lump Sum	LS
635E8110	1" Rigid Conduit, Schedule 40	155	Ft
635E8120	2" Rigid Conduit, Schedule 40	85	Ft
635E8130	3" Rigid Conduit, Schedule 40	85	Ft
635E8140	4" Rigid Conduit, Schedule 40	40	Ft
635E8230	3" Rigid Conduit, Schedule 80	470	Ft
635E9016	1/C #6 AWG Copper Wire	255	Ft
635E9018	1/C #8 AWG Copper Wire	1,905	Ft
635E9502	2/C #14 AWG Copper Tray Cable, K2	1,635	Ft
635E9503	3/C #14 AWG Copper Tray Cable, K2	120	Ft
635E9504	4/C #14 AWG Copper Tray Cable, K2	540	Ft
635E9505	5/C #14 AWG Copper Tray Cable, K2	380	Ft
635E9512	12/C #14 AWG Copper Tray Cable, K2	780	Ft
635E9525	25/C #14 AWG Copper Tray Cable, K2	780	Ft
635E9710	2/C #10 AWG Copper Pole and Bracket Cable	195	Ft

BID ITEM NUMBER	ITEM	QUANTITY	UNIT
009E0010	Mobilization	Lump Sum	LS
009E3260	Miscellaneous Staking	Lump Sum	LS
009E4200	Construction Schedule, Category II	Lump Sum	LS
110E0100	Remove Concrete Footing(s)	Lump Sum	LS
110E1550	Remove Light Tower	7	Each
635E0050	Breakaway Base Luminaire Pole with Arm, 50' Mounting Height	73	Each
635E0150	Breakaway Base Luminaire Pole with Twin Arms, 50' Mounting Height	6	Each
635E3700	Roadway Luminaire, LED with Photoelectric Cell	101	Each
635E5020	2' Diameter Footing	638.0	Ft
635E5301	Type 1 Electrical Junction Box	11	Each
635E5400	Electrical Service Cabinet	4	Each
635E8120	2" Rigid Conduit, Schedule 40	16,160	Ft
635E8220	2" Rigid Conduit, Schedule 80	330	Ft
635E9016	1/C #6 AWG Copper Wire	25,315	Ft
635E9018	1/C #8 AWG Copper Wire	26,445	Ft
635E9710	2/C #10 AWG Copper Pole and Bracket Cable	5,135	Ft

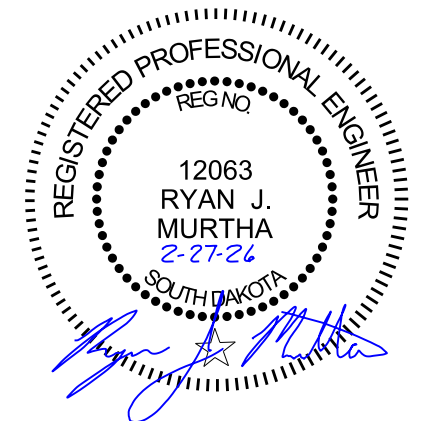

**SECTION L ESTIMATE OF QUANTITIES**

STATE OF SOUTH DAKOTA	PROJECT	SHEET	TOTAL SHEETS
	NH 0037(116)73 CR 0907(91)330	L3	L63

Plotting Date: 7/7/2025 Revised 2/27/26 by KAM

**PCN 06WT**

BID ITEM NUMBER	ITEM	QUANTITY	UNIT
110E1530	Remove Signal Pole Footing	5	Each
110E5110	Salvage Signal Equipment	Lump Sum	LS
635E2065	Signal Pole with 65' Mast Arm	1	Each
635E2150	Signal Pole with 50' Mast Arm and Luminaire Arm	2	Each
635E2155	Signal Pole with 55' Mast Arm and Luminaire Arm	1	Each
635E3700	Roadway Luminaire, LED with Photoelectric Cell	80	Each
635E4030	3 Section Vehicle Signal Head	12	Each
635E4090	4 Section Directional Vehicle Signal Head	8	Each
635E5030	3' Diameter Footing	49.0	Ft
635E5302	Type 2 Electrical Junction Box	4	Each
635E5304	Type 4 Electrical Junction Box	1	Each
635E5400	Electrical Service Cabinet	1	Each
635E5430	Traffic Signal Controller	1	Each
635E5515	Battery Backup System for Traffic Signal	1	Each
635E5520	Video Detection System	1	Each
635E5560	Emergency Vehicle Preemption Unit	1	Each
635E5570	Optical Detector	4	Each
635E5880	Accessible Pedestrian Signal	8	Each
635E5910	Pedestrian Push Button Pole	8	Each
635E5922	Pedestrian Signal Head with Countdown Timer	8	Each
635E6200	Miscellaneous, Electrical	Lump Sum	LS
635E8110	1" Rigid Conduit, Schedule 40	155	Ft
635E8120	2" Rigid Conduit, Schedule 40	85	Ft
635E8130	3" Rigid Conduit, Schedule 40	85	Ft
635E8140	4" Rigid Conduit, Schedule 40	40	Ft
635E8230	3" Rigid Conduit, Schedule 80	470	Ft
635E9016	1/C #6 AWG Copper Wire	255	Ft
635E9018	1/C #8 AWG Copper Wire	1,905	Ft
635E9502	2/C #14 AWG Copper Tray Cable, K2	1,635	Ft
635E9503	3/C #14 AWG Copper Tray Cable, K2	120	Ft
635E9504	4/C #14 AWG Copper Tray Cable, K2	540	Ft
635E9505	5/C #14 AWG Copper Tray Cable, K2	380	Ft
635E9512	12/C #14 AWG Copper Tray Cable, K2	780	Ft
635E9525	25/C #14 AWG Copper Tray Cable, K2	780	Ft
635E9710	2/C #10 AWG Copper Pole and Bracket Cable	195	Ft

**PCN 09HU**

BID ITEM NUMBER	ITEM	QUANTITY	UNIT
009E0010	Mobilization	Lump Sum	LS
009E3260	Miscellaneous Staking	Lump Sum	LS
009E4200	Construction Schedule, Category II	Lump Sum	LS
110E0100	Remove Concrete Footing(s)	Lump Sum	LS
110E1550	Remove Light Tower	7	Each
635E0050	Breakaway Base Luminaire Pole with Arm, 50' Mounting Height	73	Each
635E0150	Breakaway Base Luminaire Pole with Twin Arms, 50' Mounting Height	6	Each
635E3700	Roadway Luminaire, LED with Photoelectric Cell	101	Each
635E5020	2' Diameter Footing	638.0	Ft
635E5301	Type 1 Electrical Junction Box	11	Each
635E5400	Electrical Service Cabinet	4	Each
635E8120	2" Rigid Conduit, Schedule 40	16,160	Ft
635E8220	2" Rigid Conduit, Schedule 80	330	Ft
635E9016	1/C #6 AWG Copper Wire	25,315	Ft
635E9018	1/C #8 AWG Copper Wire	26,445	Ft
635E9710	2/C #10 AWG Copper Pole and Bracket Cable	5,135	Ft

**SUPPLYING AS BUILT PLANS**

If the traffic signal system or roadway lighting system are constructed differently than what is stated in the plans, the Contractor will supply as built plans to the Engineer and a copy will be sent to the Traffic Design Engineer. The as built plans may include conduit layouts, wiring diagrams, or other drawings depicting the changes from the original plans.

**SHOP DRAWING AND CATALOG CUTS SUBMITTALS**

The Contractor will submit shop drawings and catalog cuts in accordance with Section 985 of the Specifications.

PDF submittals will be sent to the following email addresses:

Stacy.Bartlett@state.sd.us  
Joseph.Updike@state.sd.us  
KristaM@infrastructureedg.com (for PCN 06WT)

**ON-SITE INSPECTION**

An on-site inspection of the traffic signal will be conducted before acceptance of the project once the traffic signal is completed and operational. The on-site inspection will be conducted by the Project Engineer or Region Traffic Engineer with the Contractor, City Traffic Division Supervisor, and the Traffic Design Engineer present.

**REMOVE LIGHT TOWER**

The Contractor will remove existing light tower poles ETL1-ETL7. All costs associated with the removal and disposal of the light tower poles will be incidental to the contract price per each for "Remove Light Tower".

**REMOVE CONCRETE FOOTING**

The footings of existing luminaire tower poles ETL1-ETL7 will be removed by the Contractor to a minimum of 2' below the ground surface. Restoration of the disturbed area will be to the satisfaction of the Engineer.

All costs for removing the footings of the existing luminaire poles will be incidental to the contract lump sum for "Remove Concrete Footing(s)."

**REMOVE SIGNAL POLE FOOTING**

The footings of existing signal poles ES1-ES4 will be removed by the Contractor to a minimum of 2 feet below the ground surface. Restoration of the disturbed area will be to the satisfaction of the Engineer.

All costs for removing the footings of the existing signal poles will be incidental to the contract unit price per each for "Remove Signal Pole Footing".

**SALVAGE SIGNAL EQUIPMENT**

The existing signal equipment identified on the plans will be salvaged and delivered to the City of Mitchell by the Contractor. The Contractor will notify the Public Works Department 5 days before the delivery of the salvaged signal equipment to coordinate place and time of delivery. The City contact is Joshua Harvey at (605) 995-8408.

Any equipment damaged during salvaging or delivery will be repaired or replaced by the Contractor at no cost to the State.

All costs for work involved in the salvage and delivery of the existing signal equipment will be incidental to the contract lump sum price for "Salvage Signal Equipment".



# CONDUIT LAYOUT EXIT 330, RAMP D & C



ESTIMATE OF QUANTITIES			
KEY	ITEM	EST QUANT	UNIT
	Remove Concrete Footings (ETL1-ETL7)	LS	EACH
◆	Remove Light Tower (ETL1-ETL7)	7	EACH
—	Breakaway Base Luminaire Pole w/8' Arm 50' Mount Height (L1-L3, L5-L24, L26-L33, L35-L42, L44-L51, L53-L60, L62-L79)	73	EACH
—	Breakaway Base Twin Luminaire Pole w/8' Arm 50' Mount. Height (L4, L25, L34, L43, L52, L61)	6	EACH
•	Roadway Luminaire, LED with P.E. (L1-L79, ESG1-ESG3, EL1-EL13)	101	EACH
○	2' Diameter Footing (L1-L79)	638	FT
□	Type 1 Electrical Junction Box (JL1-JL11)	11	EACH
▲	Electrical Service Cabinet	5	EACH
∅	Galvanized Steel Utility Pole Not a Bid Item	5	EACH
Ⓜ	Meter Socket Not a Bid Item	5	EACH
◇	2" Rigid Conduit, Schedule 40	16,160	FT
◇	2" Rigid Conduit, Schedule 80	330	FT
○	1/C #6 AWG Copper Wire	25,315	FT
○	1/C #8 AWG Copper Wire	26,445	FT
	2/C #10 AWG Copper Pole & Bracket Cable	5,135	FT

EXISTING ITEMS	
KEY	ITEM
◆	Existing Luminaire (EL1-EL18)
⚙	Existing Signal Pole (ES1-ES8)
⊙	Existing Junction Box (EJL1-EJL9)
⚡	Existing Snowgate (ESG1-ESG4)

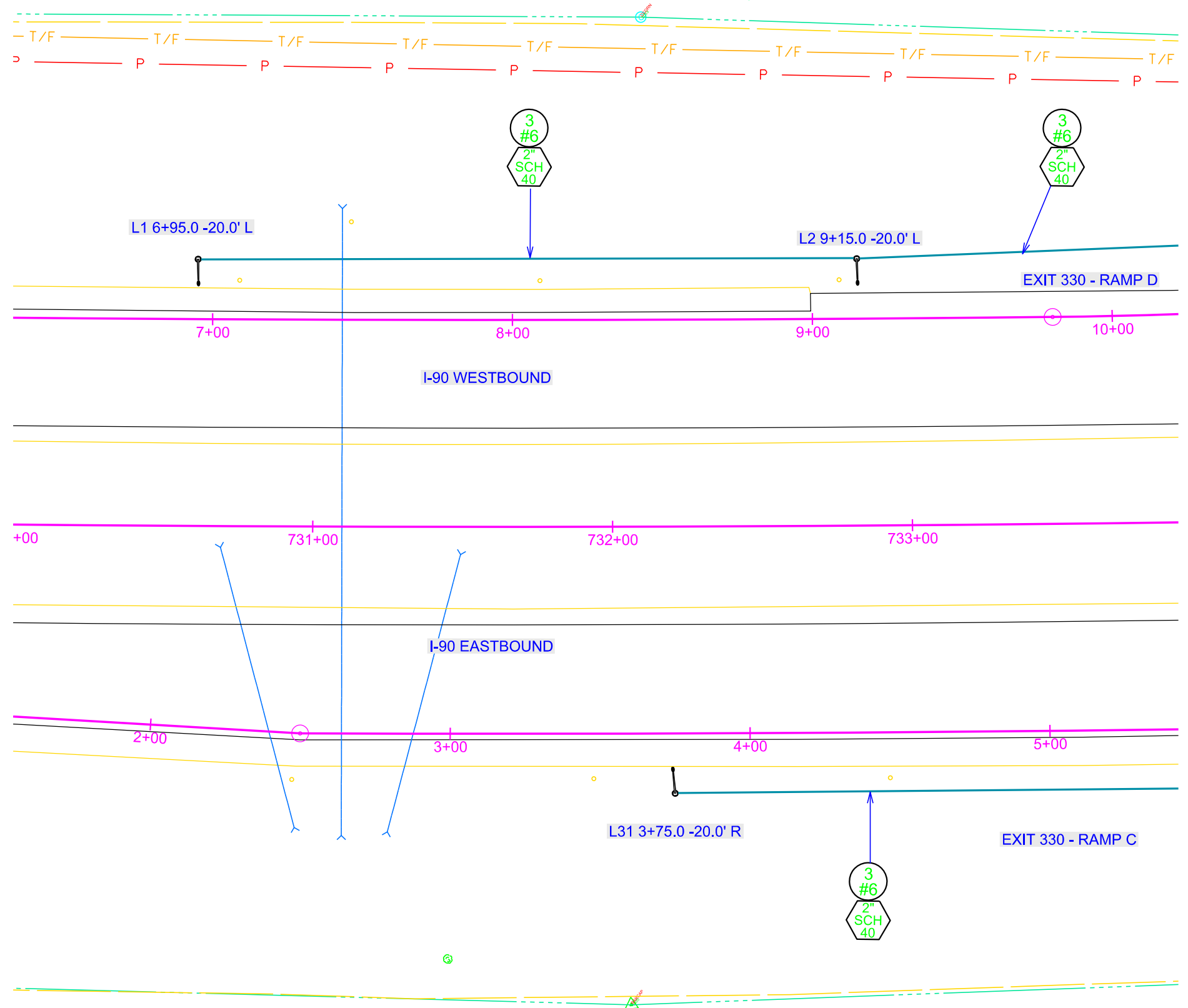

Plot Scale - 1"=40'

Plotted From - TRR011715

File - ...1190\_exit330\_RampActa.dgn

# CONDUIT LAYOUT EXIT 332, RAMP D & C

STATE OF SOUTH DAKOTA	PROJECT	SHEET	TOTAL SHEETS
	CR 0907(91)330	L39	L63

Revised: 02/27/2026-JU

Plot Scale - 1:200

Plotted From - T:\RRC\1715

File - ...190\_exit332\_RampAc3.dgn

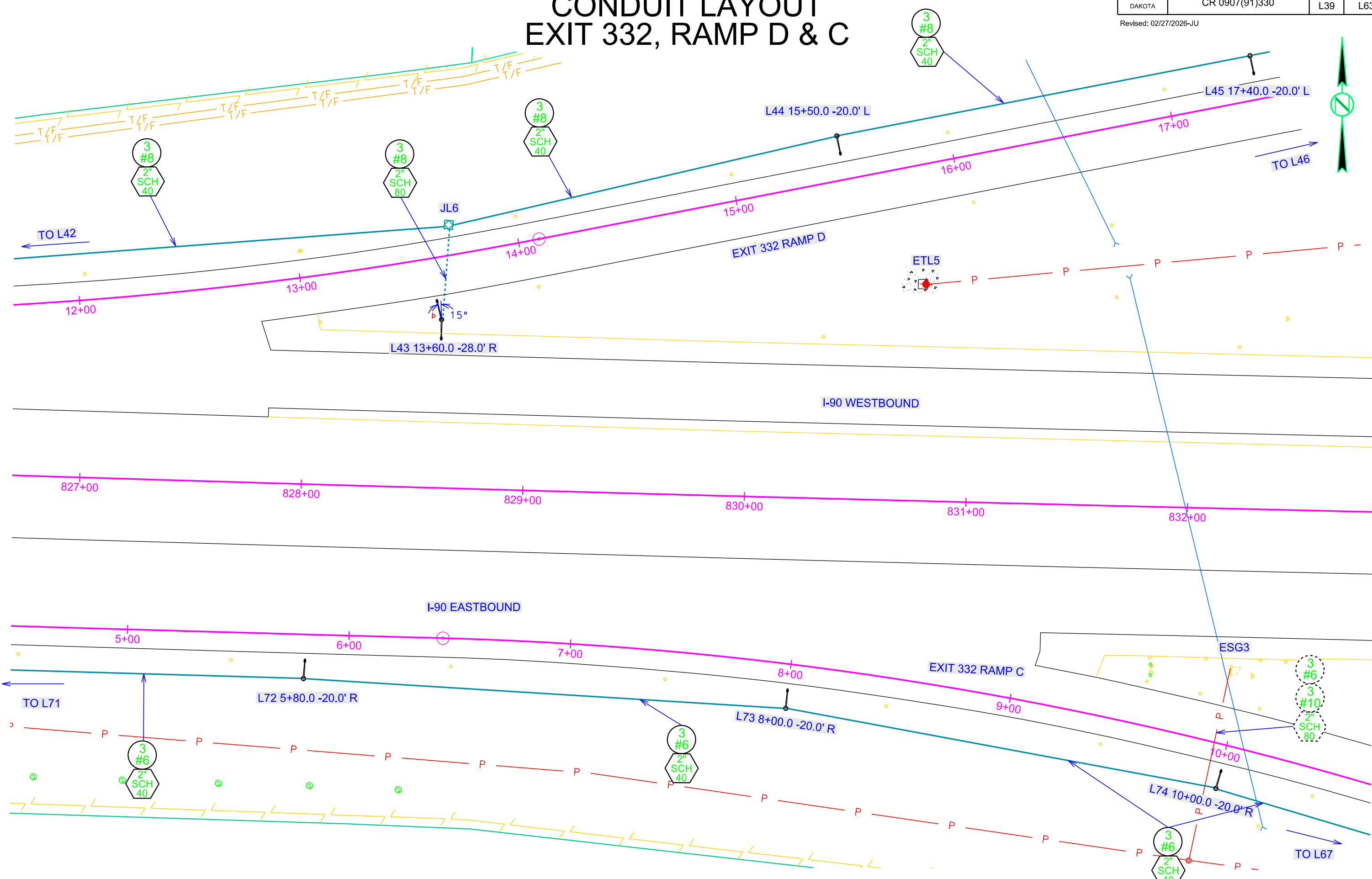

# CONDUIT LAYOUT EXIT 332, RAMP A

STATE OF SOUTH DAKOTA	PROJECT	SHEET	TOTAL SHEETS
	CR 0907(91)330	L47	L63

Revised: 02/27/2026-JU

Plot Scale - 1/4" = 1'

Plotted From - TRR011715

File - ...1190\_exit332\_RampB2.dgn

