

November 8, 2024

Re: Project's NH-CR 0014(185)229, 436() – PCN's 026Z & X05W– Urban Grading, Curb & Gutter, Sidewalk, Signals, Storm Sewer, Lighting, Asphalt Concrete Surfacing, PCC Surfacing, Water Main Improvement & Sewer Manhole Adjustments

To Whom It May Concern,

A pre-bid meeting for the US 14 (Euclid Ave) Reconstruction project is being held on November 26th at 1:30 PM CST via Microsoft TEAMS. Interested contracting parties are invited to attend the meeting virtually via the Microsoft Teams Meeting Link provided below.

This meeting will include a presentation of the project covering topics such as the overall scope of work, design aspects, traffic control, and contract time. There will be an opportunity for Contractors to present questions to Department staff, consultants, and project stakeholders.

Attendance is not a requirement, but all interested contracting parties are strongly encouraged to attend.

If attending the meeting you must join the meeting via the link provided. In order to reduce sound feedback please mute the microphone on your computer. Due to the meeting being virtual we are requesting that you please enter the name of your company followed by the individuals from your company attending the meeting into the chat feature of Microsoft Teams.

[Join Pre-bid Meeting](#)

Date: November 26, 2024

Time: 1:30-3:30 PM (CST)

Meeting ID: 211 221 837 478

Additional instructions regarding the meeting format will be provided at the beginning of the meeting.

We look forward to seeing you there!

Sincerely,
SD DOT

STATE OF SOUTH DAKOTA
DEPARTMENT OF TRANSPORTATION
PLANS FOR PROPOSED

STATE OF SOUTH DAKOTA	PROJECT	SHEET	TOTAL SHEETS
	NH-CR 0014(185)229	1	457

Plotting Date: 4/16/2024

PROJECT NH-CR 0014(185)229 U.S. HIGHWAY 14 HUGHES COUNTY

URBAN GRADING, CURB & GUTTER, ADA UPGRADES, TRAFFIC SIGNALS, STORM SEWER, ROADWAY LIGHTING, SURFACING
PCN 026Z

INDEX OF SECTIONS

- Section A: Estimate of Quantities and Environmental Commitments
- Section B: Grading Plans
- Section C: Traffic Control
- Section D: Erosion Control
- Section F: Surfacing
- Section L: Lighting and Signal Plans
- Section M: Pavement Marking Plans
- Section S: Permanent Signing
- Section X: Cross Sections

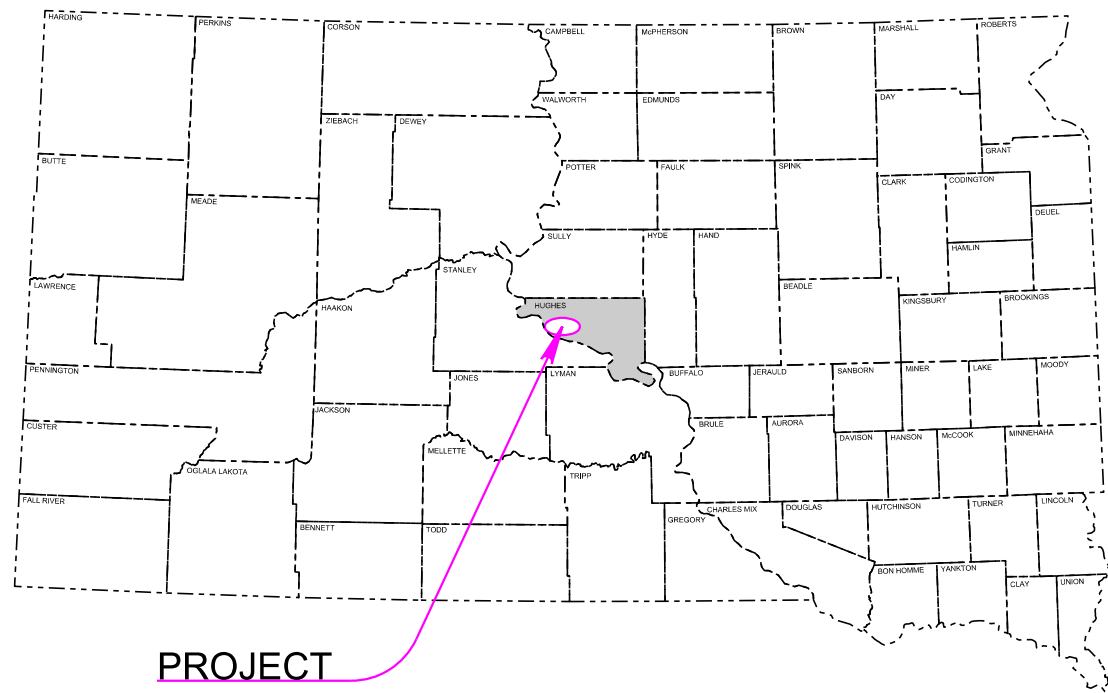

PROJECT

BEGIN NH-CR 0014(185)229
Sioux Avenue
Station 10+30.00
890.81 feet West and 343.93 feet South of the Northeast corner of Section 5 - Township 110 North - Range 79 West
MRM 229.13+0.006

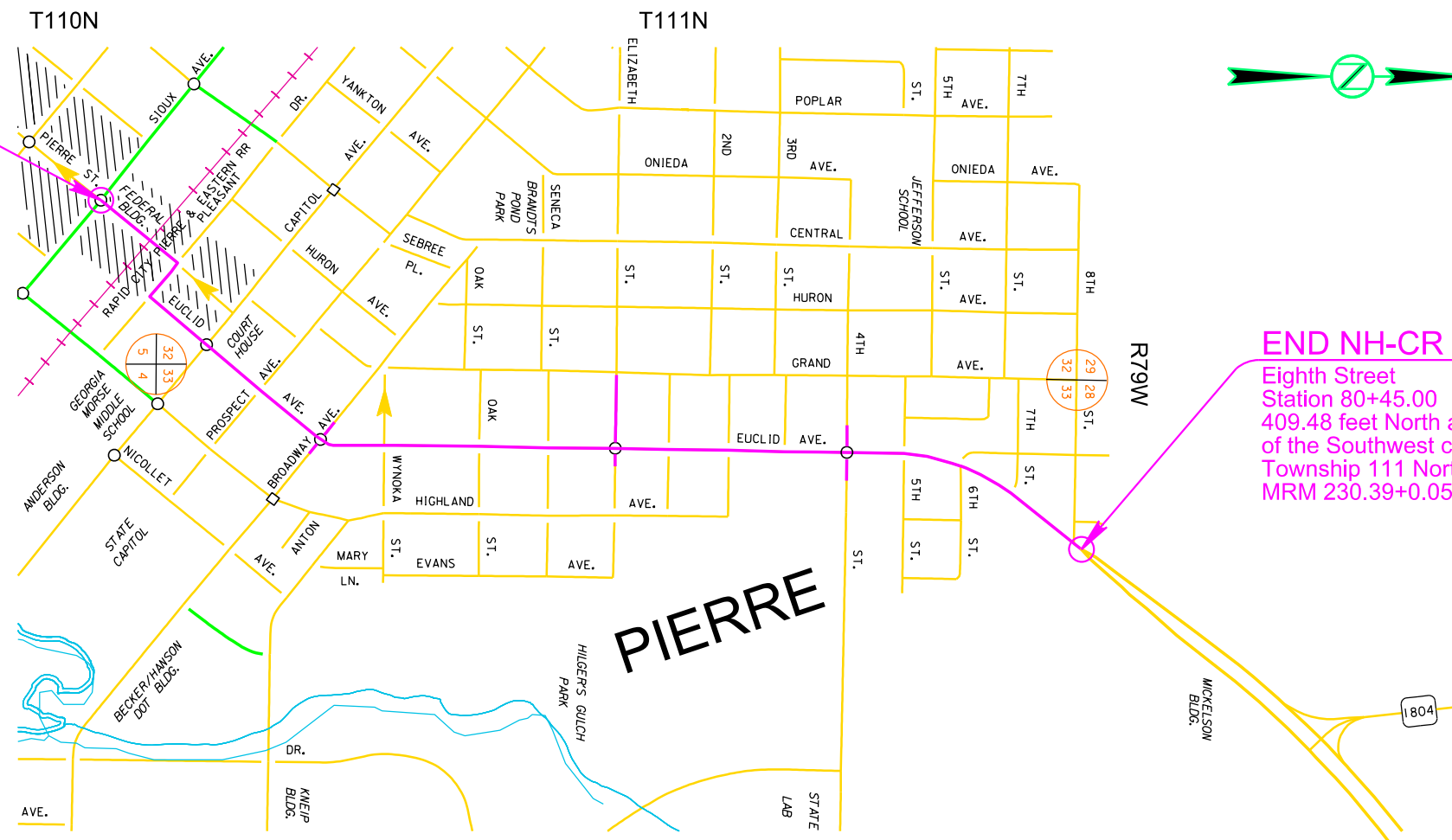

END NH-CR 0014(185)229
Eighth Street
Station 80+45.00
409.48 feet North and 1299.25 feet East of the Southwest corner of Section 28 - Township 111 North - Range 79 West
MRM 230.39+0.050

DESIGN DESIGNATION

ADT (2022)	6295
ADT (2042)	9058
DHV	1443
D	50%
T DHV	1%
T ADT	1.2%
V	35 mph (US14 - South of 4th Street) 40 mph (US14 - North of 4th Street)

STORM WATER PERMIT

Major Receiving
Body of Water: Missouri River
Area Disturbed: 40 Acres
Total Project Area: 43 Acres
Approx. Begin Lat,Long: 4.3668, -100.3538

Gross Length	7015.00 Feet	1.329 Miles
Length of Exceptions	0.00 Feet	0.000 Miles
Net Length	7015.00 Feet	1.329 Miles

1

December 11, 2024



Plot Scale - 1:200

GENSEZ

Plotted From -

File - ...Section_A\Title.dgn

ESTIMATE OF QUANTITIES AND ENVIRONMENTAL COMMITMENTS

STATE OF SOUTH DAKOTA	PROJECT	SHEET	TOTAL SHEETS
	NH-CR 0014(185)229	A1	A7

Section B - Grading

REV 05-31-24 GE
REV 07-09-24 GE
REV 08-27-24 GE

BID ITEM NUMBER	ITEM	QUANTITY	UNIT
009E0010	Mobilization	Lump Sum	LS
009E3220	Reestablish Right-of-Way and Property Corner	152	Each
009E3230	Grade Staking	2,902	Mile
009E3250	Miscellaneous Staking	1,392	Mile
009E3301	Engineer Directed Surveying/Staking	80.0	Hour
009E4300	Construction Schedule, Category III	Lump Sum	LS
009E4330	Project Management, Category III	Lump Sum	LS
100E0020	Clear and Grub Tree	70	Each
100E0100	Clearing	Lump Sum	LS
110E0300	Remove Concrete Curb and/or Gutter	15,215	Ft
110E0400	Remove Drop Inlet	39	Each
110E1100	Remove Concrete Pavement	1,433.0	SqYd
110E1130	Remove Concrete Driveway Pavement	2,711.3	SqYd
110E1140	Remove Concrete Sidewalk	9,383.3	SqYd
110E5720	Salvage Drop Inlet Frame and Grate Assembly	5	Each
120E0010	Unclassified Excavation	41,396	CuYd
120E6000	Water for Dust Control	50.0	MGal
120E6100	Water for Embankment	14.5	MGal
250E0020	Incidental Work, Grading	Lump Sum	LS
260E6010	Granular Material	2,241.0	Ton
270E0022	Salvage Asphalt Mix Material	11,612.1	Ton
270E0112	Salvage Granular Material	21,353.1	Ton
380E2564	4" Barrier Type Colored Median PCC Pavement	344.6	SqYd
380E3540	8" PCC Approach Pavement	3,736.7	SqYd
380E4050	8" PCC Fillet Section	1,542.0	SqYd
450E0122	18" RCP Class 2, Furnish	4,214	Ft
450E0130	18" RCP, Install	4,214	Ft
450E0142	24" RCP Class 2, Furnish	2,028	Ft
450E0150	24" RCP, Install	2,028	Ft
450E0162	30" RCP Class 2, Furnish	542	Ft
450E0170	30" RCP, Install	542	Ft
450E0182	36" RCP Class 2, Furnish	826	Ft
450E0190	36" RCP, Install	826	Ft
450E0192	42" RCP Class 2, Furnish	2,064	Ft
450E0200	42" RCP, Install	2,064	Ft
450E0212	54" RCP Class 2, Furnish	162	Ft
450E0220	54" RCP, Install	162	Ft
450E0222	60" RCP Class 2, Furnish	64	Ft
450E0230	60" RCP, Install	64	Ft
450E2044	60" RCP Flared End, Furnish	1	Each
450E2045	60" RCP Flared End, Install	1	Each
450E3062	54" RCP Arch Class 2, Furnish	398	Ft
450E3070	54" RCP Arch, Install	398	Ft

BID ITEM NUMBER	ITEM	QUANTITY	UNIT
450E4798	42" CMP 14 Gauge, Furnish	302	Ft
450E4800	42" CMP, Install	302	Ft
450E5030	42" CMP Elbow, Furnish	2	Each
450E5031	42" CMP Elbow, Install	2	Each
451E0518	8" PVC Pipe	28	Ft
451E3118	18" Pipe Cap	1	Each
462E0100	Class M6 Concrete	334.1	CuYd
480E0100	Reinforcing Steel	63,179	Lb
600E0300	Type III Field Laboratory	1	Each
650E0060	Type B66 Concrete Curb and Gutter	13,563	Ft
650E0080	Type B68 Concrete Curb and Gutter	1,843	Ft
650E4660	Type P6 Concrete Gutter	1,272	Ft
650E4680	Type P8 Concrete Gutter	70	Ft
650E6280	8" Concrete Valley Gutter	333.5	SqYd
651E0040	4" Concrete Sidewalk	24,073	SqFt
651E0060	6" Concrete Sidewalk	84,113	SqFt
651E0560	6" Colored Concrete Sidewalk	29,250	SqFt
651E5000	Sidewalk Drain	23.0	Ft
651E7000	Type 1 Detectable Warnings	1,737	SqFt
670E1200	Type B Frame and Grate	84	Each
670E4448	7' x 11' Concrete Type S Drop Inlet Base	3	Each
670E5340	4' x 11' Precast Concrete Type S Drop Inlet Lid	3	Each
670E5400	Precast Drop Inlet Collar	84	Each
671E4048	48" Manhole Riser Section	41.3	Ft
671E6009	Type A9 Manhole Frame and Lid	33	Each
900E0010	Refurbish Single Mailbox	7	Each
900E1150	Right of Way Marker	6	Each
900E5145	Boilard	2	Each
998E0100	Railroad Protective Insurance	Lump Sum	LS

INDEX OF SHEETS

A1 to A3 Estimate of Quantities for Sections B, C, D, F, L,
M and S
A4 to A7 Environmental Commitments

Section C - Traffic Control

BID ITEM NUMBER	ITEM	QUANTITY	UNIT
633E6005	Pavement Marking Masking, 5"	885	Ft
633E6035	Pavement Marking Masking, Combination Arrow	4	Each
634E0010	Flagging	1,000.0	Hour
634E0110	Traffic Control Signs	1,178.7	SqFt
634E0120	Traffic Control, Miscellaneous	Lump Sum	LS
634E0135	Traffic Control Supervisor	Lump Sum	LS
634E0275	Type 3 Barricade	58	Each
634E0330	Temporary Raised Pavement Markers	18,743	Ft
634E0420	Type C Advance Warning Arrow Board	2	Each
634E0640	Temporary Pavement Marking	28,858	Ft
634E0700	Traffic Control Movable Concrete Barrier	17	Each
634E1002	Detour and Restriction Signing	1,492.5	SqFt
634E1020	Temporary Business Signing	98.4	SqFt
634E1215	Contractor Furnished Portable Changeable Message Sign	3	Each
634E2000	Longitudinal Pedestrian Barricade	348	Ft
634E2015	Temporary Pedestrian Access Route	Lump Sum	LS
634E2020	Temporary Curb Ramp	5	Each
634E3000	Traffic Control Barrier	1,705	Ft



Section D - Erosion and Sediment Control

Section F - Surfacing

Rev 06-07-24 GCE

Rev 06-11-24 GCE
Rev 08-29-24 GCE

BID ITEM NUMBER	ITEM	QUANTITY	UNIT
110E1690	Remove Sediment	31.9	CuYd
110E1693	Remove Erosion Control Wattle	830	Ft
110E1695	Remove Sediment Filter Bag	3,692	Ft
110E1700	Remove Silt Fence	2,796	Ft
120E6300	Water for Vegetation	144.3	MGal
230E0010	Placing Topsoil	1,203	CuYd
730E0206	Type D Permanent Seed Mixture	448	Lb
730E0251	Special Permanent Seed Mixture 1	2	Lb
730E0252	Special Permanent Seed Mixture 2	29	Lb
731E0200	Fertilizing	1.10	Ton
732E0500	Fiber Reinforced Matrix	2.5	Ton
734E0101	Type 1 Erosion Control Blanket	250	SqYd
734E0103	Type 3 Erosion Control Blanket	260	SqYd
734E0154	12" Diameter Erosion Control Wattle	830	Ft
734E0165	Remove and Reset Erosion Control Wattle	208	Ft
734E0170	Temporary Sediment Barrier	2,241	Ft
734E0180	Sediment Filter Bag	3,692	Ft
734E0185	Remove and Reset Sediment Filter Bag	923	Ft
734E0604	High Flow Silt Fence	2,796	Ft
734E0610	Mucking Silt Fence	194	CuYd
734E0620	Repair Silt Fence	699	Ft
734E0845	Sediment Control at Inlet with Frame and Grate	117	Each
734E0847	Sediment Control at Type S Reinforced Concrete Drop Inlet	52	Ft
734E5005	Dewatering	Lump Sum	LS
734E5010	Sweeping	15	Hour
900E1320	Construction Entrance	2	Each

BID ITEM NUMBER	ITEM	QUANTITY	UNIT
009E3320	Checker	Lump Sum	LS
120E0010	Unclassified Excavation	482	CuYd
120E6200	Water for Granular Material	661.5	MGal
120E9000	Pit Run	652.4	Ton
260E1010	Base Course	21,415.1	Ton
260E1030	Base Course, Salvaged	32,965.2	Ton
270E0220	Blend and Stockpile Granular Material	32,965.2	Ton
320E1200	Asphalt Concrete Composite	588.6	Ton
320E3000	Compaction Sample	9	Each
330E0010	MC-70 Asphalt for Prime	59.8	Ton
330E0100	SS-1h or CSS-1h Asphalt for Tack	34.0	Ton
330E0300	SS-1h or CSS-1h Asphalt for Fog Seal	10.0	Ton
330E1000	Blotting Sand for Prime	10.0	Ton
330E3000	Sand for Fog Seal	10.0	Ton
360E0042	CRS-2P Asphalt for Surface Treatment	57.8	Ton
360E1200	Modified Cover Aggregate	492.6	Ton
380E0050	8" Nonreinforced PCC Pavement	7,285.8	SqYd
380E3020	6" PCC Driveway Pavement	143.6	SqYd
380E3040	8" PCC Driveway Pavement	139.2	SqYd
380E6000	Dowel Bar	11,875	Each
380E6110	Insert Steel Bar in PCC Pavement	163	Each
450E4748	15" CMP 14 Gauge, Furnish	190	Ft
450E4750	15" CMP, Install	190	Ft
450E5402	15" CMP Safety End, Furnish	2	Each
450E5403	15" CMP Safety End, Install	2	Each
831E0210	Non-woven Separator Fabric	848	SqYd
831E0300	Reinforcement Fabric (MSE)	46,429	SqYd

Alternate A

BID ITEM NUMBER	ITEM	QUANTITY	UNIT
320E0008	PG 64-34 Asphalt Binder	855.7	Ton
320E1060	Class G Asphalt Concrete	14,875.4	Ton
320E4000	Hydrated Lime	147.5	Ton

Alternate B

BID ITEM NUMBER	ITEM	QUANTITY	UNIT
320E0008	PG 64-34 Asphalt Binder	756.1	Ton
320E1060	Class G Asphalt Concrete	15,275.9	Ton
320E4000	Hydrated Lime	152.2	Ton



Section L - Signal and Lighting

BID ITEM NUMBER	ITEM	QUANTITY	UNIT
110E1530	Remove Signal Pole Footing	14	Each
110E1540	Remove Luminaire Pole Footing	63	Each
110E5100	Salvage Luminaire Pole	61	Each
110E5110	Salvage Signal Equipment	Lump Sum	LS
635E0040	Breakaway Base Luminaire Pole with Arm, 40' Mounting Height	48	Each
635E0050	Breakaway Base Luminaire Pole with Arm, 50' Mounting Height	2	Each
635E0140	Breakaway Base Luminaire Pole with Twin Arms, 40' Mounting Height	1	Each
635E2025	Signal Pole with 25' Mast Arm	1	Each
635E2030	Signal Pole with 30' Mast Arm	3	Each
635E2035	Signal Pole with 35' Mast Arm	3	Each
635E2050	Signal Pole with 50' Mast Arm	1	Each
635E2140	Signal Pole with 40' Mast Arm and Luminaire Arm	2	Each
635E2145	Signal Pole with 45' Mast Arm and Luminaire Arm	3	Each
635E2150	Signal Pole with 50' Mast Arm and Luminaire Arm	1	Each
635E2155	Signal Pole with 55' Mast Arm and Luminaire Arm	2	Each
635E2160	Signal Pole with 60' Mast Arm and Luminaire Arm	1	Each
635E3700	Roadway Luminaire, LED with Photoelectric Cell	62	Each
635E4030	3 Section Vehicle Signal Head	52	Each
635E4040	4 Section Vehicle Signal Head	20	Each
635E5020	2' Diameter Footing	376.0	Ft
635E5030	3' Diameter Footing	192.0	Ft
635E5302	Type 2 Electrical Junction Box	41	Each
635E5303	Type 3 Electrical Junction Box	14	Each
635E5304	Type 4 Electrical Junction Box	20	Each
635E5400	Electrical Service Cabinet	6	Each
635E5430	Traffic Signal Controller	4	Each
635E5470	Wireless Interconnect System	4	Each
635E5510	Signal Flasher Unit	2	Each
635E5515	Battery Backup System for Traffic Signal	5	Each
635E5520	Video Detection System	5	Each
635E5530	Preformed Detector Loop	30	Each
635E5560	Emergency Vehicle Preemption Unit	4	Each
635E5570	Optical Detector	17	Each
635E5800	Miscellaneous Signal Parts	Lump Sum	LS
635E5880	Accessible Pedestrian Signal	40	Each
635E5910	Pedestrian Push Button Pole	40	Each
635E5922	Pedestrian Signal Head with Countdown Timer	40	Each
635E5930	Pedestrian Crossing Sign	40	Each
635E5960	Solar Powered Flashing Beacon	3	Each
635E6100	Over-Height Vehicle Detection System	2	Each
635E6200	Miscellaneous, Electrical	Lump Sum	LS
635E7500	Remove and Reset Luminaire Pole	2	Each

BID ITEM NUMBER	ITEM	QUANTITY	UNIT
635E8120	2" Rigid Conduit, Schedule 40	12,000	Ft
635E8140	4" Rigid Conduit, Schedule 40	270	Ft
635E8220	2" Rigid Conduit, Schedule 80	6,625	Ft
635E8230	3" Rigid Conduit, Schedule 80	2,820	Ft
635E8240	4" Rigid Conduit, Schedule 80	240	Ft
635E8320	2" Innerduct, Schedule 40	7,095	Ft
635E8853	2/2/4 Aluminum Wire	17,220	Ft
635E9014	1/C #4 AWG Copper Wire	3,840	Ft
635E9016	1/C #6 AWG Copper Wire	1,485	Ft
635E9020	1/C #10 AWG Copper Wire	7,210	Ft
635E9502	2/C #14 AWG Copper Tray Cable, K2	6,935	Ft
635E9504	4/C #14 AWG Copper Tray Cable, K2	2,550	Ft
635E9505	5/C #14 AWG Copper Tray Cable, K2	900	Ft
635E9507	7/C #14 AWG Copper Tray Cable, K2	2,740	Ft
635E9512	12/C #14 AWG Copper Tray Cable, K2	65	Ft
635E9519	19/C #14 AWG Copper Tray Cable, K2	255	Ft
635E9524	24/C #14 AWG Copper Tray Cable, K2	2,740	Ft
635E9710	2/C #10 AWG Copper Pole and Bracket Cable	3,430	Ft
635E9924	24 Strand Fiber Optic Cable	7,320	Ft
900E5135	Traffic Counter Surface Utility Box	4	Each

Section M - Pavement Marking

BID ITEM NUMBER	ITEM	QUANTITY	UNIT
633E0010	Cold Applied Plastic Pavement Marking, 4"	25,176	Ft
633E0030	Cold Applied Plastic Pavement Marking, 24"	2,555	Ft
633E0040	Cold Applied Plastic Pavement Marking, Arrow	62	Each
633E0045	Cold Applied Plastic Pavement Marking, Combination Arrow	4	Each
633E0046	Cold Applied Plastic Pavement Marking, Lane Reduction Arrow	2	Each
633E0062	Cold Applied Plastic Pavement Marking, Symbol	1	Each
633E5000	Grooving for Cold Applied Plastic Pavement Marking, 4"	25,176	Ft
633E5015	Grooving for Cold Applied Plastic Pavement Marking, 24"	2,555	Ft
633E5025	Grooving for Cold Applied Plastic Pavement Marking, Arrow	62	Each
633E5030	Grooving for Cold Applied Plastic Pavement Marking, Combination Arrow	4	Each
633E5031	Grooving for Cold Applied Plastic Pavement Marking, Lane Reduction Arrow	2	Each
633E5037	Grooving for Cold Applied Plastic Pavement Marking, Symbol	1	Each
634E0560	Remove Pavement Marking, 4" or Equivalent	4,323	Ft
634E0565	Remove Pavement Marking, Arrow	7	Each

Section S - Permanent Signing

BID ITEM NUMBER	ITEM	QUANTITY	UNIT
110E5020	Salvage Traffic Sign	73	Each
110E7150	Remove Sign for Reset	36	Each
632E3500	Reset Sign	36	Each

SPECIFICATIONS

Standard Specifications for Roads and Bridges, 2015 Edition and Required Provisions, Supplemental Specifications, and Special Provisions as included in the Proposal.



ENVIRONMENTAL COMMITMENTS

The SDDOT is committed to protecting the environment and uses Environmental Commitments as a communication tool for the Engineer and Contractor to ensure that attention is given to avoid, minimize, and/or mitigate an environmental impact. Environmental commitments to various agencies and the public have been made to secure approval of this project. An agency with permitting authority can delay a project if identified environmental impacts have not been adequately addressed. Unless otherwise designated, the Contractor's primary contact regarding matters associated with these commitments will be the Project Engineer. During construction, the Project Engineer will verify that the Contractor has met Environmental Commitment requirements. These environmental commitments are not subject to change without prior written approval from the SDDOT Environmental Office.

Additional guidance on SDDOT's Environmental Commitments can be accessed through the Environmental Procedures Manual found at: <<https://dot.sd.gov/media/documents/EnvironmentalProceduresManual.pdf>>

For questions regarding change orders in the field that may have an effect on an Environmental Commitment, the Project Engineer will contact the Environmental Engineer at 605-773-3180 or 605-773-4336 to determine whether an environmental analysis and/or resource agency coordination is necessary.

Once construction is complete, the Project Engineer will review all environmental commitments for the project and document their completion.

COMMITMENT A: AQUATIC RESOURCES

COMMITMENT A1: WETLANDS

All efforts to avoid and minimize wetland impacts from the project have resulted in approximately 0.023 acres of wetlands (includes temporary and permanent) becoming impacted. Refer to Section B – Grading Plans for location and boundaries of the impacted wetlands.

Table of Impacted Wetlands

Wetland No.	Station	Perm. Impact Left (Acres)	Perm. Impact Right (Acres)	Temp. Impact Left (Acres)	Temp. Impact Right (Acres)	Total Impact (Acres)
1	939+00	0.00	0.01	0.00	0.013	0.023

Action Taken/Required:

Mitigation is required in accordance with the "Statewide Finding Regarding Wetlands for South Dakota Federal-Aid Highway Projects (February 2018)". Replacement of 0.01 acre(s) of permanent wetland impacts will be completed through another wetland mitigation opportunity in a manner which considers FHWA's program-wide goal of 'net gain' of wetlands through enhancement, creation, and preservation.

Temporary impacts identified in the Table of Impacted Wetlands will not be mitigated as original contours and elevations will be re-established as designated in Section B – Grading Plans. Prior to initiating temporary work in wetlands, the Contractor will submit a plan to the Project Engineer in accordance with Section 7.21 D of the Specifications.

The Contractor will notify the Project Engineer if additional easement is needed to complete work adjacent to any wetland. The Project Engineer will obtain an appropriate course of action from the Environmental Office before proceeding with construction activities that affect any wetlands beyond the work limits and easements shown in the plans.

COMMITMENT C: WATER SOURCE

The Contractor will not withdraw water with equipment previously used outside the State of South Dakota or previously used in aquatic invasive species (AIS) positive waters within South Dakota without prior approval from the SDDOT Environmental Office. To prevent and control the introduction and spread of invasive species into the project vicinity, all equipment will be power washed with hot water (≥140 °F) and completely dried for a minimum of 7 days prior to subsequent use. South Dakota administrative rule 41:10:04:02 forbids the possession and transport of AIS; therefore, all attached dirt, mud, debris and vegetation must be removed and all compartments and tanks capable of holding standing water must be drained. This includes, but is not limited to, all equipment, pumps, lines, hoses and holding tanks.

Action Taken/Required:

The Contractor will obtain the necessary permits from the regulatory agencies such as the South Dakota Department of Agriculture and Natural Resources (DANR) and the United States Army Corps of Engineers (USACE) prior to water extraction activities.

Additional information and mapping of water sources impacted by Aquatic Invasive Species in South Dakota can be accessed at: <<https://sdleastwanted.sd.gov/maps/default.aspx>>

<[South Dakota Administrative Rule 41:10:04 Aquatic Invasive Species: https://sdlegislature.gov/rules/DisplayRule.aspx?Rule=41:10:04](https://sdlegislature.gov/rules/DisplayRule.aspx?Rule=41:10:04)>

COMMITMENT D: WATER QUALITY STANDARDS

COMMITMENT D1: SURFACE WATER QUALITY

This project may be in the vicinity of multiple streams and wetlands. These waters are considered waters of the state and are protected under Administrative Rules of South Dakota (ARSD) Chapter 74:51. Special construction measures may have to be taken to ensure that this water body is not impacted.

Action Taken/Required:

The Contractor is advised that the South Dakota Surface Water Quality Standards, administered by the South Dakota Department of Agriculture and Natural Resources (DANR), apply to this project. Special construction measures will be taken to ensure the above standard(s) of the surface waters are maintained and protected.

COMMITMENT D2: SURFACE WATER DISCHARGE

The DANR General Permit for Temporary Discharge is required for temporary dewatering and discharges to waters of the state. The effluent limit for total suspended solids will be 90 mg/L 30-day average. The effluent limit applies to discharges to all waters of the state except discharges to waters classified as cold water permanent fish life propagation waters according to the ARSD 74:51:01:45. For discharges to waters of the state classified as cold water permanent fish life propagation waters, the effluent limit for total suspended solids will be 53 mg/L daily maximum.

The permittee has the option of completing effluent testing or implementing a pollution prevention plan for compliance with this permit. If the permittee develops a pollution prevention plan instead of total suspended solids sampling, the plan must be developed and implemented prior to discontinuing total suspended solids sampling. Refer to Section 4.0 of the permit. If any pollutants are suspected of being discharged, a sample must be taken for those parameters listed in Section 3.4 of the permit.

Refer to Commitment D1: Surface Water Quality for stream classification.

Action Taken/Required:

If construction dewatering is required and this project is currently covered under a General Permit for Stormwater Discharges Associated with Construction Activities, the contractor will need to submit the dewatering information to the SDDANR using the following form:

<https://danr.sd.gov/OfficeOfWater/SurfaceWaterQuality/docs/DANR_AddTempInfoFillable.pdf>

The Contractor will provide a copy of the approved permit or the submitted dewatering information to the Project Engineer prior to proceeding with any dewatering activities. The approved permit or submitted dewatering information must be kept on-site and as part of the project records.

Effluent monitoring, as a result of dewatering activities, will be summarized for each month and recorded on a separate Discharge Monitoring Report (DMR) and submitted to DANR monthly. Additional information can be found at:

<<https://danr.sd.gov/OfficeOfWater/SurfaceWaterQuality/swdpermitting/Ereporting.aspx>>

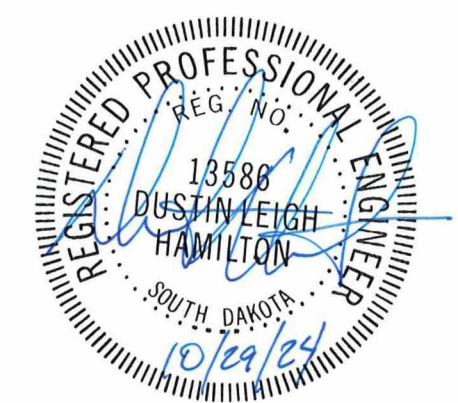

COMMITMENT E: STORM WATER

Construction activities constitute 1 acre or more of earth disturbance and/or work in a waterway.

Action Taken/Required:

The DANR General Permit for Stormwater Discharges Associated with Construction Activities is required for construction activity disturbing one or more acres of earth and work in a waterway. The SDDOT is the owner of this permit and will submit the NOI to DANR 15 days prior to project start in order to obtain coverage under the General Permit. Work can begin once the DANR letter of approval is received.

The Contractor must adhere to the "Special Provision Regarding Storm Water Discharges to Waters of the State."

The Contractor will complete the DANR Contractor Certification Form prior to the pre-construction meeting. The form certifies under penalty of law that the Contractor understands and will comply with the terms and conditions of the permit for this project. Work may not begin on this project until this form is signed and submitted to DANR.

The form can be found at:

<
https://danr.sd.gov/OfficeOfWater/SurfaceWaterQuality/docs/DANR_CGPAAppendixCCA2018Fillable.pdf>

The Contractor is advised that permit coverage may also be required for off-site activities, such as borrow and staging areas, which are the responsibility of the Contractor.

Storm Water Pollution Prevention Plan

The Storm Water Pollution Prevention Plan (SWPPP) will be developed prior to the submittal of the NOI and will be implemented for all construction activities for compliance with the permit. The SWPPP must be kept on-site and updated as site conditions change. Erosion control measures and best management practices will be implemented in accordance with the SWPPP.

The DOT 298 Form will be used for site inspections and to document changes to the SWPPP. A copy of the completed inspection form will be filed with the SWPPP documents and retained for a minimum of three years.

The inspection will include disturbed areas of the construction site that have not been finally stabilized, areas used for storage materials, structural control measures, and locations where vehicles enter or exit the site. These areas will be inspected for evidence of, or the potential for, pollutants entering the drainage system. Erosion and sediment control measures identified in the SWPPP will be observed to ensure that they are operating correctly, and sediment is not tracked off the site.

Information on storm water permits and SWPPPs are available on the following websites:

SDDOT: < <https://dot.sd.gov/doing-business/environmental/stormwater> >

DANR:<
<https://danr.sd.gov/OfficeOfWater/SurfaceWaterQuality/stormwater/default.aspx>>

EPA: < <https://www.epa.gov/npdes> >

COMMITMENT G: DEWATERING AND SEDIMENT COLLECTION

The purpose of a dewatering and sediment collection system is to collect turbid stormwater on the project, treat it with flocculants as needed, and capture the sediment that falls out of suspension before the water is discharged into "Waters of the US" or "Waters of the State". Refer to Commitment D1: Surface Water Quality for stream classification.

Action Taken/Required:

The Contractor will meet the terms of the Temporary Discharge Permit and the Storm Water Permit for Construction Activities.

The Contractor will create a Pollution Prevention Plan (PPP) for dewatering and sediment collection if the Contractor chooses to discharge the water into "Waters of the US" or "Waters of the State". Refer to the detail sheet OPTIONS FOR DEWATERING AND SEDIMENT COLLECTION in the plans. The PPP must be kept on-site and updated as site conditions change.

COMMITMENT H: WASTE DISPOSAL SITE

The Contractor will furnish a site(s) for the disposal of construction and/or demolition debris generated by this project.

Action Taken/Required:

Construction and/or demolition debris may not be disposed of within the Public ROW.

The waste disposal site(s) will be managed and reclaimed in accordance with the following from the General Permit for Construction/Demolition Debris Disposal Under the South Dakota Waste Management Program issued by the Department of Agriculture and Natural Resources.

The waste disposal site(s) will not be located in a wetland, within 200 feet of surface water, or in an area that adversely affects wildlife, recreation, aesthetic value of an area, or any threatened or endangered species, as approved by the Environmental Office and the Project Engineer.

If the waste disposal site(s) is located such that it is within view of any ROW, the following additional requirements will apply:

1. Construction and/or demolition debris consisting of concrete, asphalt concrete, or other similar materials will be buried in a trench separate from wood debris. The final cover over the construction and/or demolition debris will consist of a minimum of 1 foot of soil capable of supporting vegetation. Waste disposal sites provided outside of the Public ROW will be seeded in accordance with Natural Resources Conservation Service recommendations. The seeding recommendations may be obtained through the appropriate County NRCS Office. The Contractor will control the access to waste disposal sites not within the Public ROW with fences, gates, and placement of a sign or signs at the entrance to the site stating, "No Dumping Allowed".

2. Concrete and asphalt concrete debris may be stockpiled within view of the ROW for a period not to exceed the duration of the project. Prior to project completion, the waste will be removed from view of the ROW or buried, and the waste disposal site reclaimed as noted above.

The above requirements will not apply to waste disposal sites that are covered by an individual solid waste permit as specified in SDCL 34A-6-58, SDCL 34A-6-1.13, and ARSD 74:27:10:06. Failure to comply with the requirements stated above may result in civil penalties in accordance with South Dakota Solid Waste Law, SDCL 34A-6-1.31.

All costs associated with furnishing waste disposal site(s), disposing of waste, maintaining control of access (fence, gates, and signs), and reclamation of the waste disposal site(s) will be incidental to the various contract items.



COMMITMENT I: HISTORIC PRESERVATION OFFICE CLEARANCES

The SDDOT has obtained concurrence with the State Historic Preservation Office (SHPO) for all work included within the project limits and all department designated sources and designated option material sources, stockpile sites, storage areas, and waste sites provided within the plans.

Action Taken/Required:

All earth disturbing activities not designated within the plans require a cultural resource review prior to scheduling the pre-construction meeting. This work includes but is not limited to: Contractor furnished material sources, material processing sites, stockpile sites, storage areas, plant sites, and waste areas.

The Contractor will arrange and pay for a record search and when necessary, a cultural resource survey. The Contractor has the option to contact the state Archaeological Research Center (ARC) at 605-394-1936 or another qualified archaeologist, to obtain either a records search or a cultural resources survey. A record search might be sufficient for review if the site was previously surveyed; however, a cultural resources survey may need to be conducted by a qualified archaeologist.

The Contractor will provide ARC with the following: a topographical map or aerial view in which the site is clearly outlined, site dimensions, project number, and PCN. If applicable, provide evidence that the site has been previously disturbed by farming, mining, or construction activities with a landowner statement that artifacts have not been found on the site.

The Contractor will submit the cultural resources survey report to SDDOT Environmental Office, 700 East Broadway Avenue, Pierre, SD 57501-2586. SDDOT will submit the information to the appropriate SHPO/THPO. Allow **30 Days** from the date this information is submitted to the Environmental Engineer for SHPO/THPO review.

In the event of an inadvertent discovery of human remains, funerary objects, or if evidence of cultural resources is identified during project construction activities, then such activities within 150 feet of the inadvertent discovery will immediately cease and the Project Engineer will be immediately notified. The Project Engineer will contact the SDDOT Environmental Office, who will contact the appropriate SHPO/THPO within 48 hours of the discovery to determine an appropriate course of action.

SHPO review does not relieve the Contractor of the responsibility for obtaining any additional permits and clearances for Contractor furnished material sources, material processing sites, stockpile sites, storage areas, plant sites, and waste areas that affect wetlands, threatened and endangered species, or waterways. The Contractor will not utilize a site known or suspected of having contaminated soil or water. The Contractor will provide the required permits and clearances to the Project Engineer at the preconstruction meeting.



COMMITMENT L: CONTAMINATED MATERIAL

Contaminated soil and/or known gas stations, undergrounds storage tanks, etc. are located within the project limits. Petroleum contaminated soil may be located at the following sites:

Description	Station	L / R
Cenex Gas Station	14+00 – 17+50	R
Old Petro Plus Gas Station	22+00 – 23+50	R
Cowboy Country Store	48+75 – 50+50	R

Action Taken/Required:

The Contractor will give notice to the Engineer when contaminated soil is encountered on the project. The Engineer will contact the Environmental Office so that contact with the DANR and consultant to inspect and monitor removal of any contaminated soil can be initiated.

The Contractor will be responsible for having the existing underground utilities located in the construction area. Underground utilities damaged by the Contractor due to negligence will be repaired at the Contractor's expense.

Petroleum contaminated soil may be disposed of at the City of Pierre Landfill (phone 605-773-7434 or 605-773-7341). Measurement of "Contaminated Material Excavation" will be in accordance with Section 120.4 of the Specifications. All costs for excavating and transporting the contaminated materials to the disposal site and all fees charged per cubic yard by the disposal site will be incidental to the contract unit price per cubic yard for "Contaminated Material Excavation".

COMMITMENT M: SECTION 4(f)/6(f) RESOURCES

COMMITMENT M1: SECTION 4(f) PROPERTY

A Section 4(f) Evaluation concluded there are no feasible and prudent alternatives to avoiding Section 4(f) property located within the project.

Station	Section 4(f) Property
935+00 – 940+00	Hilgers Gulch
Project Corridor	Historic Properties

Action Taken/Required:

Hilgers Gulch:

The following measures are required to minimize harm to the above Section 4(f) property:

- Access to Hilger's Gulch Park shall always be maintained during construction activities via an approved detour.
- Access to Governor's will be restricted for a period of time that is anticipated to last no longer than 6 months and will be less than the time needed for construction.
- Appropriate signage shall be installed to alert users of Hilgers Gulch Park of construction activities, access restrictions or closures, and to direct users to secondary access points.

- The staging and/or storage of construction equipment or materials shall not take place outside proposed construction limits that are within the defined boundaries of the 4(f) property.
- The walking loop will be detoured to maintain pedestrian traffic during the construction of the drainage ditch.
- Any additional sediment displaced in the Hilgers Gulch Creek during the course of construction will be promptly removed and re-vegetated.
- Construction within the gulch is planned to take a maximum of 6 months. Timing for this construction will depend on the selected contractor. The decorative flags that are used for special events and holidays may continue to be placed within the park where construction is not occurring.
- The Contractor shall be required to closely coordinate the construction schedule with SDDOT and South Dakota BOA prior to the start of construction activities.

The Contractor is not permitted to stage equipment or materials outside of the work limits within Hilgers Gulch. The Contractor will notify the Project Engineer if additional easement is needed to complete work outside of the approved project limits in Section B. The Project Engineer will obtain an appropriate course of action from the Environmental Office before proceeding with construction activities that affect any Section 4(f) property.

Historic Properties with Permanent Right of Way Acquisition:

All permanent acquisition and temporary easements avoid the features of the historic properties. The Contractor will notify the Project Engineer if additional easement is needed to complete work outside of the approved project limits in Section B. The Project Engineer will obtain an appropriate course of action from the Environmental Office before proceeding with construction activities that affect any of the properties beyond the work limits and easements shown in the plans.

Historic Properties with Temporary Easements:

The following measures are required to minimize harm to the above Section 4(f) property:

- The duration of occupancy is temporary and less than the time needed for construction of the project, and no permanent change in ownership of the land will occur.
- The scope of work is minor, in that both the nature and magnitude of the changes to the existing 4(f) property are minimal.
- There are no anticipated permanent adverse physical impacts, nor interference with the protected activities, features, or attributes of the property, on either a temporary or permanent basis.
- Any land to be disturbed will be fully restored and returned to a condition which is at least as good as that which existed prior to the project.

The Contractor is not permitted to stage equipment or materials outside of the work limits within the project corridor. The Contractor will notify the Project Engineer if additional easement is needed to complete work outside of the approved project limits in Section B. The Project Engineer will obtain an appropriate course of action from the Environmental Office before proceeding with construction activities that affect any Section 4(f) property.

COMMITMENT N: SECTION 404 PERMIT

The SDDOT has obtained a Section 404 Permit from the USACE for the permanent actions associated with this project.

Action Taken/Required:

The Contractor will comply with all requirements contained in the Section 404 Permit.

The Contractor will also be responsible for obtaining a Section 404 Permit for any dredge, excavation, or fill activities associated with material sources, storage areas, waste sites, and Contractor work sites outside the plan work limits that affect wetlands, floodplains, or waters of the United States.

COMMITMENT Q: ARCHAEOLOGICAL COORDINATION

As a result of a Cultural Resources Survey, historic properties have been identified adjacent to the project rights-of-way.

The following historic properties have been identified that require avoidance of construction activities:

Table of Historic Properties

Station	L/R	Environmental Sensitive Site	Action
Entire project corridor	L/R	ESS- 1 – ESS-84	Work may not occur outside of the approved project limits in Section B without prior approval from the Environmental Office

Action Taken/Required:

Prior to the pre-construction meeting, the Project Engineer will notify the SDDOT Environmental Office (605-773-3180) to be present at the meeting for the purposes of discussing the historic properties within the project corridor.

If evidence for cultural resources is uncovered during project construction activities, then such activities within 150 feet of the inadvertent discovery will immediately cease and the Project Engineer will be immediately notified. The Project Engineer will contact the SDDOT Environmental Office, who will consult with the Archaeological Research Center (ARC), SHPO, and FHWA, to determine the appropriate course of action.

All artifacts, features, or other items of interest uncovered by project construction activities will not be displaced unless the landowner and the SHPO consent to it.

These identified sites cannot be used for material sources, storage areas, waste sites, and/or any other project related activities outside the plan work limits. The Contractor will notify the Project Engineer if additional easement is needed to complete work outside of the approved project limits in Section B. The Project Engineer will obtain an appropriate course of action from the Environmental Office before proceeding with construction activities that affect any historic property.

