

PLOT SCALE - 1"=200'

PLOTTED FROM - TRPR13462

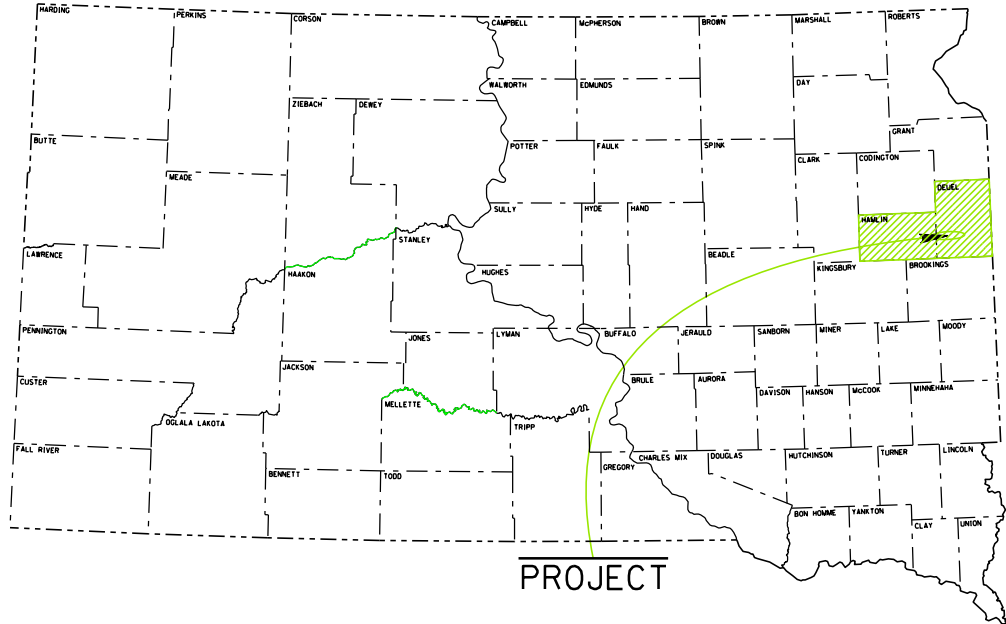

STATE OF SOUTH DAKOTA  
DEPARTMENT OF TRANSPORTATION  
PLANS FOR PROPOSED  
**PROJECT**  
**P 0028(43)355**  
**SD HIGHWAY 28**  
**HAMLIN & DEUEL COUNTY**  
ASPHALT CONCRETE SURFACING  
PCN 05Q7

STATE OF SOUTH DAKOTA	PROJECT	SHEET	TOTAL SHEETS
	P 0028(43)355	1	64

Plotting Date: 04/04/2025  
Revised: 04/04/2025 RTS

INDEX OF SECTIONS

Section A:	Estimate of Quantities and Environmental Commitments
Section C:	Traffic Control Plans
Section D:	Erosion and Sediment Control Plans
Section F:	Surfacing Plans
Section M:	Pavement Marking Plans

**BEGIN P 0028(43)355**  
Sta. 11+11.77  
MRM 355.02+0.006

**End Surfacing  
Begin Resurfacing**  
Sta. 100+05.99

**End Resurfacing  
Begin Surfacing**  
Sta. 127+71.25

**End Surfacing  
Begin Resurfacing**  
Sta. 335+09.95

**End Resurfacing  
Begin Surfacing**  
Sta. 369+89.09

**END P 0028(43)355**  
Sta. 568+41.79  
MRM 365.36+0.118

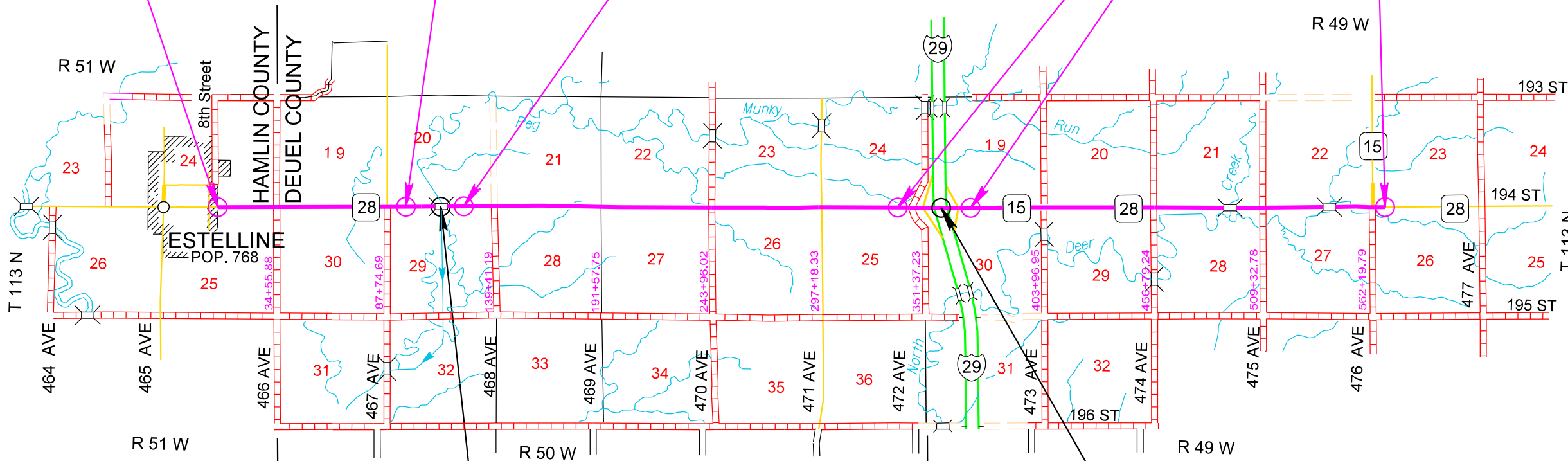

DESIGN DESIGNATION

ADT (2023)	1610
ADT (2043)	2301
DHV	258
D	50%
T DHV	8.1%
T ADT	17.8%
V	65 MPH

STORM WATER PERMIT  
(None Required)

MAJOR RECEIVING  
BODY OF WATER: Big Sioux River  
AREA DISTURBED: 5 Acres  
TOTAL PROJECT AREA: 61 Acres  
Approx. Begin Lat, Long = 44.5728, - 96.8920 (Google Maps)

Bridge Exception  
Str. No. 20-015-280 MRM 357.02  
Sta. 112+81.49 to Sta. 114+29.99

Bridge Exception  
Str. No. 20-061-280 MRM 361.61  
Sta. 352+75.72 to Sta. 356+23.39

GROSS LENGTH	55,730.02 FEET	10.555 MILES
LENGTH OF EXCEPTIONS	496.17 FEET	0.094 MILES
NET LENGTH	55,233.85 FEET	10.461 MILES

5

October 15, 2025

FILE - ... \PRJ\HAML0507\0507-TITLEA.DGN

PLOT NAME - 1

# ESTIMATE OF QUANTITIES AND ENVIRONMENTAL COMMITMENTS

STATE OF SOUTH DAKOTA	PROJECT	SHEET	TOTAL SHEETS
	P 0028(43)355	A1	A3

## Section C - Traffic Control

BID ITEM NUMBER	ITEM	QUANTITY	UNIT
634E0010	Flagging	1,000.0	Hour
634E0020	Pilot Car	300.0	Hour
634E0110	Traffic Control Signs	848.2	SqFt
634E0120	Traffic Control, Miscellaneous	Lump Sum	LS
634E0630	Temporary Pavement Marking	55.4	Mile

## Section D - Erosion and Sediment Control

BID ITEM NUMBER	ITEM	QUANTITY	UNIT
734E0010	Erosion Control	Lump Sum	LS

## SPECIFICATIONS

Standard Specifications for Roads and Bridges, 10-01-2025 Version, Required Provisions, and Special Provisions as included in the Proposal. The Standard Specifications for Roads and Bridges is available for download and viewing at <https://dot.sd.gov/doing-business/contractors/standard-specifications>.

## INDEX OF SHEETS

A1 Estimate of Quantities for Sections C, D, F and M  
A2 to A3 Environmental Commitments

## Section F – Surfacing

BID ITEM NUMBER	ITEM	QUANTITY	UNIT
009E0010	Mobilization	Lump Sum	LS
009E1350	Restoration of Stockpile Site	Lump Sum	LS
009E3200	Construction Staking	Lump Sum	LS
009E3301	Engineer Directed Surveying/Staking	40.0	Hour
009E3320	Checker	Lump Sum	LS
009E4200	Construction Schedule, Category II	Lump Sum	LS
110E0730	Remove Beam Guardrail	450.0	Ft
110E0800	Remove W Beam Guardrail End Terminal	4	Each
110E1010	Remove Asphalt Concrete Pavement	81.7	SqYd
110E6410	Remove Type 1 MGS for Reset	350.0	Ft
110E6501	Remove Type 1 Retrofit Guardrail Transition for Reset	4	Each
110E6618	Remove MGS MASH Flared End Terminal for Reset	4	Each
110E7152	Remove Delineator for Reset	16	Each
120E0100	Unclassified Excavation, Digouts	523	CuYd
120E0600	Contractor Furnished Borrow	1,045	CuYd
120E6100	Water for Embankment	13.6	MGal
120E6200	Water for Granular Material	47.2	MGal
210E1005	Surface Preparation	2.400	Mile
260E1010	Base Course	3,255.1	Ton
260E1030	Base Course, Salvaged	600.0	Ton
270E0110	Salvage and Stockpile Granular Material	600.0	Ton
320E0005	PG 58-34 Asphalt Binder	2,820.8	Ton
320E1200	Asphalt Concrete Composite	27.2	Ton
320E1202	Class Q2R Hot Mixed Asphalt Concrete	60,590.9	Ton
320E4000	Hydrated Lime	602.6	Ton
320E7012	Grind 12" Rumble Strip or Stripe in Asphalt Concrete	20.6	Mile
320E7028	Grind Centerline Rumble Stripe in Asphalt Concrete	6.8	Mile
320E7030	Grind Sinusoidal Centerline Rumble Stripe in Asphalt Concrete	3.2	Mile
330E0010	MC-70 Asphalt for Prime	83.8	Ton
330E0100	SS-1h or CSS-1h Asphalt for Tack	140.4	Ton
330E0210	SS-1h or CSS-1h Asphalt for Flush Seal	62.6	Ton
330E1000	Blotting Sand for Prime	202.0	Ton
330E2000	Sand for Flush Seal	565.9	Ton
332E0010	Cold Milling Asphalt Concrete	26,382	SqYd
600E0300	Type III Field Laboratory	1	Each
630E0500	Type 1 MGS	250.0	Ft
630E1501	Type 1 Retrofit Guardrail Transition	4	Each
630E2017	MGS MASH Flared End Terminal	4	Each
630E5010	Reset Type 1 MGS	350.0	Ft
630E5203	Reset MGS MASH Flared End Terminal	4	Each
630E5301	Reset Type 1 Retrofit Guardrail Transition	4	Each
632E2100	Reset Delineator	16	Each
632E2220	Guardrail Delineator	16	Each
900E0022	Remove and Reset Mailbox	12	Each
900E1980	Storage Unit	1	Each

Revised: 08-22-2025 LLA

## Section M - Pavement Marking

BID ITEM NUMBER	ITEM	QUANTITY	UNIT
633E0030	Cold Applied Plastic Pavement Marking, 24"	415	Ft
633E0040	Cold Applied Plastic Pavement Marking, Arrow	8	Each
633E1200	High Build Waterborne Pavement Marking Paint, White	475	Gal
633E1205	High Build Waterborne Pavement Marking Paint, Yellow	180	Gal
633E5015	Grooving for Cold Applied Plastic Pavement Marking, 24"	415	Ft
633E5025	Grooving for Cold Applied Plastic Pavement Marking, Arrow	8	Each

# ESTIMATE OF QUANTITIES AND ENVIRONMENTAL COMMITMENTS

STATE OF SOUTH DAKOTA	PROJECT	SHEET	TOTAL SHEETS
	P 0028(43)355	A2	A3

## ENVIRONMENTAL COMMITMENTS

The SDDOT is committed to protecting the environment and uses Environmental Commitments as a communication tool for the Engineer and Contractor to ensure that attention is given to avoid, minimize, and/or mitigate an environmental impact. Environmental commitments to various agencies and the public have been made to secure approval of this project. An agency with permitting authority can delay a project if identified environmental impacts have not been adequately addressed. Unless otherwise designated, the Contractor's primary contact regarding matters associated with these commitments will be the Project Engineer. During construction, the Project Engineer will verify that the Contractor has met Environmental Commitment requirements. These environmental commitments are not subject to change without prior written approval from the SDDOT Environmental Office.

Additional guidance on SDDOT's Environmental Commitments can be accessed through the Environmental Procedures Manual found at: <<https://dot.sd.gov/media/documents/EnvironmentalProceduresManual.pdf>>

For questions regarding change orders in the field that may have an effect on an Environmental Commitment, the Project Engineer will contact the Environmental Engineer at 605-773-3180 or 605-773-4336 to determine whether an environmental analysis and/or resource agency coordination is necessary.

Once construction is complete, the Project Engineer will review all environmental commitments for the project and document their completion.

### COMMITMENT C: WATER SOURCE

The Contractor will not withdraw water with equipment previously used outside the State of South Dakota or previously used in aquatic invasive species (AIS) positive waters within South Dakota without prior approval from the SDDOT Environmental Office. To prevent and control the introduction and spread of invasive species into the project vicinity, all equipment will be power washed with hot water (≥140 °F) and completely dried for a minimum of 7 days prior to subsequent use. South Dakota administrative rule 41:10:04:02 forbids the possession and transport of AIS; therefore, all attached dirt, mud, debris and vegetation must be removed and all compartments and tanks capable of holding standing water must be drained. This includes, but is not limited to, all equipment, pumps, lines, hoses and holding tanks.

The Contractor will not withdraw water directly from streams of the James, Big Sioux, and Vermillion watersheds without prior approval from the SDDOT Environmental Office.

#### Action Taken/Required:

The Contractor will obtain the necessary permits from the regulatory agencies such as the South Dakota Department of Agriculture and Natural Resources (DANR) and the United States Army Corps of Engineers (USACE) prior to water extraction activities.

Additional information and mapping of water sources impacted by Aquatic Invasive Species in South Dakota can be accessed at:  
< <https://sdleastwanted.sd.gov/maps/default.aspx> >

< [South Dakota Administrative Rule 41:10:04 Aquatic Invasive Species: https://sdlegislature.gov/rules/DisplayRule.aspx?Rule=41:10:04](https://sdlegislature.gov/rules/DisplayRule.aspx?Rule=41:10:04) >

### COMMITMENT E: STORM WATER

Construction activities constitute 1 acre or more of earth disturbance and/or work in a waterway.

#### Action Taken/Required:

The DANR General Permit for Stormwater Discharges Associated with Construction Activities is required for construction activity disturbing one or more acres of earth and work in a waterway. The SDDOT is the owner of this permit and will submit the NOI to DANR 15 days prior to project start in order to obtain coverage under the General Permit. Work can begin once the DANR letter of approval is received.

The Contractor must adhere to the "Special Provision Regarding Storm Water Discharges to Waters of the State."

The Contractor will complete the DANR Contractor Certification Form prior to the pre-construction meeting. The form certifies under penalty of law that the Contractor understands and will comply with the terms and conditions of the permit for this project. Work may not begin on this project until this form is signed and submitted to DANR.

The form can be found at:  
< [https://danr.sd.gov/OfficeOfWater/SurfaceWaterQuality/docs/DANR\\_CGPAppendixCCA2018Fillable.pdf](https://danr.sd.gov/OfficeOfWater/SurfaceWaterQuality/docs/DANR_CGPAppendixCCA2018Fillable.pdf) >

The Contractor is advised that permit coverage may also be required for off-site activities, such as borrow and staging areas, which are the responsibility of the Contractor.

### Storm Water Pollution Prevention Plan

The Storm Water Pollution Prevention Plan (SWPPP) will be developed prior to the submittal of the NOI and will be implemented for all construction activities for compliance with the permit. The SWPPP must be kept on-site and updated as site conditions change. Erosion control measures and best management practices will be implemented in accordance with the SWPPP.

The DOT 298 Form will be used for site inspections and to document changes to the SWPPP. A copy of the completed inspection form will be filed with the SWPPP documents and retained for a minimum of three years.

The inspection will include disturbed areas of the construction site that have not been finally stabilized, areas used for storage materials, structural control measures, and locations where vehicles enter or exit the site. These areas will be inspected for evidence of, or the potential for, pollutants entering the drainage system. Erosion and sediment control measures identified in the SWPPP will be observed to ensure that they are operating correctly, and sediment is not tracked off the site.

Revised: 04-04-2025 LLA

Information on storm water permits and SWPPPs are available on the following websites:

SDDOT: < <https://dot.sd.gov/doing-business/environmental/stormwater> >

DANR:<  
<https://danr.sd.gov/OfficeOfWater/SurfaceWaterQuality/stormwater/default.aspx> >

EPA: < <https://www.epa.gov/npdes> >

### COMMITMENT H: WASTE DISPOSAL SITE

The Contractor will furnish a site(s) for the disposal of construction and/or demolition debris generated by this project.

#### Action Taken/Required:

Construction and/or demolition debris may not be disposed of within the Public ROW.

The waste disposal site(s) will be managed and reclaimed in accordance with the following from the General Permit for Construction/Demolition Debris Disposal Under the South Dakota Waste Management Program issued by the Department of Agriculture and Natural Resources.

The waste disposal site(s) will not be located in a wetland, within 200 feet of surface water, or in an area that adversely affects wildlife, recreation, aesthetic value of an area, or any threatened or endangered species, as approved by the Environmental Office and the Project Engineer.

If the waste disposal site(s) is located such that it is within view of any ROW, the following additional requirements will apply:

- Construction and/or demolition debris consisting of concrete, asphalt concrete, or other similar materials will be buried in a trench separate from wood debris. The final cover over the construction and/or demolition debris will consist of a minimum of 1 foot of soil capable of supporting vegetation. Waste disposal sites provided outside of the Public ROW will be seeded in accordance with Natural Resources Conservation Service recommendations. The seeding recommendations may be obtained through the appropriate County NRCS Office. The Contractor will control the access to waste disposal sites not within the Public ROW with fences, gates, and placement of a sign or signs at the entrance to the site stating, "No Dumping Allowed".
- Concrete and asphalt concrete debris may be stockpiled within view of the ROW for a period not to exceed the duration of the project. Prior to project completion, the waste will be removed from view of the ROW or buried, and the waste disposal site reclaimed as noted above.

# ESTIMATE OF QUANTITIES AND ENVIRONMENTAL COMMITMENTS

STATE OF SOUTH DAKOTA	PROJECT	SHEET	TOTAL SHEETS
	P 0028(43)355	A3	A3

**Action Taken/Required: - CONTINUED**

The above requirements will not apply to waste disposal sites that are covered by an individual solid waste permit as specified in SDCL 34A-6-58, SDCL 34A-6-1.13, and ARSD 74:27:10:06.

Failure to comply with the requirements stated above may result in civil penalties in accordance with South Dakota Solid Waste Law, SDCL 34A-6-1.31.

All costs associated with furnishing waste disposal site(s), disposing of waste, maintaining control of access (fence, gates, and signs), and reclamation of the waste disposal site(s) will be incidental to the various contract items.

**COMMITMENT I: HISTORIC PRESERVATION OFFICE CLEARANCES**

The SDDOT has obtained concurrence with the State Historic Preservation Office (SHPO) for all work included within the project limits and all department designated sources and designated option material sources, stockpile sites, storage areas, and waste sites provided within the plans.

**Action Taken/Required:**

All earth disturbing activities not designated within the plans require a cultural resource review prior to scheduling the pre-construction meeting. This work includes but is not limited to: Contractor furnished material sources, material processing sites, stockpile sites, storage areas, plant sites, and waste areas.

The Contractor will arrange and pay for a record search and when necessary, a cultural resource survey. The Contractor has the option to contact the state Archaeological Research Center (ARC) at 605-394-1936 or another qualified archaeologist, to obtain either a records search or a cultural resources survey. A record search might be sufficient for review if the site was previously surveyed; however, a cultural resources survey may need to be conducted by a qualified archaeologist.

The Contractor will provide ARC with the following: a topographical map or aerial view in which the site is clearly outlined, site dimensions, project number, and PCN. If applicable, provide evidence that the site has been previously disturbed by farming, mining, or construction activities with a landowner statement that artifacts have not been found on the site.

The Contractor will submit the cultural resources survey report to SDDOT Environmental Office, 700 East Broadway Avenue, Pierre, SD 57501-2586. SDDOT will submit the information to the appropriate SHPO/THPO. Allow **30 Days** from the date this information is submitted to the Environmental Engineer for SHPO/THPO review.

In the event of an inadvertent discovery of human remains, funerary objects, or if evidence of cultural resources is identified during project construction activities, then such activities within 150 feet of the inadvertent discovery will immediately cease and the Project Engineer will be immediately notified. The Project Engineer will contact the SDDOT Environmental Office, who will contact the appropriate SHPO/THPO within 48 hours of the discovery to determine an appropriate course of action.

SHPO review does not relieve the Contractor of the responsibility for obtaining any additional permits and clearances for Contractor furnished material sources, material processing sites, stockpile sites, storage areas, plant sites, and waste areas that affect wetlands, threatened and endangered species, or waterways. The Contractor will not utilize a site known or suspected of having contaminated soil or water. The Contractor will provide the required permits and clearances to the Project Engineer at the preconstruction meeting.

Revised: 04-04-2025 LLA