

June 5, 2026

Re: **On-Site Visit Opportunities**; Project EM-P 0044(207)290 – PCN 05X0 – SD44 Missouri River Bridge (Platte/Winner)

To Whom It May Concern,

The South Dakota Department of Transportation (SDDOT) will offer two on-site visit opportunities for contractors interested in the Platte/Winner Bridge project. These visits are intended to provide prospective bidders with the chance to become familiar with the project site and meet with SDDOT. The preference is for subcontractors to coordinate on-site visits with prime contractors.

The SDDOT will be available to meet with contractors on Tuesday, June 23rd and Thursday, June 25th from 10:00 a.m. to 4:00 p.m. CST.

Meeting Location

Attendees should meet in the parking lot on the northeast side of the project site.

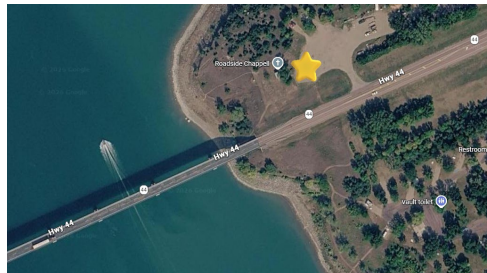

Attendance Request

Contractors must sign up for a time slot by filling out the form attached and emailing it to the SDDOT at DOTBids@State.SD.US. The SDDOT asks that all requests for on-site visits be made by Friday, June 19th.

We appreciate your interest in the Platte/Winner Bridge project and look forward to meeting with you on site.

Sincerely,
SD DOT

Contractor On-Site Visit Request Form

Project: SD44 Platte/Winner Bridge – PCN 05X0

Date of Request: _____

Company Information

- Company Name: _____
- Primary Contact Name: _____
- Phone Number: _____
- Email Address: _____

Attendees for On-Site Visit

(Please list all individuals who will attend.)

1. Name: _____ Phone: _____
2. Name: _____ Phone: _____
3. Name: _____ Phone: _____
4. Additional attendees (if any): _____

Type of Work Performed by Your Company

Requested On-Site Visit Time

Site visits are offered in 30-minute increments between **10:00 AM and 4:00 PM**. If your preferred time slot is not available, the SDDOT will contact you to pick a new time. The contractor will receive an email notification once their requested time slot has been reviewed and approved.

Preferred Time Slot: _____

Request for Additional Time (Optional)

If your team requires more than the standard 30-minute visit, please describe the reason and the amount of additional time requested. Additional time is not guaranteed but will be considered:

Signature

By submitting this form, the contractor acknowledges that site visit scheduling is subject to availability and confirmation.

Name: _____

Title: _____

Signature: _____ Date: _____

June 5, 2026

Re: **Virtual Pre-Bid Meeting** Project EM-P 0044(207)290 – PCN 05X0 – SD44 Missouri River Bridge (Platte/Winner)

To Whom It May Concern,

A pre-bid meeting for the Platte/Winner Bridge Reconstruction Project is scheduled for Tuesday, July 7th at 1:30 PM CST and will be conducted via Microsoft Teams. All interested contracting parties are invited to participate using the meeting link provided below.

The meeting will include a presentation outlining the project's overall scope of work, key design elements, traffic control considerations, and contract time. Contractors will also have the opportunity to ask questions of Department staff, consultants, and project stakeholders.

Although attendance is not mandatory, all interested contracting parties are strongly encouraged to join.

Participants must join the meeting using the link provided. To minimize audio feedback, please ensure your computer microphone is muted. Because the meeting will be held virtually, we ask that you enter your company name followed by the names of all attendees from your organization into the Microsoft Teams chat upon joining. A recording of the pre-bid meeting will be made available on the SDDOT Contractor SharePoint site following the meeting.

Join Platte/Winner Bridge Pre-Bid Meeting

Date: July 7, 2026

Time: 1:30 – 3:30 PM (CST)

Meeting ID: 228 438 244 171 169

Additional instructions regarding the meeting format will be provided at the beginning of the meeting.

We look forward to seeing you there!

Sincerely,
SD DOT

STATE OF SOUTH DAKOTA
 DEPARTMENT OF TRANSPORTATION
 PLANS FOR PROPOSED

STATE OF SOUTH DAKOTA	PROJECT	SHEET	TOTAL SHEETS
	EM-P 0044(207)290	1	410
Plotting Date: 4/27/2026		Rev 04/27/2026 BDW	

PROJECT EM-P 0044 (207)290
SD HIGHWAY 44
CHARLES MIX COUNTY & GREGORY COUNTY
 GRADING, STRUCTURE AND INTERIM SURFACING
 PCN 05X0

- INDEX OF SECTIONS**
- Section A: Estimate of Quantities and Environmental Commitments
 - Section B: Grading Plans
 - Section C: Traffic Control Plans
 - Section D: Erosion and Sediment Control Plans
 - Section E: Structure Plans
 - Section F: Surfacing Plans
 - Section M: Pavement Marking Plans
 - Section S: Permanent Signing Plans
 - Section X: Cross Sections
 - Section Z: Pipe Sections

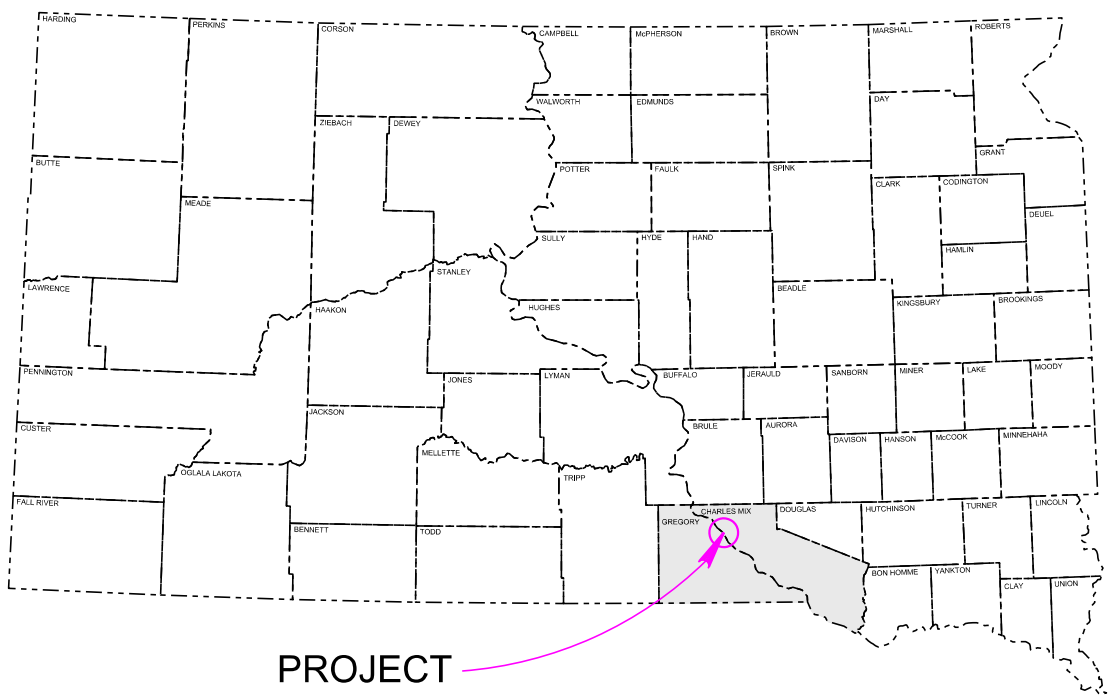

PROJECT

BEGIN EM-P 0044(207)290
 STA. 849+50.00 R2 = STA. 849+50.00 on 02V0
 Approximately 1657.49' South and 2031.06' East of the Northwest corner of Section 20 - Township 99 North - Range 70 West of the 5th P.M.
 MRM 290.00 + 0.018

END EM-P 0044(207)290
 STA. 966+91.00 R2 = STA. 100+50.00 on 002K
 Approximately 2275.78' South and 2099.50' West of the Northeast corner of Section 15 - Township 99 North - Range 70 West
 MRM 292.00 + 0.240

EQUATION
 STA. 966+91.00 R2 Bk. =
 STA. 100+50.00 R3 Ah.

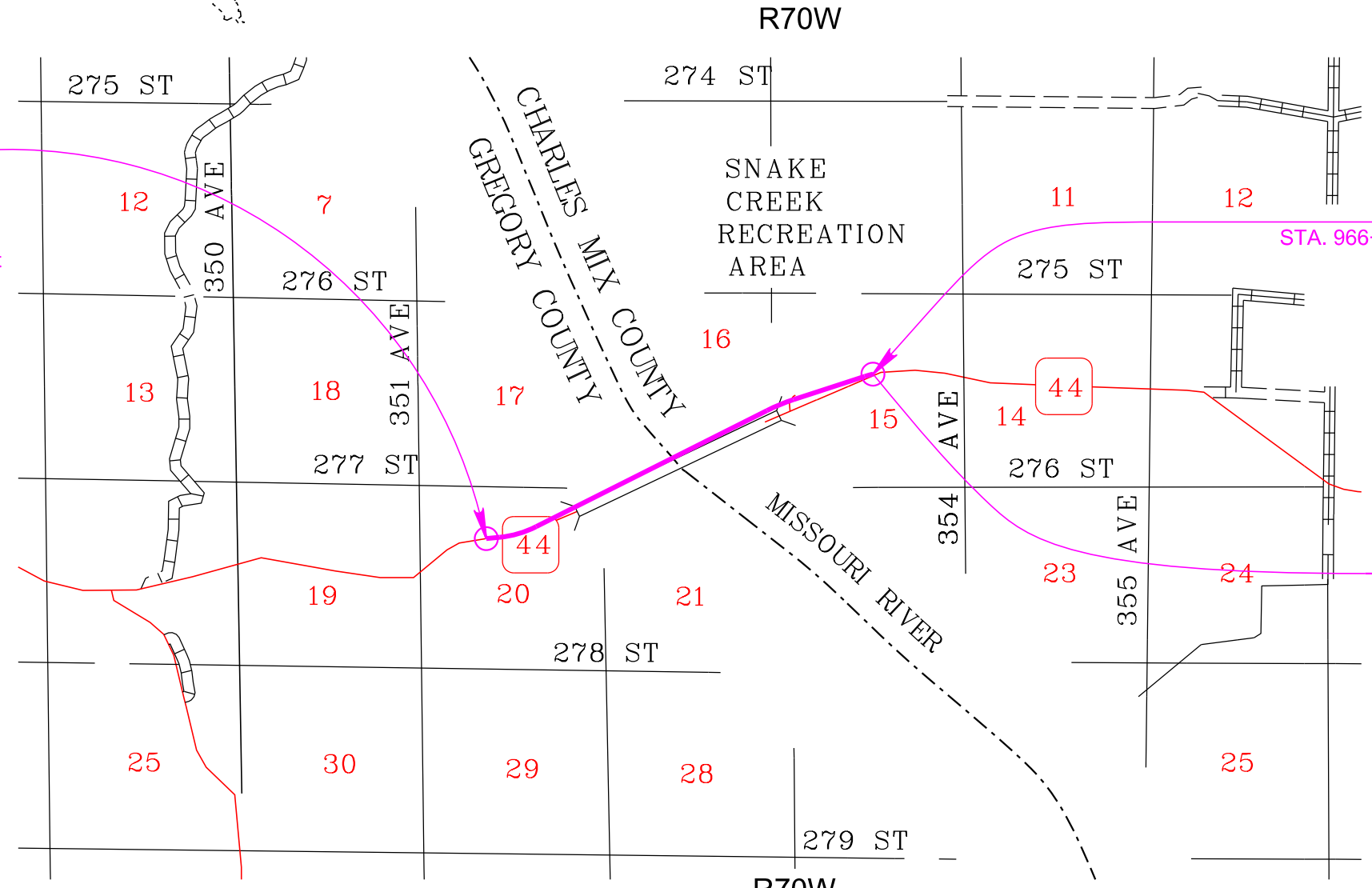

DESIGN DESIGNATION

AAADT (2022)	900
AAADT (2050)	1416
DHV	140
D	61%
DHV T%	10.7%
AAADT T%	23.5%
V	70 mph

STORM WATER PERMIT

Major Receiving
 Body of Water: Missouri River
 Area Disturbed: 62.0 Acres
 Total Project Area: 77.8 Acres
 Approx. Begin Lat,Long: 43.3811, -99.1522

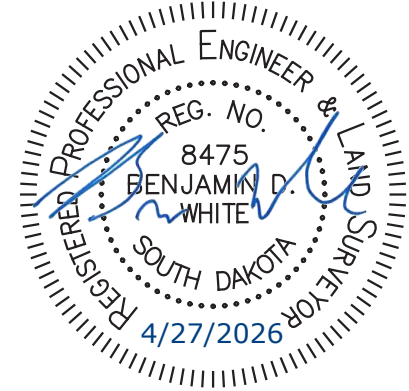

Gross Length	11,741 Feet	2.224 Miles
Length of Exceptions	0.00 Feet	0.00 Miles
Net Length	11,741 Feet	2.224 Miles

Plot Scale - 1:200

Plotted From -

File - ...12019190604\CAD\stripmap.dgn

ESTIMATE OF QUANTITIES AND ENVIRONMENTAL COMMITMENTS

Rev 05/02/2025 BDW
Rev 06/04/2026 BDW

STATE OF SOUTH DAKOTA	PROJECT	SHEET	TOTAL SHEETS
	P 0044(207)290	A1	A7

Section B - Grading

Section B – Grading

Section D - Erosion and Sediment Control

BID ITEM NUMBER	ITEM	QUANTITY	UNIT
009E0010	Mobilization	Lump Sum	LS
009E3220	Reestablish Right-of-Way and Property Corner	52	Each
009E3225	Reestablish Public Land Survey System Corner	1	Each
009E3230	Grade Staking	3,079	Mile
009E3250	Miscellaneous Staking	3,079	Mile
009E3280	Slope Staking	3,079	Mile
009E3290	Structure Staking	1	Each
009E3301	Engineer Directed Surveying/Staking	40.0	Hour
009E4300	Construction Schedule, Category III	Lump Sum	LS
100E0100	Clearing	Lump Sum	LS
110E0210	Remove Building(s)	Lump Sum	LS
110E0300	Remove Concrete Curb and/or Gutter	180	Ft
110E0400	Remove Drop Inlet	4	Each
110E0550	Remove Cattle Guard	1	Each
110E0600	Remove Fence	7,445	Ft
110E0730	Remove Beam Guardrail	368.0	Ft
110E1010	Remove Asphalt Concrete Pavement	38,238.2	SqYd
110E1970	Remove Water Main	3,648	Ft
120E0010	Unclassified Excavation	605,992	CuYd
120E0600	Contractor Furnished Borrow Excavation	56,331	CuYd
120E1000	Muck Excavation	2,978	CuYd
120E2000	Undercutting	36,050	CuYd
120E6100	Water for Embankment	4,406.5	MGal
240E0010	Obliterate Old Road	21	Sta
250E0020	Incidental Work, Grading	Lump Sum	LS
450E0122	18" RCP Class 2, Furnish	190	Ft
450E0130	18" RCP, Install	190	Ft
450E0142	24" RCP Class 2, Furnish	190	Ft
450E0150	24" RCP, Install	190	Ft
450E0164	30" RCP Class 4, Furnish	144	Ft
450E0170	30" RCP, Install	144	Ft
450E2008	18" RCP Flared End, Furnish	8	Each
450E2009	18" RCP Flared End, Install	8	Each
450E2024	30" RCP Flared End, Furnish	2	Each
450E2025	30" RCP Flared End, Install	2	Each
450E2200	24" RCP Sloped End, Furnish	2	Each
450E2201	24" RCP Sloped End, Install	2	Each
450E2308	24" RCP Safety End, Furnish	2	Each
450E2311	24" RCP Safety End, Install	2	Each
450E4768	24" CMP 14 Gauge, Furnish	158	Ft
450E4770	24" CMP, Install	158	Ft
450E4778	30" CMP 14 Gauge, Furnish	88	Ft
450E4780	30" CMP, Install	88	Ft

BID ITEM NUMBER	ITEM	QUANTITY	UNIT
450E5015	24" CMP Elbow, Furnish	2	Each
450E5016	24" CMP Elbow, Install	2	Each
450E5310	24" CMP Sloped End, Furnish	1	Each
450E5311	24" CMP Sloped End, Install	1	Each
450E5314	30" CMP Sloped End, Furnish	1	Each
450E5315	30" CMP Sloped End, Install	1	Each
450E5414	30" CMP Safety End, Furnish	2	Each
450E5417	30" CMP Safety End, Install	2	Each
450E8014	24" RCP to CMP Transition, Furnish	1	Each
450E8015	24" Pipe Transition, Install	1	Each
451E3103	3" Pipe Cap	2	Each
451E7510	Verify Utilities	2	Each
464E0100	Controlled Density Fill	62.0	CuYd
600E0200	Type II Field Laboratory	1	Each
610E0012	12' Cattle Guard	1	Each
620E0020	Type 2 Right-of-Way Fence	7,385	Ft
620E0510	Type 1 Temporary Fence	900	Ft
620E1020	2 Post Panel	46	Each
620E1030	3 Post Panel	11	Each
620E2016	16' Tubular Gate	1	Each
630E0500	Type 1 MGS	225.0	Ft
630E1500	Type 1 Guardrail Transition	4	Each
630E2019	MGS Tangent End Terminal	4	Each
671E7010	Adjust Manhole	1	Each
680E0224	4" PVC Outlet Pipe	165	Ft
680E0440	4" Slotted Corrugated Polyethylene Drainage Tubing	770	Ft
680E2000	Concrete Headwall for Underdrain	4	Each
680E2500	Porous Backfill	326.0	Ton
700E0110	Class A Riprap	308.0	Ton
700E0210	Class B Riprap	6,097.2	Ton
831E0110	Type B Drainage Fabric	5,866	SqYd
900E0010	Refurbish Single Mailbox	1	Each
900E0012	Refurbish Double Mailbox	1	Each
900E1080	Orange Plastic Safety Fence	225	Ft
900E5815	Channel Cross Section Survey	Lump Sum	LS

BID ITEM NUMBER	ITEM	QUANTITY	UNIT
110E1690	Remove Sediment	12.3	CuYd
110E1700	Remove Silt Fence	1,488	Ft
230E0010	Placing Topsoil	34,000	CuYd
730E0210	Type F Permanent Seed Mixture	1,586	Lb
731E0200	Fertilizing	45.73	Ton
732E0100	Mulching	130.6	Ton
732E0300	Bonded Fiber Matrix	18.0	Ton
734E0103	Type 3 Erosion Control Blanket	28,100	SqYd
734E0132	Type 2 Turf Reinforcement Mat	365.0	SqYd
734E0154	12" Diameter Erosion Control Wattle	5,700	Ft
734E0165	Remove and Reset Erosion Control Wattle	1,425	Ft
734E0325	Surface Roughening	8.8	Acre
734E0510	Shaping for Erosion Control Blanket	4,973	Ft
734E0602	Low Flow Silt Fence	5,700	Ft
734E0604	High Flow Silt Fence	250	Ft
734E0610	Mucking Silt Fence	413	CuYd
734E0620	Repair Silt Fence	1,488	Ft
734E0630	Floating Silt Curtain	1,170	Ft
900E1310	Concrete Washout Facility	1	Each
900E1320	Construction Entrance	4	Each

Section C - Traffic Control

BID ITEM NUMBER	ITEM	QUANTITY	UNIT
634E0010	Flagging	300.0	Hour
634E0020	Pilot Car	125.0	Hour
634E0110	Traffic Control Signs	618.4	SqFt
634E0120	Traffic Control, Miscellaneous	Lump Sum	LS
634E0275	Type 3 Barricade	6	Each
634E1002	Detour and Restriction Signing	384.0	SqFt
634E1215	Contractor Furnished Portable Changeable Message Sign	2	Each

INDEX OF SHEETS

A1 and A2 Estimate of Quantities for Sections B, C, D, E, F, M, and S
A3 to A7 Environmental Commitments

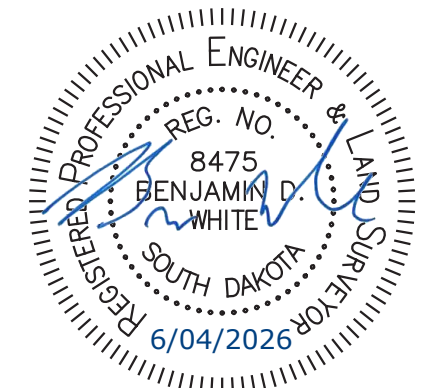

**Section E – Structure
Structure No. 12-089-076**

BID ITEM NUMBER	ITEM	QUANTITY	UNIT
009E3310	Bridge Elevation Survey	Lump Sum	LS
009E5000	Concrete Penetrating Sealer	23,555.3	SqYd
250E0030	Incidental Work, Structure	Lump Sum	LS
410E0020	Structural Steel	Lump Sum	LS
410E0030	Structural Steel, Miscellaneous	Lump Sum	LS
410E1150	Disc Bearing Assembly	96	Each
410E2150	Modular Expansion Joint Assembly	195.0	Ft
411E0100	Bridge Painting	Lump Sum	LS
420E0100	Structure Excavation, Bridge	427	CuYd
430E0200	Bridge End Embankment	1,666	CuYd
430E0300	Granular Bridge End Backfill	173.1	CuYd
430E0510	Approach Slab Underdrain Excavation	2.7	CuYd
430E0700	Precast Concrete Headwall for Drain	4	Each
460E0030	Class A45 Concrete, Bridge Deck	7,268.8	CuYd
460E0050	Class A45 Concrete, Bridge	10,426.2	CuYd
460E0150	Concrete Approach Slab for Bridge	163.4	SqYd
460E0160	Concrete Approach Sleeper Slab for Bridge	39.9	SqYd
460E0500	Deck Drain, Girder Bridge	104	Each
465E0100	Class A45 Concrete, Drilled Shaft	25,274.3	CuYd
465E0200	Drilled Shaft Excavation	16,887.2	CuYd
465E0400	Crosshole Sonic Log (CSL) Test	38	Each
465E0406	Thermal Integrity Profiling (TIP) Test	38	Each
465E1144	144" Permanent Casing	5,299.0	Ft
480E0100	Reinforcing Steel	3,611,562	Lb
480E0200	Epoxy Coated Reinforcing Steel	3,600	Lb
480E0300	Stainless Reinforcing Steel	1,979,024	Lb
480E0511	No. 11 Rebar Splice	1,824	Each
480E0514	No. 14 Rebar Splice	6,768	Each
510E3521	HP 14x73 Steel Test Pile, Furnish and Drive	110	Ft
510E3525	HP 14x73 Steel Bearing Pile, Furnish and Drive	1,700	Ft
635E8020	2" Rigid Galvanized Steel Conduit	5,740	Ft
680E0040	4" Underdrain Pipe	363	Ft
680E2500	Porous Backfill	30.3	Ton
734E2022	Bridge Berm Slope Protection, Quarried Aggregate	2,764.4	SqYd
831E0100	Type A Drainage Fabric	2,832	SqYd

Section F - Surfacing

BID ITEM NUMBER	ITEM	QUANTITY	UNIT
120E6200	Water for Granular Material	343.9	MGal
260E1080	Base Course, Salvaged, State Furnished	28,658.8	Ton
320E1200	Asphalt Concrete Composite	1,797.2	Ton
330E0010	MC-70 Asphalt for Prime	34.4	Ton
330E0300	SS-1h or CSS-1h Asphalt for Fog Seal	4.7	Ton
330E1000	Blotting Sand for Prime	86.7	Ton
330E3000	Sand for Fog Seal	10.0	Ton
360E0020	AE150S Asphalt for Surface Treatment	29.5	Ton
360E1050	Type 3 Cover Aggregate	395.8	Ton

Section M - Pavement Marking

BID ITEM NUMBER	ITEM	QUANTITY	UNIT
633E1200	High Build Waterborne Pavement Marking Paint, White	208	Gal
633E1205	High Build Waterborne Pavement Marking Paint, Yellow	94	Gal

Section S - Permanent Signing

BID ITEM NUMBER	ITEM	QUANTITY	UNIT
110E0130	Remove Traffic Sign	25	Each
110E0135	Remove Delineator	47	Each
632E1320	2.0"x2.0" Perforated Tube Post	223.3	Ft
632E1330	2.25"x2.25" Perforated Tube Post	64.2	Ft
632E1340	2.5"x2.5" Perforated Tube Post	59.0	Ft
632E2022	4"x4" White Delineator Back to Back with 1.12 Lb/Ft Post	23	Each
632E2028	4" Tubular White Delineator with 1.12 Lb/Ft Post	24	Each
632E3203	Flat Aluminum Sign, Nonremovable Copy High Intensity	153.0	SqFt
632E3205	Flat Aluminum Sign, Nonremovable Copy Super/Very High Intensity	108.6	SqFt

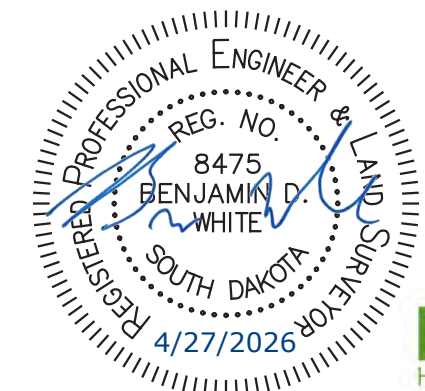

ENVIRONMENTAL COMMITMENTS

The SDDOT is committed to protecting the environment and uses Environmental Commitments as a communication tool for the Engineer and Contractor to ensure that attention is given to avoid, minimize, and/or mitigate an environmental impact. Environmental commitments to various agencies and the public have been made to secure approval of this project. An agency with permitting authority can delay a project if identified environmental impacts have not been adequately addressed. Unless otherwise designated, the Contractor's primary contact regarding matters associated with these commitments will be the Project Engineer. During construction, the Project Engineer will verify that the Contractor has met Environmental Commitment requirements. These environmental commitments are not subject to change without prior written approval from the SDDOT Environmental Office.

Additional guidance on SDDOT's Environmental Commitments can be accessed through the Environmental Procedures Manual found at: <<https://dot.sd.gov/media/documents/EnvironmentalProceduresManual.pdf>>

For questions regarding change orders in the field that may have an effect on an Environmental Commitment, the Project Engineer will contact the Environmental Engineer at 605-773-3180 or 605-773-4336 to determine whether an environmental analysis and/or resource agency coordination is necessary.

Once construction is complete, the Project Engineer will review all environmental commitments for the project and document their completion.

COMMITMENT A: AQUATIC RESOURCES

COMMITMENT A2: STREAMS

All efforts to avoid and minimize stream impacts from the project have resulted in approximately 18.03 acres of stream (includes temporary and permanent) becoming impacted. Refer to Grading Plans for location and boundaries of the impacted streams.

Table of Impacted Streams

Stream Name	Station	Perm. Impact Left (Acres)	Perm. Impact Right (Acres)	Temp. Impact Left (Acres)	Temp. Impact Right (Acres)	Total Impact (Acres)
Missouri River (Lake Francis Case Reservoir)	878+00 to 931+50	0.37	0.00	8.68	8.98	18.03

Action Taken/Required:

It has been determined that project impacts do not require mitigation. Temporary impacts identified in the Table of Impacted Streams will not be mitigated as the finished ground under the bridge will be shaped to match the upstream channel and flood plain and the existing low water channel will be maintained as near as practical to the existing location as designated in the Grading Plans.

The Contractor will notify the Project Engineer if additional easement is needed to complete work adjacent to any stream. The Project Engineer will obtain an appropriate course of action from the Environmental Office before proceeding with construction activities that affect any streams beyond the work limits and easements shown in the plans.

COMMITMENT B: FEDERALLY THREATENED, ENDANGERED, AND PROTECTED SPECIES

COMMITMENT B2: WHOOPING CRANE

The Whooping Crane is a spring and fall migratory bird in South Dakota that is about 5 feet tall and typically stops on wetlands, rivers, and agricultural lands along their migration route. An adult Whooping Crane is white with a red crown and a long, dark, pointed bill. Immature Whooping Cranes are cinnamon brown. While in flight, their long necks are kept straight and their long dark legs trail behind. Adult Whooping Cranes' black wing tips are visible during flight.

Action Taken/Required:

Harassment or other measures to cause the Whooping Crane to leave the site is a violation of the Endangered Species Act. If a Whooping Crane is sighted roosting in the vicinity of the project, borrow pits, or staging areas associated with the project, cease construction activities in the affected area until the Whooping Crane departs and immediately contact the Project Engineer. The Project Engineer will contact the Environmental Office so that the sighting can be reported to USFWS.

COMMITMENT B4: BALD EAGLE

Bald eagles are known to occur in this area.

Action Taken/Required:

If a nest is observed within one mile of the project site, notify the Project Engineer immediately so that he/she can consult with the Environmental Office for an appropriate course of action including, but not limited to, review of the National Bald Eagle Management Guidelines for recommendations to avoid harm or disturbance to bald eagles.

COMMITMENT B5: NORTHERN LONG-EARED BAT

This project is within the range of suitable habitat for the Northern Long-Eared Bat (NLEB) and project work will avoid conflicts with NLEB roosting habitat.

Action Taken/Required:

Project activities that include tree removal, structure work, and/or work within one-quarter mile of a known hibernacula or 150 feet of a known maternity roost tree, or suitable habitat should not occur within the location(s) listed below during the NLEB seasonal work restriction timeframe without approval from the SDDOT Environmental Office. Tree clearing and structure removal will occur between November 1 and March 31. A NLEB presence/absence survey is required prior to tree clearing and/or structure removal occurring between April 1 and October 31.

Station	NLEB Seasonal Work Restriction
848+00 to 966+91	April 1 to October 31

COMMITMENT B6: MIGRATORY BIRDS WORK RESTRICTION

Migratory birds are known to use the project area for nesting, which occurs from March through August.

Action Taken/Required:

The Contractor is responsible for contracting the services of a qualified biologist for conducting preconstruction migratory bird surveys in suitable areas that have not been mowed or cleared prior to April 1st to determine if there are current nests and to determine offsetting measures to compensate for impacts to migratory birds. A survey will be conducted annually for each year of construction. Contractor will coordinate the survey findings with the Project Engineer. If any nests are found, appropriate minimization measures will need to be developed in cooperation with the Environmental Office.

Construction activities should not occur in the locations listed in the table below during the migratory bird work restriction without prior approval from the SDDOT Environmental Office to avoid conflicts with nesting migratory birds.

All Swallows are state and federally protected under the Migratory Bird Treaty Act of 1918. It is illegal for any person to take, possess, transport, sell, or purchase them or their parts, such as feathers, nests, or eggs, without a permit. Active nests with eggs or chicks inside may not be touched or destroyed without a permit from the U.S. Fish and Wildlife Service (USFWS). Inactive (empty) nests do not require a permit to destroy. Nest or bird removal applications must be justified with strong, compelling reasons such as a health or safety hazard towards humans and/or birds or damage to property.

Action Taken/Required:

Construction activities should not occur in the locations listed in the table below during the migratory bird work restriction without prior approval from the SDDOT Environmental Office to avoid conflicts with nesting migratory birds.

Table of Migratory Birds Restrictions

Station	Migratory Bird Restriction
848+00 to 966+91	April 1 to July 15

If necessary, you may do the following to prevent birds from nesting:

Before birds arrive:

Remove old nests and any traces of mud. Since old nests can be reused, remove any potential nests before the birds arrive from winter migration.

Place physical barriers on potential nesting sites to prevent birds from nesting. You may use products such as coroplast, polytetrafluoroethylene (Teflon), Bird Slide™, plexiglass, plastic sheeting or silicon-based paint coated to the surface. Physical barriers may be a permanent deterrent in preventing birds from nesting in nuisance locations.

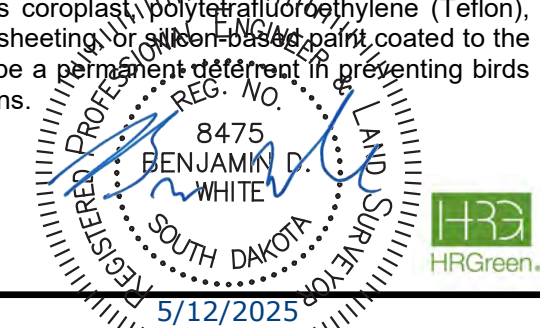

STATE OF SOUTH DAKOTA	PROJECT	SHEET	TOTAL SHEETS
	P 0044(207)290	A4	A7

After birds arrive:

Remove mud nests frequently, in between nest construction. They may eventually give up on that site if they are not successful in building a nest. You may only destroy nests that do not have eggs or chicks within.

Play sounds of alarm and distress calls of cliff and barn swallows to disrupt nest construction.

If project activities cannot be conducted outside of the seasonal restriction the Contractor will notify the Project Engineer and the Environmental Office Biologist (605-773-3309) to coordinate with the USFWS.

Migratory birds are known to use the project area for nesting, which primarily occurs from April 1st to July 15th.

COMMITMENT C: WATER SOURCE

The Contractor will not withdraw water with equipment previously used outside the State of South Dakota or previously used in aquatic invasive species (AIS) positive waters within South Dakota without prior approval from the SDDOT Environmental Office. To prevent and control the introduction and spread of invasive species into the project vicinity, all equipment will be power washed with hot water (≥140 °F) and completely dried for a minimum of 7 days prior to subsequent use. South Dakota administrative rule 41:10:04:02 forbids the possession and transport of AIS; therefore, all attached dirt, mud, debris and vegetation must be removed and all compartments and tanks capable of holding standing water must be drained. This includes, but is not limited to, all equipment, pumps, lines, hoses and holding tanks.

Action Taken/Required:

The Contractor will obtain the necessary permits from the regulatory agencies such as the South Dakota Department of Agriculture and Natural Resources (DANR) and the United States Army Corps of Engineers (USACE) prior to water extraction activities.

Additional information and mapping of water sources impacted by Aquatic Invasive Species in South Dakota can be accessed at:
<<https://sdleastwanted.sd.gov/maps/default.aspx>>

<[South Dakota Administrative Rule 41:10:04 Aquatic Invasive Species: https://sdlegislature.gov/rules/DisplayRule.aspx?Rule=41:10:04](https://sdlegislature.gov/rules/DisplayRule.aspx?Rule=41:10:04)>

COMMITMENT D: WATER QUALITY STANDARDS

COMMITMENT D1: SURFACE WATER QUALITY

The Lake Francis Case Reservoir is classified as a warm water permanent fishery with a total suspended solids standard of less than 90 mg/L 30-day average, less than 158 mg/L daily maximum.

Action Taken/Required:

The Contractor is advised that the South Dakota Surface Water Quality Standards, administered by the South Dakota Department of Agriculture and Natural Resources (DANR), apply to this project. Special construction measures will be taken to ensure the above standard(s) of the surface waters are maintained and protected.

COMMITMENT D2: SURFACE WATER DISCHARGE

The DANR General Permit for Temporary Discharge is required for temporary dewatering and discharges to waters of the state. The effluent limit for total suspended solids will be 90 mg/L 30-day average. The effluent limit applies to discharges to all waters of the state except discharges to waters classified as cold water permanent fish life propagation waters according to the ARSD 74:51:01:45. For discharges to waters of the state classified as cold water permanent fish life propagation waters, the effluent limit for total suspended solids will be 53 mg/L daily maximum.

The permittee has the option of completing effluent testing or implementing a pollution prevention plan for compliance with this permit. If the permittee develops a pollution prevention plan instead of total suspended solids sampling, the plan must be developed and implemented prior to discontinuing total suspended solids sampling. Refer to Section 4.0 of the permit. If any pollutants are suspected of being discharged, a sample must be taken for those parameters listed in Section 3.4 of the permit.

Refer to Commitment D1: Surface Water Quality for stream classification.

Action Taken/Required:

If construction dewatering is required and this project is currently covered under a General Permit for Stormwater Discharges Associated with Construction Activities, the contractor will need to submit the dewatering information to the SDDANR using the following form:

<https://danr.sd.gov/OfficeOfWater/SurfaceWaterQuality/docs/DANR_AddTemplInfoFillable.pdf>

The Contractor will provide a copy of the approved permit or the submitted dewatering information to the Project Engineer prior to proceeding with any dewatering activities. The approved permit or submitted dewatering information must be kept on-site and as part of the project records.

Effluent monitoring, as a result of dewatering activities, will be summarized for each month and recorded on a separate Discharge Monitoring Report (DMR) and submitted to DANR monthly. Additional information can be found at:
<<https://danr.sd.gov/OfficeOfWater/SurfaceWaterQuality/swdpermitting/Ereporting.aspx>>

COMMITMENT E: STORM WATER

Action Taken/Required:

The DANR General Permit for Stormwater Discharges Associated with Construction Activities is required for construction activity disturbing one or more acres of earth and work in a waterway. The SDDOT is the owner of this permit and will submit the NOI to DANR 15 days prior to project start in order to obtain coverage under the General Permit. Work can begin once the DANR letter of approval is received.

The Contractor must adhere to the “Special Provision Regarding Storm Water Discharges to Waters of the State.” The Contractor will complete the DANR Contractor Certification Form prior to the pre-construction meeting. The form certifies under penalty of law that the Contractor understands and will comply with the terms and conditions of the

permit for this project. Work may not begin on this project until this form is signed and submitted to DANR.

The form can be found at:
<https://danr.sd.gov/OfficeOfWater/SurfaceWaterQuality/docs/DANR_CGPAappendixCCA2018Fillable.pdf>

The Contractor is advised that permit coverage may also be required for off-site activities, such as borrow and staging areas, which are the responsibility of the Contractor.

Storm Water Pollution Prevention Plan

The Storm Water Pollution Prevention Plan (SWPPP) will be developed prior to the submittal of the NOI and will be implemented for all construction activities for compliance with the permit. The SWPPP must be kept on-site and updated as site conditions change. Erosion control measures and best management practices will be implemented in accordance with the SWPPP.

The DOT 298 Form will be used for site inspections and to document changes to the SWPPP. A copy of the completed inspection form will be filed with the SWPPP documents and retained for a minimum of three years.

The inspection will include disturbed areas of the construction site that have not been finally stabilized, areas used for storage materials, structural control measures, and locations where vehicles enter or exit the site. These areas will be inspected for evidence of, or the potential for, pollutants entering the drainage system. Erosion and sediment control measures identified in the SWPPP will be observed to ensure that they are operating correctly, and sediment is not tracked off the site.

Information on storm water permits and SWPPPs are available on the following websites:

SDDOT: <<https://dot.sd.gov/doing-business/environmental/stormwater>>

DANR: <<https://danr.sd.gov/OfficeOfWater/SurfaceWaterQuality/stormwater/default.aspx>>

EPA: <<https://www.epa.gov/npdes>>

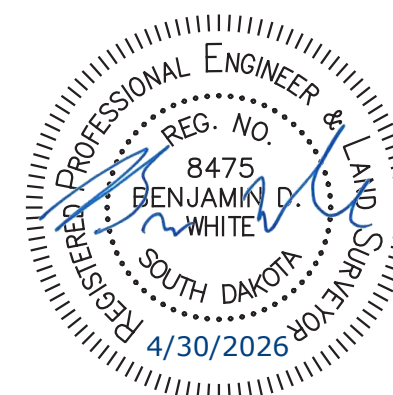

COMMITMENT H: WASTE DISPOSAL SITE

The Contractor will furnish a site(s) for the disposal of construction and/or demolition debris generated by this project.

Action Taken/Required:

Construction and/or demolition debris may not be disposed of within the Public ROW.

The waste disposal site(s) will be managed and reclaimed in accordance with the following from the General Permit for Construction/Demolition Debris Disposal Under the South Dakota Waste Management Program issued by the Department of Agriculture and Natural Resources.

The waste disposal site(s) will not be located within 50 feet of any wetland, drainage channel, or irrigation ditch or, within 200 feet of surface water, or in an area that adversely affects wildlife, recreation, aesthetic value of an area, or any threatened or endangered species, as approved by the Environmental Office and the Project Engineer.

Excavated and dredged material from wetland areas must be hauled offsite and disposed of in an upland location away from streams and wetlands. Return water from excavated or dredged material may not be allowed to re-enter Waters of the State.

If the waste disposal site(s) is located such that it is within view of any ROW, the following additional requirements will apply:

1. Construction and/or demolition debris consisting of concrete, asphalt concrete, or other similar materials will be buried in a trench separate from wood debris. The final cover over the construction and/or demolition debris will consist of a minimum of 1 foot of soil capable of supporting vegetation. Waste disposal sites provided outside of the Public ROW will be seeded in accordance with Natural Resources Conservation Service recommendations. The seeding recommendations may be obtained through the appropriate County NRCS Office. The Contractor will control the access to waste disposal sites not within the Public ROW with fences, gates, and placement of a sign or signs at the entrance to the site stating, "No Dumping Allowed".
2. Concrete and asphalt concrete debris may be stockpiled within view of the ROW for a period not to exceed the duration of the project. Prior to project completion, the waste will be removed from view of the ROW or buried, and the waste disposal site reclaimed as noted above.

The above requirements will not apply to waste disposal sites that are covered by an individual solid waste permit as specified in SDCL 34A-6-58, SDCL 34A-6-1.13, and ARSD 74:27:10:06.

Failure to comply with the requirements stated above may result in civil penalties in accordance with South Dakota Solid Waste Law, SDCL 34A-6-1.31.

All costs associated with furnishing waste disposal site(s), disposing of waste, maintaining control of access (fence, gates, and signs), and reclamation of the waste disposal site(s) will be incidental to the various contract items.

COMMITMENT I: HISTORIC PRESERVATION OFFICE CLEARANCES

The SDDOT has obtained concurrence with the State Historic Preservation Office (SHPO) for all work included within the project limits and all department designated sources and designated option material sources, stockpile sites, storage areas, and waste sites provided within the plans.

Action Taken/Required:

All earth disturbing activities not designated within the plans require a cultural resource review prior to scheduling the pre-construction meeting. This work includes but is not limited to: Contractor furnished material sources, material processing sites, stockpile sites, storage areas, plant sites, and waste areas.

The Contractor will arrange and pay for a record search and when necessary, a cultural resource survey. The Contractor has the option to contact the state Archaeological Research Center (ARC) at 605-394-1936 or another qualified archaeologist, to obtain either a records search or a cultural resources survey. A record search might be sufficient for review if the site was previously surveyed; however, a cultural resources survey may need to be conducted by a qualified archaeologist.

The Contractor will provide ARC with the following: a topographical map or aerial view in which the site is clearly outlined, site dimensions, project number, and PCN. If applicable, provide evidence that the site has been previously disturbed by farming, mining, or construction activities with a landowner statement that artifacts have not been found on the site.

The Contractor will submit the cultural resources survey report to SDDOT Environmental Office, 700 East Broadway Avenue, Pierre, SD 57501-2586. SDDOT will submit the information to the appropriate SHPO/THPO. Allow **30 Days** from the date this information is submitted to the Environmental Engineer for SHPO/THPO review.

In the event of an inadvertent discovery of human remains, funerary objects, or if evidence of cultural resources is identified during project construction activities, then such activities within 150 feet of the inadvertent discovery will immediately cease and the Project Engineer will be immediately notified. The Project Engineer will contact the SDDOT Environmental Office, who will contact the appropriate SHPO/THPO within 48 hours of the discovery to determine an appropriate course of action.

SHPO review does not relieve the Contractor of the responsibility for obtaining any additional permits and clearances for Contractor furnished material sources, material processing sites, stockpile sites, storage areas, plant sites, and waste areas that affect wetlands, threatened and endangered species, or waterways. The Contractor will not utilize a site known or suspected of having contaminated soil or water. The Contractor will provide the required permits and clearances to the Project Engineer at the preconstruction meeting.

COMMITMENT J: CONSTRUCTION PRACTICES FOR TEMPORARY WORKS IN WATERWAYS OF THE U.S.

The Contractor is advised that special construction measures must be taken to ensure that the waterways of the U.S. are not impacted.

Action Taken/Required:

Excavation will not occur below the ordinary high-water elevation in waterways outside of caissons, cribs, cofferdams, steel piling, or sheeting. The natural streambed will not be disturbed unless specified by the plans and under the observation of the Project Engineer. Refer to the Table of U.S. Waterways to Protect for ordinary high-water elevations. Any structure work over or within the waterway will be constructed according to Section 7.18 C of the Specifications.

All dredged or excavated materials will be placed at a site above the ordinary high-water elevation in a confined area (not classified as a wetland) that is a minimum of 50 feet away from concentrated flows of storm water, drainage courses, and inlets to prevent return of such material to the waterway.

All temporary caissons, cribs, cofferdams, steel piling, sheeting, work platforms, crossings, and berms will be removed with minimal disturbance to the streambed. Proper construction practices will be used to minimize increases in suspended solids and turbidity in the waterway.

Bridge berms, wing dams, traffic diversions, channel reconstruction, stream diversions, grading, etc. will be constructed in close conformity with the plans to ensure that the hydraulic capacity of the waterway is not changed.

Temporary waterway crossings required for the Contractor's construction operations will be constructed with an adequate drainage structure size and minimum fill height to reduce the potential for upstream flooding. The Contractor will be responsible for sizing the temporary drainage structure for these crossings.

All temporary works in waterways of the US are required to be covered in the Corp of Engineers 404 Permit. At the time of the preconstruction meeting, the Contractor will submit documentation for all temporary works for the purpose of complying with the 404 Permit requirements in accordance with Section 423.3 A of the Specifications.

Table of U.S. Waterways to Protect

Station	Waterway	Ordinary High-Water Elevation
877+30 to 931+70	Lake Francis Case Reservoir	1,365 ft above msl

Stream channel excavation within "Waters of the US" is subject to USACE regulatory jurisdiction. Stream channel excavation cannot exceed the permitted quantities and/or surface area. The 404 Permit is included in the Special Provisions.

The Contractor will take all precautions necessary to prevent any incidental discharges associated with the excavation and hauling of material from the stream channel. This pertains to any excavation operations such as, foundation, pier, or abutment excavation, channel cleanout, excavation for riprap protection, and removal of any temporary fill associated with construction activities.

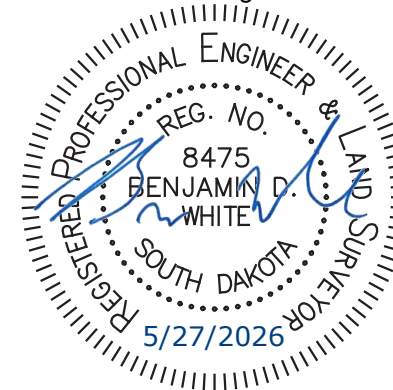

riprap protection, and removal of any temporary fill associated with construction activities.

COMMITMENT L: CONTAMINATED MATERIAL

Contaminated materials are located within the project limits. The likely presence of lead paint on the existing bridge requires that the lead-based paint and related debris must be disposed of in accordance with all applicable federal, state and local laws governing such disposal. All necessary measures and precautions shall be taken to ensure worker safety for work involving potential release of lead particles. Contaminated material may be located at the following sites:

Description	Station	L / R
Lead Paint on Structure 12-085-080	876+00 to 933+00	R
Human waste is expected to be found within the soils and septic system concrete surrounding existing RV waste dump station underground holding tank.	946+50	L
Human waste is expected to be found with in the Park Residence Septic Tank	945+13	L

Action Taken/Required:

The Contractor will give written notice, with a copy to the Area Engineer and DANR, 30 days prior to the start of work. In addition, the Contractor will give written notice to the Engineer 7 days prior to the commencement of the work so the Engineer may notify DANR of the day work will start.

Removal of lead-based paint should occur before cutting, grinding, rivet busting, or other lead-emitting tasks involved in deconstruction. Removal operations will need to plan for potential lead exposure and employees informed of the hazards of lead exposure.

The Contractor will give notice to the Engineer when contaminated soil is encountered on the project. The Engineer will contact the Environmental Office so that contact with the DANR and consultant to inspect and monitor removal of any contaminated soil can be initiated.

The Contractor will be responsible for having the existing underground utilities relocated in the construction area. Underground utilities damaged by the Contractor due to negligence will be repaired at the Contractor's expense.

Human waste contaminated soil and concrete may be disposed of at the following permitted solid waste facilities: City of Platte Landfill – 605-337-3921, City of Winner Landfill – 605-842-2606, and Tri-County Landfill – 605-894-4535 (Pukwana, SD). Materials with dry lead paint may be disposed of at the Tri-County Landfill only.

COMMITMENT M: SECTION 4(f)/6(f) RESOURCES

COMMITMENT M1: SECTION 4(f) PROPERTY

A Section 4(f) Evaluation concluded there are no feasible and prudent alternatives to avoiding Section 4(f) property located within the project.

Station	Section 4(f) Property
876+00 to 933+00	Platte-Winner Bridge
932+95 to 933+91	ESS-1
930+55 to 933+04	ESS-2
865+00 to 877+40	West Bridge Recreation Area
850+00 to 877+60	Buryanek Game Production Area
931+10 to 960+30	Snake Creek Recreation Area
871+30	West Platte Game Production Area

Action Taken/Required:

The sanitary dump/water station location transfer will occur within the West Platte GPA as mitigation for transportation impacts to Snake Creek Recreation Area. .

Access to Buryanek Game Production Area, West Bridge Recreation Area (and associated boat launch to remain open during construction), Snake Creek Recreation Area, & West Platte Game Production Area shall always be maintained during construction activities via flagging operations and/or an approved detour.

Construction plan sheets will address the location adjacent to proposed construction limits to protect ESS #1. Fill material will be used to build on top of the existing ground for the new roadway to avoid impacts to ESS #1. Any fill material sources from an outside location will be obtained from a location for which the Section 106 consultation process has been completed. SDDOT will require the contractor to document compliance with this requirement. Construction activities near ESS #1 will be monitored during construction, including ground-disturbing activities and geotechnical borings on the west and east banks of the river. The SDDOT will ensure that an archaeologist meeting the Secretary of the Interior's Professional Qualification Standards for Archaeologists (48 CFR 44738-9) and tribal monitor representatives on behalf of the Yankton Sioux Tribe and Rosebud Sioux Tribe will be present to monitor ground-disturbing activities. For ESS #1, the Contractor shall be required to closely coordinate the construction schedule with SDDOT prior to the start of construction activities.

The Contractor is not permitted to stage equipment or materials outside of the project limits within Snake Creek Recreation Area, West Bridge Recreation Area, Buryanek Game Production Area, or the West Platte Game Production Area. The Contractor will notify the Project Engineer if additional easement is needed to complete the work adjacent to any Section 4(f) property. The Project Engineer will obtain an appropriate course of action from the Environmental Office before proceeding with construction activities that affect any Section 4(f) property.

COMMITMENT M2: SECTION 6(f) PROPERTY

National Park Service concurrence has been obtained for project impacts to the following resource(s) acquired and developed through a Land and Water Conservation Fund grant.

Station	Section 6(f) Property
931+00 to 950+00	Snake Creek Recreation Area support facilities
931+00 to 950+00	Snake Creek Recreation Area picnic areas, swimming facilities, and support facilities
931+00 to 950+00	Snake Creek Recreation Area support facilities
931+00 to 950+00	Snake Creek Recreation Area RV electric pedestals, service panels, and underground wiring

Action Taken/Required:

Snake Creek Recreation Area Park services and public access to park facilities will continue throughout the duration of the construction project.

The following actions are required to ensure 6(f) replacement lands of equal value and usefulness are achieved:

- 4.2 acres of existing roadway and right of way will be converted to recreation use and coordinated with SDGFP.

The Contractor is not permitted to stage equipment or materials outside of the project limits within Snake Creek Recreation Area. The Contractor will notify the Project Engineer if additional easement is needed to complete the work adjacent to any Section 6(f) property. The Project Engineer will obtain an appropriate course of action from the Environmental Office before proceeding with construction activities that affect any Section 6(f) property.

COMMITMENT N: SECTION 404, SECTION 10, & SECTION 408 PERMITS

The SDDOT has obtained Section 404 Clean Water Act, Section 10 Rivers and Harbors Act, and Section 408 Clean Water Act permits from the USACE for the permanent actions associated with this project.

Action Taken/Required:

The Contractor will comply with all requirements contained in the Section 404, Section 10, and Section 408 permits.

The Contractor will also be responsible for obtaining a Section 404, Section 10, and Section 408 permit for any dredge, excavation, or fill activities associated with material sources, storage areas, waste sites, and Contractor work sites outside the plan work limits that affect wetlands, floodplains, or waters of the United States.

Completely remove the existing piers and pilings down to two feet below the existing streambed elevation at the pier or piling.

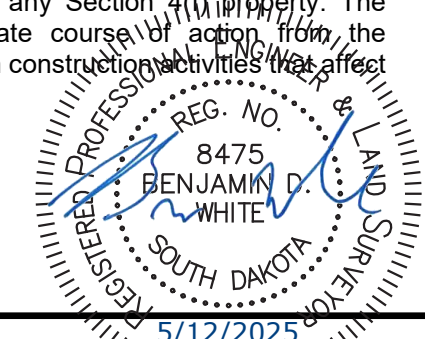

Fill from temporary causeways and other temporary features associated with the new bridge construction and old bridge demolition will not exceed fill volumes within the following Lake Francis Case Reservoir storage zones:

Storage Zone	Elevation (feet, NAVD 88)	Temporary Fill Volume (acre-feet)
Zone A – Carryover Multiple Use	1321.0 to 1351.0	-
Zone B – Annual Flood Control and Multiple Use	1351.0 to 1366.0	13
Zone C – Exclusive Flood Control	1366.0 to 1376.0	7
Zone D – Maximum Reservoir Elevation	1376.0 to 1380.3	2

The Contractor is responsible for removal of all temporary fills and the existing bridge at the end of construction. Work areas will be surveyed prior to construction beginning and again after construction is complete to ensure the removal of all temporary fill and the existing bridge has been achieved.

Surveys should extend the entire width of the flow area and include below water hydrographic surveys of the channel bottom. High density ground scan Lidar and multi-beam underwater will be used. The surveys will provide a minimum of one foot contour accuracy within the entire work area.

The Contractor will compare the pre-construction and post-construction topography and bathymetry data that was gathered to confirm complete removal of the existing bridge and all temporary fill. Surveys will be submitted to SDDOT and Project Engineer for review and submittal to USACE.

All costs associated with these surveys will be incidental to the lump sum contract unit price for "Channel Cross Section Survey".

COMMITMENT Q: ARCHAEOLOGICAL COORDINATION

As a result of a Cultural Resources Survey, historic properties have been identified within and/or adjacent to the project rights-of-way.

The following historic properties have been identified that require avoidance of construction activities:

Table of Historic Properties

Station	Offset (Ft.)	L/R	Environmental Sensitive Site	Action
932+95 to 933+91	17	R	ESS-1	Do Not Disturb/Monitor/ Orange Plastic Safety Fencing
930+55 to 933+04	27	R	ESS-2	Monitor. Geotextile fabric is required to be place over the site with 24" minimal fill to minimize impacts to the site

The locations and boundaries of the site(s) for avoidance are shown in Section B - Grading Plans.

Action Taken/Required:

If evidence for cultural resources is uncovered during project construction activities, then such activities within 150 feet of the inadvertent discovery will immediately cease and the Project Engineer will be immediately notified. The Project Engineer will contact the SDDOT Environmental Office, who will consult with the Archaeological Research Center (ARC), the Yankton Sioux THPO and SHPO, and FHWA, to determine the appropriate course of action.

All artifacts, features, or other items of interest uncovered by project construction activities will not be displaced unless the landowner and the SHPO consent to it.

Prior to the pre-construction meeting, the Contractor will contact the ARC (Phone: 605-394-1936) to coordinate the installation schedule of orange plastic safety fence around the perimeter of the sensitive site(s) listed in the Table of Historic/Archeological Sites to ensure proper location, quality, and visibility of the orange safety fence. The exact location of the safety fence will be determined later in the field by the ARC representative.

The Contractor will give written notice to the Engineer seven (7) days prior to the commencement of earth disturbing activities near listed sites identified in the Table of Historic/Archeological Site so the Engineer may notify ARC of the day work will start and schedule the installation of orange safety fence. ARC is to be present during earth disturbing activities to monitor the removal of topsoil, ensure avoidance of the fenced sites, and identify any culturally sensitive sites that may be uncovered.

Work within the vicinity of the site(s) will not begin until the safety fence is installed. All costs associated with furnishing and installing the orange safety fence will be incidental to the contract unit price per foot for "Orange Plastic Safety Fence". These identified sites cannot be used for material sources, storage areas, waste sites, and/or any other project related activities outside the plan work limits.

SDDOT will provide monitoring for the site(s) identified in the above table.

Prior to the pre-construction meeting, the Contractor will contact ARC (Phone: 605-394-1936) to be present at the meeting for the purposes of coordinating the monitoring schedule of the site(s) listed in the Table of Historic Properties. Work within vicinity of the site(s) will not begin until monitors are present at the site(s).

All costs associated with monitoring will be submitted to the Project Engineer for reimbursement.

Before earth disturbing activities near listed sites occurs, there will be seven (7) days prior notification provided to ARC for scheduling the installation of orange safety fence and/or monitoring at sensitive sites listed in the Table of Culturally Sensitive Sites. ARC and tribal monitors are to be present during earth disturbing activities to monitor the removal of topsoil, ensure avoidance of the fenced sites, and identify any culturally sensitive sites that may be uncovered.

These identified sites cannot be used for material sources, storage areas, waste sites, and/or any other project related activities outside the plan work limits.

COMMITMENT T: USCG Bridge Permit

The SDDOT has obtained a Bridge Permit from the United States Coast Guard for the permanent actions associated with this project.

Action Taken/Required:

The Contractor will comply with all requirements contained in the USCG Bridge Permit. The Contractor will also be responsible for obtaining a USCG Bridge Permit for any bridge structure within the Lake Francis Case Reservoir outside the plan work limits that affect the navigation channel.

The construction of falsework, pilings, cofferdams or other obstructions, and the scheme for constructing the bridge shall be in accordance with plans submitted to and approved by the USCG District Commander, prior to construction of the bridge. All work shall be so conducted that the free navigation of the waterway is not unreasonably interfered with and the present navigable depths are not impaired. Timely notice of any and all events that may affect navigation shall be given to the USCG District Commander during construction of the bridge.

COMMITMENT U: STATE LISTED THREATENED AND ENDANGERED SPECIES

False map turtles (*Graptemys pseudogeographica*), a state threatened species riverine species, has been recorded adjacent to the project area and is assumed present.

Action Taken/Required:

If false map turtles or other state listed species are sighted within the project, borrow pits, or staging areas associated with the project, cease construction activities and contact the Project Engineer. The Project Engineer will contact the SDDOT Environmental Office so that the sighting can be reported to SDGFP.

1. A scientific collectors permit and a state listed species authorization are required to survey for and to handle the False Map Turtles.
2. A qualified biologist is required to complete visual surveys for False Map Turtles if staging of construction materials will occur along barren sandy habitats during nesting seasons in May and June.
3. Remove any False Map Turtles from the construction area prior to staging of construction materials along barren, sandy habitats to avoid crushing turtles or their nests.
4. Use the minimum amount of rip-rap necessary for bank stabilization structure protection.
5. If turtles are in imminent danger, the contractor may move them by hand out of harm's way; otherwise, they are to be left undisturbed or moved by a qualified biologist.

