

STATE OF SOUTH DAKOTA
DEPARTMENT OF TRANSPORTATION
PLANS FOR PROPOSED

STATE OF SOUTH DAKOTA	PROJECT	SHEET	TOTAL SHEETS
	NH-CR 0034(193)402	1	429

Plotting Date: 08/16/2024 Revised 07/17/2024 AR

PROJECT NH-CR 0034(193)402
S.D. HIGHWAY 34
MOODY COUNTY

GRADING, PCC SURFACING, LIGHTING, C&G,
STORM SEWER, SIDEWALK, & SHARED USE PATH

PCN 0609

COLMAN

R 50 W

INDEX OF SECTIONS

- Section A: Estimate of Quantities and Environmental Commitments
- Section B: Grading Plans
- Section C: Traffic Control Plans
- Section D: Erosion and Sediment Control Plans
- Section F: Surfacing Plans
- Section L: Signal and Lighting Plans
- Section M: Pavement Marking Plans
 5
- Section S: Permanent Signing Plans
- Section X: Cross Sections
- Section Z: Pipe Sections

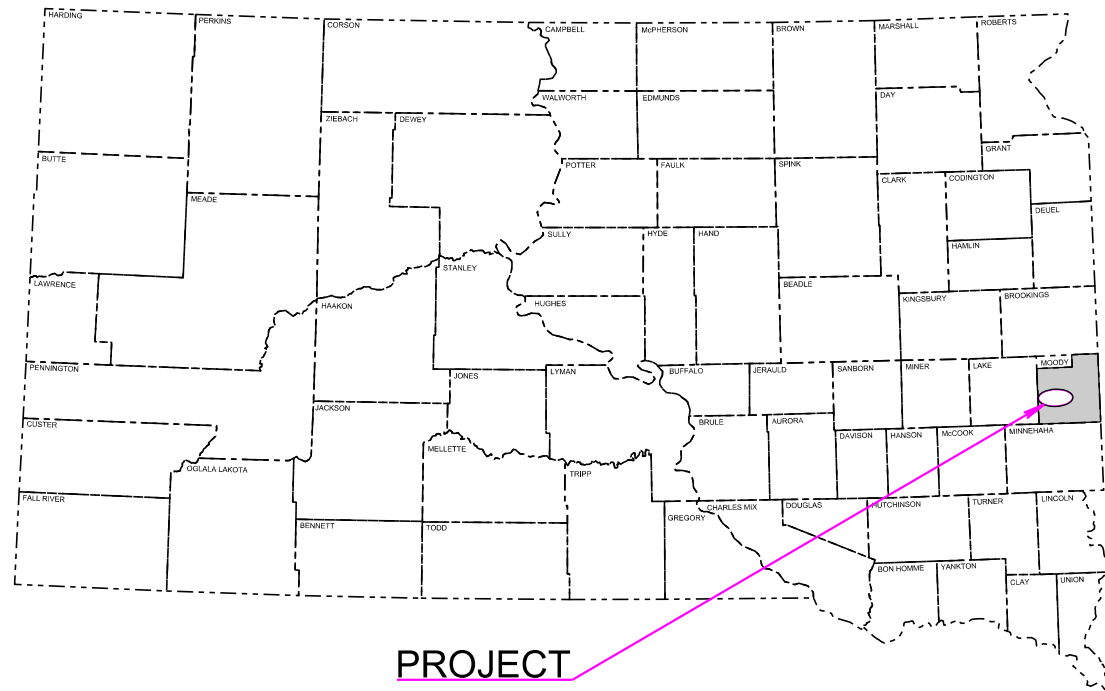

PROJECT

BEGIN NH-CR 0034(193)402
BEGIN GRADING

Station 357+14.77 = Station 357+14.57
on F 0034(15)396 located 33.49 feet South
and 1059.87 feet West of the Northwest
corner of Section 22 - Township 106 North-
Range 50 West of the 5th P.M.
MRM 402.00 +0.799

END GRADING
BEGIN SHOULDER WIDENING
Station 447+75.00

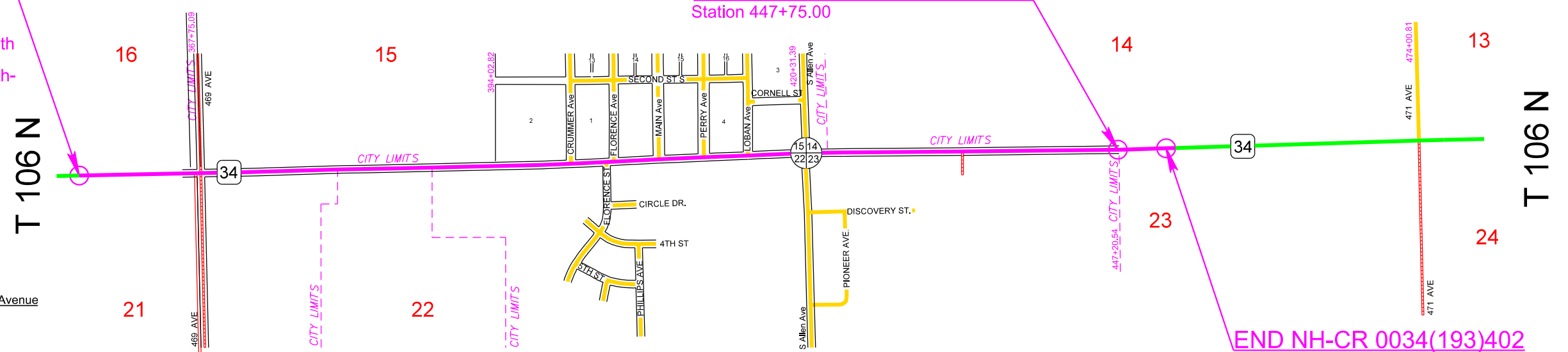

DESIGN DESIGNATION

	W. of Allen Avenue	E. of Allen Avenue
AADT (2020)	3073	4268
AADT (2040)	3150	4375
DHV	423	588
D	50	50
DHV T%	7.6%	5.0%
AADT T%	16.8%	11.0%
V	65mph (SD34 W. of 469th Avenue)	
	45mph (SD34 W. of T&R Electric Supply)	
	35mph (SD34 300' E. of Allen Avenue)	
	45mph (SD34 W. of Summit Avenue)	
	65mph (SD34 E. of 471st Avenue)	

STORM WATER PERMIT

Major Receiving
Body of Water: Bachelor Creek
Area Disturbed: 26 Acres
Total Project Area: 34 Acres
Approx. Begin Lat,Long: 43.9790, -96.8511

END NH-CR 0034(193)402
END SHOULDER WIDENING

Station 451+96.16 = Station 451+96.16 on
F 0034(193)403 located 83.18 feet South
and 2202.83 feet West of the Northeast corner of
Section 23 - Township 106 North-Range 50 West
of the 5th P.M.
MRM 404.27+0.341

R 50 W

1

November 20, 2024

Gross Length 9481.39 Feet 1.795 Miles
Length of Exceptions 0.00 Feet 0.000 Miles
Net Length 9481.39 Feet 1.795 Miles

Plot Scale - 1:200

Plotted From - TRSF12141

File - U:\traj\jmod\0609\Title.dgn

ESTIMATE OF QUANTITIES AND ENVIRONMENTAL COMMITMENTS

STATE OF SOUTH DAKOTA	PROJECT	SHEET	TOTAL SHEETS
	NH-CR 0034(193)402	A2	A5

Plotting Date: 10/11/2024

Section B – Grading

Section B – Grading, Continued

BID ITEM NUMBER	ITEM	QUANTITY	UNIT
009E0010	Mobilization	Lump Sum	LS
009E3220	Reestablish Right-of-Way and Property Corner	135	Each
009E3225	Reestablish Public Land Survey System Corner	6	Each
009E3230	Grade Staking	5.538	Mile
009E3245	Final Cross Section Survey	1.798	Mile
009E3250	Miscellaneous Staking	1.798	Mile
009E3280	Slope Staking	1.798	Mile
009E3301	Engineer Directed Surveying/Staking	40.0	Hour
009E4300	Construction Schedule, Category III	Lump Sum	LS
100E0100	Clearing	Lump Sum	LS
110E0300	Remove Concrete Curb and/or Gutter	47	Ft
110E0400	Remove Drop Inlet	21	Each
110E0600	Remove Fence	4,062	Ft
110E1010	Remove Asphalt Concrete Pavement	1,812.3	SqYd
110E1100	Remove Concrete Pavement	40,200.9	SqYd
110E1130	Remove Concrete Driveway Pavement	892.6	SqYd
110E1140	Remove Concrete Sidewalk	4.7	SqYd
120E0010	Unclassified Excavation	79,475	CuYd
120E0900	Contaminated Material Excavation	100	CuYd
120E1000	Muck Excavation	1,654	CuYd
120E2000	Undercutting	19,225	CuYd
120E6100	Water for Embankment	515.6	MGal
250E0020	Incidental Work, Grading	Lump Sum	LS
260E6010	Granular Material	247.0	Ton
270E0040	Salvage and Stockpile Asphalt Mix and Granular Base Material	18,802.6	Ton
380E3520	6" PCC Approach Pavement	983.3	SqYd
380E3540	8" PCC Approach Pavement	339.8	SqYd
380E4050	8" PCC Fillet Section	356.6	SqYd
421E0100	Pipe Culvert Undercut	131	CuYd
450E0122	18" RCP Class 2, Furnish	4,436	Ft
450E0130	18" RCP, Install	4,436	Ft
450E0142	24" RCP Class 2, Furnish	512	Ft
450E0150	24" RCP, Install	512	Ft
450E0162	30" RCP Class 2, Furnish	618	Ft
450E0170	30" RCP, Install	618	Ft
450E0182	36" RCP Class 2, Furnish	50	Ft
450E0190	36" RCP, Install	50	Ft
450E0192	42" RCP Class 2, Furnish	188	Ft
450E0200	42" RCP, Install	188	Ft
450E2008	18" RCP Flared End, Furnish	3	Each
450E2009	18" RCP Flared End, Install	3	Each
450E2028	36" RCP Flared End, Furnish	1	Each

BID ITEM NUMBER	ITEM	QUANTITY	UNIT
450E2029	36" RCP Flared End, Install	1	Each
450E2032	42" RCP Flared End, Furnish	8	Each
450E2033	42" RCP Flared End, Install	8	Each
450E2200	24" RCP Sloped End, Furnish	2	Each
450E2201	24" RCP Sloped End, Install	2	Each
450E3012	24" RCP Arch Class 2, Furnish	492	Ft
450E3020	24" RCP Arch, Install	492	Ft
450E3022	30" RCP Arch Class 2, Furnish	666	Ft
450E3030	30" RCP Arch, Install	666	Ft
450E3032	36" RCP Arch Class 2, Furnish	142	Ft
450E3040	36" RCP Arch, Install	142	Ft
450E4512	36" RCP Arch Flared End, Furnish	2	Each
450E4513	36" RCP Arch Flared End, Install	2	Each
450E4600	24" RCP Arch Sloped End, Furnish	3	Each
450E4601	24" RCP Arch Sloped End, Install	3	Each
450E4604	30" RCP Arch Sloped End, Furnish	7	Each
450E4605	30" RCP Arch Sloped End, Install	7	Each
450E4606	36" RCP Arch Sloped End, Furnish	2	Each
450E4607	36" RCP Arch Sloped End, Install	2	Each
450E4759	18" CMP 16 Gauge, Furnish	530	Ft
450E4760	18" CMP, Install	530	Ft
450E4789	36" CMP 16 Gauge, Furnish	56	Ft
450E4790	36" CMP, Install	56	Ft
450E5025	36" CMP Elbow, Furnish	2	Each
450E5026	36" CMP Elbow, Install	2	Each
450E5318	36" CMP Sloped End, Furnish	2	Each
450E5319	36" CMP Sloped End, Install	2	Each
450E5406	18" CMP Safety End, Furnish	16	Each
450E5407	18" CMP Safety End, Install	16	Each
450E5509	18" CMP Arch 16 Gauge, Furnish	54	Ft
450E5510	18" CMP Arch, Install	54	Ft
450E6006	18" CMP Arch Safety End, Furnish	2	Each
450E6007	18" CMP Arch Safety End, Install	2	Each
450E8910	Cleanout for Culvert Treatment	2	Each
450E9232	Slipline 48" Pipe	320	Ft
462E0100	Class M6 Concrete	153.2	CuYd
462E0250	Cellular Grout	78.6	CuYd
464E0100	Controlled Density Fill	3.9	CuYd
480E0100	Reinforcing Steel	27,607	Lb
600E0300	Type III Field Laboratory	1	Each
620E0020	Type 2 Right-of-Way Fence	2,587	Ft
620E0040	Type 4 Right-of-Way Fence	1,033	Ft
620E0060	Type 6 Right-of-Way Fence	489	Ft

INDEX OF SHEETS

A2 to A3 Estimate of Quantities for Sections B, C, D, L, F, M, and S
A4 to A6 Environmental Commitments

Section B – Grading, Continued

BID ITEM NUMBER	ITEM	QUANTITY	UNIT
620E1020	2 Post Panel	25	Each
620E1030	3 Post Panel	10	Each
620E2016	16' Tubular Gate	2	Each
650E0079	Modified Type B68 Concrete Curb and Gutter	2,631	Ft
650E0080	Type B68 Concrete Curb and Gutter	5,134	Ft
650E1079	Modified Type F68 Concrete Curb and Gutter	2,853	Ft
650E1080	Type F68 Concrete Curb and Gutter	301	Ft
650E3060	Type B6 Concrete Curb	19	Ft
650E4679	Modified Type P8 Concrete Gutter	320	Ft
650E4680	Type P8 Concrete Gutter	484	Ft
650E6080	8" Concrete Valley Gutter	48	Ft
651E0040	4" Concrete Sidewalk	19,335	SqFt
651E0060	6" Concrete Sidewalk	27,793	SqFt
651E0160	6" Reinforced Concrete Sidewalk	168	SqFt
651E0540	4" Colored Concrete Sidewalk	6,889	SqFt
651E0560	6" Colored Concrete Sidewalk	303	SqFt
651E0740	4" Reinforced Colored Concrete Sidewalk	30	SqFt
651E7000	Type 1 Detectable Warnings	550	SqFt
670E1200	Type B Frame and Grate	70	Each
670E2200	Type C Frame and Grate	9	Each
670E3300	Type E Frame and Grate	1	Each
670E5340	4' x 11' Precast Concrete Type S Drop Inlet Lid	7	Each
670E5400	Precast Drop Inlet Collar	71	Each
671E4548	48" Manhole Cone Section	4.0	Ft
671E6007	Type A7 Manhole Frame and Lid	2	Each
720E1015	Bank and Channel Protection Gabion	20.0	CuYd
831E0110	Type B Drainage Fabric	58	SqYd
831E0300	Reinforcement Fabric (MSE)	1,800	SqYd
900E0010	Refurbish Single Mailbox	4	Each

Plot Scale - 1:200

Plotted From - TRSF12144

File - ...:\projmody\0609\Notes\SectionA.dgn

ESTIMATE OF QUANTITIES AND ENVIRONMENTAL COMMITMENTS

STATE OF SOUTH DAKOTA	PROJECT	SHEET	TOTAL SHEETS
	NH-CR 0034(193)402	A3	A5

Plotting Date: 09/17/2024 Revised 09/17/2024 MS

Section C – Traffic Control

BID ITEM NUMBER	ITEM	QUANTITY	UNIT
634E0010	Flagging	500.0	Hour
634E0020	Pilot Car	2,500.0	Hour
634E0110	Traffic Control Signs	1,244.2	SqFt
634E0120	Traffic Control, Miscellaneous	Lump Sum	LS
634E0275	Type 3 Barricade	60	Each
634E0380	Tubular Marker	210	Each
634E0390	Replace Tubular Marker	50	Each
634E0560	Remove Pavement Marking, 4" or Equivalent	3,500	Ft
634E0600	4" Temporary Pavement Marking Tape Type I	432	Ft
634E0640	Temporary Pavement Marking	22,364	Ft
634E0900	Portable Temporary Traffic Control Signal	2	Unit
634E0919	Driveway Assistance Device	10.0	Mth
634E1002	Detour and Restriction Signing	563.0	SqFt
634E1020	Temporary Business Signing	50.0	SqFt
634E1215	Contractor Furnished Portable Changeable Message Sign	4	Each

Section F – Surfacing

BID ITEM NUMBER	ITEM	QUANTITY	UNIT
120E6200	Water for Granular Material	539.3	MGal
260E1010	Base Course	25,740.4	Ton
260E1030	Base Course, Salvaged	18,802.6	Ton
260E2010	Gravel Cushion	443.2	Ton
260E6000	Granular Material, Furnish	45.0	Ton
320E1200	Asphalt Concrete Composite	2,772.5	Ton
320E5020	Saw Joint in Asphalt Concrete	301	Ft
320E7012	Grind 12" Rumble Strip or Stripe in Asphalt Concrete	0.2	Mile
380E0050	8" Nonreinforced PCC Pavement	43,369.2	SqYd
380E3040	8" PCC Driveway Pavement	138.1	SqYd
380E6000	Dowel Bar	25,869	Each
380E6110	Insert Steel Bar in PCC Pavement	92	Each
380E6450	Saw Joint in PCC Pavement	15,363.7	Ft
380E6548	Grind Sinusoidal Centerline Rumble Stripe in PCC Pavement	0.3	Mile

Section M – Pavement Marking

BID ITEM NUMBER	ITEM	QUANTITY	UNIT
633E0010	Cold Applied Plastic Pavement Marking, 4"	36,130	Ft
633E0030	Cold Applied Plastic Pavement Marking, 24"	336	Ft
633E0040	Cold Applied Plastic Pavement Marking, Arrow	34	Each
633E0225	Preformed Thermoplastic Pavement Marking, 24"	168	Ft
633E0230	Preformed Thermoplastic Pavement Marking, Area	180	SqFt
633E5000	Grooving for Cold Applied Plastic Pavement Marking, 4"	36,130	Ft
633E5015	Grooving for Cold Applied Plastic Pavement Marking, 24"	504	Ft
633E5020	Grooving for Cold Applied Plastic Pavement Marking, Area	180	SqFt
633E5025	Grooving for Cold Applied Plastic Pavement Marking, Arrow	34	Each

Section D – Erosion and Sediment Control

BID ITEM NUMBER	ITEM	QUANTITY	UNIT
110E1690	Remove Sediment	22.3	CuYd
110E1700	Remove Silt Fence	1,661	Ft
230E0010	Placing Topsoil	6,691	CuYd
730E0100	Cover Crop Seeding	10.0	Bu
730E0206	Type D Permanent Seed Mixture	586	Lb
730E0212	Type G Permanent Seed Mixture	274	Lb
731E0200	Fertilizing	6.70	Ton
732E0100	Mulching	21.0	Ton
732E0500	Fiber Reinforced Matrix	5.2	Ton
734E0103	Type 3 Erosion Control Blanket	250	SqYd
734E0180	Sediment Filter Bag	2,780	Ft
734E0185	Remove and Reset Sediment Filter Bag	695	Ft
734E0325	Surface Roughening	1.5	Acre
734E0602	Low Flow Silt Fence	3,022	Ft
734E0604	High Flow Silt Fence	3,622	Ft
734E0610	Mucking Silt Fence	461	CuYd
734E0620	Repair Silt Fence	1,661	Ft
734E0845	Sediment Control at Inlet with Frame and Grate	82	Each
734E0847	Sediment Control at Type S Reinforced Concrete Drop Inlet	91	Ft
734E5005	Dewatering	Lump Sum	LS
900E1320	Construction Entrance	2	Each

Section L – Signal and Lighting

BID ITEM NUMBER	ITEM	QUANTITY	UNIT
110E1540	Remove Luminaire Pole Footing	30	Each
635E0050	Breakaway Base Luminaire Pole with Arm, 50' Mounting Height	6	Each
635E3700	Roadway Luminaire, LED with Photoelectric Cell	36	Each
635E5025	2.5' Diameter Footing	291.0	Ft
635E5301	Type 1 Electrical Junction Box	3	Each
635E5302	Type 2 Electrical Junction Box	4	Each
635E5400	Electrical Service Cabinet	3	Each
635E6200	Miscellaneous, Electrical	Lump Sum	LS
635E7500	Remove and Reset Luminaire Pole	30	Each
635E8110	1" Rigid Conduit, Schedule 40	45	Ft
635E8120	2" Rigid Conduit, Schedule 40	6,600	Ft
635E8210	1" Rigid Conduit, Schedule 80	60	Ft
635E8220	2" Rigid Conduit, Schedule 80	335	Ft
635E8620	2" Conduit, SDR 13.5	450	Ft
635E9011	1/C #1 AWG Copper Wire	3,580	Ft
635E9012	1/C #2 AWG Copper Wire	9,330	Ft
635E9013	1/C #3 AWG Copper Wire	3,785	Ft
635E9014	1/C #4 AWG Copper Wire	3,730	Ft
635E9016	1/C #6 AWG Copper Wire	6,060	Ft
635E9018	1/C #8 AWG Copper Wire	1,440	Ft
635E9020	1/C #10 AWG Copper Wire	5,450	Ft
635E9024	1/C #14 AWG Copper Wire	3,600	Ft
635E9710	2/C #10 AWG Copper Pole and Bracket Cable	2,520	Ft

Section S - Permanent Signing

BID ITEM NUMBER	ITEM	QUANTITY	UNIT
110E0130	Remove Traffic Sign	51	Each
110E7150	Remove Sign for Reset	3	Each
632E1320	2.0"x2.0" Perforated Tube Post	406.8	Ft
632E1340	2.5"x2.5" Perforated Tube Post	185.5	Ft
632E3203	Flat Aluminum Sign, Nonremovable Copy High Intensity	277.8	SqFt
632E3205	Flat Aluminum Sign, Nonremovable Copy Super/Very High Intensity	268.3	SqFt
632E3500	Reset Sign	3	Each
632E3700	Radar Speed Sign	2	Each

SPECIFICATIONS

Standard Specifications for Roads and Bridges, 2015 Edition and Required Provisions, Supplemental Specifications, and Special Provisions as included in the Proposal.

Plot Scale - 1:200

Plotted From - TRSF12144

File - ...:\proj\mod\0609\Notes\SectionA.dgn

ESTIMATE OF QUANTITIES AND ENVIRONMENTAL COMMITMENTS

STATE OF SOUTH DAKOTA	PROJECT NH-CR 0034(193)402	SHEET A4	TOTAL SHEETS A6
-----------------------	-------------------------------	-------------	--------------------

Plotting Date: 10/11/2024

ENVIRONMENTAL COMMITMENTS

The SDDOT is committed to protecting the environment and uses Environmental Commitments as a communication tool for the Engineer and Contractor to ensure that attention is given to avoid, minimize, and/or mitigate an environmental impact. Environmental commitments to various agencies and the public have been made to secure approval of this project. An agency with permitting authority can delay a project if identified environmental impacts have not been adequately addressed. Unless otherwise designated, the Contractor's primary contact regarding matters associated with these commitments will be the Project Engineer. During construction, the Project Engineer will verify that the Contractor has met Environmental Commitment requirements. These environmental commitments are not subject to change without prior written approval from the SDDOT Environmental Office.

Additional guidance on SDDOT's Environmental Commitments can be accessed through the Environmental Procedures Manual found at: <https://dot.sd.gov/media/documents/EnvironmentalProceduresManual.pdf> >

For questions regarding change orders in the field that may have an effect on an Environmental Commitment, the Project Engineer will contact the Environmental Engineer at 605-773-3180 or 605-773-4336 to determine whether an environmental analysis and/or resource agency coordination is necessary.

Once construction is complete, the Project Engineer will review all environmental commitments for the project and document their completion.

COMMITMENT A: AQUATIC RESOURCES

COMMITMENT A1: WETLANDS

All efforts to avoid and minimize wetland impacts from the project have resulted in approximately 0.91 acres of wetlands (includes temporary and permanent) becoming impacted. Refer to Section B – Grading Plans/plans for location and boundaries of the impacted wetlands.

Table of Impacted Wetlands

Wetland No.	Station	Perm. Impact Left (Acres)	Perm. Impact Right (Acres)	Temp. Impact Left (Acres)	Temp. Impact Right (Acres)	Total Impact (Acres)
1	370+61 L/R	0.012	0.057	0.008	0.018	0.095
2	397+00 R	0.00	0.084	0.00	0.031	0.115
3	426+00 to 437+00 L	0.253	0.000	0.047	0.400	0.700

Action Taken/Required:

SDDOT intends to purchase an anticipated 5.40 Functional Capacity Unit (FCU) credits from an approved provider in the Lower Big Sioux Provider. If no credits are available, SDDOT intends to mitigate permanent wetland impacts through the Ducks Unlimited In-Lieu Fee program.

Temporary impacts identified in the Table of Impacted Wetlands will not be mitigated as original contours and elevations will be re-established as designated in Section B – Grading Plans. Prior to initiating temporary work in wetlands, the Contractor will submit a plan to the Project Engineer in accordance with Section 7.21 D of the Specifications.

COMMITMENT A2: STREAMS

All efforts to avoid and minimize stream impacts from the project have resulted in approximately 0.003 acres of stream (includes temporary and permanent) becoming impacted. Refer to Section B – Grading Plans/plans for location and boundaries of the impacted streams.

Table of Impacted Streams

Stream Name	Station	Perm. Impact Left (Acres)	Perm. Impact Right (Acres)	Temp. Impact Left (Acres)	Temp. Impact Right (Acres)	Total Impact (Acres)
Unnamed Stream	371+00 L/R	0.003	0.00	0.00	0.00	0.00

Action Taken/Required:

It has been determined that project impacts do not require mitigation. Temporary impacts identified in the Table of Impacted Streams will not be mitigated as the finished ground under the bridge will be shaped to match the upstream channel and flood plain and the existing low water channel will be maintained as near as practical to the existing location.

COMMITMENT C: WATER SOURCE

The Contractor will not withdraw water with equipment previously used outside the State of South Dakota or previously used in aquatic invasive species (AIS) positive waters within South Dakota without prior approval from the SDDOT Environmental Office. To prevent and control the introduction and spread of invasive species into the project vicinity, all equipment will be power washed with hot water (≥140 °F) and completely dried for a minimum of 7 days prior to subsequent use. South Dakota administrative rule 41:10:04:02 forbids the possession and transport of AIS; therefore, all attached dirt, mud, debris and vegetation must be removed and all compartments and tanks capable of holding standing water must be drained. This includes, but is not limited to, all equipment, pumps, lines, hoses and holding tanks.

Action Taken/Required:

The Contractor will obtain the necessary permits from the regulatory agencies such as the South Dakota Department of Agriculture and Natural Resources (DANR) and the United States Army Corps of Engineers (USACE) prior to water extraction activities.

Additional information and mapping of water sources impacted by Aquatic Invasive Species in South Dakota can be accessed at:

< <https://sdleastwanted.sd.gov/maps/default.aspx> >

< [South Dakota Administrative Rule 41:10:04 Aquatic Invasive Species: https://sdlegislature.gov/rules/DisplayRule.aspx?Rule=41:10:04](https://sdlegislature.gov/rules/DisplayRule.aspx?Rule=41:10:04) >

COMMITMENT D: WATER QUALITY STANDARDS

COMMITMENT D1: SURFACE WATER QUALITY

This project may be in the vicinity of multiple streams and wetlands. These waters are considered waters of the state and are protected under Administrative Rules of South Dakota (ARSD) Chapter 74:51. Special construction measures may have to be taken to ensure that this water body is not impacted.

Action Taken/Required:

The Contractor is advised that the South Dakota Surface Water Quality Standards, administered by the South Dakota Department of Agriculture and Natural Resources (DANR), apply to this project. Special construction measures will be taken to ensure the above standard(s) of the surface waters are maintained and protected.

COMMITMENT D2: SURFACE WATER DISCHARGE

The DANR General Permit for Temporary Discharge is required for temporary dewatering and discharges to waters of the state. The effluent limit for total suspended solids will be 90 mg/L 30-day average. The effluent limit applies to discharges to all waters of the state except discharges to waters classified as cold water permanent fish life propagation waters according to the ARSD 74:51:01:45. For discharges to waters of the state classified as cold water permanent fish life propagation waters, the effluent limit for total suspended solids will be 53 mg/L daily maximum.

The permittee has the option of completing effluent testing or implementing a pollution prevention plan for compliance with this permit. If the permittee develops a pollution prevention plan instead of total suspended solids sampling, the plan must be developed and implemented prior to discontinuing total suspended solids sampling. Refer to Section 4.0 of the permit. If any pollutants are suspected of being discharged, a sample must be taken for those parameters listed in Section 3.4 of the permit.

Action Taken/Required:

If construction dewatering is required and this project is not required to be covered under a General Permit for Stormwater Discharges Associated with Construction Activities, the Contractor will obtain the General Permit for Temporary Discharge Activities from the DANR Surface Water Program, 605-773-3351.

< https://danr.sd.gov/OfficeOfWater/SurfaceWaterQuality/docs/DANR_TemporaryDischargeNOI2018Fillable.pdf >

If construction dewatering is required and this project is currently covered under a General Permit for Stormwater Discharges Associated with Construction Activities, the contractor will need to submit the dewatering information to the SDDANR using the following form:

< https://danr.sd.gov/OfficeOfWater/SurfaceWaterQuality/docs/DANR_AddTempInfoFillable.pdf >

The Contractor will provide a copy of the approved permit or the submitted dewatering information to the Project Engineer prior to proceeding with any dewatering activities. The approved permit or submitted dewatering information must be kept on-site and as part of the project records.

Effluent monitoring, as a result of dewatering activities, will be summarized for each month and recorded on a separate Discharge Monitoring Report (DMR) and submitted to DANR monthly. Additional information can be found at:

< <https://danr.sd.gov/OfficeOfWater/SurfaceWaterQuality/swdpermitting/Ereporting.aspx> >

ESTIMATE OF QUANTITIES AND ENVIRONMENTAL COMMITMENTS

STATE OF SOUTH DAKOTA	PROJECT	SHEET	TOTAL SHEETS
	NH-CR 0034(193)402	A5	A6

Plotting Date: 10/11/2024

COMMITMENT E: STORM WATER

Construction activities constitute 1 acre or more of earth disturbance and/or work in a waterway.

Action Taken/Required:

The DANR General Permit for Stormwater Discharges Associated with Construction Activities is required for construction activity disturbing one or more acres of earth and work in a waterway. The SDDOT is the owner of this permit and will submit the NOI to DANR 15 days prior to project start in order to obtain coverage under the General Permit. Work can begin once the DANR letter of approval is received.

The Contractor must adhere to the "Special Provision Regarding Storm Water Discharges to Waters of the State."

The Contractor will complete the DANR Contractor Certification Form prior to the pre-construction meeting. The form certifies under penalty of law that the Contractor understands and will comply with the terms and conditions of the permit for this project. Work may not begin on this project until this form is signed and submitted to DANR.

The form can be found at:

<https://danr.sd.gov/OfficeOfWater/SurfaceWaterQuality/docs/DANR_CGPA_ppendixCCA2018Fillable.pdf>

The Contractor is advised that permit coverage may also be required for off-site activities, such as borrow and staging areas, which are the responsibility of the Contractor.

Storm Water Pollution Prevention Plan

The Storm Water Pollution Prevention Plan (SWPPP) will be developed prior to the submittal of the NOI and will be implemented for all construction activities for compliance with the permit. The SWPPP must be kept on-site and updated as site conditions change. Erosion control measures and best management practices will be implemented in accordance with the SWPPP.

The DOT 298 Form will be used for site inspections and to document changes to the SWPPP. A copy of the completed inspection form will be filed with the SWPPP documents and retained for a minimum of three years.

The inspection will include disturbed areas of the construction site that have not been finally stabilized, areas used for storage materials, structural control measures, and locations where vehicles enter or exit the site. These areas will be inspected for evidence of, or the potential for, pollutants entering the drainage system. Erosion and sediment control measures identified in the SWPPP will be observed to ensure that they are operating correctly, and sediment is not tracked off the site.

Information on storm water permits and SWPPPs are available on the following websites:

SDDOT: < <https://dot.sd.gov/doing-business/environmental/stormwater> >

DANR: <<https://danr.sd.gov/OfficeOfWater/SurfaceWaterQuality/stormwater/default.aspx>>

EPA: <<https://www.epa.gov/npdes>>

COMMITMENT G: DEWATERING AND SEDIMENT COLLECTION

The purpose of a dewatering and sediment collection system is to collect turbid stormwater on the project, treat it with flocculants as needed, and capture the sediment that falls out of suspension before the water is discharged into "Waters of the US" or "Waters of the State". Refer to Commitment D1: Surface Water Quality for stream classification.

Action Taken/Required:

The Contractor will meet the terms of the Temporary Discharge Permit and the Storm Water Permit for Construction Activities.

The Contractor will create a Pollution Prevention Plan (PPP) for dewatering and sediment collection if the Contractor chooses to discharge the water into "Waters of the US" or "Waters of the State". Refer to the detail sheet OPTIONS FOR DEWATERING AND SEDIMENT COLLECTION in the plans. The PPP must be kept on-site and updated as site conditions change.

COMMITMENT H: WASTE DISPOSAL SITE

The Contractor will furnish a site(s) for the disposal of construction and/or demolition debris generated by this project.

Action Taken/Required:

Construction and/or demolition debris may not be disposed of within the Public ROW.

The waste disposal site(s) will be managed and reclaimed in accordance with the following from the General Permit for Construction/Demolition Debris Disposal Under the South Dakota Waste Management Program issued by the Department of Agriculture and Natural Resources.

The waste disposal site(s) will not be located in a wetland, within 200 feet of surface water, or in an area that adversely affects wildlife, recreation, aesthetic value of an area, or any threatened or endangered species, as approved by the Environmental Office and the Project Engineer.

If the waste disposal site(s) is located such that it is within view of any ROW, the following additional requirements will apply:

1. Construction and/or demolition debris consisting of concrete, asphalt concrete, or other similar materials will be buried in a trench separate from wood debris. The final cover over the construction and/or demolition debris will consist of a minimum of 1 foot of soil capable of supporting vegetation. Waste disposal sites provided outside of the Public ROW will be seeded in accordance with Natural Resources Conservation Service recommendations. The seeding recommendations may be obtained through the appropriate County NRCS Office. The Contractor will control the access to waste disposal sites not within the Public ROW with fences, gates, and placement of a sign or signs at the entrance to the site stating, "No Dumping Allowed".

2. Concrete and asphalt concrete debris may be stockpiled within view of the ROW for a period not to exceed the duration of the project. Prior to project completion, the waste will be removed from view of the ROW or buried, and the waste disposal site reclaimed as noted above.

The above requirements will not apply to waste disposal sites that are covered by an individual solid waste permit as specified in SDCL 34A-6-58, SDCL 34A-6-1.13, and ARSD 74:27:10:06.

Failure to comply with the requirements stated above may result in civil penalties in accordance with South Dakota Solid Waste Law, SDCL 34A-6-1.31.

All costs associated with furnishing waste disposal site(s), disposing of waste, maintaining control of access (fence, gates, and signs), and reclamation of the waste disposal site(s) will be incidental to the various contract items.

COMMITMENT I: HISTORIC PRESERVATION OFFICE CLEARANCES

The SDDOT has obtained concurrence with the State Historic Preservation Office (SHPO) for all work included within the project limits and all department designated sources and designated option material sources, stockpile sites, storage areas, and waste sites provided within the plans.

Action Taken/Required:

All earth disturbing activities not designated within the plans require a cultural resource review prior to scheduling the pre-construction meeting. This work includes but is not limited to: Contractor furnished material sources, material processing sites, stockpile sites, storage areas, plant sites, and waste areas.

The Contractor will arrange and pay for a record search and when necessary, a cultural resource survey. The Contractor has the option to contact the state Archaeological Research Center (ARC) at 605-394-1936 or another qualified archaeologist, to obtain either a records search or a cultural resources survey. A record search might be sufficient for review if the site was previously surveyed; however, a cultural resources survey may need to be conducted by a qualified archaeologist.

The Contractor will provide ARC with the following: a topographical map or aerial view in which the site is clearly outlined, site dimensions, project number, and PCN. If applicable, provide evidence that the site has been previously disturbed by farming, mining, or construction activities with a landowner statement that artifacts have not been found on the site.

The Contractor will submit the cultural resources survey report to SDDOT Environmental Office, 700 East Broadway Avenue, Pierre, SD 57501-2586. SDDOT will submit the information to the appropriate SHPO/THPO. Allow **30 Days** from the date this information is submitted to the Environmental Engineer for SHPO/THPO review.

In the event of an inadvertent discovery of human remains, funerary objects, or if evidence of cultural resources is identified during project construction activities, then such activities within 150 feet of the inadvertent discovery will immediately cease and the Project Engineer will be immediately notified. The Project Engineer will contact the SDDOT Environmental Office, who will contact the appropriate SHPO/THPO within 48 hours of the discovery to determine an appropriate course of action.

SHPO review does not relieve the Contractor of the responsibility for obtaining any additional permits and clearances for Contractor furnished material sources, material processing sites, stockpile sites, storage areas, plant sites, and waste areas that affect wetlands, threatened and endangered species, or waterways. The Contractor will not utilize a site known or suspected of having contaminated soil or water. The Contractor will provide the required permits and clearances to the Project Engineer at the preconstruction meeting.

ESTIMATE OF QUANTITIES AND ENVIRONMENTAL COMMITMENTS

STATE OF SOUTH DAKOTA	PROJECT	SHEET	TOTAL SHEETS
	NH-CR 0034(193)402	A6	A6

Plotting Date: 10/11/2024

COMMITMENT L: CONTAMINATED MATERIAL

Contaminated soil and/or known gas stations, undergrounds storage tanks, etc. are located within the project limits. Petroleum contaminated soil is located at the following sites:

Description	Station	L / R
T&R Electric Supply Company, LLC	375+50 – 394+00	L
34 Stop Gas Station	410+50	L

Action Taken/Required:

The Contractor will give notice to the Engineer when contaminated soil is encountered on the project. The Engineer will contact the Environmental Office so that contact with the DANR and consultant to inspect and monitor removal of any contaminated soil can be initiated.

The Contractor will be responsible for having the existing underground utilities located in the construction area. Underground utilities damaged by the Contractor due to negligence will be repaired at the Contractor's expense.

Petroleum contaminated soil may be disposed of at the City of Brookings Regional Landfill (phone 605-693-3667). Measurement of "Contaminated Material Excavation" will be in accordance with Section 120.4 of the Specifications. All costs for excavating and transporting the contaminated materials to the disposal site and all fees charged per cubic yard by the disposal site will be incidental to the contract unit price per cubic yard for "Contaminated Material Excavation".

The estimated quantity of "Contaminated Material Excavation" is 100 cubic yards. The quantity of "Contaminated Material Excavation" may vary from the plans. No adjustment will be made to the contract unit price for variations in the quantity of "Contaminated Material Excavation". The estimated quantity of "Contaminated Material Excavation" is provided in Section B – Grading Plans.

COMMITMENT M: SECTION 4(f)/6(f) RESOURCES

COMMITMENT M1: SECTION 4(f) PROPERTY

A Section 4(f) Evaluation concluded there are no feasible and prudent alternatives to avoiding the City of Colman Parks and Recreation Land and its associated attributes and features located within the project.

Station	Section 4(f) Property
409+00 – 415+00 R	Colman Parks and Recreation Land (Baseball Diamond)
415+00 – 420+00 R	Colman Parks and Recreation Land (RV Park)
419+30 – 420+00 L	Colman Parks and Recreation Land (Veterans Memorial Park)

Action Taken/Required:

The following measures are required to minimize harm to the above Section 4(f) property:

- Access to Colman Parks and Recreation Land shall always be maintained during construction activities.
 - Access to the City of Colman RV Park will be required at all times.
 - Access to either Allen Street or 470th Avenue will be required at all times to allow access to the City Park and Golf Course.
- The staging and/or storage of construction equipment or materials shall not take place outside proposed construction limits that are within the defined boundaries of the 4(f) property.
- The Contractor shall be required to closely coordinate the construction schedule of work adjacent to the Colman Park and Recreational Land with SDDOT Project Engineer, to coordinate with SDDOT Environmental Office and the City of Colman Mayor prior to the start of construction activities.

The Contractor is not permitted to stage equipment or materials within the City of Colman Parks and Recreation Land. The Contractor will notify the Project Engineer if additional easement is needed to complete the work adjacent to any City of Colman Parks and Recreation Land. The Project Engineer will obtain an appropriate course of action from the Environmental Office before proceeding with construction activities that affect any City of Colman Parks and Recreation Land.

COMMITMENT M2: SECTION 6(f) PROPERTY

National Park Service concurrence has been obtained for project impacts to the following resource(s) acquired and developed through a Land and Water Conservation Fund grant.

Station	Section 6(f) Property
415+50 – 420+00 R	City of Colman Parks and Recreation Land (Colman RV Park)

Action Taken/Required:

The following actions are required to ensure 6(f) replacement lands of equal value and usefulness are achieved:

- There will be a Special Provision for Construction Time included in the plans which will limit the duration of occupancy of the City of Colman Parks and Recreation Land (Colman RV Park), south of SD34 between S. Allen St. and 470th Ave to less than 180 days.

The Contractor is not permitted to stage equipment or materials within any Section 6(f) property. The Contractor will notify the Project Engineer if additional easement is needed to complete the work adjacent to any Section 6(f) property. The Project Engineer will obtain an appropriate course of action from the Environmental Office before proceeding with construction activities that affect any Section 6(f) property.

COMMITMENT N: SECTION 404 PERMIT

The SDDOT has obtained a Section 404 Permit from the USACE for the permanent actions associated with this project.

Action Taken/Required:

The Contractor will comply with all requirements contained in the Section 404 Permit.

The Contractor will also be responsible for obtaining a Section 404 Permit for any dredge, excavation, or fill activities associated with material sources, storage areas, waste sites, and Contractor work sites outside the plan work limits that affect wetlands, floodplains, or waters of the United States.