

STATE OF SOUTH DAKOTA
 DEPARTMENT OF TRANSPORTATION
 PLANS FOR PROPOSED

FOR BIDDING PURPOSES ONLY

STATE OF SOUTH DAKOTA	PROJECT	SHEET	TOTAL SHEETS
	P 0047(117)67	1	179
	P 0248(13)261		

REV 12-4-24 JT

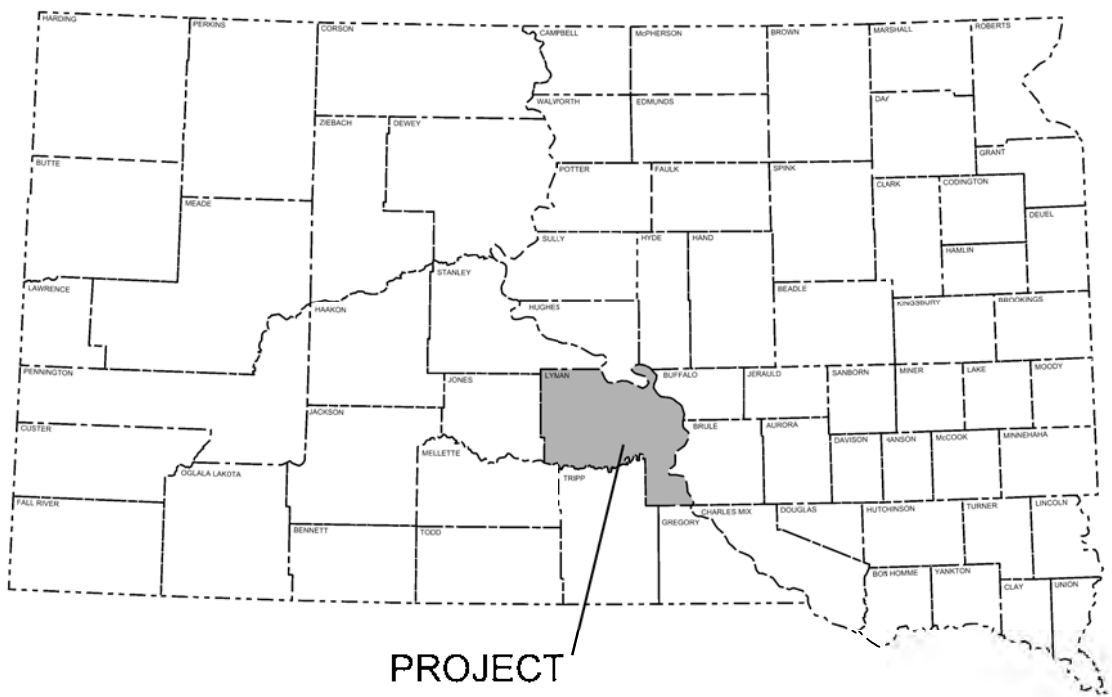

PROJECTS P 0047(117)67 & P 0248(13)261
 SD HIGHWAYS 47 & 248
 LYMAN COUNTY

COLD MILLING ASPHALT CONCRETE,
 ASPHALT CONCRETE RESURFACING,
 RUMBLE STRIPS & PIPE WORK

PCN 069Q & 06YC

INDEX OF SECTIONS

- Section A: Estimate of Quantities and Environmental Commitments
- Section B: Grading Plans
- Section C: Traffic Control Plans
- Section D: Erosion Control Plans
- Section F: Surfacing Plans
- Section M: Pavement Marking Plans
- Section X: Cross Sections
- Section Z: Pipe Sections

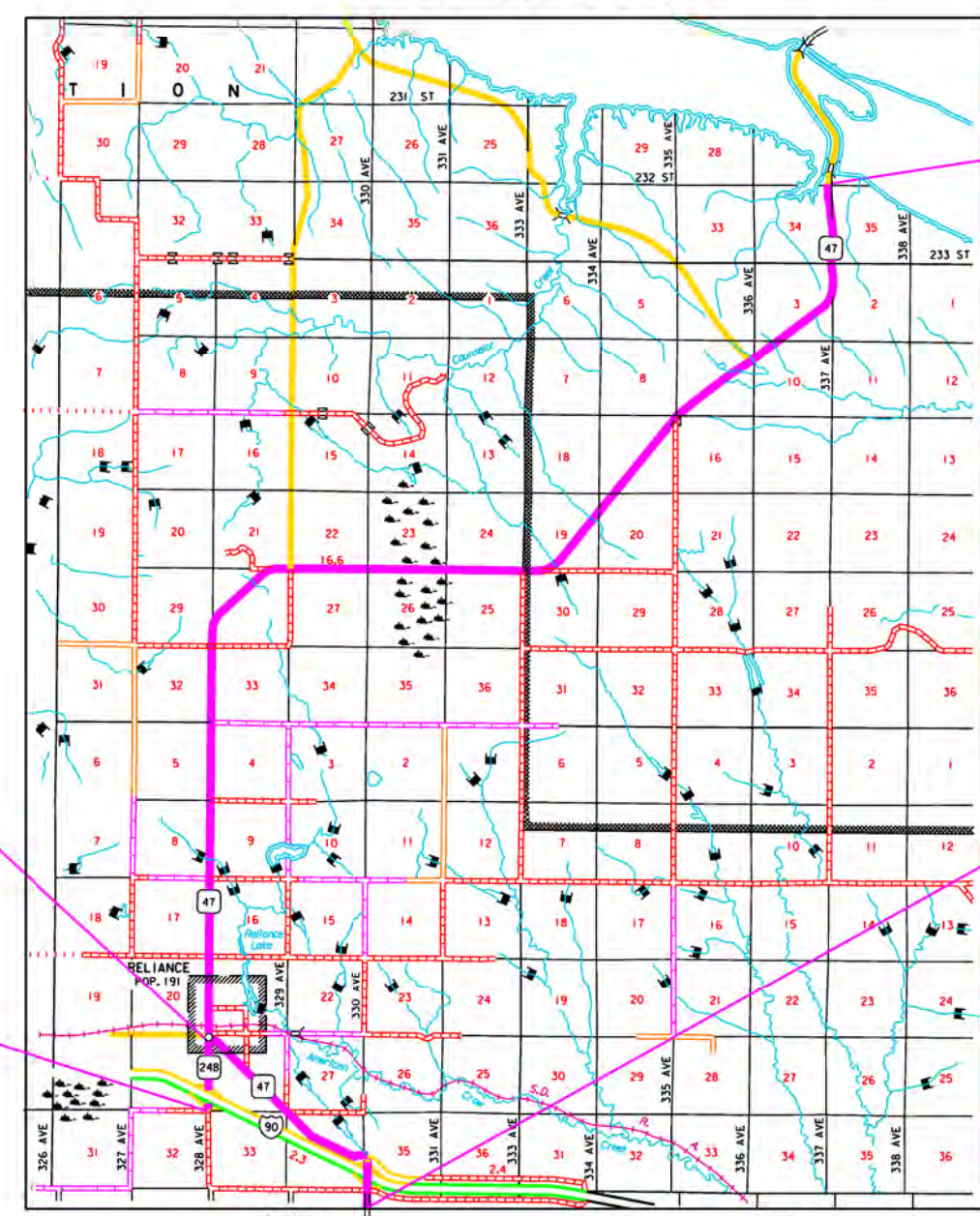

BEGIN P 0047(117)67
 Station -2+50.00
 MRM 87.00 + 0.346

BEGIN P 0248(13)261
 Station 0+00.00
 MRM 261.77

END P 0047(117)67
 Station 1024+81.32
 MRM 67.00 + 0.602

END P 0248(13)261
 Station 43+82.00
 MRM 262.57



DESIGN DESIGNATION (SD47)

AADT (2023)	525
AADT (2043)	742
DHV	118
D	50%
DHV T%	8.7%
AADT T%	19.2%
V	45, 55, & 65 mph

DESIGN DESIGNATION (SD248)

AADT (2023)	843
AADT (2043)	1191
DHV	130
D	50%
DHV T%	5.6%
AADT T%	12.7%
V	65 mph

STORM WATER PERMIT

Major Receiving
 Body of Water: Lakes Sharpe and Francis Case of the Missouri River
 Area Disturbed: 20.1 Acres
 Total Project Area: 122 Acres
 Approx. Begin Lat,Long: 44.030, -99.446



	SD 47		SD 248	
Gross Length	102,300 Feet	19.375 Miles	4382 Feet	0.820 Miles
Length of Exceptions	0.00 Feet	0.000 Miles	0.00 Feet	0.000 Miles
Net Length	102,300 Feet	19.375 Miles	4382 Feet	0.820 Miles

8

January 22, 2025

ESTIMATE OF QUANTITIES AND ENVIRONMENTAL COMMITMENTS

FOR BIDDING PURPOSES ONLY

STATE OF SOUTH DAKOTA	PROJECT P 0047(117)87 P 0248(13)261	SHEET A1	TOTAL SHEETS A5
-----------------------------	---	-------------	-----------------------

REV 12-4-24 JT

SD 47 PCN 069Q

Section B - Grading

BID ITEM NUMBER	ITEM	QUANTITY	UNIT
009E0010	Mobilization	Lump Sum	LS
009E3230	Grade Staking	21.848	Mile
009E3240	Graded Centerline Staking	19.381	Mile
009E3250	Miscellaneous Staking	19.381	Mile
009E3280	Slope Staking	0.057	Mile
009E3301	Engineer Directed Surveying/Staking	40.0	Hour
009E4100	Construction Schedule, Category I	Lump Sum	LS
110E0500	Remove Pipe Culvert	502	Ft
110E0510	Remove Pipe End Section	14	Each
110E0595	Remove Cattle Pass End Section	10	Each
110E0600	Remove Fence	1,510	Ft
110E7500	Remove Pipe for Reset	278	Ft
110E7510	Remove Pipe End Section for Reset	49	Each
110E7530	Remove Cattle Pass for Reset	8	Ft
110E7540	Remove Cattle Pass End Section for Reset	2	Each
120E0010	Unclassified Excavation	13,365	CuYd
120E0600	Contractor Furnished Borrow Excavation	5,879	CuYd
120E2000	Undercutting	2,800	CuYd
120E4100	Reprofiling Ditch	14.0	Sta
120E6100	Water for Embankment	143.0	MGal
230E0010	Placing Topsoil	10,742	CuYd
260E1010	Base Course	272.1	Ton
421E0100	Pipe Culvert Undercut	84	CuYd
450E0142	24" RCP Class 2, Furnish	146	Ft
450E0150	24" RCP, Install	146	Ft
450E0162	30" RCP Class 2, Furnish	78	Ft
450E0170	30" RCP, Install	78	Ft
450E0182	36" RCP Class 2, Furnish	200	Ft
450E0190	36" RCP, Install	200	Ft
450E0202	48" RCP Class 2, Furnish	78	Ft
450E0210	48" RCP, Install	78	Ft
450E2016	24" RCP Flared End, Furnish	2	Each
450E2017	24" RCP Flared End, Install	2	Each
450E2024	30" RCP Flared End, Furnish	2	Each
450E2025	30" RCP Flared End, Install	2	Each
450E2028	36" RCP Flared End, Furnish	7	Each
450E2029	36" RCP Flared End, Install	7	Each
450E2036	48" RCP Flared End, Furnish	2	Each
450E2037	48" RCP Flared End, Install	2	Each
450E2200	24" RCP Sloped End, Furnish	1	Each
450E2201	24" RCP Sloped End, Install	1	Each
450E4768	24" CMP 14 Gauge, Furnish	204	Ft
450E4770	24" CMP, Install	204	Ft

BID ITEM NUMBER	ITEM	QUANTITY	UNIT
450E5015	24" CMP Elbow, Furnish	2	Each
450E5016	24" CMP Elbow, Install	2	Each
450E5215	24" CMP Flared End, Furnish	1	Each
450E5216	24" CMP Flared End, Install	1	Each
450E7624	24" Steel Pipe, Furnish	352	Ft
450E8014	24" RCP to CMP Transition, Furnish	1	Each
450E8015	24" Pipe Transition, Install	1	Each
* 450E8900	Cleanout Pipe Culvert	2	Each
450E9000	Reset Pipe	278	Ft
450E9001	Reset Pipe End Section	49	Each
451E5124	Bore and Jack 24" Pipe	352	Ft
462E0250	Cellular Grout	334.0	CuYd
560E5100	Reset Reinforced Concrete Cattle Pass	8.0	Ft
560E5101	Reset Reinforced Concrete Cattle Pass End Section	2	Each
620E0020	Type 2 Right-of-Way Fence	1,510	Ft
620E0520	Type 2 Temporary Fence	2,716	Ft
620E1020	2 Post Panel	16	Each
720E1010	PVC Coated Bank and Channel Protection Gabion	9.0	CuYd
831E0110	Type B Drainage Fabric	30	SqYd
998E0100	Railroad Protective Insurance	Lump Sum	LS

* - Denotes Non-Participating

Section C – Traffic Control

BID ITEM NUMBER	ITEM	QUANTITY	UNIT
110E5010	Salvage Delineator	434	Each
260E3500	Temporary Gravel Surfacing	179.0	Ton
632E2022	4"x4" White Delineator Back to Back with 1.12 Lb/Ft Post	434	Each
634E0010	Flagging	1,100.0	Hour
634E0020	Pilot Car	450.0	Hour
634E0110	Traffic Control Signs	759.2	SqFt
634E0120	Traffic Control, Miscellaneous	Lump Sum	LS
634E0630	Temporary Pavement Marking	77.5	Mile
634E1215	Contractor Furnished Portable Changeable Message Sign	2	Each

Section D – Erosion and Sediment Control

BID ITEM NUMBER	ITEM	QUANTITY	UNIT
110E1690	Remove Sediment	3.0	CuYd
110E1700	Remove Silt Fence	1,740	Ft
730E0212	Type G Permanent Seed Mixture	500	Lb
731E0200	Fertilizing	14.40	Ton
732E0100	Mulching	48.4	Ton
734E0103	Type 3 Erosion Control Blanket	2,500	SqYd
734E0154	12" Diameter Erosion Control Wattle	1,220	Ft
734E0604	High Flow Silt Fence	1,740	Ft
734E0610	Mucking Silt Fence	121	CuYd
734E0620	Repair Silt Fence	435	Ft

Section F – Surfacing

BID ITEM NUMBER	ITEM	QUANTITY	UNIT
009E3320	Checker	Lump Sum	LS
110E1010	Remove Asphalt Concrete Pavement	2,412.0	SqYd
120E0100	Unclassified Excavation, Dugouts	969	CuYd
120E6200	Water for Granular Material	504.5	MGal
210E0100	Shoulder Clearing	38.8	Mile
260E1010	Base Course	2,893.0	Ton
260E1030	Base Course, Salvaged	1,305.0	Ton
260E6000	Granular Material, Furnish	9,269.0	Ton
* 270E0200	Blend, Haul, and Stockpile Granular Material	18,538.0	Ton
280E0020	Full Depth Reclamation, Shoulder	77,369	SqYd
320E1200	Asphalt Concrete Composite	851.5	Ton
320E1800	Asphalt Concrete Blade Laid	3,142.0	Ton
320E7008	Grind 8" Rumble Strip or Stripe in Asphalt Concrete	38.8	Mile
320E7028	Grind Centerline Rumble Stripe in Asphalt Concrete	19.4	Mile
320E7040	Grind 6" Transverse Rumble Strip in Asphalt Concrete	98.0	Ft
330E0010	MC-70 Asphalt for Prime	151.1	Ton
330E0100	SS-1h or CSS-1h Asphalt for Tack	305.9	Ton
330E0210	SS-1h or CSS-1h Asphalt for Flush Seal	102.8	Ton
330E1000	Blotting Sand for Prime	5.0	Ton
330E2000	Sand for Flush Seal	1,085.6	Ton
332E0010	Cold Milling Asphalt Concrete	383,441	SqYd
600E0300	Type III Field Laboratory	1	Each
900E1980	Storage Unit	1	Each

* - Denotes Non-Participating



ESTIMATE OF QUANTITIES AND ENVIRONMENTAL COMMITMENTS

FOR BIDDING PURPOSES ONLY

STATE OF SOUTH DAKOTA	PROJECT P 0047(117)87 P 0248(13)261	SHEET A2	TOTAL SHEETS A5
-----------------------------	---	-------------	-----------------------

REV 12-4-24 JT

Section F – Surfacing (Continued)

Alternate A

BID ITEM NUMBER	ITEM	QUANTITY	UNIT
320E0005	PG 58-34 Asphalt Binder	2,843.1	Ton
320E1202	Class Q2R Hot Mixed Asphalt Concrete	61,763.4	Ton
320E4000	Hydrated Lime	614.5	Ton

Alternate B

BID ITEM NUMBER	ITEM	QUANTITY	UNIT
320E0005	PG 58-34 Asphalt Binder	2,344.0	Ton
320E1202	Class Q2R Hot Mixed Asphalt Concrete	63,328.9	Ton
320E4000	Hydrated Lime	634.5	Ton

Section M – Pavement Marking

BID ITEM NUMBER	ITEM	QUANTITY	UNIT
633E1200	High Build Waterborne Pavement Marking Paint, White	877	Gal
633E1205	High Build Waterborne Pavement Marking Paint, Yellow	150	Gal
633E1262	High Build Waterborne Pavement Marking Paint, 24" Yellow	241	Ft
633E1272	High Build Waterborne Pavement Marking Paint, Arrow	5	Each
633E1290	High Build Waterborne Pavement Marking Paint, Railroad Crossing	2	Each

SD 248 PCN 06YC

Section B – Grading

BID ITEM NUMBER	ITEM	QUANTITY	UNIT
009E0010	Mobilization	Lump Sum	LS
009E3230	Grade Staking	0.819	Mile
009E3240	Graded Centerline Staking	0.819	Mile
009E3250	Miscellaneous Staking	0.819	Mile
009E3301	Engineer Directed Surveying/Staking	5.0	Hour
009E4100	Construction Schedule, Category I	Lump Sum	LS
110E0500	Remove Pipe Culvert	164	Ft
110E0510	Remove Pipe End Section	4	Each
120E0010	Unclassified Excavation	444	CuYd
230E0010	Placing Topsoil	444	CuYd
260E1010	Base Course	64.6	Ton
421E0100	Pipe Culvert Undercut	34	CuYd
450E0142	24" RCP Class 2, Furnish	142	Ft
450E0150	24" RCP, Install	142	Ft
450E2016	24" RCP Flared End, Furnish	4	Each
450E2017	24" RCP Flared End, Install	4	Each

Section C – Traffic Control

BID ITEM NUMBER	ITEM	QUANTITY	UNIT
110E0135	Remove Delineator	16	Each
260E3500	Temporary Gravel Surfacing	51.0	Ton
632E2022	4"x4" White Delineator Back to Back with 1.12 Lb/Ft Post	16	Each
634E0010	Flagging	120.0	Hour
634E0020	Pilot Car	24.0	Hour
634E0110	Traffic Control Signs	403.2	SqFt
634E0120	Traffic Control, Miscellaneous	Lump Sum	LS
634E0630	Temporary Pavement Marking	3.3	Mile

Section D – Erosion Control

BID ITEM NUMBER	ITEM	QUANTITY	UNIT
730E0212	Type G Permanent Seed Mixture	22	Lb
731E0200	Fertilizing	0.64	Ton
732E0100	Mulching	1.7	Ton
734E0103	Type 3 Erosion Control Blanket	320	SqYd
734E0154	12" Diameter Erosion Control Wattle	320	Ft

Section F – Surfacing

BID ITEM NUMBER	ITEM	QUANTITY	UNIT
009E3320	Checker	Lump Sum	LS
110E1010	Remove Asphalt Concrete Pavement	328.0	SqYd
120E0100	Unclassified Excavation, Digouts	41	CuYd
120E6200	Water for Granular Material	2.8	MGal
210E0100	Shoulder Clearing	1.6	Mile
260E1010	Base Course	346.0	Ton
260E1030	Base Course, Salvaged	30.0	Ton
320E1200	Asphalt Concrete Composite	124.5	Ton
320E1800	Asphalt Concrete Blade Laid	122.9	Ton
330E0100	SS-1h or CSS-1h Asphalt for Tack	19.2	Ton
330E0210	SS-1h or CSS-1h Asphalt for Flush Seal	4.3	Ton
330E2000	Sand for Flush Seal	42.3	Ton
332E0010	Cold Milling Asphalt Concrete	18,590	SqYd

Alternate A

BID ITEM NUMBER	ITEM	QUANTITY	UNIT
320E0005	PG 58-34 Asphalt Binder	104.5	Ton
320E1202	Class Q2R Hot Mixed Asphalt Concrete	2,275.9	Ton
320E4000	Hydrated Lime	22.8	Ton

Alternate B

BID ITEM NUMBER	ITEM	QUANTITY	UNIT
320E0005	PG 58-34 Asphalt Binder	86.4	Ton
320E1202	Class Q2R Hot Mixed Asphalt Concrete	2,333.5	Ton
320E4000	Hydrated Lime	23.3	Ton

Section M – Pavement Marking

BID ITEM NUMBER	ITEM	QUANTITY	UNIT
633E1200	High Build Waterborne Pavement Marking Paint, White	37	Gal
633E1205	High Build Waterborne Pavement Marking Paint, Yellow	6	Gal

SPECIFICATIONS

Standard Specifications for Roads and Bridges, 2015 Edition and Required Provisions, Supplemental Specifications, and Special Provisions as included in the Proposal.



ENVIRONMENTAL COMMITMENTS

The SDDOT is committed to protecting the environment and uses Environmental Commitments as a communication tool for the Engineer and Contractor to ensure that attention is given to avoid, minimize, and/or mitigate an environmental impact. Environmental commitments to various agencies and the public have been made to secure approval of this project. An agency with permitting authority can delay a project if identified environmental impacts have not been adequately addressed. Unless otherwise designated, the Contractor's primary contact regarding matters associated with these commitments will be the Project Engineer. During construction, the Project Engineer will verify that the Contractor has met Environmental Commitment requirements. These environmental commitments are not subject to change without prior written approval from the SDDOT Environmental Office.

Additional guidance on SDDOT's Environmental Commitments can be accessed through the Environmental Procedures Manual found at: <<https://dot.sd.gov/media/documents/EnvironmentalProceduresManual.pdf>>

For questions regarding change orders in the field that may have an effect on an Environmental Commitment, the Project Engineer will contact the Environmental Engineer at 605-773-3180 or 605-773-4336 to determine whether an environmental analysis and/or resource agency coordination is necessary.

Once construction is complete, the Project Engineer will review all environmental commitments for the project and document their completion.

COMMITMENT A: AQUATIC RESOURCES

COMMITMENT A1: WETLANDS

All efforts to avoid and minimize wetland impacts from the project have resulted in approximately 1.20 acres of wetlands (includes temporary and permanent) becoming impacted. Refer to Section B – Grading Plans for location and boundaries of the impacted wetlands.

Table of Impacted Wetlands

Wetland No.	Station	Perm. Impact Left (Acres)	Perm. Impact Right (Acres)	Temp. Impact Left (Acres)	Temp. Impact Right (Acres)	Total Impact (Acres)
069Q - WL 1	113+58	0.001	0.005	0.024	0.001	0.031
069Q - WL 2	126+67	0.000	0.000	0.090	0.000	0.090
069Q - WL 3	193+92	0.000	0.000	0.004	0.000	0.004
069Q - WL 4	211+57	0.035	0.028	0.016	0.079	0.158
069Q - WL 5	255+15	0.000	0.000	0.005	0.000	0.005
069Q - WL 6	273+15	0.000	0.000	0.000	0.001	0.001

069Q - WL 7	279+16	0.000	0.000	0.000	0.580	0.580
069Q - WL 8	323+65	0.000	0.000	0.008	0.009	0.017
069Q - WL 9	347+64	0.000	0.000	0.004	0.000	0.004
069Q - WL 10	368+97	0.000	0.000	0.013	0.019	0.032
069Q - WL 11	406+12	0.000	0.000	0.015	0.000	0.015
069Q - WL 12	424+11	0.000	0.000	0.011	0.012	0.023
069Q - WL 13	443+11	0.000	0.000	0.000	0.026	0.026
069Q - WL 14	489+78	0.000	0.000	0.008	0.009	0.017
069Q - WL 15	558+08	0.000	0.000	0.010	0.008	0.018
069Q - WL 16	564+08	0.000	0.000	0.010	0.007	0.017
069Q - WL 17	595+07	0.000	0.000	0.000	0.014	0.014
069Q - WL 18	664+50	0.000	0.000	0.009	0.014	0.023
069Q - WL 19	699+31	0.000	0.010	0.000	0.008	0.018
069Q - WL 20	740+87	0.000	0.010	0.006	0.016	0.032
069Q - WL 21	752+51	0.000	0.000	0.000	0.005	0.005

Action Taken/Required:

Mitigation is required in accordance with the "Statewide Finding Regarding Wetlands for South Dakota Federal-Aid Highway Projects (February 2018)". Replacement of 0.07 acres of permanent wetland impacts will be completed through another wetland mitigation opportunity in a manner which considers FHWA's program-wide goal of 'net gain' of wetlands through enhancement, creation, and preservation.

Temporary impacts identified in the Table of Impacted Wetlands will not be mitigated as original contours and elevations will be re-established as designated in Section B – Grading Plans. Prior to initiating temporary work in wetlands, the Contractor will submit a plan to the Project Engineer in accordance with Section 7.21 D of the Specifications.

The Contractor will notify the Project Engineer if additional easement is needed to complete work adjacent to any wetland. The Project Engineer will obtain an appropriate course of action from the Environmental Office before

proceeding with construction activities that affect any wetlands beyond the work limits and easements shown in the plans.

The Contractor will notify the Project Engineer if additional easement is needed to complete work adjacent to any wetland. The Project Engineer will obtain an appropriate course of action from the Environmental Office before proceeding with construction activities that affect any wetlands beyond the work limits and easements shown in the plans.

COMMITMENT B: FEDERALLY THREATENED, ENDANGERED, AND PROTECTED SPECIES

COMMITMENT B2: WHOOPING CRANE

The Whooping Crane is a spring and fall migratory bird in South Dakota that is about 5 feet tall and typically stops on wetlands, rivers, and agricultural lands along their migration route. An adult Whooping Crane is white with a red crown and a long, dark, pointed bill. Immature Whooping Cranes are cinnamon brown. While in flight, their long necks are kept straight and their long dark legs trail behind. Adult Whooping Cranes' black wing tips are visible during flight.

Action Taken/Required:

Harassment or other measures to cause the Whooping Crane to leave the site is a violation of the Endangered Species Act. If a Whooping Crane is sighted roosting in the vicinity of the project, borrow pits, or staging areas associated with the project, cease construction activities in the affected area until the Whooping Crane departs and immediately contact the Project Engineer. The Project Engineer will contact the Environmental Office so that the sighting can be reported to USFWS.

COMMITMENT C: WATER SOURCE

The Contractor will not withdraw water with equipment previously used outside the State of South Dakota or previously used in aquatic invasive species (AIS) positive waters within South Dakota without prior approval from the SDDOT Environmental Office. To prevent and control the introduction and spread of invasive species into the project vicinity, all equipment will be power washed with hot water (≥140 °F) and completely dried for a minimum of 7 days prior to subsequent use. South Dakota administrative rule 41:10:04:02 forbids the possession and transport of AIS; therefore, all attached dirt, mud, debris and vegetation must be removed and all compartments and tanks capable of holding standing water must be drained. This includes, but is not limited to, all equipment, pumps, lines, hoses and holding tanks.

Action Taken/Required:

The Contractor will obtain the necessary permits from the regulatory agencies such as the South Dakota Department of Agriculture and Natural Resources (DANR) and the United States Army Corps of Engineers (USACE) prior to water extraction activities.

Additional information and mapping of water sources impacted by Aquatic Invasive Species in South Dakota can be accessed at:



COMMITMENT C: WATER SOURCE, continued

Additional information and mapping of water sources impacted by Aquatic Invasive Species in South Dakota can be accessed at:
< <https://sdeastwanted.sd.gov/maps/default.aspx> >

< [South Dakota Administrative Rule 41:10:04 Aquatic Invasive Species: https://sdlegislature.gov/rules/DisplayRule.aspx?Rule=41:10:04](https://sdlegislature.gov/rules/DisplayRule.aspx?Rule=41:10:04) >

COMMITMENT D: WATER QUALITY STANDARDS**COMMITMENT D1: SURFACE WATER QUALITY**

Reliance Lake is classified as a warm water permanent fishery with a total suspended solids standard of less than 90 mg/L 30-day average, less than 158 mg/L daily maximum.

The Missouri River is classified as a cold water permanent fishery with a total suspended solids standard of less than 30 mg/L 30-day average, less than 53 mg/L daily maximum.

Reliance Lake and the Missouri River is classified as fish and wildlife propagation, recreation, irrigation, and stock watering waters. Because of these beneficial uses, special construction measures may have to be taken to ensure that this water body is not impacted.

This project may be in the vicinity of multiple streams and wetlands. These waters are considered waters of the state and are protected under Administrative Rules of South Dakota (ARSD) Chapter 74:51. Special construction measures may have to be taken to ensure that this water body is not impacted.

Action Taken/Required:

The Contractor is advised that the South Dakota Surface Water Quality Standards, administered by the South Dakota Department of Agriculture and Natural Resources (DANR), apply to this project. Special construction measures will be taken to ensure the above standard(s) of the surface waters are maintained and protected.

COMMITMENT D2: SURFACE WATER DISCHARGE

The DANR General Permit for Temporary Discharge is required for temporary dewatering and discharges to waters of the state. The effluent limit for total suspended solids will be 90 mg/L 30-day average. The effluent limit applies to discharges to all waters of the state except discharges to waters classified as cold water permanent fish life propagation waters according to the ARSD 74:51:01:45. For discharges to waters of the state classified as cold water permanent fish life propagation waters, the effluent limit for total suspended solids will be 53 mg/L daily maximum.

The permittee has the option of completing effluent testing or implementing a pollution prevention plan for compliance with this permit. If the permittee develops a pollution prevention plan instead of total suspended solids sampling, the plan must be developed and implemented prior to discontinuing total suspended solids sampling. Refer to Section 4.0 of the permit. If any pollutants are suspected of being discharged, a sample must be taken for those parameters listed in Section 3.4 of the permit.

Refer to Commitment D1: Surface Water Quality for stream classification.

Action Taken/Required:

If construction dewatering is required and this project is currently covered under a General Permit for Stormwater Discharges Associated with Construction Activities, the contractor will need to submit the dewatering information to the SDDANR using the following form:

<
https://danr.sd.gov/OfficeOfWater/SurfaceWaterQuality/docs/DANR_AddTemplInfoFillable.pdf >

The Contractor will provide a copy of the approved permit or the submitted dewatering information to the Project Engineer prior to proceeding with any dewatering activities. The approved permit or submitted dewatering information must be kept on-site and as part of the project records.

Effluent monitoring, as a result of dewatering activities, will be summarized for each month and recorded on a separate Discharge Monitoring Report (DMR) and submitted to DANR monthly. Additional information can be found at:

<
<https://danr.sd.gov/OfficeOfWater/SurfaceWaterQuality/swdpermitting/Ereporting.aspx> >

COMMITMENT E: STORM WATER

Construction activities constitute 1 acre or more of earth disturbance and/or work in a waterway.

Action Taken/Required:

The DANR General Permit for Stormwater Discharges Associated with Construction Activities is required for construction activity disturbing one or more acres of earth and work in a waterway. The SDDOT is the owner of this permit and will submit the NOI to DANR 15 days prior to project start in order to obtain coverage under the General Permit. Work can begin once the DANR letter of approval is received.

The Contractor must adhere to the "Special Provision Regarding Storm Water Discharges to Waters of the State."

The Contractor will complete the DANR Contractor Certification Form prior to the pre-construction meeting. The form certifies under penalty of law that the Contractor understands and will comply with the terms and conditions of the permit for this project. Work may not begin on this project until this form is signed and submitted to DANR.

The form can be found at:

<
https://danr.sd.gov/OfficeOfWater/SurfaceWaterQuality/docs/DANR_CGPapendixCCA2018Fillable.pdf >

The Contractor is advised that permit coverage may also be required for off-site activities, such as borrow and staging areas, which are the responsibility of the Contractor.

Storm Water Pollution Prevention Plan

The Storm Water Pollution Prevention Plan (SWPPP) will be developed prior to the submittal of the NOI and will be implemented for all construction activities for compliance with the permit. The SWPPP must be kept on-site and updated as site conditions change. Erosion control measures and best management practices will be implemented in accordance with the SWPPP.

The DOT 298 Form will be used for site inspections and to document changes to the SWPPP. A copy of the completed inspection form will be filed with the SWPPP documents and retained for a minimum of three years.

The inspection will include disturbed areas of the construction site that have not been finally stabilized, areas used for storage materials, structural control measures, and locations where vehicles enter or exit the site. These areas will be inspected for evidence of, or the potential for, pollutants entering the drainage system. Erosion and sediment control measures identified in the SWPPP will be observed to ensure that they are operating correctly, and sediment is not tracked off the site.

Information on storm water permits and SWPPPs are available on the following websites:

SDDOT: < <https://dot.sd.gov/doing-business/environmental/stormwater> >

DANR:<
<https://danr.sd.gov/OfficeOfWater/SurfaceWaterQuality/stormwater/default.aspx> >

EPA: < <https://www.epa.gov/npdes> >

COMMITMENT H: WASTE DISPOSAL SITE

The Contractor will furnish a site(s) for the disposal of construction and/or demolition debris generated by this project.

Action Taken/Required:

Construction and/or demolition debris may not be disposed of within the Public ROW.

The waste disposal site(s) will be managed and reclaimed in accordance with the following from the General Permit for Construction/Demolition Debris Disposal Under the South Dakota Waste Management Program issued by the Department of Agriculture and Natural Resources.

The waste disposal site(s) will not be located in a wetland, within 200 feet of surface water, or in an area that adversely affects wildlife, recreation, aesthetic value of an area, or any threatened or endangered species, as approved by the Environmental Office and the Project Engineer.

If the waste disposal site(s) is located such that it is within view of any ROW, the following additional requirements will apply:



STATE OF SOUTH DAKOTA	PROJECT	SHEET	TOTAL SHEETS
	P 0047(117)67	A5	A5
	P 0248(13)261		

COMMITMENT H: WASTE DISPOSAL SITE, continued

1. Construction and/or demolition debris consisting of concrete, asphalt concrete, or other similar materials will be buried in a trench separate from wood debris. The final cover over the construction and/or demolition debris will consist of a minimum of 1 foot of soil capable of supporting vegetation. Waste disposal sites provided outside of the Public ROW will be seeded in accordance with Natural Resources Conservation Service recommendations. The seeding recommendations may be obtained through the appropriate County NRCS Office. The Contractor will control the access to waste disposal sites not within the Public ROW with fences, gates, and placement of a sign or signs at the entrance to the site stating, "No Dumping Allowed".

2. Concrete and asphalt concrete debris may be stockpiled within view of the ROW for a period not to exceed the duration of the project. Prior to project completion, the waste will be removed from view of the ROW or buried, and the waste disposal site reclaimed as noted above.

The above requirements will not apply to waste disposal sites that are covered by an individual solid waste permit as specified in SDCL 34A-6-58, SDCL 34A-6-1.13, and ARSD 74:27:10:06.

Failure to comply with the requirements stated above may result in civil penalties in accordance with South Dakota Solid Waste Law, SDCL 34A-6-1.31.

All costs associated with furnishing waste disposal site(s), disposing of waste, maintaining control of access (fence, gates, and signs), and reclamation of the waste disposal site(s) will be incidental to the various contract items.

COMMITMENT I: HISTORIC PRESERVATION OFFICE CLEARANCES

The SDDOT has obtained concurrence with the State Historic Preservation Office (SHPO) for all work included within the project limits and all department designated sources and designated option material sources, stockpile sites, storage areas, and waste sites provided within the plans.

Action Taken/Required:

All earth disturbing activities not designated within the plans require a cultural resource review prior to scheduling the pre-construction meeting. This work includes but is not limited to: Contractor furnished material sources, material processing sites, stockpile sites, storage areas, plant sites, and waste areas.

The Contractor will arrange and pay for a record search and when necessary, a cultural resource survey. The Contractor has the option to contact the state Archaeological Research Center (ARC) at 605-394-1936 or another qualified archaeologist, to obtain either a records search or a cultural resources survey. A record search might be sufficient for review if the site was previously surveyed; however, a cultural resources survey may need to be conducted by a qualified archaeologist.

The Contractor will provide ARC with the following: a topographical map or aerial view in which the site is clearly outlined, site dimensions, project number, and PCN. If applicable, provide evidence that the site has been previously disturbed by farming, mining, or construction activities with a landowner statement that artifacts have not been found on the site.

The Contractor will submit the cultural resources survey report to SDDOT Environmental Office, 700 East Broadway Avenue, Pierre, SD 57501-2586. SDDOT will submit the information to the appropriate SHPO/THPO. Allow **30 Days** from the date this information is submitted to the Environmental Engineer for SHPO/THPO review.

In the event of an inadvertent discovery of human remains, funerary objects, or if evidence of cultural resources is identified during project construction activities, then such activities within 150 feet of the inadvertent discovery will immediately cease and the Project Engineer will be immediately notified. The Project Engineer will contact the SDDOT Environmental Office, who will contact the appropriate SHPO/THPO within 48 hours of the discovery to determine an appropriate course of action.

SHPO review does not relieve the Contractor of the responsibility for obtaining any additional permits and clearances for Contractor furnished material sources, material processing sites, stockpile sites, storage areas, plant sites, and waste areas that affect wetlands, threatened and endangered species, or waterways. The Contractor will not utilize a site known or suspected of having contaminated soil or water. The Contractor will provide the required permits and clearances to the Project Engineer at the preconstruction meeting.

COMMITMENT N: SECTION 404 PERMIT

The SDDOT has obtained a Section 404 Permit from the USACE for the permanent actions associated with this project.

Action Taken/Required:

The Contractor will comply with all requirements contained in the Section 404 Permit.

The Contractor will also be responsible for obtaining a Section 404 Permit for any dredge, excavation, or fill activities associated with material sources, storage areas, waste sites, and Contractor work sites outside the plan work limits that affect wetlands, floodplains, or waters of the United States.

COMMITMENT O: SECTION 401 WATER QUALITY CERTIFICATION

The SDDOT has obtained a Clean Water Act Section 401 Water Quality Certification from the Environmental Protection Agency (EPA) regarding an US Army Corp of Engineers CWA Section 404 Permit for the actions associated with this project.

Action Taken/Required:

The Contractor will comply with all requirements contained in the Section 401 certification. A copy of the EPA CWA 401 Certification must be retained on-site.

