

SECTION M: PAVEMENT MARKING PLANS

FOR BIDDING PURPOSES ONLY

STATE OF SOUTH DAKOTA	PROJECT	SHEET	TOTAL SHEETS
	P 0047(117)67 P 0248(13)261	M1	M7

REV 12-4-24 JT

INDEX OF SHEETS

- M1 General Layout with Index
- M2 Estimate with General Notes & Tables
- M3-M5 Pavement Marking Layouts
- M6-M7 Standard Plates

BEGIN P 0248(13)261
Station 0+00.00
MRM 261.77

END P 0248(13)261
Station 43+82.00
MRM 262.57

BEGIN P 0047(117)67
Station -2+50.00
MRM 87.00 + 0.346

END P 0047(117)67
Station 1024+81.32
MRM 67.00 + 0.602

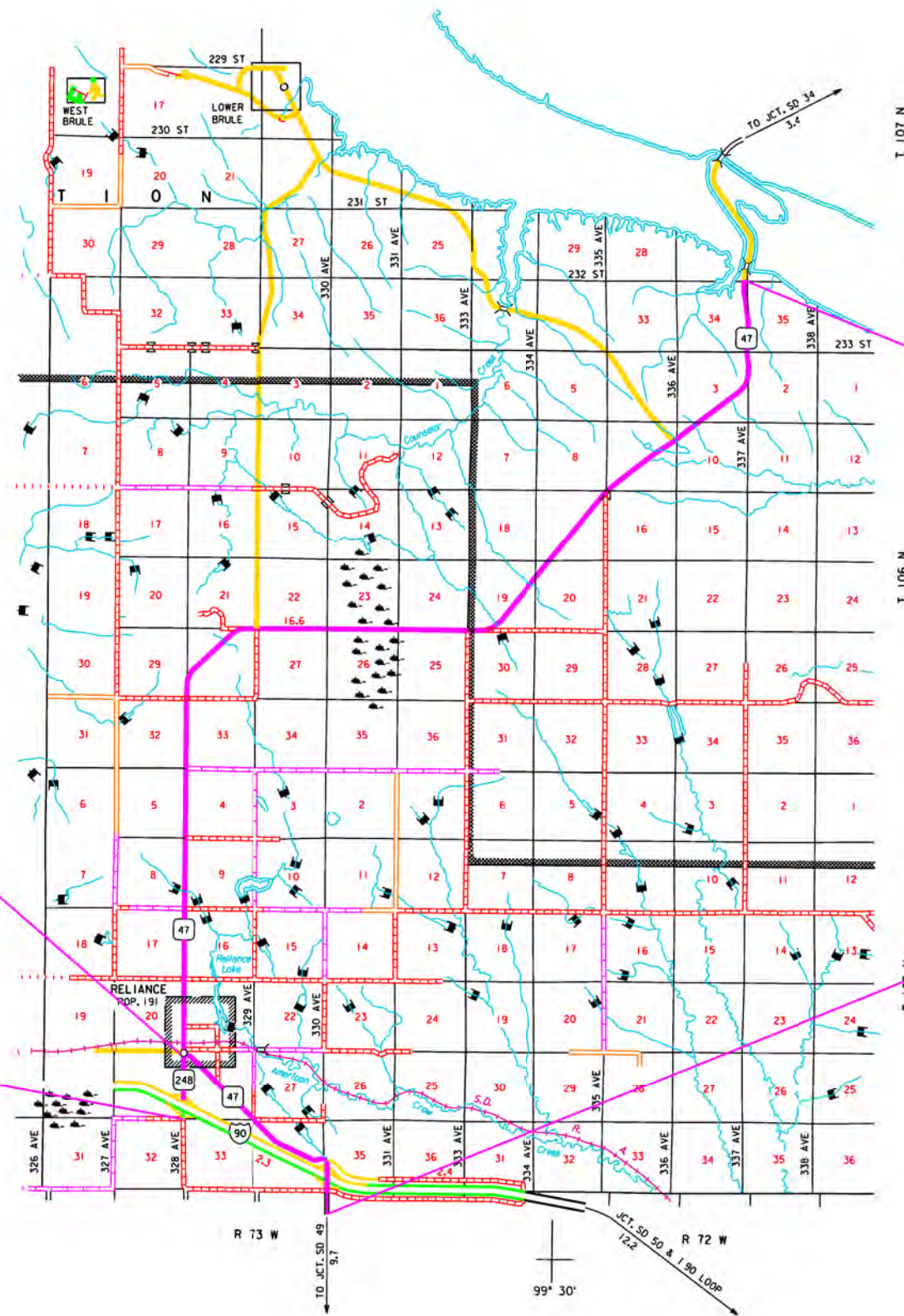

FOR BIDDING PURPOSES ONLY

SECTION M ESTIMATE OF QUANTITIES SD47 (PCN 069Q)

BID ITEM NUMBER	ITEM	QUANTITY	UNIT
633E1200	High Build Waterborne Pavement Marking Paint, White	877	Gal
633E1205	High Build Waterborne Pavement Marking Paint, Yellow	150	Gal
633E1262	High Build Waterborne Pavement Marking Paint, 24" Yellow	241	Ft
633E1272	High Build Waterborne Pavement Marking Paint, Arrow	5	Each
633E1290	High Build Waterborne Pavement Marking Paint, Railroad Crossing	2	Each

If the Department chooses to take retroreflectivity readings, three readings will be taken on the edge lines and lane lines in the direction of application. For combination solid yellow and skip yellow lines for turn lanes and for centerline markings on two-way roadways, three readings will be taken in one direction, the reflectometer will be turned 180 degrees and three more readings will be taken. The six readings for the centerline markings will be averaged and become the test reading for that test location.

If the Department chooses to take readings, the minimum retroreflectivity values will be 275 mc/m²/lux for white and 170 mc/m²/lux for yellow.

SECTION M ESTIMATE OF QUANTITIES SD248 (PCN 06YC)

BID ITEM NUMBER	ITEM	QUANTITY	UNIT
633E1200	High Build Waterborne Pavement Marking Paint, White	37	Gal
633E1205	High Build Waterborne Pavement Marking Paint, Yellow	6	Gal

PAVEMENT MARKING PAINT

The Contractor will advise the Engineer a minimum of 3 weeks prior to the application of the permanent pavement marking to allow the State to check and mark the location of no passing zones.

The application of permanent pavement marking will begin no sooner than 7 calendar days following completion of the fog or flush seal. Application of permanent pavement marking will be completed within 14 calendar days following completion of the final surfacing.

HIGH BUILD WATERBORNE PAVEMENT MARKING PAINT

All materials will be applied as per manufacturer's recommendations. High build waterborne pavement marking paint will conform to the supplemental specifications for Section 980.1 B.

Reflective media will consist of glass beads. Reflective media will require a Certificate of Compliance for Certification for each source and lot. Acceptance sampling will not be required.

RATES OF MATERIALS FOR HIGH BUILD WATERBORNE PAVEMENT MARKING PAINT

Solid 4" line = 22.5 Gals/Mile
Dashed 4" line = 6.2 Gal/Mile
Glass Beads = 8 Lbs/Gal.

All cost for materials, labor, and equipment necessary to furnish and install the pavement markings will be incidental to the contract unit price for the respective High Build Waterborne Pavement Marking Paint items.

RETROREFLECTIVITY FOR PAVEMENT MARKING PAINT

The Department may take retroreflectivity readings on the pavement marking lines after 2 days and within 30 days of the line application using either a portable or mobile retroreflectometer that conforms to 30-meter geometry. If the Department chooses to take retroreflectivity readings, three retroreflectivity readings will be taken on each line at each test location. The three readings will be averaged and become the reading for that test location.



FOR BIDDING PURPOSES ONLY

STATE OF SOUTH DAKOTA	PROJECT	SHEET	TOTAL SHEETS
	P 0047(117)67 P 0248(13)261	M3	M7
Plotting Date: 8/27/2024		Rev. 8/26/24 JT	

PAVEMENT MARKING LAYOUT

Plot Scale - 1:50

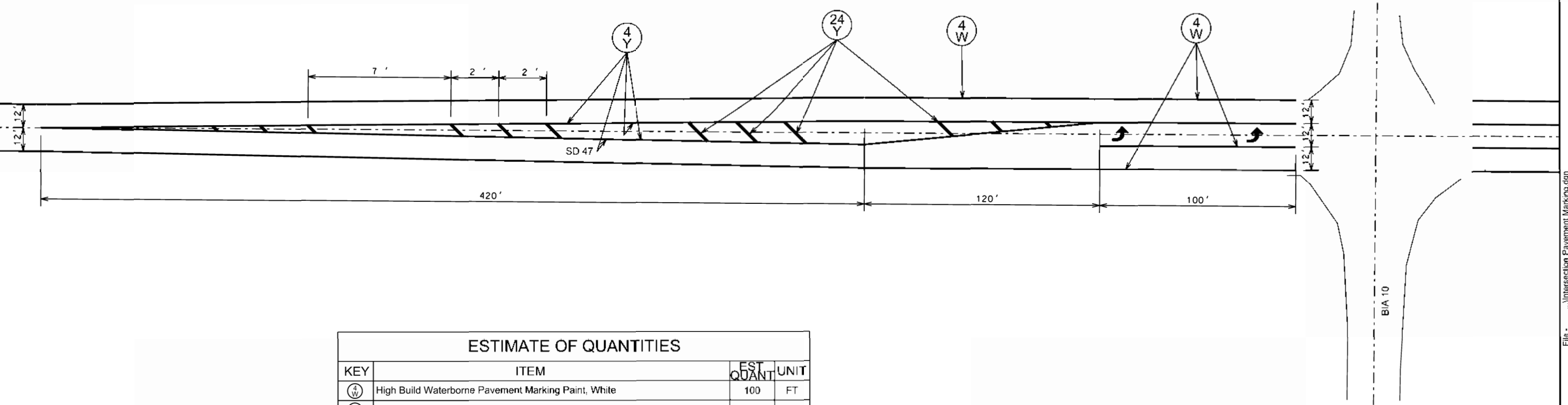
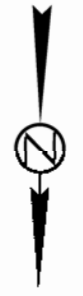

ESTIMATE OF QUANTITIES			
KEY	ITEM	EST. QUANT.	UNIT
(4 W)	High Build Waterborne Pavement Marking Paint, White	100	FT
(4 Y)	High Build Waterborne Pavement Marking Paint, Yellow	1180	FT
(24 Y)	High Build Waterborne Pavement Marking Paint, 24" Yellow	112	FT
(Arrow)	High Build Waterborne Pavement Marking Paint, Arrow	2	EACH

Plotted From - Justin

File - ...Intersection Pavement Marking.dgn



FOR BIDDING PURPOSES ONLY

STATE OF SOUTH DAKOTA	PROJECT	SHEET	TOTAL SHEETS
	P 0047(117)67 P 0248(13)261	M4	M7
Plotting Date: 8/27/2024		Rev. 8/26/24 JT	

PAVEMENT MARKING LAYOUT

Plot Scale - 1:50

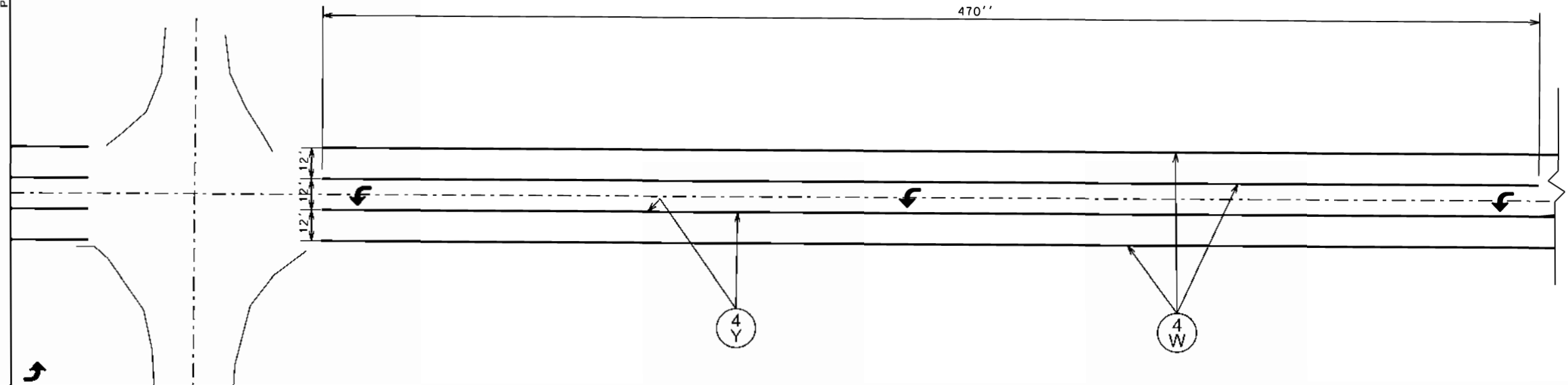

ESTIMATE OF QUANTITIES				
KEY	ITEM	EST. QUANT.	UNIT	
④ W	High Build Waterborne Pavement Marking Paint, White	470	FT	
④ Y	High Build Waterborne Pavement Marking Paint, Yellow	1550	FT	
②④ Y	High Build Waterborne Pavement Marking Paint, 24" Yellow	129	FT	
↔	High Build Waterborne Pavement Marking Paint, Arrow	3	EACH	

Plotted From - Justin

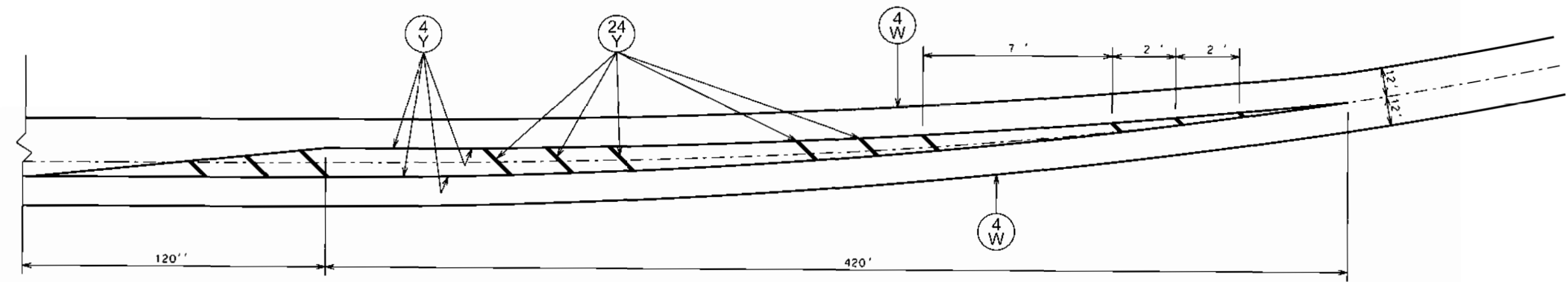

File - ...Intersection Pavement Marking2.dgn

TYPICAL PAVEMENT MARKING LAYOUT

STATE OF SOUTH DAKOTA	PROJECT	SHEET	TOTAL SHEETS
	P 0047(117)67 P 0248(13)261	M5	M7
Plotting Date: 8/27/2024		Rev. 8/26/24 JT	

FOR BIDDING PURPOSES ONLY

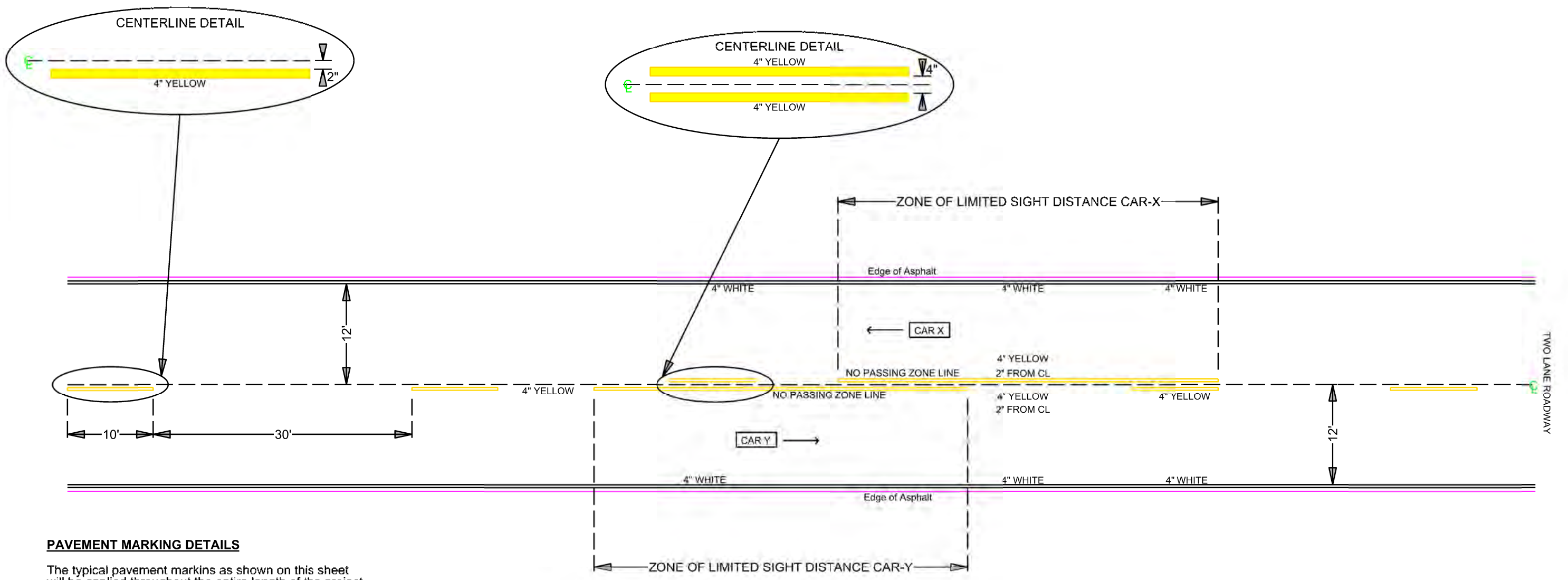

PAVEMENT MARKING DETAILS

The typical pavement markings as shown on this sheet will be applied throughout the entire length of the project.

Traffic Control will be incidental to the cost of application. The striping and advance or trailing warning vehicle will be equipped with flashing amber lights or advance warning arrow panel.

Exact location of the NO PASSING ZONE lines will be determined in the field by the Engineer. A dash of white paint will mark the beginning and end of all no passing zones. NO PASSING ZONE signs and the ending post in fence lines. If present, will not be used as the beginning and ending NO PASSING ZONE lines.

ESTIMATED QUANTITIES (BASED ON ONE APPLICATION)		
PAINT	QUANTITY	
WHITE	914	GALLONS
YELLOW	156	GALLONS



1:200

Justin

File - ...Section M Pavement Marking.dgn

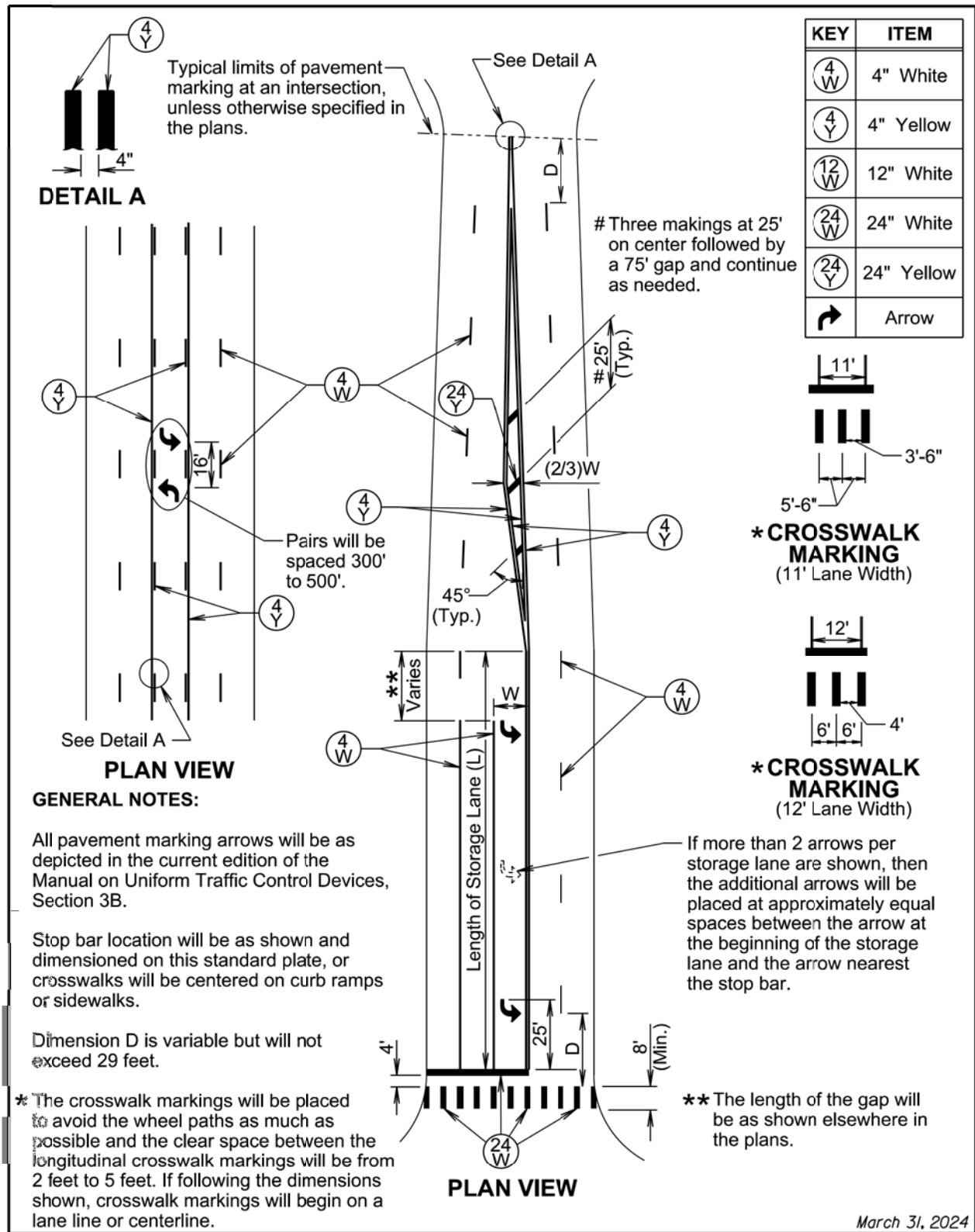

KEY	ITEM
(4 W)	4" White
(4 Y)	4" Yellow
(12 W)	12" White
(24 W)	24" White
(24 Y)	24" Yellow
↶	Arrow

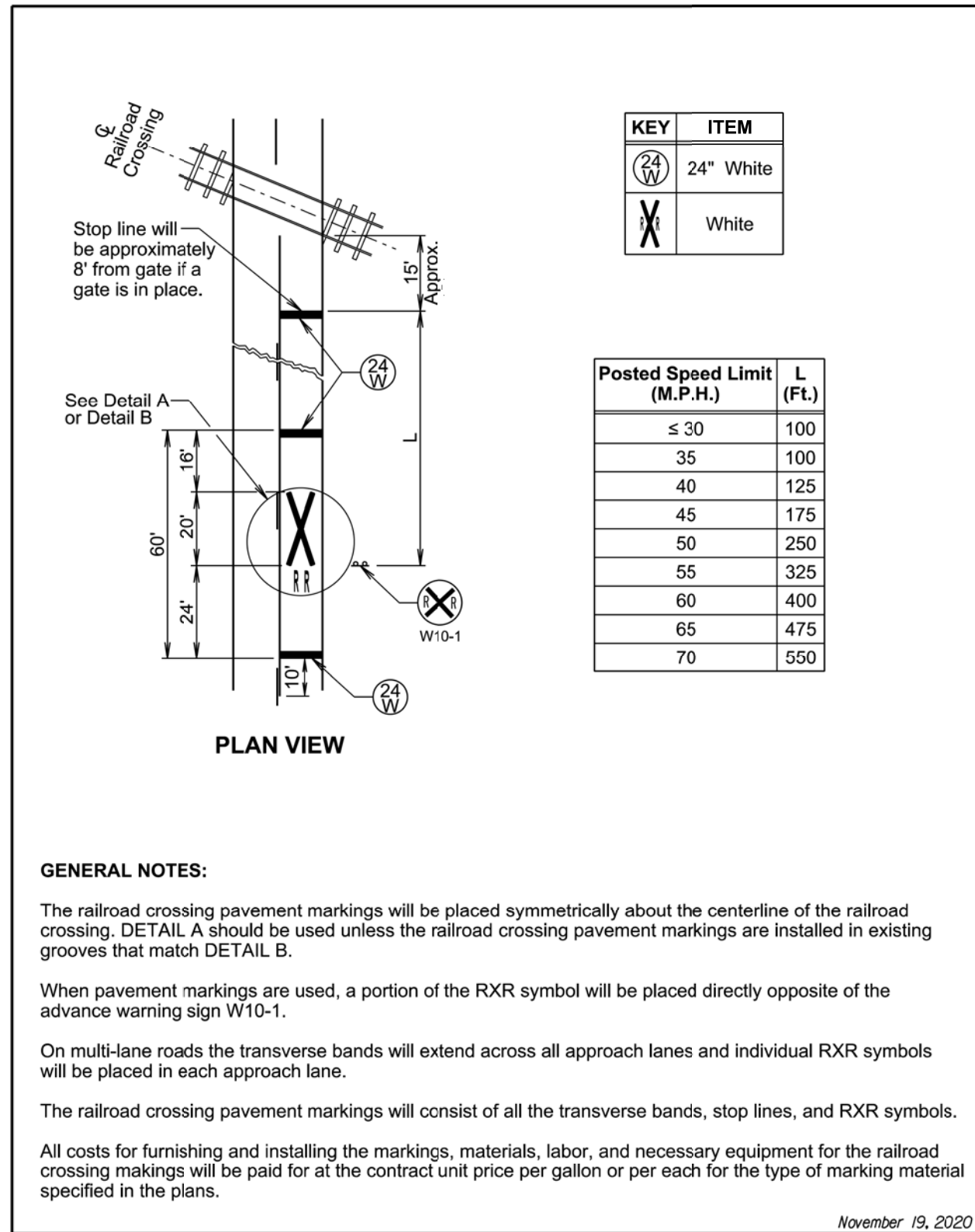
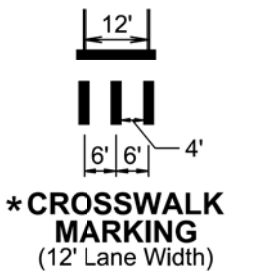
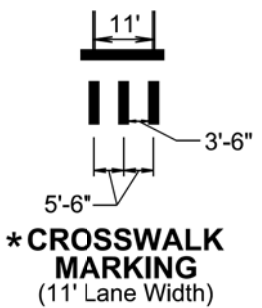

Published Date: 2025	S D D O T	PAVEMENT MARKINGS FOR ADJACENT INTERSECTIONS AND CENTER TURN LANE	PLATE NUMBER 633.01
			Sheet 1 of 1

Published Date: 2025	S D D O T	PAVEMENT MARKINGS AT RAILROAD CROSSING	PLATE NUMBER 633.10
			Sheet 1 of 2

1:200
Plotted From: Justin

File: ...Section M\StandardPlates_M.dgn

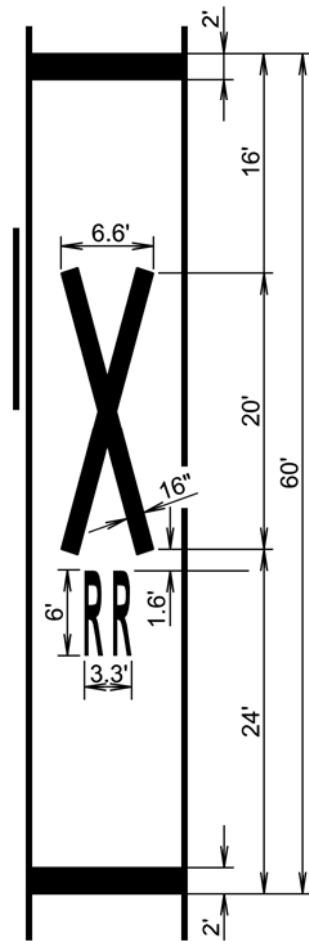

DETAIL A

Width may vary according to lane width.

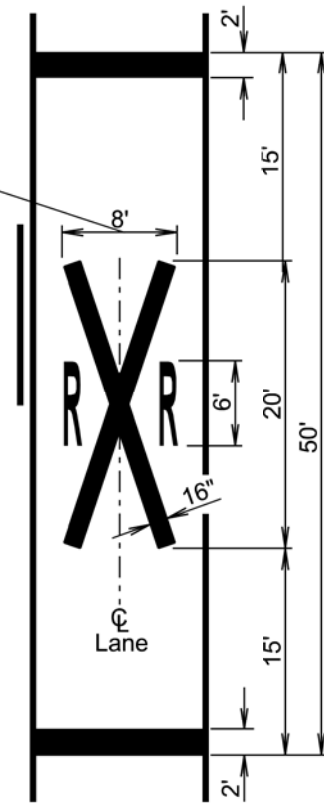

DETAIL B

November 19, 2020

Published Date: 2025

S
D
D
O
T

PAVEMENT MARKINGS AT RAILROAD CROSSING

PLATE NUMBER
633.10

Sheet 2 of 2

* Messages on signs will vary depending on the operation being conducted.

Vehicle-mounted signs will be mounted in a manner such that they are not obscured by equipment or supplies. Sign legends on vehicle-mounted signs will be covered or turned from view when work is not in progress.

Shadow and Work vehicles will display high-intensity rotating, flashing, oscillating, or strobe lights, flags, signs, or arrow boards. Vehicle hazard warning signals will not be used instead of the vehicle's high-intensity rotating, flashing, oscillating, or strobe lights.

When an arrow board is used, it will be used in the caution mode. Marching Diamonds are acceptable.

Arrow boards will, as a minimum, be Type B, with a size of 60" x 30".

All costs associated with the traffic control for mobile operation including signs, arrow boards and equipment will be incidental to the contract lump sum price for "Traffic Control, Miscellaneous".

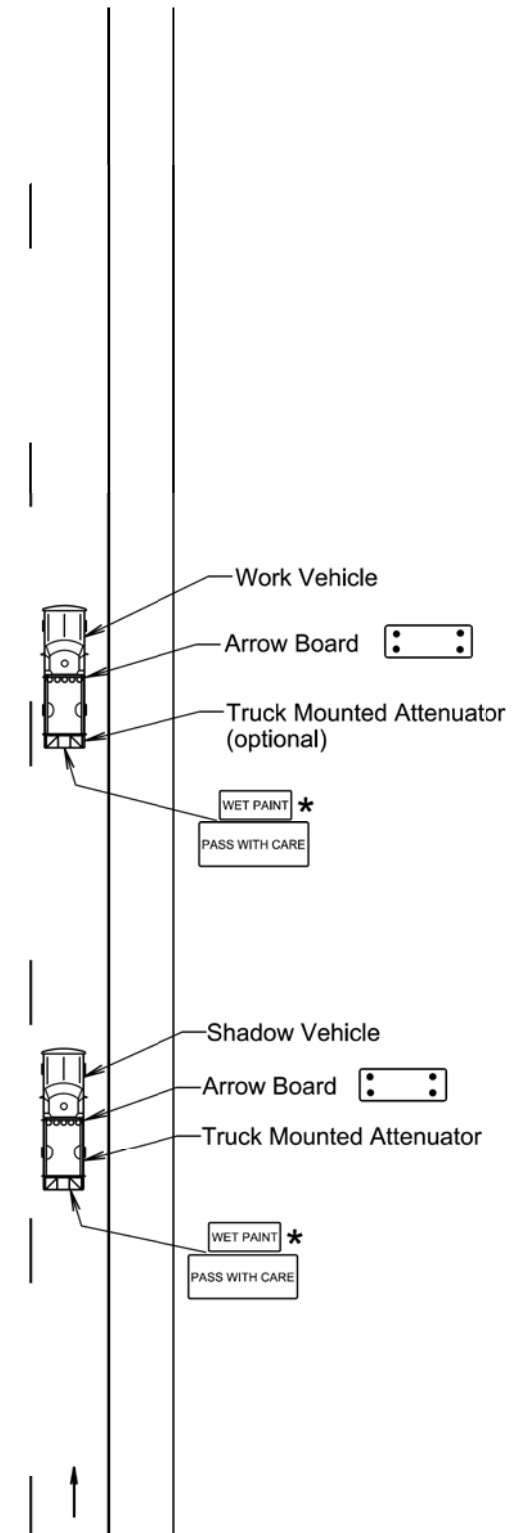

January 22, 2021

Published Date: 2025

S
D
D
O
T

MOBILE OPERATIONS ON 2-LANE ROAD

PLATE NUMBER
634.06

Sheet 1 of 1