

SECTION U: EXISTING UTILITY INFORMATION

STATE OF SOUTH DAKOTA	PROJECT	SHEET	TOTAL SHEETS
	NH-CR 0037(158)126	U1	U15

Plotting Date: 12/12/2023

UTILITY LEGEND

- 1 LUMEN
- 2 NORTHWESTERN ENERGY
- 3 SDN
- 5 CITY OF HURON WATER
- 6 UNKNOWN UTILITY

INDEX OF SHEETS

- U1 General Layout with Index
- U2 General Utility Notes
- U3-U4 Subsurface Utility Locations
- U5-U14 Utility Layouts

BEGIN NH-CR 0037(158)126
Station 9+32.27

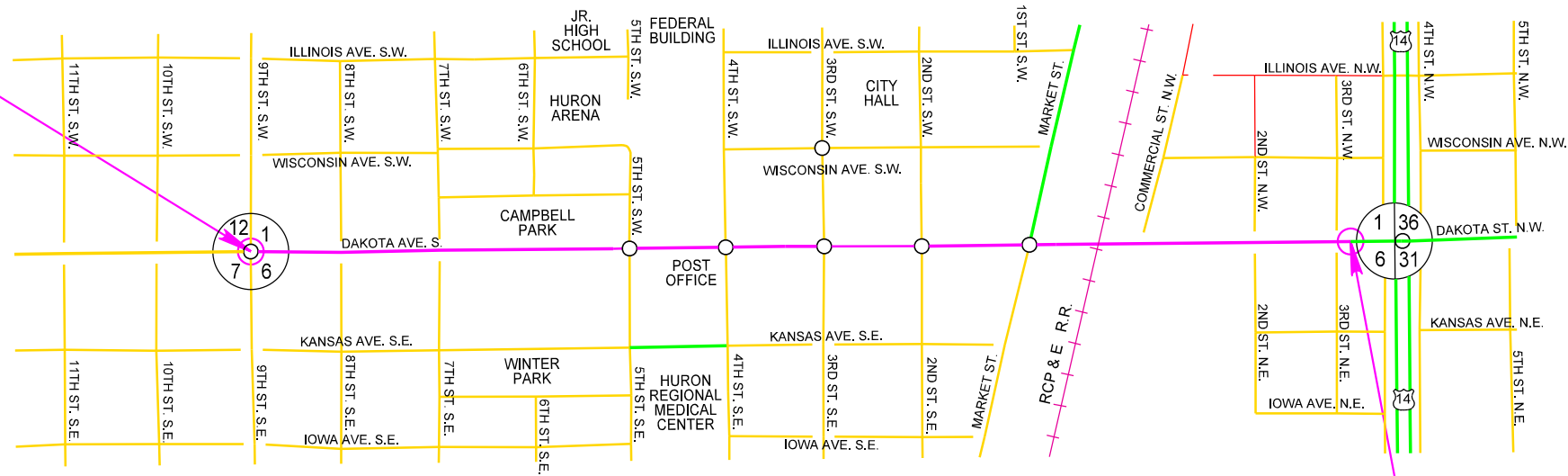

END NH-CR 0037(158)126
Station 58+84.30

HURON

STATE OF SOUTH DAKOTA	PROJECT	SHEET	TOTAL SHEETS
	NH-CR 0037(158)126	U2	U15

Plotting Date: 12/12/2023

UTILITIES

The Contractor will be aware that the existing utilities shown in the plans were surveyed prior to the design of this project and might have been relocated or replaced by a new utility facility prior to construction of this project, might be relocated or replaced by a new utility facility during the construction of this project, or might not require adjustment and may remain in its current location. The Contractor will contact each utility owner and confirm the status of all existing and new utility facilities. The utility contact information is provided elsewhere in the plans or bidding documents.

Subsurface utility explorations were done for this project. The findings can be found in the SUBSURFACE UTILITY LOCATIONS table elsewhere in the plans. The table is provided to aid the Contractor during construction. All information in the table is approximate and will be verified by the Contractor prior to construction in those areas.

CONTACT INFORMATION

Please refer to the list of utilities found in the Special Provisions for description of utility impacts and contact information.

SUBSURFACE UTILITY LOCATIONS

QUALITY LEVEL A

STATE OF SOUTH DAKOTA	PROJECT NH-CR 0037(158)126	SHEET U3	TOTAL SHEETS U15
-----------------------------	-------------------------------	-------------	------------------------

Plotting Date: 12/12/2023

Subsurface utility explorations were done at the following locations. The information below states what was located in the specified areas. This table is provided to aid the Contractor during construction and does not substitute or replace the requirements of SD One Call. All information is approximate and the Contractor shall verify all utility locations before construction in those areas as mandated in SDCL 49-7A.

Test Hole	Station	Offset	Finding	Existing Ground Elev.	Utility Depth (Ft.)	Utility Elevation	Northing	Easting
4-2	17+47.36	123.53' L	16 INCH RAW WATER MAIN	1280.29	6.50	1273.79	196605.945	2435442.087
3-4	29+97.03	40.59' L	3 – 1.5 INCH PLASTIC CONDUIT	1281.79	3.07	1278.72	197857.192	2435496.221
					3.11	1278.68		
					3.22	1278.57		
4-5	17+46.96	127.96' R	16 INCH RAW WATER MAIN	1281.12	7.16	1273.96	196611.336	2435693.527
6-6	36+21.39	47.91' R	CORRODED STEEL OR IRON PIPE	1279.24	3.10	1276.14	198483.394	2435570.289
1-7	30+20.29	45.38' L	SOUTH EDGE CONCRETE DUCT	1281.95	3.48	1278.47	197880.331	2435490.894
1-8	30+23.76	46.15' L	NORTH EDGE CONCRETE DUCT	1282.02	2.13	1279.89	197883.787	2435490.047
1-9	30+95.88	24.72' R	WEST EDGE CONCRETE DUCT	1281.03	3.72	1277.31	197957.524	2435559.227
1-10	30+95.90	26.50' R	EAST EDGE CONCRETE DUCT	1280.88	3.72	1277.16	197957.588	2435561.003
1-11	34+05.67	29.90' R	WEST EDGE CONCRETE DUCT	1279.55	3.64	1275.91	198267.332	2435557.188
3-13	34+52.16	53.85' L	2 – 1.5 INCH PLASTIC CONDUIT	1279.52	3.70	1275.82	198311.880	2435472.382
					3.62	1275.90		
1-14	34+59.18	30.38' R	WEST EDGE CONCRETE DUCT	1279.86	4.30	1275.56	198320.856	2435556.428
1-16	35+56.33	30.21' R	CENTER CONCRETE DUCT		0.00	1274.79	198417.951	2435554.061
1-16A	35+55.93	29.73' R	WEST EDGE CONCRETE DUCT	1278.73	3.96	1274.77	198417.542	2435553.592
1-16B	35+55.81	31.06' R	EAST EDGE CONCRETE DUCT	1278.64	3.90	1274.74	198417.459	2435554.920
1-17	38+50.14	29.55' R	WEST EDGE CONCRETE DUCT	1278.97	4.03	1274.94	198711.676	2435546.798
1-18	43+51.58	25.85' R	EAST EDGE CONCRETE DUCT	1277.95	2.43	1275.52	199212.921	2435531.850
2-19	44+39.99	39.51' L	6 INCH GASLINE STEEL	1277.89	1.60	1276.29	199299.801	2435464.505
2-20	44+44.91	38.53' L	8 INCH HIGH PRESSURE GAS MAIN	1277.86	2.65	1275.21	199304.738	2435465.368
1-22	48+31.17	30.59' R	EAST EDGE CONCRETE DUCT	1279.35	3.30	1276.05	199692.495	2435525.513
2-23	48+40.31	33.18' L	6 INCH GASLINE STEEL	1279.18	4.65	1274.53	199700.156	2435461.562
1-24	49+03.13	28.73' R	WEST EDGE CONCRETE DUCT	1279.20	3.26	1275.94	199764.391	2435522.004
1-27	50+45.37	30.82' R	EAST EDGE CONCRETE DUCT	1278.88	3.40	1275.48	199906.658	2435520.797
2-29	54+27.99	24.29' R	2 INCH GASLINE STEEL	1278.28	2.88	1275.40	200289.013	2435505.404
5-30	41+21.19	46.14' R	8 OR 10 INCH CLAY PIPE	1279.56	4.80	1274.76	198983.023	2435557.304
1-32	30+20.11	70.29' L	SOUTH EDGE CONCRETE DUCT	1282.11	3.36	1278.75	197879.575	2435465.994
1-33	30+24.27	71.16' L	NORTH EDGE CONCRETE DUCT	1282.15	3.91	1278.24	197883.715	2435465.027
1-34A	39+86.89	28.94' R	WEST EDGE CONCRETE DUCT	1279.22	3.96	1275.26	198848.380	2435543.122

Test Hole Owner Identification Number Codes (First number denotes utility ownership)

1 = Lumen, 2 = Northwestern Energy, 3 = SDN, 4 = City of Huron Water, 5 = City of Huron Water, 6 = Unknown Utility,

The coordinates shown on this sheet are based on the South Dakota State Plane Coordinate System. North Zone (NAD 83/2011); epoch 2010; Geoid 12A; SF = 0.9999278397
The elevations shown on this sheet are based on NAVD 88.

1:200

Plot Scale -

TRR014286

Plotted From -

File - ...Subsurface_Utility_Locations.dgn

SUBSURFACE UTILITY LOCATIONS

QUALITY LEVEL A

STATE OF SOUTH DAKOTA	PROJECT NH-CR 0037(158)126	SHEET U4	TOTAL SHEETS U15
-----------------------	-------------------------------	-------------	---------------------

Plotting Date: 12/12/2023

Subsurface utility explorations were done at the following locations. The information below states what was located in the specified areas. This table is provided to aid the Contractor during construction and does not substitute or replace the requirements of SD One Call. All information is approximate and the Contractor shall verify all utility locations before construction in those areas as mandated in SDCL 49-7A.

Test Hole	Station	Offset	Finding	Existing Ground Elev.	Utility Depth (Ft.)	Utility Elevation	Northing	Easting
1-34B	39+86.89	30.46' R	EAST EDGE CONCRETE DUCT	1279.22	3.94	1275.28	198848.414	2435544.646
1-34C	39+86.92	25.57' R	3 – 4 INCH PLASTIC CONDUIT	1279.19	2.14	1277.05	198848.333	2435539.751
1-35A	41+65.18	28.90' R	WEST EDGE CONCRETE DUCT	1278.65	4.68	1273.97	199026.619	2435539.079
1-35B	41+65.34	30.71' R	EAST EDGE CONCRETE DUCT	1278.55	4.56	1273.99	199026.819	2435540.883
1-35C	41+65.40	25.54' R	3 – 4 INCH PLASTIC CONDUIT	1278.79	2.36	1276.43	199026.767	2435535.718
1-36A	44+55.53	28.95' R	WEST EDGE CONCRETE DUCT	1278.18	3.66	1274.52	199316.918	2435532.585
1-36B	44+55.46	30.68' R	EAST EDGE CONCRETE DUCT	1278.12	3.62	1274.50	199316.891	2435534.316
1-37A	51+99.29	33.57' R	EAST EDGE CONCRETE DUCT	1278.57	2.94	1275.63	200060.592	2435519.984
1-37B	51+99.24	31.89' R	WEST EDGE CONCRETE DUCT	1278.67	3.00	1275.67	200060.495	2435518.300
1-38A	53+92.66	35.47' R	WEST EDGE CONCRETE DUCT	1278.48	3.05	1275.43	200253.953	2435517.408
1-38B	53+92.53	36.97' R	EAST EDGE CONCRETE DUCT	1278.55	3.12	1275.43	200253.857	2435518.902
1-39A	55+44.29	37.41' R	WEST EDGE CONCRETE DUCT	1279.39	3.34	1276.05	200405.577	2435515.837
1-39B	55+44.27	39.01' R	EAST EDGE CONCRETE DUCT	1279.30	3.41	1275.89	200405.595	2435517.442
1-40	54+64.30	60.41' L	4" PLASTIC CONDUIT	1279.54	3.09	1276.45	200323.357	2435419.893
1-41A	57+68.22	37.38' R	WEST EDGE CONCRETE DUCT	1279.92	2.42	1277.50	200629.449	2435510.644
1-41B	57+68.14	39.14' R	EAST EDGE CONCRETE DUCT	1280.04	2.55	1277.49	200629.407	2435512.400

Test Hole Owner Identification Number Codes (First number denotes utility ownership)

1 = Lumen, 2 = Northwestern Energy, 3 = SDN, 4 = City of Huron Water, 5 = City of Huron Water, 6 = Unknown Utility,

The coordinates shown on this sheet are based on the South Dakota State Plane Coordinate System. North Zone (NAD 83/2011); epoch 2010; Geoid 12A; SF = 0.9999278397
The elevations shown on this sheet are based on NAVD 88.

Plot Scale - 1:200

Plotted From - TRR014286

File - ...Subsurface_Utility_Locations.dgn

LEGEND

STATE OF SOUTH DAKOTA	PROJECT	SHEET	TOTAL SHEETS
	NH-CR 0037(158)126	U5	U15

Plotting Date: 12/12/2023

Plot Scale - 1:200

Plotted From - TRR014286

Anchor		Hedge		Septic Tank		State and National Line	
Antenna		Highway ROW Marker		Shrub Tree		County Line	
Approach		Interstate Close Gate		Sidewalk		Section Line	
Assumed Corner		Iron Pin		Sign Face		Quarter Line	
Azimuth Marker		Irrigation Ditch		Sign Post		Sixteenth Line	
BBQ Grill/ Fireplace		Lake Edge		Slough Or Marsh		Property Line	
Bearing Tree		Lawn Sprinkler		Spring		Construction Line	
Bench Mark		Mailbox		Stream Gauge		ROW Line	
Box Culvert		Manhole Electric		Street Marker		New ROW Line	
Bridge		Manhole Gas		Subsurface Utility Exploration Test Hole		Cut and Fill Limits	
Brush		Manhole Miscellaneous		Telephone Fiber Optics		Control of Access	
Buildings		Manhole Sanitary Sewer		Telephone Junction Box		New Control of Access	
Bulk Tank		Manhole Storm Sewer		Telephone Pole		Proposed ROW	
Cattle Guard		Manhole Telephone		Television Cable Jct Box		(After Property Disposal)	
Cemetery		Manhole Water		Television Tower			
Centerline		Merry-Go-Round		Test Wells/Bore Holes			
Cistern		Microwave Radio Tower		Traffic Signal		Drainage Arrow	
Clothes Line		Miscellaneous Line		Trash Barrel			
Commercial Sign Double Face		Miscellaneous Property Corner		Tree Belt			
Commercial Sign One Post		Miscellaneous Post		Tree Coniferous		Remove Concrete Pavement	
Commercial Sign Overhead		Overhang Or Encroachment		Tree Deciduous		Remove Concrete Driveway Pavement	
Commercial Sign Two Post		Overhead Utility Line		Tree Stumps		Remove Asphalt Concrete Pavement	
Concrete Symbol		Parking Meter		Triangulation Station		Remove Concrete Sidewalk	
Control Point		Pedestrian Push Button Pole		Underground Electric Line		Remove Concrete Median Pavement	
Creek Edge		Pipe With End Section		Underground Gas Line		Remove Concrete Curb and/or Gutter	
Curb/Gutter		Pipe With Headwall		Underground High Pressure Gas Line			
Curb		Pipe Without End Section		Underground Sanitary Sewer			
Dam Grade/Dike/Levee		Playground Slide		Underground Storm Sewer			
Deck Edge		Playground Swing		Underground Tank			
Ditch Block		Power And Light Pole		Underground Telephone Line			
Doorway Threshold		Power And Telephone Pole		Underground Television Cable			
Drainage Profile		Power Meter		Underground Water Line			
Drop Inlet		Power Pole		Warning Sign One Post			
Edge Of Asphalt		Power Pole And Transformer		Warning Sign Two Post			
Edge Of Concrete		Power Tower Structure		Water Fountain			
Edge Of Gravel		Propane Tank		Water Hydrant			
Edge Of Other		Property Pipe		Water Meter		Detectable Warning	
Edge Of Shoulder		Property Pipe With Cap		Water Tower		Pedestrian Push Button Pole	
Electric Transformer/Power Junction Box		Property Stone		Water Valve		and 30" x 48" Clear Space	
Fence Barbwire		Public Telephone		Water Well		with 1.5% slope	
Fence Chainlink		Railroad Crossing Signal		Weir Rock			
Fence Electric		Railroad Milepost Marker		Windmill			
Fence Miscellaneous		Railroad Profile		Wingwall			
Fence Rock		Railroad ROW Marker		Witness Corner			
Fence Snow		Railroad Signs					
Fence Wood		Railroad Switch					
Fence Woven		Railroad Track					
Fire Hydrant		Railroad Trestle					
Flag Pole		Rebar					
Flower Bed		Rebar With Cap					
Gas Valve Or Meter		Reference Mark					
Gas Pump Island		Regulatory Sign One Post					
Grain Bin		Regulatory Sign Two Post					
Guardrail		Retaining Wall					
Guide Sign One Post		Riprap					
Guide Sign Two Post		River Edge					
Gutter		Rock And Wire Baskets					
Guy Pole		Rockpiles					
Haystack		Satellite Dish					

File - U:\tr\proj\bead06A2\Legend.dgn

STATE OF SOUTH DAKOTA	PROJECT	SHEET	TOTAL SHEETS
	NH-CR 0037(158)126	U6	U15

Plotting Date: 12/12/2023

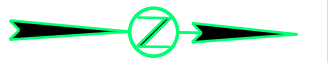

BEGIN NH-CR 0037(158)126
Station 9+32.27

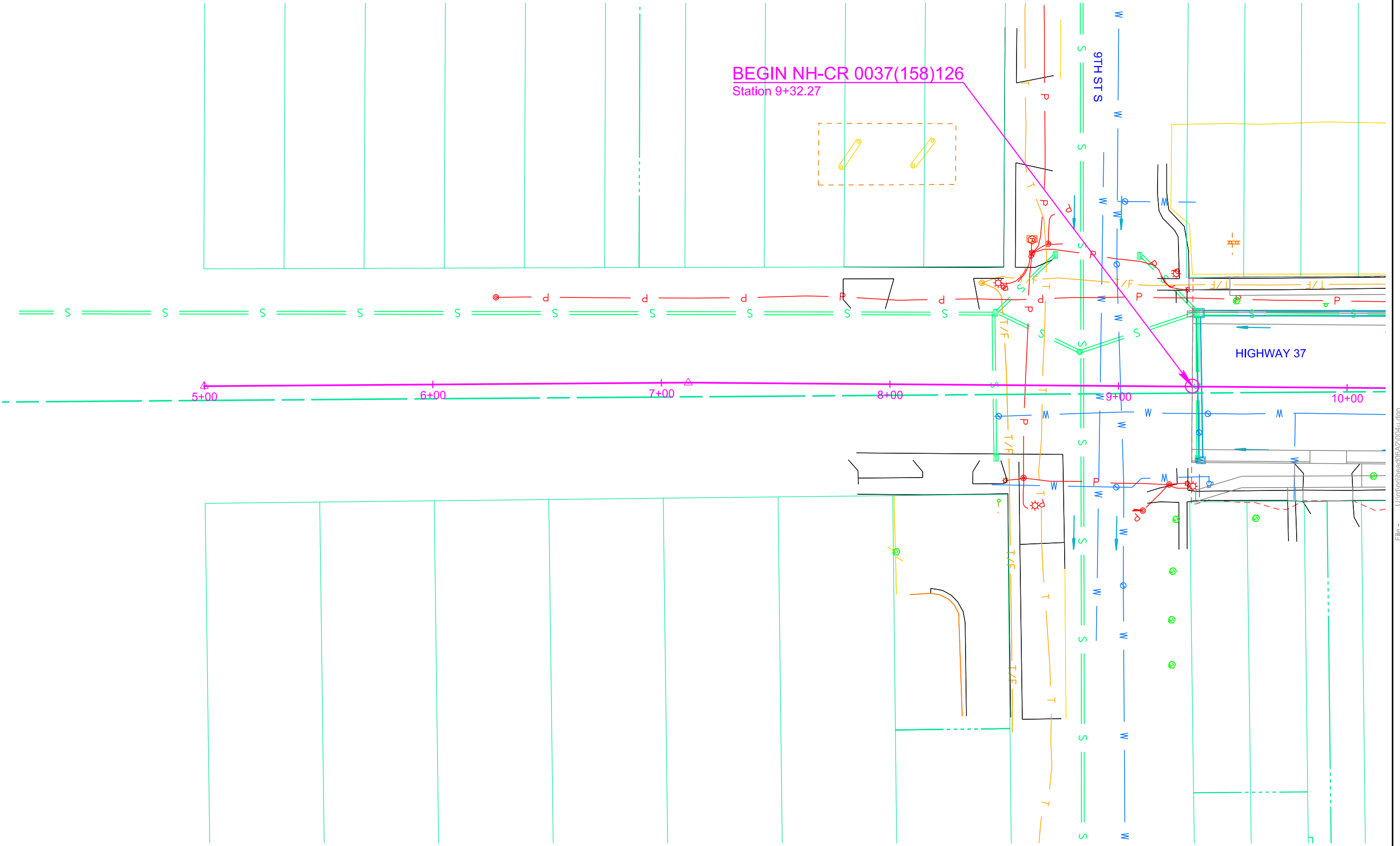

Plot Scale - 1:40

Plotted From - TRRC14286

File - U:\trc\proj\bead06A2\004u.dgn

STATE OF SOUTH DAKOTA	PROJECT	SHEET	TOTAL SHEETS
	NH-CR 0037(158)126	U7	U15

Plotting Date: 12/12/2023



Plot Scale - 1:40

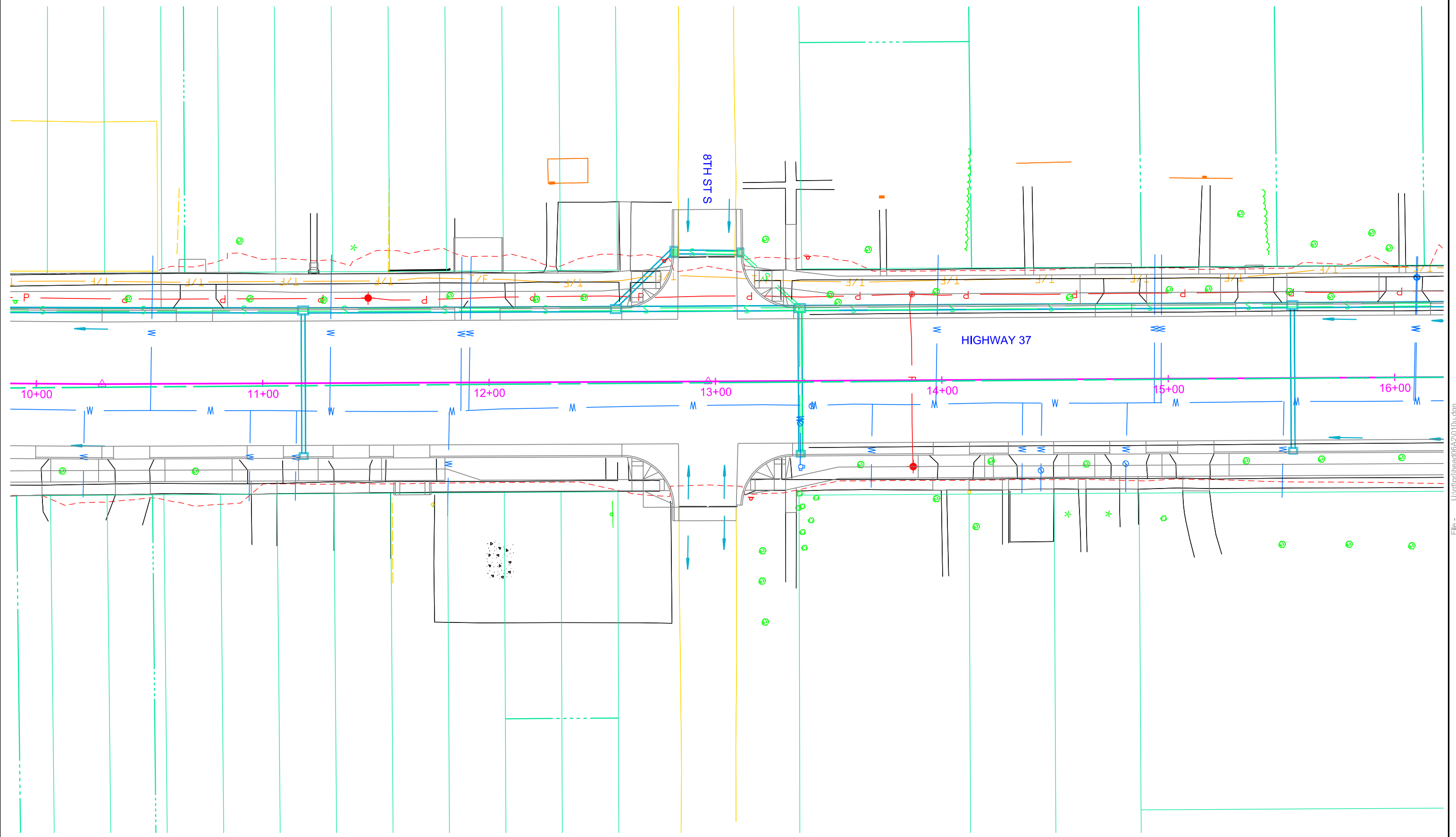

Plotted From - TRR014286

File - U:\trproj\bead06A2\010u.dgn

STATE OF SOUTH DAKOTA	PROJECT	SHEET	TOTAL SHEETS
	NH-CR 0037(158)126	U8	U15

Plotting Date: 12/12/2023



Plot Scale - 1:40

Plotted From - TRR014286

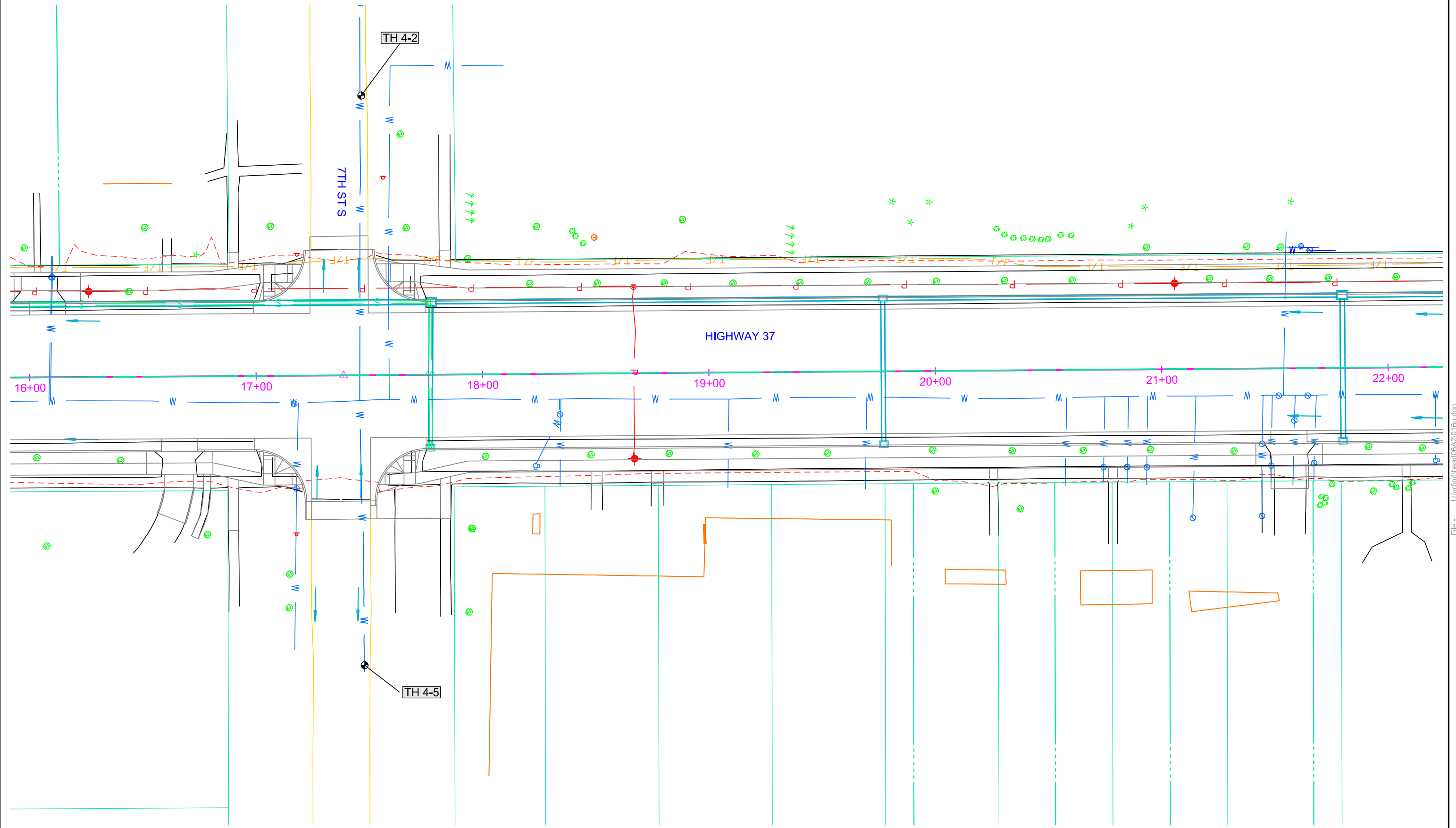

File - U:\trproj\bead06A2\016u.dgn

STATE OF SOUTH DAKOTA	PROJECT	SHEET	TOTAL SHEETS
	NH-CR 0037(158)126	U9	U15

Plotting Date: 12/12/2023



Plot Scale - 1:40

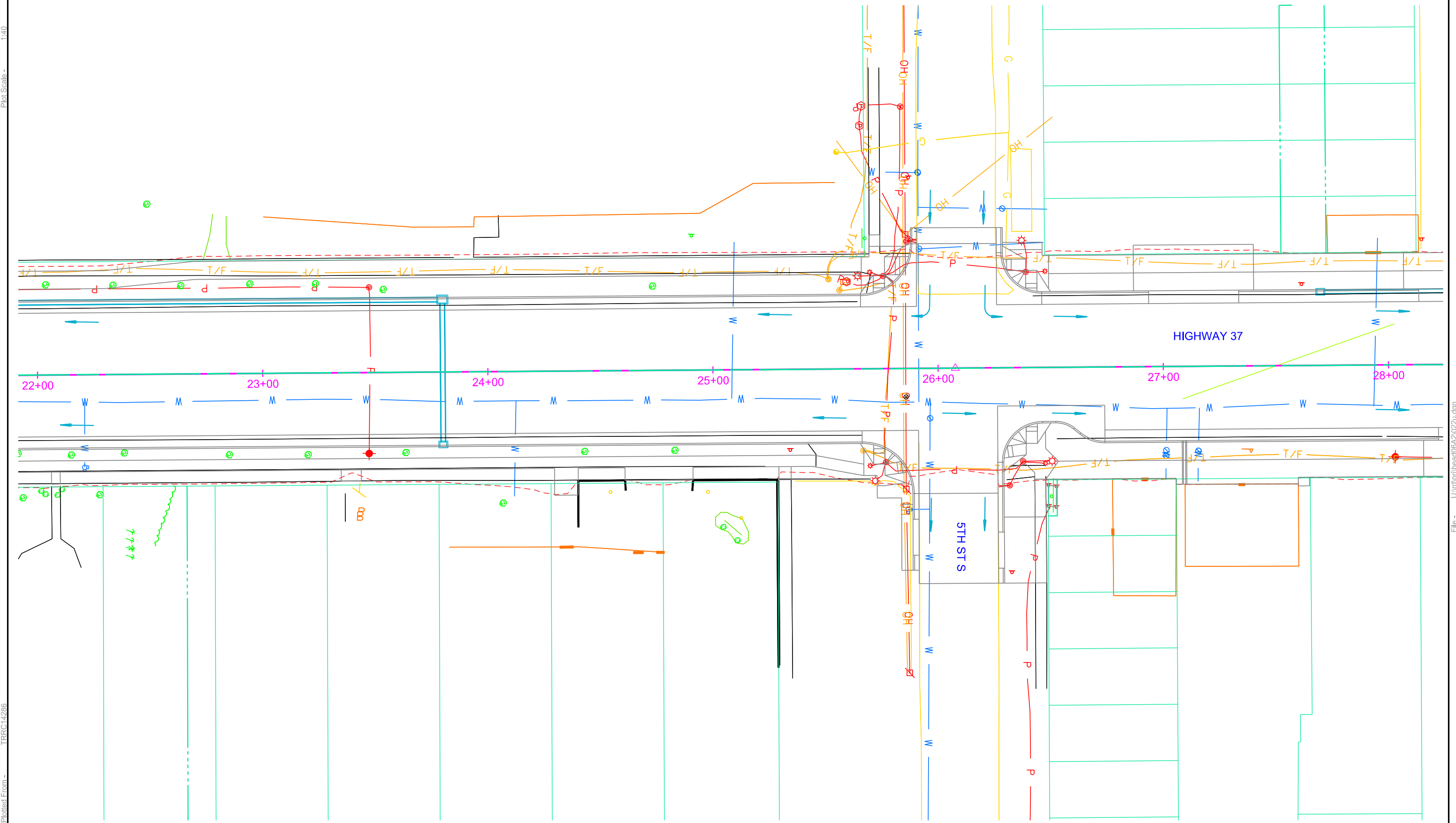

Plotted From - TRR014286

File - U:\tr\proj\bead06A2\022u.dgn



Plot Scale - 1:40

Plotted From - TRR014286

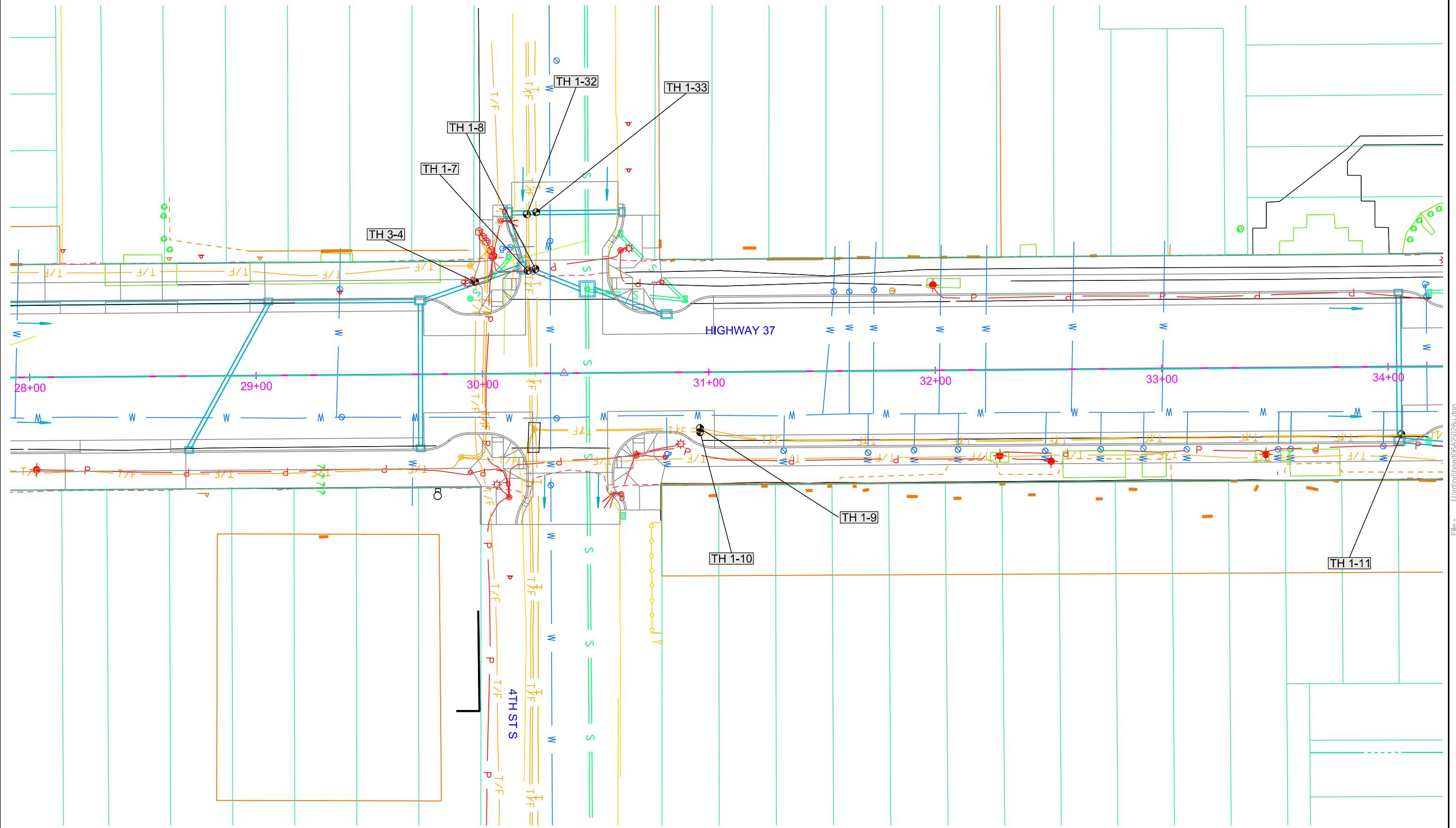

File - U:\trproj\bead06A2\02bu.dgn



Plot Scale - 1"=40'

Plotted From - TRR014286

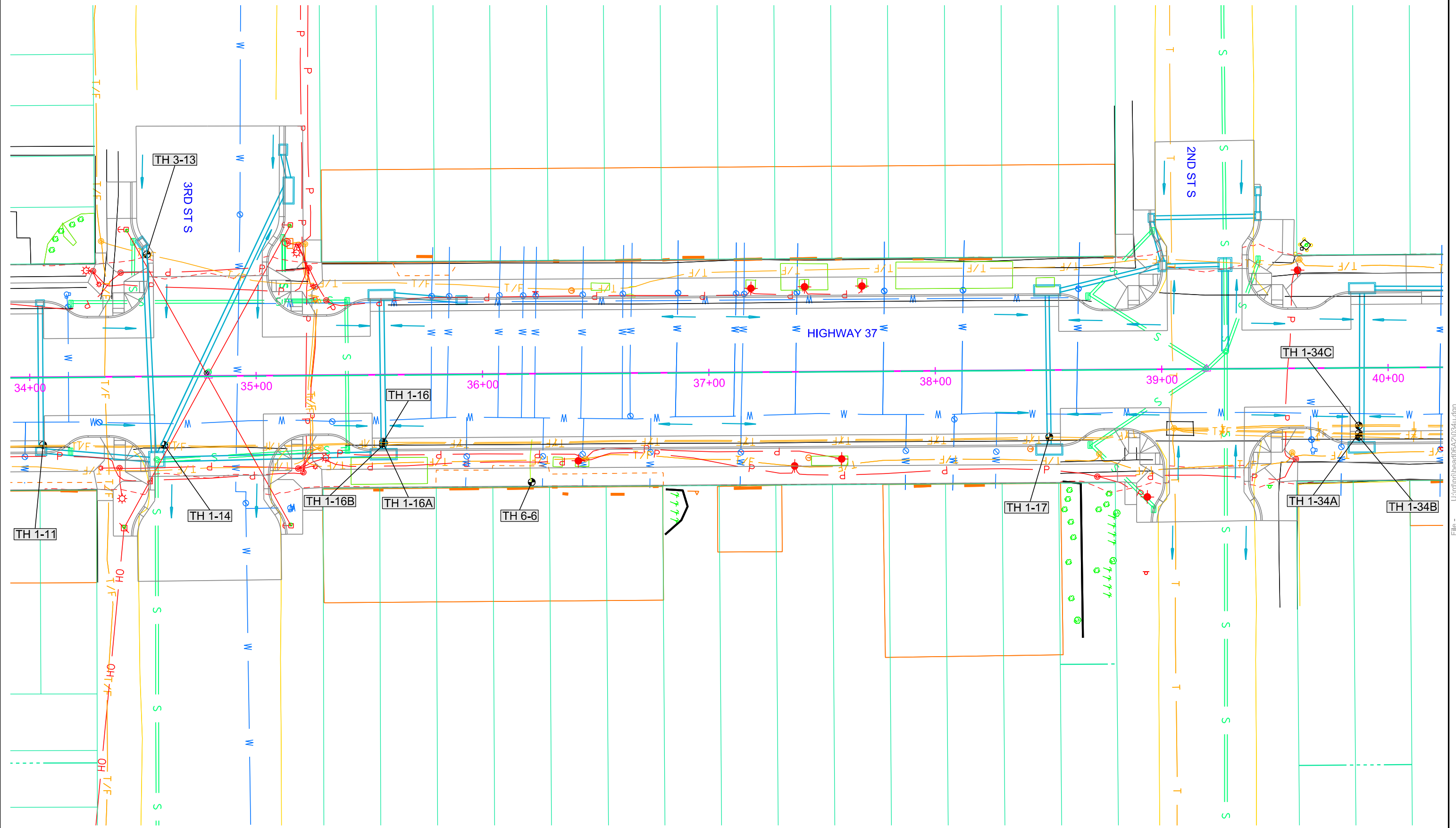



Plot Scale - 1:40

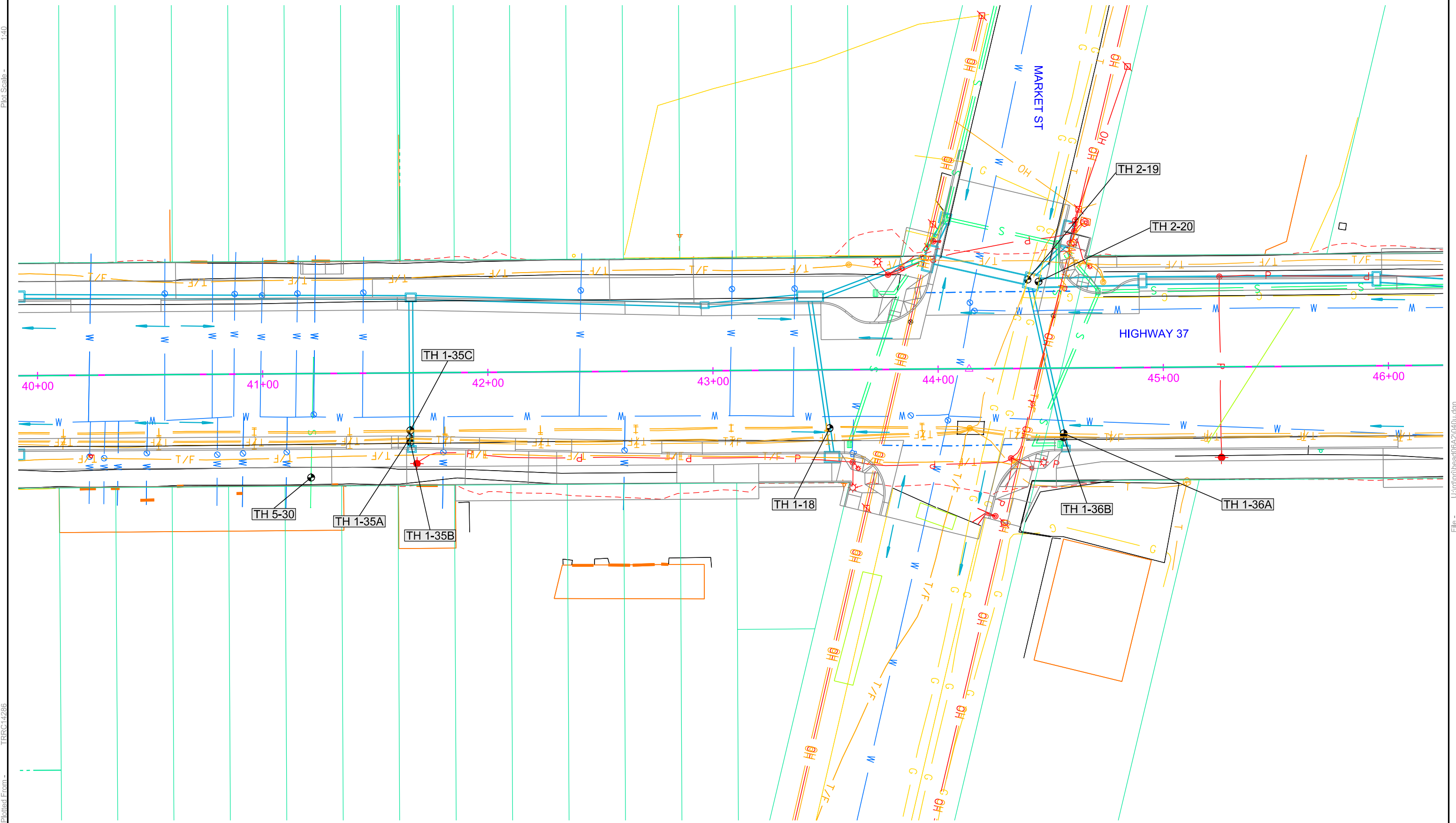

Plotted From - TRRC14286

File - U:\trc\proj\bead06A2\040u.dgn

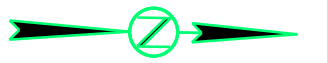

Plot Scale - 1:40

Plotted From - TRR014286

File - U:\trproj\bead06A2\046u.dgn

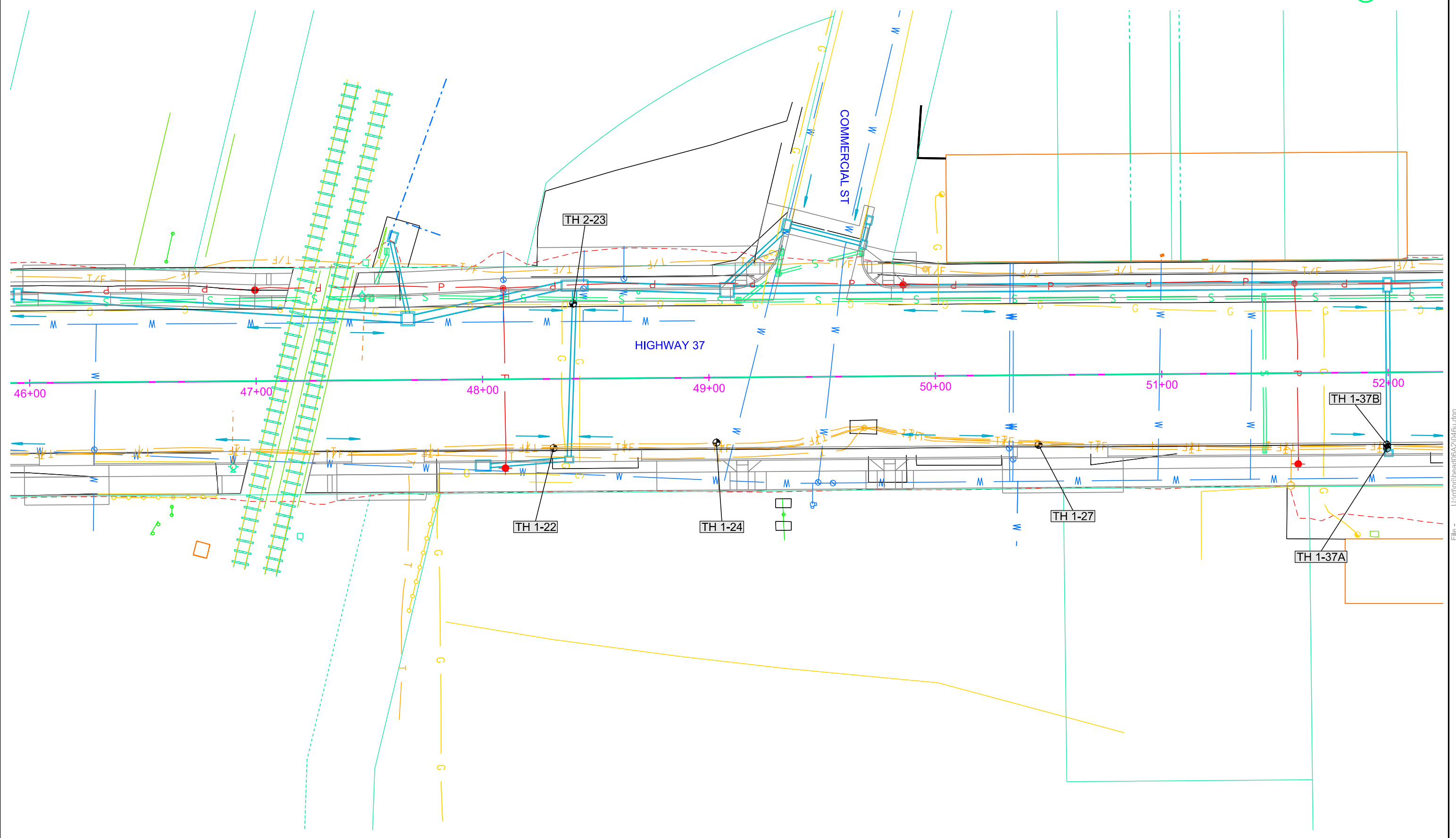

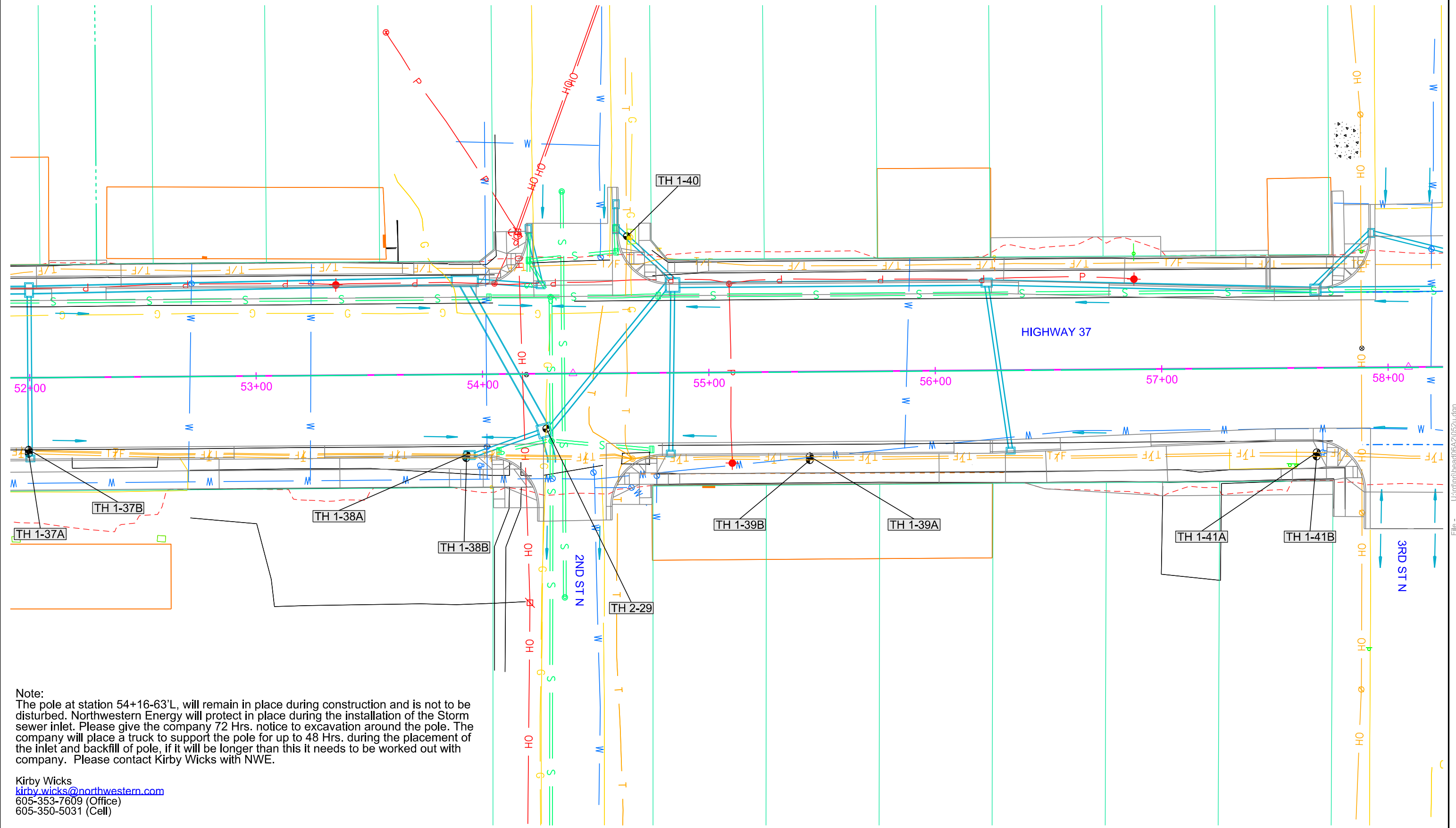

Note:
 The pole at station 54+16-63'L, will remain in place during construction and is not to be disturbed. Northwestern Energy will protect in place during the installation of the Storm sewer inlet. Please give the company 72 Hrs. notice to excavation around the pole. The company will place a truck to support the pole for up to 48 Hrs. during the placement of the inlet and backfill of pole, if it will be longer than this it needs to be worked out with company. Please contact Kirby Wicks with NWE.

Kirby Wicks
kirby.wicks@northwestern.com
 605-353-7609 (Office)
 605-350-5031 (Cell)

Plotted From: TRR014286
 Plot Scale: 1"=40'
 File: U:\tr\proj\bead06A2\052u.dgn

STATE OF SOUTH DAKOTA	PROJECT	SHEET	TOTAL SHEETS
	NH-CR 0037(158)126	U15	U15

Plotting Date: 12/12/2023

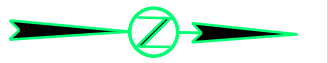

Plot Scale - 1:40

Plotted From - TRR014286

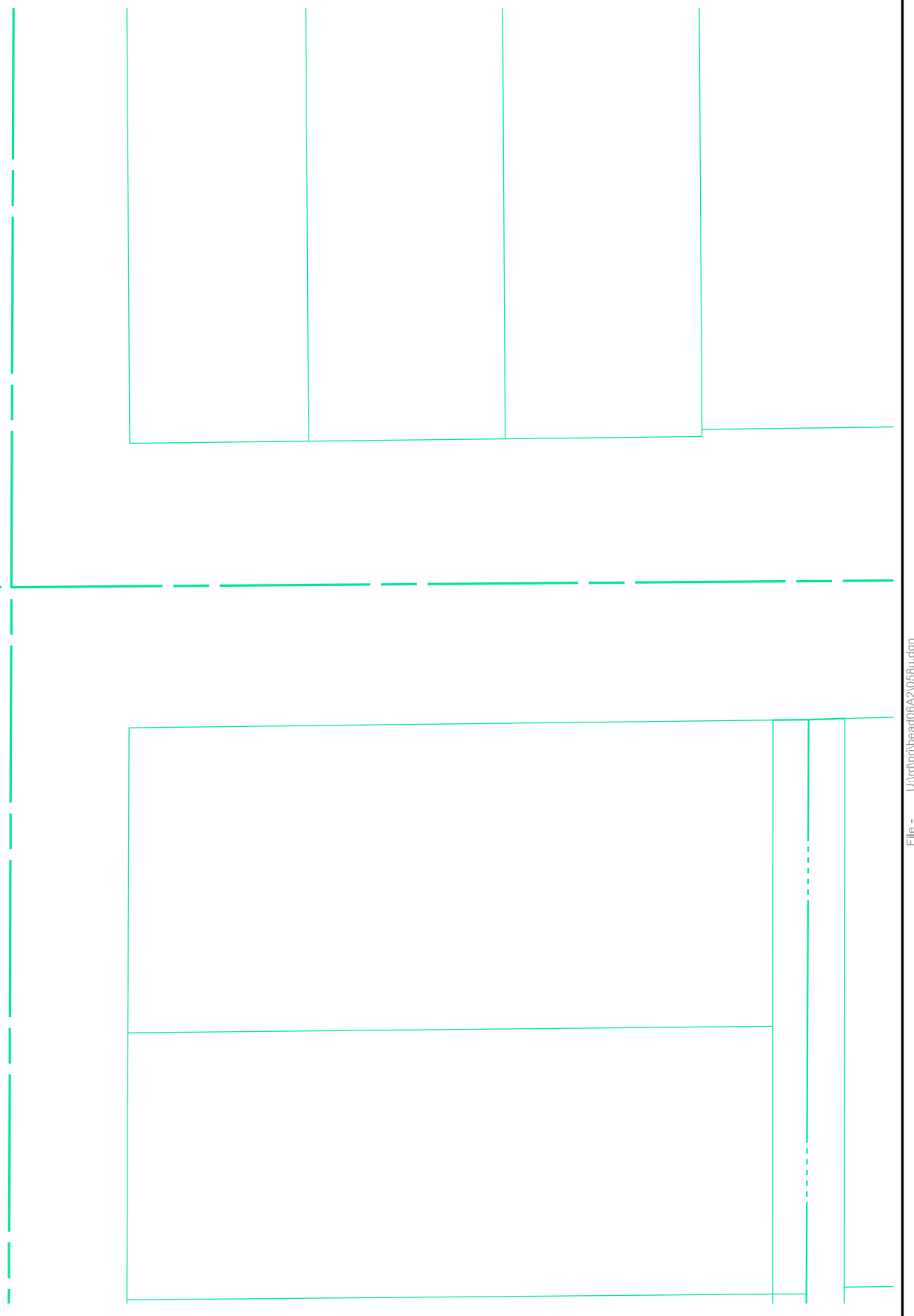
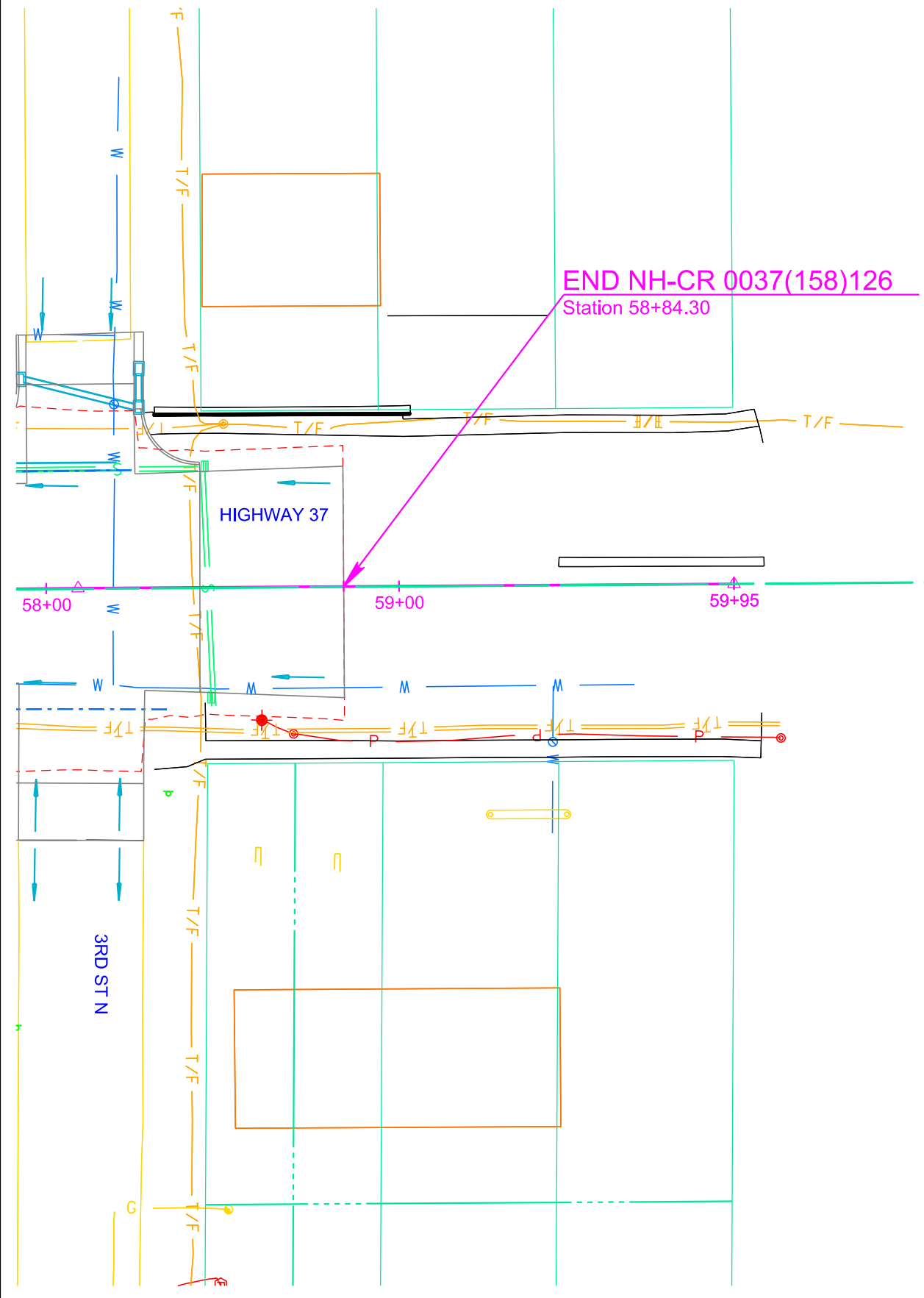

File - U:\trr\proj\bead06A2\058u.dgn