

SECTION C: TRAFFIC CONTROL PLANS

PCN 06G1 AND 06G2

STATE OF SOUTH DAKOTA	PROJECT	SHEET	TOTAL SHEETS
	NH 0212(202)38 P 0079(88)133	C1	C3

Plotting Date: 04/29/2024

INDEX OF SHEETS

C1	General Layout with Index
C2	Estimate with General Notes & Tables
C3	Standard Plates

Plot Scale - 1:200

Plotted From - TRBE-INT-18

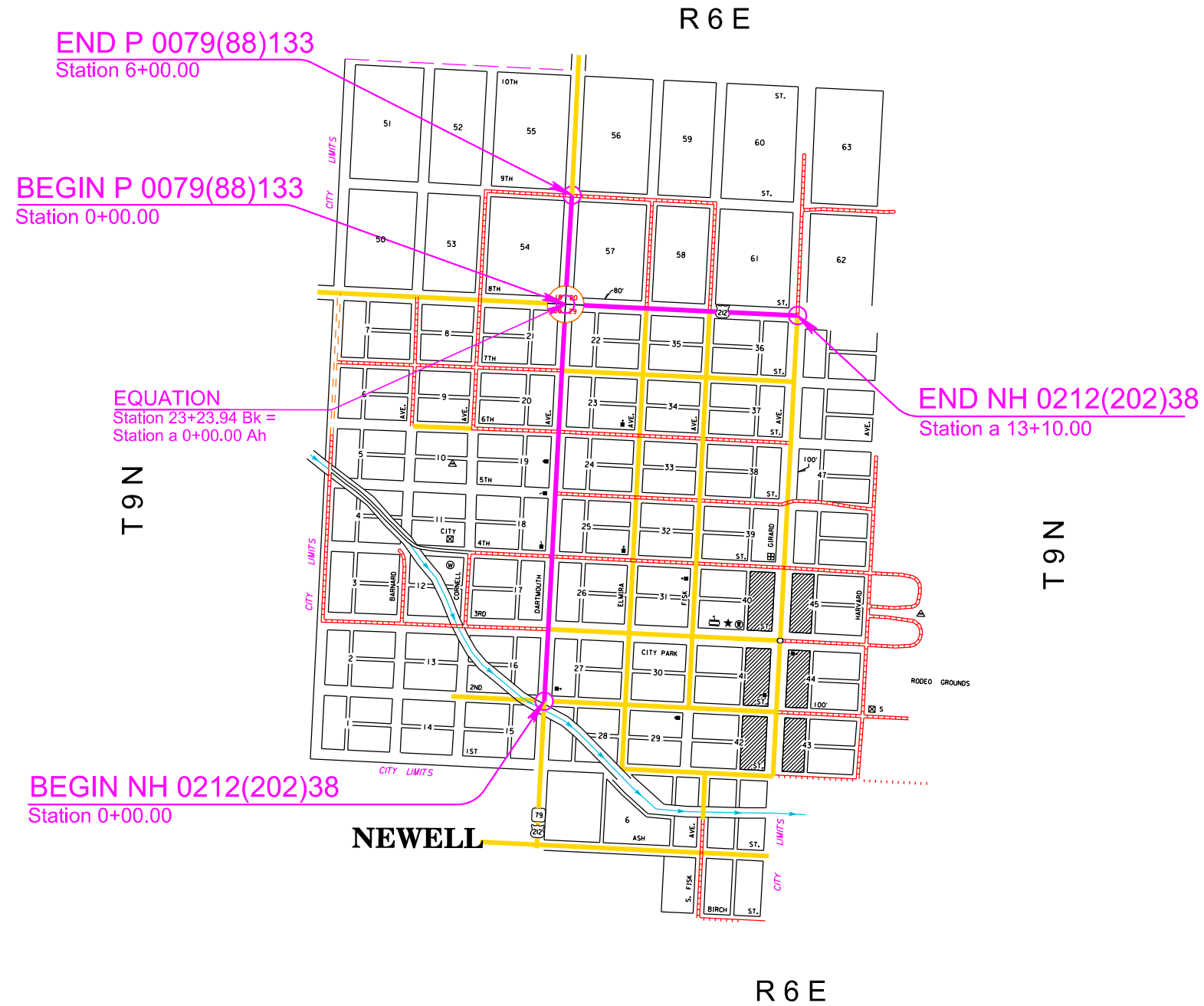

**SECTION C ESTIMATE OF QUANTITIES – PCN 06G1
SD HIGHWAY 79**

BID ITEM NUMBER	ITEM	QUANTITY	UNIT
634E0110	Traffic Control Signs	78.3	SqFt
634E0120	Traffic Control, Miscellaneous	Lump Sum	LS

**SECTION C ESTIMATE OF QUANTITIES – PCN 06G2
US HIGHWAY 212**

BID ITEM NUMBER	ITEM	QUANTITY	UNIT
634E0110	Traffic Control Signs	361.8	SqFt
634E0120	Traffic Control, Miscellaneous	Lump Sum	LS

SEQUENCE OF OPERATIONS

Contractor requests to deviate from the sequence of operations will be submitted in writing to the Engineer for review. Approval of an alternate sequence of operations will only be allowed when the proposed changes meet with the Department's intent for traffic control and sequencing of the work. An alternate sequence will be submitted for review a minimum of one week prior to potential implementation.

Two-way traffic will be maintained at all locations when work is not in progress. A 24-foot minimum wide driving surface will be required for two-way traffic. The Contractor will maintain a smooth and passable roadway for traffic as determined by the Engineer.

PCN 06G1 and 06G2

Phase I - Install the storm sewer on Fourth Street and Sixth Street (XR9R and XR16R).

Phase II – Complete the ADA Curb Ramps and sidewalk construction on the west side of US 212 (Dartmouth Ave), between Station 0+00 and 23+23, LT. Any work between Station 8+75 and 16+00, LT will be completed between mid-May and mid-August, when school is not in session.

Phase III – Complete the ADA Curb Ramps and sidewalk construction on the east side of US 212 (Dartmouth Ave), between Station 0+00 to 23+23, RT.

The construction of the ADA Curb Ramps and sidewalk on SD 79 between Station 0+00 and 6+00, may be completed at any time prior to the project completion date.

The construction of the ADA Curb Ramps and sidewalk on US 212 between Station a 0+00 to a 13+10, RT may be completed at any time prior to the project completion date.

GENERAL TRAFFIC CONTROL

Existing guide, route, informational logo, regulatory, and warning signs will be temporarily reset and maintained during construction. Removing, relocating, covering, salvaging, and resetting of existing traffic control devices, including delineation, will be the responsibility of the Contractor. Cost for this work will be incidental to the contract unit prices for the various items unless otherwise specified in the plans. Any delineators and signs damaged or lost will be replaced by the Contractor at no cost to the State.

GENERAL TRAFFIC CONTROL (CONTINUED)

All temporary traffic control sign locations will be set in the field by the Contractor and verified by the Engineer prior to installation.

Portable sign supports will not be located on sidewalks, bicycle facilities, or other areas designated for pedestrian or bicycle traffic. Signs mounted on portable supports will meet the height requirements shown on Standard Plate 634.85 if located in the same location for longer than 3 days.

All construction operations will be conducted in the general direction of traffic movement.

If there is a discrepancy between the traffic control plans, standard plates, and the MUTCD, whichever is more stringent will be used, as determined by the Engineer.

Unless otherwise stated in these plans, work will not be allowed during hours of darkness.

Fixed location signing placed more than 4 calendar days prior to the start of construction will be covered or laid down until the time of construction. The covers must be approved by the Engineer prior to installation. The cost of materials, labor, and equipment necessary to complete this work will be incidental to other contract items. No separate payment will be made.

All fixed location signs, sign posts, and breakaway bases will be removed within 7 calendar days following pavement marking.

Traffic will be maintained on the driving lanes. Use of the shoulder as a driving lane will not be permitted. Any damage to the shoulder due to rerouted traffic or Contractor's equipment will be repaired at no expense to the Department.

The Contractor will notify businesses/homeowners a minimum of two weeks prior to construction to inform them of upcoming construction and again a minimum of 48 hours prior to any blocked access to make appropriate arrangements.

**TABLE OF FIXED TRAFFIC CONTROL SIGNS – PCN 06G1
SD HIGHWAY 79**

Location	MRM or Location	Side of Road	Description
9th St SD 79	Newell 134.5	L & R L	Road Work Ahead (2) End Road Work (1)
			Road Work Ahead = 2 End Road Work = 1

**TABLE OF FIXED TRAFFIC CONTROL SIGNS – PCN 06G2
US HIGHWAY 212**

Location	MRM or Location	Side of Road	Description
Ash St	Newell	R	Road Work Ahead (1)
2nd St	Newell	L & R	Road Work Ahead (2)
3rd St	Newell	L & R	Road Work Ahead (2)
4th St	Newell	L & R	Road Work Ahead (2)
5th St	Newell	R	Road Work Ahead (1)
6th St	Newell	L & R	Road Work Ahead (2)
7th St	Newell	L & R	Road Work Ahead (2)
8 th St	Newell	L & R	Road Work Ahead (2)
Elmira Ave	Newell	L & R	Road Work Ahead (2)
Fisk Ave	Newell	L & R	Road Work Ahead (2)
Girard Ave	Newell	L & R	Road Work Ahead (2)
			Road Work Ahead = 20

Payment for fixed traffic control signs will be based on the contract unit price per square foot for "Traffic Control Signs".

**ITEMIZED LIST FOR TRAFFIC CONTROL SIGNS – PCN 06G1
SD HIGHWAY 79**

SIGN CODE	SIGN DESCRIPTION	CONVENTIONAL ROAD			
		NUMBER	SIGN SIZE	SQFT PER SIGN	SQFT
R9-9	SIDEWALK CLOSED	2	24" x 12"	2.0	4.0
R9-10	SIDEWALK CLOSED (ARROW L or R) USE OTHER SIDE	2	24" x 12"	2.0	4.0
R9-11	SIDEWALK CLOSED AHEAD (ARROW L or R) CROSS HERE	2	24" x 18"	3.0	6.0
R9-11a	SIDEWALK CLOSED (ARROW L or R) CROSS HERE	2	24" x 12"	2.0	4.0
W11-2	PEDESTRIAN (symbol)	2	36" x 36"	9.0	18.0
W16-7P	DOWNWARD DIAGONAL ARROW (plaque)	1	24" x 12"	2.0	2.0
W16-9P	AHEAD (plaque)	1	30" x 18"	3.8	3.8
W20-1	ROAD WORK AHEAD	2	48" x 48"	16.0	32.0
G20-2	END ROAD WORK	1	36" x 18"	4.5	4.5
CONVENTIONAL ROAD TRAFFIC CONTROL SIGNS SQFT					78.3

**ITEMIZED LIST FOR TRAFFIC CONTROL SIGNS – PCN 06G2
US HIGHWAY 212**

SIGN CODE	SIGN DESCRIPTION	CONVENTIONAL ROAD			
		NUMBER	SIGN SIZE	SQFT PER SIGN	SQFT
R9-9	SIDEWALK CLOSED	2	24" x 12"	2.0	4.0
R9-10	SIDEWALK CLOSED (ARROW L or R) USE OTHER SIDE	2	24" x 12"	2.0	4.0
R9-11	SIDEWALK CLOSED AHEAD (ARROW L or R) CROSS HERE	2	24" x 18"	3.0	6.0
R9-11a	SIDEWALK CLOSED (ARROW L or R) CROSS HERE	2	24" x 12"	2.0	4.0
W11-2	PEDESTRIAN (symbol)	2	36" x 36"	9.0	18.0
W16-7P	DOWNWARD DIAGONAL ARROW (plaque)	1	24" x 12"	2.0	2.0
W16-9P	AHEAD (plaque)	1	30" x 18"	3.8	3.8
W20-1	ROAD WORK AHEAD	20	48" x 48"	16.0	320.0
CONVENTIONAL ROAD TRAFFIC CONTROL SIGNS SQFT					361.8

Plotted From: TRBE:INT:18 1:200 File: ...106G2_StandardPlates.dgn

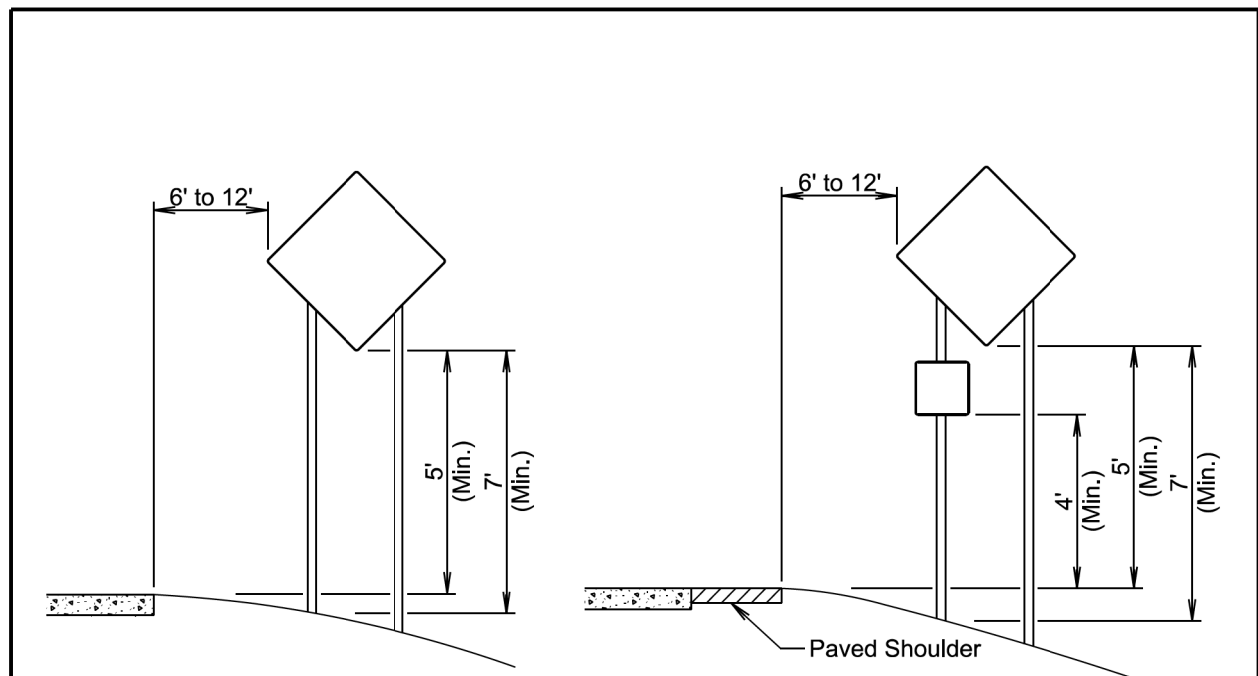

RURAL DISTRICT

RURAL DISTRICT WITH SUPPLEMENTAL PLATE

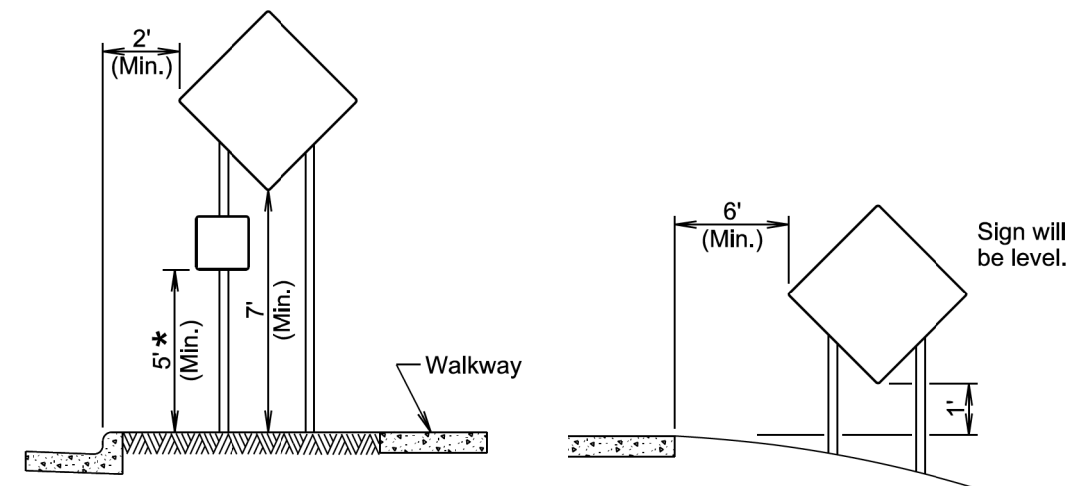

URBAN DISTRICT

RURAL DISTRICT 3 DAY MAXIMUM
(Not applicable to regulatory signs)

* If the bottom of supplemental plate is mounted lower than 7 feet above a pedestrian walkway, the supplemental plate should not project more than 4" into the pedestrian facility.

January 22, 2021

Published Date: 2024	S D D O T	CRASHWORTHY SIGN SUPPORTS (Typical Construction Signing)	PLATE NUMBER 634.85
			Sheet 1 of 1

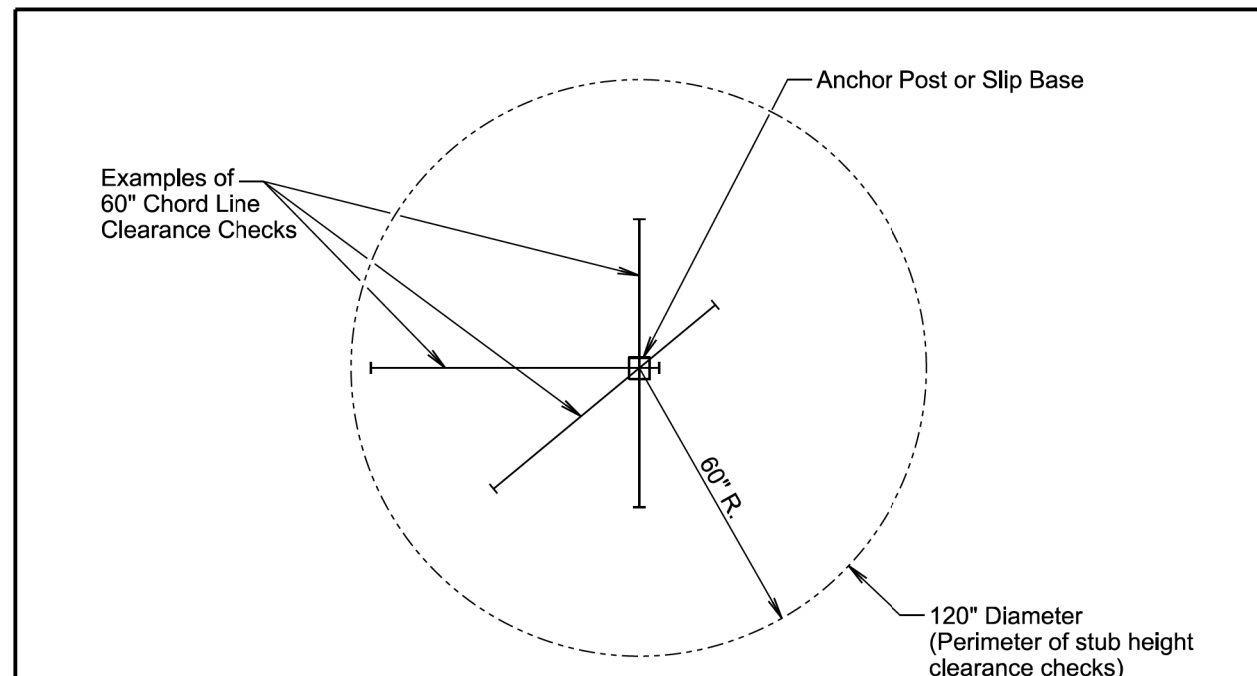

PLAN VIEW
(Examples of stub height clearance checks)

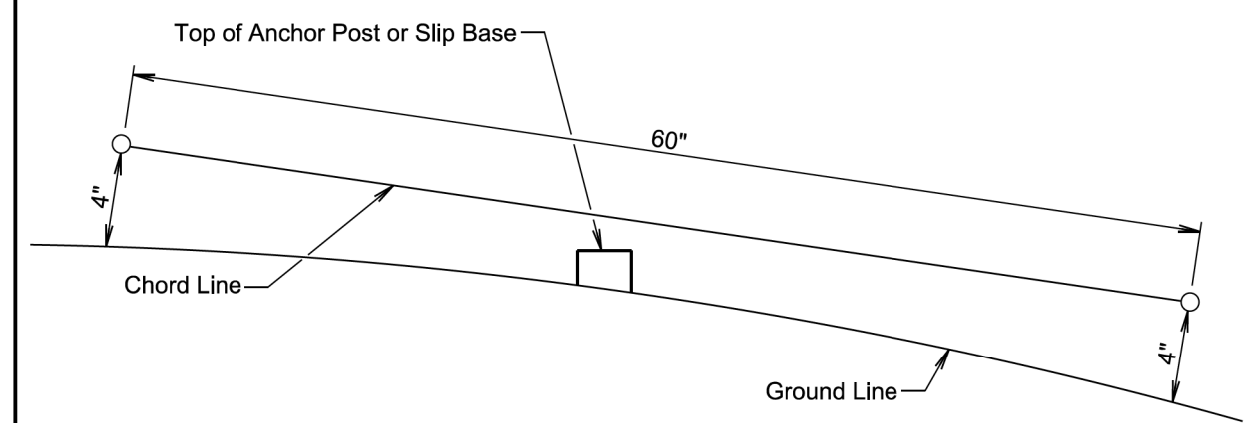

ELEVATION VIEW

GENERAL NOTES:

The top of anchor posts and slip bases WILL NOT extend above a 60" chord line within a 120" diameter circle around the post with ends 4" above the ground.

At locations where there is curb and gutter adjacent to the breakaway sign support, the stub height will be a maximum of 4" above the ground line at the localized area adjacent to the breakaway support stub.

The 4" stub height clearance is not necessary for U-channel lap splices where the support is designed to yield (bend) at the base.

January 22, 2021

Published Date: 2024	S D D O T	BREAKAWAY SUPPORT STUB CLEARANCE	PLATE NUMBER 634.99
			Sheet 1 of 1