

STATE OF SOUTH DAKOTA	PROJECT	SHEET	TOTAL SHEETS
	IM 0909(92)387	1	422

Plotting Date: 8/12/2024



STATE OF SOUTH DAKOTA
DEPARTMENT OF TRANSPORTATION
PLANS FOR PROPOSED

PROJECT IM 0909(92)387
INTERSTATE 90
& WESTERN AVE
MINNEHAHA COUNTY
STRUCTURE, GRADING, PCC SURFACING,
AC SURFACING, LIGHTING, PAVEMENT MARKING,
& PERMANENT SIGNING
PCN 06G8

INDEX OF SECTIONS

- Section A: Estimate of Quantities and Environmental Commitments
- Section B: Grading Plans
- Section C: Traffic Control Plans
- Section D: Erosion and Sediment Control Plans
- Section E: Structure Plans
- Section F: Surfacing Plans
- Section L: Signal and Lighting Plans
- Section M: Pavement Marking Plans
- Section S: Permanent Signing Plans
- Section X: Cross Sections
- Section Z: Pipe Sections

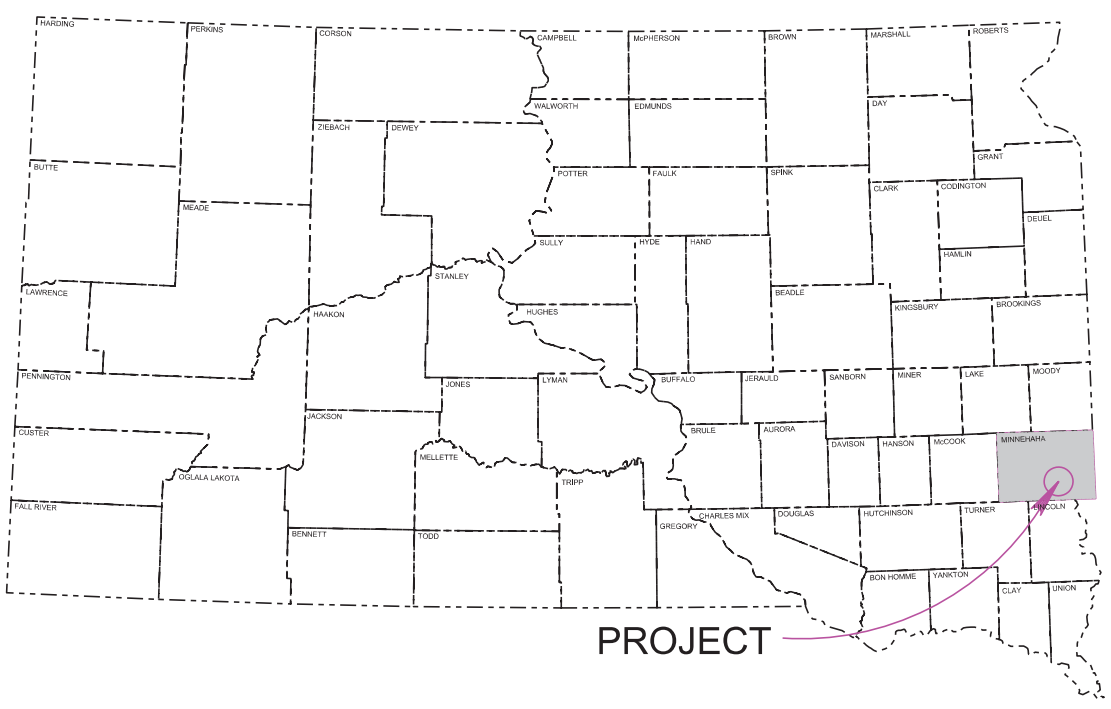

PROJECT

END IM 0909(92)387
END PROJECT

STA. 29+10.00
Approximately 1321.03' South and
49.85' East of The Northeast corner of
Section 28 - Township 102 North - Range 51 West

END IM 0909(92)387
END PROJECT

STA. 564+55.66 on I-90
Approximately 2575.76' South and
1400.30' East of The Northwest corner of
Section 27 - Township 102 North
- Range 51 West
MRM 387.76

BEGIN IM 0909(92)387
BEGIN PROJECT

STA. 2+00.00
Approximately 1135.93' North and
43.34' West of The Southwest corner of
Section 27 - Township 102 North
- Range 51 West

WESTERN AVE		I 90	
DESIGN DESIGNATION		DESIGN DESIGNATION	
AAADT (2018)	4510	AAADT (2018)	13900
AAADT (2050)	7400	AAADT (2050)	25800
DHV	605	DHV	1610
D	50%	D	50%
DHV T%	4.0%	DHV T%	18.6%
AAADT T%	7.7%	AAADT T%	19.2%
V	50 mph	V	80 mph

RAMP A		RAMP B	
DESIGN DESIGNATION		DESIGN DESIGNATION	
AAADT (2018)	1670	AAADT (2018)	1840
AAADT (2050)	3070	AAADT (2050)	3270
DHV	475	DHV	510
D	100%	D	100%
DHV T%	3.5%	DHV T%	4.1%
AAADT T%	10.7%	AAADT T%	9.5%
V	50 mph	V	50 mph

RAMP C		RAMP D	
DESIGN DESIGNATION		DESIGN DESIGNATION	
AAADT (2018)	510	AAADT (2018)	710
AAADT (2050)	580	AAADT (2050)	1400
DHV	70	DHV	115
D	100%	D	100%
DHV T%	0.8%	DHV T%	3.2%
AAADT T%	11.2%	AAADT T%	10.6%
V	50 mph	V	50 mph

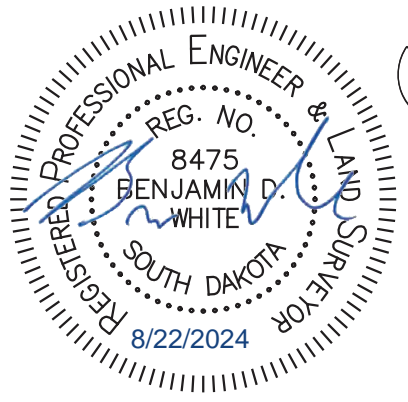

BEGIN IM 0909(92)387
BEGIN PROJECT
STA. 538+06.66 on I-90
Approximately 2690.43' South and
1246.21' West of The Northeast corner of
Section 28 - Township 102 North - Range 51 West
MRM 387.18

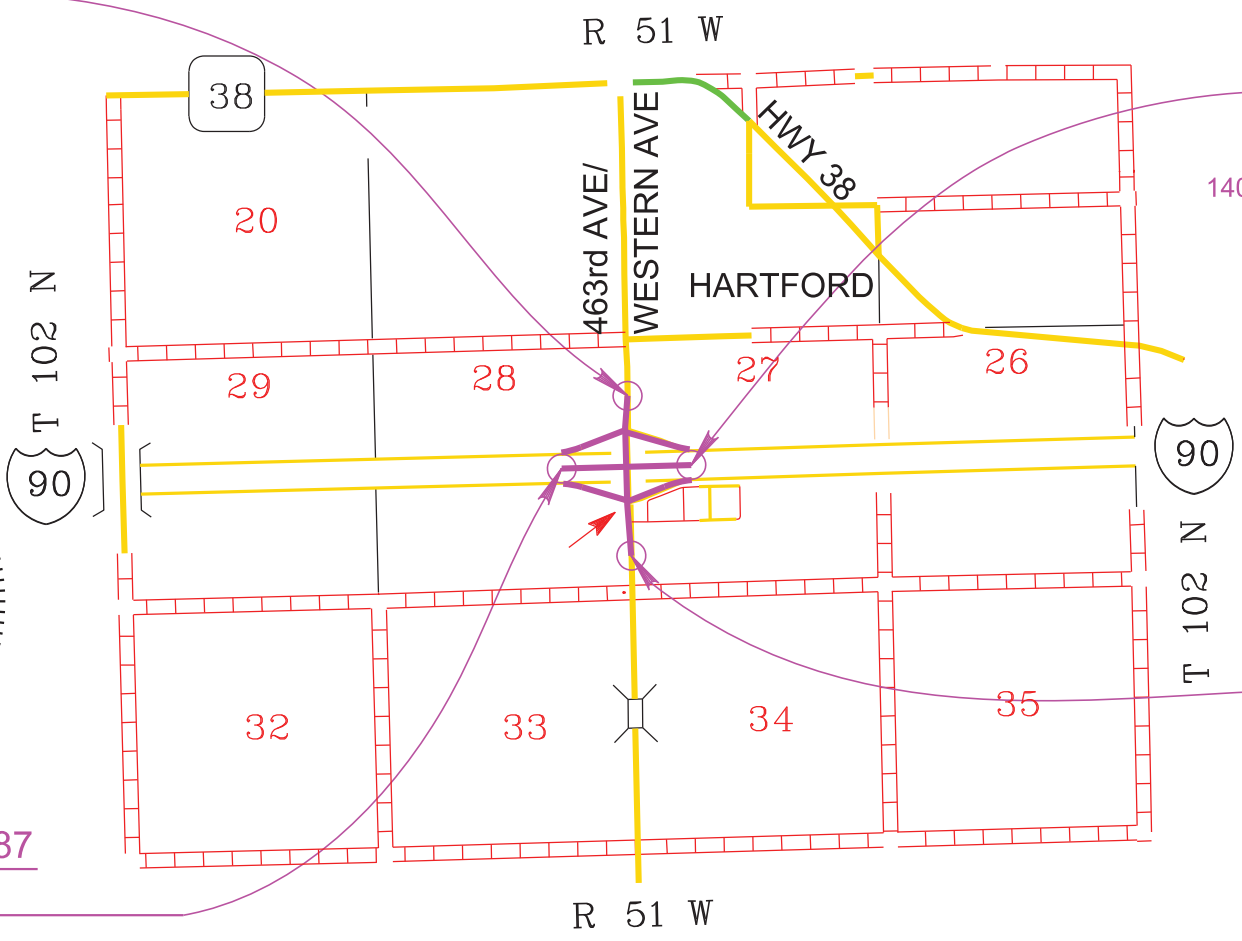

	I-90		Western Ave	
Gross Length	2649.00 Feet	0.502 Miles	2710.00 Feet	0.514 Miles
Length of Exceptions	0.00 Feet	0.00 Miles	0.00 Feet	0.00 Miles
Net Length	2649.00 Feet	0.502 Miles	2710.00 Feet	0.514 Miles



1

March 5, 2025

Plot Scale - 1:200

Plotted From - bryce.steffen

File - ...IPCN_06G8\Design\Title_A.dgn

ESTIMATE OF QUANTITIES AND ENVIRONMENTAL COMMITMENTS

FOR BIDDING PURPOSES ONLY

STATE OF SOUTH DAKOTA	PROJECT	SHEET	TOTAL SHEETS
	IM 0909(92)387	A1	A6

PCN 06G8 Section B – Grading

BID ITEM NUMBER	ITEM	QUANTITY	UNIT
009E0010	Mobilization	Lump Sum	LS
009E3220	Reestablish Right-of-Way and Property Corner	50	Each
009E3225	Reestablish Public Land Survey System Corner	1	Each
009E3230	Grade Staking	3.757	Mile
009E3250	Miscellaneous Staking	1.705	Mile
009E3280	Slope Staking	1.705	Mile
009E3290	Structure Staking	1	Each
009E3301	Engineer Directed Surveying/Staking	40.0	Hour
009E4300	Construction Schedule, Category III	Lump Sum	LS
009E4330	Project Management, Category III	Lump Sum	LS
100E0100	Clearing	Lump Sum	LS
110E0300	Remove Concrete Curb and/or Gutter	166	Ft
110E0400	Remove Drop Inlet	4	Each
110E0600	Remove Fence	3,539	Ft
110E0700	Remove 3 Cable Guardrail	1,612	Ft
110E0730	Remove Beam Guardrail	745.4	Ft
110E0740	Remove 3 Cable Guardrail Anchor Assembly	8	Each
110E0800	Remove W Beam Guardrail End Terminal	6	Each
110E1010	Remove Asphalt Concrete Pavement	27,222.7	SqYd
110E1050	Remove Asphalt Concrete Approach Pavement	896.2	SqYd
110E5451	Salvage Riprap	4.2	Ton
110E7500	Remove Pipe for Reset	28	Ft
110E7510	Remove Pipe End Section for Reset	2	Each
110E7515	Remove Pipe Bend for Reset	2	Each
120E0010	Unclassified Excavation	58,177	CuYd
120E0500	Option Borrow Excavation	180,808	CuYd
120E0600	Contractor Furnished Borrow	53,471	CuYd
120E0900	Contaminated Material Excavation	100	CuYd
120E1000	Muck Excavation	5,288	CuYd
120E2000	Undercutting	15,421	CuYd
120E6100	Water for Embankment	2,128.1	MGal
120E9000	Pit Run	3,010.0	Ton
240E0010	Oblliterate Old Road	4	Sla
250E0020	Incidental Work, Grading	Lump Sum	LS
270E0110	Salvage and Stockpile Granular Material	11,123.9	Ton
450E0122	18" RCP Class 2, Furnish	1,500	Ft
450E0130	18" RCP, Install	1,500	Ft
450E0162	30" RCP Class 2, Furnish	38	Ft
450E0163	30" RCP Class 3, Furnish	132	Ft
450E0164	30" RCP Class 4, Furnish	66	Ft
450E0170	30" RCP, Install	236	Ft
450E0182	36" RCP Class 2, Furnish	214	Ft
450E0190	36" RCP, Install	214	Ft

PCN 06G8 Section B – Grading (Continued)

BID ITEM NUMBER	ITEM	QUANTITY	UNIT
450E2008	18" RCP Flared End, Furnish	2	Each
450E2009	18" RCP Flared End, Install	2	Each
450E2024	30" RCP Flared End, Furnish	5	Each
450E2025	30" RCP Flared End, Install	5	Each
450E2204	30" RCP Sloped End, Furnish	3	Each
450E2205	30" RCP Sloped End, Install	3	Each
450E2304	18" RCP Safety End, Furnish	1	Each
450E2307	18" RCP Safety End, Install	1	Each
450E4758	18" CMP 14 Gauge, Furnish	254	Ft
450E4760	18" CMP, Install	254	Ft
450E4778	30" CMP 14 Gauge, Furnish	18	Ft
450E4780	30" CMP, Install	18	Ft
450E5010	18" CMP Elbow, Furnish	8	Each
450E5011	18" CMP Elbow, Install	8	Each
450E5211	18" CMP Flared End, Furnish	4	Each
450E5212	18" CMP Flared End, Install	4	Each
450E5219	30" CMP Flared End, Furnish	1	Each
450E5220	30" CMP Flared End, Install	1	Each
450E5508	18" CMP Arch 14 Gauge, Furnish	38	Ft
450E5510	18" CMP Arch, Install	38	Ft
450E5802	18" CMP Arch Flared End, Furnish	2	Each
450E5803	18" CMP Arch Flared End, Install	2	Each
450E8009	18" RCP to CMP Transition, Furnish	4	Each
450E8010	18" Pipe Transition, Install	4	Each
450E9000	Reset Pipe	28	Ft
450E9001	Reset Pipe End Section	2	Each
450E9005	Reset Pipe Bend	2	Each
462E0100	Class M6 Concrete	45.7	CuYd
480E0100	Reinforcing Steel	8,710	Lb
620E0020	Type 2 Right-of-Way Fence	4,779	Ft
620E1020	2 Post Panel	38	Each
620E1030	3 Post Panel	13	Each
629E0110	High Tension 4 Cable Guardrail	1,172	Ft
629E0290	High Tension Cable Guardrail Anchor Assembly	4	Each
630E0540	Type 4 MGS	200.0	Ft
630E1500	Type 1 Guardrail Transition	4	Each
630E2018	MGS MASH Tangent End Terminal	4	Each
650E1090	Type F69 Concrete Curb and Gutter	3,158	Ft
650E1390	Type FL69 Concrete Curb and Gutter	281	Ft
650E4390	Type D49 Concrete Curb and Gutter	242	Ft
650E4690	Type P9 Concrete Gutter	448	Ft
651E0040	4" Concrete Sidewalk	7,972	SqFt
651E0060	6" Concrete Sidewalk	19,770	SqFt

PCN 06G8 Section B – Grading (Continued)

BID ITEM NUMBER	ITEM	QUANTITY	UNIT
651E7000	Type 1 Detectable Warnings	312	SqFt
670E0200	Type A Frame and Grate	2	Each
670E1200	Type B Frame and Grate	20	Each
670E3300	Type E Frame and Grate	4	Each
670E5350	Special Precast Concrete Type S Drop Inlet Lid	1	Each
670E5400	Precast Drop Inlet Collar	27	Each
671E6007	Type A7 Manhole Frame and Lid	1	Each
671E6030	Type S Manhole Frame and Lid	1	Each
700E0110	Class A Riprap	198.4	Ton
700E2010	Place Riprap	4.2	Ton
831E0110	Type B Drainage Fabric	238	SqYd
831E0210	Non-woven Separator Fabric	3,080	SqYd
900E0010	Refurbish Single Mailbox	2	Each
900E0012	Refurbish Double Mailbox	2	Each

INDEX OF SHEETS

A1 and A3 Estimate of Quantities for Sections B, C, D, E, F, L, M, and S
 A4 to A6 Environmental Commitments

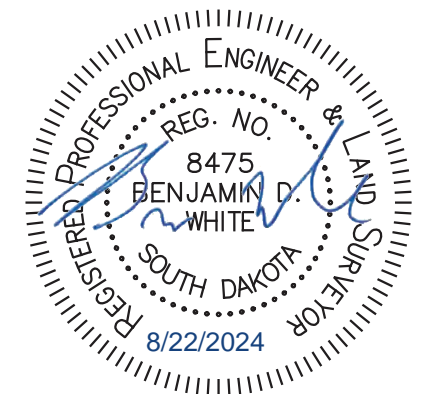

ESTIMATE OF QUANTITIES AND ENVIRONMENTAL COMMITMENTS

FOR BIDDING PURPOSES ONLY

STATE OF SOUTH DAKOTA	PROJECT	SHEET	TOTAL SHEETS
	IM 0909(92)387	A2	A6

PCN 06G8 Section C – Traffic Control

BID ITEM NUMBER	ITEM	QUANTITY	UNIT
634E0010	Flagging	200.0	Hour
634E0110	Traffic Control Signs	3,030.6	SqFt
634E0120	Traffic Control, Miscellaneous	Lump Sum	LS
634E0275	Type 3 Barricade	24	Each
634E0330	Temporary Raised Pavement Markers	29,410	Ft
634E0380	Tubular Marker	775	Each
634E0390	Replace Tubular Marker	100	Each
634E0420	Type C Advance Warning Arrow Board	6	Each
634E0525	Linear Delineation System Panel, Barrier Mounted	124	Each
634E0560	Remove Pavement Marking, 4" or Equivalent	9,500	Ft
634E0640	Temporary Pavement Marking	44,470	Ft
634E0700	Traffic Control Movable Concrete Barrier	124	Each
634E0705	Remove and Reset Traffic Control Movable Concrete Barrier	66	Each
634E0750	Temporary Concrete Barrier End Protection	4	Each
634E0760	Temporary Concrete Barrier End Protection Module Set or Repair Kit	1	Each
634E1215	Contractor Furnished Portable Changeable Message Sign	1	Each

PCN 06G8 Section E – Structure Structure No. 50-090-165

BID ITEM NUMBER	ITEM	QUANTITY	UNIT
009E3310	Bridge Elevation Survey	Lump Sum	LS
009E5000	Concrete Penetrating Sealer	1,758.0	SqYd
120E7000	Select Granular Backfill	27.4	Ton
250E0030	Incidental Work, Structure	Lump Sum	LS
260E2010	Gravel Cushion	1,594.0	Ton
410E0026	Structural Steel, Install	Lump Sum	LS
410E2600	Membrane Sealant Expansion Joint	117.8	Ft
420E0100	Structure Excavation, Bridge	225	CuYd
430E0200	Bridge End Embankment	965	CuYd
430E0300	Granular Bridge End Backfill	89.8	CuYd
460E0030	Class A45 Concrete, Bridge Deck	502.3	CuYd
460E0050	Class A45 Concrete, Bridge	248.6	CuYd
460E0150	Concrete Approach Slab for Bridge	199.7	SqYd
460E0160	Concrete Approach Sleeper Slab for Bridge	70.7	SqYd
460E0380	Install Dowel in Concrete	760	Each
460E0500	Deck Drain, Girder Bridge	30	Each
470E0120	Steel Pedestrian Railing on Sidewalk	547.5	Ft
470E0220	Steel Pedestrian Railing on Concrete Barrier	507.0	Ft
480E0100	Reinforcing Steel	56,988	Lb
480E0200	Epoxy Coated Reinforcing Steel	3,190	Lb
480E0300	Stainless Reinforcing Steel	120,670	Lb
480E0509	No. 9 Rebar Splice	4	Each
480E0511	No. 11 Rebar Splice	28	Each
480E0514	No. 14 Rebar Splice	84	Each
510E0100	Extract Pile	5	Each
510E0300	Preboring Pile	240	Ft
510E3401	HP 12x53 Steel Test Pile, Furnish and Drive	275	Ft
510E3405	HP 12x53 Steel Bearing Pile, Furnish and Drive	6,700	Ft
621E0300	Chain Link Fence for Bridge Sidewalk	548	Ft
651E0160	6" Reinforced Concrete Sidewalk	610	SqFt
734E2022	Bridge Berm Slope Protection, Quarried Aggregate	511.0	SqYd
831E1030	Perforated Geocell	783	SqFt

PCN 06G8 Section F – Surfacing

BID ITEM NUMBER	ITEM	QUANTITY	UNIT
004E0050	Remove Traffic Diversion(s)	Lump Sum	LS
120E6200	Water for Granular Material	222.8	MGal
260E1010	Base Course	6,767.3	Ton
260E2030	Gravel Cushion, Salvaged	11,084.8	Ton
260E3010	Gravel Surfacing	684.1	Ton
320E1200	Asphalt Concrete Composite	2,891.8	Ton
380E0070	9" Nonreinforced PCC Pavement	27,846.0	SqYd
380E6000	Dowel Bar	12,999	Each
380E6110	Insert Steel Bar in PCC Pavement	60	Each
410E2600	Membrane Sealant Expansion Joint	86.6	Ft
600E0300	Type III Field Laboratory	1	Each

PCN 06G8 Section L – Signal and Lighting

BID ITEM NUMBER	ITEM	QUANTITY	UNIT
635E0050	Breakaway Base Luminaire Pole with Arm, 50' Mounting Height	40	Each
635E0150	Breakaway Base Luminaire Pole with Twin Arms, 50' Mounting Height	16	Each
635E3700	Roadway Luminaire, LED with Photoelectric Cell	72	Each
635E5020	2' Diameter Footing	464.0	Ft
635E5301	Type 1 Electrical Junction Box	3	Each
635E5302	Type 2 Electrical Junction Box	1	Each
635E5303	Type 3 Electrical Junction Box	10	Each
635E5400	Electrical Service Cabinet	2	Each
635E8120	2" Rigid Conduit, Schedule 40	12,135	Ft
635E8130	3" Rigid Conduit, Schedule 40	30	Ft
635E8220	2" Rigid Conduit, Schedule 80	790	Ft
635E8310	1" Innerduct, Schedule 40	12,210	Ft
635E9011	1/C #1 AWG Copper Wire	11,330	Ft
635E9014	1/C #4 AWG Copper Wire	12,030	Ft
635E9018	1/C #8 AWG Copper Wire	27,340	Ft
635E9020	1/C #10 AWG Copper Wire	12,610	Ft
635E9710	2/C #10 AWG Copper Pole and Bracket Cable	4,840	Ft

PCN 06G8 Section D – Erosion and Sediment Control

BID ITEM NUMBER	ITEM	QUANTITY	UNIT
110E1690	Remove Sediment	9.4	CuYd
110E1693	Remove Erosion Control Wattle	255	Ft
110E1695	Remove Sediment Filter Bag	732	Ft
110E1700	Remove Silt Fence	3,242	Ft
230E0010	Placing Topsoil	28,941	CuYd
730E0100	Cover Crop Seeding	52.1	Bu
730E0212	Type G Permanent Seed Mixture	457	Lb
731E0200	Fertilizing	17.80	Ton
732E0100	Mulching	36.2	Ton
732E0500	Fiber Reinforced Matrix	18.3	Ton
734E0103	Type 3 Erosion Control Blanket	5,996	SqYd
734E0154	12" Diameter Erosion Control Wattle	1,020	Ft
734E0165	Remove and Reset Erosion Control Wattle	255	Ft
734E0180	Sediment Filter Bag	732	Ft
734E0185	Remove and Reset Sediment Filter Bag	183	Ft
734E0325	Surface Roughening	14.0	Acre
734E0510	Shaping for Erosion Control Blanket	2,360	Ft
734E0602	Low Flow Silt Fence	11,855	Ft
734E0604	High Flow Silt Fence	1,112	Ft
734E0610	Mucking Silt Fence	900	CuYd
734E0620	Repair Silt Fence	3,242	Ft
734E0845	Sediment Control at Inlet with Frame and Grate	26	Each
734E0847	Sediment Control at Type S Reinforced Concrete Drop Inlet	13	Ft
900E1320	Construction Entrance	2	Each
900E5147	Articulated Concrete Mattress	347.0	SqYd

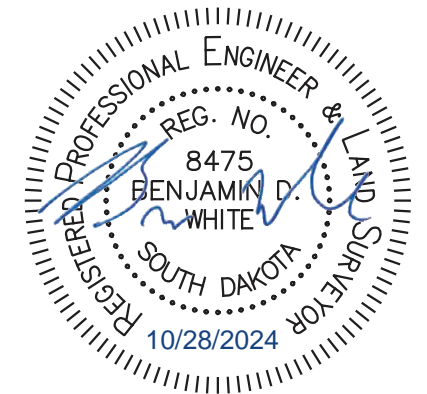

ESTIMATE OF QUANTITIES AND ENVIRONMENTAL COMMITMENTS

FOR BIDDING PURPOSES ONLY

STATE OF SOUTH DAKOTA	PROJECT	SHEET	TOTAL SHEETS
	IM 0909(92)387	A3	A6

PCN 06G8 Section M – Pavement Marking

BID ITEM NUMBER	ITEM	QUANTITY	UNIT
633E0211	Preformed Thermoplastic Pavement Marking, 4" with Contrast Border	20,103	Ft
633E0225	Preformed Thermoplastic Pavement Marking, 24"	518	Ft
633E0235	Preformed Thermoplastic Pavement Marking, Arrow	19	Each
633E0240	Preformed Thermoplastic Pavement Marking, Combination Arrow	5	Each
633E5004	Grooving for Cold Applied Plastic Pavement Marking, 4" with Contrast Border	20,103	Ft
633E5015	Grooving for Cold Applied Plastic Pavement Marking, 24"	518	Ft
633E5025	Grooving for Cold Applied Plastic Pavement Marking, Arrow	19	Each
633E5030	Grooving for Cold Applied Plastic Pavement Marking, Combination Arrow	5	Each

PCN 06G8 Section S – Permanent Signing

BID ITEM NUMBER	ITEM	QUANTITY	UNIT
110E0100	Remove Concrete Footing(s)	Lump Sum	LS
110E0130	Remove Traffic Sign	14	Each
110E0135	Remove Delineator	180	Each
110E0140	Remove Extruded Panel Sign	6	Each
632E0014	1.75' Diameter Breakaway Support Concrete Footing	56.0	Ft
632E1235	W6x20 Steel Post	128.4	Ft
632E1340	2.5"x2.5" Perforated Tube Post	230.7	Ft
632E2000	4"x4" Amber Delineator with 1.12 Lb/Ft Post	8	Each
632E2004	4"x8" Amber Delineator with 1.12 Lb/Ft Post	10	Each
632E2008	4" Tubular Amber Delineator with 1.12 Lb/Ft Post	16	Each
632E2020	4"x4" White Delineator with 1.12 Lb/Ft Post	10	Each
632E2024	4"x8" White Delineator with 1.12 Lb/Ft Post	62	Each
632E2028	4" Tubular White Delineator with 1.12 Lb/Ft Post	20	Each
632E2220	Guardrail Delineator	16	Each
632E2520	Type 2 Object Marker	21	Each
632E3113	Extruded Aluminum Sign, Nonremovable Copy High Intensity	280.0	SqFt
632E3203	Flat Aluminum Sign, Nonremovable Copy High Intensity	162.4	SqFt
632E3205	Flat Aluminum Sign, Nonremovable Copy Super/Very High Intensity	104.0	SqFt

SPECIFICATIONS

Standard Specifications for Roads and Bridges, 2015 Edition and Required Provisions, Supplemental Specifications, and Special Provisions as included in the Proposal.

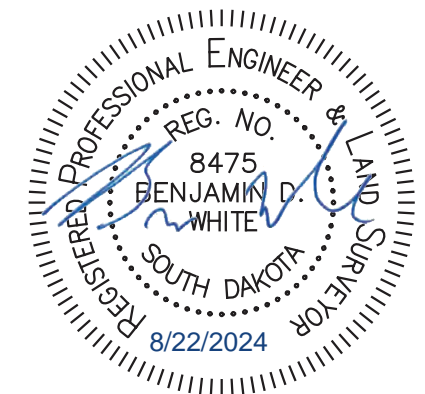

ESTIMATE OF QUANTITIES AND ENVIRONMENTAL COMMITMENTS

FOR BIDDING PURPOSES ONLY

STATE OF SOUTH DAKOTA	PROJECT	SHEET	TOTAL SHEETS
	IM 0909(92)387	A4	A6

ENVIRONMENTAL COMMITMENTS

The SDDOT is committed to protecting the environment and uses Environmental Commitments as a communication tool for the Engineer and Contractor to ensure that attention is given to avoid, minimize, and/or mitigate an environmental impact. Environmental commitments to various agencies and the public have been made to secure approval of this project. An agency with permitting authority can delay a project if identified environmental impacts have not been adequately addressed. Unless otherwise designated, the Contractor's primary contact regarding matters associated with these commitments will be the Project Engineer. During construction, the Project Engineer will verify that the Contractor has met Environmental Commitment requirements. These environmental commitments are not subject to change without prior written approval from the SDDOT Environmental Office.

Additional guidance on SDDOT's Environmental Commitments can be accessed through the Environmental Procedures Manual found at: <https://dot.sd.gov/media/documents/EnvironmentalProceduresManual.pdf>

For questions regarding change orders in the field that may have an effect on an Environmental Commitment, the Project Engineer will contact the Environmental Engineer at 605-773-3180 or 605-773-4336 to determine whether an environmental analysis and/or resource agency coordination is necessary.

Once construction is complete, the Project Engineer will review all environmental commitments for the project and document their completion.

COMMITMENT A: AQUATIC RESOURCES

COMMITMENT A1: WETLANDS

All efforts to avoid and minimize wetland impacts from the project have resulted in approximately 8.965 acres of wetlands (includes temporary and permanent) becoming impacted. Refer to Section B – Grading Plans for location and boundaries of the impacted wetlands.

Table of Impacted Wetlands

Wetland No.	Station	Perm. Impact Left (Acres)	Perm. Impact Right (Acres)	Temp. Impact Left (Acres)	Temp. Impact Right (Acres)	Total Impact (Acres)
1	56+00 to 62+00	0.368	0.000	0.211	0.000	0.579
2	55+50 to 61+50	0.000	0.116	0.000	0.006	0.122
3	6+50 to 10+85 18+13 to 22+00 23+93 to 27+69	0.017	0.047	1.813	1.370	3.247

Wetland No.	Station	Perm. Impact Left (Acres)	Perm. Impact Right (Acres)	Temp. Impact Left (Acres)	Temp. Impact Right (Acres)	Total Impact (Acres)
4	13+01 to 16+28 3+51 to 32+46	0.961	0.235	1.039	0.337	2.572
5	6+50 to 26+95	0.000	0.000	0.412	0.000	0.412
6	9+27 to 12+59	0.000	0.000	0.000	0.000	0.000
7	22+00	0.000	0.000	0.000	0.000	0.000
8	9+00 to 17+00	0.000	0.155	0.000	0.128	0.283
9	5+30	0.001	0.000	0.008	0.000	0.009
10	5+90	0.000	0.000	0.000	0.002	0.002
12	18+00 to 21+00	0.886	0.000	0.160	0.000	1.046
13	24+56 to 26+17	0.000	0.077	0.000	0.015	0.092
14	25+00 to 27+00	0.000	0.000	0.000	0.000	0.000
15	27+00 to 30+00	0.000	0.000	0.106	0.000	0.106
16	56+00 to 62+00	0.000	0.000	0.000	0.000	0.000

Action Taken/Required:

SDDOT will acquire an estimated 10.233 credits from the Jandl wetland mitigation bank site to mitigate permanent impacts.

Temporary impacts identified in the Table of Impacted Wetlands will not be mitigated as original contours and elevations will be re-established as designated in Section B – Grading Plans. Prior to initiating temporary work in wetlands, the Contractor will submit a plan to the Project Engineer in accordance with Section 7.21 D of the Specifications.

The Contractor will notify the Project Engineer if additional easement is needed to complete work adjacent to any wetland. The Project Engineer will obtain an appropriate course of action from the Environmental Office before proceeding with construction activities that affect any wetlands beyond the work limits and easements shown in the plans.

COMMITMENT C: WATER SOURCE

The Contractor will not withdraw water with equipment previously used outside the State of South Dakota or previously used in aquatic invasive species (AIS) positive waters within South Dakota without prior approval from the SDDOT Environmental Office. To prevent and control the introduction and spread of invasive species into the project vicinity, all equipment will be power washed with hot water (≥140 °F) and completely dried for a minimum of 7 days prior to subsequent use. South Dakota administrative rule 41:10:04:02 forbids the possession and transport of AIS; therefore, all attached dirt, mud, debris and vegetation must be removed and all compartments and tanks capable of holding standing water must be drained. This includes, but is not limited to, all equipment, pumps, lines, hoses and holding tanks.

Action Taken/Required:

The Contractor will obtain the necessary permits from the regulatory agencies such as the South Dakota Department of Agriculture and Natural Resources (DANR) and the United States Army Corps of Engineers (USACE) prior to water extraction activities.

Additional information and mapping of water sources impacted by Aquatic Invasive Species in South Dakota can be accessed at: <https://sdeastwanted.sd.gov/maps/default.aspx>

< [South Dakota Administrative Rule 41:10:04 Aquatic Invasive Species: https://sdlegislature.gov/rules/DisplayRule.aspx?Rule=41:10:04](https://sdlegislature.gov/rules/DisplayRule.aspx?Rule=41:10:04) >

COMMITMENT D: WATER QUALITY STANDARDS

COMMITMENT D1: SURFACE WATER QUALITY

This project may be in the vicinity of multiple streams and wetlands. These waters are considered waters of the state and are protected under Administrative Rules of South Dakota (ARSD) Chapter 74:51. Special construction measures may have to be taken to ensure that this water body is not impacted.

Action Taken/Required:

The Contractor is advised that the South Dakota Surface Water Quality Standards, administered by the South Dakota Department of Agriculture and Natural Resources (DANR), apply to this project. Special construction measures will be taken to ensure the above standard(s) of the surface waters are maintained and protected.

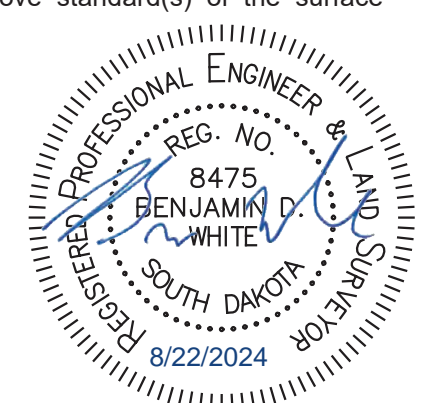

ESTIMATE OF QUANTITIES AND ENVIRONMENTAL COMMITMENTS

FOR BIDDING PURPOSES ONLY

STATE OF SOUTH DAKOTA	PROJECT	SHEET	TOTAL SHEETS
	IM 0909(92)387	A5	A6

COMMITMENT D2: SURFACE WATER DISCHARGE

The DANR General Permit for Temporary Discharge is required for temporary dewatering and discharges to waters of the state. The effluent limit for total suspended solids will be 90 mg/L 30-day average. The effluent limit applies to discharges to all waters of the state except discharges to waters classified as cold water permanent fish life propagation waters according to the ARSD 74:51:01:45. For discharges to waters of the state classified as cold water permanent fish life propagation waters, the effluent limit for total suspended solids will be 53 mg/L daily maximum.

The permittee has the option of completing effluent testing or implementing a pollution prevention plan for compliance with this permit. If the permittee develops a pollution prevention plan instead of total suspended solids sampling, the plan must be developed and implemented prior to discontinuing total suspended solids sampling. Refer to Section 4.0 of the permit. If any pollutants are suspected of being discharged, a sample must be taken for those parameters listed in Section 3.4 of the permit.

Refer to Commitment D1: Surface Water Quality for stream classification.

Action Taken/Required:

If construction dewatering is required and this project is currently covered under a General Permit for Stormwater Discharges Associated with Construction Activities, the contractor will need to submit the dewatering information to the SDDANR using the following form:

<
https://danr.sd.gov/OfficeOfWater/SurfaceWaterQuality/docs/DANR_AddTempInfoFillable.pdf>

The Contractor will provide a copy of the approved permit or the submitted dewatering information to the Project Engineer prior to proceeding with any dewatering activities. The approved permit or submitted dewatering information must be kept on-site and as part of the project records.

Effluent monitoring, as a result of dewatering activities, will be summarized for each month and recorded on a separate Discharge Monitoring Report (DMR) and submitted to DANR monthly. Additional information can be found at:

<
<https://danr.sd.gov/OfficeOfWater/SurfaceWaterQuality/swdpermitting/Ereporting.aspx>>

COMMITMENT E: STORM WATER

Construction activities constitute 1 acre or more of earth disturbance and/or work in a waterway.

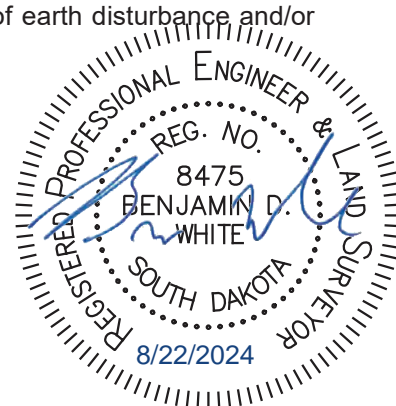

Action Taken/Required:

The DANR General Permit for Stormwater Discharges Associated with Construction Activities is required for construction activity disturbing one or more acres of earth and work in a waterway. The SDDOT is the owner of this permit and will submit the NOI to DANR 15 days prior to project start in order to obtain coverage under the General Permit. Work can begin once the DANR letter of approval is received.

The Contractor must adhere to the "Special Provision Regarding Storm Water Discharges to Waters of the State."

The Contractor will complete the DANR Contractor Certification Form prior to the pre-construction meeting. The form certifies under penalty of law that the Contractor understands and will comply with the terms and conditions of the permit for this project. Work may not begin on this project until this form is signed and submitted to DANR.

The form can be found at:

<https://danr.sd.gov/OfficeOfWater/SurfaceWaterQuality/docs/DANR_CGPAAppendixCCA2018Fillable.pdf>

The Contractor is advised that permit coverage may also be required for off-site activities, such as borrow and staging areas, which are the responsibility of the Contractor.

Storm Water Pollution Prevention Plan

The Storm Water Pollution Prevention Plan (SWPPP) will be developed prior to the submittal of the NOI and will be implemented for all construction activities for compliance with the permit. The SWPPP must be kept on-site and updated as site conditions change. Erosion control measures and best management practices will be implemented in accordance with the SWPPP.

The DOT 298 Form will be used for site inspections and to document changes to the SWPPP. A copy of the completed inspection form will be filed with the SWPPP documents and retained for a minimum of three years.

The inspection will include disturbed areas of the construction site that have not been finally stabilized, areas used for storage materials, structural control measures, and locations where vehicles enter or exit the site. These areas will be inspected for evidence of, or the potential for, pollutants entering the drainage system. Erosion and sediment control measures identified in the SWPPP will be observed to ensure that they are operating correctly, and sediment is not tracked off the site.

Information on storm water permits and SWPPPs are available on the following websites:

SDDOT: < <https://dot.sd.gov/doing-business/environmental/stormwater> >

DANR: <<https://danr.sd.gov/OfficeOfWater/SurfaceWaterQuality/stormwater/default.aspx>>

EPA: < <https://www.epa.gov/npdes> >

COMMITMENT G: DEWATERING AND SEDIMENT COLLECTION

The purpose of a dewatering and sediment collection system is to collect turbid stormwater on the project, treat it with flocculants as needed, and capture the sediment that falls out of suspension before the water is discharged into "Waters of the US" or "Waters of the State". Refer to Commitment D1: Surface Water Quality for stream classification.

Action Taken/Required:

The Contractor will meet the terms of the Temporary Discharge Permit and the Storm Water Permit for Construction Activities.

The Contractor will create a Pollution Prevention Plan (PPP) for dewatering and sediment collection if the Contractor chooses to discharge the water into "Waters of the US" or "Waters of the State". Refer to the detail sheet OPTIONS FOR DEWATERING AND SEDIMENT COLLECTION in the plans. The PPP must be kept on-site and updated as site conditions change.

COMMITMENT H: WASTE DISPOSAL SITE

The Contractor will furnish a site(s) for the disposal of construction and/or demolition debris generated by this project.

Action Taken/Required:

Construction and/or demolition debris may be disposed of within the Public ROW.

The waste disposal site(s) will be managed and reclaimed in accordance with the following from the General Permit for Construction/Demolition Debris Disposal Under the South Dakota Waste Management Program issued by the Department of Agriculture and Natural Resources.

The waste disposal site(s) will not be located in a wetland, within 200 feet of surface water, or in an area that adversely affects wildlife, recreation, aesthetic value of an area, or any threatened or endangered species, as approved by the Environmental Office and the Project Engineer.

If the waste disposal site(s) is located such that it is within view of any ROW, the following additional requirements will apply:

1. Construction and/or demolition debris consisting of concrete, asphalt concrete, or other similar materials will be buried in a trench separate from wood debris. The final cover over the construction and/or demolition debris will consist of a minimum of 1 foot of soil capable of supporting vegetation. Waste disposal sites provided outside of the Public ROW will be seeded in accordance with Natural Resources Conservation Service recommendations. The seeding recommendations may be obtained through the appropriate County NRCS Office. The Contractor will control the access to waste disposal sites not within the Public ROW with fences, gates, and placement of a sign or signs at the entrance to the site stating, "No Dumping Allowed".

ESTIMATE OF QUANTITIES AND ENVIRONMENTAL COMMITMENTS

FOR BIDDING PURPOSES ONLY

STATE OF SOUTH DAKOTA	PROJECT	SHEET	TOTAL SHEETS
	IM 0909(92)387	A6	A6

Action Taken/Required (Continue):

2. Concrete and asphalt concrete debris may be stockpiled within view of the ROW for a period not to exceed the duration of the project. Prior to project completion, the waste will be removed from view of the ROW or buried, and the waste disposal site reclaimed as noted above.

The above requirements will not apply to waste disposal sites that are covered by an individual solid waste permit as specified in SDCL 34A-6-58, SDCL 34A-6-1.13, and ARSD 74:27:10:06.

Failure to comply with the requirements stated above may result in civil penalties in accordance with South Dakota Solid Waste Law, SDCL 34A-6-1.31.

All costs associated with furnishing waste disposal site(s), disposing of waste, maintaining control of access (fence, gates, and signs), and reclamation of the waste disposal site(s) will be incidental to the various contract items.

COMMITMENT I: HISTORIC PRESERVATION OFFICE CLEARANCES

The SDDOT has obtained concurrence with the State Historic Preservation Office (SHPO or THPO) for all work included within the project limits and all department designated sources and designated option material sources, stockpile sites, storage areas, and waste sites provided within the plans.

Action Taken/Required:

All earth disturbing activities not designated within the plans require a cultural resource review prior to scheduling the pre-construction meeting. This work includes but is not limited to: Contractor furnished material sources, material processing sites, stockpile sites, storage areas, plant sites, and waste areas.

The Contractor will arrange and pay for a record search and when necessary, a cultural resource survey. The Contractor has the option to contact the state Archaeological Research Center (ARC) at 605-394-1936 or another qualified archaeologist, to obtain either a records search or a cultural resources survey. A record search might be sufficient for review if the site was previously surveyed; however, a cultural resources survey may need to be conducted by a qualified archaeologist.

The Contractor will provide ARC with the following: a topographical map or aerial view in which the site is clearly outlined, site dimensions, project number, and PCN. If applicable, provide evidence that the site has been previously disturbed by farming, mining, or construction activities with a landowner statement that artifacts have not been found on the site.

The Contractor will submit the cultural resources survey report to SDDOT Environmental Office, 700 East Broadway Avenue, Pierre, SD 57501-2586. SDDOT will submit the information to the appropriate SHPO/THPO. Allow **30 Days** from the date this information is submitted to the Environmental Engineer for SHPO/THPO review.

In the event of an inadvertent discovery of human remains, funerary objects, or if evidence of cultural resources is identified during project construction activities, then such activities within 100 feet of the inadvertent discovery will immediately cease and the Project Engineer will be immediately notified. The Project Engineer will contact the SDDOT Environmental Office, who will contact the appropriate SHPO/THPO within 48 hours of the discovery to determine an appropriate course of action.

SHPO/THPO review does not relieve the Contractor of the responsibility for obtaining any additional permits and clearances for Contractor furnished material sources, material processing sites, stockpile sites, storage areas, plant sites, and waste areas that affect wetlands, threatened and endangered species, or waterways. The Contractor will not utilize a site known or suspected of having contaminated soil or water. The Contractor will provide the required permits and clearances to the Project Engineer at the preconstruction meeting.

COMMITMENT L: CONTAMINATED MATERIAL

Contaminated soil and/or known gas stations, undergrounds storage tanks, etc. are located within the project limits. Petroleum contaminated soil may be located at the following sites:

Description	Station	L / R
Five active underground storage tanks	28+75	L

Action Taken/Required:

The Contractor will give notice to the Engineer when contaminated soil is encountered on the project. The Engineer will contact the Environmental Office so that contact with the DANR and consultant to inspect and monitor removal of any contaminated soil can be initiated.

The Contractor will be responsible for having the existing underground utilities located in the construction area. Underground utilities damaged by the Contractor due to negligence will be repaired at the Contractor's expense.

Petroleum contaminated soil may be disposed of at the Sioux Falls Regional Sanitary Landfill (phone 605-367-8162). Measurement of "Contaminated Material Excavation" will be in accordance with Section 120.4 of the Specifications. All costs for excavating and transporting the contaminated materials to the disposal site and all fees charged per cubic yard by the disposal site will be incidental to the contract unit price per cubic yard for "Contaminated Material Excavation".

The estimated quantity of "Contaminated Material Excavation" is 100 cubic yards. The quantity of "Contaminated Material Excavation" may vary from the plans. No adjustment will be made to the contract unit price for variations in the quantity of "Contaminated Material Excavation". The estimated quantity of "Contaminated Material Excavation" is provided in Section B – Grading Plans.

COMMITMENT N: SECTION 404 PERMIT

The SDDOT has obtained a Section 404 Permit from the USACE for the permanent actions associated with this project.

Action Taken/Required:

The Contractor will comply with all requirements contained in the Section 404 Permit.

The Contractor will also be responsible for obtaining a Section 404 Permit for any dredge, excavation, or fill activities associated with material sources, storage areas, waste sites, and Contractor work sites outside the plan work limits that affect wetlands, floodplains, or waters of the United States.

