

Plot Scale - 1:9240.81

Plotted From - TRP26947

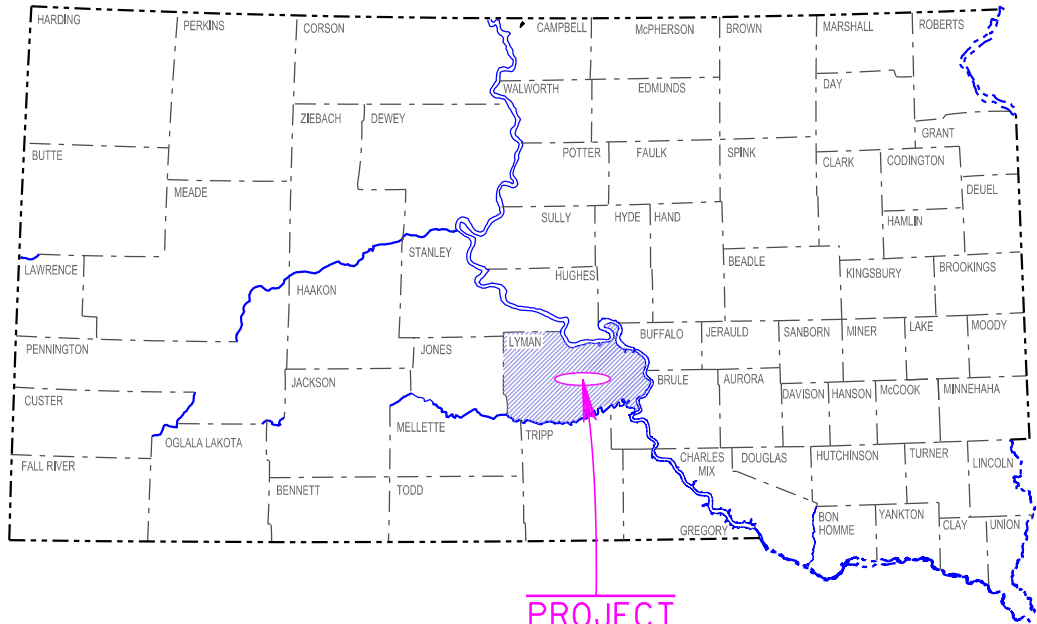

STATE OF SOUTH DAKOTA  
DEPARTMENT OF TRANSPORTATION

PLANS FOR PROPOSED  
**PROJECT IM-CR 0905(121)236**  
**INTERSTATE 90 EBL**  
**LYMAN COUNTY**

COLD MILLING ASPHALT CONCRETE,  
SHOULDER ASPHALT CONCRETE RESURFACING,  
ASPHALT SURFACE TREATMENT,  
GUARDRAIL UPGRADES,  
AND CRC PAVEMENT SPALL REPAIR

PCN 06P1

STATE OF SOUTH DAKOTA	PROJECT	SHEET	TOTAL SHEETS
	IM-CR 0905(121)236	1	77

Plotting Date: 05/06/2025

05/05/2025 Revision by VAM

**INDEX OF SECTIONS**

Section A:	Estimate of Quantities and Environmental Commitments
Section C:	Traffic Control Plans
Section D:	Erosion & Sediment Control Plans
Section F:	Surfacing Plans
Section M:	Pavement Marking Plans

**DESIGN DESIGNATION**

ADT(2023)	3768
ADT(2043)	5380
DHV	952
D	51%
T DHV	12.8%
T ADT	28.1%
V	80 MPH

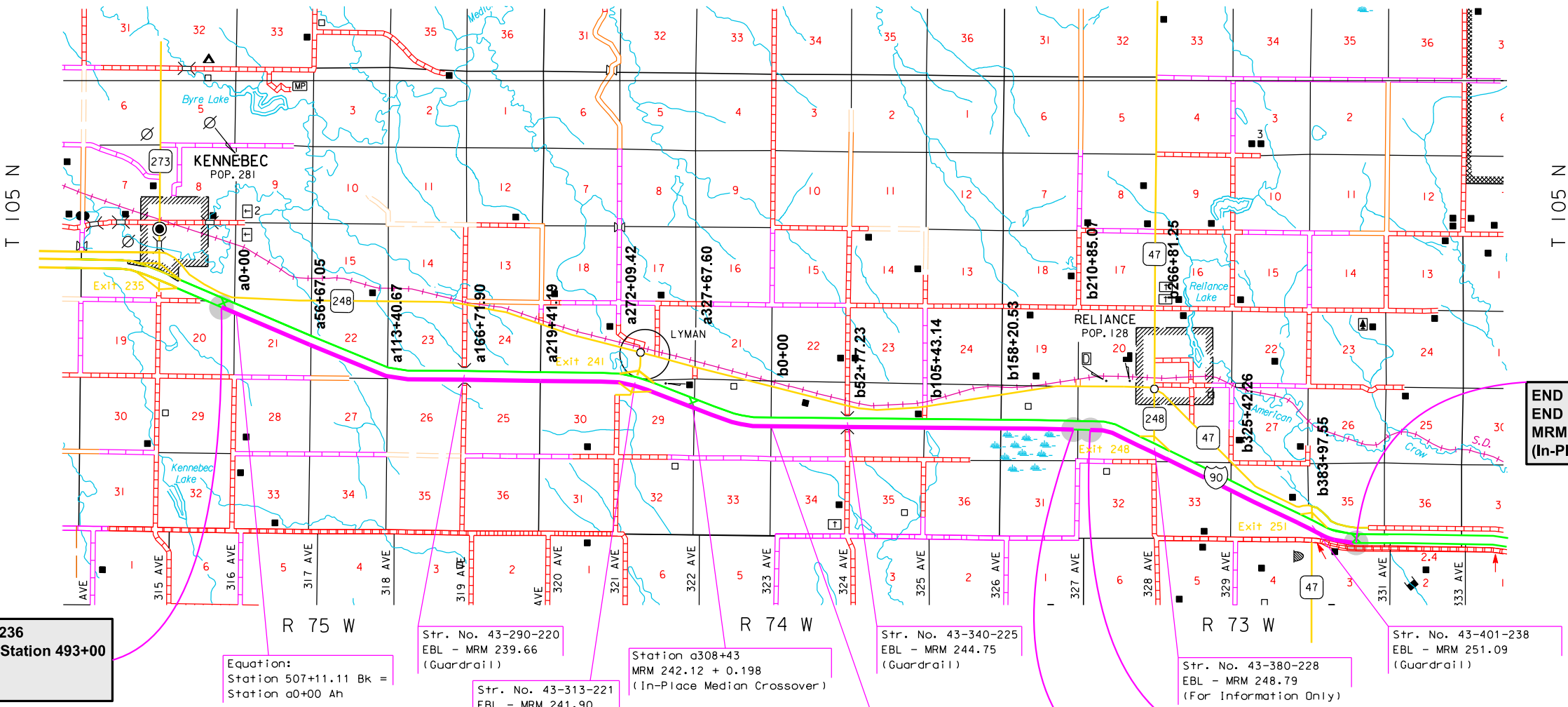

**BEGIN PROJECT IM 0905(121)236**  
**BEGIN EBL RESURFACING at Station 493+00**  
**MRM 236.00+0.218 (EB Lanes)**  
**(In-Place Median Crossover)**

**STORM WATER PERMIT**  
Receiving Waters: Missouri River Tributaries  
Area Disturbed: 3.5 Acres  
Total Project Area: 563 Acres  
Latitude: 43.890781 N (Google Maps)  
Longitude: -99.850536 W (Google Maps)

**I-90 EBL**

GROSS LENGTH	81,798.40 FEET	15.492 MILES
LENGTH OF EXCEPTIONS	1,209.40 FEET	0.229 MILES
NET LENGTH	80,589.00 FEET	15.263 MILES

Str. No. 43-290-220  
EBL - MRM 239.66  
(Guardrail)

Str. No. 43-313-221  
EBL - MRM 241.90  
(Guardrail)

Station a308+43  
MRM 242.12 + 0.198  
(In-Place Median Crossover)

Equation:  
Station a382+38.69 Bk =  
Station b0+00 Ah

Str. No. 43-340-225  
EBL - MRM 244.75  
(Guardrail)

**END IM 0905(121)236**  
**END EBL RESURFACING**  
**Station 209+80**  
**MRM 247.00 + 0.679 (EB Lanes)**

**BEGIN IM 0905(121)236**  
**BEGIN EBL RESURFACING**  
**Station 220+79**  
**MRM 247.00 + 0.915 (EB Lanes)**

**END PROJECT IM 0905(121)236**  
**END EBL RESURFACING at Station b421+48**  
**MRM 251.60 + 0.000 (EB Lanes)**  
**(In-Place Crossover)**

6

October 1, 2025

File - ...Design\Section\A06P1\_Title.dgn

ESTIMATE OF QUANTITIES

STATE OF	PROJECT	SHEET NO.	TOTAL SHEETS
S.D.	IM-CR 0905(121)236	A1	A3

SPECIFICATIONS

Standard Specifications for Roads and Bridges, 10-1-25 Version, Required Provisions, and Special Provisions as included in the Proposal. The Standard Specifications for Roads and Bridges are available for download and viewing at <https://dot.sd.gov/doing-business/contractors/standard-specifications>.

05/05/2025 Revision by VAM  
09/02/2025 Revision by VAM

Section C – Traffic Control

BID ITEM NUMBER	ITEM	QUANTITY	UNIT
634E0010	Flagging	100.0	Hour
634E0110	Traffic Control Signs	939.6	SqFt
634E0120	Traffic Control, Miscellaneous	Lump Sum	LS
634E0275	Type 3 Barricade	53	Each
634E0330	Temporary Raised Pavement Markers	9,657	Ft
634E0420	Type C Advance Warning Arrow Board	2	Each
634E1215	Contractor Furnished Portable Changeable Message Sign	2	Each
634E1255	Contractor Furnished Speed Monitoring Radar Trailer	2	Each

Section D – Erosion and Sediment Control

BID ITEM NUMBER	ITEM	QUANTITY	UNIT
110E1690	Remove Sediment	2.3	CuYd
230E0020	Contractor Furnished Topsoil	80	CuYd
230E0100	Remove and Replace Topsoil	Lump Sum	LS
734E0010	Erosion Control	Lump Sum	LS
734E0154	12" Diameter Erosion Control Wattle	1,000	Ft
734E0165	Remove and Reset Erosion Control Wattle	250	Ft

Section F – Surfacing

BID ITEM NUMBER	ITEM	QUANTITY	UNIT
009E0010	Mobilization	Lump Sum	LS
009E3210	Construction Staking	31.794	Mile
009E3250	Miscellaneous Staking	31.794	Mile
009E3301	Engineer Directed Surveying/Staking	40.0	Hour
009E3320	Checker	Lump Sum	LS
009E4200	Construction Schedule, Category II	Lump Sum	LS
110E0700	Remove 3 Cable Guardrail	1,764	Ft
110E0730	Remove Beam Guardrail	700.0	Ft
110E0740	Remove 3 Cable Guardrail Anchor Assembly	12	Each
110E0745	Remove 3 Cable Guardrail Slip Base Anchor Assembly	4	Each
110E1010	Remove Asphalt Concrete Pavement	1,781.0	SqYd
120E0010	Unclassified Excavation	614	CuYd
120E0100	Unclassified Excavation, Digouts	763	CuYd
120E0600	Contractor Furnished Borrow Excavation	3,015	CuYd
210E0100	Shoulder Clearing	30.5	Mile
210E1000	Shoulder Preparation	1.000	Mile
260E1010	Base Course	1,526.0	Ton
260E1030	Base Course, Salvaged	1,076.4	Ton
* 260E6000	Granular Material, Furnish	4,360.4	Ton
270E0040	Salvage and Stockpile Asphalt Mix and Granular Base Material	1,226.4	Ton
* 270E0200	Blend, Haul, and Stockpile Granular Material	10,901.0	Ton
320E0005	PG 58-34 Asphalt Binder	693.7	Ton
320E1070	Class HR Asphalt Concrete	20,966.6	Ton
320E3000	Compaction Sample	3	Each
320E5010	Saw and Seal Shoulder Joint	161,177	Ft
320E7012	Grind 12" Rumble Strip or Stripe in Asphalt Concrete	15.5	Mile
330E0100	SS-1h or CSS-1h Asphalt for Tack	60.5	Ton
330E0300	SS-1h or CSS-1h Asphalt for Fog Seal	27.0	Ton
332E0010	Cold Milling Asphalt Concrete	120,267	SqYd
360E0042	CRS-2P Asphalt for Surface Treatment	168.1	Ton
360E1200	Modified Cover Aggregate	1,149.1	Ton
380E5100	Continuously Reinforced PCC Pavement Repair	181.8	SqYd
380E6110	Insert Steel Bar in PCC Pavement	268	Each
380E6500	Planing PCC Pavement	694.0	SqYd
* 450E8900	Cleanout Pipe Culvert	4	Each
600E0300	Type III Field Laboratory	1	Each
630E0500	Type 1 MGS	2,287.5	Ft
630E1501	Type 1 Retrofit Guardrail Transition	8	Each
630E2018	MGS MASH Tangent End Terminal	8	Each
632E2220	Guardrail Delineator	65	Each

\* - Denotes Non-Participating

Section M – Pavement Marking

BID ITEM NUMBER	ITEM	QUANTITY	UNIT
633E0010	Cold Applied Plastic Pavement Marking, 4"	1,450	Ft
633E0025	Cold Applied Plastic Pavement Marking, 12"	2,300	Ft
633E1201	High Build Waterborne Pavement Marking Paint with Reflective Elements, White	567	Gal
633E1206	High Build Waterborne Pavement Marking Paint with Reflective Elements, Yellow	450	Gal
633E5050	Surface Preparation for Pavement Marking	195,596	Ft

# ENVIRONMENTAL COMMITMENTS

STATE OF SOUTH DAKOTA	PROJECT	SHEET	TOTAL SHEETS
	IM-CR 0905(121)236	A2	A3

## ENVIRONMENTAL COMMITMENTS

The SDDOT is committed to protecting the environment and uses Environmental Commitments as a communication tool for the Engineer and Contractor to ensure that attention is given to avoid, minimize, and/or mitigate an environmental impact. Environmental commitments to various agencies and the public have been made to secure approval of this project. An agency with permitting authority can delay a project if identified environmental impacts have not been adequately addressed. Unless otherwise designated, the Contractor's primary contact regarding matters associated with these commitments will be the Project Engineer. During construction, the Project Engineer will verify that the Contractor has met Environmental Commitment requirements. These environmental commitments are not subject to change without prior written approval from the SDDOT Environmental Office.

Additional guidance on SDDOT's Environmental Commitments can be accessed through the Environmental Procedures Manual found at: <<https://dot.sd.gov/media/documents/EnvironmentalProceduresManual.pdf> >

For questions regarding change orders in the field that may have an effect on an Environmental Commitment, the Project Engineer will contact the Environmental Engineer at 605-773-3180 or 605-773-4336 to determine whether an environmental analysis and/or resource agency coordination is necessary.

Once construction is complete, the Project Engineer will review all environmental commitments for the project and document their completion.

## COMMITMENT B: FEDERALLY THREATENED, ENDANGERED, AND PROTECTED SPECIES

### COMMITMENT B2: WHOOPING CRANE

The Whooping Crane is a spring and fall migratory bird in South Dakota that is about 5 feet tall and typically stops on wetlands, rivers, and agricultural lands along their migration route. An adult Whooping Crane is white with a red crown and a long, dark, pointed bill. Immature Whooping Cranes are cinnamon brown. While in flight, their long necks are kept straight and their long dark legs trail behind. Adult Whooping Cranes' black wing tips are visible during flight.

#### Action Taken/Required:

Harassment or other measures to cause the Whooping Crane to leave the site is a violation of the Endangered Species Act. If a Whooping Crane is sighted roosting in the vicinity of the project, borrow pits, or staging areas associated with the project, cease construction activities in the affected area until the Whooping Crane departs and immediately contact the Project Engineer. The Project Engineer will contact the Environmental Office so that the sighting can be reported to USFWS.

## COMMITMENT B4: BALD EAGLE

Bald eagles are known to occur in this area.

#### Action Taken/Required:

If a nest is observed within one mile of the project site, notify the Project Engineer immediately so that he/she can consult with the Environmental Office for an appropriate course of action.

## COMMITMENT C: WATER SOURCE

The Contractor will not withdraw water with equipment previously used outside the State of South Dakota or previously used in aquatic invasive species (AIS) positive waters within South Dakota without prior approval from the SDDOT Environmental Office. To prevent and control the introduction and spread of invasive species into the project vicinity, all equipment will be power washed with hot water (≥140 °F) and completely dried for a minimum of 7 days prior to subsequent use. South Dakota administrative rule 41:10:04:02 forbids the possession and transport of AIS; therefore, all attached dirt, mud, debris and vegetation must be removed and all compartments and tanks capable of holding standing water must be drained. This includes, but is not limited to, all equipment, pumps, lines, hoses and holding tanks.

#### Action Taken/Required:

The Contractor will obtain the necessary permits from the regulatory agencies such as the South Dakota Department of Agriculture and Natural Resources (DANR) and the United States Army Corps of Engineers (USACE) prior to water extraction activities.

Additional information and mapping of water sources impacted by Aquatic Invasive Species in South Dakota can be accessed at:  
< <https://sdleastwanted.sd.gov/maps/default.aspx>

< [South Dakota Administrative Rule 41:10:04 Aquatic Invasive Species: https://sdlegislature.gov/rules/DisplayRule.aspx?Rule=41:10:04](https://sdlegislature.gov/rules/DisplayRule.aspx?Rule=41:10:04) >

## COMMITMENT E: STORM WATER

#### Action Taken/Required:

At a minimum and regardless of project size, appropriate erosion and sediment control measures must be installed to control the discharge of pollutants from the construction site.

Construction activities constitute 1 acre or more of earth disturbance and/or work in a waterway.

#### Action Taken/Required:

The DANR General Permit for Stormwater Discharges Associated with Construction Activities is required for construction activity disturbing one or more acres of earth and work in a waterway. The SDDOT is the owner of this permit and will submit the NOI to DANR 15 days prior to project start in order

to obtain coverage under the General Permit. Work can begin once the DANR letter of approval is received.

The Contractor must adhere to the "Special Provision Regarding Storm Water Discharges to Waters of the State."

The Contractor will complete the DANR Contractor Certification Form prior to the pre-construction meeting. The form certifies under penalty of law that the Contractor understands and will comply with the terms and conditions of the permit for this project. Work may not begin on this project until this form is signed and submitted to DANR.

The form can be found at:  
<[https://danr.sd.gov/OfficeOfWater/SurfaceWaterQuality/docs/DANR\\_CGPA\\_ppendixCCA2018Fillable.pdf](https://danr.sd.gov/OfficeOfWater/SurfaceWaterQuality/docs/DANR_CGPA_ppendixCCA2018Fillable.pdf) >

The Contractor is advised that permit coverage may also be required for off-site activities, such as borrow and staging areas, which are the responsibility of the Contractor.

## Storm Water Pollution Prevention Plan

The Storm Water Pollution Prevention Plan (SWPPP) will be developed prior to the submittal of the NOI and will be implemented for all construction activities for compliance with the permit. The SWPPP must be kept on-site and updated as site conditions change. Erosion control measures and best management practices will be implemented in accordance with the SWPPP.

The DOT 298 Form will be used for site inspections and to document changes to the SWPPP. A copy of the completed inspection form will be filed with the SWPPP documents and retained for a minimum of three years.

The inspection will include disturbed areas of the construction site that have not been finally stabilized, areas used for storage materials, structural control measures, and locations where vehicles enter or exit the site. These areas will be inspected for evidence of, or the potential for, pollutants entering the drainage system. Erosion and sediment control measures identified in the SWPPP will be observed to ensure that they are operating correctly, and sediment is not tracked off the site.

Information on storm water permits and SWPPPs are available on the following websites:

SDDOT: < <https://dot.sd.gov/doing-business/environmental/stormwater> >

DANR:<<https://danr.sd.gov/OfficeOfWater/SurfaceWaterQuality/stormwater/default.aspx>>

EPA: < <https://www.epa.gov/npdes> >



**COMMITMENT H: WASTE DISPOSAL SITE**

The Contractor will furnish a site(s) for the disposal of construction and/or demolition debris generated by this project.

**Action Taken/Required:**

Construction and/or demolition debris may not be disposed of within the Public ROW.

The waste disposal site(s) will be managed and reclaimed in accordance with the following from the General Permit for Construction/Demolition Debris Disposal Under the South Dakota Waste Management Program issued by the Department of Agriculture and Natural Resources.

The waste disposal site(s) will be managed and reclaimed in accordance with the following from the General Permit for Construction/Demolition Debris Disposal Under the South Dakota Waste Management Program issued by the Department of Agriculture and Natural Resources.

The waste disposal site(s) will not be located in a wetland, within 200 feet of surface water, or in an area that adversely affects wildlife, recreation, aesthetic value of an area, or any threatened or endangered species, as approved by the Environmental Office and the Project Engineer.

If the waste disposal site(s) is located such that it is within view of any ROW, the following additional requirements will apply:

1. Construction and/or demolition debris consisting of concrete, asphalt concrete, or other similar materials will be buried in a trench separate from wood debris. The final cover over the construction and/or demolition debris will consist of a minimum of 1 foot of soil capable of supporting vegetation. Waste disposal sites provided outside of the Public ROW will be seeded in accordance with Natural Resources Conservation Service recommendations. The seeding recommendations may be obtained through the appropriate County NRCS Office. The Contractor will control the access to waste disposal sites not within the Public ROW with fences, gates, and placement of a sign or signs at the entrance to the site stating, “No Dumping Allowed”.
2. Concrete and asphalt concrete debris may be stockpiled within view of the ROW for a period not to exceed the duration of the project. Prior to project completion, the waste will be removed from view of the ROW or buried, and the waste disposal site reclaimed as noted above.

The above requirements will not apply to waste disposal sites that are covered by an individual solid waste permit as specified in SDCL 34A-6-58, SDCL 34A-6-1.13, and ARSD 74:27:10:06. Failure to comply with the requirements stated above may result in civil penalties in accordance with South Dakota Solid Waste Law, SDCL 34A-6-1.31.

All costs associated with furnishing waste disposal site(s), disposing of waste, maintaining control of access (fence, gates, and signs), and reclamation of the waste disposal site(s) will be incidental to the various contract items.

**COMMITMENT I: HISTORIC PRESERVATION OFFICE CLEARANCES**

The SDDOT has obtained concurrence with the State Historic Preservation Office (SHPO or THPO) for all work included within the project limits and all department designated sources and designated option material sources, stockpile sites, storage areas, and waste sites provided within the plans.

**Action Taken/Required:**

All earth disturbing activities not designated within the plans require a cultural resource review prior to scheduling the pre-construction meeting. This work includes but is not limited to: Contractor furnished material sources, material processing sites, stockpile sites, storage areas, plant sites, and waste areas.

The Contractor will arrange and pay for a record search and when necessary, a cultural resource survey. The Contractor has the option to contact the state Archaeological Research Center (ARC) at 605-394-1936 or another qualified archaeologist, to obtain either a records search or a cultural resources survey. A record search might be sufficient for review if the site was previously surveyed; however, a cultural resources survey may need to be conducted by a qualified archaeologist.

The Contractor will provide ARC with the following: a topographical map or aerial view in which the site is clearly outlined, site dimensions, project number, and PCN. If applicable, provide evidence that the site has been previously disturbed by farming, mining, or construction activities with a landowner statement that artifacts have not been found on the site.

The Contractor will submit the cultural resources survey report to SDDOT Environmental Office, 700 East Broadway Avenue, Pierre, SD 57501-2586. SDDOT will submit the information to the appropriate SHPO/THPO. Allow **30 Days** from the date this information is submitted to the Environmental Engineer for SHPO/THPO review.

In the event of an inadvertent discovery of human remains, funerary objects, or if evidence of cultural resources is identified during project construction activities, then such activities within 100 feet of the inadvertent discovery will immediately cease and the Project Engineer will be immediately notified. The Project Engineer will contact the SDDOT Environmental Office, who will contact the appropriate SHPO/THPO within 48 hours of the discovery to determine an appropriate course of action.

SHPO/THPO review does not relieve the Contractor of the responsibility for obtaining any additional permits and clearances for Contractor furnished material sources, material processing sites, stockpile sites, storage areas, plant sites, and waste areas that affect wetlands, threatened and endangered species, or waterways. The Contractor will not utilize a site known or suspected of having contaminated soil or water. The Contractor will provide the required permits and clearances to the Project Engineer at the preconstruction meeting.