

SECTION D: EROSION AND SEDIMENT CONTROL PLANS

STATE OF SOUTH DAKOTA	PROJECT	SHEET	TOTAL SHEETS
	NH 0212(200) 313	D1	D2

Plotting Date: 03/19/2025

LEGEND

- Drainage Arrow
- VB

 Vegetated Buffer Strip
- CE

 Stabilized Construction Entrance
- TS

 Topsoil Stockpile
- M

 On-Site Construction Material Storage Area
- D

 Dumpster or other Trash and Debris Container
- V

 Vehicle and Equipment Parking Area, Fueling Area, or Maintenance Area
- CP

 Concrete Plant Site
- CW

 Concrete Washout
- AP

 Asphalt Plant Site
- WP

 Work Platform
- B

 Borrow Area
- SK

 Spill Kit
- PT

 Portable Toilet

Symbols in the Legend that apply to this project are to be shown on this Title Sheet to update the SWPPP.

INDEX OF SHEETS

- D1 General Layout with Index
- D2 Estimate with General Notes

BEGIN NH 0212(200)313

Station 10+00.00 = 10+00.00 on NH 212(206)313
located 1644.88 feet west and 43.10 feet south
from the Northwest 1/4 corner of Section 11-
Township 116 north - Range 63 West of the
5th P.M.
MRM 313.00+0.896

Bridge Exception

Str. No. 58-183-250
Sta. 98+88.61 to Sta. 101+42.32

END SURFACING/ BEGIN RESURFACING

Station 277+71.00
MRM 319.00+0.018

END NH 0212(200)313

Station 713+71
MRM 327.00+0.256

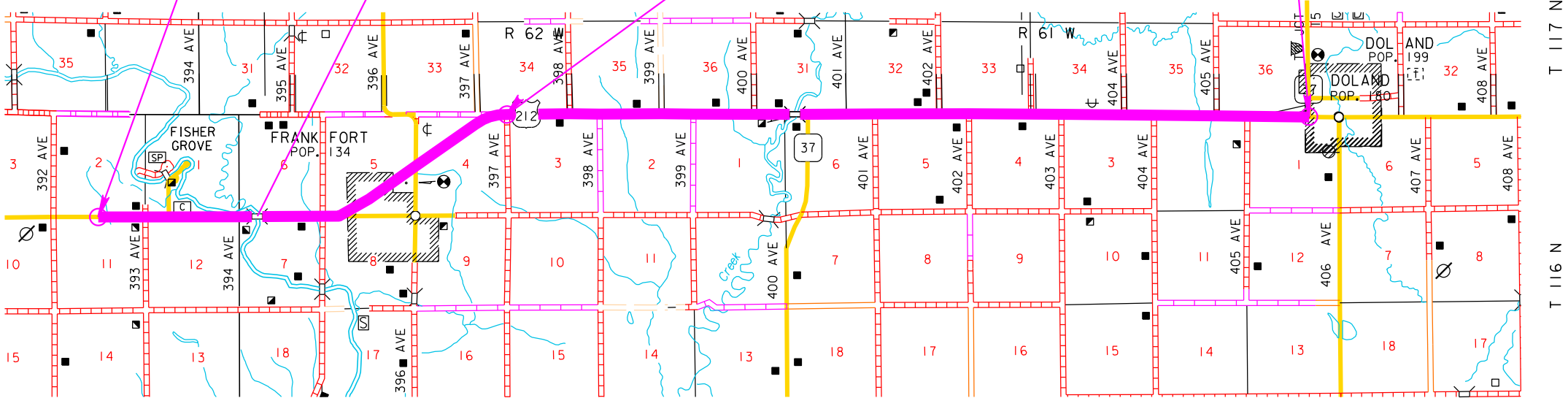

1:200
Plot Scale -
trpr17200
Plotted From -

SECTION D ESTIMATE OF QUANTITIES

06PQ

BID ITEM NUMBER	ITEM	QUANTITY	UNIT
734E0010	Erosion Control	Lump Sum	LS

EROSION CONTROL

It's anticipated that no Earth will be disturbed during construction, however if there is disturbance that requires revegetation and erosion control all costs for the erosion control work for furnishing, placing, and maintaining erosion control including equipment, labor, seeding, and mulching will be incidental to the contract lump sum price for "Erosion Control".

The limits of erosion control work will be determined by the Engineer during construction.

Permanent Seeding

The areas to be seeded consist of all newly graded areas within the project limits except for the top of roadways.

Type B Permanent Seed Mixture will consist of the following:

Grass Species	Variety	Pure Live Seed (PLS) (Pounds/Acre)
Western Wheatgrass	Arriba, Flintlock, Rodan, Rosana, Walsh	7
Switchgrass	Dacotah, Forestburg, Nebraska 28, Pathfinder, Summer, Sunburst, Trailblazer	3
Indiangrass	Holt, Tomahawk, Chief, Nebraska 54	3
Big Bluestem	Bison, Bonilla, Champ, Sunnyview, Rountree, Bonanza	3
Canada Wildrye	Mandan	2
Total:		18

Mycorrhizal Inoculum

Mycorrhizal inoculum will consist of mycorrhizal fungi spores and mycorrhizal fungi-infected root fragments in a solid carrier. The carrier may include organic materials, calcinated clay, or other materials consistent with application and good plant growth. The supplier will provide certification of the fungal species claimed and the live propagule count. The inoculum will include a minimum 25% the fungal species *Rhizophagus intraradices*. The remaining 75% may include other endomycorrhizal fungal species.

All seed will be inoculated by the seed supplier with a minimum of 100,000 live propagules of mycorrhizal fungi per acre. All costs of inoculating the seed will be incidental to the contract unit price per pound for the corresponding permanent seed mixture.

The Mycorrhizal Inoculum provided will be from the approved product list. The approved product list may be viewed at the following internet site:

<http://apps.sd.gov/HC60ApprovedProducts/main.aspx>

Mulching (Grass Hay or Straw)

If the Contractor uses a no-till drill, mulch may be applied prior to seeding and the mulch can then be punched into the soil by the no-till drill. If the Contractor uses this process, the no-till drill seeding will be completed immediately following the mulch application and the mulch will be punched into the soil at a 3-inch depth.

Hydraulic Straw Mulch

Hydraulic straw mulch will be applied to the areas noted in the table. Hydraulic straw mulch will not be placed in channels. Hydraulic straw mulch will be applied after hydroseeding and before water for vegetation. Areas designated for hydraulic straw mulch application do not require a grass hay or straw mulch application. The application rate is 3,000 pounds per acre.

All costs for furnishing and applying the hydraulic straw mulch including the manufacturer recommended soil stabilizer or tackifier, hauling, materials, equipment, labor, and incidentals necessary will be paid for at the contract unit price per pound for "Hydraulic Straw Mulch".

An additional quantity of Hydraulic Straw Mulch has been added to the Estimate of Quantities for erosion control on areas determined by the Engineer during construction.

The Hydraulic Straw Mulch provided will be from the approved product list. The approved product list may be viewed at the following internet site:

<http://apps.sd.gov/HC60ApprovedProducts/main.aspx>

STATE OF SOUTH DAKOTA	PROJECT	SHEET	TOTAL SHEETS
	NH 0212(200) 313	D2	D2
Plotting Date:		03/19/2025	