

Plot Scale - 1:200

TRPR17190

Plotted From -

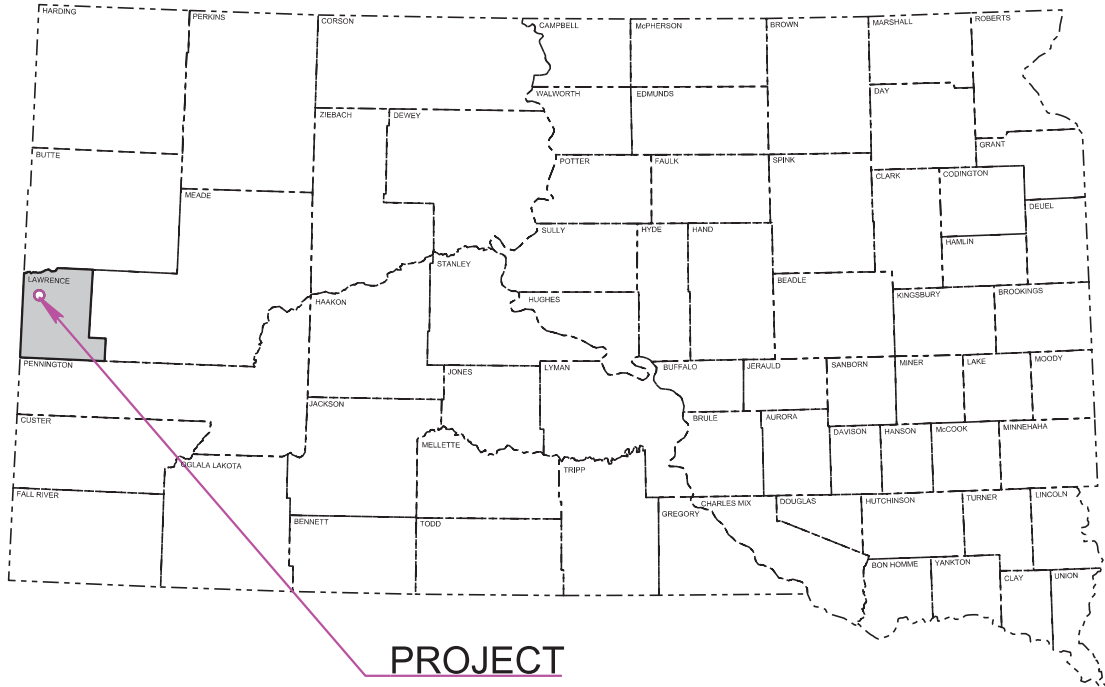

STATE OF SOUTH DAKOTA
DEPARTMENT OF TRANSPORTATION
PLANS FOR PROPOSED

PROJECT NH-B 014A(26)29
US HIGHWAY 14A
LAWRENCE COUNTY

STRUCTURE, APPROACH GRADING
PCN 06XL

STATE OF SOUTH DAKOTA	PROJECT	SHEET	TOTAL SHEETS
	NH-B 014A(26)29	1	135

Plotting Date: 07/07/2025 Rev 07/07/25 RU

INDEX OF SECTIONS

- Section A: Estimate of Quantities and Environmental Commitments
Section B: Grading Plans
Section C: Traffic Control Plans
Section D: Erosion and Sediment Control Plans
Section E: Structure Plans
Section F: Surfacing Plans
Section M: Pavement Marking Plans
Section S: Permanent Signing Plans
Section X: Cross Sections
Section Z: Pipe Sections

BEGIN NH-B 014A(26)29
Station 25+50.00 = Station 8+32.27
on F 0028(2) located 726.22 feet
South and 298.73 feet East of the
North 1/4 corner of Section 22-
Township 4 North - Range 2 East
of the B.H.M.
MRM 29.15+0.116

END NH-B 014A(26)29
Station 39+00.00 = Station 16+30.71
on F 0028(2) located 890.27 feet
South and 1051.05 feet West of the
Northeast corner of Section 22-
Township 4 North - Range 2 East
of the B.H.M.
MRM 29.15+0.372

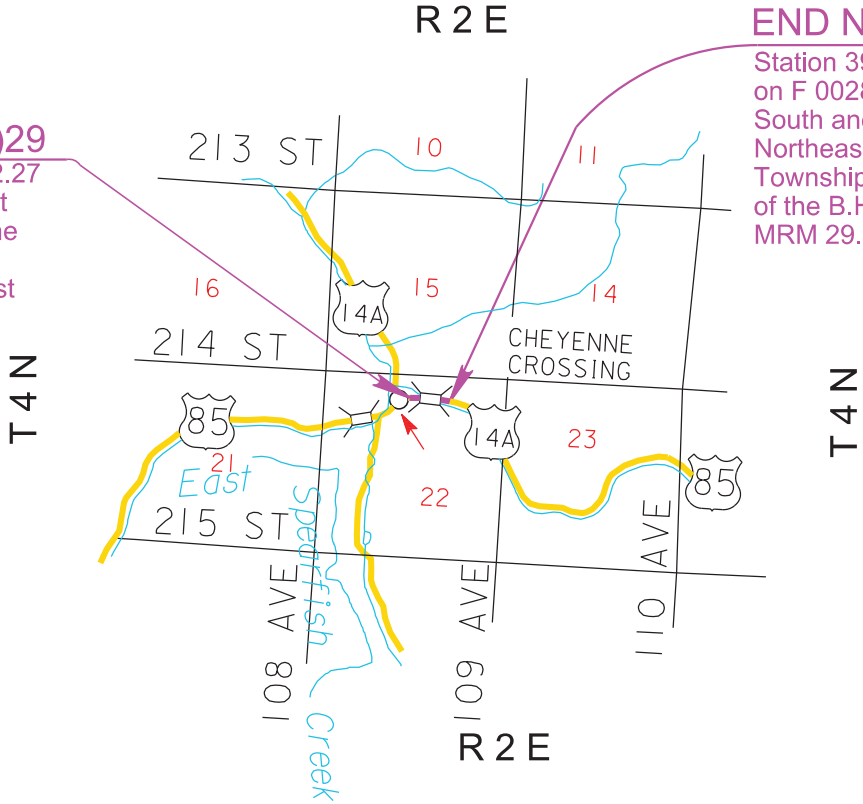

DESIGN DESIGNATION

AADT (2023)	1447
AADT (2048)	2259
DHV	370
D	51%
DHV T%	2%
AADT T%	4.4%
V	60 mph

STORM WATER PERMIT

Major Receiving
Body of Water: Spearfish Creek
Area Disturbed: 3 Acres
Total Project Area: 6 Acres
Approx. Begin Lat,Long: 44.2982, 103.8642

Gross Length	1,350.00 Feet	0.256 Miles
Length of Exceptions	0.00 Feet	0.000 Miles
Net Length	1,350.00 Feet	0.256 Miles



7

October 15, 2025

ESTIMATE OF QUANTITIES AND ENVIRONMENTAL COMMITMENTS

STATE OF SOUTH DAKOTA	PROJECT	SHEET	TOTAL SHEETS
	NH-B 014A(26)29	A1	A6

Plotting Date: 07/07/2025 Rev 06/25/25 RU

Section B - Grading

BID ITEM NUMBER	ITEM	QUANTITY	UNIT
004E0030	Maintenance of Traffic Diversion(s)	Lump Sum	LS
004E0050	Remove Traffic Diversion(s)	Lump Sum	LS
009E0010	Mobilization	Lump Sum	LS
009E3220	Reestablish Right-of-Way and Property Corner	29	Each
009E3230	Grade Staking	0.768	Mile
009E3245	Final Cross Section Survey	0.768	Mile
009E3250	Miscellaneous Staking	0.768	Mile
009E3280	Slope Staking	0.768	Mile
009E3290	Structure Staking	1	Each
009E3301	Engineer Directed Surveying/Staking	40.0	Hour
009E4200	Construction Schedule, Category II	Lump Sum	LS
100E0100	Clearing	Lump Sum	LS
110E1010	Remove Asphalt Concrete Pavement	7,425.5	SqYd
110E4290	Salvage Beam Guardrail	202.5	Ft
110E4390	Salvage MGS MASH Tangent End Terminal	2	Each
120E0010	Unclassified Excavation	17,446	CuYd
120E0600	Contractor Furnished Borrow	133	CuYd
120E2000	Undercutting	3,544	CuYd
250E0020	Incidental Work, Grading	Lump Sum	LS
450E0142	24" RCP Class 2, Furnish	164	Ft
450E0150	24" RCP, Install	164	Ft
450E2200	24" RCP Sloped End, Furnish	3	Each
450E2201	24" RCP Sloped End, Install	3	Each
450E4759	18" CMP 16 Gauge, Furnish	54	Ft
450E4760	18" CMP, Install	54	Ft
450E4769	24" CMP 16 Gauge, Furnish	40	Ft
450E4770	24" CMP, Install	40	Ft
450E5015	24" CMP Elbow, Furnish	2	Each
450E5016	24" CMP Elbow, Install	2	Each
450E5310	24" CMP Sloped End, Furnish	1	Each
450E5311	24" CMP Sloped End, Install	1	Each
450E5406	18" CMP Safety End, Furnish	2	Each
450E5407	18" CMP Safety End, Install	2	Each
450E8014	24" RCP to CMP Transition, Furnish	1	Each
450E8015	24" Pipe Transition, Install	1	Each
600E0200	Type II Field Laboratory	1	Each
630E1006	25'-0" Longspan MGS	1	Each
630E2018	MGS MASH Tangent End Terminal	2	Each
680E0204	4" Perforated PVC Drain Pipe with Sleeve	300	Ft
680E0224	4" PVC Outlet Pipe	60	Ft
680E2000	Concrete Headwall for Underdrain	1	Each
680E2500	Porous Backfill	126.0	Ton
720E1015	Bank and Channel Protection Gabion	9.0	CuYd

Section B – Grading (Cont.)

BID ITEM NUMBER	ITEM	QUANTITY	UNIT
734E0900	Temporary Diversion Channel for Fish Passage	1	Each
831E0110	Type B Drainage Fabric	30	SqYd
900E1080	Orange Plastic Safety Fence	100	Ft
900E1150	Right of Way Marker	24	Each

Section C - Traffic Control

BID ITEM NUMBER	ITEM	QUANTITY	UNIT
634E0010	Flagging	2,000.0	Hour
634E0020	Pilot Car	1,000.0	Hour
634E0110	Traffic Control Signs	299.2	SqFt
634E0120	Traffic Control, Miscellaneous	Lump Sum	LS
634E0275	Type 3 Barricade	4	Each
634E0310	Temporary Flexible Vertical Markers (Tabs)	5,390	Ft
634E0525	Linear Delineation System Panel, Barrier Mounted	44	Each
634E0600	4" Temporary Pavement Marking Tape Type I	216	Ft
634E0700	Traffic Control Movable Concrete Barrier	88	Each
634E0900	Portable Temporary Traffic Control Signal	2	Unit
634E1002	Detour and Restriction Signing	276.0	SqFt

Section D - Erosion and Sediment Control

BID ITEM NUMBER	ITEM	QUANTITY	UNIT
110E1690	Remove Sediment	0.6	CuYd
110E1693	Remove Erosion Control Wattle	68	Ft
110E1700	Remove Silt Fence	238	Ft
230E0010	Placing Topsoil	1,263	CuYd
230E0050	Topsoil Amendment	6,261	Lb
730E0100	Cover Crop Seeding	1.6	Bu
730E0251	Special Permanent Seed Mixture 1	42	Lb
730E1200	Hydroseeding	7,576	SqYd
731E0200	Fertilizing	0.80	Ton
732E0500	Fiber Reinforced Matrix	2.4	Ton
734E0044	Soil Stabilizer	1.0	Acre
734E0103	Type 3 Erosion Control Blanket	3,545	SqYd
734E0132	Type 2 Turf Reinforcement Mat	565.0	SqYd
734E0154	12" Diameter Erosion Control Wattle	270	Ft
734E0165	Remove and Reset Erosion Control Wattle	68	Ft
734E0170	Temporary Sediment Barrier	2,100	Ft
734E0604	High Flow Silt Fence	950	Ft
734E0610	Mucking Silt Fence	66	CuYd
734E0620	Repair Silt Fence	238	Ft
900E1320	Construction Entrance	2	Each

INDEX OF SHEETS

A1 and A2 Estimate of Quantities for Sections B, C, D, E, F, M, and S
A3 to A6 Environmental Commitments

Section E – Structure

Structure No. 41-096-211

BID ITEM NUMBER	ITEM	QUANTITY	UNIT
250E0030	Incidental Work, Structure	Lump Sum	LS
410E0010	Structural Steel	122	Lb
420E0200	Structure Excavation, Box Culvert	221	CuYd
421E0200	Box Culvert Undercut	686	CuYd
460E0120	Class A45 Concrete, Box Culvert	639.4	CuYd
460E0380	Install Dowel in Concrete	146	Each
480E0100	Reinforcing Steel	116,426	Lb
700E0210	Class B Riprap	825.5	Ton
734E1200	Natural Streambed Material	199.4	Ton
734E1201	Natural Streambed Material Type 1	673.9	Ton
831E0110	Type B Drainage Fabric	831	SqYd

Section F – Surfacing

BID ITEM NUMBER	ITEM	QUANTITY	UNIT
260E1010	Base Course	6,576.3	Ton
320E1200	Asphalt Concrete Composite	2,823.9	Ton
320E7012	Grind 12" Rumble Strip or Stripe in Asphalt Concrete	0.5	Mile
320E7028	Grind Centerline Rumble Stripe in Asphalt Concrete	0.3	Mile

ESTIMATE OF QUANTITIES AND ENVIRONMENTAL COMMITMENTS

STATE OF SOUTH DAKOTA	PROJECT	SHEET	TOTAL SHEETS
	NH-B 014A(26)29	A2	A6

Plotting Date: 09/02/2025 Rev 06/25/25 RU

Section M - Pavement Marking

BID ITEM NUMBER	ITEM	QUANTITY	UNIT
633E1220	High Build Waterborne Pavement Marking Paint, 4" White	3,390	Ft
633E1222	High Build Waterborne Pavement Marking Paint, 4" Yellow	3,006	Ft
633E5100	Grooving for Durable Pavement Marking, 4"	3,390	Ft

Section S - Permanent Signing

BID ITEM NUMBER	ITEM	QUANTITY	UNIT
110E0130	Remove Traffic Sign	8	Each
110E7150	Remove Sign for Reset	3	Each
632E1320	2.0"x2.0" Perforated Tube Post	42.9	Ft
632E1340	2.5"x2.5" Perforated Tube Post	72.6	Ft
632E2022	4"x4" White Delineator Back to Back with 1.12 Lb/Ft Post	15	Each
632E2510	Type 2 Object Marker Back to Back	4	Each
632E3203	Flat Aluminum Sign, Nonremovable Copy High Intensity	36.4	SqFt
632E3205	Flat Aluminum Sign, Nonremovable Copy Super/Very High Intensity	5.6	SqFt
632E3500	Reset Sign	3	Each

SPECIFICATIONS

Standard Specifications for Roads and Bridges, 10-1-25 Version, Required Provisions, and Special Provisions as included in the Proposal. The Standard Specifications for Roads and Bridges are available for download and viewing at <https://dot.sd.gov/doing-business/contractors/standard-specifications>.

1:200
Plot Scale -

Plotted From -
TRPR17190

File - ...lpj\lawr06\L\Notes\SectionA.dgn

ESTIMATE OF QUANTITIES AND ENVIRONMENTAL COMMITMENTS

STATE OF SOUTH DAKOTA	PROJECT	SHEET	TOTAL SHEETS
	NH-B 014A(26)29	A3	A6

Plotting Date: 06/25/2025 Rev 06/25/25 RU

ENVIRONMENTAL COMMITMENTS

The SDDOT is committed to protecting the environment and uses Environmental Commitments as a communication tool for the Engineer and Contractor to ensure that attention is given to avoid, minimize, and/or mitigate an environmental impact. Environmental commitments to various agencies and the public have been made to secure approval of this project. An agency with permitting authority can delay a project if identified environmental impacts have not been adequately addressed. Unless otherwise designated, the Contractor's primary contact regarding matters associated with these commitments will be the Project Engineer. During construction, the Project Engineer will verify that the Contractor has met Environmental Commitment requirements. These environmental commitments are not subject to change without prior written approval from the SDDOT Environmental Office.

Additional guidance on SDDOT's Environmental Commitments can be accessed through the Environmental Procedures Manual found at: <https://dot.sd.gov/media/documents/EnvironmentalProceduresManual.pdf> >

For questions regarding change orders in the field that may have an effect on an Environmental Commitment, the Project Engineer will contact the Environmental Engineer at 605-773-3180 or 605-773-4336 to determine whether an environmental analysis and/or resource agency coordination is necessary.

Once construction is complete, the Project Engineer will review all environmental commitments for the project and document their completion.

COMMITMENT A: AQUATIC RESOURCES

COMMITMENT A1: WETLANDS

All efforts to avoid and minimize wetland impacts from the project have resulted in approximately 0.23 acres of wetlands (includes temporary and permanent) becoming impacted. Refer to Section B – Grading Plans for location and boundaries of the impacted wetlands.

Table of Impacted Wetlands

Wetland No.	Station	Perm. Impact Left (Acres)	Perm. Impact Right (Acres)	Temp. Impact Left (Acres)	Temp. Impact Right (Acres)	Total Impact (Acres)
1	26+55 to 34+22	0.053	0.000	0.152	0.003	0.208
2	34+00	0.000	0.000	0.000	0.017	0.017

Action Taken/Required:

Mitigation is required in accordance with the “*Statewide Finding Regarding Wetlands for South Dakota Federal-Aid Highway Projects (February 2018)*”. Replacement of 0.053 acres of permanent wetland impacts will be completed through another wetland mitigation opportunity in a manner which considers FHWA's program-wide goal of ‘net gain’ of wetlands through enhancement, creation, and preservation.

Temporary impacts identified in the Table of Impacted Wetlands will not be mitigated as original contours and elevations will be re-established as designated in Section B – Grading Plans. Prior to initiating temporary work in wetlands, the Contractor will submit a plan to the Project Engineer in accordance with Section 7.21 D of the Specifications.

The Contractor will notify the Project Engineer if additional easement is needed to complete work adjacent to any wetland. The Project Engineer will obtain an appropriate course of action from the Environmental Office before proceeding with construction activities that affect any wetlands beyond the work limits and easements shown in the plans.

COMMITMENT A2: STREAMS

All efforts to avoid and minimize stream impacts from the project have resulted in approximately 0.08 acres of stream (includes temporary and permanent) becoming impacted. Refer to Section B – Grading Plans for location and boundaries of the impacted streams.

Table of Impacted Streams

Stream Name	Station	Perm. Impact (Acres)	Temp. Impact (Acres)	Total Impact (Acres)
Icebox Gulch (Ice Box Creek)	24+00 to 34+50	0.04	0.04	0.08

Action Taken/Required:

It has been determined that project impacts do not require mitigation. Temporary impacts identified in the Table of Impacted Streams will not be mitigated as the finished ground under the bridge will be shaped to match the upstream channel and flood plain and the existing low water channel will be maintained as near as practical to the existing location as designated in Section B – Grading Plans.

The Contractor will notify the Project Engineer if additional easement is needed to complete work adjacent to any stream. The Project Engineer will obtain an appropriate course of action from the Environmental Office before proceeding with construction activities that affect any streams beyond the work limits and easements shown in the plans.

COMMITMENT C: WATER SOURCE

The Contractor will not withdraw water with equipment previously used outside the State of South Dakota or previously used in aquatic invasive species (AIS) positive waters within South Dakota without prior approval from the SDDOT Environmental Office. To prevent and control the introduction and spread of invasive species into the project vicinity, all equipment will be power washed with hot water (≥140 °F) and completely dried for a minimum of 7 days prior to subsequent use. South Dakota administrative rule 41:10:04:02 forbids the possession and transport of AIS; therefore, all attached dirt, mud, debris and vegetation must be removed and all compartments and tanks capable of holding standing water must be drained. This includes, but is not limited to, all equipment, pumps, lines, hoses and holding tanks.

Action Taken/Required:

The Contractor will obtain the necessary permits from the regulatory agencies such as the South Dakota Department of Agriculture and Natural Resources (DANR) and the United States Army Corps of Engineers (USACE) prior to water extraction activities.

Additional information and mapping of water sources impacted by Aquatic Invasive Species in South Dakota can be accessed at:

< <https://sdleastwanted.sd.gov/maps/default.aspx> >

< [South Dakota Administrative Rule 41:10:04 Aquatic Invasive Species: https://sdlegislature.gov/rules/DisplayRule.aspx?Rule=41:10:04](https://sdlegislature.gov/rules/DisplayRule.aspx?Rule=41:10:04) >

COMMITMENT D: WATER QUALITY STANDARDS

COMMITMENT D1: SURFACE WATER QUALITY

Icebox Gulch (Ice Box Creek) is classified as a cold water marginal fishery with a total suspended solids standard of less than 90 mg/L 30-day average, less than 158 mg/L daily maximum.

Spearfish Creek is classified as a cold water permanent fishery with a total suspended solids standard of less than 30 mg/L 30-day average, less than 53 mg/L daily maximum.

Icebox Gulch (Ice Box Creek) and Spearfish Creek are classified as fish and wildlife propagation, recreation, irrigation, and stock watering waters. Because of these beneficial uses, special construction measures may have to be taken to ensure that this water body is not impacted.

This project may be in the vicinity of multiple streams and wetlands. These waters are considered waters of the state and are protected under Administrative Rules of South Dakota (ARSD) Chapter 74:51. Special construction measures may have to be taken to ensure that this water body is not impacted.

Action Taken/Required:

The Contractor is advised that the South Dakota Surface Water Quality Standards, administered by the South Dakota Department of Agriculture and Natural Resources (DANR), apply to this project. Special construction measures will be taken to ensure the above standard(s) of the surface waters are maintained and protected.

ESTIMATE OF QUANTITIES AND ENVIRONMENTAL COMMITMENTS

STATE OF SOUTH DAKOTA	PROJECT	SHEET	TOTAL SHEETS
	NH-B 014A(26)29	A4	A6

Plotting Date: 06/25/2025 Rev 06/25/25 RU

COMMITMENT D2: SURFACE WATER DISCHARGE

The DANR General Permit for Temporary Discharge is required for temporary dewatering and discharges to waters of the state. The effluent limit for total suspended solids will be 90 mg/L 30-day average. The effluent limit applies to discharges to all waters of the state except discharges to waters classified as cold water permanent fish life propagation waters according to the ARSD 74:51:01:45. For discharges to waters of the state classified as cold water permanent fish life propagation waters, the effluent limit for total suspended solids will be 53 mg/L daily maximum.

The permittee has the option of completing effluent testing or implementing a pollution prevention plan for compliance with this permit. If the permittee develops a pollution prevention plan instead of total suspended solids sampling, the plan must be developed and implemented prior to discontinuing total suspended solids sampling. Refer to Section 4.0 of the permit. If any pollutants are suspected of being discharged, a sample must be taken for those parameters listed in Section 3.4 of the permit.

Refer to Commitment D1: Surface Water Quality for stream classification.

Action Taken/Required:

If construction dewatering is required and this project is currently covered under a General Permit for Stormwater Discharges Associated with Construction Activities, the contractor will need to submit the dewatering information to the SDDANR using the following form:

< https://danr.sd.gov/OfficeOfWater/SurfaceWaterQuality/docs/DANR_AddTemplInfoFillable.pdf >

The Contractor will provide a copy of the approved permit or the submitted dewatering information to the Project Engineer prior to proceeding with any dewatering activities. The approved permit or submitted dewatering information must be kept on-site and as part of the project records.

Effluent monitoring, as a result of dewatering activities, will be summarized for each month and recorded on a separate Discharge Monitoring Report (DMR) and submitted to DANR monthly. Additional information can be found at:

< <https://danr.sd.gov/OfficeOfWater/SurfaceWaterQuality/swdpermitting/Ereporting.aspx> >

COMMITMENT E: STORM WATER

Construction activities constitute 1 acre or more of earth disturbance and/or work in a waterway.

Action Taken/Required:

The DANR General Permit for Stormwater Discharges Associated with Construction Activities is required for construction activity disturbing one or more acres of earth and work in a waterway. The SDDOT is the owner of this permit and will submit the NOI to DANR 15 days prior to project start in order to obtain coverage under the General Permit. Work can begin once the DANR letter of approval is received.

The Contractor must adhere to the “Special Provision Regarding Storm Water Discharges to Waters of the State.”

The Contractor will complete the DANR Contractor Certification Form prior to the pre-construction meeting. The form certifies under penalty of law that the Contractor understands and will comply with the terms and conditions of the permit for this project. Work may not begin on this project until this form is signed and submitted to DANR.

The form can be found at:
< https://danr.sd.gov/OfficeOfWater/SurfaceWaterQuality/docs/DANR_CGPAppendixCCA2018Fillable.pdf >

The Contractor is advised that permit coverage may also be required for off-site activities, such as borrow and staging areas, which are the responsibility of the Contractor.

Storm Water Pollution Prevention Plan

The Storm Water Pollution Prevention Plan (SWPPP) will be developed prior to the submittal of the NOI and will be implemented for all construction activities for compliance with the permit. The SWPPP must be kept on-site and updated as site conditions change. Erosion control measures and best management practices will be implemented in accordance with the SWPPP.

The DOT 298 Form will be used for site inspections and to document changes to the SWPPP. A copy of the completed inspection form will be filed with the SWPPP documents and retained for a minimum of three years.

The inspection will include disturbed areas of the construction site that have not been finally stabilized, areas used for storage materials, structural control measures, and locations where vehicles enter or exit the site. These areas will be inspected for evidence of, or the potential for, pollutants entering the drainage system. Erosion and sediment control measures identified in the SWPPP will be observed to ensure that they are operating correctly, and sediment is not tracked off the site.

Information on storm water permits and SWPPPs are available on the following websites:

SDDOT: < <https://dot.sd.gov/doing-business/environmental/stormwater> >

DANR:< <https://danr.sd.gov/OfficeOfWater/SurfaceWaterQuality/stormwater/default.aspx> >

EPA: < <https://www.epa.gov/npdes> >

COMMITMENT F: SEASONAL WORK RESTRICTION

The State of South Dakota Game, Fish, and Parks has designated a cold water fishery associated with this project.

Action Taken/Required:

Construction or demolition activities should not take place during the Seasonal Work Restriction listed in the below table to avoid conflicts with spawning fish.

If flows during this time are nonexistent or extremely low, the seasonal use restriction may not be applicable. The Contractor will not conduct in-stream work during the Seasonal Work Restriction without prior approval from the SDDOT Environmental Office.

Stream Name	Stream Classification	Seasonal Work Restriction
Icebox Gulch (Ice Box Creek)	Cold Water	October 1 to April 1

ESTIMATE OF QUANTITIES AND ENVIRONMENTAL COMMITMENTS

STATE OF SOUTH DAKOTA	PROJECT	SHEET	TOTAL SHEETS
	NH-B 014A(26)29	A5	A6

Plotting Date: 06/25/2025 Rev 06/25/25 RU

COMMITMENT H: WASTE DISPOSAL SITE

The Contractor will furnish a site(s) for the disposal of construction and/or demolition debris generated by this project.

Action Taken/Required:

Construction and/or demolition debris may not be disposed of within the Public ROW.

The waste disposal site(s) will be managed and reclaimed in accordance with the following from the General Permit for Construction/Demolition Debris Disposal Under the South Dakota Waste Management Program issued by the Department of Agriculture and Natural Resources.

The waste disposal site(s) will not be located in a wetland, within 200 feet of surface water, or in an area that adversely affects wildlife, recreation, aesthetic value of an area, or any threatened or endangered species, as approved by the Environmental Office and the Project Engineer.

If the waste disposal site(s) is located such that it is within view of any ROW, the following additional requirements will apply:

1. Construction and/or demolition debris consisting of concrete, asphalt concrete, or other similar materials will be buried in a trench separate from wood debris. The final cover over the construction and/or demolition debris will consist of a minimum of 1 foot of soil capable of supporting vegetation. Waste disposal sites provided outside of the Public ROW will be seeded in accordance with Natural Resources Conservation Service recommendations. The seeding recommendations may be obtained through the appropriate County NRCS Office. The Contractor will control the access to waste disposal sites not within the Public ROW with fences, gates, and placement of a sign or signs at the entrance to the site stating, “No Dumping Allowed”.

2. Concrete and asphalt concrete debris may be stockpiled within view of the ROW for a period not to exceed the duration of the project. Prior to project completion, the waste will be removed from view of the ROW or buried, and the waste disposal site reclaimed as noted above.

The above requirements will not apply to waste disposal sites that are covered by an individual solid waste permit as specified in SDCL 34A-6-58, SDCL 34A-6-1.13, and ARSD 74:27:10:06. Failure to comply with the requirements stated above may result in civil penalties in accordance with South Dakota Solid Waste Law, SDCL 34A-6-1.31.

All costs associated with furnishing waste disposal site(s), disposing of waste, maintaining control of access (fence, gates, and signs), and reclamation of the waste disposal site(s) will be incidental to the various contract items.

COMMITMENT I: HISTORIC PRESERVATION OFFICE CLEARANCES

The SDDOT has obtained concurrence with the State Historic Preservation Office (SHPO) for all work included within the project limits and all department designated sources and designated option material sources, stockpile sites, storage areas, and waste sites provided within the plans.

Action Taken/Required:

All earth disturbing activities not designated within the plans require a cultural resource review prior to scheduling the pre-construction meeting. This work includes but is not limited to: Contractor furnished material sources, material processing sites, stockpile sites, storage areas, plant sites, and waste areas.

The Contractor will arrange and pay for a record search and when necessary, a cultural resource survey. The Contractor has the option to contact the state Archaeological Research Center (ARC) at 605-394-1936 or another qualified archaeologist, to obtain either a records search or a cultural resources survey. A record search might be sufficient for review if the site was previously surveyed; however, a cultural resources survey may need to be conducted by a qualified archaeologist.

The Contractor will provide ARC with the following: a topographical map or aerial view in which the site is clearly outlined, site dimensions, project number, and PCN. If applicable, provide evidence that the site has been previously disturbed by farming, mining, or construction activities with a landowner statement that artifacts have not been found on the site.

The Contractor will submit the cultural resources survey report to SDDOT Environmental Office, 700 East Broadway Avenue, Pierre, SD 57501-2586. SDDOT will submit the information to the appropriate SHPO/THPO. Allow **30 Days** from the date this information is submitted to the Environmental Engineer for SHPO/THPO review.

In the event of an inadvertent discovery of human remains, funerary objects, or if evidence of cultural resources is identified during project construction activities, then such activities within 150 feet of the inadvertent discovery will immediately cease and the Project Engineer will be immediately notified. The Project Engineer will contact the SDDOT Environmental Office, who will contact the appropriate SHPO/THPO within 48 hours of the discovery to determine an appropriate course of action.

SHPO review does not relieve the Contractor of the responsibility for obtaining any additional permits and clearances for Contractor furnished material sources, material processing sites, stockpile sites, storage areas, plant sites, and waste areas that affect wetlands, threatened and endangered species, or waterways. The Contractor will not utilize a site known or suspected of having contaminated soil or water. The Contractor will provide the required permits and clearances to the Project Engineer at the preconstruction meeting.

COMMITMENT J: CONSTRUCTION PRACTICES FOR TEMPORARY WORKS IN WATERWAYS OF THE U.S.

The Contractor is advised that special construction measures must be taken to ensure that the waterways of the U.S. are not impacted.

Action Taken/Required:

Excavation will not occur below the ordinary high-water elevation in waterways outside of caissons, cribs, cofferdams, steel piling, or sheeting. The natural streambed will not be disturbed unless specified by the plans and under the observation of the Project Engineer. Refer to the Table of U.S. Waterways to Protect for ordinary high-water elevations. Any structure work over or within

the waterway will be constructed according to Section 7.21 C of the Specifications.

All dredged or excavated materials will be placed at a site above the ordinary high-water elevation in a confined area (not classified as a wetland) that is a minimum of 50 feet away from concentrated flows of storm water, drainage courses, and inlets to prevent return of such material to the waterway.

The construction of temporary work platforms, crossings, or berms below the ordinary high-water elevation will be allowed if all material placed below the ordinary high-water elevation consists of Class B or larger riprap.

All temporary caissons, cribs, cofferdams, steel piling, sheeting, work platforms, crossings, and berms will be removed with minimal disturbance to the streambed. Proper construction practices will be used to minimize increases in suspended solids and turbidity in the waterway.

Bridge berms, wing dams, traffic diversions, channel reconstruction, stream diversions, grading, etc. will be constructed in close conformity with the plans to ensure that the hydraulic capacity of the waterway is not changed.

Temporary waterway crossings required for the Contractor's construction operations will be constructed with an adequate drainage structure size and minimum fill height to reduce the potential for upstream flooding. The Contractor will be responsible for sizing the temporary drainage structure for these crossings.

All temporary works in waterways of the US are required to be covered in the Corp of Engineers 404 Permit. At the time of the preconstruction meeting, the Contractor will submit documentation for all temporary works for the purpose of complying with the 404 Permit requirements in accordance with Section 423.3 A of the Specifications.

Table of U.S. Waterways to Protect

Station	Waterway	Ordinary High-Water Elevation
28+00	Icebox Gulch (Ice Box Creek)	5391.4' (varies)

Stream channel excavation within “Waters of the US” is subject to USACE regulatory jurisdiction. Stream channel excavation cannot exceed the permitted quantities and/or surface area. The 404 Permit is included in the Special Provisions.

The Contractor will take all precautions necessary to prevent any incidental discharges associated with the excavation and hauling of material from the stream channel. This pertains to any excavation operations such as, foundation, pier, or abutment excavation, channel cleanout, excavation for riprap protection, and removal of any temporary fill associated with construction activities.

1:200

Plot Scale -

TRPR17190

Plotted From -

File - ...\\pjl\awr06\XL\Notes\SectionA.dgn

ESTIMATE OF QUANTITIES AND ENVIRONMENTAL COMMITMENTS

STATE OF SOUTH DAKOTA	PROJECT	SHEET	TOTAL SHEETS
	NH-B 014A(26)29	A6	A6

Plotting Date: 06/25/2025 Rev 06/25/25 RU

COMMITMENT N: SECTION 404 PERMIT

The SDDOT has obtained a Section 404 Permit from the USACE for the permanent actions associated with this project.

Action Taken/Required:

The Contractor will comply with all requirements contained in the Section 404 Permit.

The Contractor will also be responsible for obtaining a Section 404 Permit for any dredge, excavation, or fill activities associated with material sources, storage areas, waste sites, and Contractor work sites outside the plan work limits that affect wetlands, floodplains, or waters of the United States.

COMMITMENT Q: ARCHAEOLOGICAL COORDINATION

As a result of a Cultural Resources Survey, historic properties have been identified within and/or adjacent to the project rights-of-way.

The following historic property has been identified that requires avoidance of construction activities:

Table of Historic Properties

Station	Offset (Ft.)	L/R	Environmental Sensitive Site	Action
24+00 to 26+30	60	R	ESS-1	Do Not Disturb/Site Fencing

The locations and boundaries of the site(s) for avoidance are shown in Section B - Grading Plans.

Action Taken/Required:

If evidence for cultural resources is uncovered during project construction activities, then such activities within 150 feet of the inadvertent discovery will immediately cease and the Project Engineer will be immediately notified. The Project Engineer will contact the SDDOT Environmental Office, who will consult with the Archaeological Research Center (ARC), the SHPO, the United States Forest Service, and FHWA, to determine the appropriate course of action.

All artifacts, features, or other items of interest uncovered by project construction activities will not be displaced unless the landowner and the SHPO consent to it.

Prior to the pre-construction meeting, the Contractor will contact the ARC (Phone: 605-394-1936) to coordinate the installation schedule of orange plastic safety fence around the perimeter of the sensitive site(s) listed in the Table of Historic/Archeological Sites to ensure proper location, quality, and visibility of the orange safety fence. The exact location of the safety fence will be determined later in the field by the ARC representative.

The Contractor will give written notice to the Engineer seven (7) days prior to the commencement of earth disturbing activities near listed sites identified in the Table of Historic/Archaeological Site so the Engineer may notify ARC of

the day work will start and schedule the installation of orange safety fence. ARC is to be present during earth disturbing activities to monitor the removal of topsoil, ensure avoidance of the fenced sites, and identify any culturally sensitive sites that may be uncovered.

Work within the vicinity of the site(s) will not begin until the safety fence is installed. All costs associated with furnishing and installing the orange safety fence will be incidental to the contract unit price per foot for “Orange Plastic Safety Fence”. These identified sites cannot be used for material sources, storage areas, waste sites, and/or any other project related activities outside the plan work limits.

COMMITMENT S: FIRE PREVENTION IN THE BLACK HILLS AREA

This project is located within the Black Hills Forest Fire Protection Boundary.

Action Taken/Required:

The Contractor will adhere to the “Special Provision for Fire Plan”.

1:200

Plot Scale -

TRPR17190

Plotted From -

File - ...\\lawr06\\L\\Notes\\SectionA.dgn