

STATE OF SOUTH DAKOTA  
DEPARTMENT OF TRANSPORTATION  
PLANS FOR PROPOSED

PROJECT NH 212(206)313  
U.S. HIGHWAY 212  
SPINK COUNTY  
GRADING & INTERM SURFACING  
PCN 0808

STATE OF SOUTH DAKOTA	PROJECT	SHEET	TOTAL SHEETS
	NH 212(206)313	1	228

Plotting Date: 02/11/2025 Rev 2/11/2025 BT

INDEX OF SECTIONS

- Section A: Estimate of Quantities and Environmental Commitments
- Section B: Grading Plans
- Section C: Traffic Control Plans
- Section D: Erosion and Sediment Control Plans
- Section F: Surfacing Plans
- Section M: Pavement Marking Plans
- Section S: Permanent Signing Plans
- Section X: Cross Sections
- Section Z: Pipe Sections

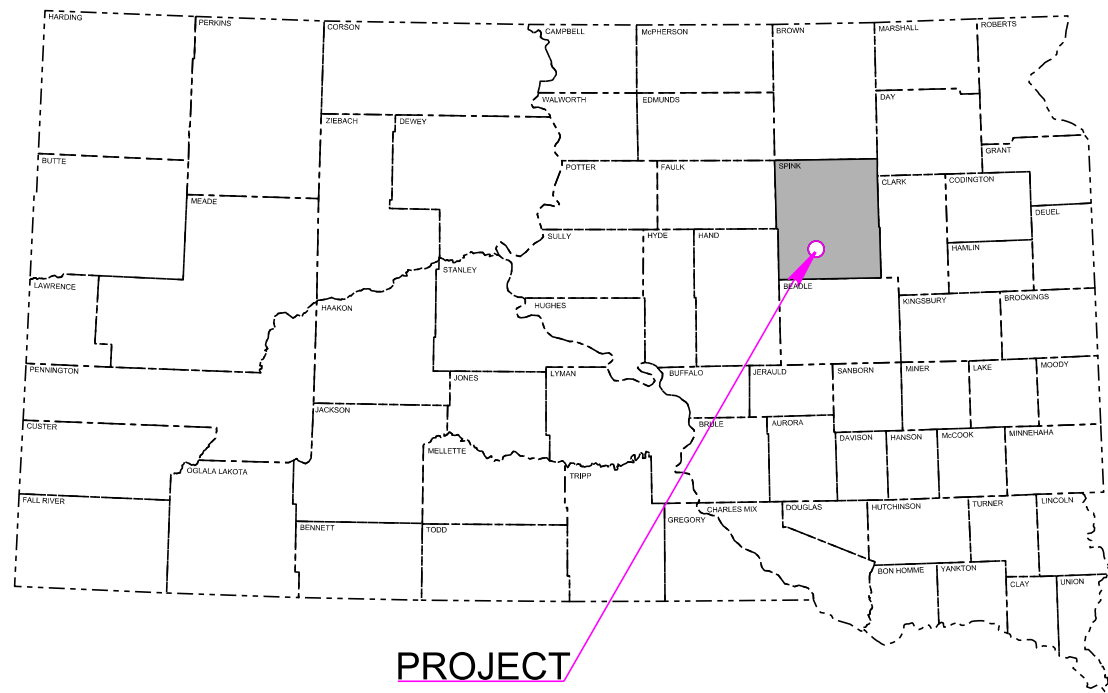

PROJECT

**BEGIN NH 212(206)313**

Station 10+00.00 = 368+00.00 on NH 0212(87)313 located 1644.88 feet west and 43.10 feet south from the Northwest 1/4 corner of Section 11 - Township 116 north - Range 63 West of the 5th P.M  
MRM 313.00+0.896

**BRIDGE EXCEPTION**

Structure No 58-183-250  
Station 98+88.61 to 101+42.32

**END NH 212(206)313**

Station 277+71.00 = 188+76.00 on NH 0212(87)313 located 1738.91 feet west of the east 1/4 corner of Section 34 - Township 117 North - Range 62 West of the 5th P.M  
MRM 319.00+0.018

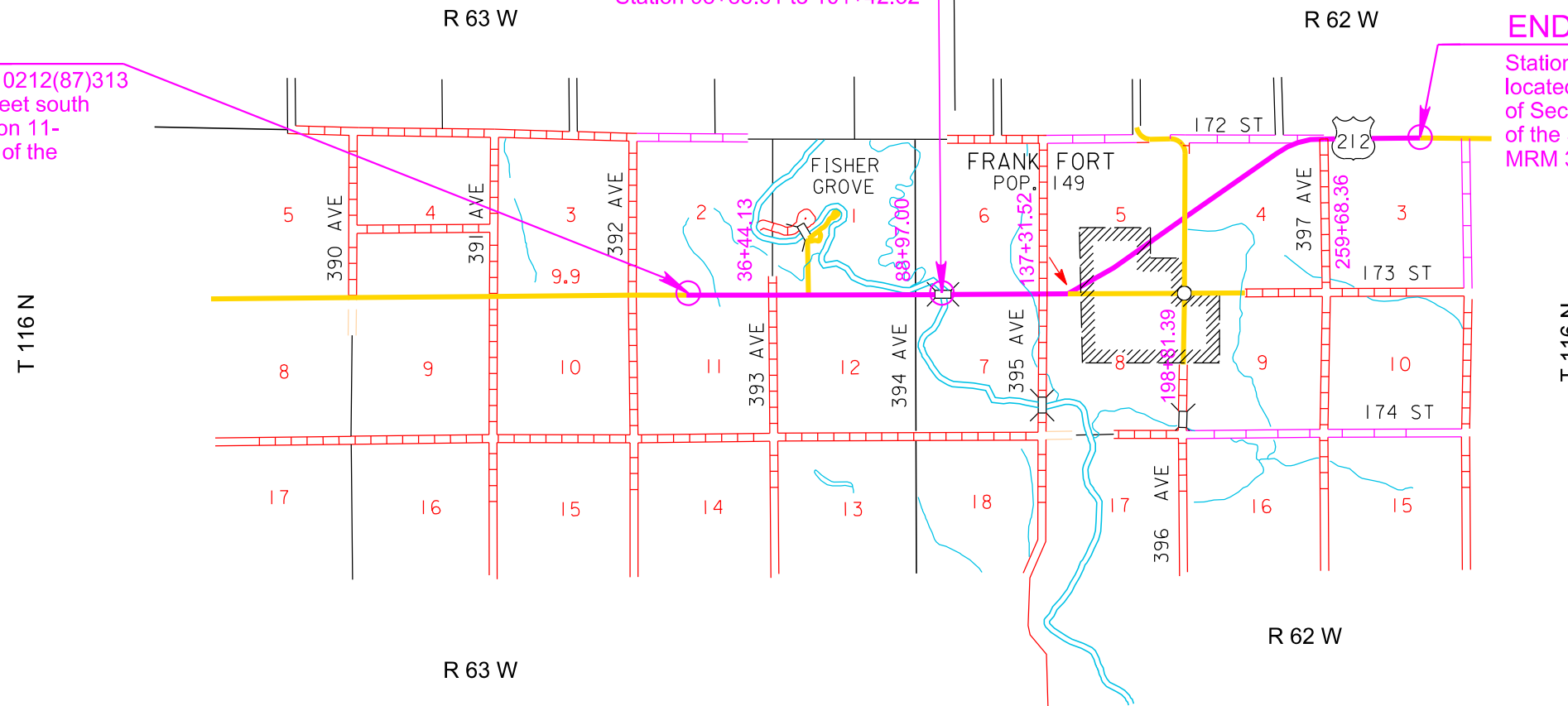

**DESIGN DESIGNATION**

AADT (2023)	1460
AADT (2044)	2120
DHV	250
D	50%
DHV T%	8.7%
AADT T%	19.1%
V	70mph

**STORM WATER PERMIT**

Major Receiving  
Body of Water: James River  
Area Disturbed: 96 Acres  
Total Project Area: 144 Acres  
Approx. Begin Lat, Long: 44.8789/-98.3719

100% Passing Sight Distance

Gross Length	26,785 Feet	5.07 Miles
Length of Exceptions	254 Feet	0.048 Miles
Net Length	26,531 Feet	5.02 Miles

1

March 19, 2025

Plot Scale - 1:200

Plotted From - TRPR17192

File - U:\trproj\spmk0808\title.dgn

# ESTIMATE OF QUANTITIES AND ENVIRONMENTAL COMMITMENTS

STATE OF SOUTH DAKOTA	PROJECT	SHEET	TOTAL SHEETS
	NH 212(206)313	A1	A6
Plotting Date: 02/11/2025		Rev 2/11/2025 BT	

## Section B – Grading

BID ITEM NUMBER	ITEM	QUANTITY	UNIT
009E0010	Mobilization	Lump Sum	LS
009E3220	Reestablish Right-of-Way and Property Corner	101	Each
009E3225	Reestablish Public Land Survey System Corner	5	Each
009E3230	Grade Staking	5.718	Mile
009E3245	Final Cross Section Survey	5.410	Mile
009E3250	Miscellaneous Staking	5.410	Mile
009E3280	Slope Staking	5.410	Mile
009E3301	Engineer Directed Surveying/Staking	40.0	Hour
009E4200	Construction Schedule, Category II	Lump Sum	LS
100E0020	Clear and Grub Tree	2	Each
100E0100	Clearing	Lump Sum	LS
110E0600	Remove Fence	35,777	Ft
110E0730	Remove Beam Guardrail	506.0	Ft
110E1020	Remove Asphalt Concrete Pavement	24,209.0	CuYd
120E0010	Unclassified Excavation	351,409	CuYd
120E0600	Contractor Furnished Borrow Excavation	21,019	CuYd
120E1000	Muck Excavation	15,162	CuYd
120E2000	Undercutting	146,086	CuYd
120E6100	Water for Embankment	2,520.0	MGal
250E0020	Incidental Work, Grading	Lump Sum	LS
260E6010	Granular Material	200.0	Ton
270E0020	Salvage and Stockpile Asphalt Mix Material	33,790.0	Ton
270E0040	Salvage and Stockpile Asphalt Mix and Granular Base Material	68,336.0	Ton
421E0100	Pipe Culvert Undercut	577	CuYd
450E0142	24" RCP Class 2, Furnish	284	Ft
450E0150	24" RCP, Install	284	Ft
450E0162	30" RCP Class 2, Furnish	548	Ft
450E0170	30" RCP, Install	548	Ft
450E0182	36" RCP Class 2, Furnish	110	Ft
450E0184	36" RCP Class 4, Furnish	110	Ft
450E0190	36" RCP, Install	220	Ft
450E0222	60" RCP Class 2, Furnish	132	Ft
450E0224	60" RCP Class 4, Furnish	208	Ft
450E0230	60" RCP, Install	340	Ft
450E2028	36" RCP Flared End, Furnish	2	Each
450E2029	36" RCP Flared End, Install	2	Each
450E2044	60" RCP Flared End, Furnish	4	Each
450E2045	60" RCP Flared End, Install	4	Each
450E2200	24" RCP Sloped End, Furnish	6	Each
450E2201	24" RCP Sloped End, Install	6	Each
450E2204	30" RCP Sloped End, Furnish	12	Each
450E2205	30" RCP Sloped End, Install	12	Each

## Section B – Grading (Cont.)

BID ITEM NUMBER	ITEM	QUANTITY	UNIT
450E3022	30" RCP Arch Class 2, Furnish	290	Ft
450E3030	30" RCP Arch, Install	290	Ft
450E3032	36" RCP Arch Class 2, Furnish	388	Ft
450E3040	36" RCP Arch, Install	388	Ft
450E3052	48" RCP Arch Class 2, Furnish	156	Ft
450E3060	48" RCP Arch, Install	156	Ft
450E4512	36" RCP Arch Flared End, Furnish	8	Each
450E4513	36" RCP Arch Flared End, Install	8	Each
450E4520	48" RCP Arch Flared End, Furnish	4	Each
450E4521	48" RCP Arch Flared End, Install	4	Each
450E4604	30" RCP Arch Sloped End, Furnish	6	Each
450E4605	30" RCP Arch Sloped End, Install	6	Each
450E4759	18" CMP 16 Gauge, Furnish	1,106	Ft
450E4760	18" CMP, Install	1,106	Ft
450E4768	24" CMP 14 Gauge, Furnish	156	Ft
450E4769	24" CMP 16 Gauge, Furnish	340	Ft
450E4770	24" CMP, Install	496	Ft
450E5015	24" CMP Elbow, Furnish	4	Each
450E5016	24" CMP Elbow, Install	4	Each
450E5215	24" CMP Flared End, Furnish	2	Each
450E5216	24" CMP Flared End, Install	2	Each
450E5406	18" CMP Safety End, Furnish	30	Each
450E5407	18" CMP Safety End, Install	30	Each
450E5410	24" CMP Safety End, Furnish	12	Each
450E5411	24" CMP Safety End, Install	12	Each
600E0200	Type II Field Laboratory	1	Each
620E0020	Type 2 Right-of-Way Fence	20,139	Ft
620E0510	Type 1 Temporary Fence	15,633	Ft
620E0520	Type 2 Temporary Fence	4,506	Ft
620E1020	2 Post Panel	31	Each
620E1030	3 Post Panel	20	Each
630E0500	Type 1 MGS	175.0	Ft
630E1501	Type 1 Retrofit Guardrail Transition	4	Each
630E2018	MGS MASH Tangent End Terminal	4	Each
700E0210	Class B Riprap	32.6	Ton
700E0310	Class C Riprap	364.0	Ton
720E1015	Bank and Channel Protection Gabion	37.0	CuYd
831E0110	Type B Drainage Fabric	485	SqYd
900E0010	Refurbish Single Mailbox	2	Each
900E1150	Right of Way Marker	27	Each

### INDEX OF SHEETS

A1 and A2 Estimate of Quantities for Sections B, C, D, F, M, and S  
A3 to A5 Environmental Commitments

## Section C - Traffic Control

BID ITEM NUMBER	ITEM	QUANTITY	UNIT
004E0010	Blading	100	Hour
260E1010	Base Course	500.0	Ton
601E0600	Dust Control Chloride, Haul Road Restoration	16,000	Lb
634E0010	Flagging	100.0	Hour
634E0020	Pilot Car	50.0	Hour
634E0110	Traffic Control Signs	968.5	SqFt
634E0120	Traffic Control, Miscellaneous	Lump Sum	LS
634E0275	Type 3 Barricade	36	Each
634E1002	Detour and Restriction Signing	2,114.8	SqFt

## Section D - Erosion and Sediment Control

BID ITEM NUMBER	ITEM	QUANTITY	UNIT
110E1690	Remove Sediment	3.7	CuYd
110E1693	Remove Erosion Control Wattle	400	Ft
110E1700	Remove Silt Fence	2,389	Ft
230E0010	Placing Topsoil	52,018	CuYd
730E0100	Cover Crop Seeding	30.0	Bu
730E0212	Type G Permanent Seed Mixture	1,677	Lb
731E0200	Fertilizing	32.20	Ton
732E0100	Mulching	129.0	Ton
734E0044	Soil Stabilizer	5.8	Acre
734E0103	Type 3 Erosion Control Blanket	9,964	SqYd
734E0154	12" Diameter Erosion Control Wattle	1,600	Ft
734E0165	Remove and Reset Erosion Control Wattle	400	Ft
734E0325	Surface Roughening	5.8	Acre
734E0510	Shaping for Erosion Control Blanket	2,107	Ft
734E0602	Low Flow Silt Fence	7,445	Ft
734E0604	High Flow Silt Fence	2,110	Ft
734E0610	Mucking Silt Fence	663	CuYd
734E0620	Repair Silt Fence	2,389	Ft
734E0630	Floating Silt Curtain	600	Ft
734E0635	Remove and Reset Floating Silt Curtain	200	Ft
900E1320	Construction Entrance	2	Each

# ESTIMATE OF QUANTITIES AND ENVIRONMENTAL COMMITMENTS

STATE OF SOUTH DAKOTA	PROJECT	SHEET	TOTAL SHEETS
	NH 212(206)313	A2	A6

Plotting Date: 02/12/2025 Rev 2/11/2025 BT

## Section F – Surfacing

BID ITEM NUMBER	ITEM	QUANTITY	UNIT
009E3320	Checker	Lump Sum	LS
120E6200	Water for Granular Material	1,631.2	MGal
260E1030	Base Course, Salvaged	135,916.5	Ton
260E6000	Granular Material, Furnish	33,790.3	Ton
270E0220	Blend and Stockpile Granular Material	67,580.6	Ton
330E0010	MC-70 Asphalt for Prime	93.0	Ton
330E0300	SS-1h or CSS-1h Asphalt for Fog Seal	20.4	Ton
330E1000	Blotting Sand for Prime	434.8	Ton
330E3000	Sand for Fog Seal	10.0	Ton
332E0010	Cold Milling Asphalt Concrete	85,714	SqYd
360E0020	AE150S Asphalt for Surface Treatment	145.3	Ton
360E1050	Type 3 Cover Aggregate	1,956.4	Ton

## Section M - Pavement Marking

BID ITEM NUMBER	ITEM	QUANTITY	UNIT
633E1220	High Build Waterborne Pavement Marking Paint, 4" White	53,942	Ft
633E1222	High Build Waterborne Pavement Marking Paint, 4" Yellow	13,158	Ft

## Section S - Permanent Signing

BID ITEM NUMBER	ITEM	QUANTITY	UNIT
110E0130	Remove Traffic Sign	43	Each
110E0135	Remove Delineator	120	Each
110E7150	Remove Sign for Reset	7	Each
632E1320	2.0"x2.0" Perforated Tube Post	790.3	Ft
632E1340	2.5"x2.5" Perforated Tube Post	8.0	Ft
632E2022	4"x4" White Delineator Back to Back with 1.12 Lb/Ft Post	130	Each
632E2028	4" Tubular White Delineator with 1.12 Lb/Ft Post	29	Each
632E2220	Guardrail Delineator	16	Each
632E2510	Type 2 Object Marker Back to Back	82	Each
632E3203	Flat Aluminum Sign, Nonremovable Copy High Intensity	258.9	SqFt
632E3205	Flat Aluminum Sign, Nonremovable Copy Super/Very High Intensity	232.1	SqFt
632E3500	Reset Sign	5	Each

# ESTIMATE OF QUANTITIES AND ENVIRONMENTAL COMMITMENTS

STATE OF SOUTH DAKOTA	PROJECT	SHEET	TOTAL SHEETS
	NH 212(206)313	A3	A6

Plotting Date: 02/11/2025 Rev 2/11/2025 BT

## SPECIFICATIONS

Standard Specifications for Roads and Bridges, 2015 Edition and Required Provisions, Supplemental Specifications, and Special Provisions as included in the Proposal.

## ENVIRONMENTAL COMMITMENTS

The SDDOT is committed to protecting the environment and uses Environmental Commitments as a communication tool for the Engineer and Contractor to ensure that attention is given to avoid, minimize, and/or mitigate an environmental impact. Environmental commitments to various agencies and the public have been made to secure approval of this project. An agency with permitting authority can delay a project if identified environmental impacts have not been adequately addressed. Unless otherwise designated, the Contractor's primary contact regarding matters associated with these commitments will be the Project Engineer. During construction, the Project Engineer will verify that the Contractor has met Environmental Commitment requirements. These environmental commitments are not subject to change without prior written approval from the SDDOT Environmental Office.

Additional guidance on SDDOT's Environmental Commitments can be accessed through the Environmental Procedures Manual found at: <https://dot.sd.gov/media/documents/EnvironmentalProceduresManual.pdf>

For questions regarding change orders in the field that may have an effect on an Environmental Commitment, the Project Engineer will contact the Environmental Engineer at 605-773-3180 or 605-773-4336 to determine whether an environmental analysis and/or resource agency coordination is necessary.

Once construction is complete, the Project Engineer will review all environmental commitments for the project and document their completion.

### COMMITMENT A: AQUATIC RESOURCES

#### COMMITMENT A1: WETLANDS

All efforts to avoid and minimize wetland impacts from the project have resulted in approximately 10.35 acres of wetlands (includes temporary and permanent) becoming impacted. Refer to Section B – Grading Plans/plans for location and boundaries of the impacted wetlands.

#### Table of Impacted Wetlands

Wetland No.	Station	Perm. Impact Left (Acres)	Perm. Impact Right (Acres)	Temp. Impact Left (Acres)	Temp. Impact Right (Acres)	Total Impact (Acres)
W2	69+00-79+00	0.000	0.013	0.000	0.907	0.92
W3	163+00-169+00	1.000	0.142	1.000	0.000	2.14
W4	159+00-181+00	0.794	0.000	0.051	0.000	0.85

W5	175+00-197+50	0.000	0.843	0.000	0.021	0.86
W6	181+50-197+50	0.591	0.000	0.000	0.000	0.59
W7	197+50-199+00	0.363	0.000	0.093	0.000	0.46
W8	197+75-199+00	0.000	0.084	0.000	0.121	0.21
W9	199+00	0.000	0.075	0.000	0.000	0.08
W10	202+50-205+00	0.000	0.019	0.000	0.004	0.2
W11	199+50-208+00	0.099	0.000	0.192	0.000	0.29
W12	207+00-209+50	0.056	0.000	0.000	0.000	0.06
W13	215+00-238+00	1.268	0.000	0.084	0.000	1.35
W14	221+00-238+50	0.000	1.005	0.000	0.065	1.07
W15	239+00-259+50	0.000	0.291	0.000	1.123	1.41
W16	260+50-263+00	0.000	0.001	0.000	0.047	0.05

#### Action Taken/Required:

SDDOT will acquire 5.29 credits from the DU ILF wetland bank in the upper James GSA to mitigate permanent impacts.

Temporary impacts identified in the Table of Impacted Wetlands will not be mitigated as original contours and elevations will be re-established as designated in Section B – Grading Plans. Prior to initiating temporary work in wetlands, the Contractor will submit a plan to the Project Engineer in accordance with Section 7.21 D of the Specifications.

The Contractor will notify the Project Engineer if additional easement is needed to complete work adjacent to any wetland. The Project Engineer will obtain an appropriate course of action from the Environmental Office before proceeding with construction activities that affect any wetlands beyond the work limits and easements shown in the plans.

#### COMMITMENT A2: STREAMS

All efforts to avoid and minimize stream impacts from the project have resulted in approximately 0.046 acres of stream (includes temporary and permanent) becoming impacted. Refer to Section B – Grading Plans/plans for location and boundaries of the impacted streams.

#### Table of Impacted Streams

Stream Name	Station	Perm. Impact Left (Acres)	Perm. Impact Right (Acres)	Temp. Impact Left (Acres)	Temp. Impact Right (Acres)	Total Impact (Acres)
James River	85+75	0.006	0.000	0.040	0.000	0.046

#### Action Taken/Required:

It has been determined that project impacts do not require mitigation. Temporary impacts identified in the Table of Impacted Streams will not be mitigated as the finished ground under the bridge will be shaped to match the upstream channel and flood plain and the existing low water channel will be maintained as near as practical to the existing location as designated in Section B – Grading Plans.

The Contractor will notify the Project Engineer if additional easement is needed to complete work adjacent to any stream. The Project Engineer will obtain an appropriate course of action from the Environmental Office before proceeding with construction activities that affect any streams beyond the work limits and easements shown in the plans.

### COMMITMENT B: FEDERALLY THREATENED, ENDANGERED, AND PROTECTED SPECIES

#### COMMITMENT B2: WHOOPING CRANE

The Whooping Crane is a spring and fall migratory bird in South Dakota that is about 5 feet tall and typically stops on wetlands, rivers, and agricultural lands along their migration route. An adult Whooping Crane is white with a red crown and a long, dark, pointed bill. Immature Whooping Cranes are cinnamon brown. While in flight, their long necks are kept straight and their long dark legs trail behind. Adult Whooping Cranes' black wing tips are visible during flight.

#### Action Taken/Required:

Harassment or other measures to cause the Whooping Crane to leave the site is a violation of the Endangered Species Act. If a Whooping Crane is sighted roosting in the vicinity of the project, borrow pits, or staging areas associated with the project, cease construction activities in the affected area until the Whooping Crane departs and immediately contact the Project Engineer. The Project Engineer will contact the Environmental Office so that the sighting can be reported to USFWS.

#### COMMITMENT B4: BALD EAGLE

Bald eagles are known to occur in this area.

#### Action Taken/Required:

Plot Scale - 1:200

Plotted From - TRPR17192

File - ...:\proj\spmk0808\Notes\SectionA.dgn

# ESTIMATE OF QUANTITIES AND ENVIRONMENTAL COMMITMENTS

STATE OF SOUTH DAKOTA	PROJECT	SHEET	TOTAL SHEETS
	NH 212(206)313	A4	A6

Plotting Date: 02/11/2025 Rev 2/11/2025 BT

If a nest is observed within one-half mile of the project site, notify the Project Engineer immediately so that he/she can consult with the Environmental Office for an appropriate course of action.

## **COMMITMENT C: WATER SOURCE**

The Contractor will not withdraw water with equipment previously used outside the State of South Dakota or previously used in aquatic invasive species (AIS) positive waters within South Dakota without prior approval from the SDDOT Environmental Office. To prevent and control the introduction and spread of invasive species into the project vicinity, all equipment will be power washed with hot water ( $\geq 140$  °F) and completely dried for a minimum of 7 days prior to subsequent use. South Dakota administrative rule 41:10:04:02 forbids the possession and transport of AIS; therefore, all attached dirt, mud, debris and vegetation must be removed and all compartments and tanks capable of holding standing water must be drained. This includes, but is not limited to, all equipment, pumps, lines, hoses and holding tanks.

The Contractor will not withdraw water directly from streams of the James, Big Sioux, and Vermillion watersheds without prior approval from the SDDOT Environmental Office.

### **Action Taken/Required:**

The Contractor will obtain the necessary permits from the regulatory agencies such as the South Dakota Department of Agriculture and Natural Resources (DANR) and the United States Army Corps of Engineers (USACE) prior to water extraction activities.

Additional information and mapping of water sources impacted by Aquatic Invasive Species in South Dakota can be accessed at:

< <https://sdleastwanted.sd.gov/maps/default.aspx> >

< [South Dakota Administrative Rule 41:10:04 Aquatic Invasive Species: https://sdlegislature.gov/rules/DisplayRule.aspx?Rule=41:10:04](https://sdlegislature.gov/rules/DisplayRule.aspx?Rule=41:10:04) >

## **COMMITMENT D: WATER QUALITY STANDARDS**

### **COMMITMENT D1: SURFACE WATER QUALITY**

The James River is classified as a warm water permanent fishery with a total suspended solids standard of less than 90 mg/L 30-day average, less than 158 mg/L daily maximum.

Timber Creek is classified as warm water, marginal fishery with a total suspended solids standard of less than 150 mg/L 30-day average, less than 263 mg/L daily maximum.

This project may be in the vicinity of multiple streams and wetlands. These waters are considered waters of the state and are protected under Administrative Rules of South Dakota (ARSD) Chapter 74:51. Special construction measures may have to be taken to ensure that this water body is not impacted.

### **Action Taken/Required:**

The Contractor is advised that the South Dakota Surface Water Quality Standards, administered by the South Dakota Department of Agriculture and

Natural Resources (DANR), apply to this project. Special construction measures will be taken to ensure the above standard(s) of the surface waters are maintained and protected.

### **COMMITMENT D2: SURFACE WATER DISCHARGE**

The DANR General Permit for Temporary Discharge is required for temporary dewatering and discharges to waters of the state. The effluent limit for total suspended solids will be 90 mg/L 30-day average. The effluent limit applies to discharges to all waters of the state except discharges to waters classified as cold water permanent fish life propagation waters according to the ARSD 74:51:01:45. For discharges to waters of the state classified as cold water permanent fish life propagation waters, the effluent limit for total suspended solids will be 53 mg/L daily maximum.

The permittee has the option of completing effluent testing or implementing a pollution prevention plan for compliance with this permit. If the permittee develops a pollution prevention plan instead of total suspended solids sampling, the plan must be developed and implemented prior to discontinuing total suspended solids sampling. Refer to Section 4.0 of the permit. If any pollutants are suspected of being discharged, a sample must be taken for those parameters listed in Section 3.4 of the permit.

Refer to Commitment D1: Surface Water Quality for stream classification.

### **Action Taken/Required:**

If construction dewatering is required and this project is currently covered under a General Permit for Stormwater Discharges Associated with Construction Activities, the contractor will need to submit the dewatering information to the SDDANR using the following form:

< [https://danr.sd.gov/OfficeOfWater/SurfaceWaterQuality/docs/DANR\\_AddTempInfoFillable.pdf](https://danr.sd.gov/OfficeOfWater/SurfaceWaterQuality/docs/DANR_AddTempInfoFillable.pdf) >

The Contractor will provide a copy of the approved permit or the submitted dewatering information to the Project Engineer prior to proceeding with any dewatering activities. The approved permit or submitted dewatering information must be kept on-site and as part of the project records.

Effluent monitoring, as a result of dewatering activities, will be summarized for each month and recorded on a separate Discharge Monitoring Report (DMR) and submitted to DANR monthly. Additional information can be found at:

< <https://danr.sd.gov/OfficeOfWater/SurfaceWaterQuality/swdpermitting/Ereporting.aspx> >

### **COMMITMENT E: STORM WATER**

Construction activities constitute 1 acre or more of earth disturbance and/or work in a waterway.

### **Action Taken/Required:**

The DANR General Permit for Stormwater Discharges Associated with Construction Activities is required for construction activity disturbing one or more acres of earth and work in a waterway. The SDDOT is the owner of this permit and will submit the NOI to DANR 15 days prior to project start in order to obtain coverage under the General Permit. Work can begin once the DANR letter of approval is received.

The Contractor must adhere to the "Special Provision Regarding Storm Water Discharges to Waters of the State."

The Contractor will complete the DANR Contractor Certification Form prior to the pre-construction meeting. The form certifies under penalty of law that the Contractor understands and will comply with the terms and conditions of the permit for this project. Work may not begin on this project until this form is signed and submitted to DANR.

The form can be found at:

< [https://danr.sd.gov/OfficeOfWater/SurfaceWaterQuality/docs/DANR\\_CGPApendixCCA2018Fillable.pdf](https://danr.sd.gov/OfficeOfWater/SurfaceWaterQuality/docs/DANR_CGPApendixCCA2018Fillable.pdf) >

The Contractor is advised that permit coverage may also be required for off-site activities, such as borrow and staging areas, which are the responsibility of the Contractor.

### **Storm Water Pollution Prevention Plan**

The Storm Water Pollution Prevention Plan (SWPPP) will be developed prior to the submittal of the NOI and will be implemented for all construction activities for compliance with the permit. The SWPPP must be kept on-site and updated as site conditions change. Erosion control measures and best management practices will be implemented in accordance with the SWPPP.

The DOT 298 Form will be used for site inspections and to document changes to the SWPPP. A copy of the completed inspection form will be filed with the SWPPP documents and retained for a minimum of three years.

The inspection will include disturbed areas of the construction site that have not been finally stabilized, areas used for storage materials, structural control measures, and locations where vehicles enter or exit the site. These areas will be inspected for evidence of, or the potential for, pollutants entering the drainage system. Erosion and sediment control measures identified in the SWPPP will be observed to ensure that they are operating correctly, and sediment is not tracked off the site.

Information on storm water permits and SWPPPs are available on the following websites:

SDDOT: < <https://dot.sd.gov/doing-business/environmental/stormwater> >

DANR: < <https://danr.sd.gov/OfficeOfWater/SurfaceWaterQuality/stormwater/default.aspx> >

EPA: < <https://www.epa.gov/npdes> >

# ESTIMATE OF QUANTITIES AND ENVIRONMENTAL COMMITMENTS

STATE OF SOUTH DAKOTA	PROJECT NH 212(206)313	SHEET A5	TOTAL SHEETS A6
-----------------------	---------------------------	-------------	--------------------

Plotting Date: 02/11/2025 Rev 2/11/2025 BT

## COMMITMENT H: WASTE DISPOSAL SITE

The Contractor will furnish a site(s) for the disposal of construction and/or demolition debris generated by this project.

### Action Taken/Required:

Construction and/or demolition debris may not be disposed of within the Public ROW.

The waste disposal site(s) will be managed and reclaimed in accordance with the following from the General Permit for Construction/Demolition Debris Disposal Under the South Dakota Waste Management Program issued by the Department of Agriculture and Natural Resources.

The waste disposal site(s) will not be located in a wetland, within 200 feet of surface water, or in an area that adversely affects wildlife, recreation, aesthetic value of an area, or any threatened or endangered species, as approved by the Environmental Office and the Project Engineer.

If the waste disposal site(s) is located such that it is within view of any ROW, the following additional requirements will apply:

1. Construction and/or demolition debris consisting of concrete, asphalt concrete, or other similar materials will be buried in a trench separate from wood debris. The final cover over the construction and/or demolition debris will consist of a minimum of 1 foot of soil capable of supporting vegetation. Waste disposal sites provided outside of the Public ROW will be seeded in accordance with Natural Resources Conservation Service recommendations. The seeding recommendations may be obtained through the appropriate County NRCS Office. The Contractor will control the access to waste disposal sites not within the Public ROW with fences, gates, and placement of a sign or signs at the entrance to the site stating, "No Dumping Allowed".

2. Concrete and asphalt concrete debris may be stockpiled within view of the ROW for a period not to exceed the duration of the project. Prior to project completion, the waste will be removed from view of the ROW or buried, and the waste disposal site reclaimed as noted above.

The above requirements will not apply to waste disposal sites that are covered by an individual solid waste permit as specified in SDCL 34A-6-58, SDCL 34A-6-1.13, and ARSD 74:27:10:06.

Failure to comply with the requirements stated above may result in civil penalties in accordance with South Dakota Solid Waste Law, SDCL 34A-6-1.31.

All costs associated with furnishing waste disposal site(s), disposing of waste, maintaining control of access (fence, gates, and signs), and reclamation of the waste disposal site(s) will be incidental to the various contract items.

## COMMITMENT I: HISTORIC PRESERVATION OFFICE CLEARANCES

The SDDOT has obtained concurrence with the State Historic Preservation Office (SHPO or THPO) for all work included within the project limits and all department designated sources and designated option material sources, stockpile sites, storage areas, and waste sites provided within the plans.

### Action Taken/Required:

All earth disturbing activities not designated within the plans require a cultural resource review prior to scheduling the pre-construction meeting. This work includes but is not limited to: Contractor furnished material sources, material processing sites, stockpile sites, storage areas, plant sites, and waste areas.

The Contractor will arrange and pay for a record search and when necessary, a cultural resource survey. The Contractor has the option to contact the state Archaeological Research Center (ARC) at 605-394-1936 or another qualified archaeologist, to obtain either a records search or a cultural resources survey. A record search might be sufficient for review if the site was previously surveyed; however, a cultural resources survey may need to be conducted by a qualified archaeologist.

The Contractor will provide ARC with the following: a topographical map or aerial view in which the site is clearly outlined, site dimensions, project number, and PCN. If applicable, provide evidence that the site has been previously disturbed by farming, mining, or construction activities with a landowner statement that artifacts have not been found on the site.

The Contractor will submit the cultural resources survey report to SDDOT Environmental Office, 700 East Broadway Avenue, Pierre, SD 57501-2586. SDDOT will submit the information to the appropriate SHPO/THPO. Allow **30 Days** from the date this information is submitted to the Environmental Engineer for SHPO/THPO review.

In the event of an inadvertent discovery of human remains, funerary objects, or if evidence of cultural resources is identified during project construction activities, then such activities within 150 feet of the inadvertent discovery will immediately cease and the Project Engineer will be immediately notified. The Project Engineer will contact the SDDOT Environmental Office, who will contact the appropriate SHPO/THPO within 48 hours of the discovery to determine an appropriate course of action.

SHPO/THPO review does not relieve the Contractor of the responsibility for obtaining any additional permits and clearances for Contractor furnished material sources, material processing sites, stockpile sites, storage areas, plant sites, and waste areas that affect wetlands, threatened and endangered species, or waterways. The Contractor will not utilize a site known or suspected of having contaminated soil or water. The Contractor will provide the required permits and clearances to the Project Engineer at the preconstruction meeting.

## COMMITMENT J: CONSTRUCTION PRACTICES FOR TEMPORARY WORKS IN WATERWAYS OF THE U.S.

The Contractor is advised that special construction measures must be taken to ensure that the waterways of the U.S. are not impacted.

### Action Taken/Required:

Excavation will not occur below the ordinary high-water elevation in waterways outside of caissons, cribs, cofferdams, steel piling, or sheeting. The natural streambed will not be disturbed unless specified by the plans and under the observation of the Project Engineer. Refer to the Table of U.S. Waterways to Protect for ordinary high-water elevations. Any structure work over or within the waterway will be constructed according to Section 7.21 C of the Specifications.

All dredged or excavated materials will be placed at a site above the ordinary high-water elevation in a confined area (not classified as a wetland) that is a minimum of 50 feet away from concentrated flows of storm water, drainage courses, and inlets to prevent return of such material to the waterway.

The construction of temporary work platforms, crossings, or berms below the ordinary high-water elevation will be allowed if all material placed below the ordinary high-water elevation consists of Class B or larger riprap.

All temporary caissons, cribs, cofferdams, steel piling, sheeting, work platforms, crossings, and berms will be removed with minimal disturbance to the streambed. Proper construction practices will be used to minimize increases in suspended solids and turbidity in the waterway.

Bridge berms, wing dams, traffic diversions, channel reconstruction, stream diversions, grading, etc. will be constructed in close conformity with the plans to ensure that the hydraulic capacity of the waterway is not changed.

Temporary waterway crossings required for the Contractor's construction operations will be constructed with an adequate drainage structure size and minimum fill height to reduce the potential for upstream flooding. The Contractor will be responsible for sizing the temporary drainage structure for these crossings.

All temporary works in waterways of the US are required to be covered in the Corp of Engineers 404 Permit. At the time of the preconstruction meeting, the Contractor will submit documentation for all temporary works for the purpose of complying with the 404 Permit requirements in accordance with Section 423.3 A of the Specifications.

### Table of U.S. Waterways to Protect

Station	Waterway	Ordinary High-Water Elevation
85+75L	James River	12.41.9'

Stream channel excavation within "Waters of the US" is subject to USACE regulatory jurisdiction. Stream channel excavation cannot exceed the permitted quantities and/or surface area. The 404 Permit is included in the Special Provisions.

The Contractor will take all precautions necessary to prevent any incidental discharges associated with the excavation and hauling of material from the stream channel. This pertains to any excavation operations such as, foundation, pier, or abutment excavation, channel cleanout, excavation for riprap protection, and removal of any temporary fill associated with construction activities.

# ESTIMATE OF QUANTITIES AND ENVIRONMENTAL COMMITMENTS

STATE OF SOUTH DAKOTA	PROJECT	SHEET	TOTAL SHEETS
	NH 212(206)313	A6	A6

Plotting Date: 02/11/2025 Rev 2/11/2025 BT

## COMMITMENT M: SECTION 4(f)/6(f) RESOURCES

### COMMITMENT M1: SECTION 4(f) PROPERTY

The following Section 4(f) property is located adjacent to this project.

Station	Section 4(f) Property
49+50 L	Fischer Grove State Park

### Action Taken/Required:

The following measures are required to minimize harm to the above Section 4(f) property:

The contractor must adhere to Section C Traffic Plan Note: Fisher Grove Country Club/State Park Campground: The Contractor will be responsible to maintain access at all times for the Fisher Grove Country Club and Fisher Gove State Park Campground located on Fishers Lane.

The contractor shall notify the Project Engineer if addition temporary or permanent easement is necessary to construct the project. Temporary occupancy and permanent incorporation of, and restriction of access to, the Section 4(f) property must be avoided unless there are no feasible or prudent alternatives to use of the land and the action includes all possible planning to minimize harm to the property. Section 4(f) use must be approved by the Federal Highway Administration.

### COMMITMENT N: SECTION 404 PERMIT

The SDDOT has obtained a Section 404 Permit from the USACE for the permanent actions associated with this project.

### Action Taken/Required:

The Contractor will comply with all requirements contained in the Section 404 Permit.

The Contractor will also be responsible for obtaining a Section 404 Permit for any dredge, excavation, or fill activities associated with material sources, storage areas, waste sites, and Contractor work sites outside the plan work limits that affect wetlands, floodplains, or waters of the United States.

Plot Scale - 1:200

Plotted From - TRPR17192

File - ...\\spmk0808\Notes\SectionA.dgn