

Section D: Erosion Control Plans

STATE OF SOUTH DAKOTA	PROJECT	SHEET	TOTAL SHEETS
	NH 0018(239)244 P 0049(10)42		
Plotting Date: 02/07/2025		D1	D2

INDEX OF SHEETS

D1	General Layout W/Index
D2	Estimate With Notes

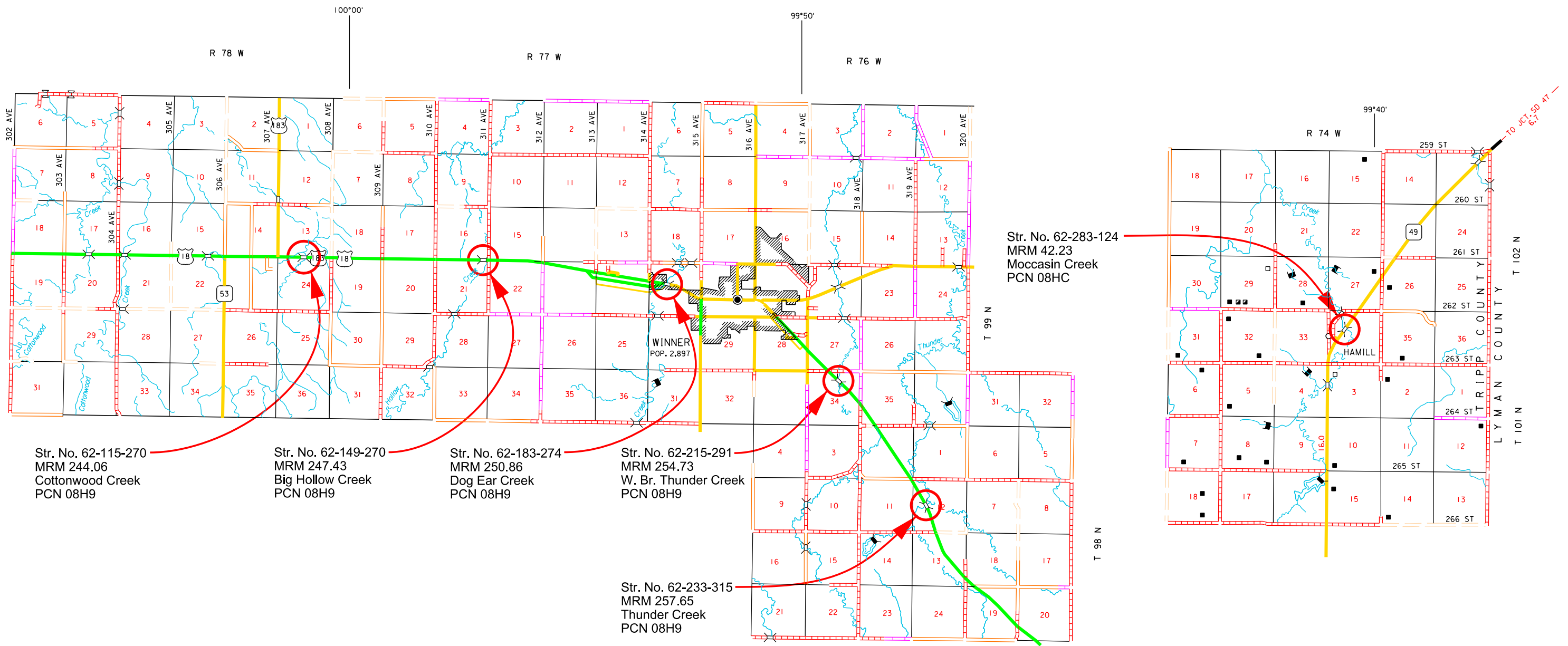

Plot Scale - 1:100

Plotted From - TRPR22410

Plot Name -

File - ...ICAD\08H9_Erosion Control.dgn

SECTION D ESTIMATE OF QUANTITIES

PCN 08H9

BID ITEM NUMBER	ITEM	QUANTITY	UNIT
230E0100	Remove and Replace Topsoil	Lump Sum	LS
734E0010	Erosion Control	Lump Sum	LS

PCN 08HC

BID ITEM NUMBER	ITEM	QUANTITY	UNIT
230E0100	Remove and Replace Topsoil	Lump Sum	LS
734E0010	Erosion Control	Lump Sum	LS

REMOVE AND REPLACE TOPSOIL

PCN 08H9

Prior to beginning resurfacing operations and guardrail installation, a 4" depth of topsoil will be removed or bladed down the respective inslope and left in a windrow a maximum of 10' from the edge of the existing shoulder. Following completion of construction, topsoil will be spread evenly over the disturbed areas.

The estimated amount of topsoil to be removed and replaced is 80 CuYd.

PCN 08HC

Topsoil will be salvaged and stockpiled prior to constructing the bridge berm repair areas. Limits of this work, depth of salvage, and stockpile location will be directed by the Engineer. Following completion of construction, topsoil will be spread evenly over the disturbed areas.

The estimated amount of topsoil to be removed and replaced is 30 CuYd.

All costs associated with removing and replacing the topsoil along areas to be resurfaced will be incidental to the contract lump sum price for "Remove and Replace Topsoil".

EROSION CONTROL

The estimated area requiring erosion control is 6,250 square feet for PCN 08H9. The estimated area requiring erosion control is 2,500 square feet for PCN 08HC. All costs for the erosion control work for furnishing, placing, and maintaining erosion control including equipment, labor, seeding, fertilizing, and mulching will be incidental to the contract lump sum price for "Erosion Control".

The limits of erosion control work will be determined by the Engineer during construction.

Mycorrhizal Inoculum

Mycorrhizal inoculum will consist of mycorrhizal fungi spores and mycorrhizal fungi-infected root fragments in a solid carrier. The carrier may include organic materials, calcinated clay, or other materials consistent with application and good plant growth. The supplier will provide certification of the fungal species claimed and the live propagule count. The inoculum will include a minimum 25% the fungal species *Rhizophagus intraradices*. The remaining 75% may include other endomycorrhizal fungal species.

All seed will be inoculated by the seed supplier with a minimum of 20,000 live propagules of mycorrhizal fungi per 1,000 square feet. All costs of inoculating the seed will be incidental to the contract unit price per pound for the corresponding permanent seed mixture.

The Mycorrhizal Inoculum provided will be from the approved product list. The approved product list may be viewed at the following internet site:

<http://apps.sd.gov/HC60ApprovedProducts/main.aspx>

Permanent Seeding

Type C Permanent Seed Mixture will consist of the following:

Grass Species	Variety	Pure Live Seed (PLS) (Pounds/Acre)
Western Wheatgrass	Arriba, Flintlock, Rodan, Rosana, Walsh	16
Canada Wildrye	Mandan	2
Oats or Spring Wheat: April through May; Winter Wheat: August through November		10
Total:		28

Cover Crop Seeding

Cover crop seeding may be used on this project as a temporary erosion control measure. The actual limits and use of cover crop seeding will be determined by the Engineer during construction.

STATE OF SOUTH DAKOTA	PROJECT	SHEET	TOTAL SHEETS
	NH 0018(239)244 P 0049(10)42	D2	D2

Revised 2/24/2025 JPJ

Fiber Mulching

Fiber mulch will be applied in a separate operation following permanent seeding.

The Contractor will allow the fiber mulch to cure a minimum of 18 hours prior to watering or any storm event to ensure proper cohesion between the soil and fiber particles.

The fiber mulch provided will be from the approved product list. The approved product list for fiber mulch may be viewed at the following internet site:

<http://apps.sd.gov/HC60ApprovedProducts/main.aspx>