

STATE OF SOUTH DAKOTA
DEPARTMENT OF TRANSPORTATION
PLANS FOR PROPOSED

PROJECT	SECTION	SHEET
090E-468 & IM 1902(00)1	A	1/3

Plotting Date: 06/21/2024

INDEX OF SECTIONS

- Section A: Estimate of Quantities and Environmental Commitments
Section C: Traffic Control Plans
Section E: Structure Plans

PROJECTS 090E-468 & IM 1902(00)1
INTERSTATE 90 & 190
MEADE & PENNINGTON COUNTIES

REPAIR OVERHEIGHT IMPACT ON BRIDGE
PCNS i7dd & 09NX

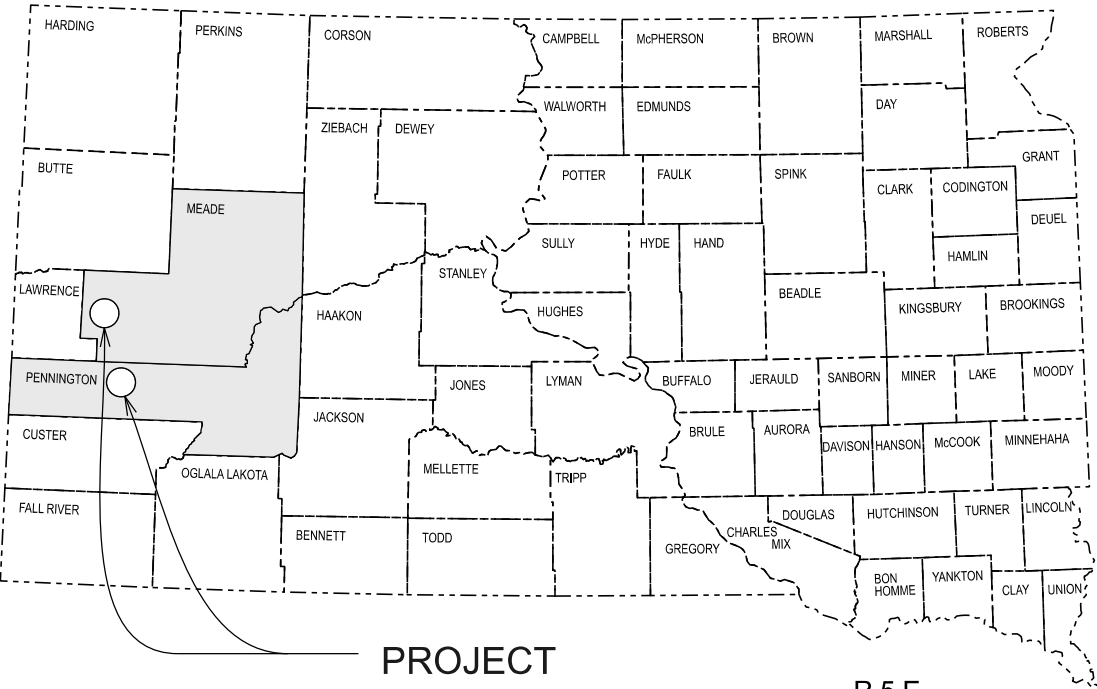

PROJECT

R 5 E

DESIGN DESIGNATION (I90E)

ADT (2023)	10801
ADT (2043)	17044
DHV	2504
D	51%
T DHV	6.3%
T ADT	13.9%
V	75 MPH

T 5 N

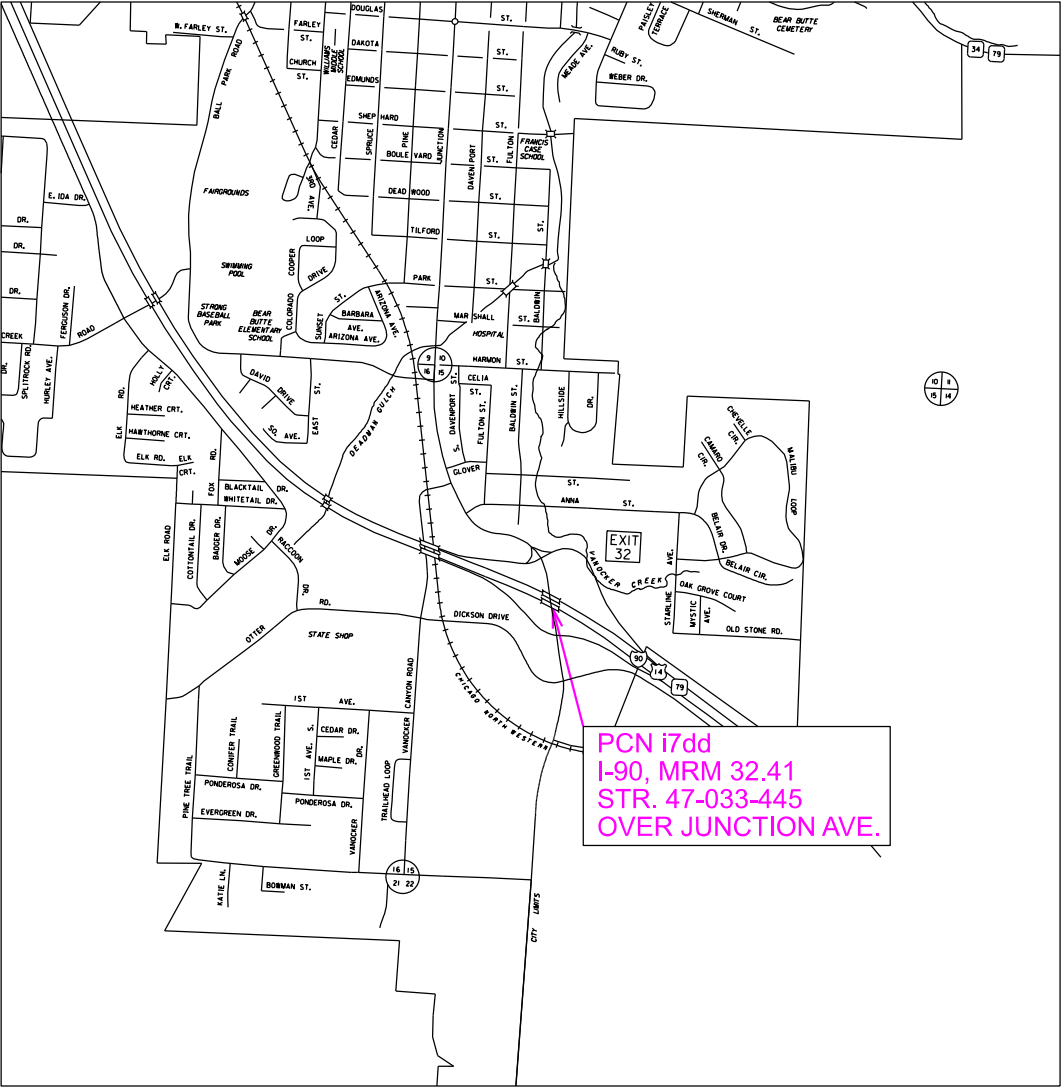

PCN i7dd
I-90, MRM 32.41
STR. 47-033-445
OVER JUNCTION AVE.

STORM WATER PERMIT
No Permit Required

DESIGN DESIGNATION (I90E)

ADT (2023)	16001
ADT (2043)	23186
DHV	2439
D	50%
T DHV	4.1%
T ADT	9.0%
V	65 MPH

T 2 N

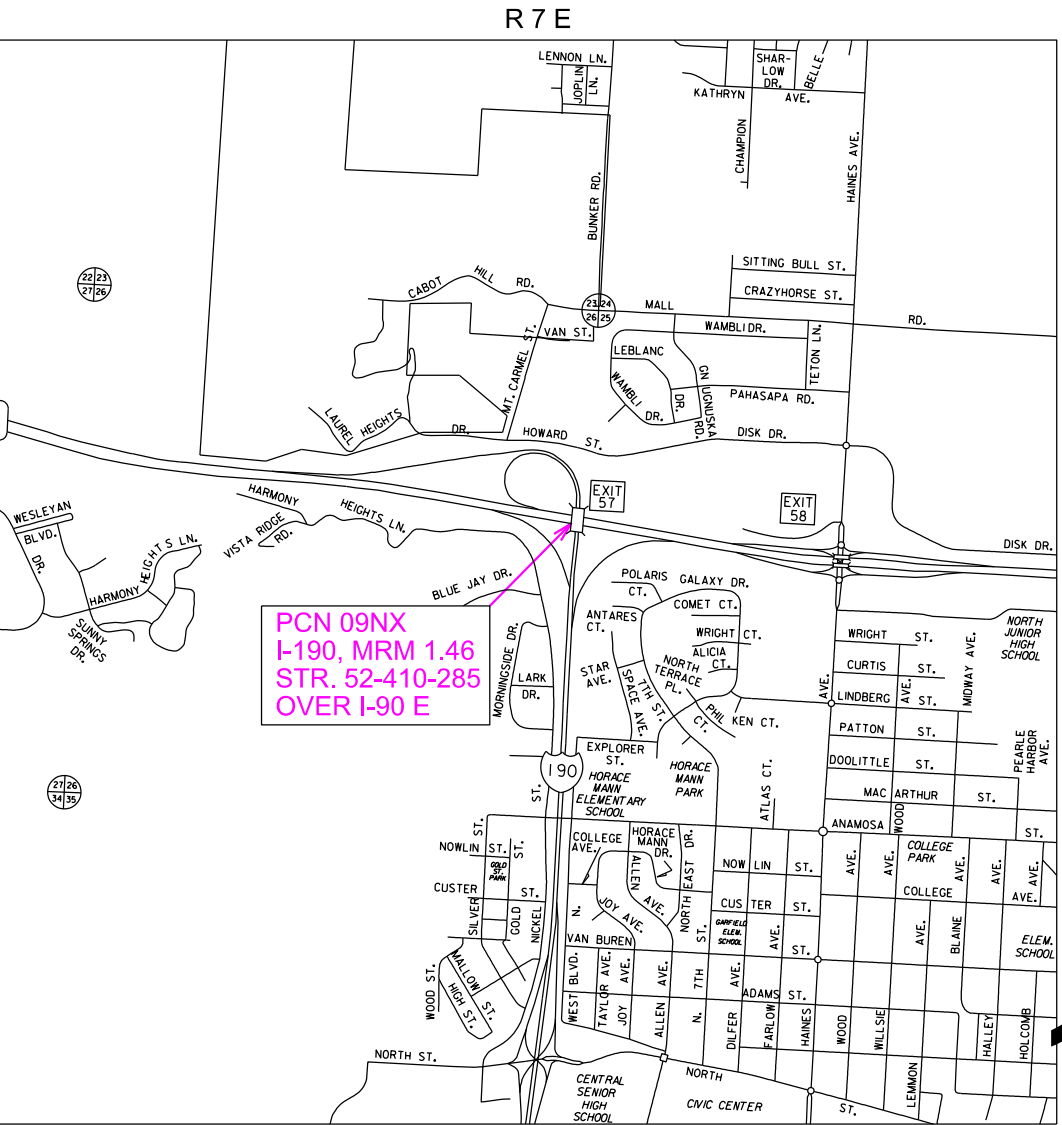

PCN 09NX
I-190, MRM 1.46
STR. 52-410-285
OVER I-90 E



1

August 7, 2024

ESTIMATE OF QUANTITIES and ENVIRONMENTAL COMMITMENTS

STATE OF SOUTH DAKOTA	PROJECT	SECTION	SHEET
	090E-486 & IM 1902(00)1	A	2/3

Revised Date: 7/12/24 GDS

Section C – Traffic Control (PCN 09NX)

BID ITEM NUMBER	ITEM	QUANTITY	UNIT
634E0110	Traffic Control Signs	337.0	SqFt
634E0120	Traffic Control, Miscellaneous	Lump Sum	LS
634E0275	Type 3 Barricade	5	Each
634E0420	Type C Advance Warning Arrow Board	1	Each
634E1215	Contractor Furnished Portable Changeable Message Sign	1	Each
634E1240	Queue Detection System	1	Each

Section C – Traffic Control (PCN i7dd)

BID ITEM NUMBER	ITEM	QUANTITY	UNIT
634E0010	Flagging	200.0	Hour
634E0110	Traffic Control Signs	306.0	SqFt
634E0120	Traffic Control, Miscellaneous	Lump Sum	LS
634E0275	Type 3 Barricade	3	Each

Section E – Structure 52-410-285 (PCN 09NX)

BID ITEM NUMBER	ITEM	QUANTITY	UNIT
009E0010	Mobilization	Lump Sum	LS
410E0030	Structural Steel, Miscellaneous	Lump Sum	LS
410E0250	Heat Straighten Steel Member(s)	Lump Sum	LS
410E0350	Remove and Replace Web	1	Each
410E0380	Remove and Replace Steel Diaphragm	2	Each
410E0508	Field Weld	12	In
410E0512	Grind Weld	12	In
410E0515	Drill Hole in Existing Steel	1	Each
410E0520	Surface Grinding of Structural Steel	144	SqIn
410E3010	Magnetic Particle Weld Inspection	2,242	In
410E3020	Ultrasonic Weld Inspection	40	In
410E3030	Magnetic Particle Weld Inspection, Impact Damage Repair	624	SqIn
412E0100	Bridge Repainting, Class I	Lump Sum	LS
412E0500	Paint Residue Containment	Lump Sum	LS

Section E – Structure 47-033-445 (PCN i7dd)

BID ITEM NUMBER	ITEM	QUANTITY	UNIT
009E0010	Mobilization	Lump Sum	LS
410E0030	Structural Steel, Miscellaneous	Lump Sum	LS
410E0250	Heat Straighten Steel Member(s)	Lump Sum	LS
410E0385	Repair Steel Diaphragm	1	Each
410E0508	Field Weld	136	In
410E0512	Grind Weld	136	In
410E0515	Drill Hole in Existing Steel	1	Each
410E0520	Surface Grinding of Structural Steel	144	SqIn
410E3010	Magnetic Particle Weld Inspection	412	In

SPECIFICATIONS

Standard Specifications for Roads and Bridges, 2015 Edition and Required Provisions, Supplemental Specifications, and Special Provisions as included in the Proposal.

ENVIRONMENTAL COMMITMENTS

The SDDOT is committed to protecting the environment and uses Environmental Commitments as a communication tool for the Engineer and Contractor to ensure that attention is given to avoid, minimize, and/or mitigate an environmental impact. Environmental commitments to various agencies and the public have been made to secure approval of this project. An agency with permitting authority can delay a project if identified environmental impacts have not been adequately addressed. Unless otherwise designated, the Contractor's primary contact regarding matters associated with these commitments will be the Project Engineer. During construction, the Project Engineer will verify that the Contractor has met Environmental Commitment requirements. These environmental commitments are not subject to change without prior written approval from the SDDOT Environmental Office.

Additional guidance on SDDOT's Environmental Commitments can be accessed through the Environmental Procedures Manual found at: <<https://dot.sd.gov/media/documents/EnvironmentalProceduresManual.pdf> >

For questions regarding change orders in the field that may have an effect on an Environmental Commitment, the Project Engineer will contact the Environmental Engineer at 605-773-3180 or 605-773-4336 to determine whether an environmental analysis and/or resource agency coordination is necessary.

Once construction is complete, the Project Engineer will review all environmental commitments for the project and document their completion.

COMMITMENT B: FEDERALLY THREATENED, ENDANGERED, AND PROTECTED SPECIES

COMMITMENT B2: WHOOPING CRANE

The Whooping Crane is a spring and fall migratory bird in South Dakota that is about 5 feet tall and typically stops on wetlands, rivers, and agricultural lands along their migration route. An adult Whooping Crane is white with a red crown and a long, dark, pointed bill. Immature Whooping Cranes are cinnamon brown. While in flight, their long necks are kept straight and their long dark legs trail behind. Adult Whooping Cranes' black wing tips are visible during flight.

Action Taken/Required:

Harassment or other measures to cause the Whooping Crane to leave the site is a violation of the Endangered Species Act. If a Whooping Crane is sighted roosting in the vicinity of the project, borrow pits, or staging areas associated with the project, cease construction activities in the affected area until the Whooping Crane departs and immediately contact the Project Engineer. The Project Engineer will contact the Environmental Office so that the sighting can be reported to USFWS.

COMMITMENT E: STORM WATER

Construction activities constitute less than 1 acre of disturbance.

Action Taken/Required:

At a minimum and regardless of project size, appropriate erosion and sediment control measures must be installed to control the discharge of pollutants from the construction site.

COMMITMENT H: WASTE DISPOSAL SITE

The Contractor will furnish a site(s) for the disposal of construction and/or demolition debris generated by this project.

Action Taken/Required:

Construction and/or demolition debris may not be disposed of within the Public ROW.

The waste disposal site(s) will be managed and reclaimed in accordance with the following from the General Permit for Construction/Demolition Debris Disposal Under the South Dakota Waste Management Program issued by the Department of Agriculture and Natural Resources.

The waste disposal site(s) will not be located in a wetland, within 200 feet of surface water, or in an area that adversely affects wildlife, recreation, aesthetic value of an area, or any threatened or endangered species, as approved by the Environmental Office and the Project Engineer.

If the waste disposal site(s) is located such that it is within view of any ROW, the following additional requirements will apply:

1. Construction and/or demolition debris consisting of concrete, asphalt concrete, or other similar materials will be buried in a trench separate from wood debris. The final cover over the construction and/or demolition debris will consist of a minimum of 1 foot of soil capable of supporting vegetation. Waste disposal sites provided outside of the Public ROW will be seeded in accordance with Natural Resources Conservation Service recommendations. The seeding recommendations may be obtained through the appropriate County NRCS Office. The Contractor will control the access to waste disposal sites not within the Public ROW with fences, gates, and placement of a sign or signs at the entrance to the site stating, "No Dumping Allowed".
2. Concrete and asphalt concrete debris may be stockpiled within view of the ROW for a period not to exceed the duration of the project. Prior to project completion, the waste will be removed from view of the ROW or buried, and the waste disposal site reclaimed as noted above.

The above requirements will not apply to waste disposal sites that are covered by an individual solid waste permit as specified in SDCL 34A-6-58, SDCL 34A-6-1.13, and ARSD 74:27:10:06.

Failure to comply with the requirements stated above may result in civil penalties in accordance with South Dakota Solid Waste Law, SDCL 34A-6-1.31.

All costs associated with furnishing waste disposal site(s), disposing of waste, maintaining control of access (fence, gates, and signs), and reclamation of the waste disposal site(s) will be incidental to the various contract items.

COMMITMENT I: HISTORICAL PRESERVATION OFFICE CLEARANCES

The SDDOT has obtained concurrence with the State Historical Preservation Office (SHPO or THPO) for all work included within the project limits and all department designated sources and designated option material sources, stockpile sites, storage areas, and waste sites provided within the plans.

Action Taken/Required:

All earth disturbing activities not designated within the plans require a cultural resource review prior to scheduling the pre-construction meeting. This work includes but is not limited to: Contractor furnished material sources, material processing sites, stockpile sites, storage areas, plant sites, and waste areas.

The Contractor will arrange and pay for a record search and when necessary, a cultural resource survey. The Contractor has the option to contact the state Archaeological Research Center (ARC) at 605-394-1936 or another qualified archaeologist, to obtain either a records search or a cultural resources survey. A record search might be sufficient for review if the site was previously surveyed; however, a cultural resources survey may need to be conducted by a qualified archaeologist.

The Contractor will provide ARC with the following: a topographical map or aerial view in which the site is clearly outlined, site dimensions, project number, and PCN. If applicable, provide evidence that the site has been previously disturbed by farming, mining, or construction activities with a landowner statement that artifacts have not been found on the site.

The Contractor will submit the cultural resources survey report to SDDOT Environmental Office, 700 East Broadway Avenue, Pierre, SD 57501-2586. SDDOT will submit the information to the appropriate SHPO/THPO. Allow **30 Days** from the date this information is submitted to the Environmental Engineer for SHPO/THPO review.

In the event of an inadvertent discovery of human remains, funerary objects, or if evidence of cultural resources is identified during project construction activities, then such activities within 100 feet of the inadvertent discovery will immediately cease and the Project Engineer will be immediately notified. The Project Engineer will contact the SDDOT Environmental Office, who will contact the appropriate SHPO/THPO within 48 hours of the discovery to determine an appropriate course of action.

SHPO/THPO review does not relieve the Contractor of the responsibility for obtaining any additional permits and clearances for Contractor furnished material sources, material processing sites, stockpile sites, storage areas, plant sites, and waste areas that affect wetlands, threatened and endangered species, or waterways. The Contractor will not utilize a site known or suspected of having contaminated soil or water. The Contractor will provide the required permits and clearances to the Project Engineer at the preconstruction meeting.

COORDINATION WITH OTHER PROJECTS

Structure Replacement on project IM-B-TA 1902(67)0, PCN 065K is scheduled for the construction season of 2024. The location of this project is I-190, MRM 0+ 0.123 to MRM 1+ 0.263. The Contractor on this project will coordinate with the Contractor on the Structure Replacement project. All costs associated with this coordination will be incidental to the various bid items on the project.