

STATE OF SOUTH DAKOTA
DEPARTMENT OF TRANSPORTATION
PLANS FOR PROPOSED
PROJECT NH 0043(251)
SD HIGHWAY 79, 79S, & 79N
FALL RIVER & CUSTER COUNTIES

INDEX OF SHEETS

1	General Layout with Index
2-7	Notes, Tables, and Estimate
8-11	Special Details
12-17	Standard Plates

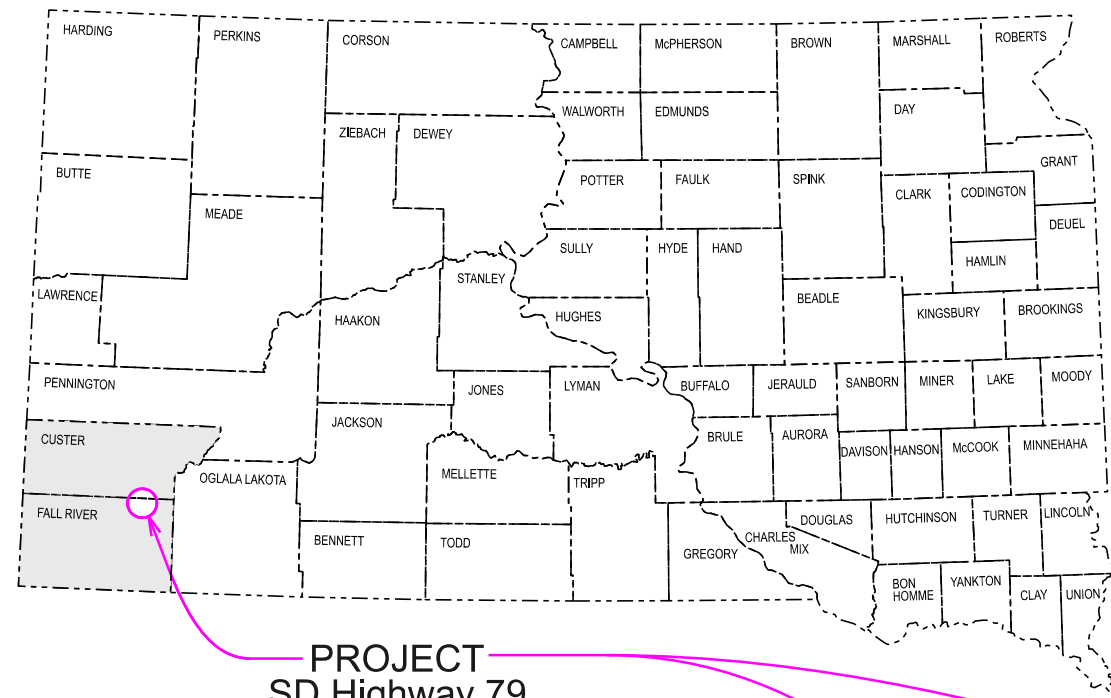

PROJECT
SD Highway 79
MRM 26.75+0.000 to MRM 27+0.000
SD Highway 79 SB
MRM 27+0.000 to MRM 27+0.142
SD Highway 79 NB
MRM 27+0.000 to MRM 33+0.848

PCC REPAIR
PCN 09X8

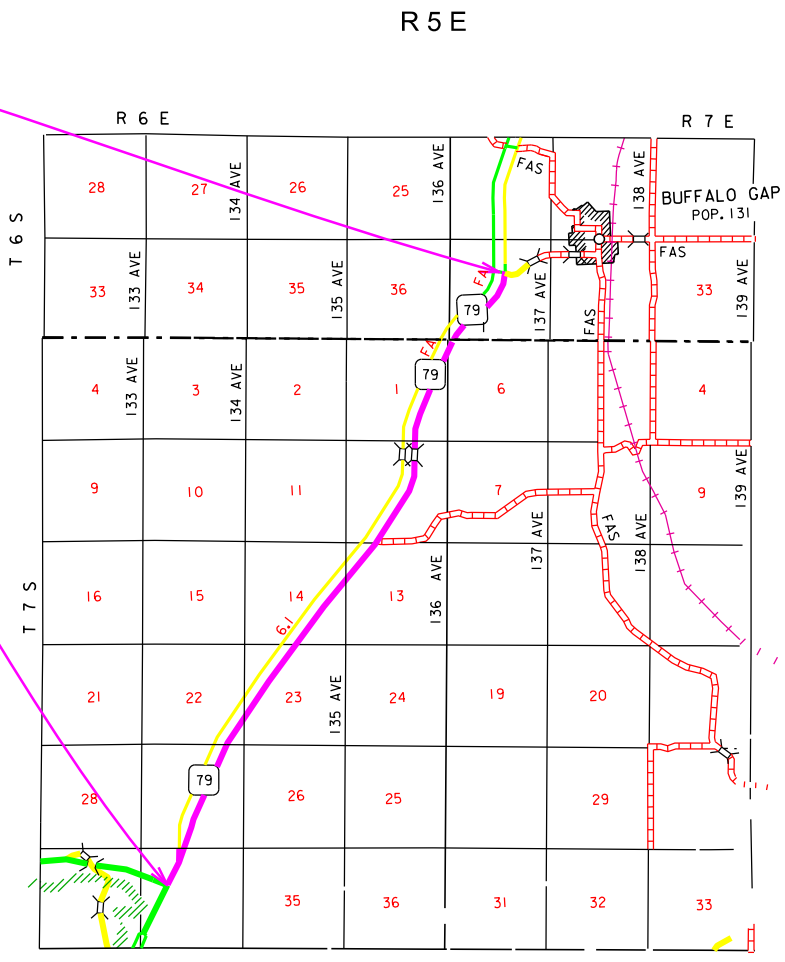

DESIGN DESIGNATION

ADT (2024)	2410
ADT (2044)	3581
DHV	587
D	51%
T DHV	7.9%
T ADT	15.8%
V	70 MPH

STORM WATER PERMIT
None Required

ESTIMATE OF QUANTITIES

BID ITEM NUMBER	ITEM	QUANTITY	UNIT
009E0010	Mobilization	Lump Sum	LS
009E4200	Construction Schedule, Category II	Lump Sum	LS
380E5030	Nonreinforced PCC Pavement Repair	313.0	SqYd
380E6000	Dowel Bar	39	Each
380E6110	Insert Steel Bar in PCC Pavement	197	Each
380E6302	Reseal PCC Pavement Joint - Hot Pour	95,187	Ft
633E1220	High Build Waterborne Pavement Marking Paint, 4" White	163	Ft
633E1222	High Build Waterborne Pavement Marking Paint, 4" Yellow	80	Ft
633E5100	Grooving for Durable Pavement Marking, 4"	243	Ft
634E0110	Traffic Control Signs	250.0	SqFt
634E0120	Traffic Control, Miscellaneous	Lump Sum	LS
634E0275	Type 3 Barricade	2	Each
634E0420	Type C Advance Warning Arrow Board	1	Each
634E0640	Temporary Pavement Marking	10,052	Ft
634E1255	Contractor Furnished Vehicle Speed Feedback Sign	1	Each

ENVIRONMENTAL COMMITMENTS

The SDDOT is committed to protecting the environment and uses Environmental Commitments as a communication tool for the Engineer and Contractor to ensure that attention is given to avoid, minimize, and/or mitigate an environmental impact. Environmental commitments to various agencies and the public have been made to secure approval of this project. An agency with permitting authority can delay a project if identified environmental impacts have not been adequately addressed. Unless otherwise designated, the Contractor's primary contact regarding matters associated with these commitments will be the Project Engineer. During construction, the Project Engineer will verify that the Contractor has met Environmental Commitment requirements. These environmental commitments are not subject to change without prior written approval from the SDDOT Environmental Office.

Additional guidance on SDDOT's Environmental Commitments can be accessed through the Environmental Procedures Manual found at: <https://dot.sd.gov/doing-business/environmental/about-environmental/>

For questions regarding change orders in the field that may have an effect on an Environmental Commitment, the Project Engineer will contact the Environmental Engineer at 605-773-3180 or 605-773-4336 to determine whether an environmental analysis and/or resource agency coordination is necessary.

Once construction is complete, the Project Engineer will review all environmental commitments for the project and document their completion.

COMMITMENT B: FEDERALLY THREATENED, ENDANGERED, AND PROTECTED SPECIES

COMMITMENT B2: WHOOPING CRANE

The Whooping Crane is a spring and fall migratory bird in South Dakota that is about 5 feet tall and typically stops on wetlands, rivers, and agricultural lands along their migration route. An adult Whooping Crane is white with a red crown and a long, dark, pointed bill. Immature Whooping Cranes are cinnamon brown. While in flight, their long necks are kept straight, and their long dark legs trail behind. Adult Whooping Cranes' black wing tips are visible during flight.

Action Taken/Required:

Harassment or other measures to cause the Whooping Crane to leave the site is a violation of the Endangered Species Act. If a Whooping Crane is sighted roosting in the vicinity of the project, borrow pits, or staging areas associated with the project, cease construction activities in the affected area until the Whooping Crane departs and immediately contact the Project Engineer. The Project Engineer will contact the Environmental Office so that the sighting can be reported to USFWS.

COMMITMENT B4: BALD EAGLE

Bald and/or Golden eagles are known to occur in this area.

Action Taken/Required:

If a nest is observed within one mile of the project site, notify the Project Engineer immediately so that he/she can consult with the Environmental Office for an appropriate course of action.

COMMITMENT C: WATER SOURCE

If a Contractor needs access to state waters for extraction, the Contractor must obtain a water right, through the application of a Temporary Permit to Use Public Waters before work begins.

The Contractor will not withdraw water with equipment previously used outside the State of South Dakota or previously used in aquatic invasive species (AIS) positive waters within South Dakota without prior approval from the SDDOT Environmental Office. To prevent and control the introduction and spread of invasive species into the project vicinity, all equipment will be power washed with hot water (≥140 °F) and completely dried for a minimum of 7 days prior to subsequent use. South Dakota administrative rule 41:10:04:02 forbids the possession and transport of AIS; therefore, all attached dirt, mud, debris and vegetation must be removed and all compartments and tanks capable of holding standing water must be drained. This includes, but is not limited to, all equipment, pumps, lines, hoses and holding tanks.

Action Taken/Required:

The Contractor will obtain the necessary permits from the regulatory agencies such as the South Dakota Department of Agriculture and Natural Resources (SDDANR) and the United States Army Corps of Engineers (USACE) prior to water extraction activities.

Temporary permit to use public waters for highway construction purposes application can be found on the SDDANR website: <https://danr.sd.gov/OfficeOfWater/WaterRights/PermitForms/default.aspx>

Additional information and mapping of water sources impacted by Aquatic Invasive Species in South Dakota can be accessed at: <https://sdleastwanted.sd.gov/maps/default.aspx>

South Dakota Administrative Rule 41:10:04 Aquatic Invasive Species: <https://sdlegislature.gov/rules/DisplayRule.aspx?Rule=41:10:04>

COMMITMENT E: STORM WATER

Construction activities constitute less than 1 acre of disturbance.

Action Taken/Required:

At a minimum and regardless of project size, appropriate erosion and sediment control measures must be installed to control the discharge of pollutants from the construction site.

COMMITMENT H: WASTE DISPOSAL SITE

The Contractor will furnish a site(s) for the disposal of construction and/or demolition debris generated by this project.

Action Taken/Required:

Construction and/or demolition debris may not be disposed of within the Public ROW.

The waste disposal site(s) will be managed and reclaimed in accordance with the following from the General Permit for Construction/Demolition Debris Disposal Under the South Dakota Waste Management Program issued by the Department of Agriculture and Natural Resources.

The waste disposal site(s) will not be located in a wetland, within 200 feet of surface water, or in an area that adversely affects wildlife, recreation, aesthetic value of an area, or any threatened or endangered species, as approved by the Environmental Office and the Project Engineer.

If the waste disposal site(s) is located such that it is within view of any ROW, the following additional requirements will apply:

1. Construction and/or demolition debris consisting of concrete, asphalt concrete, or other similar materials will be buried in a trench separate from wood debris. The final cover over the construction and/or demolition debris will consist of a minimum of 1 foot of soil capable of supporting vegetation. Waste disposal sites provided outside of the Public ROW will be seeded in accordance with Natural Resources Conservation Service recommendations. The seeding recommendations may be obtained through the appropriate County NRCS Office. The Contractor will control the access to waste disposal sites not within the Public ROW with fences, gates, and placement of a sign or signs at the entrance to the site stating, "No Dumping Allowed".
2. Concrete and asphalt concrete debris may be stockpiled within view of the ROW for a period not to exceed the duration of the project. Prior to project completion, the waste will be removed from view of the ROW or buried, and the waste disposal site reclaimed as noted above.

The above requirements will not apply to waste disposal sites that are covered by an individual solid waste permit as specified in SDCL 34A-6-58, SDCL 34A-6-1.13, and ARSD 74:27:10:06.

Failure to comply with the requirements stated above may result in civil penalties in accordance with South Dakota Solid Waste Law, SDCL 34A-6-1.31.

All costs associated with furnishing waste disposal site(s), disposing of waste, maintaining control of access (fence, gates, and signs), and reclamation of the waste disposal site(s) will be incidental to the various contract items.

COMMITMENT I: HISTORIC PRESERVATION OFFICE CLEARANCES

The SDDOT has obtained concurrence with the State Historic Preservation Office (SHPO or THPO) for all work included within the project limits and all department designated sources and designated option material sources, stockpile sites, storage areas, and waste sites provided within the plans.

Action Taken/Required:

All earth disturbing activities not designated within the plans require a cultural resource review prior to scheduling the pre-construction meeting. This work includes but is not limited to: Contractor furnished material sources, material processing sites, stockpile sites, storage areas, plant sites, and waste areas.

The Contractor will arrange and pay for a record search and when necessary, a cultural resource survey. The Contractor has the option to contact the state Archaeological Research Center (ARC) at 605-394-1936 or another qualified archaeologist, to obtain either a records search or a cultural resources survey. A record search might be sufficient for review if the site was previously surveyed; however, a cultural resources survey may need to be conducted by a qualified archaeologist.

The Contractor will provide ARC with the following: a topographical map or aerial view in which the site is clearly outlined, site dimensions, project number, and PCN. If applicable, provide evidence that the site has been previously disturbed by farming, mining, or construction activities with a landowner statement that artifacts have not been found on the site.

The Contractor will submit the cultural resources survey report to SDDOT Environmental Office, 700 East Broadway Avenue, Pierre, SD 57501-2586. SDDOT will submit the information to the appropriate SHPO/THPO. Allow **30 Days** from the date this information is submitted to the Environmental Engineer for SHPO/THPO review.

In the event of an inadvertent discovery of human remains, funerary objects, or if evidence of cultural resources is identified during project construction activities, then such activities within 150 feet of the inadvertent discovery will immediately cease and the Project Engineer will be immediately notified. The Project Engineer will contact the SDDOT Environmental Office, who will contact the appropriate SHPO/THPO within 48 hours of the discovery to determine an appropriate course of action.

SHPO/THPO review does not relieve the Contractor of the responsibility for obtaining any additional permits and clearances for Contractor furnished material sources, material processing sites, stockpile sites, storage areas, plant sites, and waste areas that affect wetlands, threatened and endangered species, or waterways. The Contractor will not utilize a site known or suspected of having contaminated soil or water. The Contractor will provide the required permits and clearances to the Project Engineer at the preconstruction meeting.

COMMITMENT S: FIRE PREVENTION IN THE BLACK HILLS AREA

This project is located within the Black Hills Forest Fire Protection Boundary.

Action Taken/Required:

The Contractor will adhere to the "Special Provision for Fire Plan".

UTILITIES

Utilities are not planned to be affected on this project. If utilities are identified near the improvement area through the SD One Call Process as required by South Dakota Codified Law 49-7A and Administrative Rule Article 20:25, the Contractor will contact the Engineer to determine modifications that will be necessary to avoid utility impacts.

EXISTING PCC PAVEMENT

The existing pavement for: SD 79 is 8.5" Nonreinforced PCC Pavement with limestone aggregate. Longitudinal joints are reinforced with No. 5x30" deformed tie bars spaced 30" to 48" center to center. The transverse joints are spaced at 20' apart. Transverse joints are reinforced with 1 ¼" plain round dowel bars and with No. 9 deformed tie bars spaced 12" center to center.

ASPHALT CONCRETE COMPOSITE

Asphalt Concrete Composite will be used for shoulder repair at full depth PCC replacement locations.

Mineral aggregate for the Asphalt Concrete Composite will conform to the requirements for Class E, Type 1.

All other requirements in the Standard Specifications for Asphalt Concrete Composite will apply.

The asphalt binder used in the mixture can be PG 58H-34 or PG 58V-34 Asphalt Binder.

No MC-70 Asphalt for Prime will be required.

No flush seal will be required.

This work will be incidental to the contract unit price bid for Nonreinforced PCC Pavement Repair

RESEAL PCC PAVEMENT JOINT

Sealing joints shall be performed in accordance with Section 380.3 P.

It is not essential that all of the sealant be removed. Remaining sealant adhering to the sides may remain in place if the Engineer determines that it is not detrimental to the joint.

Joint widths are to be kept as narrow as possible and shall not be widened more than 1/8". In certain areas the joint may be wider than the original construction. It may be necessary to provide backer rod in the wide area. Any additional cost to perform this work shall be at no additional cost to the State. The Contractor shall be responsible to verify joint widths prior to establishing the contract unit price.

In areas of new concrete, sawing and sealing the joints in the repaired sections will be included in the quantities for Reseal PCC Pavement Joint.

Cost for removing, cleaning, and resealing the transverse joints shall be incidental to the contract unit price per foot for Reseal PCC Pavement Joint-Hot Pour.

NONREINFORCED PCC PAVEMENT REPAIR

Concrete will meet the requirements stated in Section 380 of the Specifications, except as modified by the following notes:

The fine aggregate will be screened over a one-inch square-opening screen just prior to introduction into the concrete paving mix if required by the Engineer.

The slump requirement will be limited to 3" maximum after water reducer is added and the concrete will contain 4.5% to 7.0% entrained air. The concrete will contain a minimum of 50% coarse aggregate by weight. Coarse aggregate will be crushed ledge rock, Size No. 1 unless an alternative gradation is approved by the Concrete Engineer as part of the mix design submittal. The mix design will contain at least 650 lbs of Type I or II cement or 600 lbs of Type III cement per cubic yard. The minimum 28-day compressive strength will be 4,000 psi. The Contractor is responsible for the mix design used. The Contractor will submit a mix design and supporting documentation for approval at least 2 weeks prior to use.

The use of a water reducer at manufacturer's recommended dosage will be required.

Concrete will be cured with white pigmented curing compound (ASTM C309, Type 2) applied as soon as practical at a rate of 125 square feet per gallon. Concrete will be cured for a minimum of 48 hours before opening to traffic. The 48 hours is based upon a concrete surface temperature of 60°F or higher throughout the cure period. If the concrete surface temperature falls below 60°F, the cure time will be extended, or other measures taken, at no additional cost to the State. A strength of 2,500 psi must be attained prior to opening to traffic.

Upon placement of the concrete, repair areas will be straight edged to ensure a smooth riding surface and will be textured longitudinally with the pavement by finishing with a stiff broom. Repair areas will then be checked with a 10' foot straight edge. The permissible longitudinal and transverse surface deviation will be 1/8" in 10'.

Concrete will be covered with suitable insulation blanket consisting of a layer of closed cell polystyrene foam protected by at least one layer of plastic. Insulation blanket will have an R-value of at least 0.5, as rated by the manufacturer. Insulation blanket will be left in place, except for joint sawing operations, until the 2,500 psi is attained. Insulation blanket will be overlapped on to the existing concrete by 4'. This requirement for covering repair areas with insulation blankets may be waived during periods of hot weather upon approval of the Engineer.

A construction joint will be sawed whenever new concrete pavement is placed adjacent to existing concrete pavement.

The Contractor will note the locations of the in-place transverse construction joints and will be place the new joints at the existing locations.

Rumble Strips in PCC Pavement will be placed 15 inches wide 3 inches from the outside edge of the pavement. Payment for forming rumble strips including labor, materials and incidentals will be incidental to the contract unit price per square yard for Nonreinforced PCC Pavement Repair.

Cost for performing the aforementioned work including sawing and removing concrete, furnishing and placing concrete, sawing and sealing joints, sawing and removing a 2' width of asphalt shoulder adjacent to the removed panels, repairing gravel and asphalt concrete shoulders, labor, tools and equipment will be included in the contract unit price per square yard for Nonreinforced PCC Pavement Repair.

STEEL BAR INSERTION

The Contractor will insert the Steel Bars (No. 9 x 18 inch epoxy coated deformed tie bars, No. 5 x 24 inch epoxy coated deformed tie bars, and 1 1/4" x 18" epoxy coated plain round dowel bars) into drilled holes in the existing concrete pavement. Anchoring of the steel bars in the drilled holes will conform to the Specifications.

The steel bars will be cut to the specified length by sawing or shearing and will be free from burring or other deformations.

Epoxy coated plain round steel bars will be inserted on 12-inch centers in the transverse joint. The first steel bar will be placed a minimum of 3 inches and a maximum of 6 inches from the outside edge of the slab.

Epoxy coated deformed steel bars will be inserted on 18-inch centers in the transverse joint. The first steel bar will be placed a minimum of 3 inches and a maximum of 9 inches from the outside edge of the slab.

Epoxy coated deformed steel bars will be inserted on 30-inch centers in the longitudinal joint and will be placed a minimum of 15 inches from the existing transverse contraction joint.

HIGH BUILD WATERBORNE PAVEMENT MARKING PAINT

All materials will be applied as per manufacturer's recommendations. High build waterborne pavement marking paint will conform to Section 980.1 B.

Reflective media will consist of glass beads. Reflective media will require a Certificate of Compliance for Certification for each source and lot. Acceptance sampling will not be required.

RATES OF MATERIALS FOR HIGH BUILD WATERBORNE PAVEMENT MARKING PAINT

Solid 4" line = 22.5 Gals/Mile
Dashed 4" line = 6.2 Gal/Mile
Glass Beads = 8 Lbs/Gal.

All cost for materials, labor, and equipment necessary to furnish and install the pavement markings will be incidental to the contract unit price for the respective High Build Waterborne Pavement Marking Paint items.

STATE OF SOUTH DAKOTA	PROJECT	SECTION	SHEET
	NH 0043(251)	Non	4/17

Revised 3/31/26 GDS

GROOVING FOR HIGH BUILD WATERBORNE PAVEMENT MARKING PAINT

The Contractor will establish a positive means for the removal of the grinding and/or grooving residue. Residue from dry grooving will be vacuumed. Solid residue will be removed from the pavement surfaces before being blown by traffic action or wind. The Contractor will conduct this work to control and minimize airborne dust and similar debris that may become a hazard to motor vehicle operation or nuisance to property owners. Residue from wet grooving will not be permitted to flow across lanes being used by public traffic or into gutter or drainage facilities. Residue, whether in solid or slurry form, will be disposed of in a manner that will prevent it from reaching any waterway in a concentrated state. All costs for removal of grinding and/or grooving residue will be included in the contract unit price per foot for Grooving for Durable Pavement Marking contract item.

Unless otherwise specified in the plans, the Contractor will groove the surface for High Build Waterborne Pavement Marking Paint as specified in these plans and as per the manufacturer's instructions.

The grooving will be completed within the following tolerances:

Description	Specification	Tolerance
Depth of Groove	Marking Thickness ¹ + 15 mils	+ 5 mils
Width of Groove	5 to 6 inches	
Length of Skip Lines ²	10 foot 6 inches	± 3 inch
Tapers at ends of lines	6 to 9 inches	
Between Double Lines	4 inches	± 1/2 inch

¹ Marking thickness will include the thickness of marking material and reflective media.

² Additional length may be required as specified in the plans.

The equipment will be capable of the following:

- Grooving the total width of the groove in one pass or uniform depths with multiple passes.
- Grooving without causing damage to the pavement joints or joint sealant material.
- Provide uniform alignment and depth.
- Moving continuously to permit a mobile traffic work operation.

If damage occurs, including, but not limited to, joints, joint sealant material, and backer rod, the grooving operation will be stopped and modifications will be made to the grooving operation to prevent further damage. The Contractor will be required to use specially prepared circular diamond blade cutting heads to prevent damage at the joints. Damage caused will be repaired or replaced by the Contractor, as directed by the Engineer. No additional payment will be made for the repair work or any reapplication of the pavement marking in the area of the repair.

SEQUENCE OF OPERATIONS

The Contractor will submit a sequence of operations for approval two weeks prior to the preconstruction meeting. If changes to the sequence of operations are proposed during the project, these must be submitted for review a minimum of one week prior to potential implementation. Approval for changes to the sequence of operations will only be allowed when the proposed changes meet with the Department's intent for traffic control and sequencing of the work.

Standard Plates 634.63, 634.85, and 634.99 will be used for traffic control in the Contractors sequence of operations.

GENERAL TRAFFIC CONTROL

Existing guide, route, informational logo, regulatory, and warning signs will be temporarily reset and maintained during construction. Removing, relocating, covering, salvaging, and resetting of existing traffic control devices, including delineation, will be the responsibility of the Contractor. Cost for this work will be incidental to the contract unit prices for the various items unless otherwise specified in the plans. Any delineators and signs damaged or lost will be replaced by the Contractor at no cost to the State.

All temporary traffic control sign locations will be set in the field by the Contractor and verified by the Engineer prior to installation.

If there is a discrepancy between the traffic control plans, standard plates, and the MUTCD, whichever is more stringent will be used, as determined by the Engineer.

Unless otherwise stated in these plans, work will not be allowed during hours of darkness.

Fixed location signing placed more than 4 calendar days prior to the start of construction will be covered or laid down until the time of construction. The covers must be approved by the Engineer prior to installation. The cost of materials, labor, and equipment necessary to complete this work will be incidental to other contract items. No separate payment will be made.

All fixed location signs, sign posts, and breakaway bases will be removed within 7 calendar days following pavement marking.

All haul trucks will be equipped with an additional flashing amber light that is visible from the backside of the haul truck. The costs for the flashing amber lights will be incidental to the various related contract items.

Traffic will be maintained on the driving lanes. Use of the shoulder as a driving lane will not be permitted. Any damage to the shoulder due to rerouted traffic or Contractor's equipment will be repaired at no expense to the Department.

The Contractor will furnish, install, maintain, and remove TRUCK CROSSING (W8-6) signs daily. The TRUCK CROSSING signs will be displayed always when haul vehicles are hauling material. When hauling conditions no longer exist, the signs will be covered or removed from view. The exact number and location will be determined during construction. Payment for additional signs will be based on the contract unit price per square foot for Traffic Control Signs.

A Type 3 Barricade will be installed at the end of a lane closure taper.

Lane closures will be limited to 5 miles in length. The distance between the closest points of any two-lane closures will be at least 3 miles, excluding tapers.

Construction vehicles will exit or enter the construction work zone at locations identified by the Engineer. At no time will construction vehicles utilize the maintenance crossovers or the median to exit or enter mainline traffic.

TRAFFIC CONTROL FOR PCCP REPAIR

Each mainline concrete repair location, from which the in-place concrete has been removed, will be marked with a minimum of two reflectorized drums.

Construction workspaces on divided roadways will be limited to 5 miles in length. Construction workspaces on undivided roadways will be limited to 300 feet in length. The distance between the closest points of any two construction workspaces, including channeling devices, will not be less than 3 miles. Drivers in two-way traffic workspaces must be able to see approaching traffic through and beyond the work zone.

Holes adjacent to centerline in the lane open to traffic created during removal and replacement of PCC pavement repair areas will be filled with gravel cushion material and cold-mix asphalt concrete prior to opening the lane to traffic. Gravel cushion material and cold-mix asphalt concrete will be furnished by the Contractor.

Holes in the gravel and asphalt concrete shoulders created during removal and replacement of PCC pavement repair areas will be filled with gravel cushion material and asphalt concrete composite (to match the shoulder surfacing) prior to opening the lane to traffic. Gravel cushion material and asphalt concrete composite will be furnished and installed by the Contractor at no additional cost to the State.

All costs for furnishing, hauling, and placing gravel cushion material and asphalt concrete composite will be incidental to the contract unit price per square yard for Nonreinforced PCC Pavement Repair.

Routing traffic onto the mainline shoulders during any phase of the construction will not be allowed.

Damage to the shoulders, median, or ditch due to the Contractor's operations will be repaired by the Contractor to the satisfaction of the Engineer at no expense to the State. This includes the apparent routing of traffic onto the shoulders around the work zones.

TEMPORARY PAVEMENT MARKING

- SD 79N MRM 27+0.980** Northbound Lane Closure Tapers and Repair Area
1040 Ft. – White
1000 Ft. – Yellow

- SD 79N MRM 30+0.470** Northbound Lane Closure Tapers And Repair Area
1000 Ft. – White
980 Ft. – Yellow

- SD 79N MRM 31+0.360** Northbound Lane Closure Tapers And Repair Area
1000 Ft. – White
980 Ft. – Yellow

- SD 79N MRM 31+0.880** Northbound Lane Closure Taper And Repair Area
1926 Ft. – White
6 Ft. – Yellow

- SD 79N MRM 33+0.670** Northbound Lane Closure Taper and Repair Area
1000 Ft. – White

- SD 79N MRM 33+0.690** Northbound Lane Closure Taper And Repair Area
1120 Ft. – White

ITEMIZED LISTS FOR TRAFFIC CONTROL

EXPRESSWAY / INTERSTATE					
SIGN CODE	SIGN DESCRIPTION	NUMBER	SIGN SIZE	SQFT PER SIGN	SQFT
R2-1	SPEED LIMIT 45	1	36" x 48"	12.0	12.0
R2-1	SPEED LIMIT 65	3	36" x 48"	12.0	36.0
R2-1	SPEED LIMIT 70	1	36" x 48"	12.0	12.0
R2-6aP	FINES DOUBLE (plaque)	1	36" x 24"	6.0	6.0
W3-5	SPEED REDUCTION AHEAD (65 MPH)	2	48" x 48"	16.0	32.0
W3-5	SPEED REDUCTION AHEAD (45 MPH)	1	48" x 48"	16.0	16.0
W4-2	LEFT or RIGHT LANE ENDS (symbol)	2	48" x 48"	16.0	32.0
W8-6	TRUCK CROSSING	2	48" x 48"	16.0	32.0
W20-1	ROAD WORK AHEAD	2	48" x 48"	16.0	32.0
W20-5	LEFT or RIGHT LANE CLOSED AHEAD	2	48" x 48"	16.0	32.0
G20-2	END ROAD WORK	1	48" x 24"	8.0	8.0
EXPRESSWAY / INTERSTATE TRAFFIC CONTROL SIGNS SQFT					250.0

PRESS RELEASE ANNOUNCEMENTS

The SDDOT will prepare a press release to be released 5 days prior to any phase change or any other major change that affects traffic flow. The SDDOT will be responsible to keep law enforcement, emergency services, and the traveling public notified of changes in project access. The Contractor will provide the Engineer with pertinent information 7 days prior to any phase change or any other major change that affects traffic flow.

WORK ZONE SPEED REDUCTION

The Department is required to obtain a speed reduction resolution prior to the installation of any SPEED LIMIT (R2-1) signs shown on standard plate 634.63. To provide adequate time for the resolution to be enacted, the Contractor will inform the Engineer a minimum of 3 weeks prior to the scheduled installation of any work zone speed reduction signs on the project. The information provided by the Contractor will include the anticipated date of sign installation, the newly reduced speed limit, the location of the work zone, and the anticipated completion date of work requiring the speed reduction.

Revised 3/31/26 GDS

Table of PCC Repair

Route	MRM	Disp	Direction	Lane	Length (Ft)	Width (Ft)	Notes	No. 5 Deformed Tie Bar (Each)	No. 9 Deformed Tie Bar (Each)	1 1/4" Bar (Each)	Insert Steel Bar in PCC Pavement (Each)	Dowel Bar (Each)	Nonreinforced PCC Pavement Repair (SqYd)
79N	27	+0.980	NB	All Lanes	40	26	2 panels settled over cross pipe.	16		32	48	26	115.6
79N	30	+0.470	NB	All Lanes	20	26	Panel cracked. Replace single panel in both NB lanes.	8		32	40		57.8
79N	31	+0.360	NB	All Lanes	20	26	Cracked panel. Remove and replace single panel both NB lanes.	8		32	40		57.8
79N	31	+0.880	NB	Passing	6	6	Temporary sylvex patch in spall.	6	4	4	14		4
79N	33	+0.670	NB	Driving	20	14	Replace single panel NB driving lane.	8		18	26		31.1
79N	33	+0.690	NB	Driving	30	14	Cracked/spalled panel. Replace 1.5 panels in driving lane.	12	8	9	29	13	46.7
Total											197	39	313

Table of Reseal PCCP Joint

Route	MRM	Disp	to	MRM	Disp	Number of Longitudinal Joints	Length Ft	Width Ft	Joint Spacing Ft	Longitudinal Joint Length Ft	Transverse Joint Length Ft	Combined Joint Length Ft	Reseal PCC Pavement Joint - Hot Pour Ft	
79	26.75	+0.000		27	+0.000	5	1199	70	20	5995	4200	10195	10195	Longitudinal and Transverse throughout project length
79S	27	+0.000		27	+0.142	1	750	26	20	750	988	1738	1738	Longitudinal and Transverse throughout project length
79N	27	+0.000		33	+0.848	1	36194	26	20	36194	47060	83254	83254	Longitudinal and Transverse throughout project length
Total													95187	

Table of Pavement Marking

Route	MRM	Disp	Direction	Lane	Length (Ft)	High Build Waterborne Pavement Marking Paint, 4" White (Ft)	High Build Waterborne Pavement Marking Paint, 4" Yellow (Ft)	Grooving for Durable Pavement Marking, 4" (Ft)
79N	27	+0.980	NB	All Lanes	40	50	40	90
79N	30	+0.470	NB	All Lanes	20	25	20	45
79N	31	+0.360	NB	All Lanes	20	25	20	45
79N	31	+0.880	NB	Passing	2			
79N	33	+0.670	NB	Driving	20	25		25
79N	33	+0.690	NB	Driving	30	38		38
Total						163	80	243

TYPICAL IN-PLACE SURFACING SECTION

STATE OF SOUTH DAKOTA	PROJECT	SECTION	SHEET
	NH 0043(251)	Non	8/17
Plotting Date: 3/31/2026			

Mainline SD 79

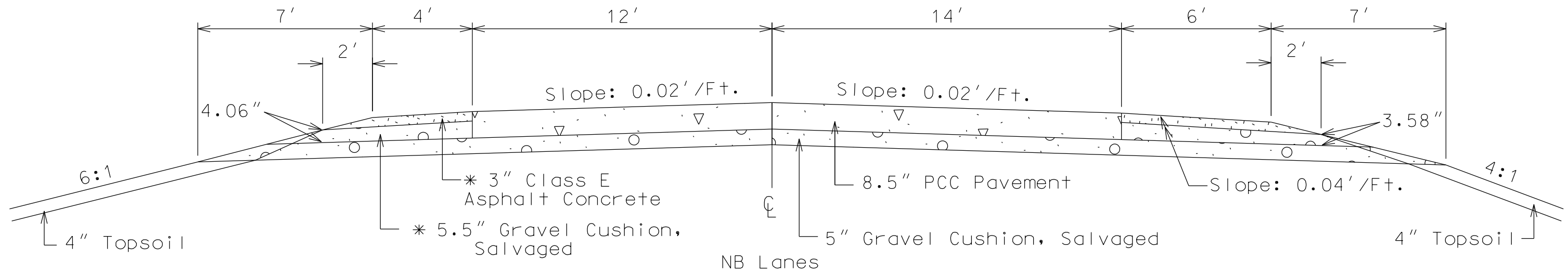

RESEAL PCC PAVEMENT JOINTS WITH HOT Poured ELASTIC JOINT SEALER

TRANSVERSE JOINT

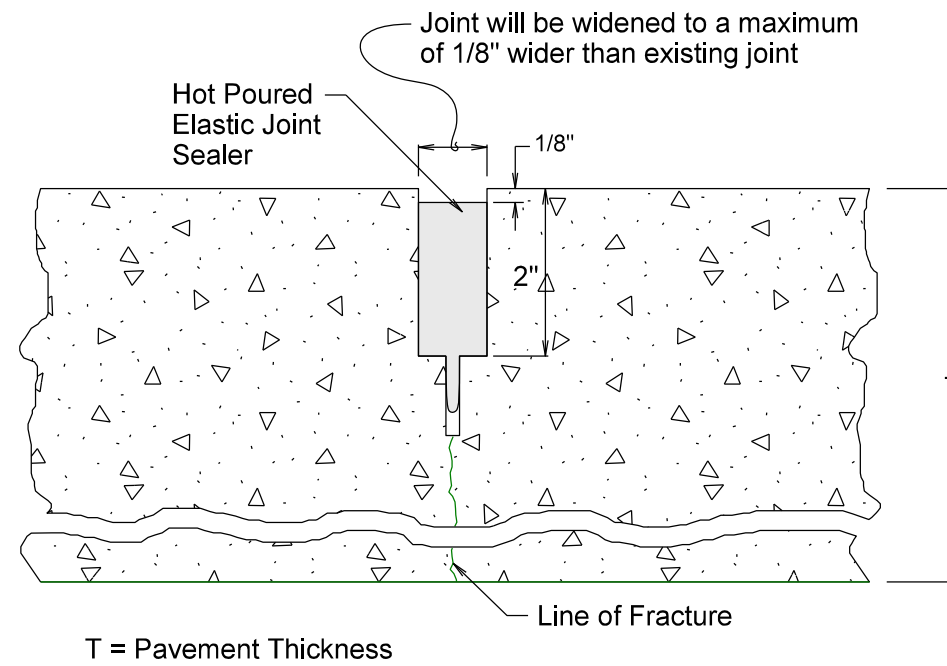

LONGITUDINAL JOINT

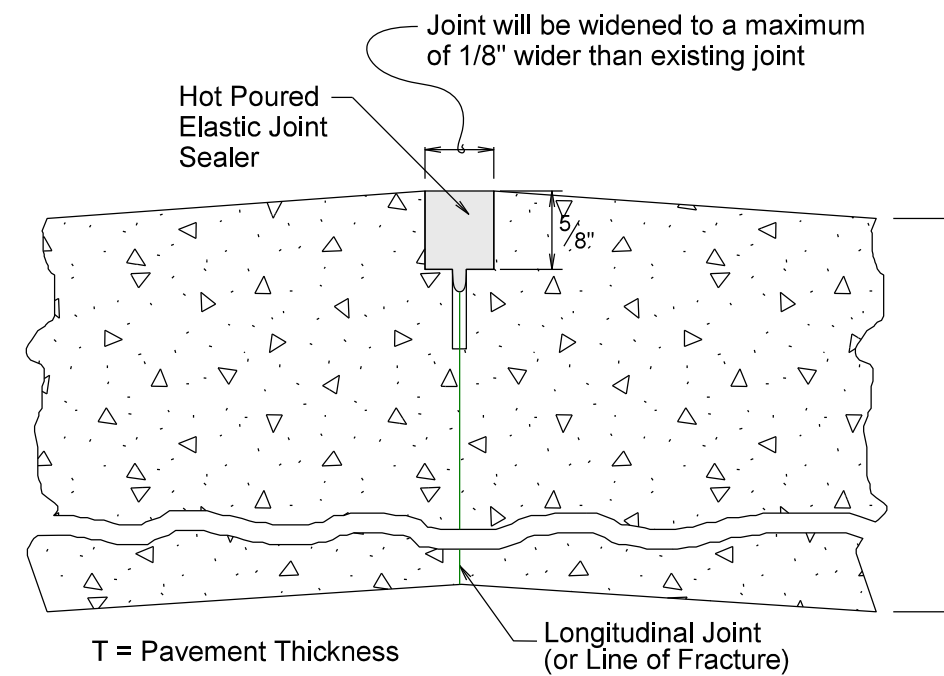

TYPICAL PAVEMENT MARKING LAYOUT

4 LANE DIVIDED HIGHWAY (4" Marking)

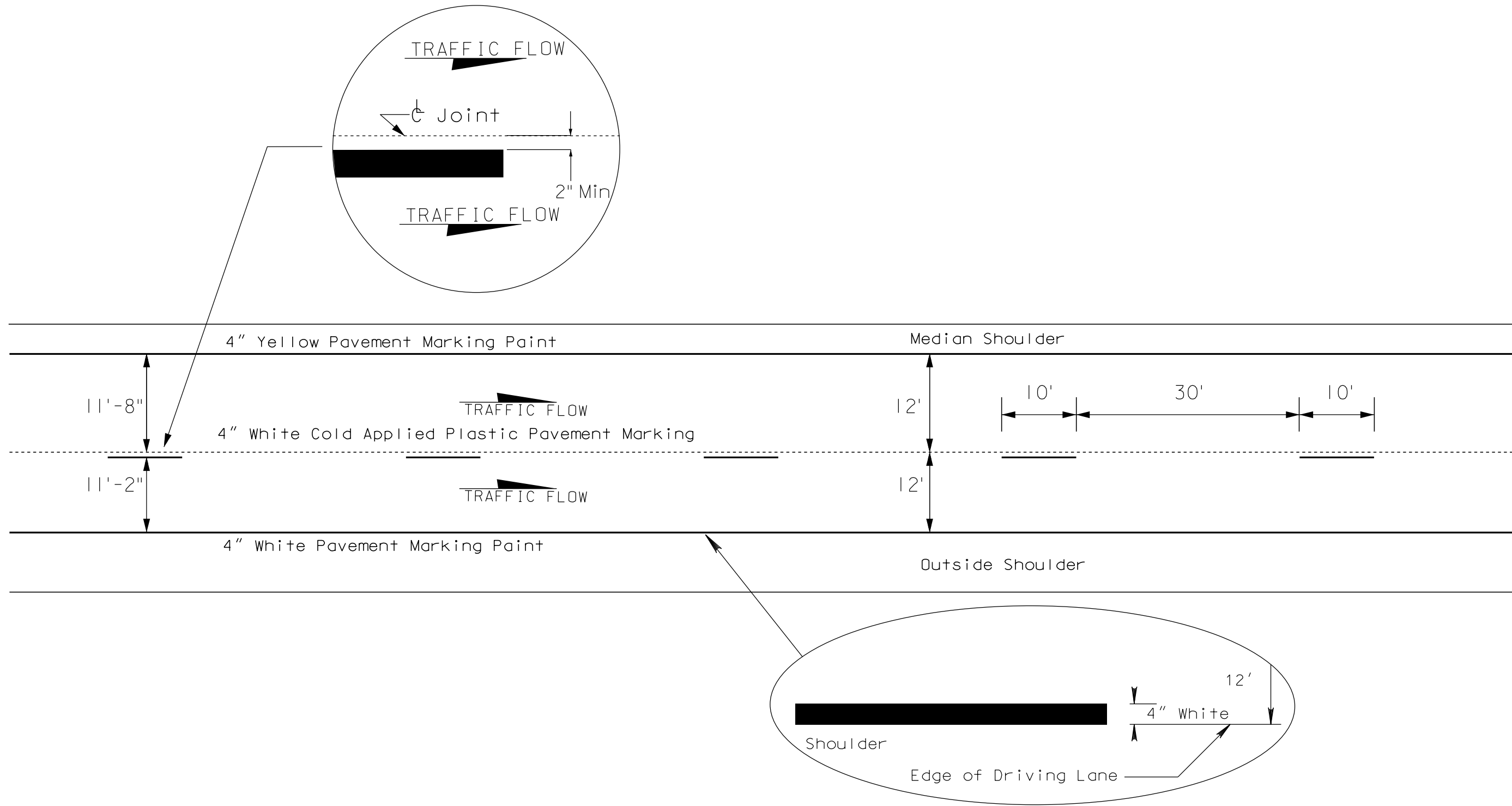

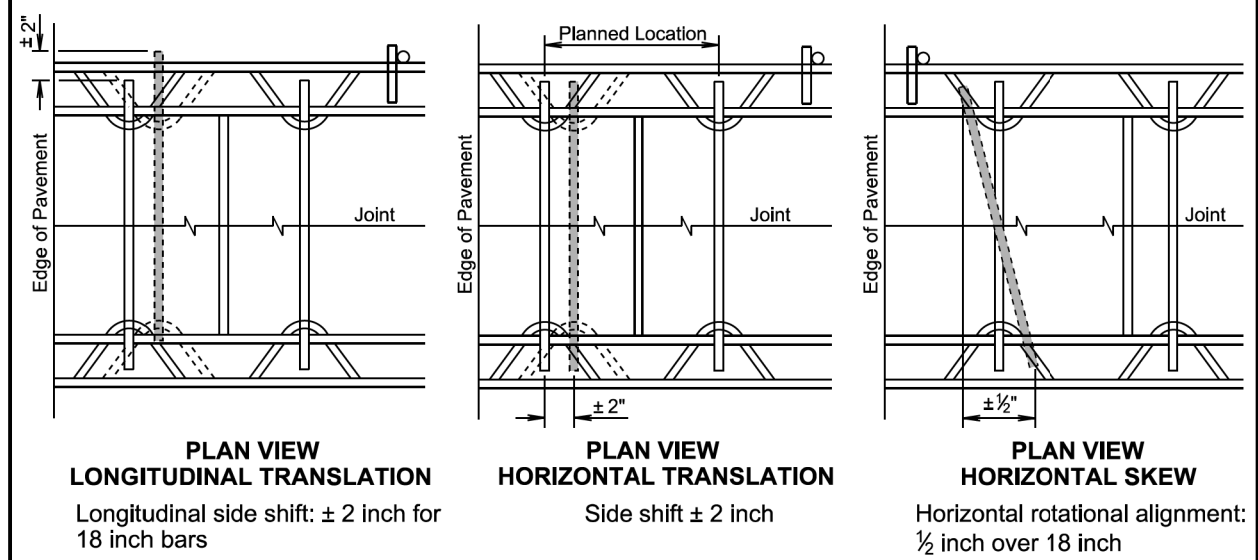
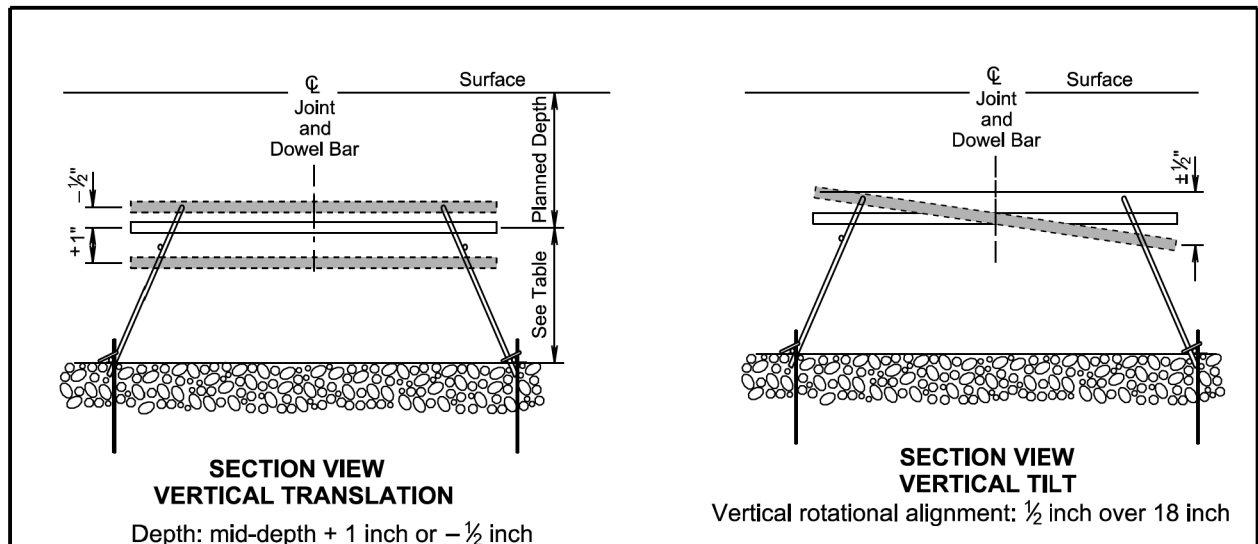

PAVEMENT THICKNESS	EPOXY COATED DOWEL BAR SIZE	HEIGHT TO CENTER
7" to 7 1/2"	1" x 18"	3.0"
8" to 10"	1 1/4" x 18"	4.0"
10 1/2" to 13"	1 1/2" x 18"	5.0"

GENERAL NOTE:
The tolerances shown above represent the maximum deviation for acceptance of dowel bar placement.

November 19, 2022

S D D O T	PCC PAVEMENT DOWEL BAR ALIGNMENT TOLERANCES	PLATE NUMBER 380.01
		Sheet 1 of 1
<i>Published Date: 2026</i>		

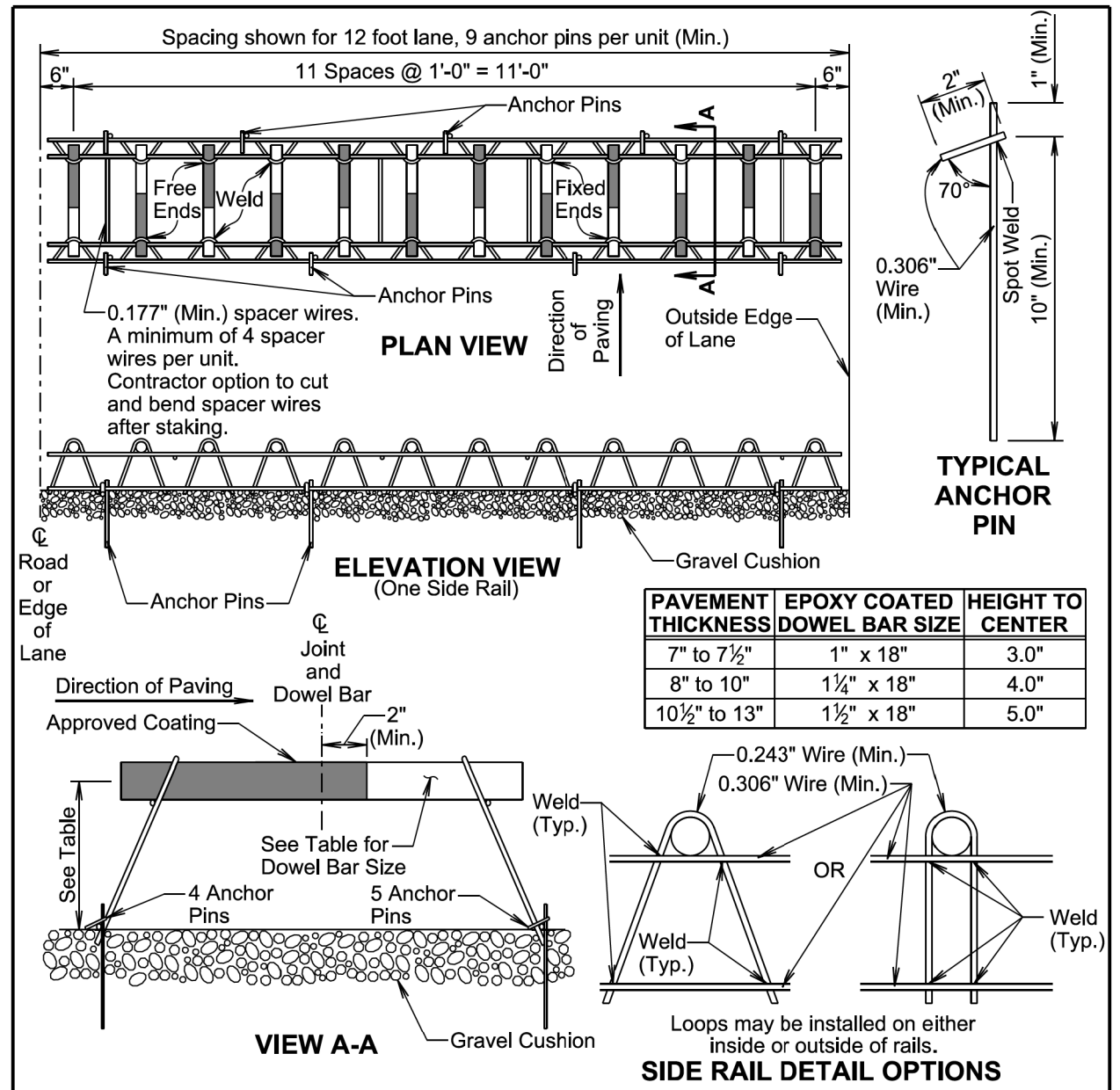

PAVEMENT THICKNESS	EPOXY COATED DOWEL BAR SIZE	HEIGHT TO CENTER
7" to 7 1/2"	1" x 18"	3.0"
8" to 10"	1 1/4" x 18"	4.0"
10 1/2" to 13"	1 1/2" x 18"	5.0"

GENERAL NOTES:

Longitudinal joint tie bars will be placed a minimum of 15 inches from the transverse contraction joint.

The transverse contraction joints will be sawed perpendicular to the centerline of the roadway. The transverse sawed joint will be centered over the dowel bars.

Supporting devices as shown on this sheet, or equivalent as approved by the Engineer, will be used to maintain proper horizontal and vertical alignment of the dowel bars.

All dowel bar alignment tolerances will be as shown in the PCC Pavement Dowel Bar Alignment Tolerances standard plate.

November 19, 2022

S D D O T	PCC PAVEMENT DOWEL BAR ASSEMBLY FOR TRANSVERSE CONTRACTION JOINTS 12 Bar Assembly on Granular Base Material	PLATE NUMBER 380.04
		Sheet 1 of 1
<i>Published Date: 2026</i>		

DETAIL A TRANSVERSE CONSTRUCTION JOINT WITH TIE BARS

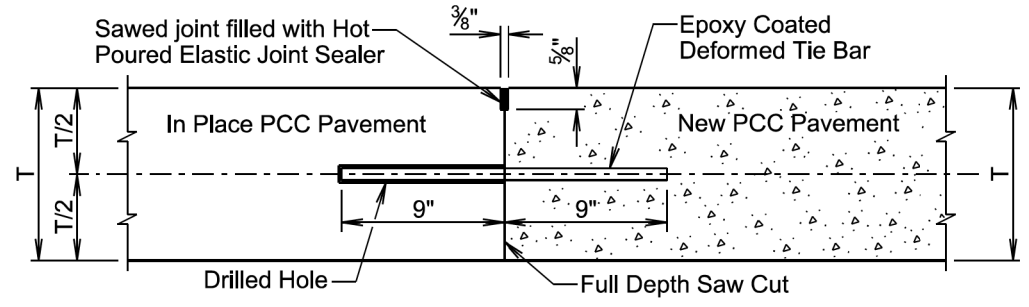

T = In Place PCC Pavement and New PCC Pavement Thickness

GENERAL NOTES:

The term "In Place PCC Pavement" in the above drawing indicates that the in place PCC pavement was placed on a previous project.

See sheet 2 of 2 of this standard plate to determine if Detail A will be used.

The tie bars will be embedded a minimum depth of 9 inches into the in place PCC pavement and anchored with an epoxy resin adhesive or a non-shrink grout.

No. 9 epoxy coated deformed tie bars will be used in 10 inch thickness and less PCC Pavement and No. 11 epoxy coated deformed tie bars will be used in 10.5 inch thickness and greater PCC Pavement. The tie bar spacing will be 18 inches center to center and will be a minimum of 3 inches and a maximum of 9 inches from the pavement edges.

DETAIL B TRANSVERSE CONSTRUCTION JOINT WITH DOWEL BARS

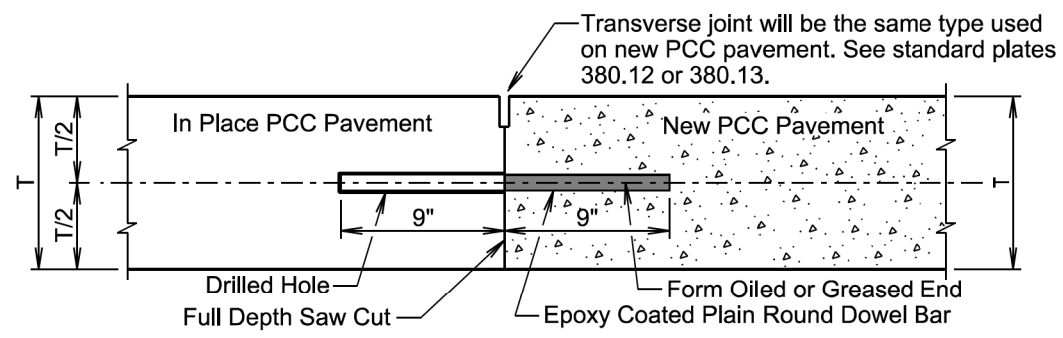

T = In Place PCC Pavement and New PCC Pavement Thickness

GENERAL NOTES:

The term "In Place PCC Pavement" in the above drawing indicates that the in place PCC pavement was placed on a previous project or current project.

See sheet 2 of 2 of this standard plate to determine if Detail B will be used.

The plain round dowel bars will be embedded a minimum depth of 9 inches into the in place PCC pavement and anchored with an epoxy resin adhesive or a non-shrink grout.

The epoxy coated plain round dowel bar size, number, and spacing will be the same as detailed on the corresponding dowel bar assembly standard plate (380.04, 380.05, 380.06, or 380.07). The epoxy coated plain round dowel bars will be a minimum of 3 inches and a maximum of 6 inches from the pavement edges.

January 22, 2023

Published Date: 2026	S D D O T	PCC PAVEMENT TRANSVERSE CONSTRUCTION JOINTS WITH TIE BARS OR DOWEL BARS	PLATE NUMBER 380.15
			Sheet 1 of 2

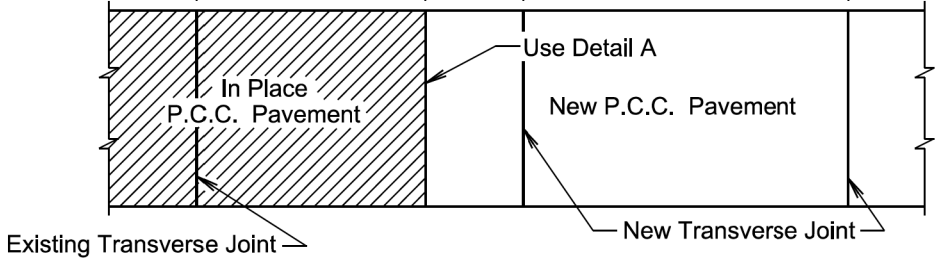
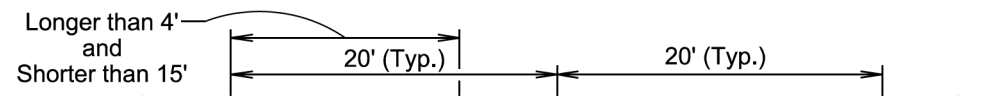

PLAN VIEW

(For typical transverse joint spacing of 20' on the current project)

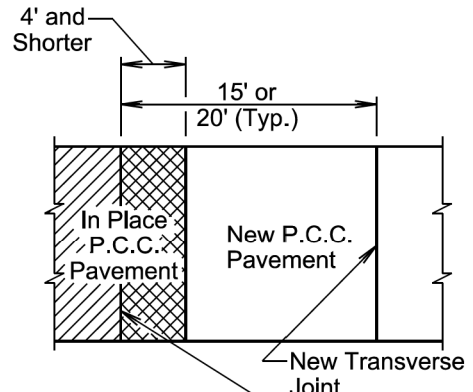
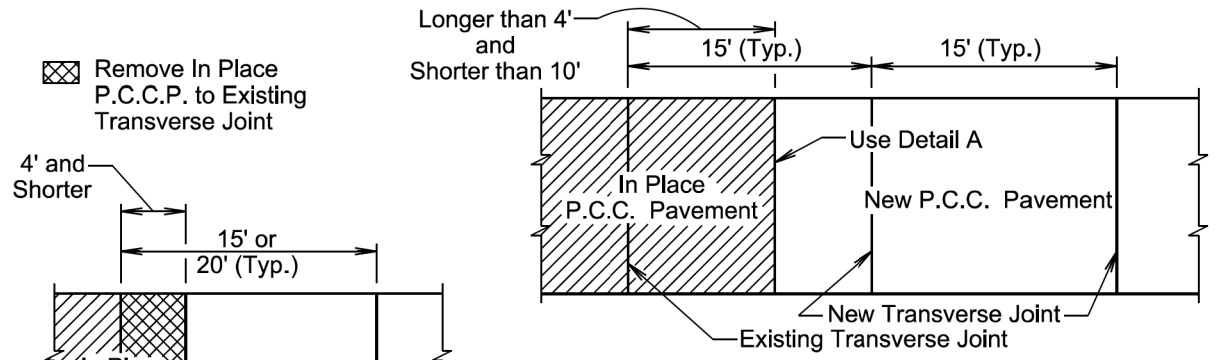

PLAN VIEW

(For typical transverse joint spacing of 15' or 20' on the current project)

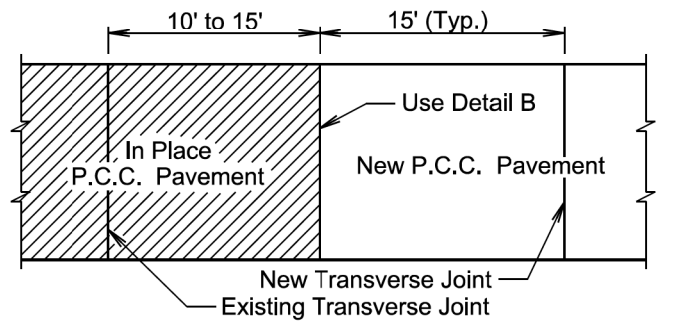

PLAN VIEW

(For typical transverse joint spacing of 15' on the current project)

January 22, 2023

Published Date: 2026	S D D O T	PCC PAVEMENT TRANSVERSE CONSTRUCTION JOINTS WITH TIE BARS OR DOWEL BARS	PLATE NUMBER 380.15
			Sheet 2 of 2

LONGITUDINAL CONSTRUCTION JOINT WITH TIE BARS

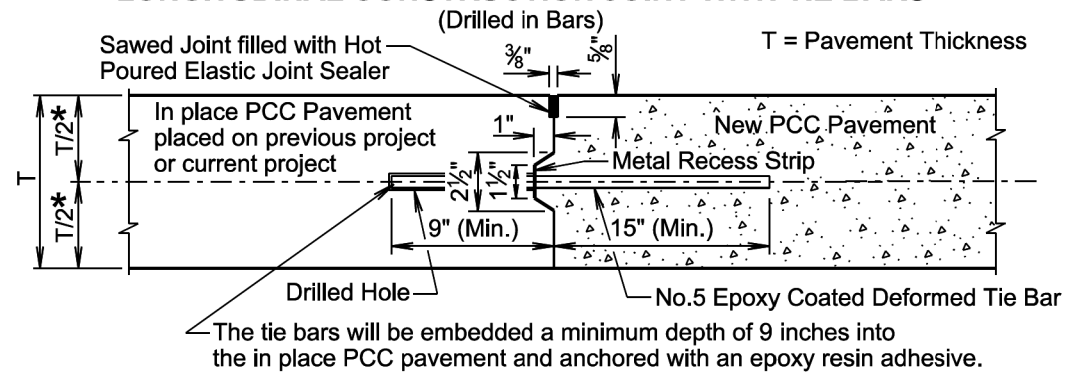

LONGITUDINAL CONSTRUCTION JOINT WITH TIE BARS

(Inserted or Formed in Bars)

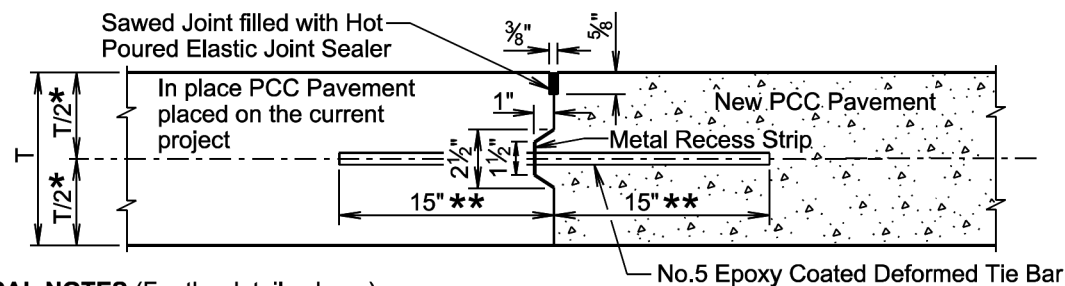

GENERAL NOTES (For the details above):

The epoxy coated deformed tie bars will be spaced in accordance with the following tables:

TIE BAR SPACING 48" MAXIMUM	
Transverse Contraction Joint Spacing	Number of Tie Bars
6.5' to 10'	2
10.5' to 14'	3
14.5' to 18'	4
18.5' to 22'	5

TIE BAR SPACING 30" MAXIMUM	
Transverse Contraction Joint Spacing	Number of Tie Bars
5' to 7'	2
7.5' to 9.5'	3
10' to 12'	4
12.5' to 14.5'	5
15' to 17'	6
17.5' to 19.5'	7
20' to 22'	8

The tie bars will be placed a minimum of 15 inches from transverse contraction joints.

The required number of tie bars as shown in the table will be uniformly spaced within each panel. The uniformly spaced tie bars will be spaced a maximum of 48 inches center to center for a female keyway and will be spaced a maximum of 30 inches center to center for a vertical face and male keyway. The maximum tie bar spacing will apply to tie bars within each panel.

The keyway illustrated in the above details depict a female keyway.

The keyway is optional and is not required. When concrete pavement is formed and a keyway is provided, a metal recess strip will be used. When concrete pavement is slip formed, a metal recess strip is not required.

- * The vertical placement tolerance for any part of the tie bar will be $\pm T/6$.
- ** The transverse placement (side shift) tolerance will be ± 3 inches when measured perpendicular to the longitudinal joint line.

November 19, 2022

Published Date: 2026	S D D O T	PCC PAVEMENT LONGITUDINAL JOINTS WITH TIE BARS	PLATE NUMBER 380.20
			Sheet 1 of 2

SAWED LONGITUDINAL JOINT WITH TIE BARS

(Poured Monolithically)

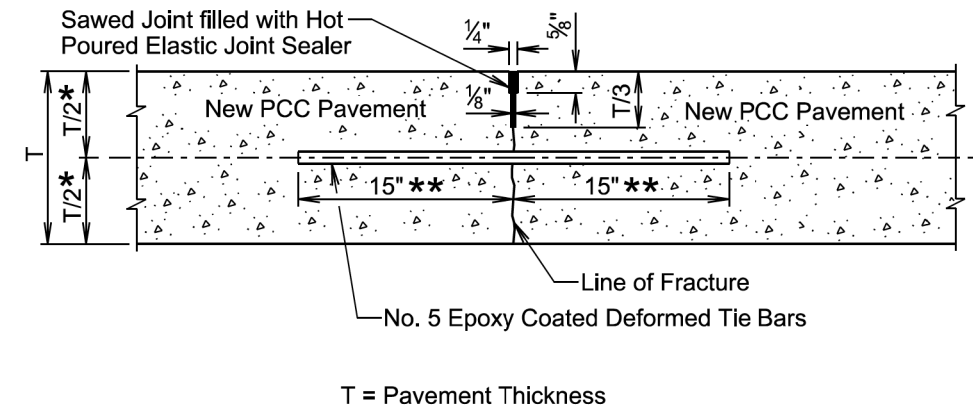

GENERAL NOTES (For the detail above):

The epoxy coated deformed tie bars will be spaced in accordance with the following table:

TIE BAR SPACING 48" MAXIMUM	
Transverse Contraction Joint Spacing	Number of Tie Bars
6.5' to 10'	2
10.5' to 14'	3
14.5' to 18'	4
18.5' to 22'	5

The tie bars will be placed a minimum of 15 inches from the transverse contraction joints.

The required number of tie bars as shown in the table will be uniformly spaced within each panel with a maximum space of 48 inches center to center. The maximum tie bar spacing will apply to tie bars within each panel.

The first saw cut to control cracking will be a minimum of 1/3 the thickness of the pavement. Additional sawing for widening the saw cut to provide the width for the installation of the hot poured elastic joint sealer is necessary.

- * The vertical placement tolerance for any part of the tie bar will be $\pm T/6$.
- ** The transverse placement (side shift) tolerance will be ± 3 inches when measured perpendicular to the longitudinal joint line.

November 19, 2022

Published Date: 2026	S D D O T	PCC PAVEMENT LONGITUDINAL JOINTS WITH TIE BARS	PLATE NUMBER 380.20
			Sheet 2 of 2

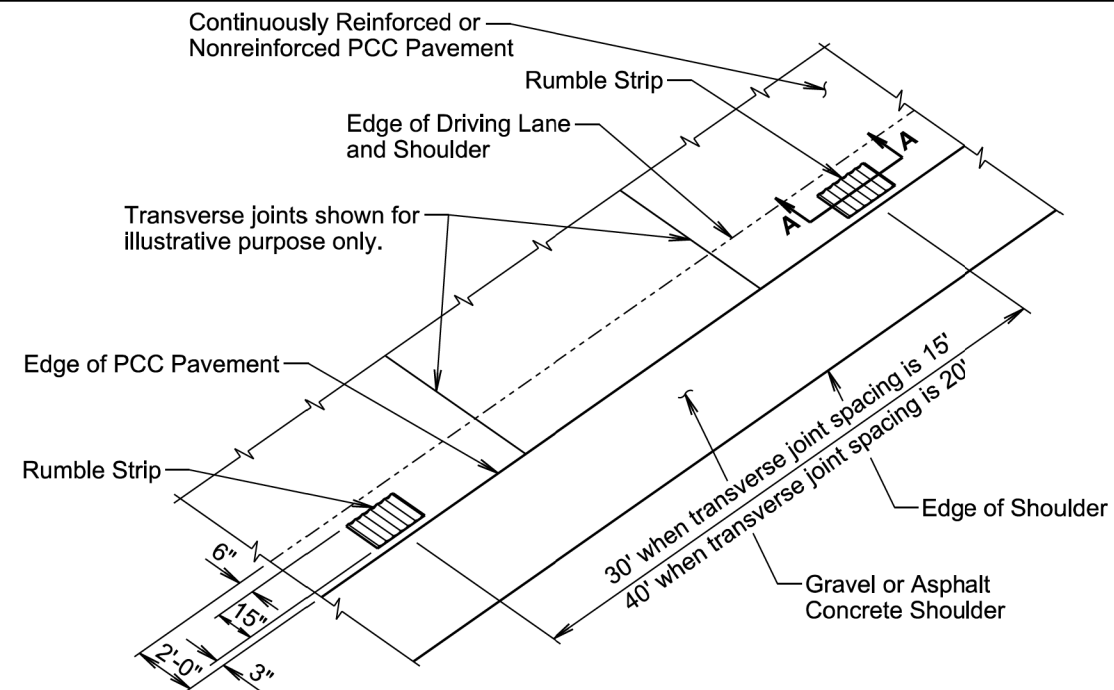

PERSPECTIVE OF TYPICAL RUMBLE STRIPS ON PCC PAVEMENT SHOULDER ADJACENT TO GRAVEL OR ASPHALT CONCRETE SHOULDER

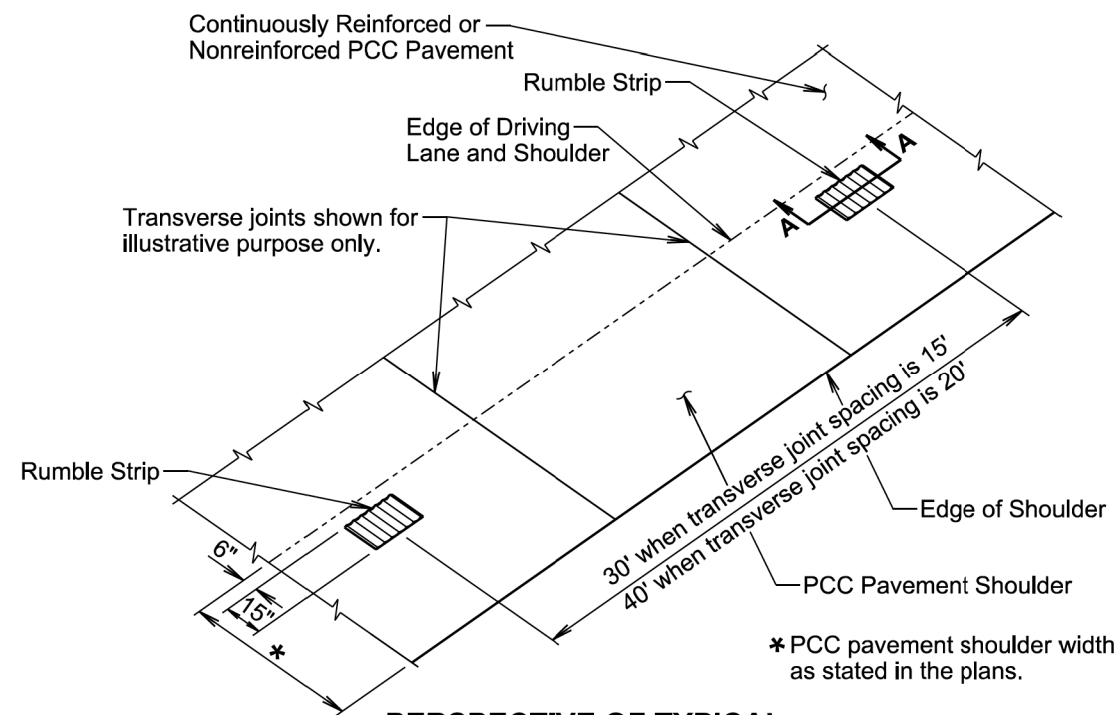

PERSPECTIVE OF TYPICAL RUMBLE STRIPS ON PCC PAVEMENT SHOULDER

November 19, 2022

Published Date: 2026	S D D O T	RUMBLE STRIP ON PCC PAVEMENT SHOULDER	PLATE NUMBER 380.53
			Sheet 1 of 2

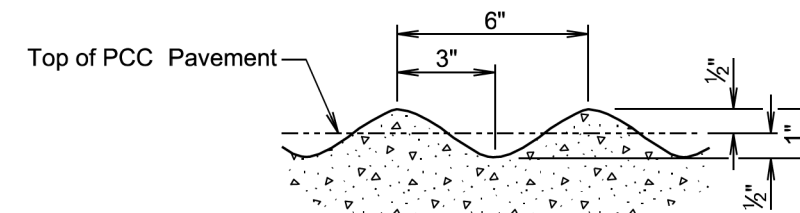

DETAIL B

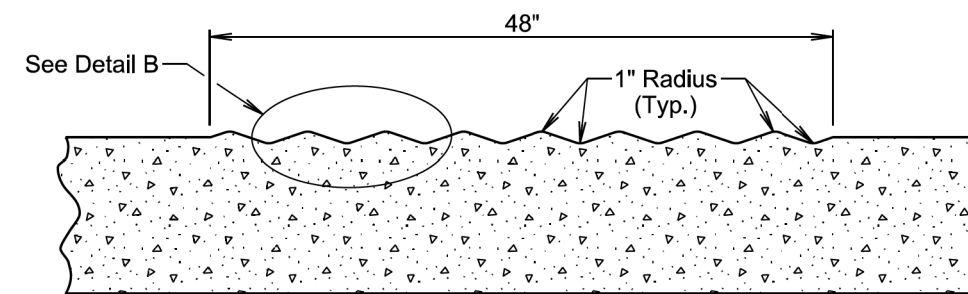

SECTION A-A

GENERAL NOTES:

The rumble strips will be evenly spaced and will not coincide with any transverse contraction joints.

The rumble strips will NOT be placed along areas adjacent to entrance ramps, exit ramps, and gore areas.

Payment for constructing the PCC Pavement Rumble Strips will be incidental to the contract unit price per square yard for the corresponding PCC Pavement contract item.

November 19, 2022

Published Date: 2026	S D D O T	RUMBLE STRIP ON PCC PAVEMENT SHOULDER	PLATE NUMBER 380.53
			Sheet 2 of 2

Posted Speed Prior to Work (M.P.H.)	Spacing of Advance Warning Signs (Feet)		
	(A)	(B)	(C)
0 - 30	200		
35 - 40	350		
45 - 50	500		
55	750		
60 - 65	1000		
	(A)	(B)	(C)
70 - 80	1000	1500	2640

** Speed appropriate for location.

- ⊙ Reflectorized Drum
- Channelizing Device

ROAD WORK AHEAD sign is only required in advance of the first lane closure.

High speed is defined as having a posted speed limit greater than 45 mph.

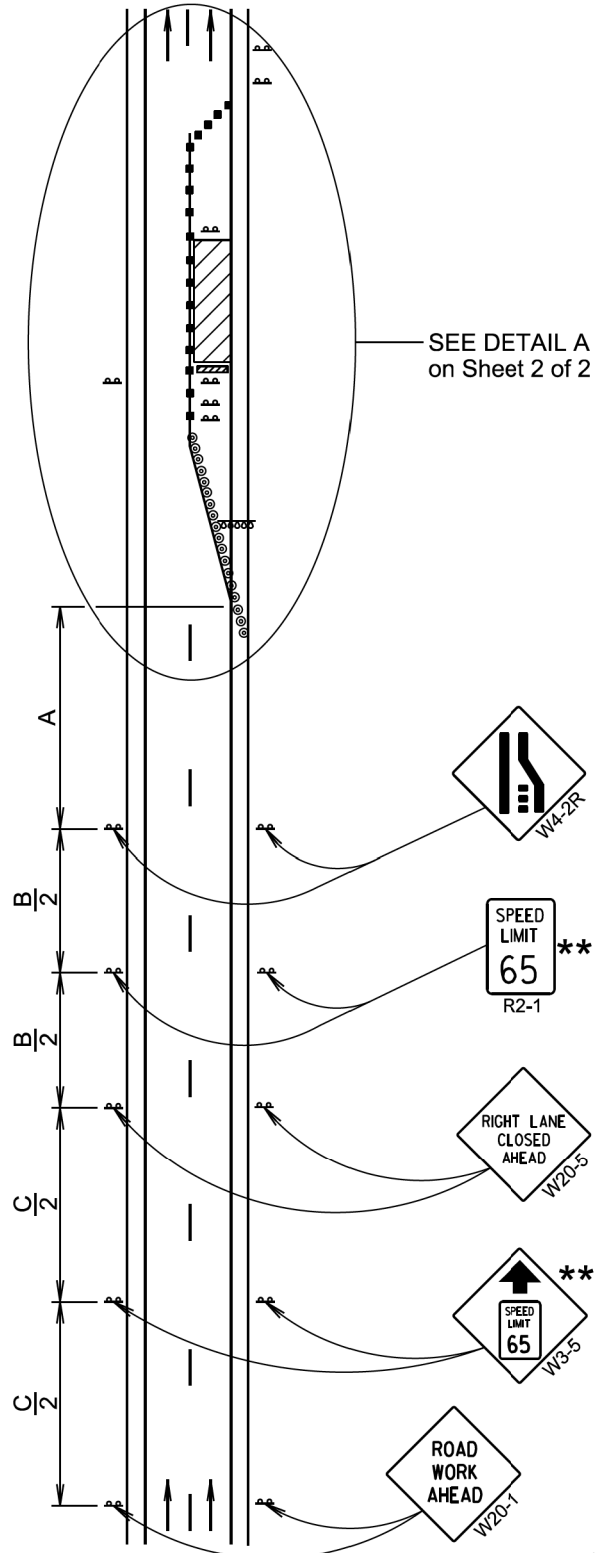

SEE DETAIL A on Sheet 2 of 2

April 8, 2025

S
D
D
O
T

WORK ZONE SPEED REDUCTION FOR INTERSTATE AND HIGH SPEED MULTI-LANE HIGHWAYS

PLATE NUMBER
634.63

Sheet 1 of 2

Published Date: 2026

Posted Speed Prior to Work (M.P.H.)	Spacing of Channelizing Devices (Feet) (G)	Taper Length (Feet) (L)
0 - 30	25	180
35 - 40	25	320
45	25	600
50	50 *	600
55	50 *	660
60 - 65	50 *	780
70 - 80	50 *	960

* Spacing is 40' for 42" cones.

** Speed appropriate for location.

*** Use speed limit designated for the condition when workers are present in the work space. Signs will be covered or removed when workers are not present.

⊙ Reflectorized Drum

■ Channelizing Device

The Work Space will be a minimum of 500' from the end of the taper.

The channelizing devices will be 42" cones or drums.

42" cones may be used in place of the drums shown in the taper if setup will not be used during night time hours.

4" white temporary pavement marking tape for right lane closures, 4" yellow temporary pavement marking tape for left lane closures, or temporary raised pavement markers at 5' spacing will be installed in the taper when the lane is closed overnight, and along the tangent section where the skip lines do not exist and the lane is closed for more than 3 days.

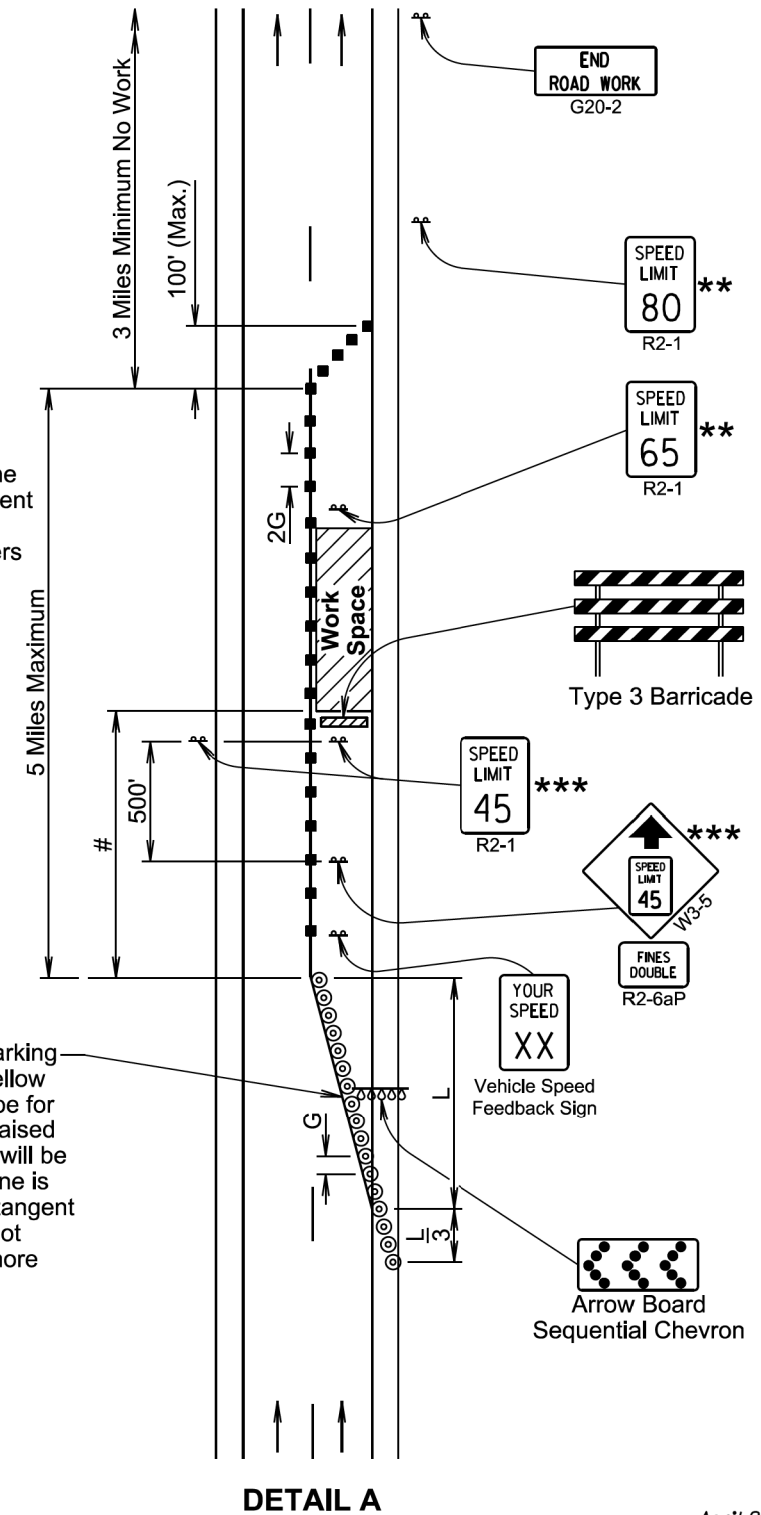

DETAIL A

April 8, 2025

S
D
D
O
T

WORK ZONE SPEED REDUCTION FOR INTERSTATE AND HIGH SPEED MULTI-LANE HIGHWAYS

PLATE NUMBER
634.63

Sheet 2 of 2

Published Date: 2026

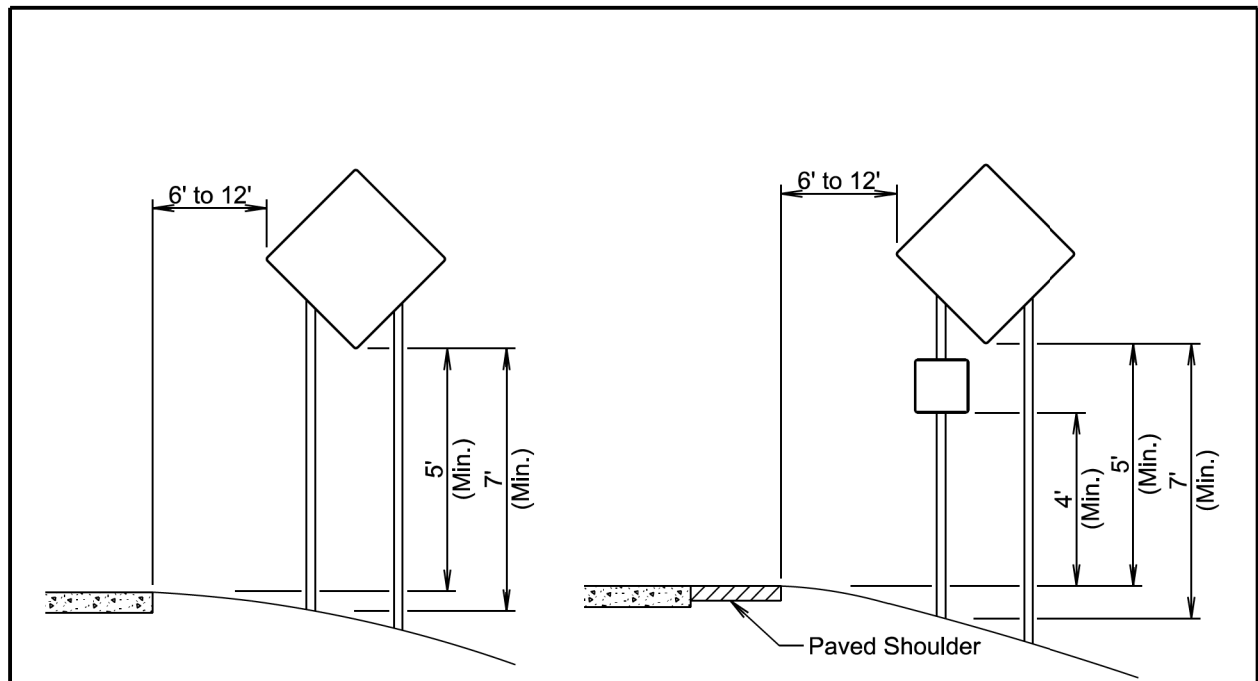

RURAL DISTRICT

RURAL DISTRICT WITH SUPPLEMENTAL PLATE

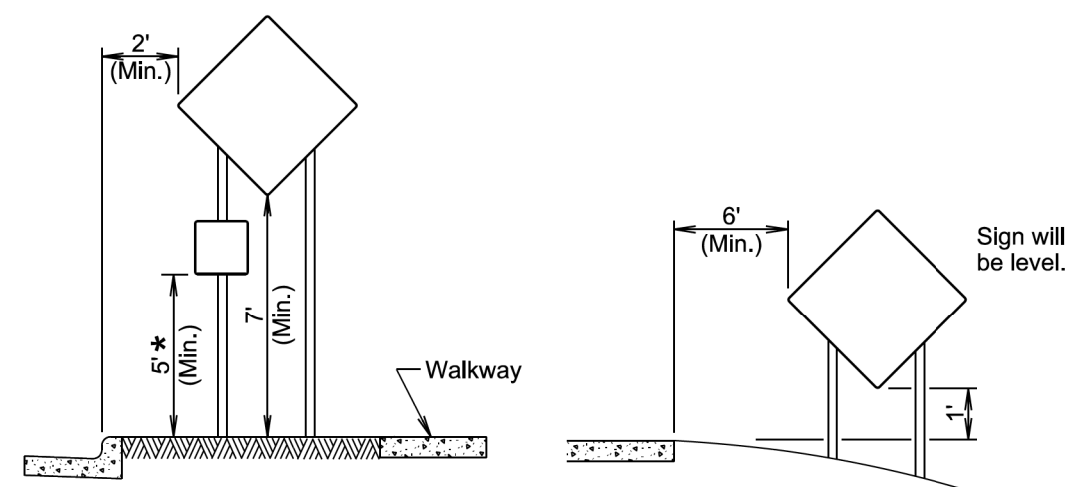

URBAN DISTRICT

RURAL DISTRICT 3 DAY MAXIMUM
(Not applicable to regulatory signs)

* If the bottom of supplemental plate is mounted lower than 7 feet above a pedestrian walkway, the supplemental plate should not project more than 4" into the pedestrian facility.

January 22, 2021

Published Date: 2026	S D D O T	CRASHWORTHY SIGN SUPPORTS (Typical Construction Signing)	PLATE NUMBER 634.85
			Sheet 1 of 1

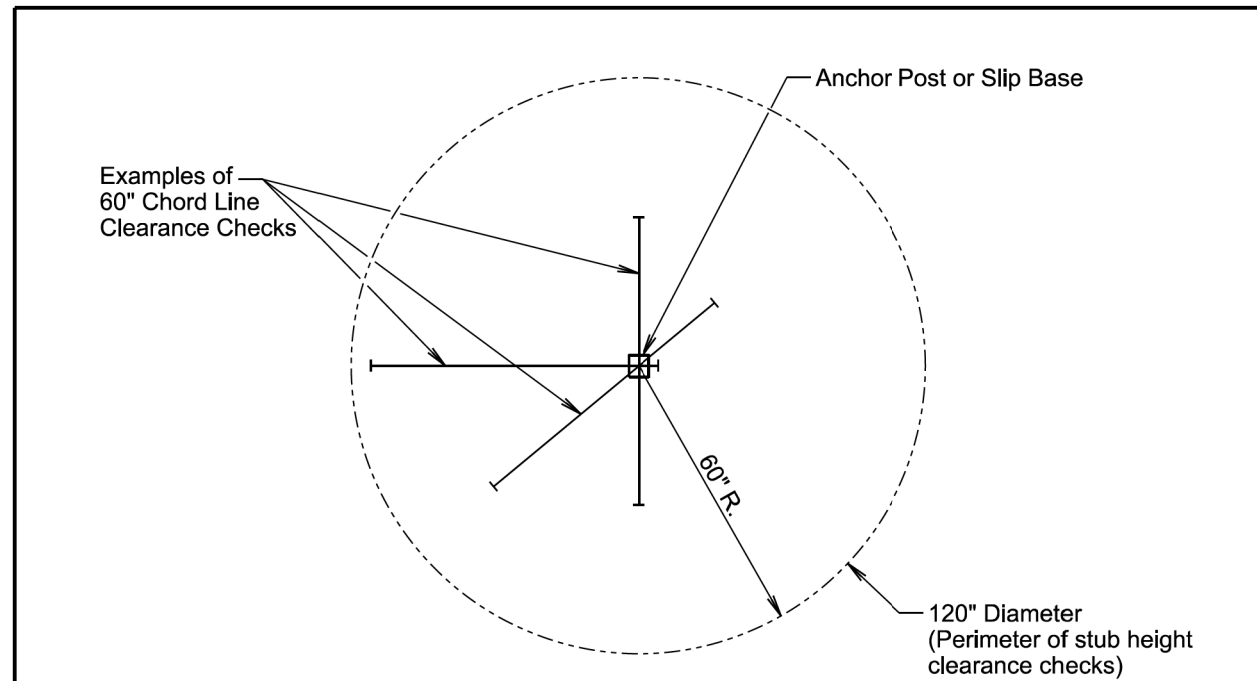

PLAN VIEW
(Examples of stub height clearance checks)

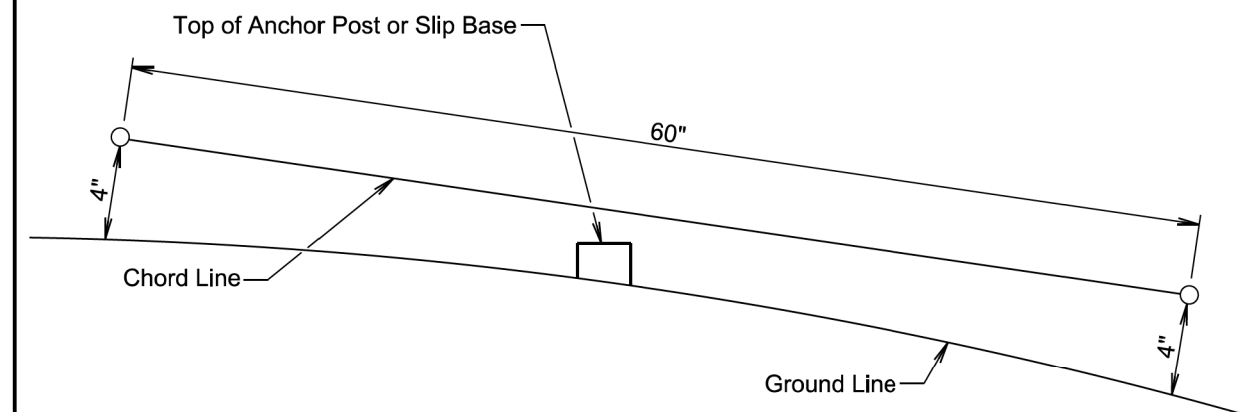

ELEVATION VIEW

GENERAL NOTES:

The top of anchor posts and slip bases WILL NOT extend above a 60" chord line within a 120" diameter circle around the post with ends 4" above the ground.

At locations where there is curb and gutter adjacent to the breakaway sign support, the stub height will be a maximum of 4" above the ground line at the localized area adjacent to the breakaway support stub.

The 4" stub height clearance is not necessary for U-channel lap splices where the support is designed to yield (bend) at the base.

January 22, 2021

Published Date: 2026	S D D O T	BREAKAWAY SUPPORT STUB CLEARANCE	PLATE NUMBER 634.99
			Sheet 1 of 1