

0001-271 & 0001-272 MINNEHAHA & LINCOLN COUNTIES MOWING

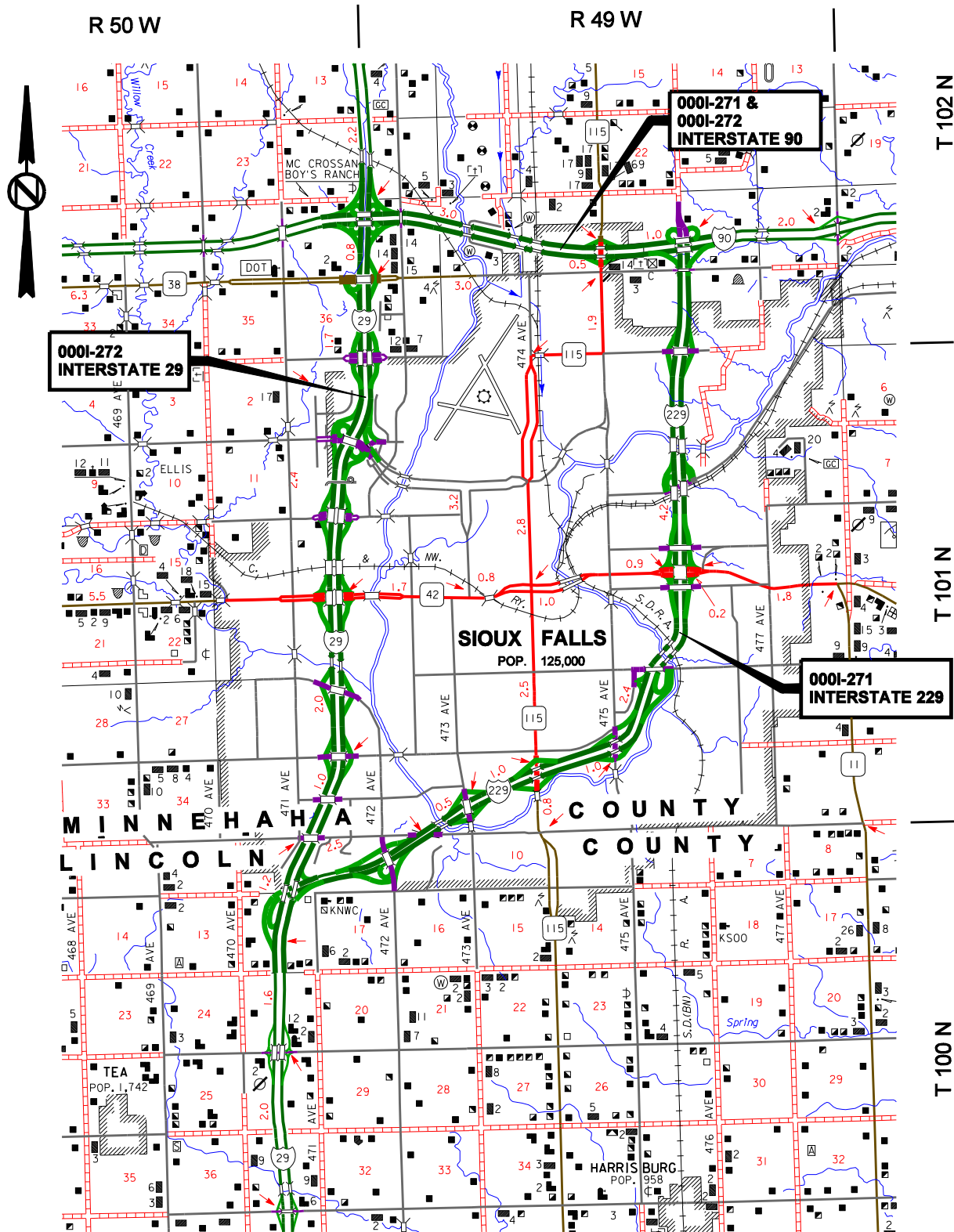

**000I-271 & 000I-272
MINNEHAHA & LINCOLN COUNTIES**

DESCRIPTION OF WORK

The work shall consist of mowing grass and other vegetation within the right-of-way of Interstates 29, 90 and 229 looping the City of Sioux Falls as shown in these plans.

CONTRACT REQUIREMENTS

1. The Contractor shall be considered an Independent Contractor and shall comply to all labor regulations pertaining to the employment of his employees and assume responsibility for withholding of all monies applicable for fringe benefits and for applicable taxes for his employees. All employees of the Contractor shall be deemed the Contractor's employees for purpose of the Workers Compensation Act and not as employees of the State of South Dakota.
2. At the time of the execution of the contract, the Contractor shall furnish a performance bond in a sum equal to the full amount of the contract.
3. The contract work shall not be sublet, assigned or otherwise disposed of except with the written consent of the South Dakota Department of Transportation. In no case will it be permissible to sublet more than 50% of the work. Consent to sublet or assign a portion of the work shall not be construed to relieve the Contractor of any responsibility for fulfillment of the contract.
4. An area of exception between I29 MRM 78 and I29 MRM 80 will not be mowed as part of this contract, during 2006. The exception will be mowed by others.

During 2007 and 2008, other sections of this project may also be removed from the contract due to construction or other reasons. No payment will be made for sections of the project that are removed from the plans and no adjustment will be allowed to the contract unit prices as result of the removed sections.

5. Prior to beginning work, the Contractor shall be required to show proof of public liability insurance of not less than \$100,000.00 per person and \$300,000.00 per accident, and \$50,000.00 property damage to cover any and all claims that may arise of work performed under the provisions of the contract, and shall hold harmless the State of South Dakota, its officers and employees from any claims whatsoever as a result of acts performed by the Contractor.
6. The Contractor shall give his personal supervision of the work, or have a competent designate available at all times with authority to act for the Contractor.
7. Prior to beginning work, a conference shall be arranged with the Department of Transportation. At this meeting, the Contractor shall outline their proposed mowing procedure and give their plan for performing the work while providing the safe passage of traffic at all times.

CONTRACT PERIOD – 3 YEARS

The contract start date is the date the contract is awarded to the Contractor. The contract completion date is the last date the Contractor performs services for the Department.

EQUIPMENT

1. The mowing may be performed with tractor operated rotary, flail or sickle mowers. Other types of cutting machines may be used but will require approval prior to use.
2. All rotary mowers must be equipped with safety chains or approved devices to prevent damage to property from flying debris from under the mower.
3. The mower/tractor shall be equipped with a flashing amber light mounted on the top of the tractor visible for 360°. A strobe light with 600,000 candle power or a revolving light with a 4" sealed beam unit is acceptable. (Minimum requirements).
4. A slow moving emblem will be required to be mounted on the mowing unit visible from the rear.
5. Mowers shall be kept in good operating condition at all times in order to produce a clean, sharp cut of vegetation.

**000I-271 & 000I-272
MINNEHAHA & LINCOLN COUNTIES**

MOWING REQUIREMENTS

1. The start of mowing operations will be determined by the Engineer. Mowing will not begin until the vegetation reaches an average height of 12 inches.
2. The Contractor shall begin mowing operations within ten days after notification.
3. Priority shall be given to the first fifteen feet of width adjacent to shoulders. The fifteen feet adjacent to shoulders shall be mowed first, for the entire length of project, at all locations. Once this has been completed, the Contractor can complete the mowing out to the right-of-way fence, or the additional fifteen feet of width.
4. After mowing is started, the Contractor will be required to complete each mowing cycle within thirty calendar days unless otherwise extended by the Engineer.
5. Unless otherwise directed by the Engineer, mowing of the Project will be performed three times between the dates of May 1 and October 31. First cutting shall be done prior to June 1. Second cutting shall be done between July 1 and August 1, third cutting shall be done between September 1 and October 1. In the event that vegetation does not reach the average height of 12 inches, the mowing schedule may be adjusted and/or the third mowing may be eliminated (partially or in full).
6. Vegetation shall be mowed to a height of four to six inches.
7. The Contractor will confine all operations to daylight hours with no work performed on Sundays or State Holidays unless authorized by the Engineer.
8. All mowed areas shall be left in a neat appearing condition upon completion of the mowing. Strips of uncut grass or piles of cut grass shall not be left in the mowed areas. Baling will not be permitted within the area covered under this contract.
9. Hand trimming will be required around sign posts, delineators, guardrail, trees and shrubbery, improvement, or appurtenances. Hand trimming will be done on the entire project during all three cycles of Mowing. Cost for hand trimming shall be incidental to the contract unit price per acre for Mowing.
10. The median will be mowed the entire length of the Project. The median shall be mowed from the inside shoulder edge of one lane to the inside shoulder edge of the opposite lane.
11. The roadway inslopes, including the ramps, service roads and approaches shall be mowed a width of fifteen or thirty feet, as specified in these plans, measured from the edge of the shoulder, in areas where mowing only the inslopes is specified. Mowing equipment will not be allowed on the driving lanes or shoulders.
12. Due to Interstate construction around Sioux Falls, some areas may not require mowing. These areas will be deducted from the contract mowing quantity.
13. Additional areas can be ordered mowed for control of noxious weeds, sight distance or for appearance. Areas included in the mowing summary may also be deleted as determined by the Engineer.
14. Mowing of inslopes or backslopes steeper than 2.5:1 and wet and/or other inaccessible areas will not be required unless the vegetation interferes with safe sight distance to the driving public, which then may require hand mowing.
15. Sanitary sewer manholes are in place within the mowing area at various locations throughout the project. It is the Contractor's responsibility to verify these locations. If a manhole is disturbed due to the Contractor's operations, the City of Sioux Falls shall be contacted immediately. Any damage caused by the Contractor's operations shall be repaired at the Contractor's expense.

**000I-271 & 000I-272
MINNEHAHA & LINCOLN COUNTIES**

MOWING REQUIREMENTS (CONTINUED)

16. Mowing of the median inside or between the steel beam and cable guardrail installations adjacent to structures will be required. The method of getting the mowers inside or between guardrail installations must have Engineer approval or be hand mowed. Median enclosures exist at these locations:

I-90

MRM 397.45
MRM 397.86
MRM 398.69
MRM 399.56

I-229

MRM 1.88
MRM 3.12
MRM 4.16
MRM 5.52
MRM 7.84
MRM 8.28

17. If equipment is left on the project overnight, it cannot be left in the median. The equipment must be parked near the right-of-way fence line. Equipment shall not be left unattended within thirty feet of the roadway shoulder at any time.
18. Mower movement in and out of the median and crossing traffic lanes shall be kept to a minimum. Bridges shall be crossed using the proper lanes and travel only in the true direction of traffic. The Contractor shall take all needed precautions when it is necessary to cross the traffic lanes. Mowing equipment will not be allowed to swing out into the driving lanes while mowing around delineator posts along the edge of the driving lanes.
19. Where wildflowers are in bloom, mowing may be reduced to median and 15' topcut only. The Engineer will direct mowing operations in these areas.

MEASUREMENT AND PAYMENT

1. Payment for Mobilization 1, 2 or 3 will be made at the contract unit price per each and is payment for the work necessary to establish, modify and/or organize the facilities, equipment, and personnel to provide mowing as per this contract. Payment for Mobilization 1 will take place once, after contract award, and payment for Mobilization 2 or 3 will take place once, in each of the successive 2 years of the contract, provided that the contract is renewed and, provided that the Contractor demonstrates to the Department that the aforementioned mobilization work is accomplished.
2. Mowing will be paid by the acre. The acres shown in the Table of Mowing will be the basis for measurement (by times mowed). Changes in the mowing from what is shown in the Table of Mowing will be measured separately for payment and added or deducted as applicable.

The contract unit price per acre will be full compensation for furnishing all labor, equipment, supplies, and incidentals necessary to complete each mowing.

3. The acres of mowing were determined by horizontal width and length computations referenced to mile reference markers. No deductions were made in these computations for waterways, inaccessible areas or other nonmowable areas.
4. A payment will be made after the satisfactory completion of each mowing cycle. An interim payment can be made if requested by the Contractor but it will be limited to one interim payment per mowing cycle.
5. To protect against extreme changes in the cost of fuel, the State of South Dakota Department of Transportation Special Provision for Fuel Cost Adjustment, dated October 5, 2005, applies to all mowing work provided under this contract.

LOCATION MRM TO MRM		AREA TO BE MOWED	2006 ACRES	2007 ACRES	2008 ACRES
I29					
74.20	74.80	R/W to R/W line, 48' Median and 85' sides	15.8	15.8	15.8
74.80	75.60	I29 Interchange Exit 75 (Includes I229 MRM 0.00 to MRM 0.09)	102.1	102.1	102.1
75.60	78.80	R/W to R/W line, 48' Median and 60' sides plus area beyond channel	-	84.6	84.6
75.60	78.00	R/W to R/W line, 48' Median and 60' sides plus area beyond channel	63.4	-	-
77.26		41st St. - Interchange Exit 77 (within ramps)	7.2	7.2	7.2
78.12		26th St. - Interchange Exit 78 (within chnl./ramps)	-	20.3	20.3
78.80	79.50	12th St. - Interchange Exit 79 (Includes I29 MRM 78.80 to MRM 79.50)	-	17.8	17.8
79.50	80.56	Madison St. - Interchange Exit 80 (Includes I29 MRM 79.50 to MRM 80.56)	-	33.4	33.4
80.00	80.56	Madison St. - Interchange Exit 80 (Includes I29 MRM 80.56 to MRM 80.56)	19.5	-	-
80.56	82.01	Russell St. - Interchange Exit 81 (Includes I29 MRM 80.56 to MRM 82.01)	88	88	88
82.01	82.77	Benson Rd - Interchange Exit 82 (Includes I29 MRM 82.01 to MRM 82.77)	23.7	23.7	23.7
82.77	83.81	60th St. N - Interchange Exit 83 (Includes I29 MRM 82.77 to MRM 83.81)	81.3	81.3	81.3
83.81	84.40	I29 Interchange Exit 84 (Includes I90 MRM 396.10 to MRM 397.00)	54.4	54.4	54.4
I29 PROJECT 0001-272 TOTAL:			455.4	528.6	528.6
I90					
396.10	397.00	Included in I29 MRM 83.90 to MRM 84.40 above	-	-	-
397.00	399.30	48' Median and two 30' cuts on the inslopes	30.1	30.1	30.1
399.30	400.20	R/W to R/W line, 48' Median and 85' sides	23.8	23.8	23.8
399.56		Cliff Ave. - Interchange Exit 399 (within ramps)	6.1	6.1	6.1
400.20	401.00	Included in I229 MRM 10.5 to MRM 11.10 below	-	-	-
I90 PROJECT 0001-271 TOTAL:			60.0	60.0	60.0
I229					
0.00	0.09	Included in I29 MRM 74.80 to MRM 75.60 above	-	-	-
0.09	0.53	R/W to R/W line, 48' Median and 85' sides	11.6	11.6	11.6
0.53	1.29	Louise Ave. - Interchange Exit 1C (Includes I229 MRM 0.53 to MRM 1.29)	67.9	67.9	67.9
1.29	6.70	R/W to R/W line, 48' Median and 85'/73' sides	135.1	135.1	135.1
2.08		Western Ave. - Interchange Exit 2 (within ramps)	6.7	6.7	6.7
3.12		Minnesota Ave. - Interchange Exit 3 (within ramps)	9.6	9.6	9.6
4.16		Cliff Ave. - Interchange Exit 4 (within ramps)	11.5	11.5	11.5
5.32		26th St. - Interchange Exit 5 (within ramps)	22.2	22.2	22.2
6.66		10th St. - Interchange Exit 6 (within ramps)	3.0	3.0	3.0
6.70	9.46	R/W to R/W line - Width varies	95.7	95.7	95.7
7.84		Rice St. - Interchange Exit 7 (within ramps)	12.7	12.7	12.7
9.46	10.50	R/W to R/W line, 48' Median and 105' east side and 85' to 164' west side	43.1	43.1	43.1
9.46		Benson Rd. - Interchange Exit 9 (within ramps)	24.8	24.8	24.8
10.50	11.10	I229 Interchange Exit 10 (Includes I90 MRM 400.20 to MRM 401.00)	61.6	61.6	61.6
I229 PROJECT 0001-271 TOTAL:			505.5	505.5	505.5
GRAND TOTAL:			1020.9	1094.1	1094.1

0001-272 INTERSTATES 29 & 229 MOWING

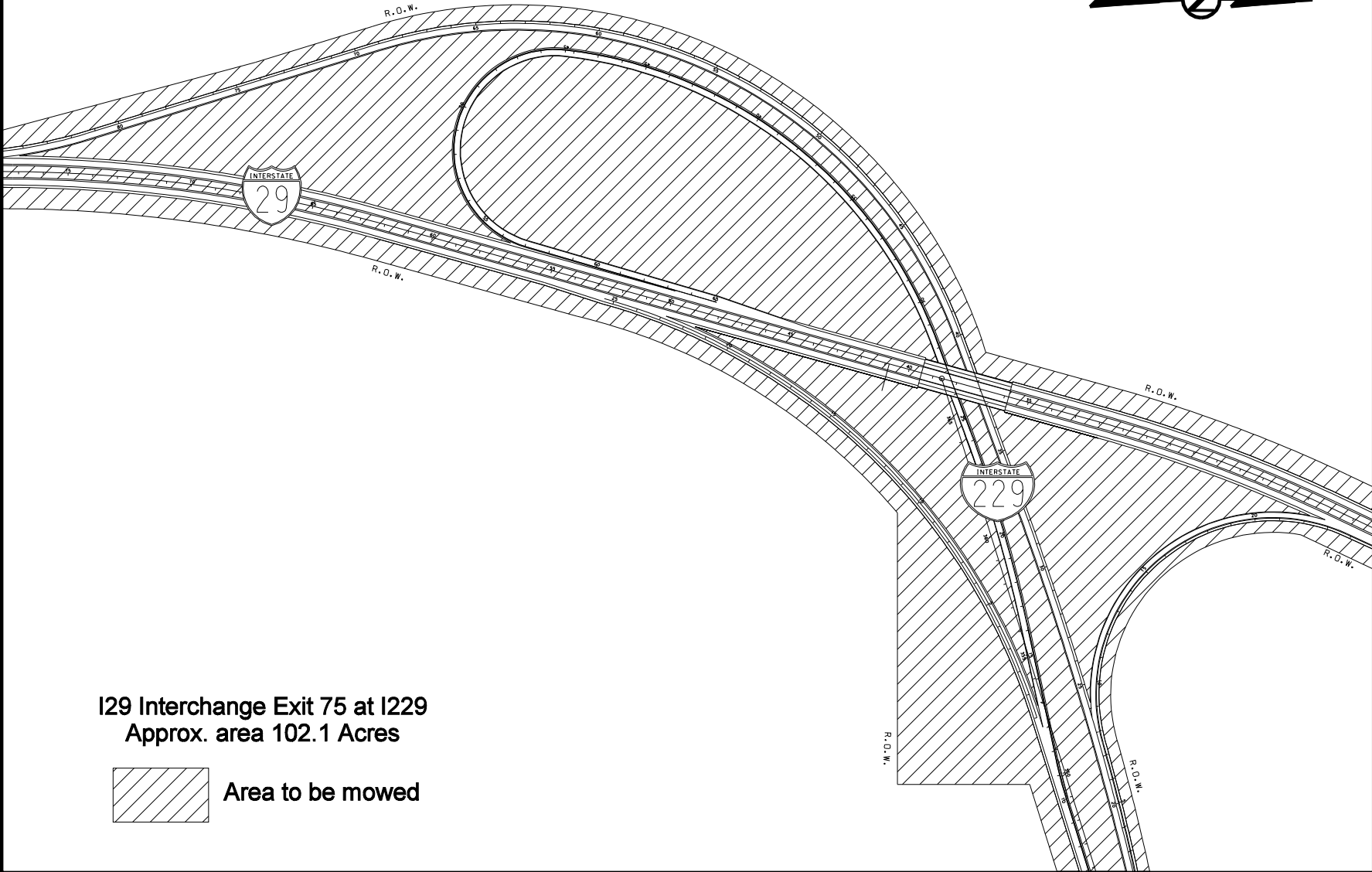

Sheet 6 of 24

I29 Interchange Exit 75 at I229
Approx. area 102.1 Acres



Area to be mowed

0001-271 & 0001-272
MINNEHAHA & LINCOLN COUNTIES

000I-272 INTERSTATE 29 MOWING

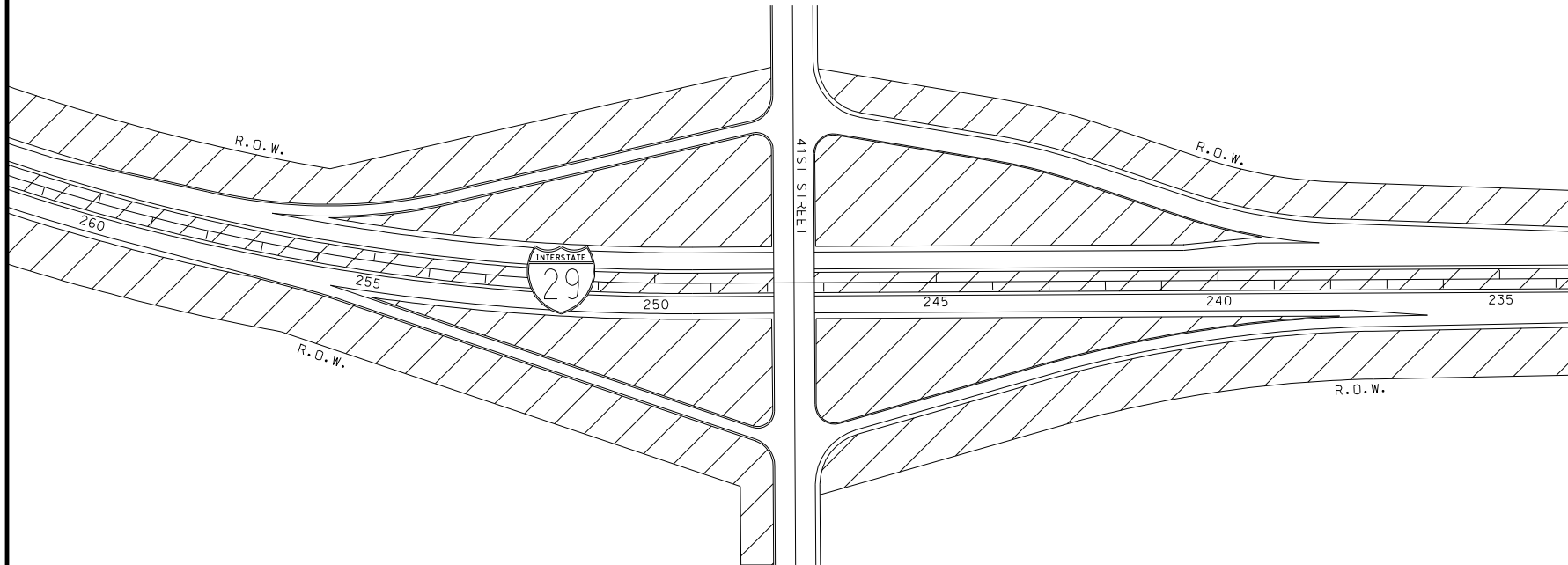

Sheet 7 of 24

000I-271 & 000I-272
MINNEHAHA & LINCOLN COUNTIES

41st St. I29 Interchange Exit 77
Approx. area within ramps 7.2 Acres



Area to be mowed

0001-272 INTERSTATE 29 MOWING

Sheet 8 of 24

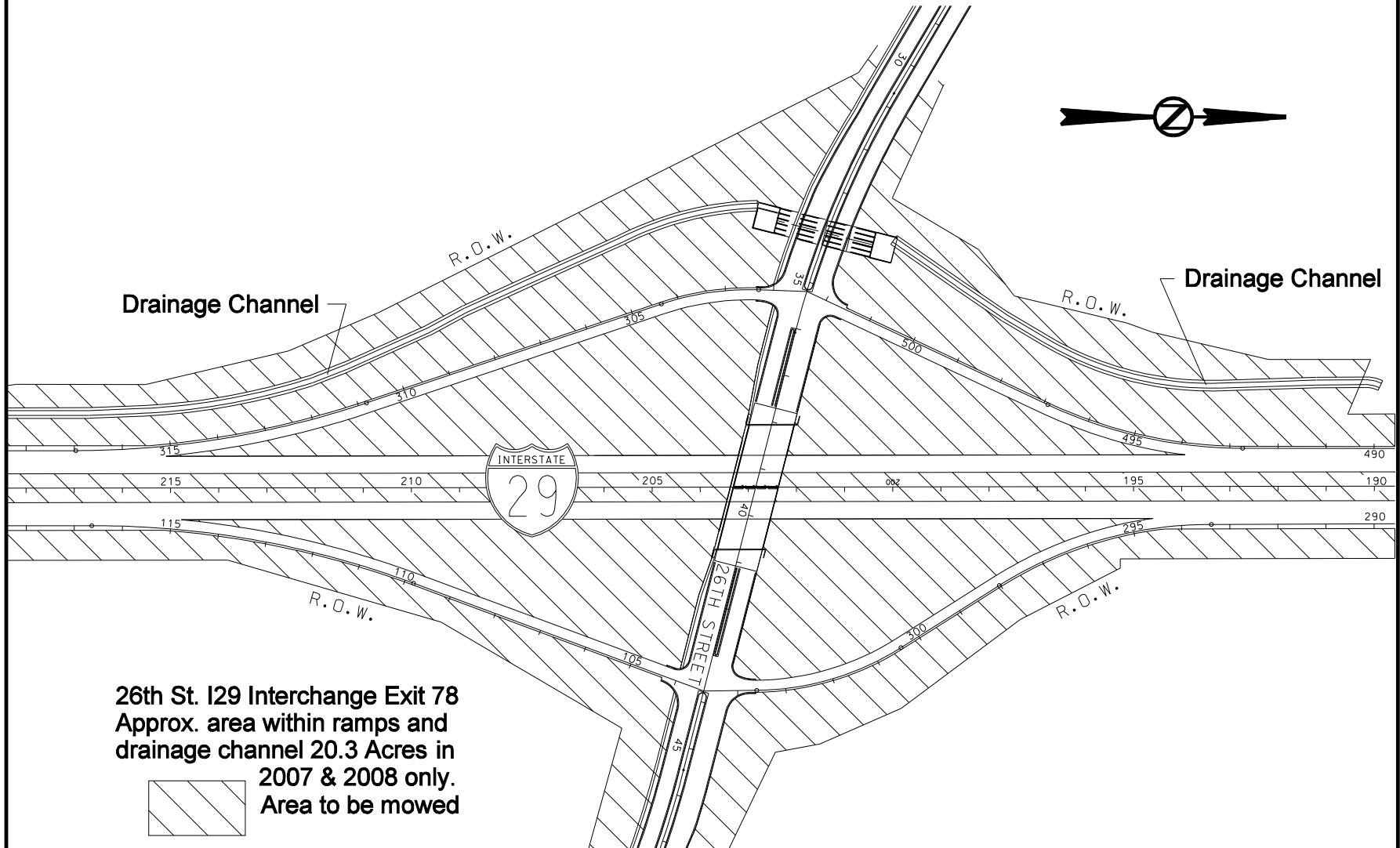

26th St. I29 Interchange Exit 78
Approx. area within ramps and
drainage channel 20.3 Acres in
2007 & 2008 only.
Area to be mowed

0001-271 & 0001-272
MINNEHAHA & LINCOLN COUNTIES

000I-272 INTERSTATE 29 MOWING

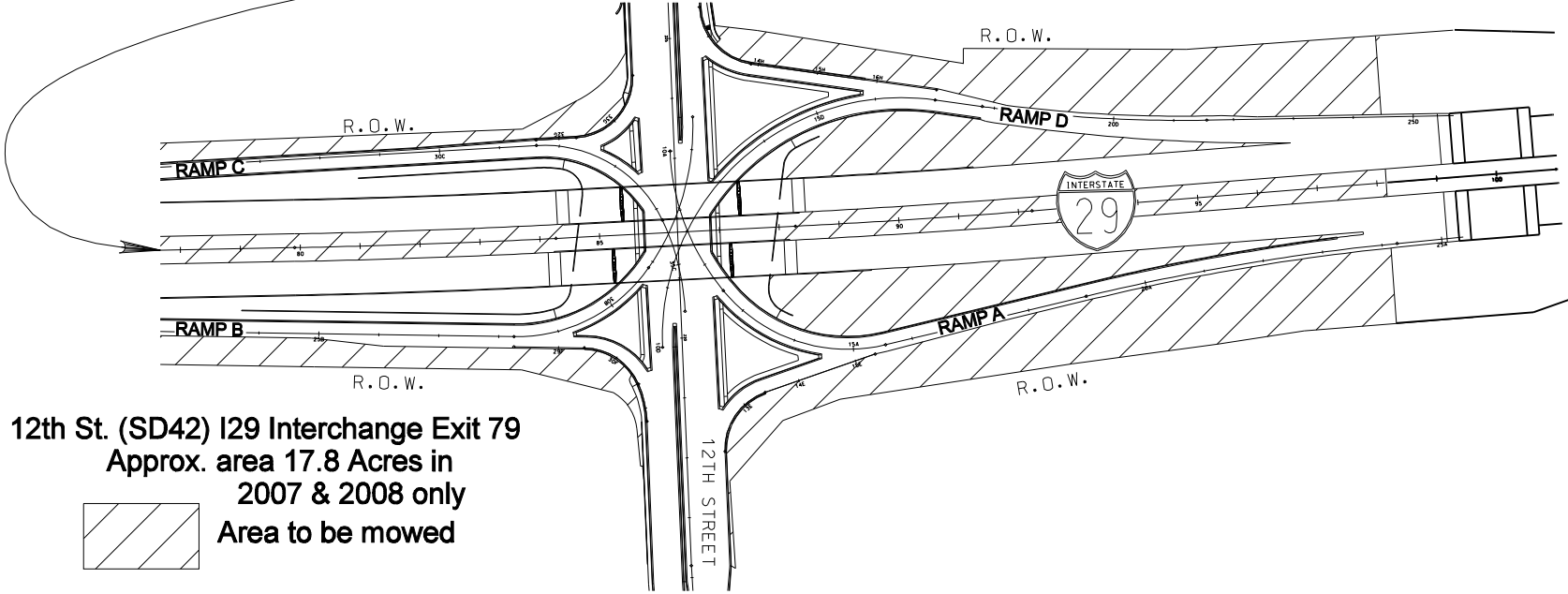
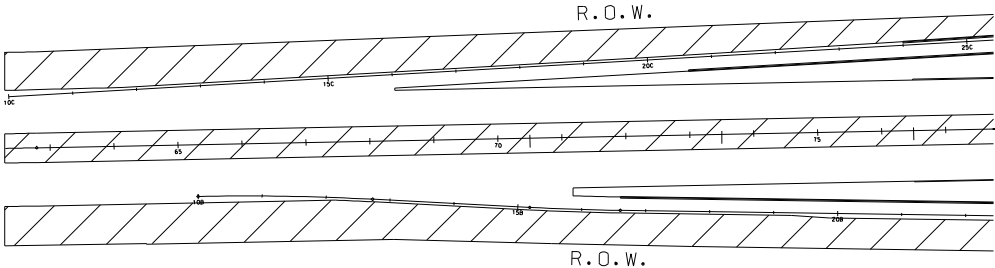

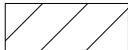
12th St. (SD42) I29 Interchange Exit 79
Approx. area 17.8 Acres in
2007 & 2008 only
 Area to be mowed

Sheet 9 of 24

000I-271 & 000I-272
MINNEHAHA & LINCOLN COUNTIES

000I-272 INTERSTATE 29 MOWING

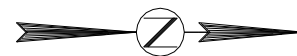

Approx. area to be mowed 13.9 Acres in 2007 & 2008 only

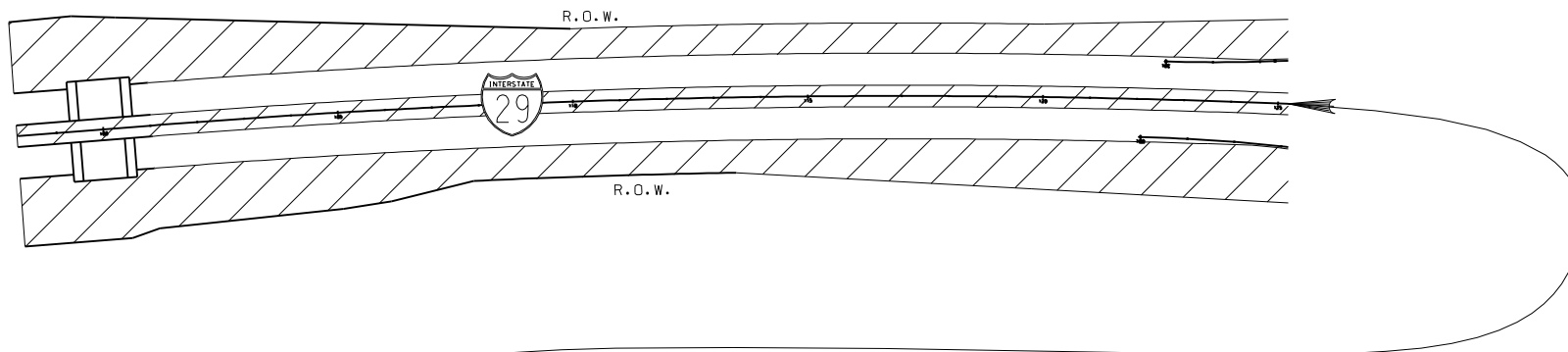

Approx. area to be mowed 19.5 Acres in 2006, 2007 & 2008

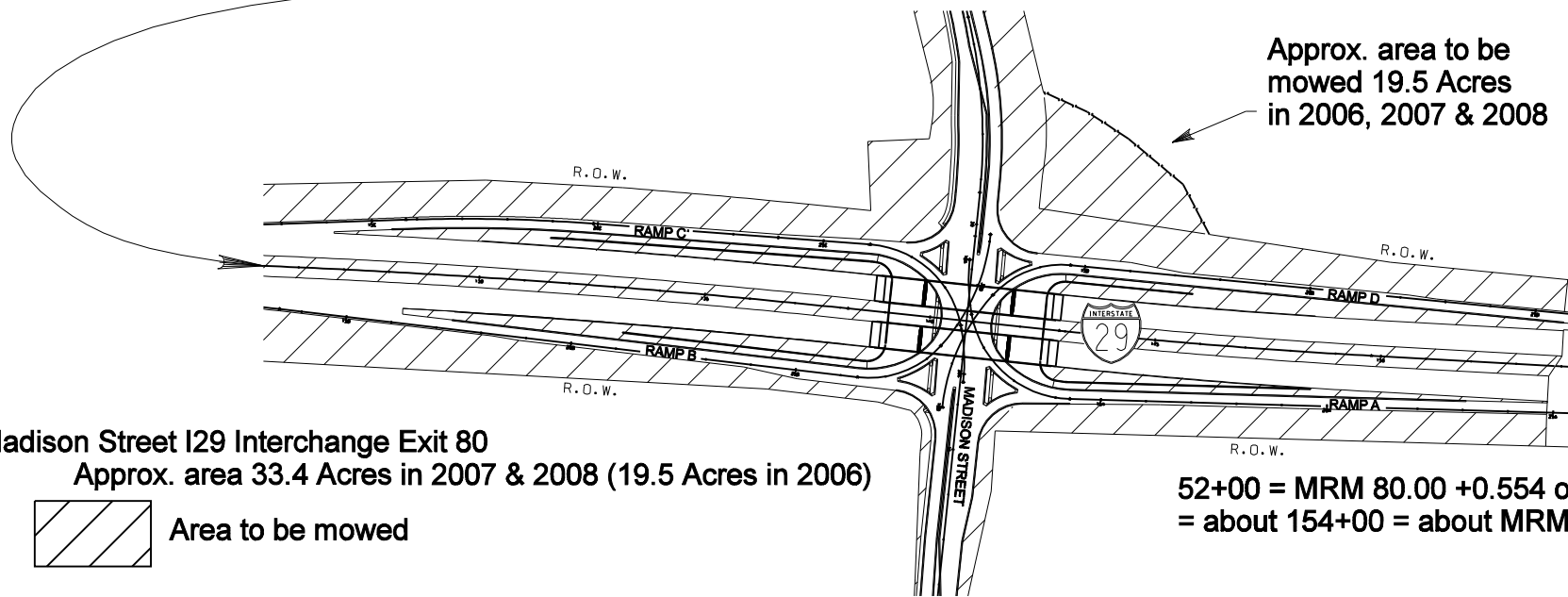

Madison Street I29 Interchange Exit 80
Approx. area 33.4 Acres in 2007 & 2008 (19.5 Acres in 2006)

 Area to be mowed

52+00 = MRM 80.00 +0.554 or
= about 154+00 = about MRM

0001-272 INTERSTATE 29 MOWING



Sheet 11 of 24

0001-271 & 0001-272
MINNEHAHA & LINCOLN COUNTIES

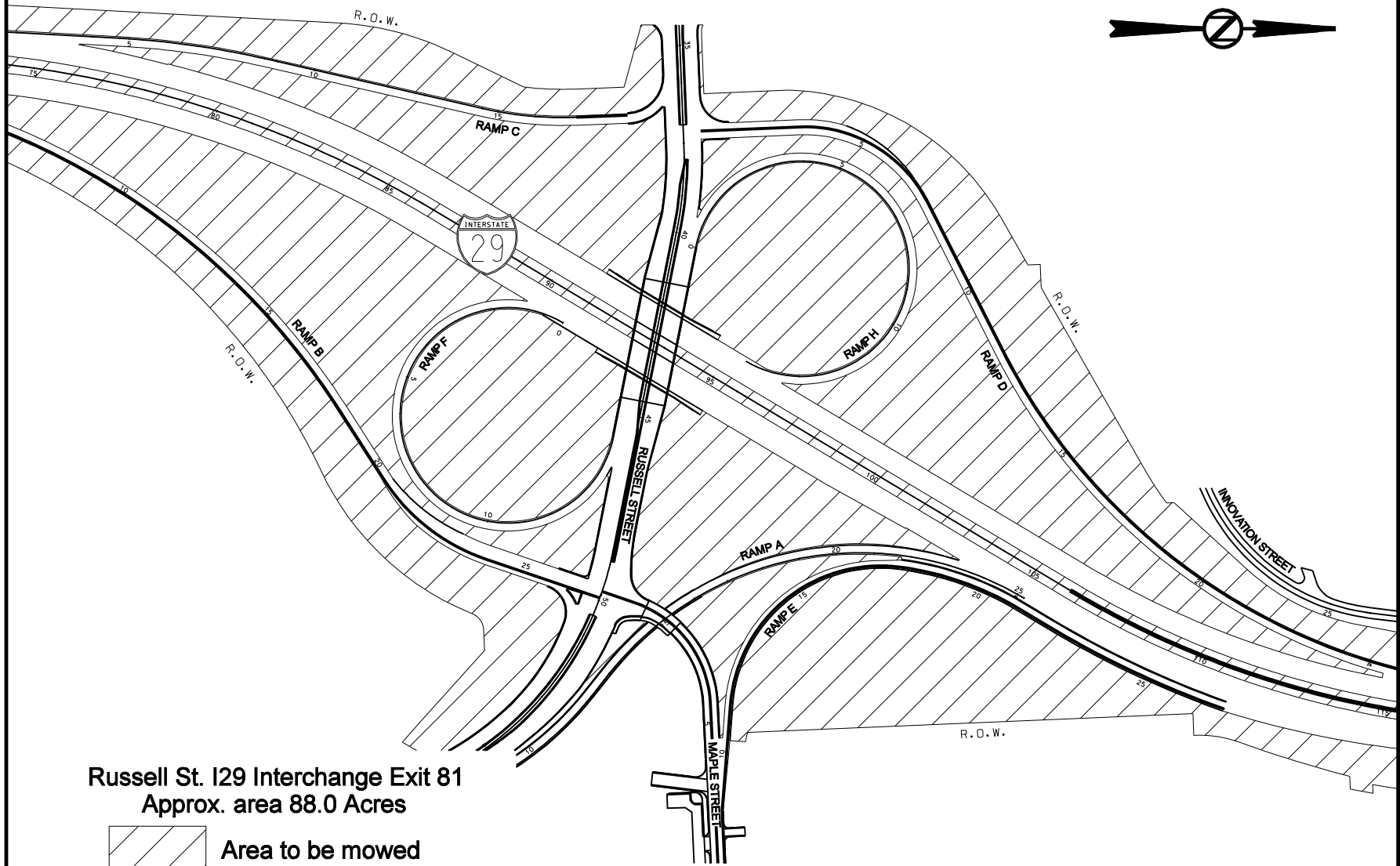

000I-272 INTERSTATE 29 MOWING



Sheet 12 of 24

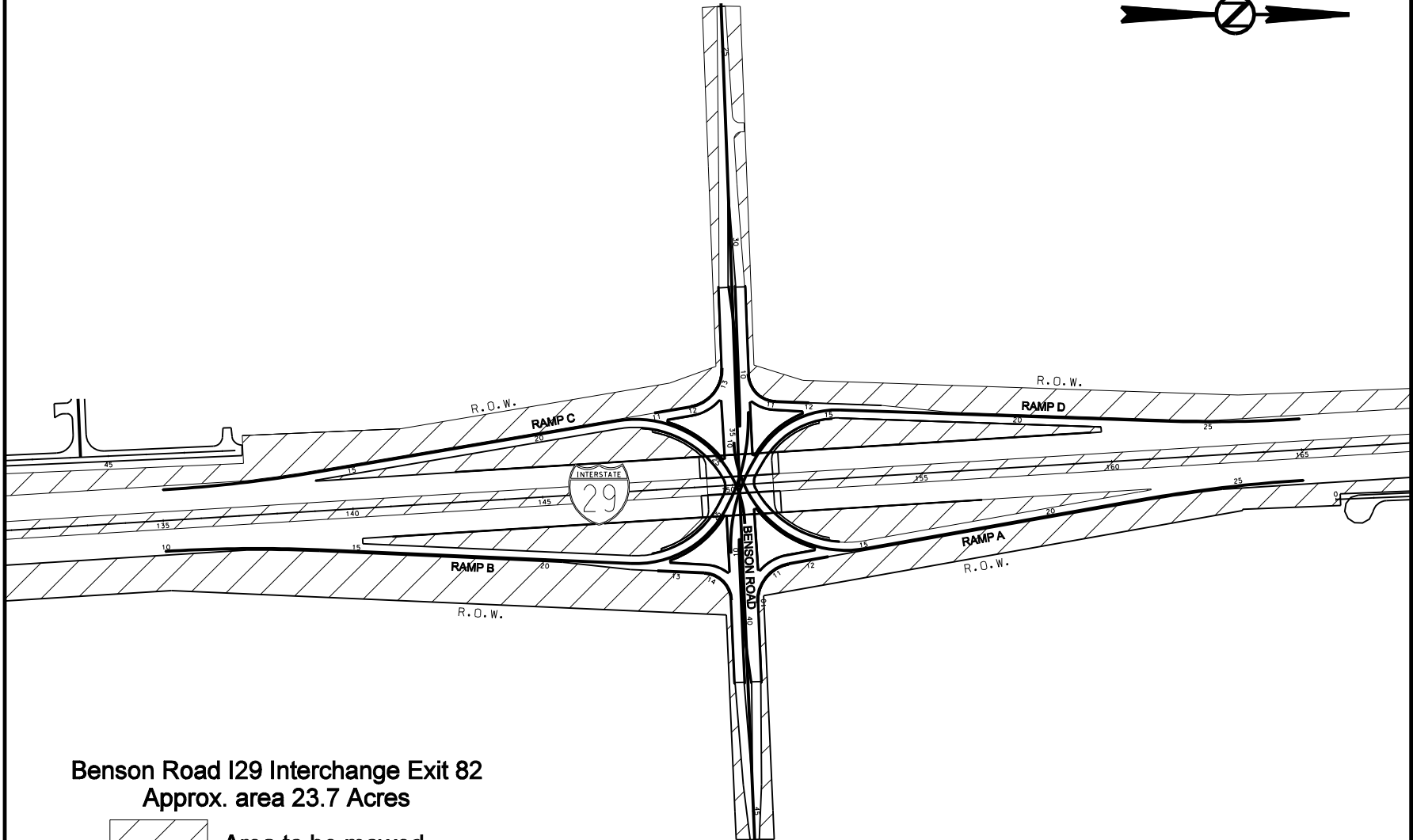

Benson Road I29 Interchange Exit 82
Approx. area 23.7 Acres

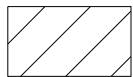

Area to be mowed

000I-271 & 000I-272
MINNEHAHA & LINCOLN COUNTIES

000I-272 INTERSTATE 29 MOWING



Sheet 13 of 24

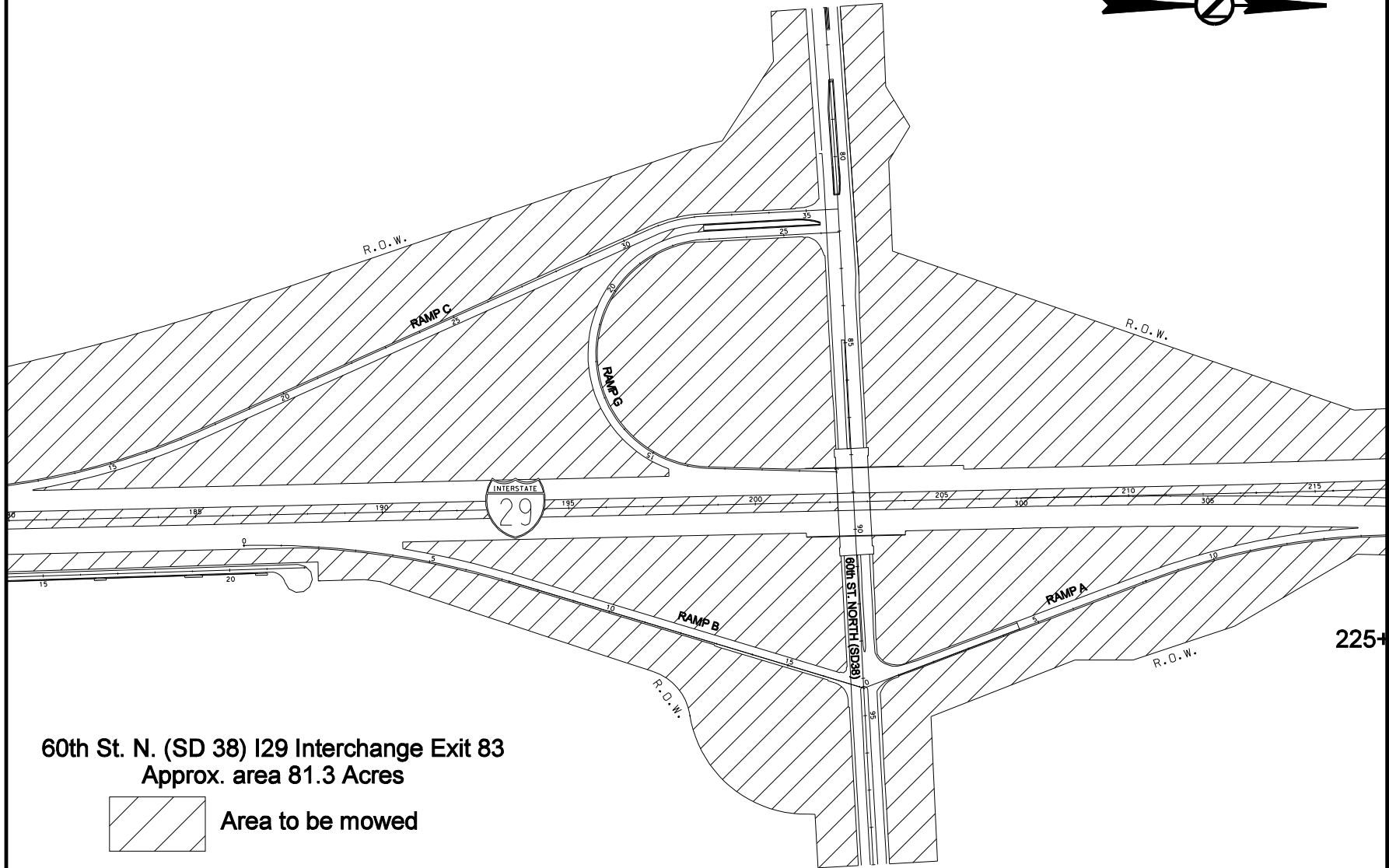

000I-271 & 000I-272
MINNEHAHA & LINCOLN COUNTIES

225+

60th St. N. (SD 38) I29 Interchange Exit 83
Approx. area 81.3 Acres

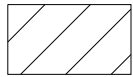

Area to be mowed

000I-272 INTERSTATES 29 & 90 MOWING



Sheet 14 of 24

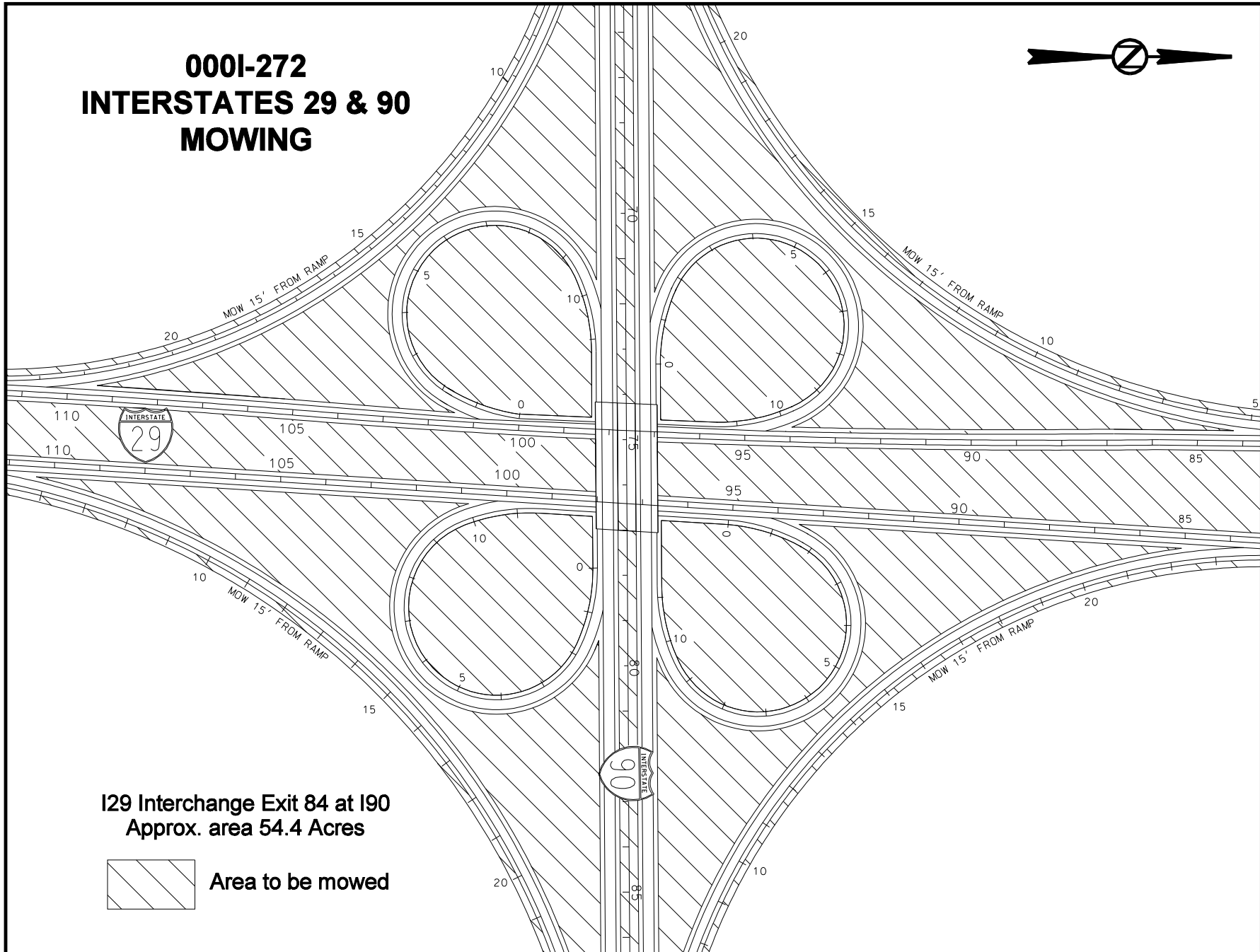

I29 Interchange Exit 84 at I90
Approx. area 54.4 Acres



Area to be mowed

000I-271 & 000I-272
MINNEHAHA & LINCOLN COUNTIES

000I-271 INTERSTATE 90 MOWING

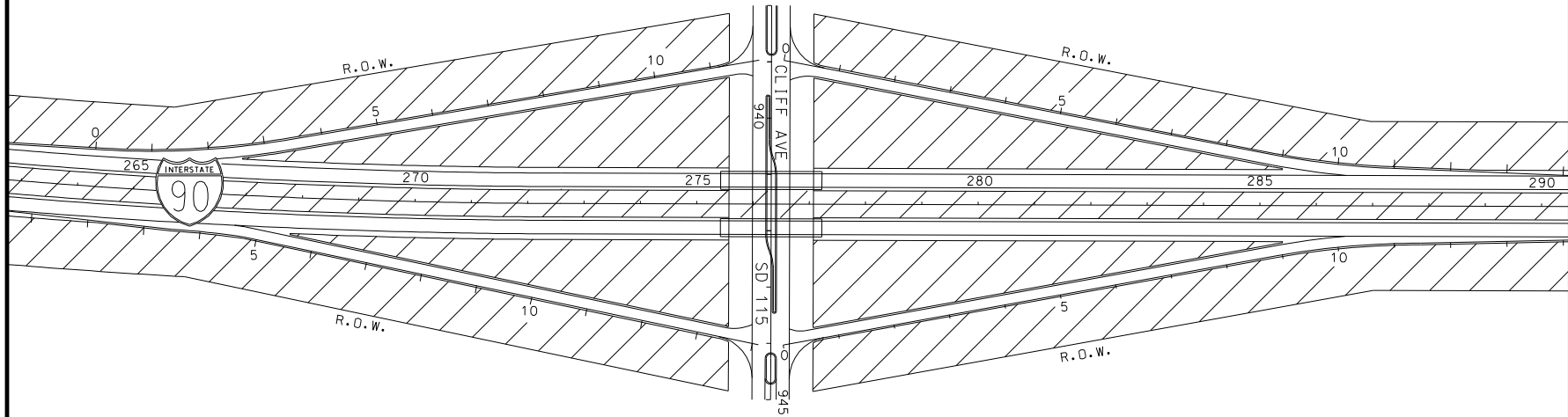

Sheet 15 of 24

Cliff Ave. (SD 115) I90 Interchange Exit 399
Approx. area within ramps 6.1 Acres



Area to be mowed

000I-271 & 000I-272
MINNEHAHA & LINCOLN COUNTIES

0001-271 INTERSTATE 229 MOWING



Sheet 16 of 24

0001-271 & 0001-272
MINNEHAHA & LINCOLN COUNTIES

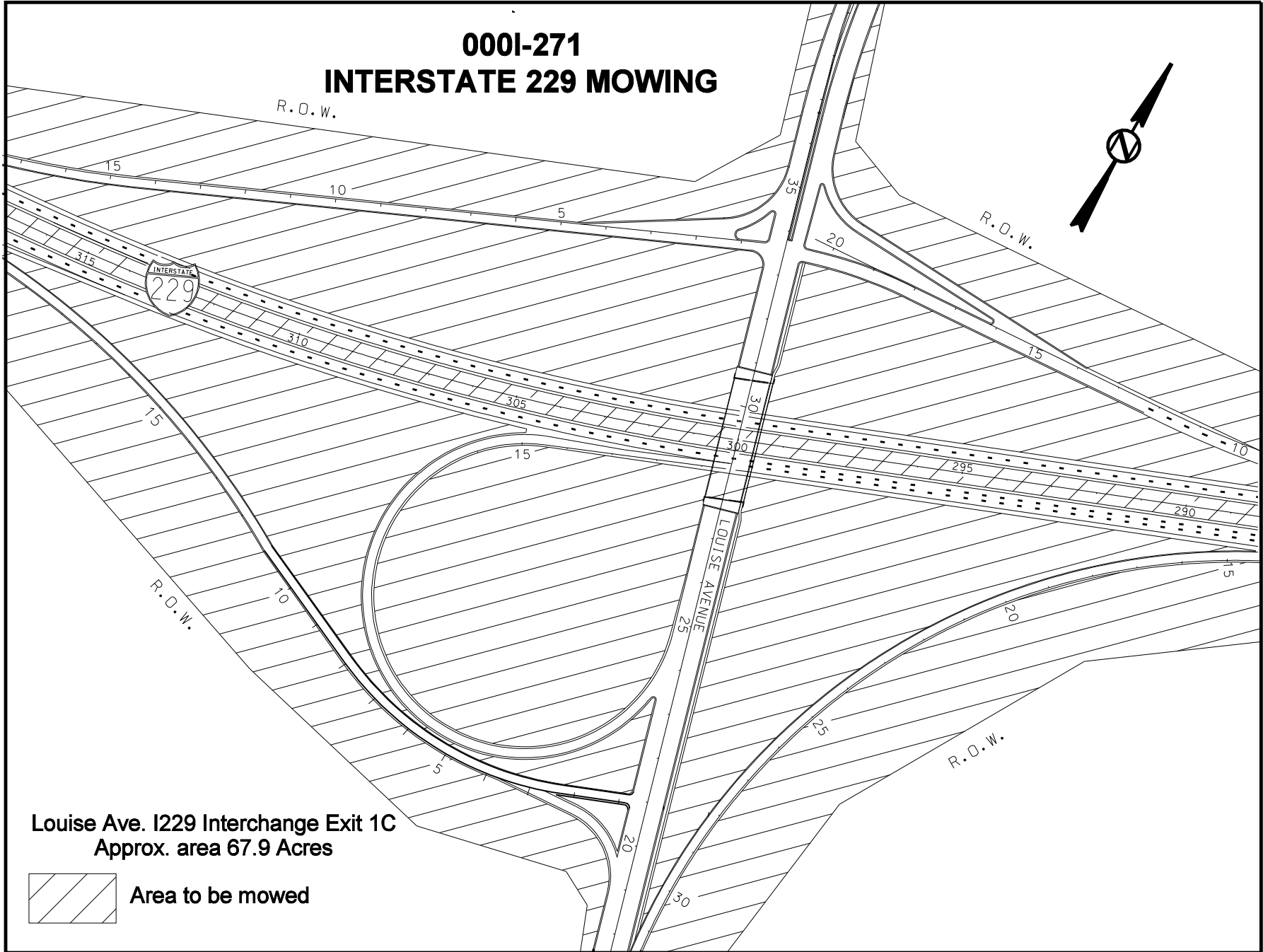

Louise Ave. I229 Interchange Exit 1C
Approx. area 67.9 Acres

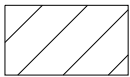

Area to be mowed

000I-271 INTERSTATE 229 MOWING

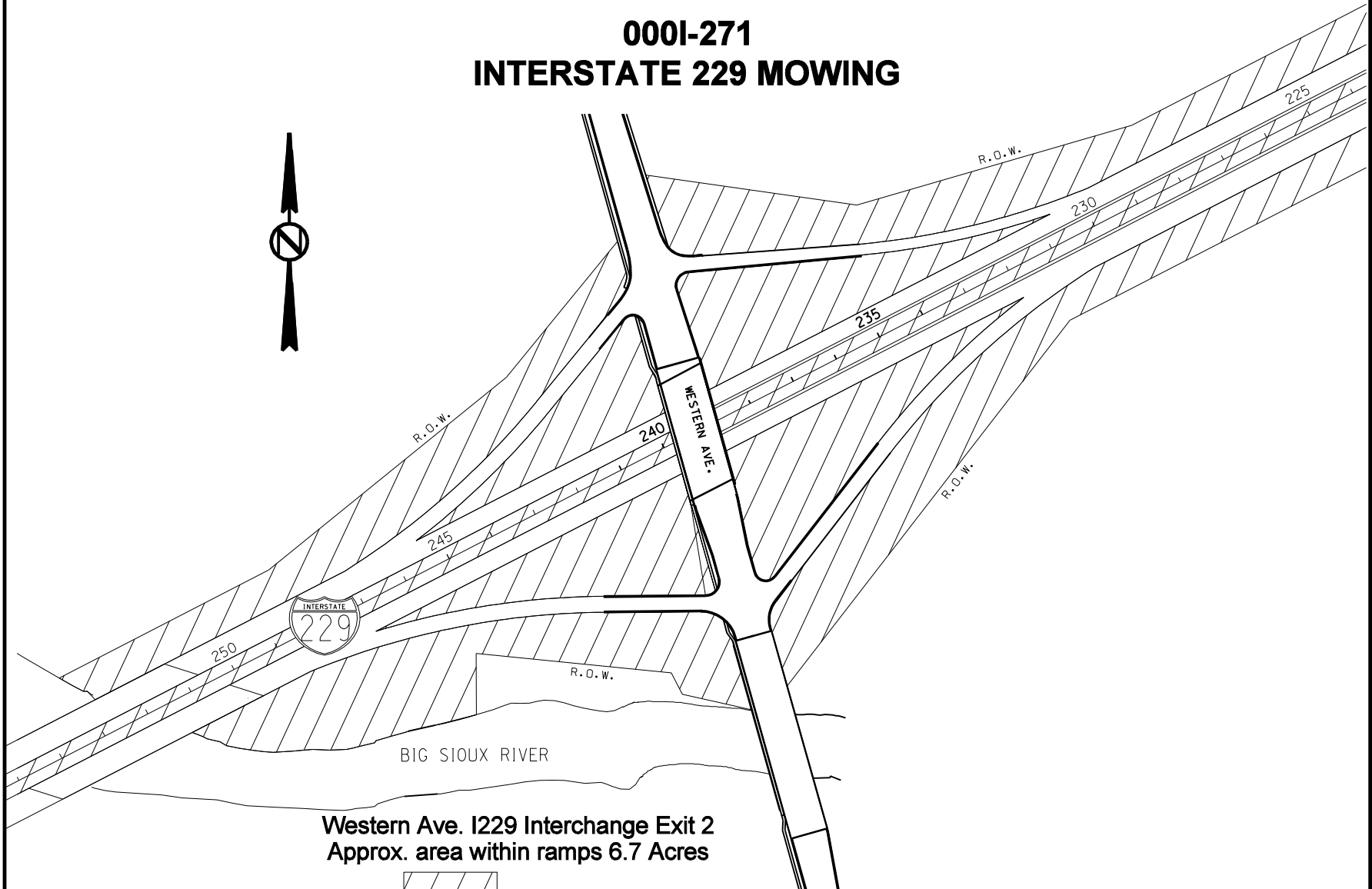

Western Ave. I229 Interchange Exit 2
Approx. area within ramps 6.7 Acres



Area to be mowed



**000I-271
INTERSTATE 229 MOWING**

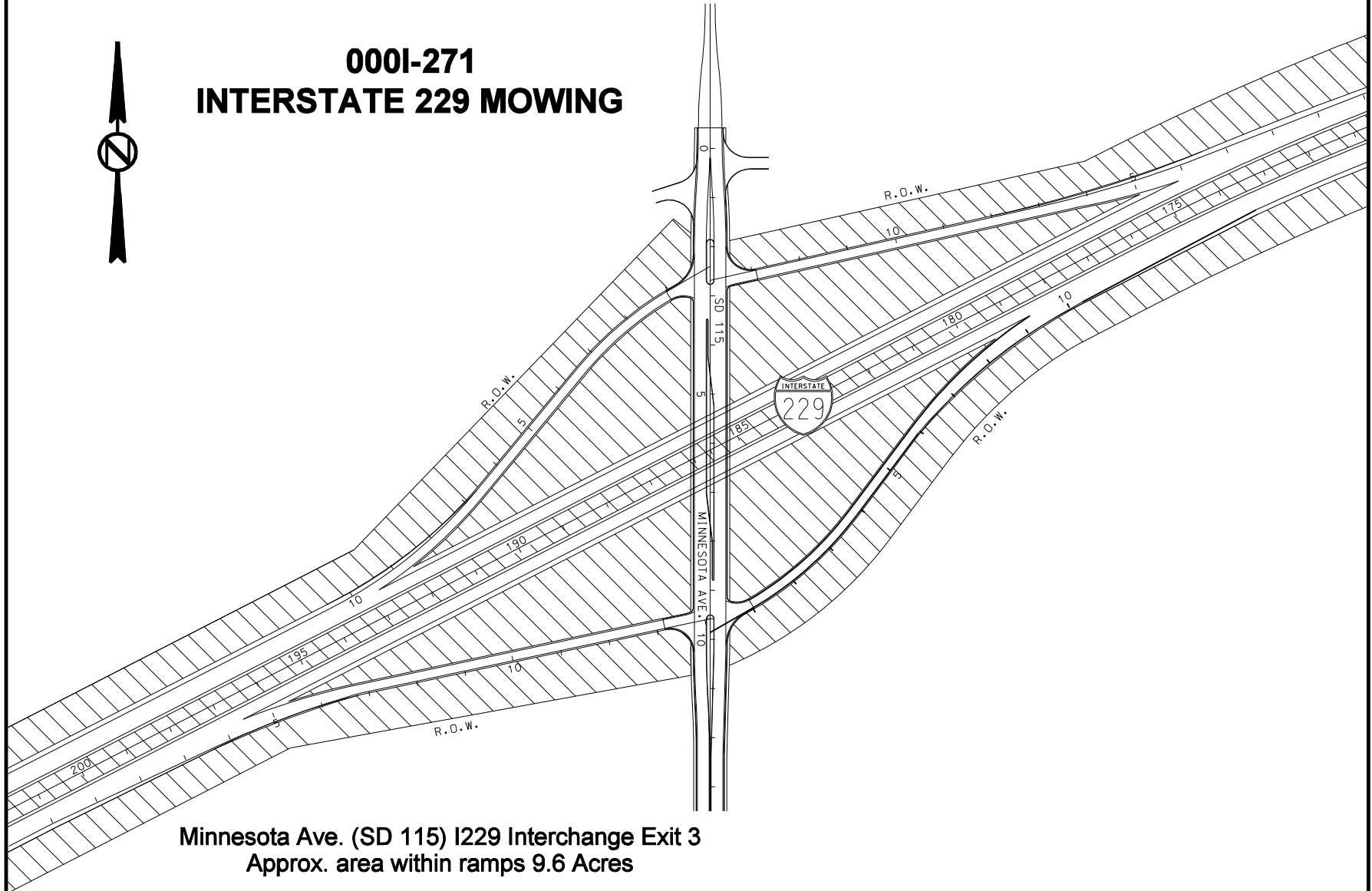

**Minnesota Ave. (SD 115) I229 Interchange Exit 3
Approx. area within ramps 9.6 Acres**



Area to be mowed

000I-271 INTERSTATE 229 MOWING



Sheet 19 of 24

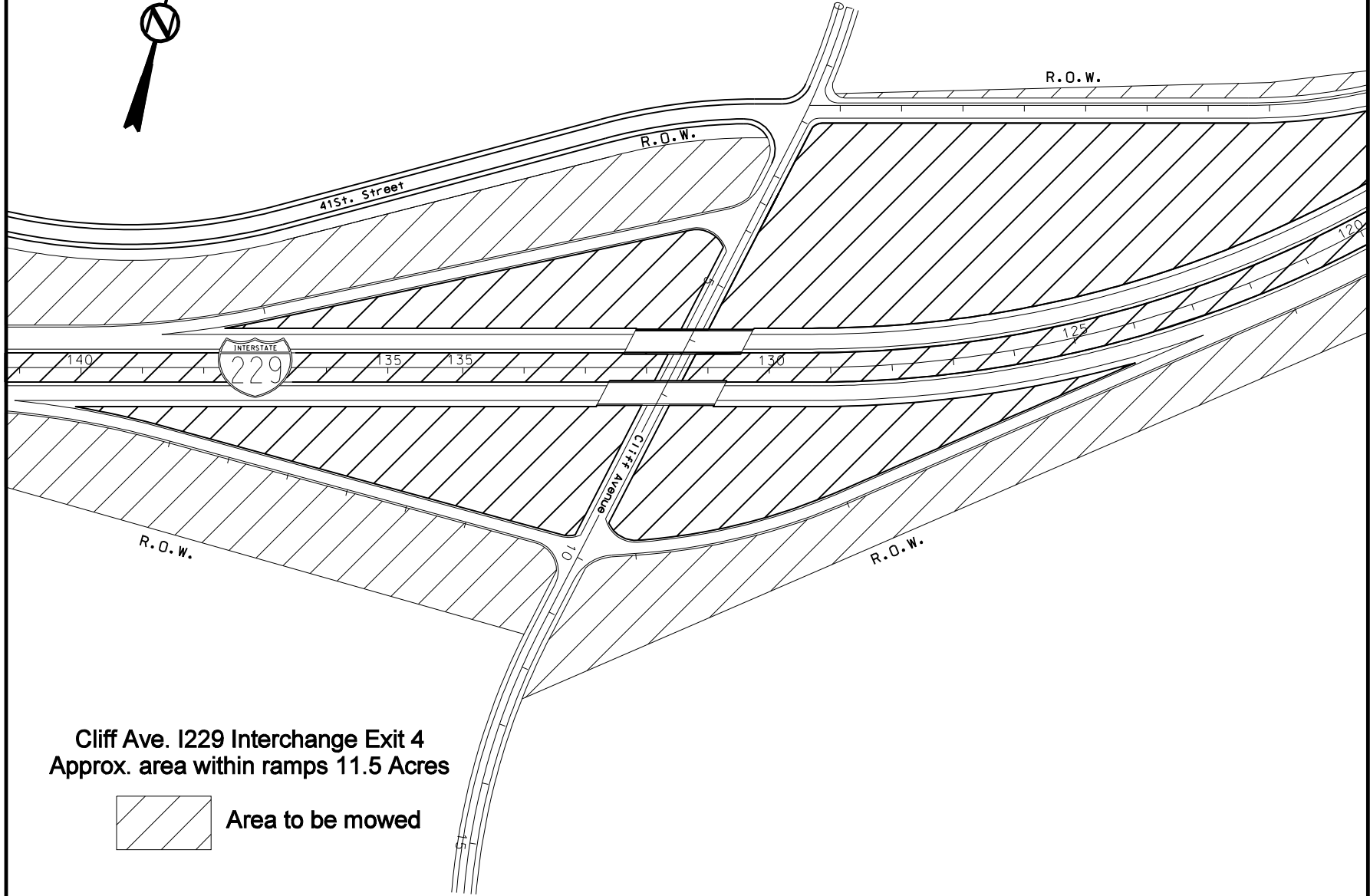

Cliff Ave. I229 Interchange Exit 4
Approx. area within ramps 11.5 Acres



Area to be mowed

000I-271 & 000I-272
MINNEHAHA & LINCOLN COUNTIES

0001-271 INTERSTATE 229 MOWING

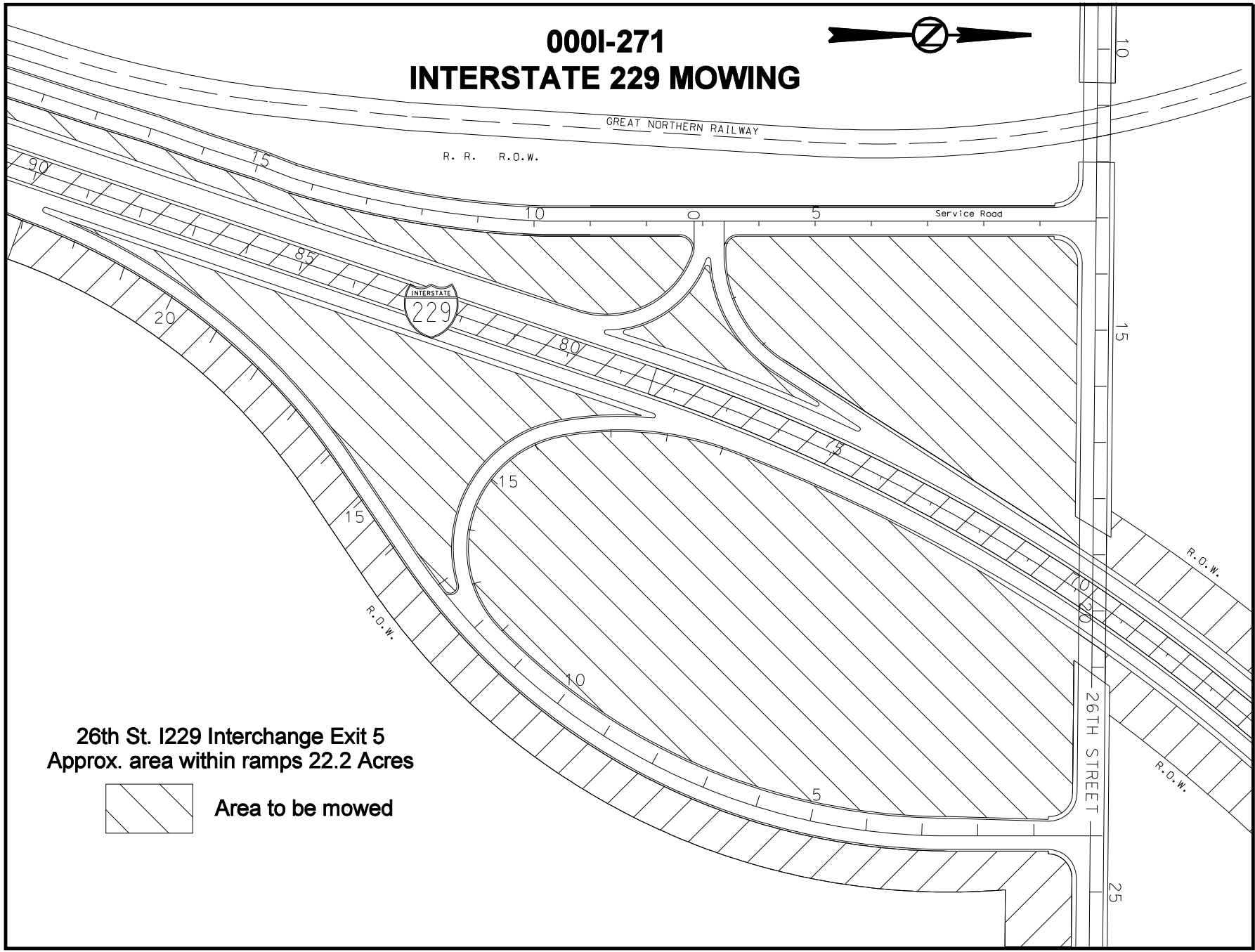
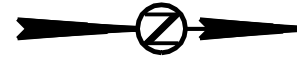

0001-271 & 0001-272
MINNEHAHA & LINCOLN COUNTIES

Sheet 20 of 24

26th St. I229 Interchange Exit 5
Approx. area within ramps 22.2 Acres



Area to be mowed

000I-271 INTERSTATE 229 MOWING

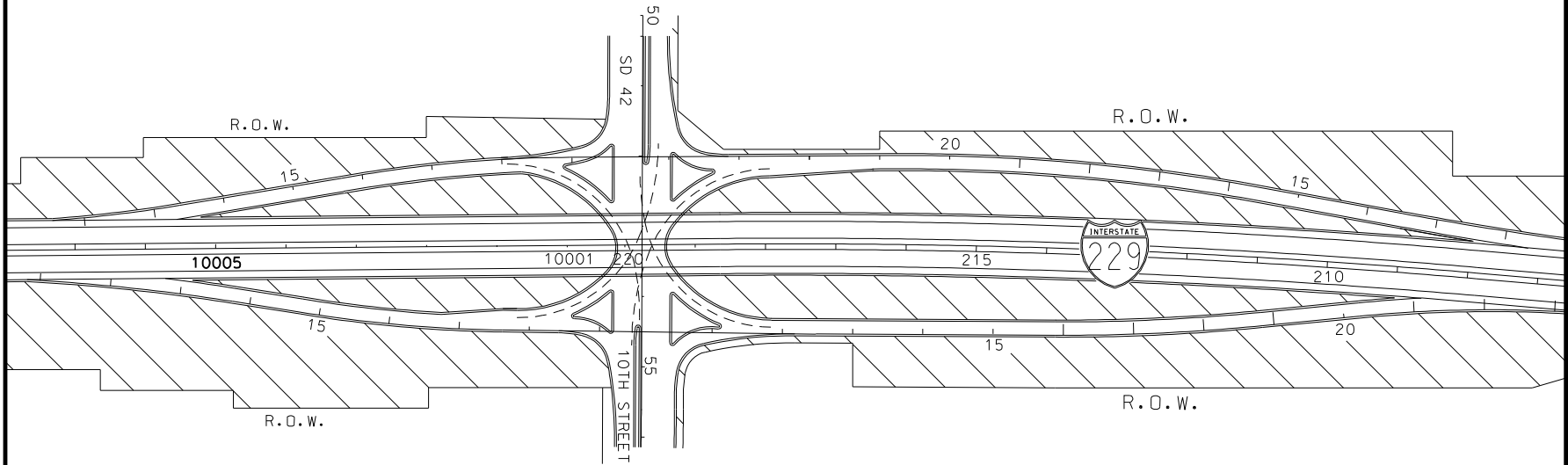

Sheet 21 of 24

10th St. I229 Interchange Exit 6
Approx. area within ramps 3.0 Acres



Area to be mowed

000I-271 & 000I-272
MINNEHAHA & LINCOLN COUNTIES



0001-271 INTERSTATE 229 MOWING

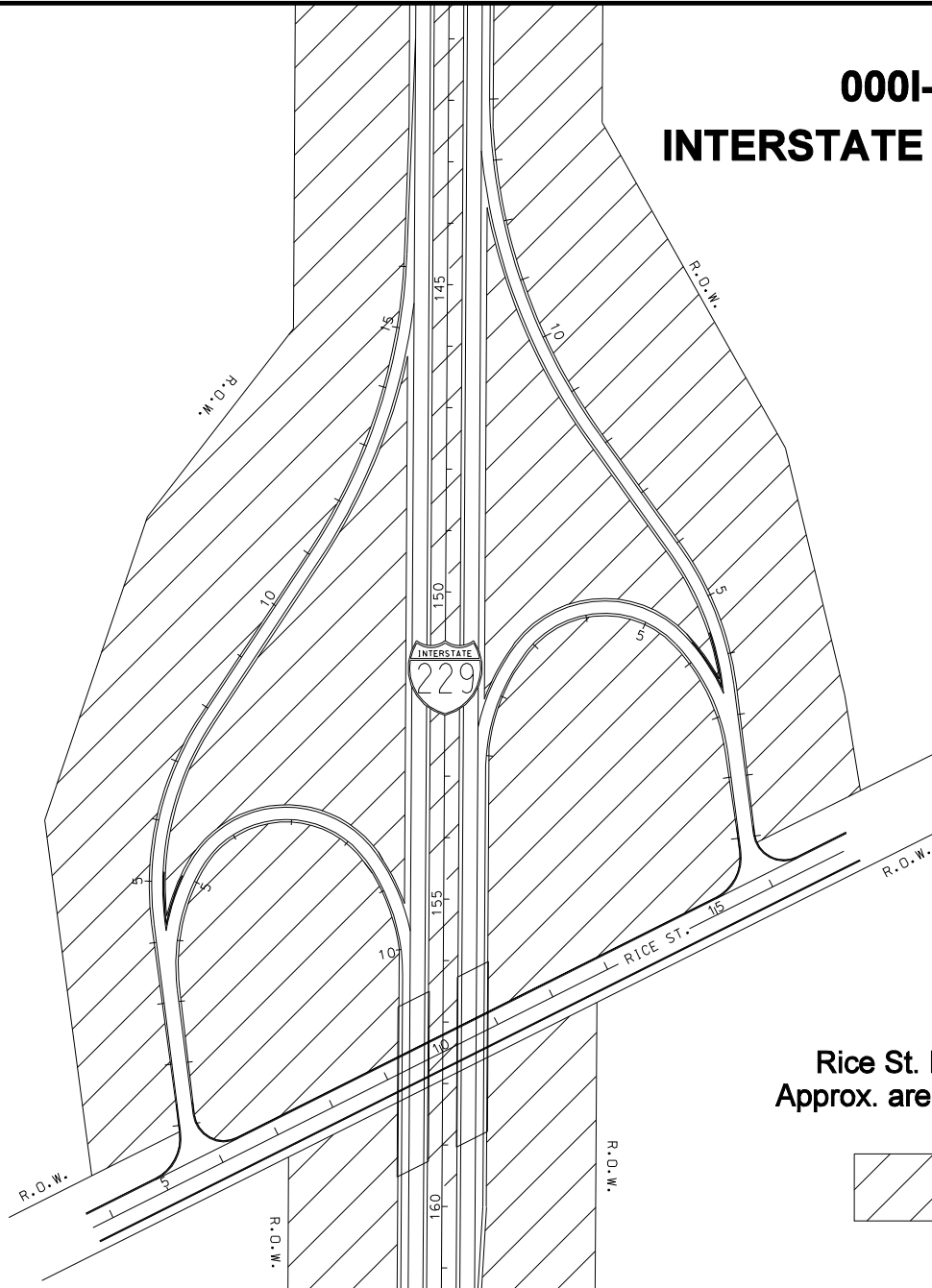

Rice St. I229 Interchange Exit 7
Approx. area within ramps 12.7 Acres



Area to be mowed

000I-271 INTERSTATE 229 MOWING

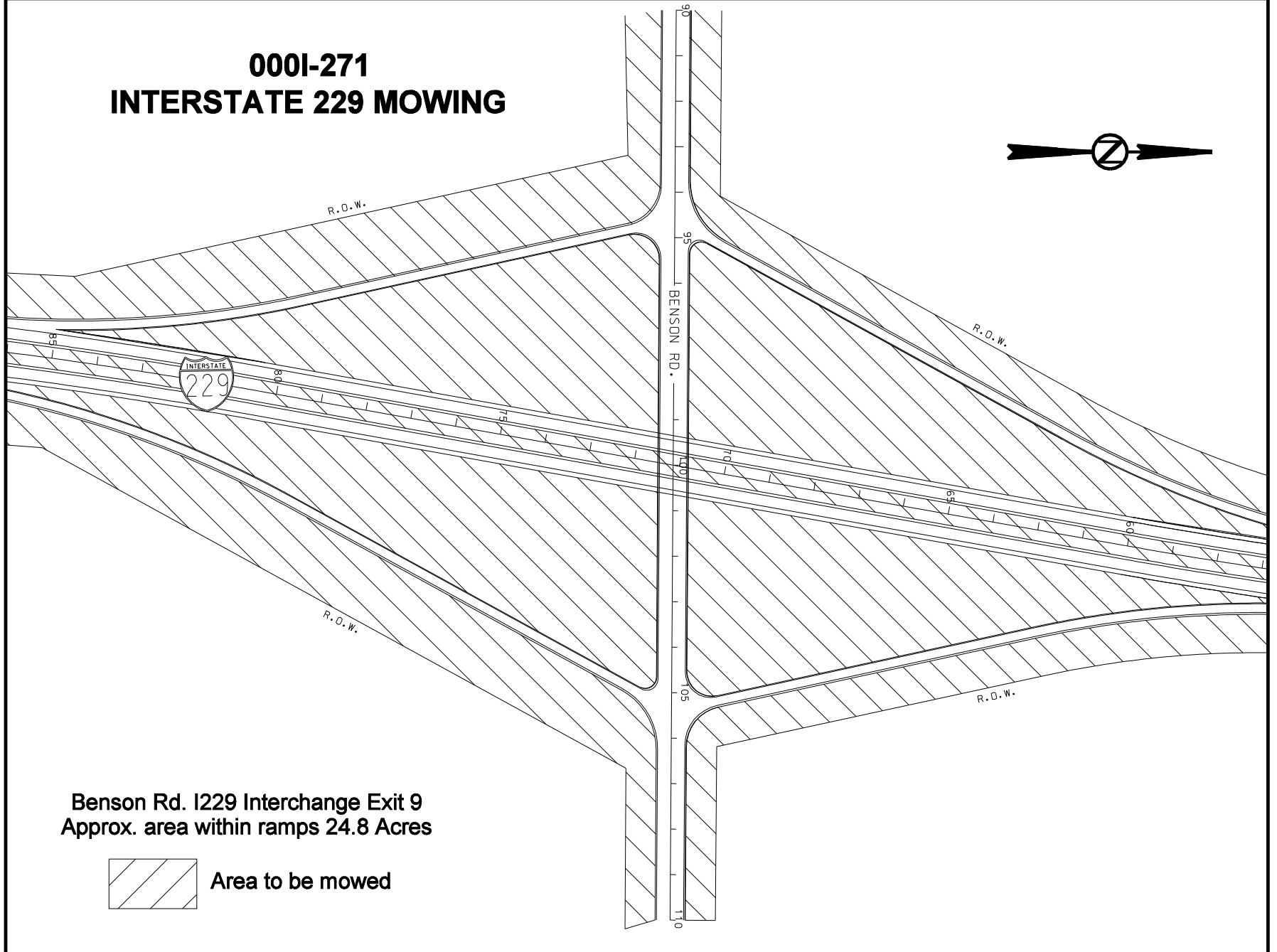

Benson Rd. I229 Interchange Exit 9
Approx. area within ramps 24.8 Acres

 Area to be mowed

Sheet 23 of 24

000I-271 & 000I-272
MINNEHAHA & LINCOLN COUNTIES

0001-271 INTERSTATES 90 & 229 MOWING

0001-271 & 0001-272
MINNEHAHA & LINCOLN COUNTIES

Sheet 24 of 24

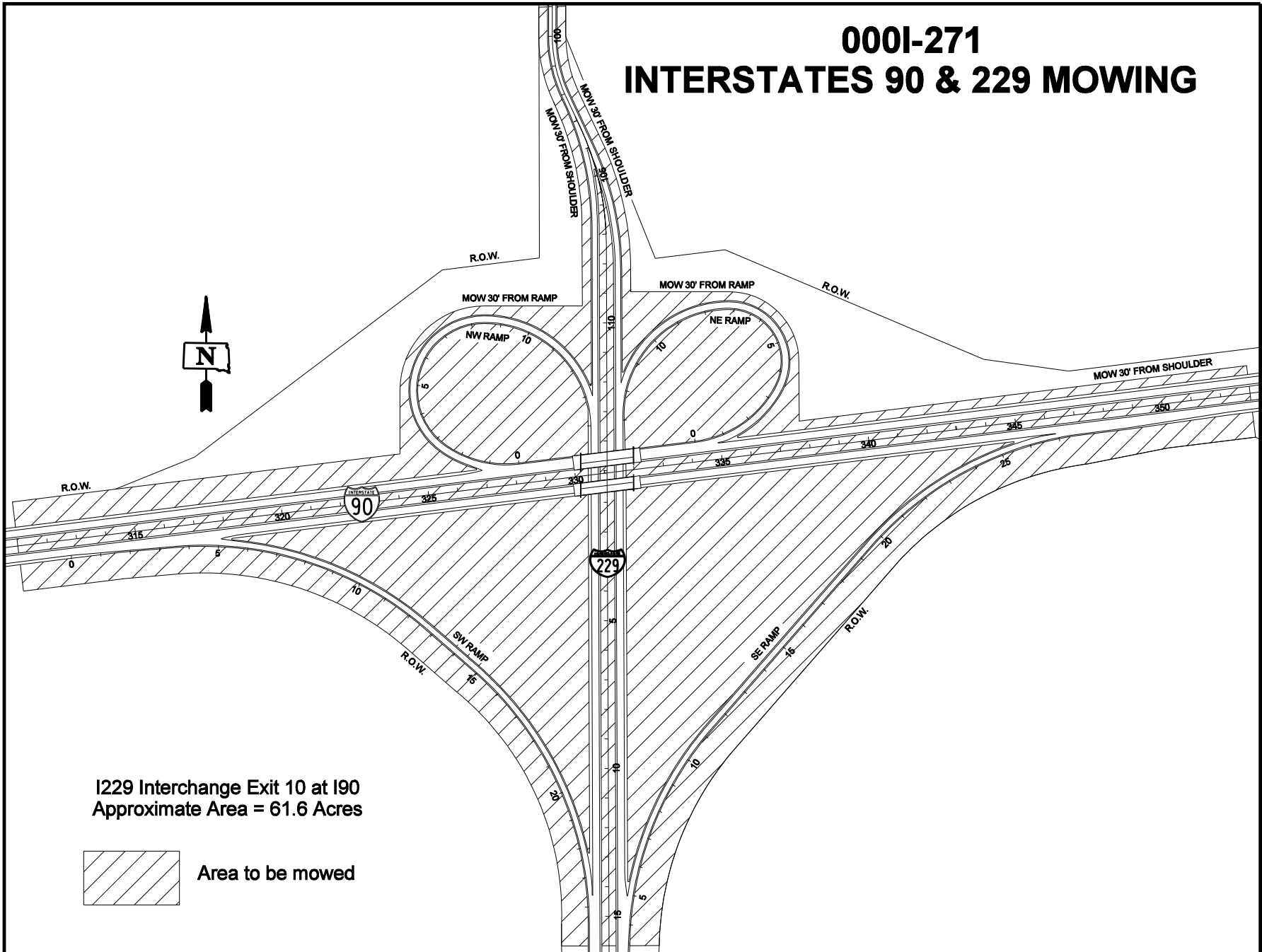

I229 Interchange Exit 10 at I90
Approximate Area = 61.6 Acres



Area to be mowed