

0001-252 DAVISON COUNTY CHAIN LINK FENCE PCN 10LM

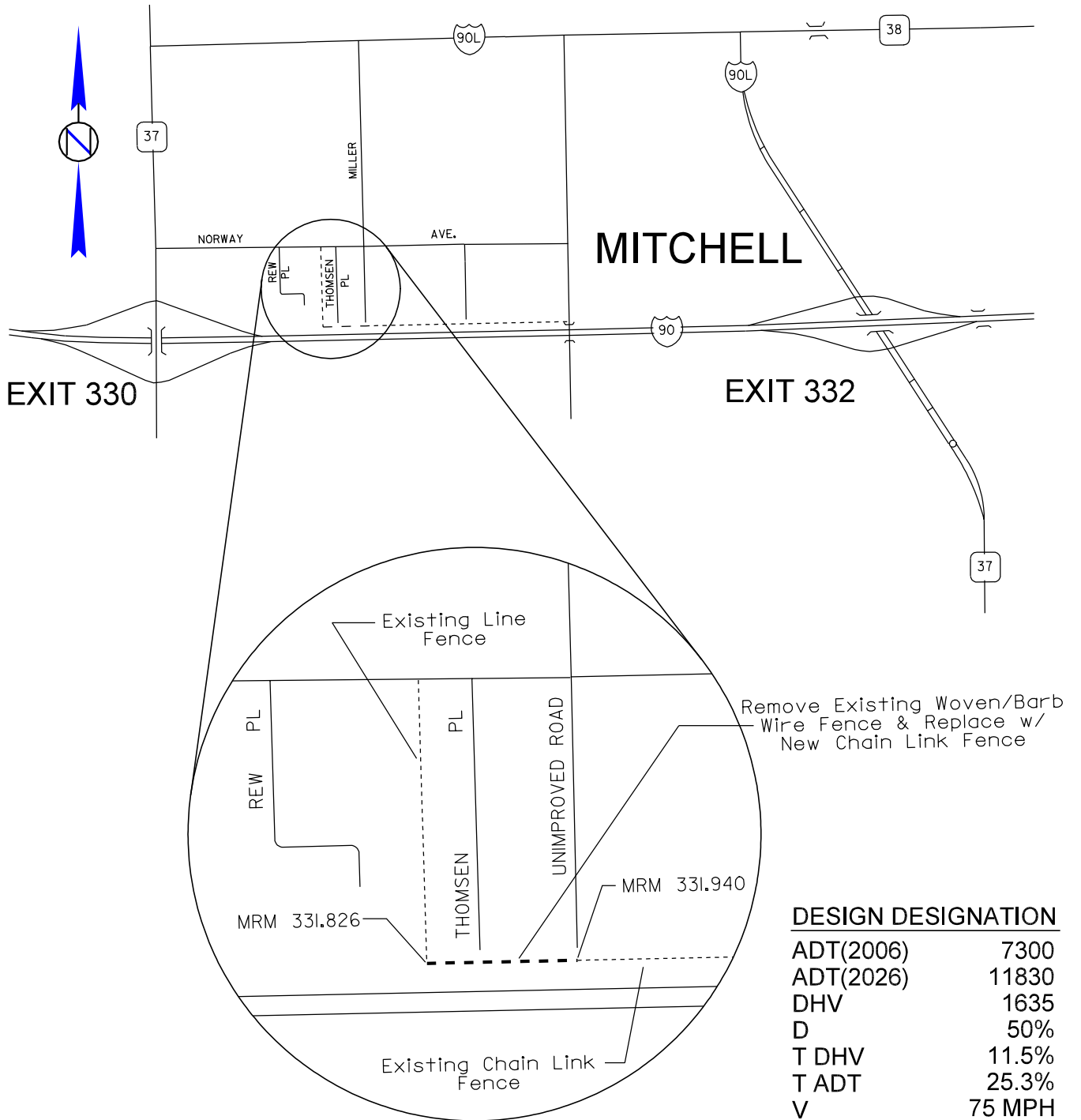

**0001-252
DAVISON COUNTY**

INDEX OF PLAN SHEETS

Sheet 1	Layout Map
Sheet 2	Index of Plan Sheets
Sheet 3	Estimate of Quantities
Sheets 4 and 5	Plan Notes
Sheet 6	Traffic Control
Sheets 7 and 8	Details for Chain Link Fence

0001-252
DAVISON COUNTY

ESTIMATE OF QUANTITIES

BID ITEM NUMBER	ITEM	QUANTITY	UNIT
009E0010	Mobilization	Lump Sum	LS
100E0100	Clearing	Lump Sum	LS
110E0600	Remove Fence	600	Ft
621E0060	6' Chain Link Fence with Top Rail	600	Ft
634E0120	Traffic Control Miscellaneous	Lump Sum	LS

**0001-252
DAVISON COUNTY**

SPECIFICATIONS

Standard Specifications for Roads and Bridges, 2004 Edition and Required Provisions, Supplemental Specifications and/or Special Provisions as included in the Proposal.

COMPLETION DATE

All work shall be completed on or before November 2, 2007.

Liquidated damages, as specified in Section 8.7 of the Standard Specifications, will be assessed for failure to meet the completion date.

UTILITIES

The Contractor shall contact the involved utility companies through South Dakota One Call (1-800-781-7474) prior to starting work. It shall be the responsibility of the Contractor to coordinate work with the utility owners to avoid damage to existing facilities.

COORDINATION BETWEEN CONTRACTORS

A separate contract for Project Nos. 090 E-253 – PCN I0M1, 090 W-253 – PCN I0M2, 090 E-252 – PCNs I0M3 & I0M5 & 090 W-252 PCNs I0M4 & I0M6 will be awarded to another Contractor for concrete pavement repair on I-90 from MRM 296 to MRM 380.

The Contractor shall schedule his work so as not to interfere with or hinder the progress of the work performed by other Contractors on the concrete pavement repair project.

WASTE DISPOSAL SITE

The Contractor will be required to furnish a site(s) for the disposal of construction/demolition debris generated by this project.

All construction/demolition debris generated by this project shall be cleaned up and disposed of by the Contractor.

The waste disposal site(s) shall be managed and reclaimed in accordance with the following from the General Permit for Highway, Road, and Railway Construction/Demolition Debris Disposal Under the South Dakota Waste Management Program issued by the Department of Environment and Natural Resources.

The waste disposal site(s) shall not be located in a wetland, within 200 feet of surface water, or in an area that adversely affects wildlife, recreation, aesthetic value of an area, or any threatened or endangered species, as approved by the Engineer.

If the waste disposal site(s) is located such that it is within view of any ROW, the following additional requirements shall apply:

1. Construction/demolition debris consisting of concrete, asphalt concrete, or other similar materials shall be buried in a trench completely separate from wood debris. The final cover over the construction/demolition debris shall consist of a minimum of 1 foot of soil capable of supporting vegetation. Waste disposal sites provided outside of the State ROW shall be seeded in accordance with Natural Resources Conservation Service recommendations. The seeding recommendations may be obtained through the appropriate County NRCS Office. The Contractor shall control the access to waste disposal sites not within the State ROW through the use of fences, gates, and placement of a sign or signs at the entrance to the site stating No Dumping Allowed.
2. Concrete and asphalt concrete debris may be stockpiled within view of the ROW for a period of time not to exceed the duration of the project. Prior to project completion, the waste shall be removed from view of the ROW or buried and the waste disposal site reclaimed as noted above.

The above requirements will not apply to waste disposal sites that are covered by an individual solid waste permit as specified in SDCL 34A-6-58, SDCL 34A-6-1.13, and ARSD 74:27:10:06.

Failure to comply with the requirements stated above may result in civil penalties in accordance with South Dakota Solid Waste Law, SDCL 34A-6-1.31.

Cost for furnishing waste disposal site(s), disposing of waste, maintaining control of access (fence, gates & signs) and reclamation of the waste disposal site(s) shall be incidental to the contract unit prices for the various items.

**0001-252
DAVISON COUNTY**

RESTORATION OF INSLOPES AND DITCHES

Any slope area or ditch that is rutted or otherwise unduly disturbed during fencing operations shall be restored and seeded by the Contractor, at no expense to the State. Cost for this work shall be incidental to the contract unit prices for the various items.

REMOVE ROW (WOVEN/BARB WIRE) FENCE

The removal and replacement of fence is along the north ROW of I-90 WB between MRM 331.826 and 331.940.

The Contractor shall remove the existing ROW fence that is to be replaced as designated in the plans and/or as ordered by the Engineer.

CLEARING

Prior to installing right-of-way fence, the fence alignment shall be cleared of all trees, tree branches, tree stumps, brush, vegetation, debris, bladed and leveled to the satisfaction of the Engineer. Sod cleared from the fence alignment may be disposed on the interstate ditch back slope. Lumps or clods over 3 inches in diameter shall be broken up.

Clearing will be paid for at the contract lump sum price. Payment shall be full compensation for labor and equipment necessary to clear the entire line for fence and smooth ground irregularities.

FENCE ALIGNMENT

Where fence is being removed and replaced, fence shall be installed on the same alignment as existing. It shall be the Contractor's responsibility to preserve the fence alignment.

GENERAL MAINTENANCE OF TRAFFIC

Removing, relocating, covering, salvaging and resetting of permanent traffic control devices, including delineation, shall be the responsibility of the Contractor. Cost for this work shall be incidental to the contract unit prices for the various items unless otherwise specified in the plans. Any delineators and signs damaged or lost shall be replaced by the Contractor at no cost to the State.

Storage of vehicles and equipment shall be outside the clear zone and as near as possible to the right-of-way line. Contractor's employees should mobilize at a location off the right-of-way and arrive at the work sites in a minimum number of vehicles necessary to perform the work. Indiscriminate driving and parking of vehicles within the right-of-way will not be permitted. Any damage to the vegetation, surfacing, embankment, delineators and existing signs resulting from such indiscriminate use shall be repaired and/or restored by the Contractor, at no expense to the State, and to the satisfaction of the Engineer.

Cost for traffic control, including signs, shall be included in the contract lump sum price for Traffic Control Miscellaneous.

The signs illustrated are not required if the work space is behind a barrier, more than 2 feet behind the curb, or 15 feet or more from the edge of any roadway.

The signs illustrated shall be used where there are distracting situations; such as: vehicles parked on shoulder, vehicles accessing the work site via the highway, and equipment traveling on or crossing the roadway to perform work operations.

The ROAD WORK AHEAD sign may be replaced with other appropriate signs, such as the SHOULDER WORK sign. The SHOULDER WORK sign may be used for work adjacent to the shoulder.

* If the work space is on a divided highway, an advance warning sign should also be placed on the left side of the directional roadway.

For short term, short duration, or mobile operations, all signs and channelizing devices may be eliminated if a vehicle with an activated flashing or revolving yellow light is used.

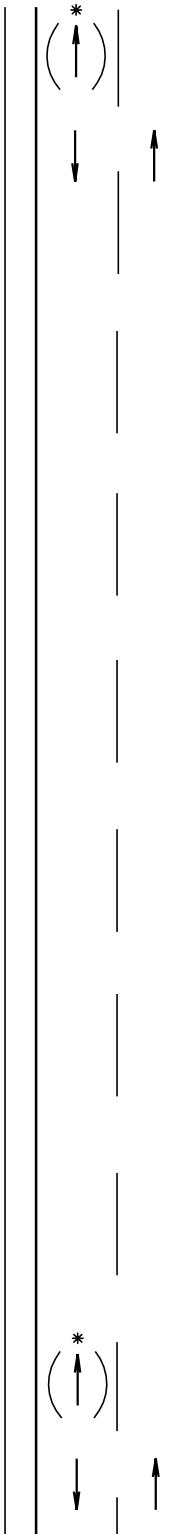

Posted Speed Prior to Work (M.P.H.)	Spacing of Advance Warning Signs (Feet) (A)
0 - 30	200
35 - 40	350
45 - 50	500
55	750
60 - 75	1000

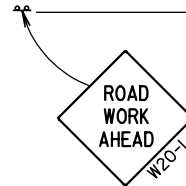

July 1, 2005

Published Date: 1st Qtr. 2007

**S
D
D
O
T**

**GUIDES FOR TRAFFIC CONTROL DEVICES
 WORK BEYOND THE SHOULDER**

PLATE NUMBER
634.01

Sheet 1 of 1

Plotting Date: 14-FEB-2007

Username - TRM11NT51

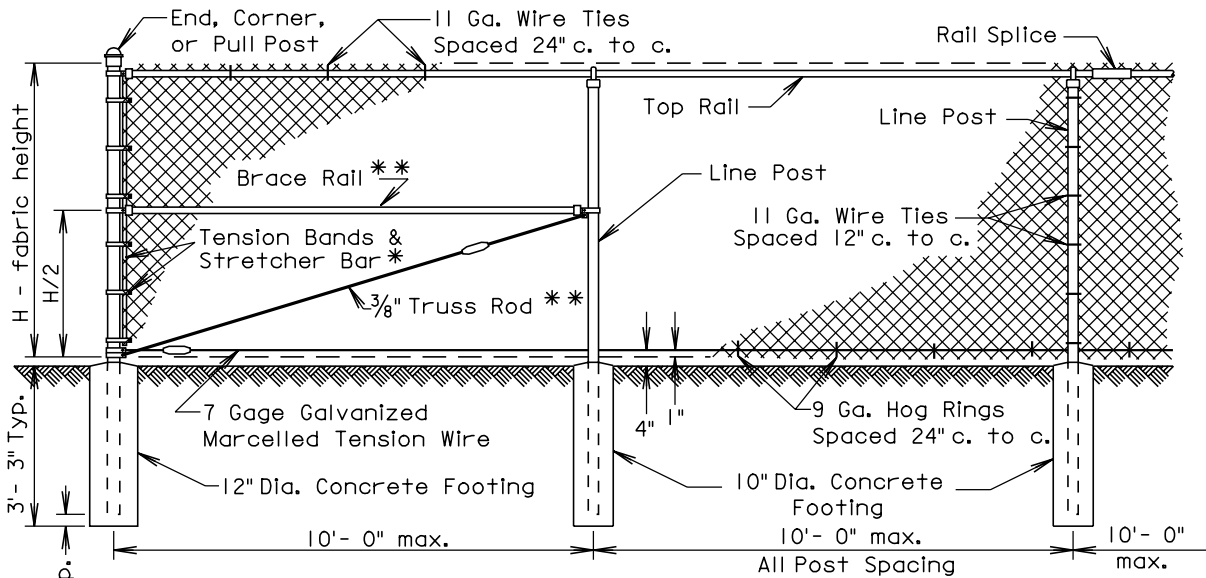

- * Tension Bands shall be spaced 12" c. to c.
- ** Are not required for 3' thru 5' fences.
- Tightening Device such as shown on Plate No. 621.03

Component	End, Corner & Pull Post		Line Post			Top & Brace Rail	
	Round Pipe Nominal	Roll Formed Steel	Round Pipe Nominal	"C" Section	H-Beam Steel	Round Pipe Nominal	Roll Formed Steel
Size	3.00" O. D.	3.5" x 3.5"	2.50" O. D.	1.875"x1.625"	2.25"x1.70"	1.625" O. D.	1.625"x1.25"
Weight (lb. / ft.)	5.79 or 4.64	5.14	3.65 or 3.12	2.34	3.43	2.27 or 1.84	1.35

GENERAL NOTES:

Specific details of manufacture of component parts of the complete fence construction shall be subject to the approval of the Engineer. Commercially available items produced specifically for the use intended shall be used wherever possible in the construction of the fence.

"H" (Height of Fabric) shall be as shown on the Plans. Fabric is available in the the following heights; 36", 42", 48", 60", 72", 84", 96", 108", 120", & 144". Fabric heights 60 inches and under shall be knuckled at both selvages. Fabric heights 72 inches and over shall be knuckled at one selvage and twisted at the other selvage.

Chain Link Fabric shall be 2" mesh, No. 9 gage galvanized wire securely fastened to Tension Wire, Line Post, Rails, Braces and Stretcher Bars spaced as shown hereon.

Fence may be constructed with either Round Pipe, "C" Section, "H" Beam, or roll Formed Steel components as shown in the table above. Line post may be Round Pipe, "C" Section, or "H" Beam. The Corner Post and Rails shall be either Round Pipe or Roll Formed Steel. The type of components used shall have prior approval by the Engineer before construction.

Where fence must cross small bodies of water (such as drainage areas or ponds) that could freeze during the winter, use 11 gage Hog Rings. Provide only two ties per Tension Wire and Top Rail between line posts.

A suitable method of rail splicing shall be used to allow for expansion and contraction while maintaining proper position of the Top Rail.

March 31, 2000

SDOT	CHAIN LINK FENCE WITH TOP RAIL	PLATE NUMBER 621.01
		Sheet 1 of 1

Published Date: 1st Qtr. 2007

Plotting Date: 14-FEB-2007

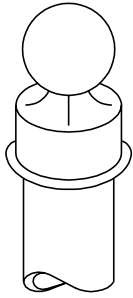

For End, Corner
 and Pull Posts

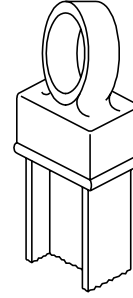
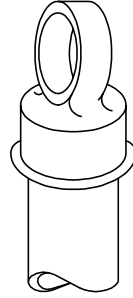
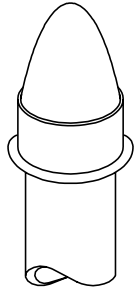

For Line Posts

Typical Post Tops
 (Shown for example only)

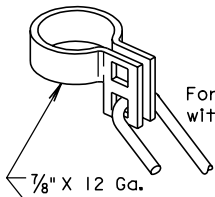

For use
 without Bolt

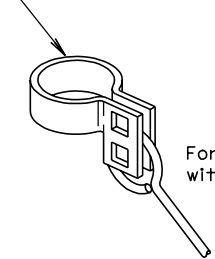

For use
 with Bolt

Brace & Truss Bands

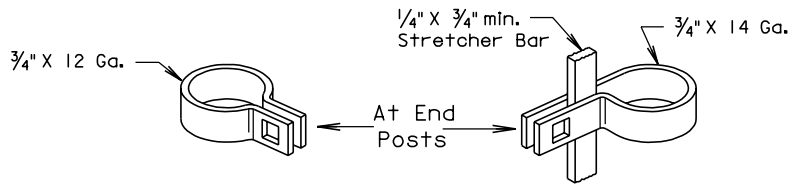

1/4" X 3/4" min.
 Stretcher Bar

3/4" X 12 Ga.

3/4" X 14 Ga.

At End
 Posts

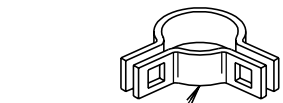

At Corner
 Posts

7/8" X 12 Ga.

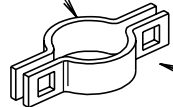

At Line
 Pull Posts

7/8" X 12 Ga.

1" X 11 Ga.

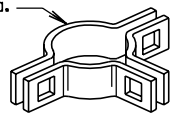

Three Way

Brace Bands

Tension Bands

NOTE: Bands shall be rectangular for
 "C" Section and "H" Beam Posts.

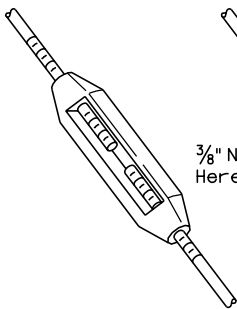

3/8" Turnbuckle

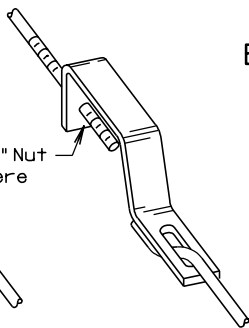

11 Ga. Tightener

Tightening Devices

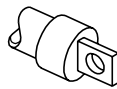

Straight Tip

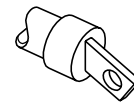

Offset Tip

Rail Ends

March 31, 2000

Published Date: 1st Qtr. 2007

**S
 D
 D
 O
 T**

HARDWARE FOR CHAIN LINK FENCE

**PLATE NUMBER
 621.03**

Sheet 1 of 1

Plotting Date: 14-FEB-2007