

STATE OF SOUTH DAKOTA  
DEPARTMENT OF TRANSPORTATION  
 PLANS FOR PROPOSED

# PROJECT NOS. 3751C, 3763C, 3775C SDDOT HERREID MAINTENANCE YARD, SELBY STOCKPILE SITE, EAGLE BUTTE STOCKPILE SITE CAMPBELL, WALWORTH AND DEWEY COUNTIES

COVER AGGREGATE STOCKPILES

PCN I1Q1, I1Q2 & I1Q3

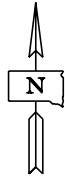
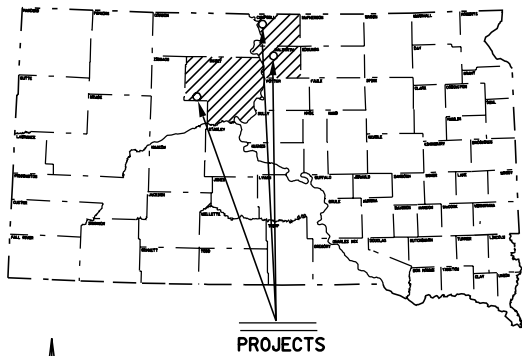

NO SCALE

Herreid Maintenance Yard  
 Stockpile Number 3751C  
 Campbell County  
 (NE1/4 SEC 6 T128N R76W)

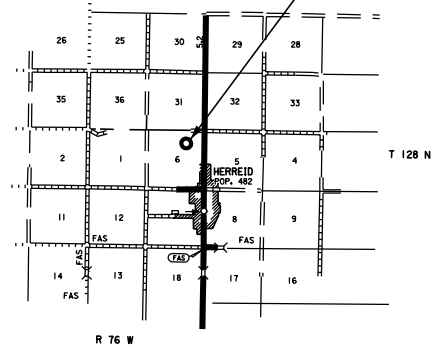

Selby Stockpile Site  
 Stockpile Number 3763C  
 Walworth County  
 (NW1/4 SEC 33 T124N R76W)

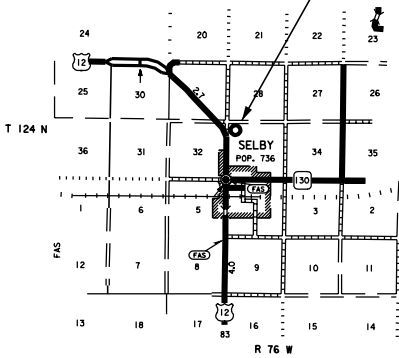

Eagle Butte Stockpile Site  
 Stockpile Number 3775C  
 Dewey County  
 (SW1/4 SEC 12 T12N R23E)

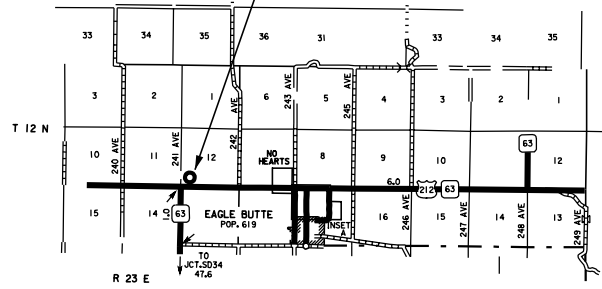

**INDEX OF PLAN SHEETS**

SHEET NO. 1	LAYOUT MAP
SHEET NO. 2	INDEX OF PLAN SHEETS AND ESTIMATE OF QUANTITIES
SHEET NO. 3	SPECIFICATIONS & NOTES
SHEET NO. 4	STANDARD PLATES

**ESTIMATE OF QUANTITIES**

<b>Bid Item Number</b>	<b>Item</b>	<b>Quantity</b>	<b>Unit</b>
<b>009E0010</b>	<b>Mobilization</b>	<b>LS</b>	<b>Lump Sum</b>
<b>360E1200</b>	<b>Modified Cover Aggregate</b> (Herreid Maintenance Yard) Stockpile # 3751C	<b>3000</b>	<b>Ton</b>
<b>360E1200</b>	<b>Modified Cover Aggregate</b> (1 Mi. N. of Selby on US12-83) Stockpile # 3763C	<b>3000</b>	<b>Ton</b>
<b>360E1200</b>	<b>Modified Cover Aggregate</b> (2 Mi. W. of Eagle Butte, Jct 212-63) Stockpile # 3775C	<b>3000</b>	<b>Ton</b>

## **SPECIFICATIONS**

Standard Specifications for Roads and Bridges, 2004 Edition and Required Provisions, Supplemental Specifications and/or Special Provisions as included in the Proposal.

### **MODIFIED COVER AGGREGATE**

Aggregate for Cover Aggregate shall conform to the following gradation requirements:

Passing a 3/8 Inch Sieve	100%
Passing a No. 4 Sieve	50-95%
Passing a No. 8 Sieve	0-30%
Passing a No. 40 Sieve	0-6%
Passing a No. 200 Sieve	0-3.0%

Aggregate may be crushed or uncrushed.

All other requirements of the Standard Specifications (Section 881) for Type 1B shall apply.

The contract unit price per ton shall include all costs for furnishing and stockpiling the modified cover aggregate.

### **MAINTENANCE OF TRAFFIC**

The Contractor shall furnish and install 48" x 48" TRUCK CROSSING signs, W8-6, to be placed on State or County highways or other well-traveled roadways. The signs shall be located a minimum of 550' in advance of intersections and approaches to the highway where the haul route crosses or turns onto/from the highway. The TRUCK CROSSING signs shall be installed for both directions of traffic travel. The exact number and location of the signs will be determined based on the pit location and haul road approved for use.

The TRUCK CROSSING signs shall be displayed at all times when the haul vehicles are hauling material from the pit to the stockpile site. During non-working hours, the signs shall be covered or removed from view. Hinged signs may be used. There will be no direct payment for the TRUCK CROSSING signs. All costs for furnishing, installation, maintenance and removal of the signs shall be absorbed in the various contract items.

### **HAUL ROADS**

The Contractor shall be responsible for any haul roads used to transport material to the stockpile site. The State will not participate in the cost of restoration of any haul roads used by the Contractor.

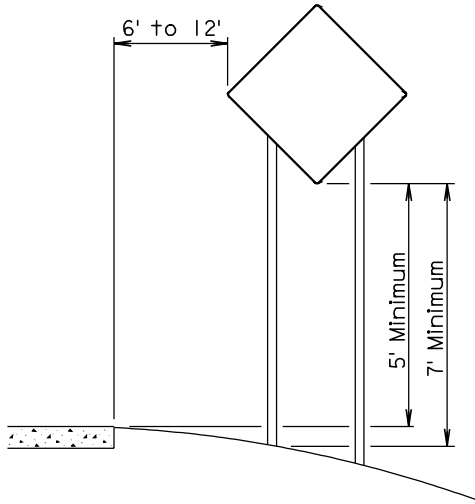

RURAL DISTRICT

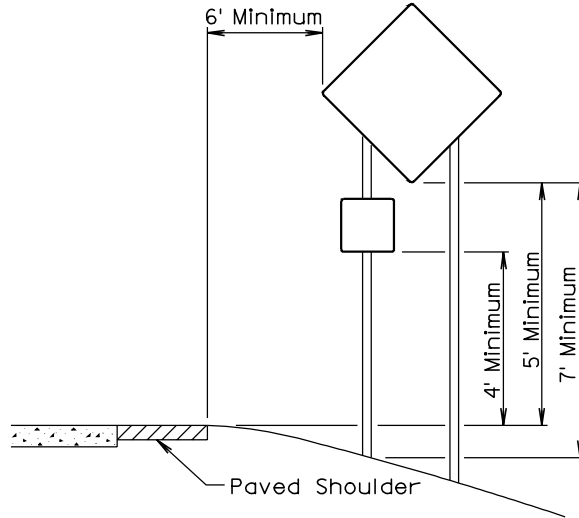

RURAL DISTRICT WITH  
 SUPPLEMENTAL PLATE

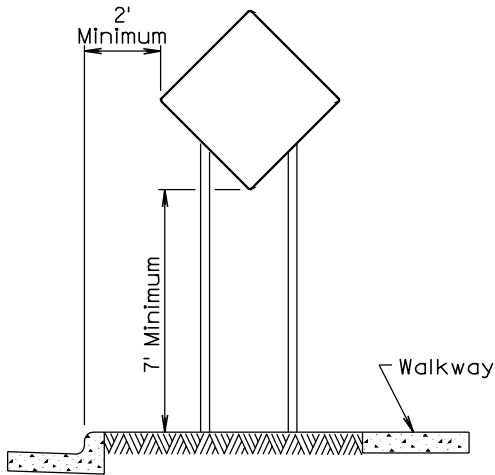

URBAN DISTRICT

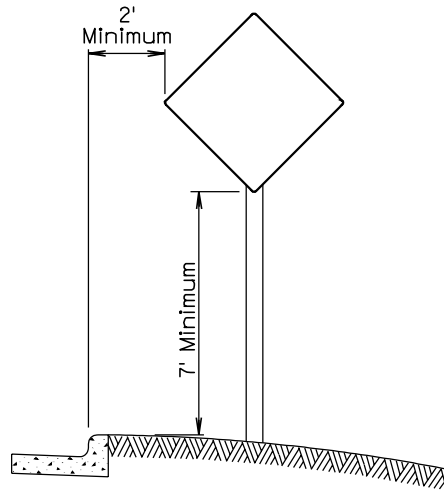

URBAN DISTRICT

Username - trmoint13

December 23, 2003

<p><i>Published Date: 1st Qtr. 2010</i></p>	<p><b>S D D O T</b></p>	<p><b>BREAKAWAY SIGN SUPPORTS</b>                  (Typical Construction Signing)</p>	<p>PLATE NUMBER  <b>634.85</b></p>
			<p>Sheet 1 of 1</p>

Plotting Date: 06-APR-2010