

**2621G**  
**GREGORY COUNTY**  
**GRAVEL SURFACING STOCKPILES**  
**PCN I2GR**

**GREGORY AIRPORT &**  
**SDDOT BONESTEEL MAINTENANCE YARD**

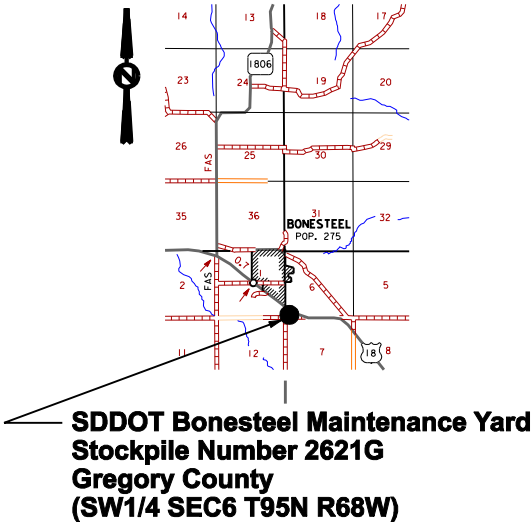

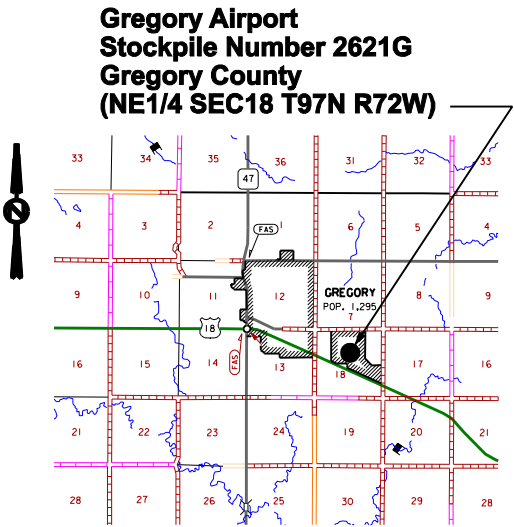
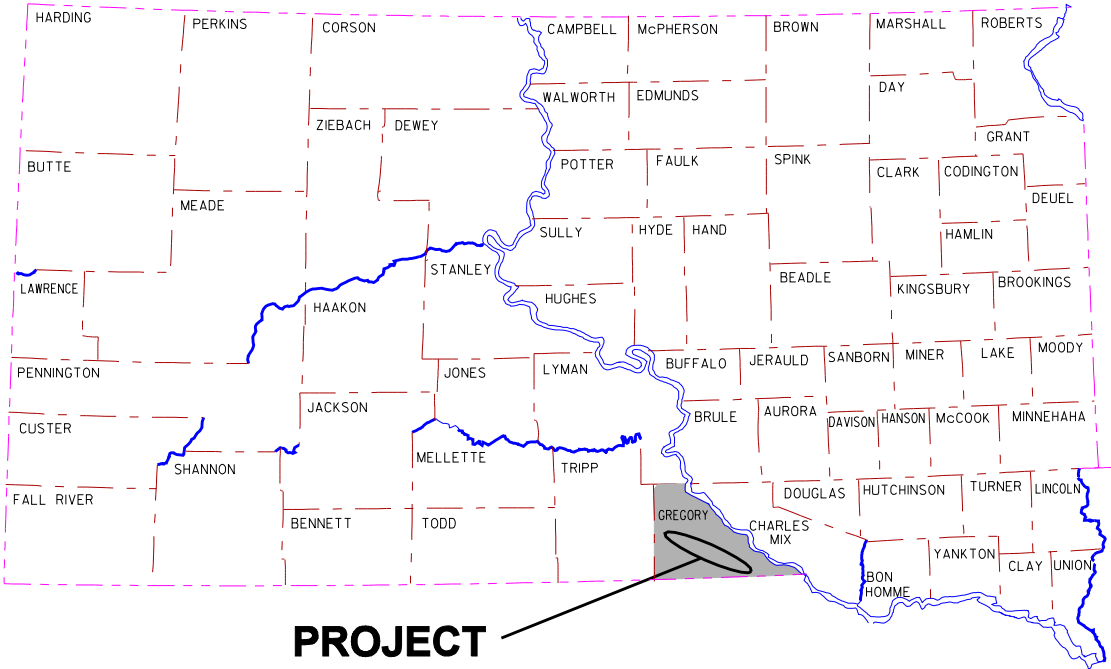

**2621G  
GREGORY COUNTY**

**INDEX OF SHEETS**

|         |   |
|---------|---|
| Sheet 1 | Layout Map                                  |
| Sheet 2 | Index of Sheets &<br>Estimate of Quantities |
| Sheet 3 | Notes                                       |
| Sheet 4 | Standard Plate                              |

**ESTIMATE OF QUANTITIES**

| <b>Bid Item<br/>Number</b> | <b>Item</b>   | <b>Quantity</b> | <b>Unit</b> |
|----------------------------|---|-----------------|-------------|
| 009E0010                   | Mobilization  | 1               | LS          |
| 260E3010                   | Gravel Surfacing (Stockpiled at Gregory Airport)            | 5300            | Ton         |
| 260E3010                   | Gravel Surfacing (Stockpiled at Bonesteel Maintenance Yard) | 4000            | Ton         |

- Gregory Airport is at: 33810 Highway 18, Gregory, SD
- Bonesteel Maintenance Yard is at: 36211 E. Highway 18, Bonesteel, SD



**2621G  
GREGORY COUNTY**

**SPECIFICATIONS**

Standard Specifications for Roads and Bridges, 2004 Edition and Required Provisions, Supplemental Specifications and/or Special Provisions as included in the Proposal.

**CONSTRUCTION**

Prior to construction contact Travis Sparks, Highway Maintenance Supervisor at 605-724-2871 (Armour Shop) or at 605-730-1334 (Cell Phone) for further information in regards to the stockpile locations for the project.

**GRAVEL SURFACING**

Gravel for Gravel Surfacing shall conform to the following gradation requirements:

|                          |           |
|--------------------------|-----------|
| Passing a 3/4 Inch Sieve | 100%      |
| Passing a No. 4 Sieve    | 50-78%    |
| Passing a No. 8 Sieve    | 37-67%    |
| Passing a No. 40 Sieve   | 13-35%    |
| Passing a No. 200 Sieve  | 4.0-15.0% |

All other requirements of the Standard Specifications Section 882 for Gravel Surfacing shall apply.

Cost for furnishing and stockpiling the gravel surfacing shall be included in the contract unit price per ton for Gravel Surfacing.

**MAINTENANCE OF TRAFFIC**

The Contractor shall furnish and install 48" x 48" TRUCK CROSSING signs, W8-6, to be placed on State or County highways or other well-traveled roadways. The signs shall be located a minimum of 550' in advance of intersections and approaches to the highway where the haul route crosses or turns onto/from the highway. The TRUCK CROSSING signs shall be installed for both directions of traffic travel. The exact number and location of the signs will be determined based on the pit location and haul road approved for use.

The TRUCK CROSSING signs shall be displayed at all times when the haul vehicles are hauling material from the pit to the stockpile site. During nonworking hours, the signs shall be covered or removed from view. Hinged signs may be used. There will be no direct payment for the TRUCK CROSSING signs. Cost for furnishing, installing, maintaining and removing the signs shall be incidental to the contract unit prices for the various items.

**HAUL ROADS**

The Contractor shall be responsible for any haul roads used to transport material to the stockpile site. The State will not participate in the cost of restoration of any haul roads used by the Contractor.



**2621G  
GREGORY COUNTY**

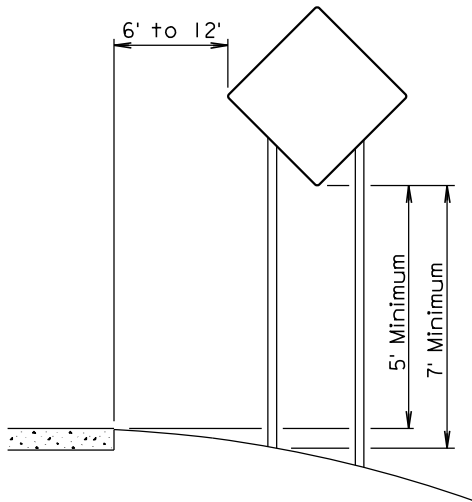

**RURAL DISTRICT**

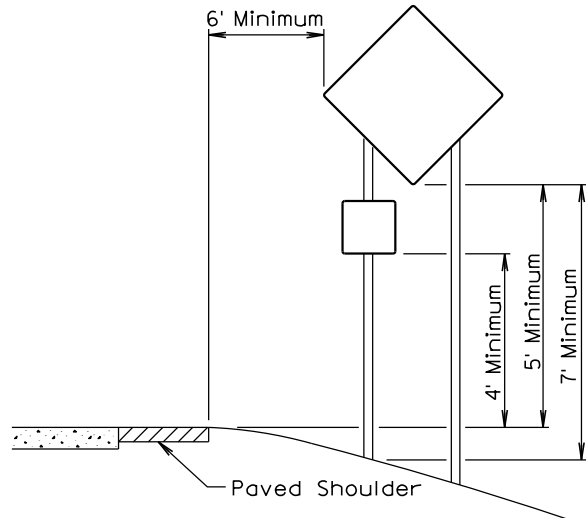

**RURAL DISTRICT WITH  
SUPPLEMENTAL PLATE**

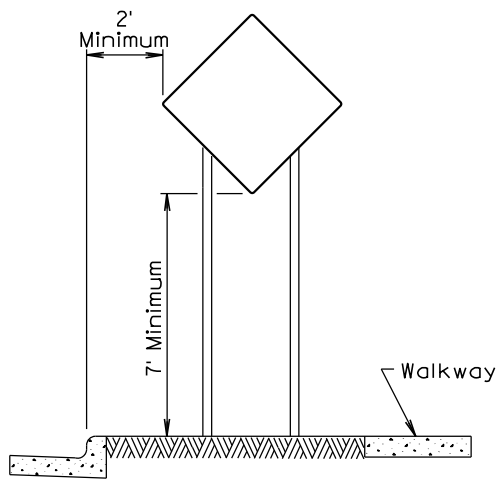

**URBAN DISTRICT**

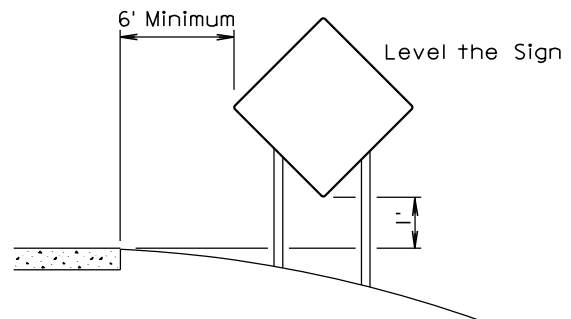

**RURAL DISTRICT  
3 DAY MAXIMUM**

February 14, 2011

*Published Date: 1st Qtr. 2012*

**S  
D  
D  
T**

**CRASHWORTHY SIGN SUPPORTS  
(Typical Construction Signing)**

**PLATE NUMBER  
634.85**

*Sheet 1 of 1*