

Department of Transportation

Mitchell Region Office

PO Box 1206
Mitchell, SD 57301-7206 605/995-8129
FAX: 605/995-8135

September 5, 2013

June Hansen
Civil Rights Officer
Department of Transportation
700 Broadway Avenue East
Pierre, South Dakota 57501

RE: 000I-291, Union County – PCN I36Y, I37A & I37B
2013-2014 – PCN I36Y, 2014-2015 – PCN I37A & 2015-2016 – PCN I37B
I29 in the Dakota Dunes, North Sioux City and Jefferson Areas from MRM 0.0 to MRM 14.0

June,

Enclosed are a Contract Proposal and plans for the above referenced project that is being let to contract by the informal bidding procedure in the Mitchell Region on **September 26, 2013**.

If you know of any interested Contractors, please advise us.

Very truly yours,

DEPARTMENT OF TRANSPORTATION
Craig Smith, Region Engineer

Monte D. Rice, Region Design Engineer

cc: Humphrey – Construction and Maintenance
Peterson/Gall – Yankton Area

NOTICE TO CONTRACTORS

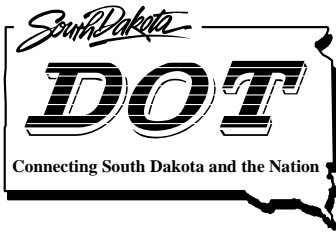

Department of Transportation

Mitchell Region Office

PO Box 1206
Mitchell, SD 57301-7206 605/995-8129
FAX: 605/995-8135

September 5, 2013

TO: Interested Bidders

RE: 000I-291, Union County – PCN I36Y, I37A & I37B
2013-2014 – PCN I36Y, 2014-2015 – PCN I37A & 2015-2016 – PCN I37B
I29 in the Dakota Dunes, North Sioux City and Jefferson Areas from MRM 0.0 to MRM 14.0

The South Dakota Department of Transportation (SDDOT) desires to solicit bids for Night Winter Road Inspection and Snow & Ice Control Services on I29 in the Dakota Dunes, N. Sioux City and Jefferson Areas (I29 MRM 0.0 to MRM 14.0). Refer to the proposal and plans (in the link below) for location and details of the work to be done.

A Contract Proposal (DOT 123) form and an Equipment Data Sheet are enclosed for submission of your bid. Be sure to have the Contract Proposal signed and notarized as indicated. FAX bids will not be accepted.

The DOT in accordance with Title VI of the Civil Rights Act of 1964, 78 Stat. 252, 42 U.S.C. 2000d to 2000d-4 and Title 49, Code of Federal Regulations, Department of Transportation, Subtitle A, Office of the Secretary, Part 21, Nondiscrimination in Federally-assisted programs of the Department of Transportation issued pursuant to such Act, hereby notifies all bidders that it will affirmatively insure that in any contract entered into pursuant to this advertisement, minority business enterprises will be afforded full opportunity to submit bids in response to this invitation and will not be discriminated against on the grounds of race, color, religion, national origin, sex, age or disability in consideration for an award.

A Special Provision for Fuel Cost Adjustment is included in the Proposal. The successful bidder will need to submit the DOT-208 Fuel Adjustment Affidavit (Attachment A) prior to the contract being awarded; therefore, all bidders are encouraged to submit the Fuel Adjustment Affidavit prior to or at the time of bidding.

The contract unit price bid per each for Mobilization 1, 2 or 3 shall not exceed \$2,000 (\$6,000 total).

If you submit a bid for this project, a bid bond, certified check, cashier's check, or bank draft will be required for NOT LESS THAN FIVE (5) PERCENT OF THE TOTAL AMOUNT OF THE BID. If an electronic bid bond is used, the Contractor is required to submit the bid bond identification number with the bid. Except for the lowest bidder on the project, all guarantees will be returned immediately following the receipt and checking of all bids.

A Certificate of Insurance will be required from the successful bidder prior to beginning work.

All bid proposals must be returned in the enclosed self-addressed envelope to Craig Smith, Region Engineer, 1300 S. Ohlman St., Post Office Box 1206, Mitchell, South Dakota 57301-7206 before **1:30 P.M. on Thursday, September 26, 2013.**

Proposal and Plans (and Addenda, when applicable) can be accessed at the following link: <http://sddot.com/business/contractors/bid/region/Default.aspx>. It is the Contractor's responsibility to obtain the proposal, plans and any addenda pertaining to this contract prior to submitting a bid. Addenda, if and when applicable to this contract, will be posted on this website with the contract.

Questions regarding the plans and/or proposal should be directed to:
[Ron Peterson \(Ext. 101\)](#) or [Rodney Gall \(Ext. 102\)](#) at 605 668-2931 or [Monte Rice](#) at 605-995-3302.

The SDDOT reserves the right to reject any or all bids.

Please verify that all required information is complete prior to mailing bid documents.

Very truly yours,
DEPARTMENT OF TRANSPORTATION
Craig Smith, Region Engineer

Monte D. Rice, Region Design Engineer

cc: Humphrey – Construction and Maintenance
Hansen – Civil Rights
Peterson/Gall – Yankton Area

**SOUTH DAKOTA DEPARTMENT OF TRANSPORTATION
CONTRACT PROPOSAL**

DOT-123
(5/05)
1 of 2

CODE	PROJECT			MAINT UNIT	CONTROL REFERENCE	AFE	FUNCTION	BEGIN MRM	END MRM
	PRE	ROUTE	AGR						
		000I		291		I36Y	2524		
		000I		291		I37A	2524		
		000I		291		I37B	2524		

CITY AND/OR COUNTY: Union County **BUDGET SOURCE:** Contract Maintenance

FINALS ENGINEER REVIEW REQUIRED: YES NO
REGION MATERIALS CERTIFICATION REQUIRED: YES NO
CERTIFIED INSPECTORS/TESTERS REQUIRED: YES NO
TO BE INSTALLED ON CM&P: YES NO

TYPE, PURPOSE AND LOCATION OF WORK: Night Winter Road Inspection and Snow & Ice Control Services on Interstate 29 in the Dakota Dunes, North Sioux City and Jefferson Areas. Involves inspecting, sanding and plowing of the interstate, ramps and crossroads and notifying SDDOT management when road conditions require additional winter maintenance. I29 MRM 0.0 to 14.0.

ESTIMATE OF QUANTITIES AND COST

BID ITEM NUMBER	ITEM	QUANTITY	UNIT	UNIT PRICE	AMOUNT
009E0197	Mobilization 1	1	Each		
900E2400	Winter Road Inspection	60	Hour		
900E2402	Standby Time	20	Hour		
900E2410	Sanding Road	20	Hour		
900E2418	Snow Plowing and Sanding Road	50	Hour		
900E2420	Snow Plowing	75	Hour		
SUBTOTAL FOR		2013 - 2014 PCN I36Y			
009E0198	Mobilization 2	1	Each		
900E2400	Winter Road Inspection	60	Hour		
900E2402	Standby Time	20	Hour		
900E2410	Sanding Road	20	Hour		
900E2418	Snow Plowing and Sanding Road	50	Hour		
900E2420	Snow Plowing	75	Hour		
SUBTOTAL FOR		2014 - 2015 PCN I37A			
009E0199	Mobilization 3	1	Each		
900E2400	Winter Road Inspection	60	Hour		
900E2402	Standby Time	20	Hour		
900E2410	Sanding Road	20	Hour		
900E2418	Snow Plowing and Sanding Road	50	Hour		
900E2420	Snow Plowing	75	Hour		
SUBTOTAL FOR		2015 - 2016 PCN I37B			
TOTAL					

The Department of Transportation reserves the right to terminate this contract based on unsatisfactory performance by the Contractor. The Department will continually monitor the Contractor's performance during the duration of this agreement. Should the Department desire to terminate the contract, the Contractor shall be notified in writing.

Also, it is understood and agreed that funding for this agreement is dependent upon future appropriations of the South Dakota Legislature. In the event sufficient funding is not available, the State may terminate this agreement.

**SOUTH DAKOTA DEPARTMENT OF TRANSPORTATION
CONTRACT PROPOSAL**

DOT-123
(5/05)
2 of 2

CODE	PROJECT			MAINT UNIT	CONTROL REFERENCE	AFE	FUNCTION	BEGIN MRM	END MRM
	PRE	ROUTE	AGR						
		000I		291		I36Y	2524		
		000I		291		I37A	2524		
		000I		291		I37B	2524		

CONTRACTOR'S PROPOSAL STATEMENT

The undersigned does hereby agree to furnish the labor and/or material in the quantities, at the unit price, for the purpose, in the place and in accordance with attached provisions upon approval of this Proposal by the State Transportation Commission. This document becomes the Contract when signed by the Contractor and a Department of Transportation Representative. The Contractor agrees to provide services in compliance with the Americans with Disabilities Act of 1990. The Contractor agrees to provide a certificate of insurance prior to commencing work, for liability coverage for the duration of the work as per the current edition of the SDDOT Standard Specifications for Roads and Bridges.

PROPOSED START DATE _____

OVERALL COMPLETION DATE May 2016

SUBSCRIBED AND SWORN TO BEFORE ME THE

DAY OF _____, 20__

SIGNATURE _____
COMPANY _____
ADDRESS _____

NOTARY - My Commission Expires _____

FEDERAL TAX ID NUMBER _____

RECOMMENDED FOR APPROVAL:

CONSTRUCTION & MAINTENANCE ENGINEER **DATE**

REGION ENGINEER **DATE**

DIRECTOR OF OPERATIONS **DATE**

APPROVED FOR THE TRANSPORTATION COMMISSION

NAME _____ **TITLE** _____ **DATE** _____

APPROVED as per Federal Highway Stewardship Provisions this _____ day of _____, 20__.

PROJECT DEVELOPMENT ENGINEER

EQUIPMENT DATA SHEET

Project: 000I-291 PCN I36Y, I37A & I37B Route: 129

Truck #1 (Required)

Truck Manufacturer _____ Year _____

Plow Manufacturer _____ Size _____ Year _____

Sander Manufacturer _____ Capacity _____ Year _____

Truck #2 (Optional)

Truck Manufacturer _____ Year _____

Plow Manufacturer _____ Size _____ Year _____

Sander Manufacturer _____ Capacity _____ Year _____

Truck #3 (Optional)

Truck Manufacturer _____ Year _____

Plow Manufacturer _____ Size _____ Year _____

Sander Manufacturer _____ Capacity _____ Year _____

RESPONSIBLE INDIVIDUAL(S)

NAME OFFICE PHONE NUMBER CELLULAR PHONE NUMBER

1. _____

2. _____

3. _____

TO BE RETURNED WITH BID PROPOSAL

Attachment A

DOT-208
(09/08)

FUEL ADJUSTMENT AFFIDAVIT

Project Number _____
PCN _____
County _____

For formally let projects (projects let through the South Dakota Electronic Bid System), the Contractor is not required to notify the Department at the time of submitting bids whether he will or will not participate in the fuel cost adjustment program. The Fuel Adjustment Affidavit shall include the anticipated fuel cost of subcontractors.

Does your company elect to participate in a fuel adjustment for this contract for the fuels that do not have a fixed price? No adjustments in fuel prices will be made if "No" is checked.

Yes No

If yes, provide the total dollars for each of the applicable fuels. No adjustments in fuel price will be made for the fuel types that are left blank or completed with a \$0.00 value.

Diesel (x) \$ _____

Unleaded (y) \$ _____

Burner Fuel (z) \$ _____ Type of Burner Fuel Used: _____

Sum (x + y + z) = \$ _____

Note: The sum of the x, y, and z may not exceed 15% of the original contract amount.

The following must be completed regardless of whether the Contractor elects to participate in the fuel adjustment affidavit

Under the penalty of law for perjury or falsification, the undersigned, _____,
(Printed Name)
_____ of _____,
(Title) *(Contractor)*

hereby certifies that the documentation is submitted in good faith, that the information provided is accurate and complete to the best of their knowledge and belief, and that the monetary amount identified accurately reflects the cost for fuel, and that they are duly authorized to certify the above documentation on behalf of the company.

I hereby agree that the Department or its authorized representative shall have the right to examine and copy all Contractor records, documents, work sheets, bid sheets, and other data pertinent to the justification of the fuel costs shown above.

Dated _____ Signature _____

Notarization is required only when the Contractor elects to participate in the fuel adjustment affidavit

Subscribed and sworn before me this _____ day of _____, 20____.

Notary Public

My Commission Expires

**SOUTH DAKOTA
DEPARTMENT OF TRANSPORTATION
MITCHELL REGION**

**PROPOSAL FOR
000I-291
UNION COUNTY
NIGHT WINTER ROAD INSPECTION AND
SNOW & ICE CONTROL SERVICES
2013-2014 - PCN I36Y
2014-2015 - PCN I37A
2015-2016 - PCN I37B**

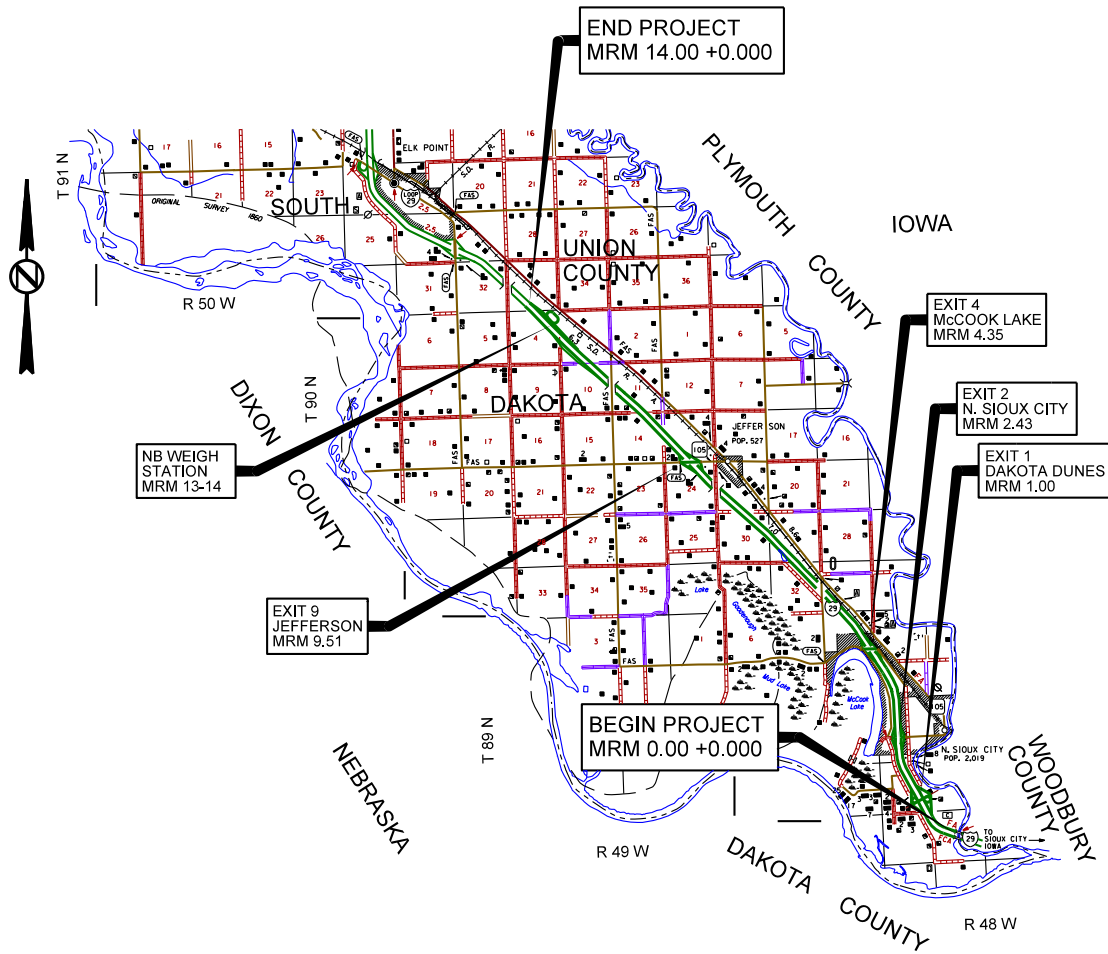

NOTICE TO ALL BIDDERS

TO REPORT BID RIGGING ACTIVITIES, CALL: 1-800-424-9071

THE U.S. DEPARTMENT OF TRANSPORTATION (DOT) OPERATES THE ABOVE TOLL-FREE "HOTLINE" MONDAY THROUGH FRIDAY, 8:00 A.M. TO 5:00 P.M., EASTERN TIME. ANYONE WITH KNOWLEDGE OF POSSIBLE BID RIGGING, BIDDER COLLUSION, OR OTHER FRAUDULENT ACTIVITIES SHOULD USE THE "HOTLINE" TO REPORT SUCH ACTIVITIES.

THE "HOTLINE" IS PART OF THE DOT'S CONTINUING EFFORT TO IDENTIFY AND INVESTIGATE HIGHWAY CONSTRUCTION CONTRACT FRAUD AND ABUSE AND IS OPERATED UNDER THE DIRECTION OF THE DOT INSPECTOR GENERAL.

ALL INFORMATION WILL BE TREATED CONFIDENTIALLY AND CALLER ANONYMITY WILL BE RESPECTED.

* * * *

STATE OF SOUTH DAKOTA
DEPARTMENT OF TRANSPORTATION
SPECIAL PROVISION
FOR
FUEL COST ADJUSTMENT ON INFORMAL CONTRACTS
SEPTEMBER 12, 2008

Delete Section 9.12 of the Standard Specifications for Roads and Bridges and replace with the following:

General

Compensation adjustments for motor fuels and burner fuels consumed in prosecuting the contract shall be determined by the Engineer in accordance with the provisions set forth herein.

Compensation adjustments will be assessed for the cost of the motor fuels and burner fuels whenever the Current Fuel Index (CFI) is outside the range of 85 percent to 115 percent of the Base Fuel Index (BFI). Compensation adjustments for burner fuel will only be made when asphalt concrete bid items are paid for on the estimate.

Bidders are required to notify the Department at the time of submitting bids whether he will or will not participate in the fuel cost adjustment program. The Bidder shall submit the Fuel Adjustment Affidavit - Form DOT-208 to the Department when he submits a bid.

Determination of whether to participate in the Fuel Adjustment program is the decision of the Prime Contractor. If the Prime Contractor decides not to participate, or if he has a fixed fuel cost for any of the fuel types, no compensation adjustments will be made for the subcontractors by the Department. The Fuel Adjustment Affidavit shall include the anticipated fuel cost of subcontractors, if the Prime Contractor chooses to participate in the fuel cost adjustment program. If compensation adjustments are made, the prime contractor shall ensure that all subcontractors including second and lower tier, are included in the adjustments in proportion to the percentage of work and anticipated fuel cost by that subcontractor.

Each week the Department will record the average wholesale price for No. 2 fuel oil (diesel), regular unleaded gasoline, and propane (LPG), Freight On Board (FOB) South Dakota terminals, as listed in the "Oil Price Information Service" (OPIS) publication.

The BFI price for motor fuels and burner fuel to be used in the contract will be the average of the recorded wholesale fuel prices for the four most recent weekly reporting periods prior to the week of the bid letting.

The CFI price for motor fuels and burner fuel to be used for each progress payment will be the average for the recorded wholesale fuel prices for the four most recent weekly reporting periods available at the time when the progress payment is prepared.

Burner fuel adjustment will use the BFI and CFI as determined for No. 2 fuel oil (diesel), except when the contractor lists the burner fuel as propane (LPG) on Form DOT-208, Fuel Adjustment Affidavit. In that case, the BFI and CFI will be as determined for propane (LPG).

Compensation adjustments will not be assessed for fuel items which the contractor has obtained a fixed fuel cost, or if the contractor elects not to participate in fuel adjustments on Form DOT-208, Fuel Adjustment Affidavit. Fixed fuel costs are defined as a fuel cost that has been set and will remain the same for the entire length of the contract.

Compensation adjustments made in accordance with these provisions may be made on progress payments without a prior approved Construction Change Order.

Fuel Cost Percentage Change

The biweekly change in fuel cost percentage will be determined by Equation 1 as follows:

Equation 1

$$Change_{(x, y, z)} = \left(\frac{CFI_{(x, y, z)} - BFI_{(x, y, z)}}{BFI_{(x, y, z)}} \right)$$

- (x) = Motor Fuel (Diesel)
- (y) = Motor Fuel (Unleaded)
- (z) = Burner Fuel

Change_(x, y, z) = Percent change in the respective fuel price compared to the Base Fuel Index Price set for the contract.

CFI_(x, y, z) = Current Fuel Index Price for the respective fuel type (\$\$).

BFI_(x, y, z) = Base Fuel Index Price for the respective fuel type (\$\$).

Contract Fuel Percentage

For the purpose of determining fuel cost adjustment, a percent of contract will be determined for Motor Fuel (Diesel), and Motor Fuel (Unleaded) based on the original

contract prices. Burner Fuel will be adjusted based on the original contract prices of the plant mix asphalt concrete pavement bid items.

The percent of the contract will remain the same throughout the length of the contract. No changes to this percentage will be allowed for any reason. The sum of the individual fuel costs shall not exceed 15% of the Original Contract Cost. The percent of the contract will be determined by Equation 2 as follows:

Equation 2

$$\% \text{ Contract}_{(x, y, z)} = \left(\frac{\text{Affidavit Cost}_{(x, y, z)}}{\text{Original Contract Cost}_{(x, y, z)}} \right) \times 100$$

- (x) = Motor Fuel (Diesel)
- (y) = Motor Fuel (Unleaded)
- (z) = Burner Fuel

- % Contract_(x,y,z) = Percent of contract for each respective fuel item.

- Affidavit Cost_(x,y,z) = Cost from Fuel Adjustment Affidavit (Form DOT-208)

- Original Contract Cost_(x,y) = Total of the original contract bid cost excluding lane rental, and Part B of the bid (when A+B bidding is used), if applicable (\$\$).

- Original Contract Cost_(z) = Total original contract cost for all plant mix asphalt concrete pavement bid items combined, excluding bid items for asphalt binder, hydrated lime, sawing and sealing joints, compaction samples, etc. Only bid items measured by the Ton will be included in the calculation.

Compensation Adjustment

The compensation adjustments will be determined for Motor Fuel (diesel), Motor Fuel (Unleaded), and Burner Fuel separately. The calculation will be based on the current Engineer’s pay estimate, the percent of the contract for each of the respective fuel items, and the portion of the Current Fuel Index price that falls outside the 85 to 115 percent range of the Base Fuel Index price.

When the “Change_(x, y, z)” from Equation 1 is greater than 15%, Equation 3 will be used to determine the compensation adjustment for each item as follows:

Equation 3

$$FCA_{(x,y,z)} = \frac{\% \text{ Contract}_{(x,y,z)}}{100} \times \text{Estimate Cost}_{(x,y,z)} \times (\text{Change}_{(x,y,z)} - 0.15)$$

(x)	=	Motor Fuel (Diesel)
(y)	=	Motor Fuel (Unleaded)
(z)	=	Burner Fuel
$FCA_{(x,y,z)}$	=	Fuel Cost Adjustment for the respective fuel item for the current Engineer's estimate (\$\$).
$\% \text{ Contract}_{(x,y,z)}$	=	Percent of contract for each respective fuel item (from Equation 2).
$\text{Estimate Cost}_{(x,y)}$	=	Amount to be paid on the biweekly pay estimate excluding all pay adjustments made for incentive, disincentive, price adjustments, pay factor adjustments, liquidated damages, and royalties.
$\text{Estimate Cost}_{(z)}$	=	Amount to be paid on the biweekly pay estimate for all plant mix asphalt concrete pavement bid items combined, excluding bid items for asphalt binder, hydrated lime, sawing and sealing joints, compaction samples, all pay adjustments made for incentive, disincentive, price adjustments, pay factor adjustments, liquidated damages, and royalties. Only asphalt concrete bid items measured by the Ton will be included in the calculation.
$\text{Change}_{(x,y,z)}$	=	Change in the respective fuel price compared to the Base Fuel Index price (from Equation 1).

When the “ $\text{Change}_{(x,y,z)}$ ” from Equation 1 is less than -15%, the Equation 4 will be used to determine the compensation adjustment for each item.

Equation 4

$$FCA_{(x,y,z)} = \frac{\% \text{ Contract}_{(x,y,z)}}{100} \times \text{Estimate Cost}_{(x,y,z)} \times (\text{Change}_{(x,y,z)} + 0.15)$$

(x)	=	Motor Fuel (Diesel)
(y)	=	Motor Fuel (Unleaded)
(z)	=	Burner Fuel

$FCA_{(x,y,z)}$	=	Fuel Cost Adjustment for the respective fuel item for the current Engineer's estimate (\$\$).
% Contract $_{(x,y,z)}$	=	Percent of contract for each respective fuel item (from Equation 2).
Estimate Cost $_{(x,y)}$	=	Amount to be paid on the biweekly pay estimate excluding all pay adjustments made for incentive, disincentive, price adjustments, pay factor adjustments, liquidated damages, and royalties.
Estimate Cost $_{(z)}$	=	Amount to be paid on the biweekly pay estimate for all plant mix asphalt concrete pavement bid items combined, excluding bid items for asphalt binder, hydrated lime, sawing and sealing joints, compaction samples, all pay adjustments made for incentive, disincentive, price adjustments, pay factor adjustments, liquidated damages and royalties. Only asphalt concrete bid items measured by the Ton will be included in the calculation.
Change $_{(x,y,z)}$	=	Change in the respective fuel price compared to the Base Fuel Index price (from Equation1).

Payment

Adjustments will be determined by the Engineer on biweekly progress payments based on when the completed work is paid for, not when the work is completed. Adjustments will be made by utilizing the following lump sum line items: Motor Fuel Cost Adjustment, Diesel; Motor Fuel Cost Adjustment, Unleaded; Burner Fuel Cost Adjustment, Propane; and Burner Fuel Cost Adjustment, Diesel.

* * * * *

For informational purposes, Form DOT-208 follows in Attachment A.

