

STATE OF SOUTH DAKOTA  
 DEPARTMENT OF TRANSPORTATION  
 PLANS FOR PROPOSED

**PROJECT 3971R**

**US18**

**TRIPP COUNTY**

**CLASS A RIPRAP STOCKPILE**

PCN I371

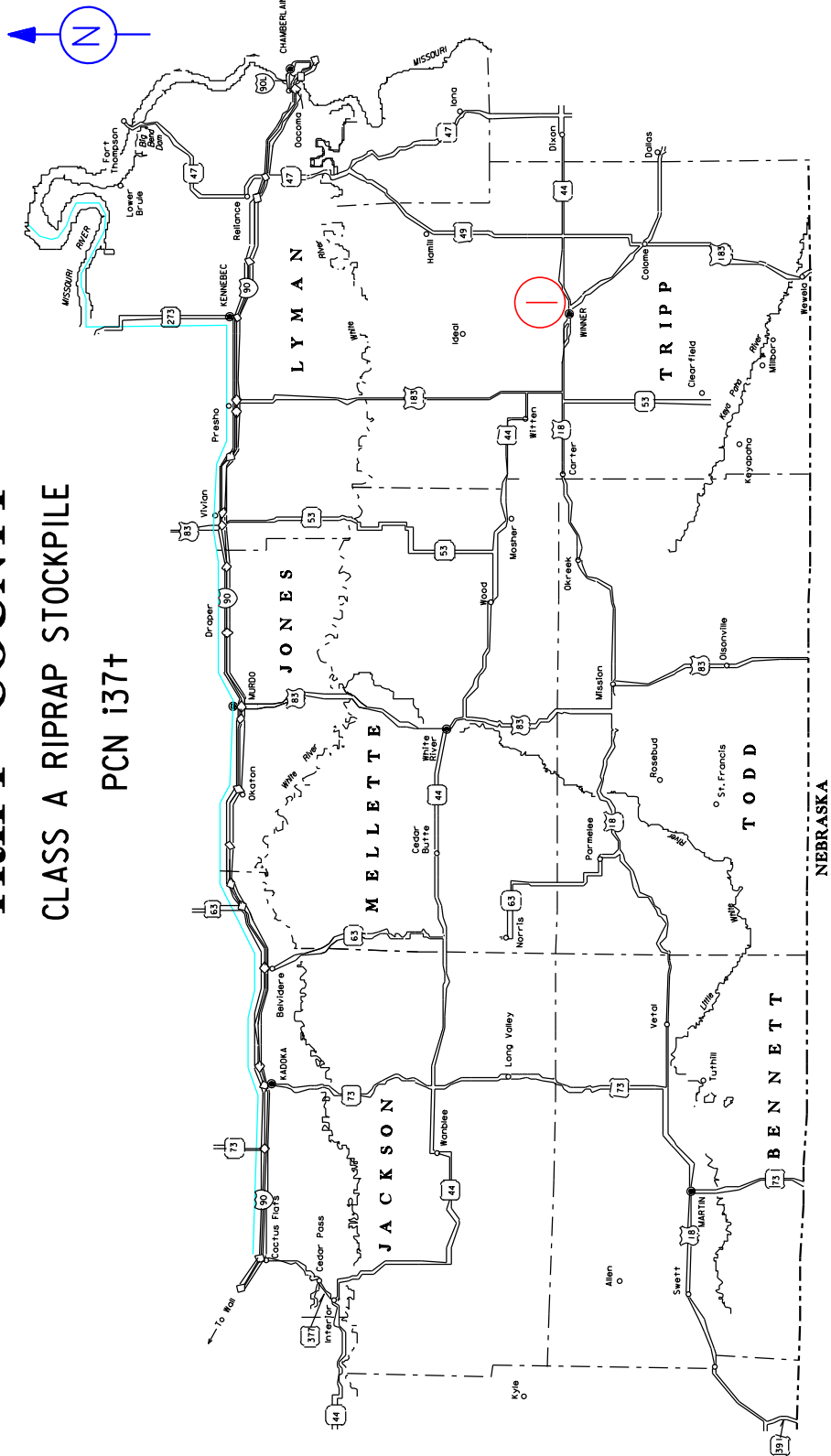

PILE IS DESIGNATED BY A CIRCLED NUMBER AND DESCRIBED ON SUBSEQUENT SHEETS.

① = 3971R

Pile	Stockpile #	PCN	County	Location
1	3971R	i37t	Tripp	Winner Maintenance Yard Legal: SE1/4 SEC 21 T99N R76W

## INDEX OF PLAN SHEETS

SHEET NOS. 1 AND 2	LAYOUT MAP & LOCATION DESCRIPTION FOR CLASS A RIPRAP STOCKPILE
SHEET NO. 3	INDEX OF PLAN SHEETS AND ESTIMATE OF QUANTITIES
SHEET NO. 4	SPECIFICATIONS & NOTES

---

## ESTIMATE OF QUANTITIES

### PCN I37T – Stockpile 3971R

Bid Item Number	Item	Quantity	Unit
009E0010	Mobilization	Lump Sum	LS
700E0110	Class A Riprap	500.0	Ton

## **SPECIFICATIONS**

Standard Specifications for Roads and Bridges, 2004 Edition and Required Provisions, Supplemental Specifications and/or Special Provisions as included in the Proposal.

## **STOCKPILE CONSTRUCTION**

The Contractor is responsible for contacting the following person prior to stockpile construction:

Gregg Ulmer, Highway Maintenance Supervisor, at 842-0810

The Contractor shall find out the exact location to place the stockpile at each site and also the desired shape of the finished stockpile. If the shape and location are not done properly as per the Maintenance Supervisors instructions, the Contractor will be held accountable to correct the stockpile before any payment of materials is made.

## **CLASS A RIPRAP**

Class A riprap shall conform to the requirements of the Standard Specifications (Section 830) and shall be furnished by the Contractor.

The contract unit price per ton shall include all costs for furnishing and stockpiling the Class A riprap.

## **MAINTENANCE OF TRAFFIC**

The Contractor shall furnish and install 48" x 48" TRUCK CROSSING signs, W8-6, to be placed on State or County highways or other well-traveled roadways. The signs shall be located a minimum of 550' in advance of intersections and approaches to the highway where the haul route crosses or turns onto/from the highway. The TRUCK CROSSING signs shall be installed for both directions of traffic travel. The exact number and location of the signs will be determined based on the pit location and haul road approved for use.

The TRUCK CROSSING signs shall be displayed at all times when the haul vehicles are hauling material from the pit to the stockpile site. During non-working hours, the fixed signs shall be covered and the portable signs shall be removed from view. Hinged signs may be used.

There will be no direct payment for the TRUCK CROSSING signs. All costs for furnishing, installing, maintaining and removing the signs shall be incidental to other contract items.