

STATE OF SOUTH DAKOTA	PROJECT	SHEET	TOTAL SHEETS
	410C281	1	5

Plotting Date: 02/26/2014

STATE OF SOUTH DAKOTA
DEPARTMENT OF TRANSPORTATION

PLANS FOR PROPOSED
PROJECT 410C281
MARTIN MAINTENANCE YARD
BENNETT COUNTY

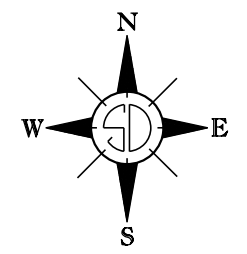

ASPHALT CONCRETE SURFACING/RESURFACING

PCN i3ca

INDEX OF SHEETS

- | | |
|----------------|---------------------------|
| Sheet No. 1 | Title Sheet |
| Sheet No. 2 | Martin Yard Layout Map |
| Sheet No. 3 | Estimate of Quantities |
| Sheet Nos. 3-4 | Environmental Commitments |
| Sheet No. 5 | Plan Notes |

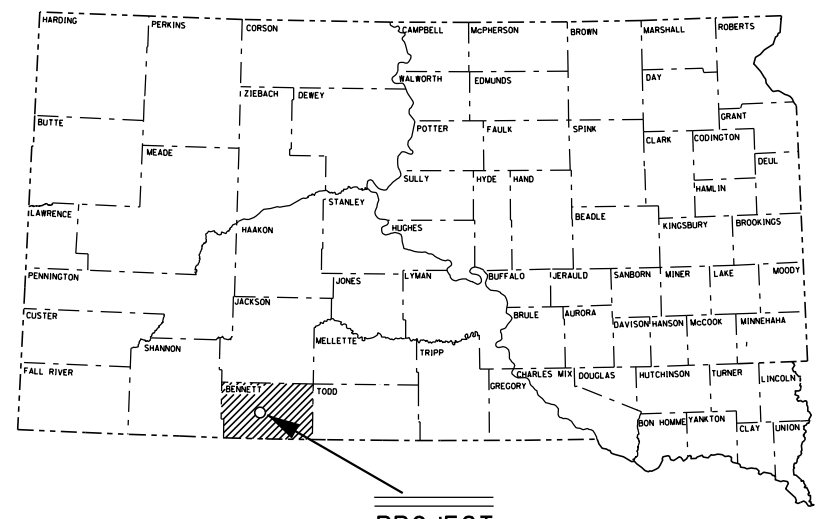

PROJECT

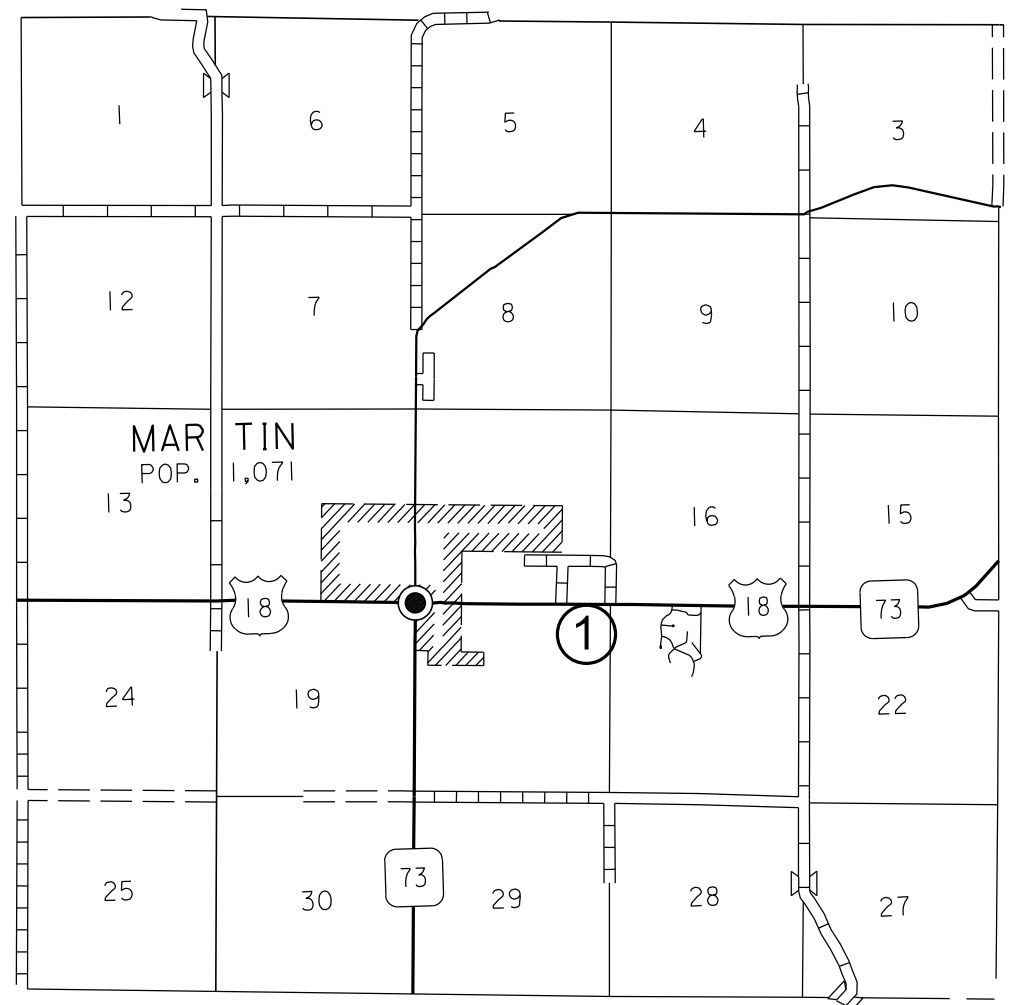

R 38 W

R 37 W

PROJECT LOCATION IS DESIGNATED BY A CIRCLED NUMBER AND DESCRIBED BELOW.

① = MARTIN MAINTENANCE SHOP IN MARTIN, SD

STORM WATER PERMIT
NO PERMIT REQUIRED

PLOT SCALE - 1:25616.3

PLOTTED FROM - TRW11INT26

PLOT NAME - 1

FILE - ... \DESIGN FILES\TITLE.DGN

STATE OF SOUTH DAKOTA	PROJECT 410C281	SHEET 2	TOTAL SHEETS 5
-----------------------	--------------------	------------	-------------------

Plotting Date: 02/25/2014

MARTIN MAINTENANCE YARD PAVING LAYOUT

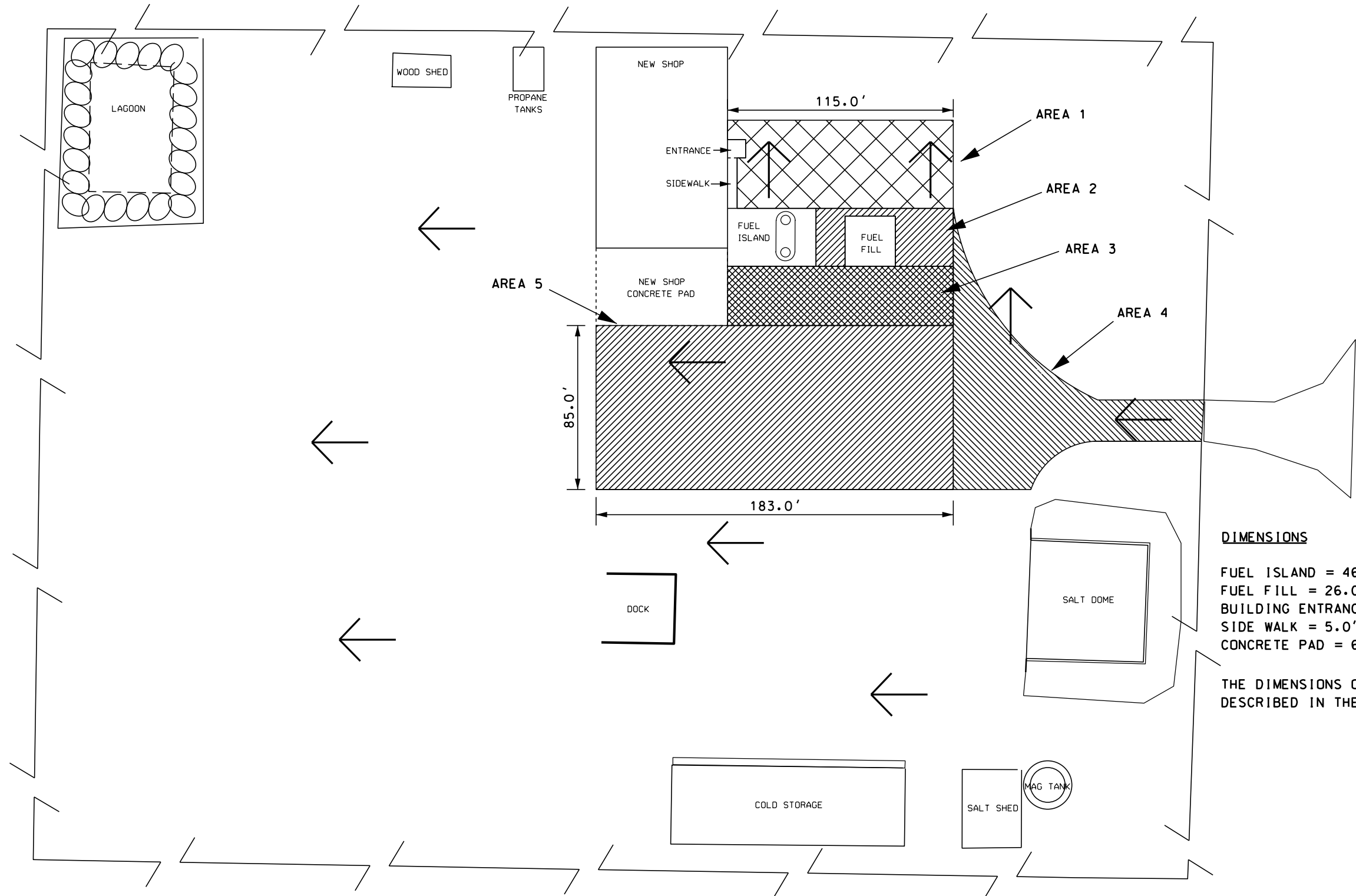
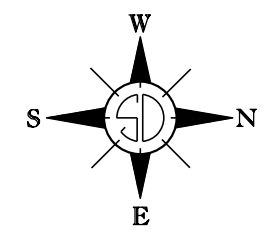

DIMENSIONS
 FUEL ISLAND = 46.75' X 30.0'
 FUEL FILL = 26.0' X 26.0'
 BUILDING ENTRANCE = 8.3' X 8.3'
 SIDE WALK = 5.0' X 30.0'
 CONCRETE PAD = 68.0' X 40.0'

THE DIMENSIONS OF EACH AREA ARE DESCRIBED IN THE NOTES.

← INDICATES DESIGNED FINISHED DRAINAGE

PLOT SCALE - 1:25616.3

PLOTTED FROM - TRW11INT26

PLOT NAME - 4

FILE - ... \DESIGN FILES\MARTIN YARD.DGN

ESTIMATE OF QUANTITIES AND ENVIRONMENTAL COMMITMENTS

STATE OF SOUTH DAKOTA	PROJECT	SHEET NO.	TOTAL SHEETS
	410C281	3	5

ESTIMATE OF QUANTITIES

Bid Item Number	Item	Quantity	Unit
009E0010	Mobilization	Lump Sum	LS
320E1200	Asphalt Concrete Composite	700.0	Ton

SPECIFICATIONS

Standard Specifications for Roads & Bridges, 2004 Edition and Required Provisions, Supplemental Specifications and/or Special Provisions as included in the Proposal.

UTILITIES

Utilities are not planned to be affected on this project. If utilities are identified near the improvement area through SD One Call Process as required by South Dakota Codified Law 49-7A and Administrative Rule Article 20:25, the Contractor shall contact the Engineer to determine modifications that will be necessary to avoid utility impacts.

ENVIRONMENTAL COMMITMENTS

An Environment Commitment is a measure that SDDOT commits to implement in order to avoid, minimize, and/or mitigate a real or potential environmental impact. Environmental commitments to various agencies and the public have been made to secure approval of this project. An agency mentioned below with permitting authority can influence a project if perceived environmental impacts have not been adequately addressed. Unless otherwise designated, the Contractor's primary contact regarding matters associated with these commitments will be the Project Engineer. These environmental commitments are not subject to change without prior written approval from the SDDOT Environmental Office. The environmental commitments associated with this project are as follows:

COMMITMENT H: WASTE DISPOSAL SITE

The Contractor shall furnish a site(s) for the disposal of construction/demolition debris generated by this project.

Action Taken/Required:

Construction and/or demolition debris may not be disposed of within the State ROW.

The waste disposal site(s) shall be managed and reclaimed in accordance with the following from the General Permit for Highway, Road, and Railway Construction/Demolition Debris Disposal Under the South Dakota Waste Management Program issued by the Department of Environment and Natural Resources.

The waste disposal site(s) shall not be located in a wetland, within 200 feet of surface water, or in an area that adversely affects wildlife, recreation, aesthetic value of an area, or any threatened or endangered species, as approved by the Engineer.

If the waste disposal site(s) is located such that it is within view of any ROW, the following additional requirements shall apply:

1. Construction and/or demolition debris consisting of concrete, asphalt concrete, or other similar materials shall be buried in a trench completely separate from wood debris. The final cover over the construction and/or demolition debris shall consist of a minimum of

1 foot of soil capable of supporting vegetation. Waste disposal sites provided outside of the State ROW shall be seeded in accordance with Natural Resources Conservation Service recommendations. The seeding recommendations may be obtained through the appropriate County NRCS Office. The Contractor shall control the access to waste disposal sites not within the State ROW through the use of fences, gates, and placement of a sign or signs at the entrance to the site stating "No Dumping Allowed".

2. Concrete and asphalt concrete debris may be stockpiled within view of the ROW for a period of time not to exceed the duration of the project. Prior to project completion, the waste shall be removed from view of the ROW or buried and the waste disposal site reclaimed as noted above.

The above requirements will not apply to waste disposal sites that are covered by an individual solid waste permit as specified in SDCL 34A-6-58, SDCL 34A-6-1.13, and ARSD 74:27:10:06.

Failure to comply with the requirements stated above may result in civil penalties in accordance with South Dakota Solid Waste Law, SDCL 34A-6-1.31.

All costs associated with furnishing waste disposal site(s), disposing of waste, maintaining control of access (fence, gates, and signs), and reclamation of the waste disposal site(s) shall be incidental to the various contract items.

STATE OF SOUTH DAKOTA	PROJECT	SHEET NO.	TOTAL SHEETS
	410C281	4	5

COMMITMENT I: HISTORICAL PRESERVATION OFFICE CLEARANCES

The SDDOT has obtained concurrence with the State Historical Preservation Office (SHPO or THPO) for all work included within the project limits and all designated option borrow sites provided within the plans.

Action Taken/Required:

All earth disturbing activities not designated within the plans review of cultural resources impacts. This work includes, but is not limited to: staging areas, borrow sites, waste disposal sites, and all material processing sites.

The Contractor shall arrange and pay for the cultural resource survey and/or records search. The Contractor has the option to contact the state Archaeological Research Center (ARC) at 605-394-1936 or another qualified archaeologist, to obtain records search or a cultural resources survey. A record search might be sufficient for review; however, a cultural resources survey may need to be conducted by a qualified archaeologist.

The Contractor shall provide ARC with the following: a topographical map or aerial view on which the site is clearly outlined, site dimensions, project number, and PCN. If applicable, provide evidence that the site has been previously disturbed by farming, mining, or construction activities with a landowner statement that artifacts have not been found on the site.

The Contractor shall submit the records search or cultural resources survey report and if the location of the site is within the current geographical or historic boundaries of any South Dakota reservation to SDDOT Environmental Engineer, 700 East Broadway Avenue, Pierre, SD 57501-2586 (605-773-3180). SDDOT will submit the information to the appropriate SHPO/THPO. Allow **30 Days** from the date this information is submitted to the Environmental Engineer for SHPO/THPO review.

If evidence for cultural resources is uncovered during project construction activities, then such activities shall cease and the Project Engineer shall be immediately notified. The Project Engineer will contact the SDDOT Environmental Engineer in order to determine an appropriate course of action.

SHPO/THPO review does not relieve the Contractor of the responsibility for obtaining any additional permits and clearances for staging areas, borrow sites, waste disposal sites, or material processing sites that affect wetlands, threatened and endangered species, or waterways. The Contractor shall provide the required permits and clearances to the Project Engineer at the preconstruction meeting.

STATE OF SOUTH DAKOTA	PROJECT	SHEET NO.	TOTAL SHEETS
	410C281	5	5

SEQUENCE OF WORK

1. Shape and compact in-place salvaged material
2. Place tack
3. Place Asphalt Concrete Composite

The Department anticipates that the building, the construction of the new fuel island, and all miscellaneous items associated with the new building contract will be completed by July 1st, 2014. The Contractor shall coordinate with the Winner Area Office personnel to make any necessary adjustments/modifications in their project schedule to avoid any conflict with the building project. When all items are completed with the building contract, the surfacing/resurfacing of the Martin Yard may begin.

SCOPE OF WORK

Area 1: Currently this area consists of several inches of in-place salvaged asphalt material. The Contractor is to lightly shape and compact the salvaged asphalt material surface to make sure the surface is tightened up prior to paving this area. Then, the Contractor is to place 4 inches of Asphalt Concrete Composite in this area. The Asphalt Concrete Composite shall be placed in two lifts. Care is to be taken to ensure that positive drainage in the Martin Yard exists as per direction of the Engineer. Area 1 contains 615 Square Yards. Dimensions are 115 ft X 50 ft less the area of the sidewalk & entrance.

Area 2: Currently this area consists of several inches of in-place salvaged asphalt material. The Contractor is to lightly shape and compact the salvaged asphalt material surface to make sure the surface is tightened up prior to paving this area. Then, the Contractor is to place 4 inches of Asphalt Concrete Composite in this area. The Asphalt Concrete Composite shall be placed in two lifts. Care is to be taken to ensure that positive drainage in the Martin Yard exists as per direction of the Engineer. Area 2 contains 155 Square Yards. Dimensions are 69 ft X 30 ft less the area of the fuel fill concrete.

Area 3: Currently this area consists of several inches of in-place salvaged asphalt material. The Contractor is to lightly shape and compact the salvaged asphalt material surface to make sure the surface is tightened up prior to paving this area. Then, the Contractor is to place 4 inches of Asphalt Concrete Composite in this area. The Asphalt Concrete Composite shall be placed in two lifts. Care is to be taken to

ensure that positive drainage in the Martin Yard exists as per direction of the Engineer. Area 3 contains 383 Square Yards. Dimensions are 115 ft X 30 ft.

Area 4: Currently this area consists of in-place asphalt material that is showing minimal signs of distress. The Contractor shall place tack on the in-place asphalt prior to paving this area. Then, the Contractor is to place 3 inches of Asphalt Concrete Composite in this area. Care is to be taken to ensure that positive drainage in the Martin Yard exists as per direction of the Engineer. Area 4 contains 844 Square Yards. Dimensions are 113 ft X 24 ft from the gate to Area 5. The radius paving will be determined in the field by the Engineer.

Area 5: Currently this area consists of in-place asphalt material that is showing minimal signs of distress. The Contractor shall place tack on the in-place asphalt prior to paving this area. Then, the Contractor is to place 3 inches of Asphalt Concrete Composite in this area. Care is to be taken to ensure that positive drainage in the Martin Yard exists as per direction of the Engineer. Area 5 contains 1,728 Square Yards. Dimensions are 183 ft X 85 ft.

The Contractors attention is drawn to the fact that the fuel island & fuel fills are present within the vicinity of Areas 1, 2, & 3. Care is to be taken to avoid damaging the items in these areas. Any damage to the concrete fueling island will be repaired by the Contractor, to the satisfaction of the Engineer, at no expense to the State.

ASPHALT CONCRETE COMPOSITE

Mineral aggregate for the Asphalt Concrete Composite shall conform to the requirements of the Standard Specifications for Class E, Type 1.

All other requirements in the Standard Specification for Asphalt Concrete Composite shall apply.

The asphalt binder used in the mixture shall be PG 64-22, PG 64-28 or PG 64-34 Asphalt Binder.

It is estimated that 700.0 tons of Asphalt Concrete Composite will be needed overall to complete the paving of the designated areas. The depths and locations of the paving may be changed as per direction of the Engineer. Any additional Asphalt Concrete Composite will be placed at locations in the Martin Yard as directed by the Engineer.

It is estimated that 0.8 tons of CSS-1h or SS-1h for tack will be needed for this work as calculated at an application rate of 0.05 gallons per square yard. All vertical faces, the first lift of Asphalt Concrete Composite in Areas 1 - 3, and Areas 4 & 5 will require tack. No separate payment will be made for placement of tack oil. Placement is considered as incidental to other items of work.

In place field densities will not be taken. Specified Roller Coverage shall apply.

Placement of Asphalt Concrete Composite will be accomplished with a self-propelled paver in all Areas except for areas adjacent to the building. The Engineer may allow alternate methods in the smaller areas provided a steel faced vibratory roller is used for compaction.

The Contractor shall furnish, install and maintain "TRUCK CROSSING" signs. The location for this pair of signs will be determined in the field. Payment for these signs shall be incidental to the various contract items.