

Department of Transportation

Mitchell Region Office

PO Box 1206
Mitchell, SD 57301-7206 605/995-8129
FAX: 605/995-8135

February 26, 2016

June Hansen
Civil Rights Officer
Department of Transportation
700 Broadway Avenue East
Pierre, South Dakota 57501

RE: 018-292, Hutchinson County – PCN I44P
Pipe and Erosion Repair on US18 from SD37 to SD25

June,

Enclosed are a Contract Proposal and Plans for the above referenced project that is being let to contract in the Mitchell Region on March 22, 2016.

We have sent a bid invitation letter to the DBE/WBE Contractors listed below:

BX Civil & Construction Inc. **Grangaard Construction Inc.**

If you know of any other interested Contractors, please advise us.

Very truly yours,

DEPARTMENT OF TRANSPORTATION
Craig Smith, Region Engineer

Monte D. Rice, Region Design Engineer

cc: Humphrey – Construction and Maintenance
Gall/Rothschadl/Sestak – Yankton Area

NOTICE TO CONTRACTORS

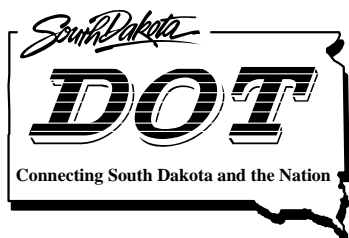

Department of Transportation

Mitchell Region Office

PO Box 1206
Mitchell, SD 57301-7206 605/995-8129
FAX: 605/995-8135

February 26, 2016

TO: Interested Bidders

RE: 018-292, Hutchinson County – PCN I44P
Pipe and Erosion Repair on US18 from SD37 to SD25

The South Dakota Department of Transportation (SDDOT) desires to solicit bids for Pipe and Erosion Repair on US18 from SD37 to SD25. Refer to the proposal and plans (in the link below) for location and details of the work to be done.

A Contract Proposal (DOT 123) form, a Utilization of Minority Business Enterprises Clauses form and a Contractor's Affidavit/Declaration form are enclosed for submission of your bid. Be sure to have the forms signed and notarized as indicated on the forms. FAX bids will not be accepted.

The Department of Transportation in accordance with Title VI of the Civil Rights Act of 1964, 78 Stat. 252, 42 U.S.C. 2000d to 2000d-4 and Title 49, Code of Federal Regulations, Department of Transportation, Subtitle A, Office of the Secretary, Part 21, Nondiscrimination in Federally-assisted programs of the Department of Transportation issued pursuant to such Act, hereby notifies all bidders that it will affirmatively insure that in any contract entered into pursuant to this advertisement, minority business enterprises will be afforded full opportunity to submit bids in response to this invitation and will not be discriminated against on the grounds of race, color, religion, national origin, sex, age or disability in consideration for an award.

The successful bidder will need to submit the DOT-208 Fuel Adjustment Affidavit (Attachment A) prior to the contract being awarded; therefore, all bidders are encouraged to submit the Fuel Adjustment Affidavit prior to or at the time of bidding.

If you submit a bid for this project, a bid bond, certified check, cashier's check, or bank draft will be required for NOT LESS THAN FIVE (5) PERCENT OF THE TOTAL AMOUNT OF THE BID. If an electronic bid bond is used, the Contractor is required to submit the bid bond identification number with the bid. Except for the lowest bidder on the project, all guarantees will be returned immediately following the receipt and checking of all bids.

The successful bidder shall furnish a performance bond in a sum equal to the full amount of the contract, prior to contract award. Therefore, please provide the performance bond as soon as possible after letting. The performance bond will not be returned for one (1) year after the completion of the project.

A Certificate of Insurance will be required from the successful bidder prior to beginning work.

Sealed bids will be received by the SDDOT through the US Postal Service at PO Box 1206 until **8:00 A.M. on Tuesday, March 22, 2016** or may be hand delivered (in person or by a package delivery service) to the Department of Transportation, Mitchell Regional Office located at 1300 S Ohlman St, Mitchell, SD 57301 until **1:30 P.M. on Tuesday, March 22, 2016**. Bid must be submitted in an envelope clearly indicating that the contents are a bid and the letting for which the bid applies.

If hand delivering, address the envelope to:

Monte Rice, Region Design Engineer
Department of Transportation
1300 S Ohlman St
Mitchell, SD 57301

If using the US Postal Service, address the envelope to:

Monte Rice, Region Design Engineer
Department of Transportation
PO Box 1206
Mitchell, SD 57301

Proposal and Plans (and Addenda, when applicable) can be accessed at the following link:

<http://sddot.com/business/contractors/bid/region/Default.aspx>. Prior to submitting a bid, it is the bidder's responsibility to examine the project in accordance with Section 2.5 of the specifications. It is also the bidder's responsibility to acknowledge and account for any addenda issued prior to bid opening.

Questions regarding the plans and/or proposal should be directed to:

Rod Gall (Ext. 1302001) or Greg Rothschild (Ext. 1302002) at 605-668-2931 or Monte Rice at 605-995-3302.

The SDDOT reserves the right to reject any or all bids.

Please verify that all required information is complete prior to mailing bid documents.

Very truly yours,

DEPARTMENT OF TRANSPORTATION

Craig Smith, Region Engineer

Monte D. Rice, Region Design Engineer

cc: Humphrey – Construction and Maintenance
Hansen – Civil Rights
Gall/Rothschadl/Sestak – Yankton Area
Gustafson – Operations
Long – Materials

**SOUTH DAKOTA DEPARTMENT OF TRANSPORTATION
CONTRACT PROPOSAL**

DOT-123
(5/05)
1 of 1

CODE	PROJECT			MAINT UNIT	CONTROL REFERENCE	AFE	FUNCTION	BEGIN MRM	END MRM
	PRE	ROUTE	AGR						
		018		292		I44P	2290	373.9	387.7

CITY AND/OR COUNTY: Hutchinson County

BUDGET SOURCE: Contract Maintenance

FINALS ENGINEER REVIEW REQUIRED: ☒ YES ☐ NO
 REGION MATERIALS CERTIFICATION REQUIRED: ☒ YES ☐ NO
 CERTIFIED INSPECTORS/TESTERS REQUIRED: ☒ YES ☐ NO
 TO BE INSTALLED ON CM&P: ☒ YES ☐ NO

TYPE, PURPOSE AND LOCATION OF WORK: Pipe and Erosion Repair on US18 from SD37 to SD25.

ESTIMATE OF QUANTITIES AND COST

BID ITEM NUMBER	ITEM	QUANTITY	UNIT	UNIT PRICE	AMOUNT
009E0010	Mobilization	Lump Sum	LS	Lump Sum	
110E7500	Remove Pipe for Reset	132	Ft		
110E7510	Remove Pipe End Section for Reset	1	Each		
120E0600	Contractor Furnished Borrow Excavation	17	CuYd		
230E0100	Remove and Replace Topsoil	Lump Sum	LS	Lump Sum	
450E9000	Reset Pipe	132	Ft		
450E9001	Reset Pipe End Section	1	Each		
634E0010	Flagging	20	Hour	\$24.19	
634E0110	Traffic Control Signs	106	SqFt		
634E0120	Traffic Control Miscellaneous	Lump Sum	LS	Lump Sum	
720E1010	PVC Coated Bank and Channel Protection Gabion	24	CuYd		
734E0010	Erosion Control	Lump Sum	LS	Lump Sum	
831E0110	Type B Drainage Fabric	48	SqYd		
TOTAL					

CONTRACTOR'S PROPOSAL STATEMENT

The undersigned does hereby agree to furnish the labor and/or material in the quantities, at the unit price, for the purpose, in the place and in accordance with attached provisions upon approval of this Proposal by the State Transportation Commission. This document becomes the Contract when signed by the Contractor and a Department of Transportation Representative. The Contractor agrees to provide services in compliance with the Americans with Disabilities Act of 1990. The Contractor agrees to provide a certificate of insurance prior to commencing work, for liability coverage for the duration of the work as per the current edition of the SDDOT Standard Specifications for Roads and Bridges.

PROPOSED START DATE _____

OVERALL COMPLETION DATE **November 4, 2016**

SUBSCRIBED AND SWORN TO BEFORE ME THE
_____, DAY OF _____, 20__

SIGNATURE _____
 PRINTED NAME _____
 COMPANY _____
 ADDRESS _____

NOTARY - My Commission Expires _____ (SEAL) FEDERAL TAX ID NUMBER _____

RECOMMENDED FOR APPROVAL:

CONSTRUCTION & MAINTENANCE ENGINEER _____ DATE _____

REGION ENGINEER _____ DATE _____ DIRECTOR OF OPERATIONS _____ DATE _____

APPROVED FOR THE TRANSPORTATION COMMISSION

NAME _____ TITLE _____ DATE _____

APPROVED as per Federal Highway Stewardship Provisions this _____ day of _____, 20__.

PROJECT DEVELOPMENT ENGINEER _____

**BIDDER MUST EXECUTE THE FOLLOWING:
PARTICIPATION BY MINORITY CONTRACTORS**

Utilization of Minority Business Enterprises Clauses

PROJECT: 018-292

PCN I44P

COUNTY: HUTCHINSON

1. The Contractor agrees to use his best efforts to carry out this policy in the award of his subcontracts to the fullest extent consistent with the efficient performance of his contract. As used in this contract, 'Minority Business Enterprise' or 'MBE' means a small business concern, as defined pursuant to section 3 of the Small Business Act and implementing regulations, which is owned and controlled by one or more minorities or women. 'Owned and controlled' means a business: (a) Which is at least 51 per centum owned by one or more minorities or women or, in the case of publicly owned business, at least 51 per centum of the stock of which is owned by one or more minorities or women; and (b) Whose management and daily business operations are controlled by one or more such individuals. 'Minority' means a person who is a citizen or lawful permanent resident of the United States and who is: (a) Black (a person having origins in any of the black racial groups of Africa); (b) Hispanic (a person of Spanish or Portuguese culture with origins in Mexico, South or Central America or the Caribbean Islands, regardless of race); (c) Asian American (a person having origins in any of the original peoples of the Far East, Southeast Asia, the Indian subcontinent, or the Pacific Islands); or (d) American Indian and Alaskan Native (a person having origins in any of the original peoples of North America); (e) Members of other groups, or other individuals, found to be economically and socially disadvantaged by the Small Business Administration under section 8(a) of the Small Business Act, as amended. Contractors may rely on written representatives by subcontractors regarding their status as minority business enterprise in lieu of an independent investigation.
2. The Contractor agrees to establish and conduct a program which will enable minority business enterprise to be considered fairly as subcontractors and suppliers under this contract. In this connection the Contractor shall . . .
 - (a) Designate a liaison officer who will administer the Contractor's minority business enterprises program.
 - (b) Provide adequate and timely consideration of the potentialities of known minority business enterprises in all "make-or-buy" decisions.
 - (c) Ensure that known minority business enterprises will have an equitable opportunity to compete for subcontracts, particularly by arranging solicitations, time for the preparation of bids, quantities, specifications and delivery schedules so as to facilitate the participation of minority business enterprises.
 - (d) Maintain records showing (1) procedures which have been adopted to comply with the policies set forth in this clause, including the establishment of a source list of minority business enterprises, (2) awards to minority business enterprises on the source list, and (3) specific efforts to identify and award contracts to minority business enterprises.
 - (e) Include the "Utilization of Minority Business Enterprises Clause" in subcontracts which offer substantial minority business enterprises subcontracting opportunities.
 - (f) Cooperate with the State's Contracting Officer in any studies and surveys of the Contractor's minority business enterprises procedures and practices that the State's Contracting Officer may from time to time conduct.
 - (g) Submit periodic reports of subcontracting to known minority business enterprises with respect to the records referred to in subparagraph (d) above, in such form and manner and at such time (not more often than quarterly) as the State's Contracting Officer may prescribe.
3. The Contractor further agrees to insert in any subcontract hereunder provisions which shall conform substantially to the language of this clause, including this paragraph 3 and to notify the State's Contracting Officer of the names of such subcontractors.
4. The bidder hereby certifies that should he at any time decide to subcontract a portion of the work, he will take affirmative action to seek out and consider minority business enterprises as potential subcontractors. He further certifies that he will maintain records showing the contacts made with potential minority business enterprises subcontractors and the results of such contacts.

Name of Company (print or type)

Date

By _____
Signature of Company Official

Title

BIDDER MUST EXECUTE THE FOLLOWING:

**STATE OF SOUTH DAKOTA
DEPARTMENT OF TRANSPORTATION**

CONTRACTOR'S AFFIDAVIT / DECLARATION

PROJECT: 018-292 PCN **I44P**

COUNTY: HUTCHINSON

(an individual)
(a partnership)
(a corporation)

do hereby certify that I, We or any owner or partner holding a controlling interest, director or officer of the bidder; principal investigator, project director or other position involved in management of the project for which this bid is submitted, have not directly or indirectly, entered into any agreement, participated in any collusion, or otherwise taken any action in restraint of free competitive bidding in connection with the contract for the project, and that within the last 3 years none of the above have been suspended, debarred, voluntarily excluded or determined ineligible by any federal or state agency, been indicted, convicted, or had a civil judgment rendered against any of the above or the business entity described herein by a court of competent jurisdiction in any matter involving fraud or official misconduct for which we are currently under suspension or debarment. Nor is a proposed suspension or debarment pending against any of the above for any of the above listed reasons.

* * * *

COMPLETE SIGNATURE BLOCK A. or B. BELOW:

A. _____ (an individual)
Signed _____ (a partnership)
By _____ (a corporation)
Title _____
County of _____)
State of _____):SS
Subscribed and sworn to before me this _____ day of _____, 20____.
(SEAL) _____
Notary Public My Commission Expires _____.

* * * *

B. Under the penalty of perjury under the laws of the United States, I hereby certify that the above statement is true and correct.
Signed _____ (an individual)
By _____ (a partnership)
Title _____ (a corporation)

**SOUTH DAKOTA
DEPARTMENT OF TRANSPORTATION
MITCHELL REGION**

PROPOSAL FOR

**PROJECT 018-292
US HIGHWAY 18
HUTCHINSON COUNTY**

PIPE AND EROSION REPAIR
PCN I44P

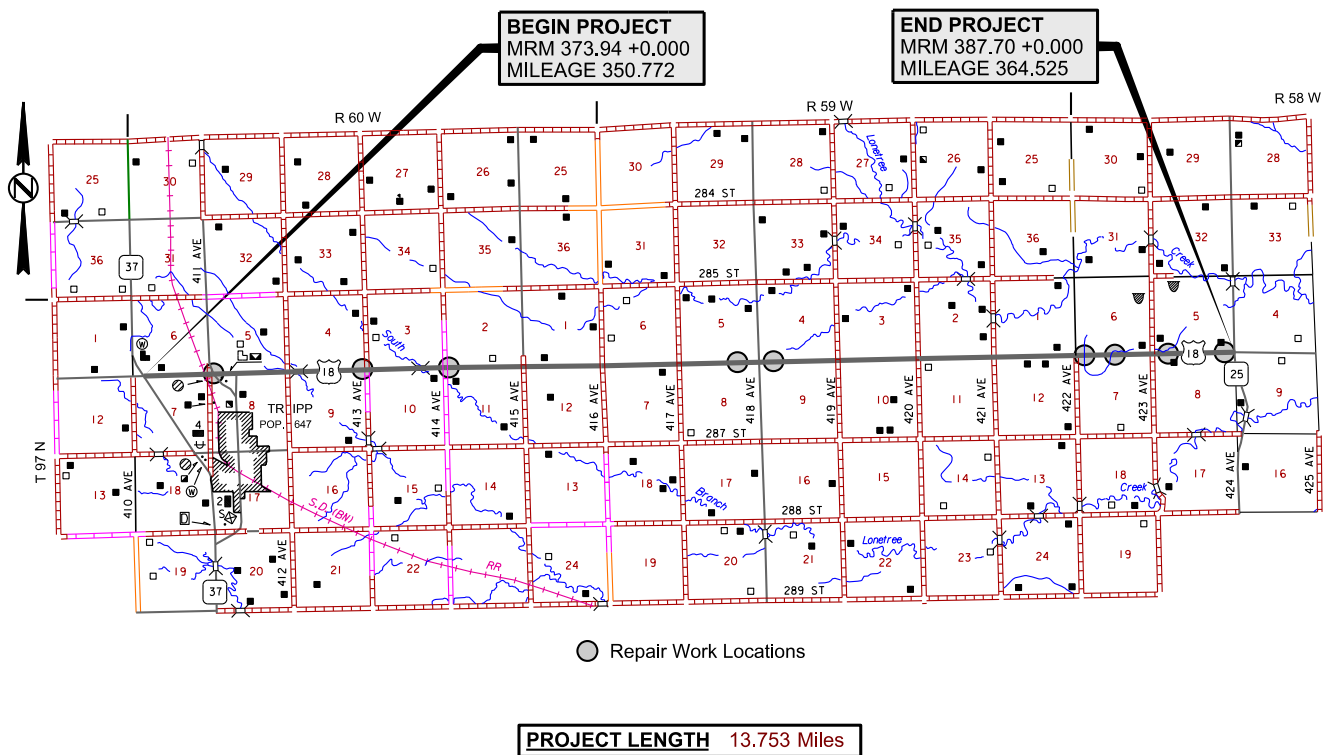

NOTICE TO ALL BIDDERS

TO REPORT BID RIGGING ACTIVITIES, CALL: 1-800-424-9071

THE U.S. DEPARTMENT OF TRANSPORTATION (DOT) OPERATES THE ABOVE TOLL-FREE "HOTLINE" MONDAY THROUGH FRIDAY, 8:00 A.M. TO 5:00 P.M., EASTERN TIME. ANYONE WITH KNOWLEDGE OF POSSIBLE BID RIGGING, BIDDER COLLUSION, OR OTHER FRAUDULENT ACTIVITIES SHOULD USE THE "HOTLINE" TO REPORT SUCH ACTIVITIES.

THE "HOTLINE" IS PART OF THE DOT'S CONTINUING EFFORT TO IDENTIFY AND INVESTIGATE HIGHWAY CONSTRUCTION CONTRACT FRAUD AND ABUSE AND IS OPERATED UNDER THE DIRECTION OF THE DOT INSPECTOR GENERAL.

ALL INFORMATION WILL BE TREATED CONFIDENTIALLY AND CALLER ANONYMITY WILL BE RESPECTED.

* * * *

REV. 2/26/16

PROJECT: 018-292 PCN I44P

COUNTY: HUTCHINSON

TYPE OF WORK: PIPE AND EROSION REPAIR

THE FOLLOWING ITEMS ARE INCLUDED IN THIS PROPOSAL FORM:

Special Provision Regarding Section 404 of the Clean Water Act, dated 2/26/2016.

Nationwide Permit 3

Regional Conditions

Special Provision for Contractor Administered Preconstruction Meeting, dated 4/18/13.

Fuel Adjustment Affidavit, DOT form 208 dated 7/15.

Standard Title VI Assurance, dated 3/1/16.

Special Provision For Implementation of Clean Air Act & Federal Water Pollution Control Act,
dated 9/1/97.

Special Provision Regarding Minimum Wage on State Funded Projects, dated 4/30/13.

Wage and Hour Division US Department of Labor Washington DC.

- US Dept. of Labor Decision Number SD150001, dated 10/9/15.

Special Provision for Price Schedule for Miscellaneous Items, dated 10/14/15.

Plans for Project – Sheets 1 through 10.

* * * *

STATE OF SOUTH DAKOTA
DEPARTMENT OF TRANSPORTATION

SPECIAL PROVISION REGARDING
SECTION 404 OF
THE CLEAN WATER ACT

018-292 PCN I44P
HUTCHINSON COUNTY

FEBRUARY 26, 2016
NATIONWIDE PERMIT NO NWO 2016-0201-PIE

The above referenced project is authorized by the Department of the Army Nationwide Permit Section (3), found in the February 21, 2012 Federal Register (77 FR 10184), Reissuance of Nation Wide Permits.

The following general conditions must be adhered to in order for any authorization by a nationwide permit to be valid:

Please refer to the attached *Fact Sheet Nationwide Permit 3 and 2012 Nationwide Permits Regional Conditions*

The above authorization permits placement of fill in the drainage crossings or wetlands noted below:

Drainage Crossing(s) Permanent:

MRM 381.41	Tributary to Lone Tree Creek
MRM 385.74	Tributary to Lone Tree Creek
MRM 386.16	Tributary to Lone Tree Creek

* * * *

Nationwide Permit 3

Maintenance

(a) The repair, rehabilitation, or replacement of any previously authorized, currently serviceable structure, or fill, or of any currently serviceable structure or fill authorized by 33 CFR 330.3, provided that the structure or fill is not to be put to uses differing from those uses specified or contemplated for it in the original permit or the most recently authorized modification. Minor deviations in the structure's configuration or filled area, including those due to changes in materials, construction techniques, requirements of other regulatory agencies, or current construction codes or safety standards that are necessary to make the repair, rehabilitation, or replacement are authorized. Any stream channel modification is limited to the minimum necessary for the repair, rehabilitation, or replacement of the structure or fill; such modifications, including the removal of material from the stream channel, must be immediately adjacent to the project or within the boundaries of the structure or fill. This NWP also authorizes the repair, rehabilitation, or replacement of those structures or fills destroyed or damaged by storms, floods, fire or other discrete events, provided the repair, rehabilitation, or replacement is commenced, or is under contract to commence, within two years of the date of their destruction or damage. In cases of catastrophic events, such as hurricanes or tornadoes, this two-year limit may be waived by the district engineer, provided the permittee can demonstrate funding, contract, or other similar delays.

(b) This NWP also authorizes the removal of accumulated sediments and debris in the vicinity of existing structures (e.g., bridges, culverted road crossings, water intake structures, etc.) and/or the placement of new or additional riprap to protect the structure. The removal of sediment is limited to the minimum necessary to restore the waterway in the vicinity of the structure to the approximate dimensions that existed when the structure was built, but cannot extend farther than 200 feet in any direction from the structure. This 200 foot limit does not apply to maintenance dredging to remove accumulated sediments blocking or restricting outfall and intake structures or to maintenance dredging to remove accumulated sediments from canals associated with outfall and intake structures. All dredged or excavated materials must be deposited and retained in an area that has no waters of the United States unless otherwise specifically approved by the district engineer under separate authorization. The placement of new or additional riprap must be the minimum necessary to protect the structure or to ensure the safety of the structure. Any bank stabilization measures not directly associated with the structure will require a separate authorization from the district engineer.

(c) This NWP also authorizes temporary structures, fills, and work necessary to conduct the maintenance activity. Appropriate measures must be taken to maintain normal downstream flows and minimize flooding to the maximum extent practicable, when temporary structures, work, and discharges, including cofferdams, are necessary for construction activities, access fills, or dewatering of construction sites. Temporary fills must consist of materials, and be placed in a manner, that will not be eroded by expected high flows. Temporary fills must be removed in

their entirety and the affected areas returned to pre-construction elevations. The areas affected by temporary fills must be revegetated, as appropriate.

(d) This NWP does not authorize maintenance dredging for the primary purpose of navigation. This NWP does not authorize beach restoration. This NWP does not authorize new stream channelization or stream relocation projects.

Notification: For activities authorized by paragraph (b) of this NWP, the permittee must submit a pre-construction notification to the district engineer prior to commencing the activity. The pre-construction notification must include information regarding the original design capacities and configurations of the outfalls, intakes, small impoundments, and canals.

(Sections 10 and 404)

Note: This NWP authorizes the repair, rehabilitation, or replacement of any previously authorized structure or fill that does not qualify for the Clean Water Act Section 404(f) exemption for maintenance.

Nationwide Permit General Conditions

Note: To qualify for NWP authorization, the prospective permittee must comply with the following general conditions, as applicable, in addition to any regional or case-specific conditions imposed by the division engineer or district engineer.

1. Navigation. (a) No activity may cause more than a minimal adverse effect on navigation.

(b) Any safety lights and signals prescribed by the U.S. Coast Guard, through regulations or otherwise, must be installed and maintained at the permittee's expense on authorized facilities in navigable waters of the United States.

(c) The permittee understands and agrees that, if future operations by the United States require the removal, relocation, or other alteration, of the structure or work herein authorized, or if, in the opinion of the Secretary of the Army or his authorized representative, said structure or work shall cause unreasonable obstruction to the free navigation of the navigable waters, the permittee will be required, upon due notice from the Corps of Engineers, to remove, relocate, or alter the structural work or obstructions caused thereby, without expense to the United States. No claim shall be made against the United States on account of any such removal or alteration.

2. Aquatic Life Movements. No activity may substantially disrupt the necessary life cycle movements of those species of aquatic life indigenous to the waterbody, including those species that normally migrate through the area, unless the activity's primary purpose is to impound water. All permanent and temporary crossings of waterbodies shall be suitably culverted, bridged, or otherwise designed and constructed to maintain low flows to sustain the movement of those aquatic species.

3. Spawning Areas. Activities in spawning areas during spawning seasons must be avoided to the maximum extent practicable. Activities that result in the physical destruction (e.g., through excavation, fill, or downstream smothering by substantial turbidity) of an important spawning area are not authorized.

4. Migratory Bird Breeding Areas. Activities in waters of the United States that serve as breeding areas for migratory birds must be avoided to the maximum extent practicable.

5. Shellfish Beds. No activity may occur in areas of concentrated shellfish populations, unless the activity is directly related to a shellfish harvesting activity authorized by NWP 4 and 48, or is a shellfish seeding or habitat restoration activity authorized by NWP 27.

6. Suitable Material. No activity may use unsuitable material (e.g., trash, debris, car bodies, asphalt, etc.). Material used for construction or discharged must be free from toxic pollutants in toxic amounts (see Section 307 of the Clean Water Act).

7. Water Supply Intakes. No activity may occur in the proximity of a public water supply intake, except where the activity is for the repair or improvement of public water supply intake structures or adjacent bank stabilization.

8. Adverse Effects From Impoundments. If the activity creates an impoundment of water, adverse effects to the aquatic system due to accelerating the passage of water, and/or restricting its flow must be minimized to the maximum extent practicable.

9. Management of Water Flows. To the maximum extent practicable, the pre-construction course, condition, capacity, and location of open waters must be maintained for each activity, including stream channelization and storm water management activities, except as provided below. The activity must be constructed to withstand expected high flows. The activity must not restrict or impede the passage of normal or high flows, unless the primary purpose of the activity is to impound water or manage high flows. The activity may alter the pre-construction course, condition, capacity, and location of open waters if it benefits the aquatic environment (e.g., stream restoration or relocation activities).

10. Fills Within 100-Year Floodplains. The activity must comply with applicable FEMA-approved state or local floodplain management requirements.

11. Equipment. Heavy equipment working in wetlands or mudflats must be placed on mats, or other measures must be taken to minimize soil disturbance.

12. Soil Erosion and Sediment Controls. Appropriate soil erosion and sediment controls must be used and maintained in effective operating condition during construction, and all exposed soil and other fills, as well as any work below the ordinary high water mark or high tide line, must be permanently stabilized at the earliest practicable date. Permittees are encouraged to perform work within waters of the United States during periods of low-flow or no-flow.

13. Removal of Temporary Fills. Temporary fills must be removed in their entirety and the affected areas returned to pre-construction elevations. The affected areas must be revegetated, as appropriate.

14. Proper Maintenance. Any authorized structure or fill shall be properly maintained, including maintenance to ensure public safety and compliance with applicable NWP general conditions, as well as any activity-specific conditions added by the district engineer to an NWP authorization.

15. Single and Complete Project. The activity must be a single and complete project. The same NWP cannot be used more than once for the same single and complete project.

16. Wild and Scenic Rivers. No activity may occur in a component of the National Wild and Scenic River System, or in a river officially designated by Congress as a “study river” for possible inclusion in the system while the river is in an official study status, unless the appropriate Federal agency with direct management responsibility for such river, has determined in writing that the proposed activity will not adversely affect the Wild and Scenic River designation or study status. Information on Wild and Scenic Rivers may be obtained from the appropriate Federal land management agency responsible for the designated Wild and Scenic River or study river (e.g., National Park Service, U.S. Forest Service, Bureau of Land Management, U.S. Fish and Wildlife Service).

17. Tribal Rights. No activity or its operation may impair reserved tribal rights, including, but not limited to, reserved water rights and treaty fishing and hunting rights.

18. Endangered Species. (a) No activity is authorized under any NWP which is likely to directly or indirectly jeopardize the continued existence of a threatened or endangered species or a species proposed for such designation, as identified under the Federal Endangered Species Act (ESA), or which will directly or indirectly destroy or adversely modify the critical habitat of such species. No activity is authorized under any NWP which “may affect” a listed species or critical habitat, unless Section 7 consultation addressing the effects of the proposed activity has been completed.

(b) Federal agencies should follow their own procedures for complying with the requirements of the ESA. Federal permittees must provide the district engineer with the appropriate documentation to demonstrate compliance with those requirements. The district engineer will review the documentation and determine whether it is sufficient to address ESA compliance for the NWP activity, or whether additional ESA consultation is necessary.

(c) Non-federal permittees must submit a pre-construction notification to the district engineer if any listed species or designated critical habitat might be affected or is in the vicinity of the project, or if the project is located in designated critical habitat, and shall not begin work on the activity until notified by the district engineer that the requirements of the ESA have been satisfied and that the activity is authorized. For activities that might affect Federally-listed endangered or threatened species or designated critical habitat, the pre-construction notification must include the name(s) of the endangered or threatened species that might be affected by the proposed work or that utilize the designated critical habitat that might be affected by the

proposed work. The district engineer will determine whether the proposed activity “may affect” or will have “no effect” to listed species and designated critical habitat and will notify the non-Federal applicant of the Corps’ determination within 45 days of receipt of a complete pre-construction notification. In cases where the non-Federal applicant has identified listed species or critical habitat that might be affected or is in the vicinity of the project, and has so notified the Corps, the applicant shall not begin work until the Corps has provided notification the proposed activities will have “no effect” on listed species or critical habitat, or until Section 7 consultation has been completed. If the non-Federal applicant has not heard back from the Corps within 45 days, the applicant must still wait for notification from the Corps.

(d) As a result of formal or informal consultation with the FWS or NMFS the district engineer may add species-specific regional endangered species conditions to the NWP.

(e) Authorization of an activity by a NWP does not authorize the “take” of a threatened or endangered species as defined under the ESA. In the absence of separate authorization (e.g., an ESA Section 10 Permit, a Biological Opinion with “incidental take” provisions, etc.) from the U.S. FWS or the NMFS, The Endangered Species Act prohibits any person subject to the jurisdiction of the United States to take a listed species, where “take” means to harass, harm, pursue, hunt, shoot, wound, kill, trap, capture, or collect, or to attempt to engage in any such conduct. The word “harm” in the definition of “take” means an act which actually kills or injures wildlife. Such an act may include significant habitat modification or degradation where it actually kills or injures wildlife by significantly impairing essential behavioral patterns, including breeding, feeding or sheltering.

(f) Information on the location of threatened and endangered species and their critical habitat can be obtained directly from the offices of the U.S. FWS and NMFS or their world wide web pages at <http://www.fws.gov/> or <http://www.fws.gov/ipac> and <http://www.noaa.gov/fisheries.html> respectively.

19. Migratory Birds and Bald and Golden Eagles. The permittee is responsible for obtaining any “take” permits required under the U.S. Fish and Wildlife Service’s regulations governing compliance with the Migratory Bird Treaty Act or the Bald and Golden Eagle Protection Act. The permittee should contact the appropriate local office of the U.S. Fish and Wildlife Service to determine if such “take” permits are required for a particular activity.

20. Historic Properties. (a) In cases where the district engineer determines that the activity may affect properties listed, or eligible for listing, in the National Register of Historic Places, the activity is not authorized, until the requirements of Section 106 of the National Historic Preservation Act (NHPA) have been satisfied.

(b) Federal permittees should follow their own procedures for complying with the requirements of Section 106 of the National Historic Preservation Act. Federal permittees must provide the district engineer with the appropriate documentation to demonstrate compliance with those requirements. The district engineer will review the documentation and determine whether it is sufficient to address section 106 compliance for the NWP activity, or whether additional section 106 consultation is necessary.

(c) Non-federal permittees must submit a pre-construction notification to the district engineer if the authorized activity may have the potential to cause effects to any historic properties listed on, determined to be eligible for listing on, or potentially eligible for listing on the National Register of Historic Places, including previously unidentified properties. For such

activities, the pre-construction notification must state which historic properties may be affected by the proposed work or include a vicinity map indicating the location of the historic properties or the potential for the presence of historic properties. Assistance regarding information on the location of or potential for the presence of historic resources can be sought from the State Historic Preservation Officer or Tribal Historic Preservation Officer, as appropriate, and the National Register of Historic Places (see 33 CFR 330.4(g)). When reviewing pre-construction notifications, district engineers will comply with the current procedures for addressing the requirements of Section 106 of the National Historic Preservation Act. The district engineer shall make a reasonable and good faith effort to carry out appropriate identification efforts, which may include background research, consultation, oral history interviews, sample field investigation, and field survey. Based on the information submitted and these efforts, the district engineer shall determine whether the proposed activity has the potential to cause an effect on the historic properties. Where the non-Federal applicant has identified historic properties on which the activity may have the potential to cause effects and so notified the Corps, the non-Federal applicant shall not begin the activity until notified by the district engineer either that the activity has no potential to cause effects or that consultation under Section 106 of the NHPA has been completed.

(d) The district engineer will notify the prospective permittee within 45 days of receipt of a complete pre-construction notification whether NHPA Section 106 consultation is required. Section 106 consultation is not required when the Corps determines that the activity does not have the potential to cause effects on historic properties (see 36 CFR §800.3(a)). If NHPA section 106 consultation is required and will occur, the district engineer will notify the non-Federal applicant that he or she cannot begin work until Section 106 consultation is completed. If the non-Federal applicant has not heard back from the Corps within 45 days, the applicant must still wait for notification from the Corps.

(e) Prospective permittees should be aware that section 110k of the NHPA (16 U.S.C. 470h-2(k)) prevents the Corps from granting a permit or other assistance to an applicant who, with intent to avoid the requirements of Section 106 of the NHPA, has intentionally significantly adversely affected a historic property to which the permit would relate, or having legal power to prevent it, allowed such significant adverse effect to occur, unless the Corps, after consultation with the Advisory Council on Historic Preservation (ACHP), determines that circumstances justify granting such assistance despite the adverse effect created or permitted by the applicant. If circumstances justify granting the assistance, the Corps is required to notify the ACHP and provide documentation specifying the circumstances, the degree of damage to the integrity of any historic properties affected, and proposed mitigation. This documentation must include any views obtained from the applicant, SHPO/THPO, appropriate Indian tribes if the undertaking occurs on or affects historic properties on tribal lands or affects properties of interest to those tribes, and other parties known to have a legitimate interest in the impacts to the permitted activity on historic properties.

21. Discovery of Previously Unknown Remains and Artifacts. If you discover any previously unknown historic, cultural or archeological remains and artifacts while accomplishing the activity authorized by this permit, you must immediately notify the district engineer of what you have found, and to the maximum extent practicable, avoid construction activities that may affect the remains and artifacts until the required coordination has been completed. The district engineer will initiate the Federal, Tribal and state coordination required to determine if the items

or remains warrant a recovery effort or if the site is eligible for listing in the National Register of Historic Places.

22. Designated Critical Resource Waters. Critical resource waters include, NOAA-managed marine sanctuaries and marine monuments, and National Estuarine Research Reserves. The district engineer may designate, after notice and opportunity for public comment, additional waters officially designated by a state as having particular environmental or ecological significance, such as outstanding national resource waters or state natural heritage sites. The district engineer may also designate additional critical resource waters after notice and opportunity for public comment.

(a) Discharges of dredged or fill material into waters of the United States are not authorized by NWPs 7, 12, 14, 16, 17, 21, 29, 31, 35, 39, 40, 42, 43, 44, 49, 50, 51, and 52 for any activity within, or directly affecting, critical resource waters, including wetlands adjacent to such waters.

(b) For NWPs 3, 8, 10, 13, 15, 18, 19, 22, 23, 25, 27, 28, 30, 33, 34, 36, 37, and 38, notification is required in accordance with general condition 31, for any activity proposed in the designated critical resource waters including wetlands adjacent to those waters. The district engineer may authorize activities under these NWPs only after it is determined that the impacts to the critical resource waters will be no more than minimal.

23. Mitigation. The district engineer will consider the following factors when determining appropriate and practicable mitigation necessary to ensure that adverse effects on the aquatic environment are minimal:

(a) The activity must be designed and constructed to avoid and minimize adverse effects, both temporary and permanent, to waters of the United States to the maximum extent practicable at the project site (i.e., on site).

(b) Mitigation in all its forms (avoiding, minimizing, rectifying, reducing, or compensating for resource losses) will be required to the extent necessary to ensure that the adverse effects to the aquatic environment are minimal.

(c) Compensatory mitigation at a minimum one-for-one ratio will be required for all wetland losses that exceed 1/10-acre and require pre-construction notification, unless the district engineer determines in writing that either some other form of mitigation would be more environmentally appropriate or the adverse effects of the proposed activity are minimal, and provides a project-specific waiver of this requirement. For wetland losses of 1/10-acre or less that require pre-construction notification, the district engineer may determine on a case-by-case basis that compensatory mitigation is required to ensure that the activity results in minimal adverse effects on the aquatic environment. Compensatory mitigation projects provided to offset losses of aquatic resources must comply with the applicable provisions of 33 CFR part 332.

(1) The prospective permittee is responsible for proposing an appropriate compensatory mitigation option if compensatory mitigation is necessary to ensure that the activity results in minimal adverse effects on the aquatic environment.

(2) Since the likelihood of success is greater and the impacts to potentially valuable uplands are reduced, wetland restoration should be the first compensatory mitigation option considered.

(3) If permittee-responsible mitigation is the proposed option, the prospective permittee is responsible for submitting a mitigation plan. A conceptual or detailed mitigation plan may be

used by the district engineer to make the decision on the NWP verification request, but a final mitigation plan that addresses the applicable requirements of 33 CFR 332.4(c)(2) – (14) must be approved by the district engineer before the permittee begins work in waters of the United States, unless the district engineer determines that prior approval of the final mitigation plan is not practicable or not necessary to ensure timely completion of the required compensatory mitigation (see 33 CFR 332.3(k)(3)).

(4) If mitigation bank or in-lieu fee program credits are the proposed option, the mitigation plan only needs to address the baseline conditions at the impact site and the number of credits to be provided.

(5) Compensatory mitigation requirements (e.g., resource type and amount to be provided as compensatory mitigation, site protection, ecological performance standards, monitoring requirements) may be addressed through conditions added to the NWP authorization, instead of components of a compensatory mitigation plan.

(d) For losses of streams or other open waters that require pre-construction notification, the district engineer may require compensatory mitigation, such as stream rehabilitation, enhancement, or preservation, to ensure that the activity results in minimal adverse effects on the aquatic environment.

(e) Compensatory mitigation will not be used to increase the acreage losses allowed by the acreage limits of the NWPs. For example, if an NWP has an acreage limit of 1/2-acre, it cannot be used to authorize any project resulting in the loss of greater than 1/2-acre of waters of the United States, even if compensatory mitigation is provided that replaces or restores some of the lost waters. However, compensatory mitigation can and should be used, as necessary, to ensure that a project already meeting the established acreage limits also satisfies the minimal impact requirement associated with the NWPs.

(f) Compensatory mitigation plans for projects in or near streams or other open waters will normally include a requirement for the restoration or establishment, maintenance, and legal protection (e.g., conservation easements) of riparian areas next to open waters. In some cases, riparian areas may be the only compensatory mitigation required. Riparian areas should consist of native species. The width of the required riparian area will address documented water quality or aquatic habitat loss concerns. Normally, the riparian area will be 25 to 50 feet wide on each side of the stream, but the district engineer may require slightly wider riparian areas to address documented water quality or habitat loss concerns. If it is not possible to establish a riparian area on both sides of a stream, or if the waterbody is a lake or coastal waters, then restoring or establishing a riparian area along a single bank or shoreline may be sufficient. Where both wetlands and open waters exist on the project site, the district engineer will determine the appropriate compensatory mitigation (e.g., riparian areas and/or wetlands compensation) based on what is best for the aquatic environment on a watershed basis. In cases where riparian areas are determined to be the most appropriate form of compensatory mitigation, the district engineer may waive or reduce the requirement to provide wetland compensatory mitigation for wetland losses.

(g) Permittees may propose the use of mitigation banks, in-lieu fee programs, or separate permittee-responsible mitigation. For activities resulting in the loss of marine or estuarine resources, permittee-responsible compensatory mitigation may be environmentally preferable if there are no mitigation banks or in-lieu fee programs in the area that have marine or estuarine credits available for sale or transfer to the permittee. For permittee-responsible mitigation, the special conditions of the NWP verification must clearly indicate the party or parties responsible

for the implementation and performance of the compensatory mitigation project, and, if required, its long-term management.

(h) Where certain functions and services of waters of the United States are permanently adversely affected, such as the conversion of a forested or scrub-shrub wetland to a herbaceous wetland in a permanently maintained utility line right-of-way, mitigation may be required to reduce the adverse effects of the project to the minimal level.

24. Safety of Impoundment Structures. To ensure that all impoundment structures are safely designed, the district engineer may require non-Federal applicants to demonstrate that the structures comply with established state dam safety criteria or have been designed by qualified persons. The district engineer may also require documentation that the design has been independently reviewed by similarly qualified persons, and appropriate modifications made to ensure safety.

25. Water Quality. Where States and authorized Tribes, or EPA where applicable, have not previously certified compliance of an NWP with CWA Section 401, individual 401 Water Quality Certification must be obtained or waived (see 33 CFR 330.4(c)). The district engineer or State or Tribe may require additional water quality management measures to ensure that the authorized activity does not result in more than minimal degradation of water quality.

26. Coastal Zone Management. In coastal states where an NWP has not previously received a state coastal zone management consistency concurrence, an individual state coastal zone management consistency concurrence must be obtained, or a presumption of concurrence must occur (see 33 CFR 330.4(d)). The district engineer or a State may require additional measures to ensure that the authorized activity is consistent with state coastal zone management requirements.

27. Regional and Case-By-Case Conditions. The activity must comply with any regional conditions that may have been added by the Division Engineer (see 33 CFR 330.4(e)) and with any case specific conditions added by the Corps or by the state, Indian Tribe, or U.S. EPA in its section 401 Water Quality Certification, or by the state in its Coastal Zone Management Act consistency determination.

28. Use of Multiple Nationwide Permits. The use of more than one NWP for a single and complete project is prohibited, except when the acreage loss of waters of the United States authorized by the NWPs does not exceed the acreage limit of the NWP with the highest specified acreage limit. For example, if a road crossing over tidal waters is constructed under NWP 14, with associated bank stabilization authorized by NWP 13, the maximum acreage loss of waters of the United States for the total project cannot exceed 1/3-acre.

29. Transfer of Nationwide Permit Verifications. If the permittee sells the property associated with a nationwide permit verification, the permittee may transfer the nationwide permit verification to the new owner by submitting a letter to the appropriate Corps district office to validate the transfer. A copy of the nationwide permit verification must be attached to the letter, and the letter must contain the following statement and signature:

“When the structures or work authorized by this nationwide permit are still in existence at the time the property is transferred, the terms and conditions of this nationwide permit, including any special conditions, will continue to be binding on the new owner(s) of the property. To validate the transfer of this nationwide permit and the associated liabilities associated with compliance with its terms and conditions, have the transferee sign and date below.”

(Transferee)

(Date)

30. Compliance Certification. Each permittee who receives an NWP verification letter from the Corps must provide a signed certification documenting completion of the authorized activity and any required compensatory mitigation. The success of any required permittee-responsible mitigation, including the achievement of ecological performance standards, will be addressed separately by the district engineer. The Corps will provide the permittee the certification document with the NWP verification letter. The certification document will include:

(a) A statement that the authorized work was done in accordance with the NWP authorization, including any general, regional, or activity-specific conditions;

(b) A statement that the implementation of any required compensatory mitigation was completed in accordance with the permit conditions. If credits from a mitigation bank or in-lieu fee program are used to satisfy the compensatory mitigation requirements, the certification must include the documentation required by 33 CFR 332.3(1)(3) to confirm that the permittee secured the appropriate number and resource type of credits; and

(c) The signature of the permittee certifying the completion of the work and mitigation.

31. Pre-Construction Notification. (a) Timing. Where required by the terms of the NWP, the prospective permittee must notify the district engineer by submitting a pre-construction notification (PCN) as early as possible. The district engineer must determine if the PCN is complete within 30 calendar days of the date of receipt and, if the PCN is determined to be incomplete, notify the prospective permittee within that 30 day period to request the additional information necessary to make the PCN complete. The request must specify the information needed to make the PCN complete. As a general rule, district engineers will request additional information necessary to make the PCN complete only once. However, if the prospective permittee does not provide all of the requested information, then the district engineer will notify the prospective permittee that the PCN is still incomplete and the PCN review process will not commence until all of the requested information has been received by the district engineer. The prospective permittee shall not begin the activity until either:

(1) He or she is notified in writing by the district engineer that the activity may proceed under the NWP with any special conditions imposed by the district or division engineer; or

(2) 45 calendar days have passed from the district engineer's receipt of the complete PCN and the prospective permittee has not received written notice from the district or division

engineer. However, if the permittee was required to notify the Corps pursuant to general condition 18 that listed species or critical habitat might be affected or in the vicinity of the project, or to notify the Corps pursuant to general condition 20 that the activity may have the potential to cause effects to historic properties, the permittee cannot begin the activity until receiving written notification from the Corps that there is “no effect” on listed species or “no potential to cause effects” on historic properties, or that any consultation required under Section 7 of the Endangered Species Act (see 33 CFR 330.4(f)) and/or Section 106 of the National Historic Preservation (see 33 CFR 330.4(g)) has been completed. Also, work cannot begin under NWPs 21, 49, or 50 until the permittee has received written approval from the Corps. If the proposed activity requires a written waiver to exceed specified limits of an NWP, the permittee may not begin the activity until the district engineer issues the waiver. If the district or division engineer notifies the permittee in writing that an individual permit is required within 45 calendar days of receipt of a complete PCN, the permittee cannot begin the activity until an individual permit has been obtained. Subsequently, the permittee’s right to proceed under the NWP may be modified, suspended, or revoked only in accordance with the procedure set forth in 33 CFR 330.5(d)(2).

(b) Contents of Pre-Construction Notification: The PCN must be in writing and include the following information:

- (1) Name, address and telephone numbers of the prospective permittee;
- (2) Location of the proposed project;
- (3) A description of the proposed project; the project’s purpose; direct and indirect adverse environmental effects the project would cause, including the anticipated amount of loss of water of the United States expected to result from the NWP activity, in acres, linear feet, or other appropriate unit of measure; any other NWP(s), regional general permit(s), or individual permit(s) used or intended to be used to authorize any part of the proposed project or any related activity. The description should be sufficiently detailed to allow the district engineer to determine that the adverse effects of the project will be minimal and to determine the need for compensatory mitigation. Sketches should be provided when necessary to show that the activity complies with the terms of the NWP. (Sketches usually clarify the project and when provided results in a quicker decision. Sketches should contain sufficient detail to provide an illustrative description of the proposed activity (e.g., a conceptual plan), but do not need to be detailed engineering plans);
- (4) The PCN must include a delineation of wetlands, other special aquatic sites, and other waters, such as lakes and ponds, and perennial, intermittent, and ephemeral streams, on the project site. Wetland delineations must be prepared in accordance with the current method required by the Corps. The permittee may ask the Corps to delineate the special aquatic sites and other waters on the project site, but there may be a delay if the Corps does the delineation, especially if the project site is large or contains many waters of the United States. Furthermore, the 45 day period will not start until the delineation has been submitted to or completed by the Corps, as appropriate;
- (5) If the proposed activity will result in the loss of greater than 1/10-acre of wetlands and a PCN is required, the prospective permittee must submit a statement describing how the mitigation requirement will be satisfied, or explaining why the adverse effects are minimal and why compensatory mitigation should not be required. As an alternative, the prospective permittee may submit a conceptual or detailed mitigation plan.

(6) If any listed species or designated critical habitat might be affected or is in the vicinity of the project, or if the project is located in designated critical habitat, for non-Federal applicants the PCN must include the name(s) of those endangered or threatened species that might be affected by the proposed work or utilize the designated critical habitat that may be affected by the proposed work. Federal applicants must provide documentation demonstrating compliance with the Endangered Species Act; and

(7) For an activity that may affect a historic property listed on, determined to be eligible for listing on, or potentially eligible for listing on, the National Register of Historic Places, for non-Federal applicants the PCN must state which historic property may be affected by the proposed work or include a vicinity map indicating the location of the historic property. Federal applicants must provide documentation demonstrating compliance with Section 106 of the National Historic Preservation Act.

(c) Form of Pre-Construction Notification: The standard individual permit application form (Form ENG 4345) may be used, but the completed application form must clearly indicate that it is a PCN and must include all of the information required in paragraphs (b)(1) through (7) of this general condition. A letter containing the required information may also be used.

(d) Agency Coordination: (1) The district engineer will consider any comments from Federal and state agencies concerning the proposed activity's compliance with the terms and conditions of the NWP and the need for mitigation to reduce the project's adverse environmental effects to a minimal level.

(2) For all NWP activities that require pre-construction notification and result in the loss of greater than 1/2-acre of waters of the United States, for NWP 21, 29, 39, 40, 42, 43, 44, 50, 51, and 52 activities that require pre-construction notification and will result in the loss of greater than 300 linear feet of intermittent and ephemeral stream bed, and for all NWP 48 activities that require pre-construction notification, the district engineer will immediately provide (e.g., via e-mail, facsimile transmission, overnight mail, or other expeditious manner) a copy of the complete PCN to the appropriate Federal or state offices (U.S. FWS, state natural resource or water quality agency, EPA, State Historic Preservation Officer (SHPO) or Tribal Historic Preservation Office (THPO), and, if appropriate, the NMFS). With the exception of NWP 37, these agencies will have 10 calendar days from the date the material is transmitted to telephone or fax the district engineer notice that they intend to provide substantive, site-specific comments. The comments must explain why the agency believes the adverse effects will be more than minimal. If so contacted by an agency, the district engineer will wait an additional 15 calendar days before making a decision on the pre-construction notification. The district engineer will fully consider agency comments received within the specified time frame concerning the proposed activity's compliance with the terms and conditions of the NWPs, including the need for mitigation to ensure the net adverse environmental effects to the aquatic environment of the proposed activity are minimal. The district engineer will provide no response to the resource agency, except as provided below. The district engineer will indicate in the administrative record associated with each pre-construction notification that the resource agencies' concerns were considered. For NWP 37, the emergency watershed protection and rehabilitation activity may proceed immediately in cases where there is an unacceptable hazard to life or a significant loss of property or economic hardship will occur. The district engineer will consider any comments received to decide whether the NWP 37 authorization should be modified, suspended, or revoked in accordance with the procedures at 33 CFR 330.5.

(3) In cases of where the prospective permittee is not a Federal agency, the district engineer will provide a response to NMFS within 30 calendar days of receipt of any Essential Fish Habitat conservation recommendations, as required by Section 305(b)(4)(B) of the Magnuson-Stevens Fishery Conservation and Management Act.

(4) Applicants are encouraged to provide the Corps with either electronic files or multiple copies of pre-construction notifications to expedite agency coordination.

Further Information

1. District Engineers have authority to determine if an activity complies with the terms and conditions of an NWP.

2. NWPs do not obviate the need to obtain other federal, state, or local permits, approvals, or authorizations required by law.

3. NWPs do not grant any property rights or exclusive privileges.

4. NWPs do not authorize any injury to the property or rights of others.

5. NWPs do not authorize interference with any existing or proposed Federal project.

**2012 NATIONWIDE PERMITS
REGIONAL CONDITIONS
OMAHA DISTRICT
STATE OF SOUTH DAKOTA**

The following Nationwide Permit (NWP) regional conditions will be used in the State of South Dakota. Regional conditions are placed on NWPs to ensure projects result in less than minimal adverse impacts to the aquatic environment and to address local resources concerns.

Wetlands Classified as Peatlands – Revoked for Use

All NWPs, with the exception of 3, 5, 20, 27, 30, 32, 38, and 45, are revoked for use in peatlands in South Dakota.

“Peatlands” are saturated and inundated wetlands where conditions inhibit organic matter decomposition and allow for the accumulation of peat. Under cool, anaerobic, and acidic conditions, the rate of organic matter accumulation exceeds organic decay. Peatlands can be primarily classified into ombrotrophic bogs and minerotrophic fens; the latter subdivided into poor, moderate-rich, and extreme-rich fens, each with distinctive indicator species, community physiognomy, acidity, alkalinity, and base cation content.

Wetlands Classified as Peatlands – Pre-construction Notification Requirement

For NWPs 3, 5, 20, 27, 30, 32, 38, and 45 permittees must notify the Corps in accordance with General Condition No. 31 (Notification) prior to initiating any regulated activity impacting peatlands in South Dakota.

Waters Adjacent to Natural Springs – Pre-construction Notification Requirement – All Nationwide Permits

For all NWPs, permittees must notify the Corps in accordance with General Condition No. 31 (Notification) for regulated activities located within 100 feet of the water source in natural spring areas in South Dakota. For purposes of this condition, a spring source is defined as any location where there is artesian flow emanating from a distinct point at any time during the growing season. Springs do not include seeps and other groundwater discharge areas where there is no distinct point source.

Borrow Site Identification – All Nationwide Permits

The permittee is responsible for ensuring that the Corps is notified of the location of any borrow site that will be used in conjunction with the construction of the authorized activity so that the Corps may evaluate the site for potential impacts to aquatic resources, historic properties, and endangered species. For projects where there is another lead Federal agency, the permittee shall provide the Corps documentation indicating that the lead Federal agency has complied with the National Historic Preservation Act and Endangered Species Act for the borrow site. The permittee shall not initiate work at the borrow site in conjunction with the authorized activity until approval is received from the Corps.

Minimum Culvert Width – All Nationwide Permits

The permittee shall size culvert stream crossings based on the estimated two-year storm event or the width of the bankfull stream channel. Culverts placed in streams with a discernable bed and bank shall have a maximum width that is at least as wide as the bankfull channel width in the section of stream where the culvert will be placed. In lieu of bankfull width as a reference for minimum culvert size, the permittee may install a culvert that can pass the two-year storm event without causing rise of flood flows upstream of the culvert. Bankfull width shall be defined as the width of the stream at where over-bank flow begins during a flood event. In incised stream channels that do not or infrequently access their floodplains bankfull indicators may include slope changes, vegetation changes, the maximum elevation of deposited bedload, or the top of undercut banks.

Culvert Countersink Depth for Aquatic Organism Depth – All Nationwide Permits

The permittee shall install culverts as so that the culvert invert is set below the natural flowline of the water body according to the below table.

Culvert Type	Drainage Area	Culvert Invert Depression Below Stream Grade Line
All culvert types	≤ 100 acres	Not required
Pipe diameter < 8.0 ft	100 to 640 acres	0.5 ft
Pipe diameter < 8.0 ft	> 640 acres	1.0 ft
Pipe diameter ≥ 8.0 ft	All drainage sizes	20 % of pipe diameter
Box culvert	All drainage sizes	1.0 ft

- **The stream grade line shall be defined as the longitudinal average of the low-flow stream channel.**
- **The slope of the culvert should be parallel to the slope of the stream grade line.**
- **The culvert invert depression depth shall be measured at the culvert inlet for culverts installed at a slope less than the slope of the stream grade line.**
- **Riprap inlet and outlet protection shall be placed to match the height of the culvert invert.**

GENERAL CONDITIONS (REGIONAL ADDITIONS)

General Condition 3 - Spawning Areas

In order to further minimize adverse impacts in certain waters of the United States and to comply with General Condition No. 3, projects authorized under all available Section 404 NWPs that would occur in South Dakota's cold water streams must comply with the following regional condition:

In all South Dakota streams classified as cold water streams, when water flow is present, the discharge of dredged or fill material shall not take place without the permittee notifying the Corps in accordance with General Condition No. 31 (Notification) prior to initiating any regulated activity between October 15 and April 1. The Corps of Engineers, the South Dakota Department of Game, Fish and Parks, or the South Dakota Department of Environment and Natural Resources can be contacted for the location of State classified cold water streams. The cold water fisheries rivers and streams in South Dakota may be found at <http://legis.state.sd.us/rules/DisplayRule.aspx?Rule=74:51:03>.

General Condition 6 - Suitable Material

Permittees are reminded that General Condition No. 6 prohibits the use of unsuitable material. In addition, the following materials are not suitable for discharge into waters of the United States in the State of South Dakota:

1. Vehicle bodies, farm machinery and metal junk, including appliances and metal containers, are prohibited.
2. The use of old or used asphalt paving material as a fill material and the use of new or used asphalt for bank stabilization or erosion control is prohibited.
3. The use of organic debris as fill material is prohibited. (Properly anchored trees, treetops, root wads, logs, and hay bales may be allowed on a case-by-case basis.)
4. Any material subject to leaching when in an aquatic environment is prohibited (for example, but not limited to, chemically-treated building material, roofing material, and wood debris).
5. Individual or unanchored tires are prohibited. (Tires may be allowed on a case-by-case basis when placed in the form of a mat or grid with multiple anchoring points to reduce the risk of design failure.)
6. Small aggregate (i.e. less than 6 inches in diameter) may not be placed below the ordinary high water mark (OHWM) of a water body for the purpose of bank stabilization or erosion control when such aggregate will be unstable or subject to frequent failure. Small aggregate may, however, be placed below the OHWM if its purpose is to fill the interstices of a well-graded rock riprap revetment or channel lining.

7. Slab material, regardless of source, must be broken before placement so that the dimension of the largest slab will not be more than 3.5 times the dimension of the smallest slab (unless justified by a qualified engineer) and must be free of exposed rebar, wire and wire mesh.

8. The use of clean brick, broken concrete and cinder block for erosion control or bank stabilization will be considered on a case-by-case basis. If allowed, the broken concrete must be free of exposed rebar, wire, wire mesh, asphalt paving material, paint, and other erodible materials. Broken concrete must range in size from 6 to 36 inches (unless justified by a qualified engineer).

**STATE OF SOUTH DAKOTA
DEPARTMENT OF TRANSPORTATION**

**SPECIAL PROVISION
FOR
CONTRACTOR ADMINISTERED PRECONSTRUCTION MEETING**

APRIL 18, 2013

I. DESCRIPTION

This work consists of the Contractor scheduling and conducting a preconstruction meeting prior to beginning work on this contract. Additionally this work consists of the Contractor providing the Area Engineer a completed list of required submittals.

II. MATERIALS (Not Specified)

III. CONSTRUCTION REQUIREMENTS

For the purposes of this special provision, a business day is any calendar day except Saturdays, holidays, and days designated by the Governor of this State as an administrative leave day for state employees.

The Department will provide the Contractor a list of required submittals and the Authorization Form for Preconstruction Meeting (Form DOT-270) within five (5) business days of the date of the Notice to Proceed.

The Contractor's Required Submittals Form (Form DOT-272) is a document outlining information required prior to the completion of the project. This list will include two types of submittals; 1) information required before scheduling a preconstruction meeting and 2) information required before the Contractor begins related work. The Department reserves the right to request additional information not included in the original list of required submittals. The list of required submittals will include, but is not limited to, proposed sequence changes, shop drawings, permits, certifications, mix designs, labor compliance, equal employment opportunity, and disadvantaged business enterprise documents.

Prior to scheduling the preconstruction meeting, the Contractor will complete and provide the Area Engineer all items on the list of required submittals that are required as described in 1) above. If the Contractor cannot complete and provide a submittal item required prior to scheduling the preconstruction meeting, the Contractor will contact the Area Engineer to establish a mutually agreed upon

date when the required submittal will be completed and provided to the Area office.

The Contractor will not begin work on an item until the Contractor has provided the Area Engineer with all required information for the applicable work item and the appropriate office has approved the information, if necessary. The Contractor will make every reasonable effort to deliver the required submittals at the earliest possible time.

The Contractor's authorized representative as indicated on the Signature Authorization Form (Form DOT-209) will complete, in its entirety, the first page of the Authorization Form for Preconstruction Meeting and will initial each proceeding section. By initialing each section, the Contractor is confirming comprehension of each section.

When the Contractor has provided the Area Engineer all required submittals, unless the Contractor and Department have established an agreement in writing providing future dates of outstanding required submittal items, the Contractor will schedule a preconstruction meeting with the Area Engineer.

Within two (2) business days following the Contractor scheduling the preconstruction meeting, the Area Engineer will prepare and send the Contractor a meeting confirmation and the Preconstruction Meeting Outline (Form DOT-271) of discussion items including specific Department items.

The Contractor will complete the Contractor's portion of the Preconstruction Meeting Outline and will add additional discussion items as needed. The Contractor will send the meeting notice and final Preconstruction Meeting Outline to the Area Engineer, all subcontractors, utility companies, and all suppliers at least five (5) business days prior to the preconstruction meeting.

The Area Engineer will send the notice of the meeting and the final Preconstruction Meeting Outline of discussion items to any other government entities and other principle stakeholders involved in the project at least three (3) business days prior to the preconstruction meeting.

At the discretion of the Area Engineer, the preconstruction meeting may be held in person, videoconference, or over the phone. The Contractor's competent superintendent, as required by Section 5.5, who will be working on this project, is required to attend the preconstruction meeting.

The Contractor will lead the meeting discussion as described in the Preconstruction Meeting Outline. The Area Engineer will prepare the meeting minutes including any unresolved items and distribute them to all attendees and principle stakeholders within five (5) business days following the preconstruction meeting.

IV. METHOD OF MEASUREMENT

The Department will not make a separate measurement for the preconstruction meeting.

V. BASIS OF PAYMENT

The Department will not make a separate payment for the preconstruction meeting. All costs associated with the preconstruction meeting will be incidental to other contract items.

* * * * *

FUEL ADJUSTMENT AFFIDAVIT

Project Number _____
PCN _____
County _____

For project let using the SDEBS) and in accordance with Section 9.12, the bidder is not required to notify the Department at the time of submitting bids whether the Contractor will or will not participate in the fuel cost adjustment program. Prior to execution of the contract, the successful bidder must submit this completed form to the Department for approval. The Fuel Adjustment Affidavit shall include the anticipated fuel cost of subcontractors.

Does your company elect to participate in a fuel adjustment for this contract for the fuels that do not have a fixed price? No adjustments in fuel prices will be made if "No" is checked.

☐ Yes

☐ No

If yes, provide the total dollars for each of the applicable fuels. No adjustments in fuel price will be made for the fuel types that are left blank or completed with a \$0.00 value.

Diesel (x) \$ _____

Unleaded (y) \$ _____

Burner Fuel (z) \$ _____ Type of Burner Fuel Used: _____

Sum (x + y + z) = \$ _____

Note: The sum of the x, y, and z may not exceed 15% of the original contract amount.

The following must be completed regardless of whether the Contractor elects to participate in the fuel adjustment affidavit

Under the penalty of law for perjury or falsification, the undersigned, _____,
(Printed Name)

_____ of _____,
(Title) (Contractor)

hereby certifies that the documentation is submitted in good faith, that the information provided is accurate and complete to the best of their knowledge and belief, and that the monetary amount identified accurately reflects the cost for fuel, and that they are duly authorized to certify the above documentation on behalf of the company.

I hereby agree that the Department or its authorized representative shall have the right to examine and copy all Contractor records, documents, work sheets, bid sheets, and other data pertinent to the justification of the fuel costs shown above.

Dated _____ Signature _____

Notarization is required only when the Contractor elects to participate in the fuel adjustment affidavit

Subscribed and sworn before me this _____ day of _____, 20____.

Notary Public

My Commission Expires

**STATE OF SOUTH DAKOTA
DEPARTMENT OF TRANSPORTATION**

**STANDARD TITLE VI / NONDISCRIMINATION ASSURANCES
APPENDIX A & E**

MARCH 1, 2016

During the performance of this contract, the contractor, for itself, its assignees, and successors in interest (hereinafter referred to as the "contractor") agrees as follows:

1. **Compliance with Regulations:** The contractor (hereinafter includes consultants) will comply with the Acts and the Regulations relative to Non-discrimination in Federally-assisted programs of the U.S. Department of Transportation, Federal Highway Administration, as they may be amended from time to time, which are herein incorporated by reference and made a part of this contract.
2. **Non-discrimination:** The contractor, with regard to the work performed by it during the contract, will not discriminate on the grounds of race, color, or national origin in the selection and retention of subcontractors, including procurements of materials and leases of equipment. The contractor will not participate directly or indirectly in the discrimination prohibited by the Acts and the Regulations, including employment practices when the contract covers any activity, project, or program set forth in Appendix B of 49 CFR Part 21.
3. **Solicitations for Subcontracts, Including Procurements of Materials and Equipment:** In all solicitations, either by competitive bidding, or negotiation made by the contractor for work to be performed under a subcontract, including procurements of materials, or leases of equipment, each potential subcontractor or supplier will be notified by the contractor of the contractor's obligations under this contract and the Acts and the Regulations relative to Non-discrimination on the grounds of race, color, or national origin.
4. **Information and Reports:** The contractor will provide all information and reports required by the Acts, the Regulations, and directives issued pursuant thereto and will permit access to its books, records, accounts, other sources of information, and its facilities as may be determined by the Recipient or the Federal Highway Administration to be pertinent to ascertain compliance with such Acts, Regulations, and instructions. Where any information required of a contractor is in the exclusive possession of another who fails or refuses to furnish the information, the contractor will so certify to the Recipient or the Federal Highway Administration, as appropriate, and will set forth what efforts it has made to obtain the information.
5. **Sanctions for Noncompliance:** In the event of a contractor's noncompliance with the Non-discrimination provisions of this contract, the Recipient will impose such contract sanctions as it or the Federal Highway Administration may determine to be appropriate, including, but not limited to:
 - a. withholding payments to the contractor under the contract until the contractor complies; and/or
 - b. cancelling, terminating, or suspending a contract, in whole or in part.
6. **Incorporation of Provisions:** The contractor will include the provisions of paragraphs one through six in every subcontract, including procurements of materials and leases of equipment, unless exempt by the Acts, the Regulations and directives issued pursuant thereto. The contractor will take action with respect to any subcontract or procurement as the Recipient or the Federal Highway Administration may direct as a means of enforcing such provisions including sanctions for noncompliance. Provided, that if the contractor becomes involved in, or

is threatened with litigation by a subcontractor, or supplier because of such direction, the contractor may request the Recipient to enter into any litigation to protect the interests of the Recipient. In addition, the contractor may request the United States to enter into the litigation to protect the interests of the United States.

During the performance of this contract, the contractor, for itself, its assignees, and successors in interest (hereinafter referred to as the "contractor") agrees to comply with the following non-discrimination statutes and authorities; including but not limited to:

Pertinent Non-Discrimination Authorities:

- Title VI of the Civil Rights Act of 1964 (42 U.S.C. § 2000d et seq., 78 stat. 252), (prohibits discrimination on the basis of race, color, national origin); and 49 CFR Part 21.
- The Uniform Relocation Assistance and Real Property Acquisition Policies Act of 1970, (42 U.S.C. § 4601), (prohibits unfair treatment of persons displaced or whose property has been acquired because of Federal or Federal-aid programs and projects);
- Federal-Aid Highway Act of 1973, (23 U.S.C. § 324 et seq.), (prohibits discrimination on the basis of sex);
- Section 504 of the Rehabilitation Act of 1973, (29 U.S.C. § 794 et seq.), as amended, (prohibits discrimination on the basis of disability); and 49 CFR Part 27;
- The Age Discrimination Act of 1975, as amended, (42 U.S.C. § 6101 et seq.), (prohibits discrimination on the basis of age);
- Airport and Airway Improvement Act of 1982, (49 USC § 471, Section 47123), as amended, (prohibits discrimination based on race, creed, color, national origin, or sex);
- The Civil Rights Restoration Act of 1987, (PL 100-209), (Broadened the scope, coverage and applicability of Title VI of the Civil Rights Act of 1964, The Age Discrimination Act of 1975 and Section 504 of the Rehabilitation Act of 1973, by expanding the definition of the terms "programs or activities" to include all of the programs or activities of the Federal-aid recipients, sub-recipients and contractors, whether such programs or activities are Federally funded or not);
- Titles II and III of the Americans with Disabilities Act, which prohibit discrimination on the basis of disability in the operation of public entities, public and private transportation systems, places of public accommodation, and certain testing entities (42 U.S.C. §§ 12131-12189) as implemented by Department of Transportation regulations at 49 C.F.R. parts 37 and 38;
- The Federal Aviation Administration's Non-discrimination statute (49 U.S.C. § 47123) (prohibits discrimination on the basis of race, color, national origin, and sex);
- Executive Order 12898, Federal Actions to Address Environmental Justice in Minority Populations and Low-Income Populations, which ensures Non-discrimination against minority populations by discouraging programs, policies, and activities with disproportionately high and adverse human health or environmental effects on minority and low-income populations;
- Executive Order 13166, Improving Access to Services for Persons with Limited English Proficiency, and resulting agency guidance, national origin discrimination includes discrimination because of Limited English proficiency (LEP). To ensure compliance with Title VI, you must take reasonable steps to ensure that LEP persons have meaningful access to your programs (70 Fed. Reg. at 74087 to 74100);
- Title IX of the Education Amendments of 1972, as amended, which prohibits you from discriminating because of sex in education programs or activities (20 U.S.C. 1681 et seq).

**STATE OF SOUTH DAKOTA
DEPARTMENT OF TRANSPORTATION**

**SPECIAL PROVISION FOR
IMPLEMENTATION OF CLEAN AIR ACT
AND
FEDERAL WATER POLLUTION CONTROL ACT**

SEPTEMBER 1, 1997

By signing this bid, the bidder will be deemed to have stipulated as follows:

- a) That any facility to be utilized in the performance of this contract, unless such contract is exempt under the Clean Air Act, as amended (42 U.S.C. 1857 et seq., as amended by Pub. L. 91-604), and under the Federal Water Pollution Control Act, as amended (33 U.S.C. 1251 et seq., as amended by Pub. L. 92-500), Executive Order 11738, and regulations in implementation thereof (40 CFR, Part 15), is not listed on the U.S. Environmental Protection Agency (EPA) List of Violating Facilities pursuant to 40 CFR 15.20.
- b) That the State Transportation Department shall be promptly notified prior to contract award of the receipt by the bidder of any communication from the Director, Office of Federal Activities, EPA, indicating that a facility to be utilized for the contract is under consideration to be listed on the EPA List of Violating Facilities.

* * * *

**STATE OF SOUTH DAKOTA
DEPARTMENT OF TRANSPORTATION**

**SPECIAL PROVISION REGARDING
MINIMUM WAGE ON STATE FUNDED PROJECTS**

APRIL 30, 2013

This proposal contains a copy of the most recent United States Department of Labor (USDOL) Davis-Bacon Act Wage Decision, adopted by the South Dakota Transportation Commission.

If the amount of this contract, as awarded, is \$100,000.00 or more, the following wage provisions will apply:

1. The Contractor and each related subcontractor will pay all laborers and mechanics working at the site of work unconditionally and not less than once a week, and without subsequent deduction or rebate of any account, other than permitted payroll deductions. The Contractor and each related subcontractor must compute the full amount of wages and bona fide fringe benefits (or cash equivalents thereof) due at the time of payment at rates not less than those rates contained in the USDOL Davis-Bacon Act Wage Decision.
2. The Contractor and each related subcontractor will pay their respective employees not less than the USDOL minimum wage for each work classification an employee actually performs at the site of the work.
3. The Contractor and each related subcontractor must submit weekly, for each week in which any contract work is performed, a copy of a completed certified weekly payroll report to the South Dakota Department of Transportation (SDDOT) Labor Compliance Officer (LCO), at the following mailing address, within fourteen (14) calendar days of the end of the workweek

Department of Transportation
Labor Compliance Program
700 E. Broadway Avenue.
Pierre, SD 57501-2586

4. Each submitted certified weekly payroll report must set out accurately and completely all information required by the Instructions for SDDOT Statement of Compliance & Certified Payroll Report (located on the SDDOT Labor Compliance website). Each certified weekly payroll report must include the most recent [SDDOT Statement of Compliance Form](#), signed by the Contractor or related subcontractor or his or her agent who pays or supervises the payment of the persons employed

under the contract. The SDDOT will not accept any payroll report which does not include the most recent [SDDOT Statement of Compliance Form](#).

5. The Contractor and each related subcontractor will maintain payrolls and basic records relating thereto during the course of the work and preserve these records for a period of three (3) years from the date of completion of the contract for all laborers, mechanics, apprentices, trainees, watchmen, and guards working at the site of the work. These records must contain the name, address, social security number of each such worker, his or her correct work classification, and hourly rates of wages paid (including rates of contributions or costs anticipated for bona fide fringe benefits or cash equivalents thereof). The Contractor and each related subcontractor will make these records available for inspection, copying, or transcription by the LCO and will permit the LCO to interview employees during working hours on the site of the work.
6. The SDDOT will upon its own action, or upon written request of an authorized representative of the USDOL, withhold, or cause to be withheld, from the Contractor or related subcontractor under this contract, or any other contract with the same prime Contractor, as much of the accrued payments, advances, or guarantee of funds as may be considered necessary to pay laborers and mechanics, including apprentices, trainees, and helpers employed by the Contractor or any related subcontractor, the full amount of wages required by the contract. In the event the Contractor fails to pay any laborer or mechanic, including any apprentice, trainee, or helper employed or working on the site of the work, all or part of the wages required by the contract, the LCO may, after written notice to the Contractor, take such action as may be necessary to cause the suspension of any further payment, advance, or guarantee of funds under this contract or any other contract with the same prime Contractor until such violations have ceased.

* * * * *

**Wage and Hour Division
U.S. Department of Labor (DOL)
200 Constitution Avenue, N.W.
Washington, DC 20210**

Davis-Bacon Act Wage Decisions

State: South Dakota

Construction Types: Heavy and Highway

Counties: South Dakota Statewide

***SUSD2015-001 08-13-2015**

LABORERS

GROUP GL1

Air Tool Operator; Common Laborer; Landscape Worker; Flagger; Pilot Car Driver;
Trucks under 26,000 GVW; Blue-top Checker; Materials Checker

GROUP GL2

Mechanic Tender (Helper); Pipe Layer (except culvert); Form Builder Tender;
Special Surface Finish Applicator; Striping

GROUP GL3

Asphalt Plant Tender; Pile Driver Leadsman; Form Setter; Oilier/Greaser

GROUP GL5

Carpenter; Form Builder

GROUP GL6

Concrete Finisher; Painter; Grade Checker

POWER EQUIPMENT OPERATORS

GROUP G01

Concrete Paving Cure Machine; Concrete Paving Joint Sealer; Conveyor; Tractor (farm type with
attachments); Self Propelled Broom; Concrete Routing Machine; Paver Feeder; Pugmill; Skid Steer

GROUP G02

Bull Dozer 80 HP or less; Front End Loader 1.25 CY or less; Self Propelled Roller (except Hot Mix);
Sheepsfoot/50Ton Pneumatic Roller; Pneumatic Tired Tractor or Crawler (includes Water Wagon and
Power Spray units); Wagon Drill; Air Trac; Truck Type Auger; Concrete Paving Saw

GROUP G03

Asphalt Distributor; Bull Dozer over 80 HP; Concrete Paving Finishing Machine; Backhoes/ Excavators
20 tons or less; Crusher (may include internal screening plant); Front End Loader over 1.25 CY;
Rough Motor Grader; Self Propelled Hot Mix Roller; Push Tractor; Euclid or Dumpster; Material Spreader;
Rumble Strip Machine

GROUP G04

Asphalt Paving Machine Screed; Asphalt Paving Machine; Cranes/Derricks/Draglines/Pile Drivers/Shovels
30 to 50 tons; Backhoes/Excavators 21 to 40 tons; Maintenance Mechanic; Scrapers; Concrete Pump Truck

GROUP G05

Asphalt Plant; Concrete Batch Plant; Backhoes/Excavators over 40 Tons; Cranes/ Derricks/Draglines/Pile
Drivers/Shovels over 50 tons; Heavy Duty Mechanic; Finish Motor Grader; Automatic Fine Grader;
Milling Machine; Bridge Welder

TRUCK DRIVERS

GROUP GT1

Tandem Truck without trailer or pup; Single Axle Truck over 26,000 GVW with Trailer

GROUP GT2

Semi-Tractor and Trailer; Tandem Truck with Pup

ELECTRICIANS

GROUP E01

Electrician

WELDERS – Receive rate prescribed for craft performing operation to which welding is incidental.

Unlisted classifications needed for work not included within the scope of the classifications listed may be added after award, pursuant to 29 CFR 5.5(a)(1)(ii); contractors are responsible for requesting SDDOT to secure necessary additional work classifications and rates.

*Classifications listed under an "SU" identifier were derived from survey data and the published rate is the weighted average rate of all the rates reported in the survey for that classification. As this weighted average rate includes all rates reported in the survey, it may include both union and non-union rates.

Survey wage rates are not updated and will remain in effect until a new survey is conducted.

Agency: U.S. DOL
Wage Decision Number: **SD150001** SD1
Counties: SD Statewide
Wage Decision Date: **10/09/2015**

Rates	Fringes
15.74	0.00

17.51	0.00
-------	------

18.95	0.00
-------	------

22.77	0.00
-------	------

21.41	0.00
-------	------

16.85	0.00
-------	------

18.13	0.00
-------	------

19.89	0.00
-------	------

20.30	0.00
-------	------

22.75	0.00
-------	------

16.57	0.00
-------	------

18.82	0.00
-------	------

22.79	0.00
-------	------

**Wage and Hour Division
U.S. Department of Labor
200 Constitution Avenue, N.W.
Washington, DC 20210**

Davis-Bacon Act Wage Decisions**State: South Dakota****Construction Types: Heavy and Highway****Counties: South Dakota Statewide**

=====

In the listing above, the "SU" identifier indicates the rates were derived from survey data. As these weighted average rates include all rates reported in the survey, it may include both union and non-union rates. Example: SULA2012-007 5/13/2014. SU indicates the rates are survey rates based on weighted average calculation of rates and are not majority rates. LA indicates the State of Louisiana. 2012 is the year of the survey on which these classifications and rates are based. The next number, 007 in this example, is an internal number used in producing the wage determination. 5/13/2014 indicates the survey completion date for the classifications and rates.

Survey wage rates are not updated and remain in effect until a new survey is conducted.

For SDDOT Defined Work Classifications, please visit: <http://www.sddot.com/business/contractors/labor/wcwr/Default.aspx>

WAGE DETERMINATION APPEALS PROCESS

1.) Has there been an initial decision in the matter? This can be:

- an existing published wage determination
- a survey underlying a wage determination
- a Wage and Hour Division letter setting forth a position on a wage determination matter
- a conformance (additional classification and rate) ruling

On survey related matters, initial contact, including requests for summaries of surveys, should be with the Wage and Hour Regional Office for the area in which the survey was conducted because those Regional Offices have responsibility for the Davis-Bacon survey program. If the response from this initial contact is not satisfactory, then the process described in 2.) and 3.) should be followed.

With regard to any other matter not yet ripe for the formal process described here, initial contact should be with the Branch of Construction Wage Determinations. Write to:

Branch of Construction Wage Determinations
Wage and Hour Division
U.S. Department of Labor
200 Constitution Avenue, N.W.
Washington, DC 20210

2.) If the answer to the question in 1.) is yes, then an interested party (those affected by the action) can request review and reconsideration from the Wage and Hour Administrator (See 29 CFR Part 1.8 and 29 CFR Part 7). Write to:

Wage and Hour Administrator
U.S. Department of Labor
200 Constitution Avenue, N.W.
Washington, DC 20210

The request should be accompanied by a full statement of the interested party's position and by any information (wage payment data, project description, area practice material, etc.) that the requestor considers relevant to the issue.

3.) If the decision of the Administrator is not favorable, an interested party may appeal directly to the Administrative Review Board (formerly the Wage Appeals Board). Write to:

Administrative Review Board
U.S. Department of Labor
200 Constitution Avenue, N.W.
Washington, DC 20210

4.) All decisions by the Administrative Review Board are final.

=====

END OF GENERAL DECISION

**STATE OF SOUTH DAKOTA
DEPARTMENT OF TRANSPORTATION**

**SPECIAL PROVISION
FOR
PRICE SCHEDULE FOR MISCELLANEOUS ITEMS**

OCTOBER 14, 2015

The following unit bid prices have been established by the South Dakota Department of Transportation Commission.

These prices will be pre-entered in the bidding package for each project or will establish a standard price to be used whenever no project contract unit price exists for that item.

Each unit price listed is considered full compensation for the cost of labor, material, and equipment to provide the item of work and/or material, complete in place, including (but not limited to) royalty, waste of unsuitable materials, equipment rental, overhead, profit, and incidentals.

Items specified in this document may be paid for on progressive estimates without the benefit of a prior approved Construction Change Order.

Specification Section Number	Specification Section Name	Item Name	Price per Item
5.8	Construction Stakes, Lines and Grades	Three-Man Survey Crew	\$160.00/hour
7.7	Public Convenience and Safety	Water	\$15.00/M.Gal
9.3	Payment for extra haul of Materials	Extra Haul	\$0.15/ton mile
120.5 A.5.	Roadway and Drainage Exc. & Emb.	Unclassified Excavation Digouts	\$8.00/cu.yd.
120.5 H.	Roadway and Drainage Exc. & Emb.	Extra Haul	\$0.05/cu.yd. station
120.5 I.	Roadway and Drainage Exc. & Emb.	Water for Embankment	\$15.00/M.Gal
421.5	Undercutting Pipe & Plate Pipe	Undercutting Culverts	\$12.00/cu.yd.
510.5 D.	Timber, Prestressed, and Steel Piles	Timber Pile Splice	\$550.00/each

		Steel Pile Splices (*All Weights)	Splice made after one of the pieces has been driven.
		8 HP*	\$220.00/each
		10 HP*	\$300.00/each
		12 HP*	\$360.00/each
		14 HP*	\$420.00/each
			Splice made before either of the pieces has been driven.
		8 HP*	\$105.00/each
		10 HP*	\$125.00/each
		12 HP*	\$140.00/each
		14 HP*	\$160.00/each
510.5 E	Timber, Prestressed, and Steel Piles	Pile Shoes (Timber Pile)	\$110.00/each
510.5.H	Timber, Prestressed, and Steel Piles	Pile Tip Reinforcement (Steel Pile)	
		10" HP Tip Reinforced	\$120.00/each
		12" HP Tip Reinforced	\$140.00/each
		14" HP Tip Reinforced	\$170.00/each
601.5	Haul Roads	Granular Material	\$12.00/ton
601.5	Haul Roads	Asphalt Concrete (including asphalt)	\$80.00/ton
601.5	Haul Roads	Cover Aggregate	\$25.00/ton
601.5	Haul Roads	Asphalt for Prime	\$700.00/ton
601.5	Haul Roads	Asphalt (Tack, Flush & Surface Treatment)	\$450.00/ton
601.5	Haul Roads	Water	\$15.00/M.Gal
601.5	Haul Roads	Dust Control Chlorides	\$0.35/lb
634.5	Temporary Traffic Control	Flagging	\$24.19/hour
634.5	Temporary Traffic Control	Pilot Car	\$38.35/hour

* * * * *