

P 6608(02)
DEUEL COUNTY
DOWN SPOUT RESTORATION
PCN i0zf

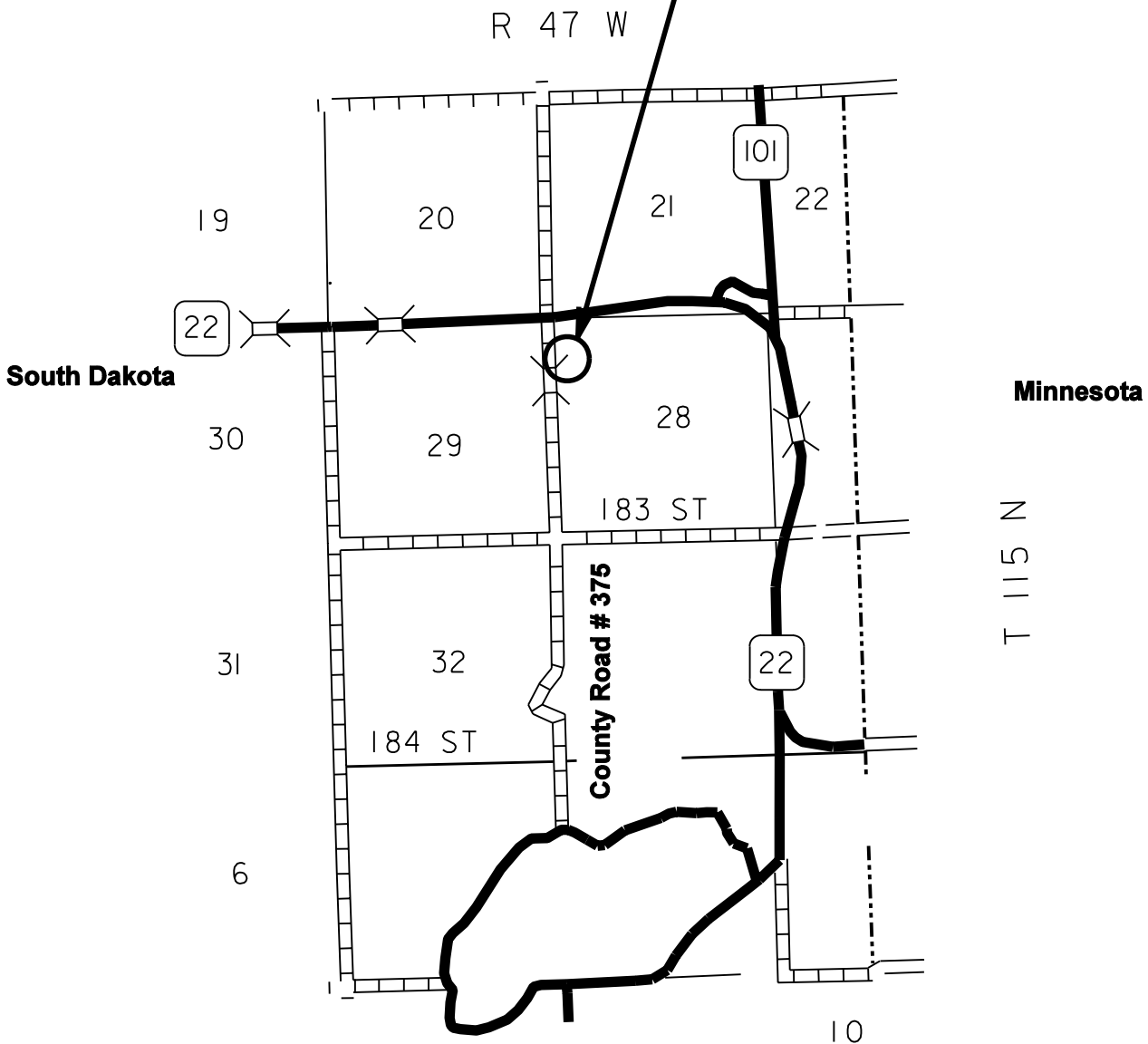

County Road # 375
114+70 - 40' Rt to 115+27 - 50' Rt
24" - 42' CM Pipe Downspout



**P 6608(02)
DEUEL COUNTY**

INDEX OF SHEETS

Sheet 1	Layout Map
Sheet 2	Index of Sheets and Estimate of Quantities
Sheets 3 - 5	Plan Notes
Sheet 6	Plan View
Sheet 7	Standard Plate 634.01

ESTIMATE OF QUANTITIES

BID ITEM NUMBER	ITEM	QUANTITY	UNIT
009E 0010	Mobilization	Lump Sum	LS
009E 0800	General Laborer	1	Hr
110E 7500	Remove Pipe for Reset	42	Ft
110E 7510	Remove Pipe End Section for Reset	2	Ea
120E 0010	Unclassified Excavation	100	CuYd
120E 0600	Contractor Furnished Borrow	100	CuYd
230E 0100	Remove and Replace Topsoil	Lump Sum	LS
450E 9000	Reset Pipe	42	Ft
450E 9001	Reset Pipe End Section	2	Ea
634E 0120	Traffic Control, Miscellaneous	Lump Sum	LS

P 6608(02)
DEUEL COUNTY

SPECIFICATIONS

Standard Specifications for Roads and Bridges, 2004 Edition and Required Provisions, Supplemental Specifications and/or Special Provisions as included in the Proposal.

GENERAL MAINTENANCE OF TRAFFIC

Removing, relocating, covering, salvaging and resetting of permanent traffic control devices, including delineation, shall be the responsibility of the Contractor. Cost for this work shall be incidental to the contract unit prices for the various items unless otherwise specified in the plans. Any delineators and signs damaged or lost shall be replaced by the Contractor at no cost to the State.

Storage of vehicles and equipment shall be outside the clear zone and as near as possible to the right-of-way line. Contractor's employees should mobilize at a location off the right-of-way and arrive at the work sites in a minimum number of vehicles necessary to perform the work.

Indiscriminate driving and parking of vehicles within the right-of-way will not be permitted. Any damage to the vegetation, surfacing, embankment, delineators and existing signs resulting from such indiscriminate use shall be repaired and/or restored by the Contractor, at no expense to the State, and to the satisfaction of the Engineer.

The Contractor shall provide documentation that all breakaway sign supports comply with FHWA NCHRP 350 crash-worthy requirements. The Contractor shall provide installation details at the preconstruction meeting for all breakaway sign support assemblies.

Cost for traffic control, including signing required for the project as indicated on standard plate 634.01, shall be incidental to the contract and included in the contract lump sum price for Traffic Control, Miscellaneous.

Work activities shall be conducted during daylight hours only. During nights, weekends and other non-working hours, all traffic control signs, materials and equipment shall be removed from the ditch and shall be stored a minimum of 30 feet from the traveled lanes.

UTILITIES

The Contractor shall contact the involved utility companies through South Dakota One Call (1-800-781-7474) prior to starting work. It shall be the responsibility of the Contractor to coordinate work with the utility owners to avoid damage to existing facilities.

WASTE DISPOSAL SITE

The Contractor will be required to furnish a site(s) for the disposal of construction/demolition debris generated by this project.

Construction/demolition debris may not be disposed of within the County (Right-of-Way) ROW.

All construction/demolition debris generated by this project shall be cleaned up and disposed of by the Contractor.

The waste disposal site(s) shall be managed and reclaimed in accordance with the following from the General Permit for Highway, Road, and Railway Construction/Demolition Debris Disposal Under the South Dakota Waste Management Program issued by the Department of Environment and Natural Resources.

The waste disposal site(s) shall not be located in a wetland, within 200 feet of surface water, or in an area that adversely affects wildlife, recreation, aesthetic value of an area, or any threatened or endangered species, as approved by the Engineer.

P 6608(02)
DEUEL COUNTY

WASTE DISPOSAL SITE (continued)

If the waste disposal site(s) is located such that it is within view of any ROW, the following additional requirements shall apply:

1. Construction/demolition debris consisting of concrete, asphalt concrete or other similar materials shall be buried in a trench completely separate from wood debris. The final cover over the construction/demolition debris shall consist of a minimum of 1 foot of soil capable of supporting vegetation. Waste disposal sites provided outside of the State ROW shall be seeded in accordance with Natural Resources Conservation Service recommendations. Seeding recommendations may be obtained through the appropriate County NRCS Office. The Contractor shall control the access to waste disposal sites not within the State ROW through the use of fences, gates, and placement of a sign or signs at the entrance to the site stating No Dumping Allowed.
2. Concrete and asphalt concrete debris may be stockpiled within view of the ROW for a period of time not to exceed the duration of the project. Prior to project completion, the waste shall be removed from view of the ROW or buried and the waste disposal site reclaimed as noted above.

The above requirements will not apply to waste disposal sites that are covered by an individual solid waste permit as specified in SDCL 34A-6-58, SDCL 34A-6-1.13, and ARSD 74:27:10:06.

Failure to comply with the requirements stated above may result in civil penalties in accordance with South Dakota Solid Waste Law, SDCL 34A-6-1.31.

Cost for furnishing waste disposal site(s), disposing of waste, maintaining control of access (fence, gates & signs) and reclamation of the waste disposal site(s) shall be incidental to the contract unit prices for the various items.

HISTORICAL PRESERVATION OFFICE CLEARANCES

To obtain SHPO clearance, a cultural resources survey may need to be conducted by a qualified archaeologist. The Contractor shall arrange and pay for this survey. In lieu of a cultural resources survey, the Contractor could request a literature search on the site and provide evidence that the site has been previously disturbed by farming, mining, or construction activities with a landowner statement that no artifacts have been found on the site. Jim Donohue, State Archaeological Research Center at 605-394-1937 shall be contacted for a literature search.

If borrow material is furnished from within the current geographical reservation boundaries or historic boundaries of the Lake Traverse, Yankton, or Flandreau-Santee reservations, the Contractor shall obtain THPO (Tribal Historical Preservation Office) clearance from the Tribal Cultural Resources Officer. This requirement is in addition to the SHPO clearance. If no Tribal contact exists, the required SHPO clearance shall suffice, with documentation of Tribal contact efforts provided to SHPO.

To facilitate SHPO and THPO responses, the Contractor should submit a cultural resources survey report or the results of the literature search along with a legal description of the site, a topographical map with the site clearly marked, and evidence of prior site disturbance to Dave Graves, DOT Environmental Engineer, 700 East Broadway Avenue, Pierre, SD 57501-2586 (605-773-5727). Allow 30 days from the date this information is submitted to the Environmental Engineer for SHPO approval. The Contractor is responsible for obtaining all required permits and clearances for the borrow and/or waste disposal site(s) prior to commencing construction activities at the borrow and/or waste disposal site(s). The Contractor shall provide the required permits and clearances to the Engineer at the preconstruction meeting.

RESTORATION OF INSLOPES AND DITCHES

Any slope area or ditch that is rutted or otherwise unduly disturbed during operations shall be restored and seeded by the Contractor, at no expense to the State. Cost for this work shall be incidental to the contract unit prices for the various items.

P 6608(02)
DEUEL COUNTY

TOP SOIL

Contractor will salvage 4 inches of top soil prior to site excavation and replace when operations are complete. All costs associated with this process will be paid for using the bid item Remove and Replace Top Soil. County will perform re-seeding.

PIPE RE-ALIGNMENT

The 24" CMP Down-Spout will be required to be re-aligned to match the flow line of the ditch. Moving this pipe approximately 11 feet towards the centerline of the road will allow proper drainage. Refer to Sheet **6** for proposed elevations. All costs for pipe and elbow removal and reset shall be incidental to the contract unit price per foot for Remove Pipe for Reset and Reset Pipe.

The end sections will be removed and reset. All costs associated with this process shall be incidental to the contract unit price per each for Remove Pipe End Section for Reset and Reset Pipe End Section.

UNCLASSIFIED EXCAVATION

Some trees may have been buried in the ROW. If trees are discovered in this area, Contractor will be required to remove and dispose of the material and replace it with Contractor Furnished Borrow.

One hour of General Laborer will be paid to the contractor for investigating the area listed on Sheet **6**. The area shall be investigated by digging to a depth of 3 feet. If trees or debris are encountered, contractor will dispose of these items and back fill the area with Contractor Furnished Borrow.

All costs associated with this removal and disposal shall be incidental to the contract unit price per cubic yard for Unclassified Excavation.

P6608(02)
DEUEL COUNTY

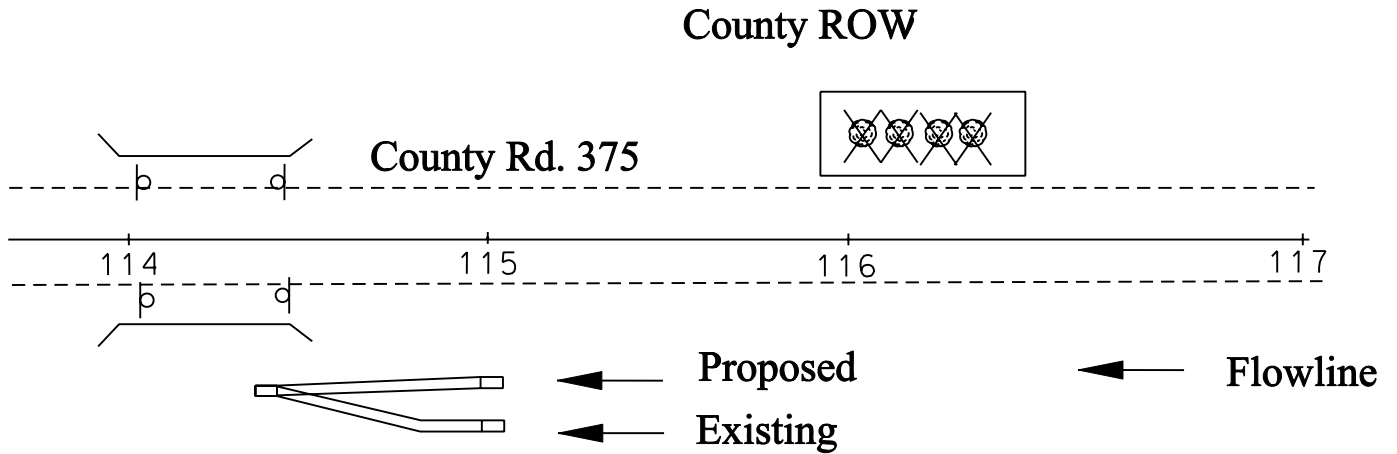
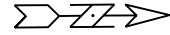

New Inlet Elevation 1620.00

This will match the existing flowline.

This pipe needs to be adjusted about 11 ft closer to the road.

On the west side of CR 375, an area may have trees buried in the ROW.
DOT personnel will stake the area.

The signs illustrated are not required if the work space is behind a barrier, more than 2 feet behind the curb, or 15 feet or more from the edge of any roadway.

The signs illustrated shall be used where there are distracting situations; such as: vehicles parked on shoulder, vehicles accessing the work site via the highway, and equipment traveling on or crossing the roadway to perform work operations.

The ROAD WORK AHEAD sign may be replaced with other appropriate signs, such as the SHOULDER WORK sign. The SHOULDER WORK sign may be used for work adjacent to the shoulder.

* If the work space is on a divided highway, an advance warning sign should also be placed on the left side of the directional roadway.

For short term, short duration, or mobile operations, all signs and channelizing devices may be eliminated if a vehicle with an activated flashing or revolving yellow light is used.

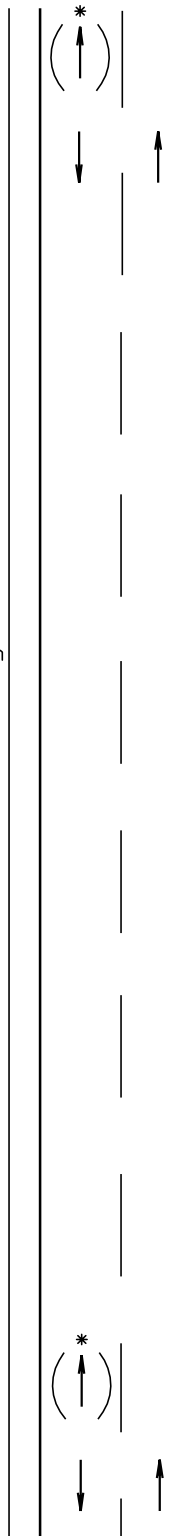

Posted Speed Prior to Work (M.P.H.)	Spacing of Advance Warning Signs (Feet) (A)
0 - 30	200
35 - 40	350
45 - 50	500
55	750
60 - 75	1000

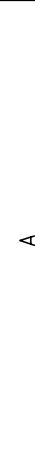

July 1, 2005

Published Date: 3rd Qtr. 2008

**S
D
D
O
T**

**GUIDES FOR TRAFFIC CONTROL DEVICES
 WORK BEYOND THE SHOULDER**

PLATE NUMBER
634.01

Sheet 1 of 1