

PLOT SCALE - 200,000000:1,000000

PLOTTED FROM - TRRC15324

STATE OF SOUTH DAKOTA  
DEPARTMENT OF TRANSPORTATION  
PLANS FOR PROPOSED

| STATE OF SOUTH DAKOTA | PROJECT    | SHEET NO. | TOTAL SHEETS |
|-----------------------|------------|-----------|--------------|
|                       | 410 D285() | 1         | 3            |

Plotting Date: 05-DEC-2008

PROJECT 410 D285()  
OELRICHS MAINTENANCE YARD  
FALL RIVER COUNTY

ASPHALT CONCRETE RESURFACING  
PCN 1160

INDEX OF SHEETS

- Sheet 1: Title Sheet
- Sheet 2: Estimate of Quantities and Plan Notes
- Sheet 3: Project Layout

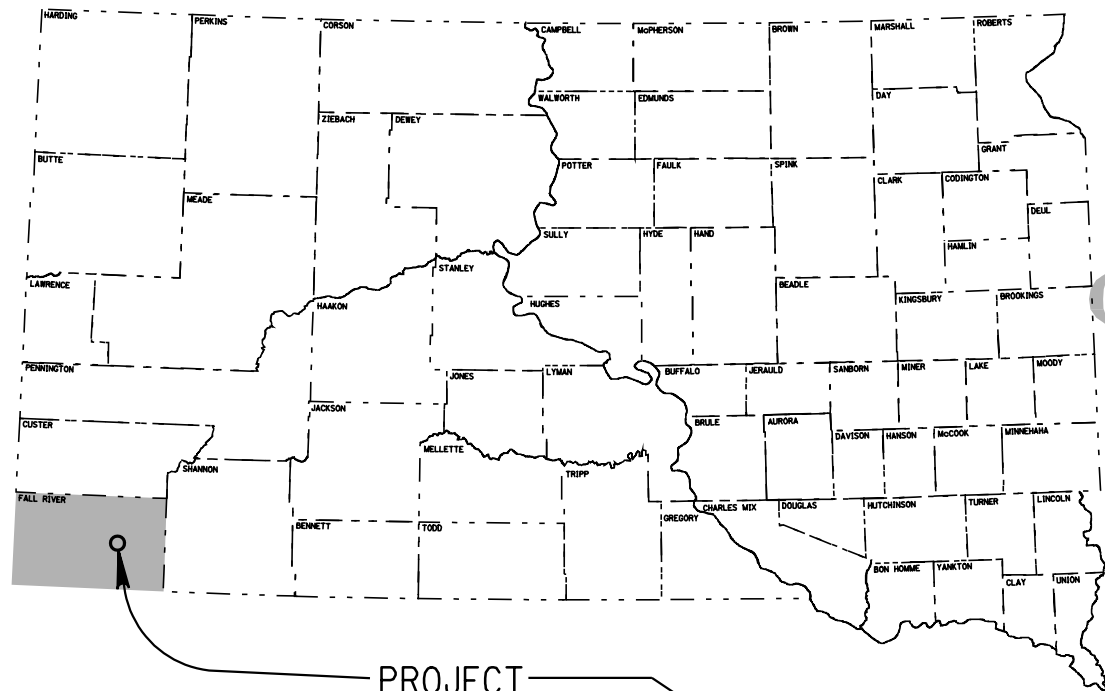

PROJECT

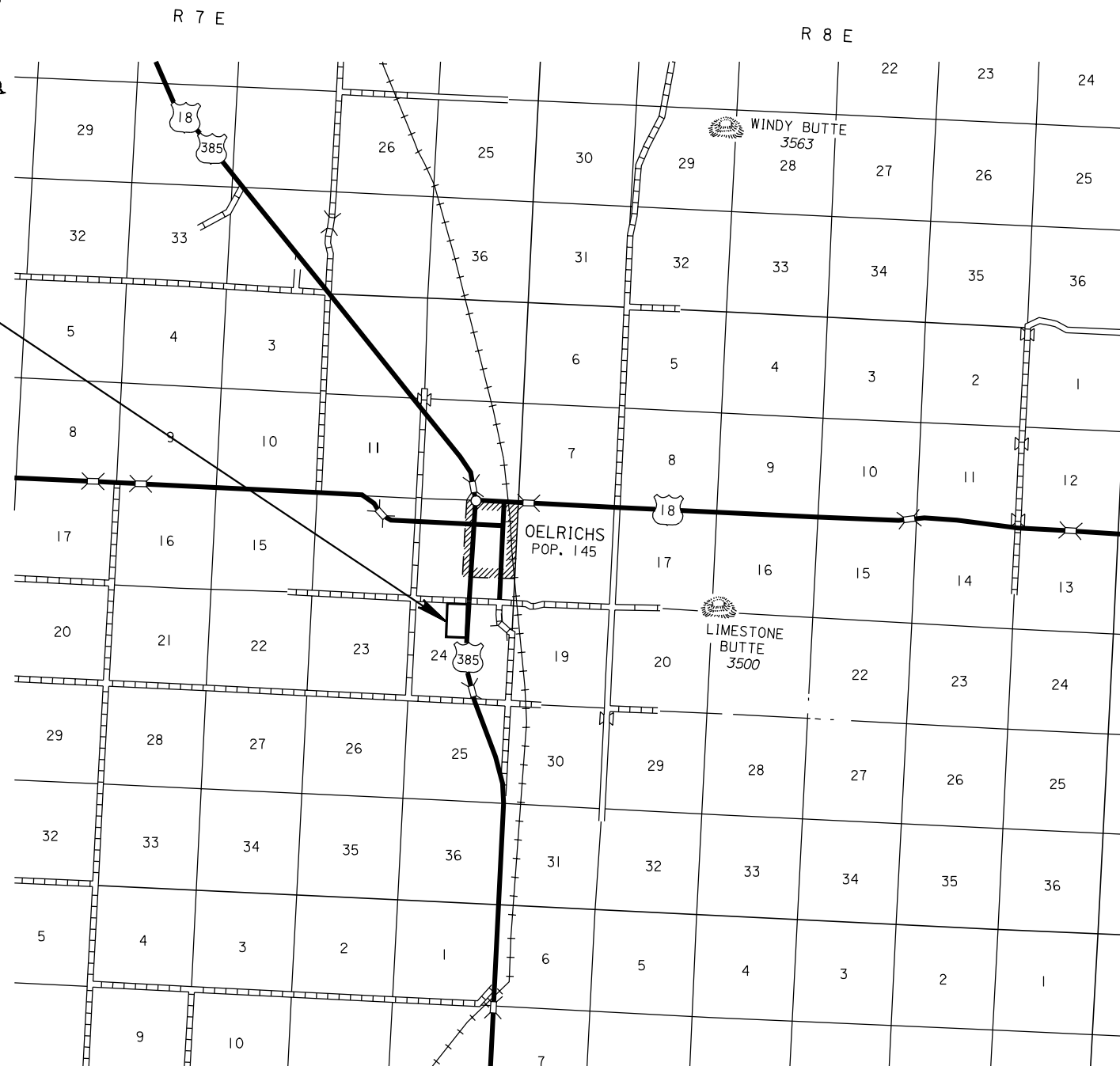

T 10 S

FILE - U:\REGIONRC\PR\2009\RCREGMAINT\PLANS\OELRICHS YARD\_119\TITLE.DGN PLOT NAME - 1

**ESTIMATE OF QUANTITIES**

| BID ITEM NUMBER | ITEM                       | QUANTITY | UNIT |
|-----------------|----------------------------|----------|------|
| 009E0010        | Mobilization               | Lump Sum | LS   |
| 320E1200        | Asphalt Concrete Composite | 840      | Ton  |

**SPECIFICATIONS**

Standard Specifications for Roads and Bridges, 2004 Edition and Required Provisions, Supplemental Specifications and/or Special Provisions as included in the Proposal.

**UTILITIES**

The Contractor will be responsible for locating (SD One-Call 1-800-781-7474) and protecting all utilities within the project limits. Any damage done to a utility will be the Contractor's responsibility to repair at no cost to the State.

**WORK DESCRIPTION**

Work under this project will include the following:

- Asphalt concrete paving of Oelrichs Maintenance Yard.

The overall completion date for this project is 10/2/09.

**ASPHALT CONCRETE COMPOSITE**

Asphalt Concrete Composite shall be furnished by the Contractor.

Mineral aggregate for the Asphalt Concrete Composite shall conform to the requirements of the Standard Specifications for Class E, Type 1.

All other requirements in the Standard Specifications for Asphalt Concrete Composite shall apply.

The asphalt binder used in the mixture shall be PG 64-22, PG 64-28 or PG 64-34 Asphalt Binder.

Asphalt Concrete Composite shall be applied at a thickness of 2 inches when being placed over existing asphalt concrete and 4 inches in areas without existing asphalt concrete. The maximum thickness of each lift is specified in Section 324.3B.

Location and quantity shown in the plans are approximate. Exact locations are to be set by the Engineer. The Engineer reserves the right to adjust quantities and/or add locations dependent on the condition of the Yard at the time of the work.

**TRAFFIC CONTROL**

Work activities during non-daylight hours are subject to prior approval. Daylight hours are considered to be ½ hour before sunrise until ½ hour after sunset.

To allow for employee parking modifications, a 24 hour advanced notice of work is required.

Access to fuel pumps is required at all times.

|                       |            |       |              |
|-----------------------|------------|-------|--------------|
| STATE OF SOUTH DAKOTA | PROJECT    | SHEET | TOTAL SHEETS |
|                       | 410 D285() | 2     | 3            |



**SITE PREPARATION**

Site preparation will be completed by the SDDOT. The Contractor shall give a minimum of two week notice to Clarence Bowman, phone number 745-5103, prior to the start of paving.

|                             |         |              |                 |
|-----------------------------|---------|--------------|-----------------|
| STATE OF<br>SOUTH<br>DAKOTA | PROJECT | SHEET<br>NO. | TOTAL<br>SHEETS |
|                             | 410D285 | 3            | 3               |

Plotting Date: 05-DEC-2008

# PROJECT LAYOUT

-  2" Asphalt Concrete Composite
-  4" Asphalt Concrete Composite

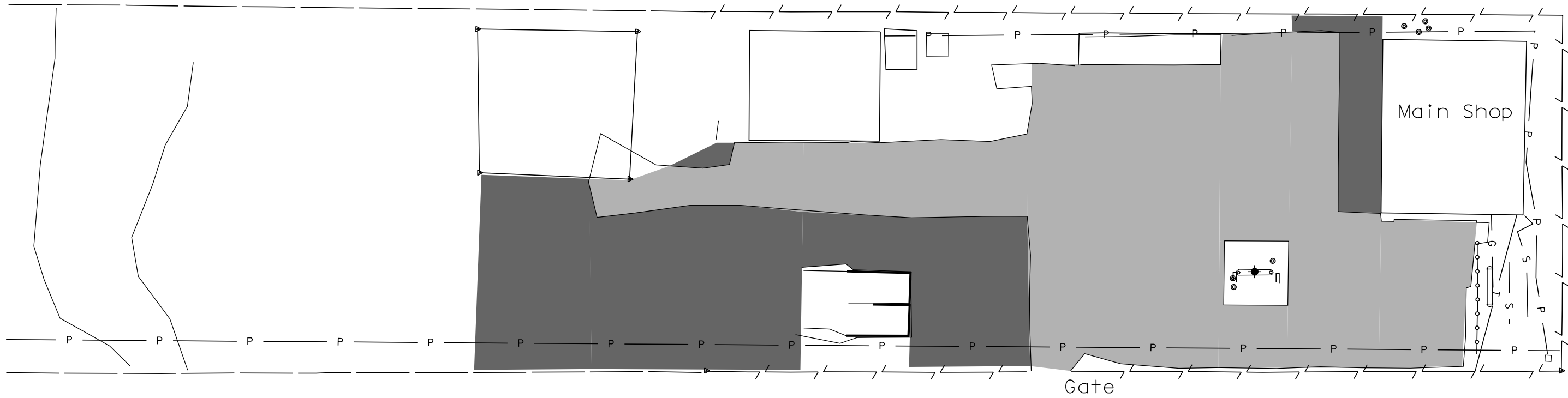
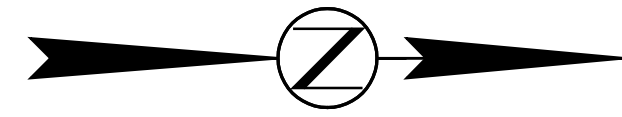

1"=50'

PLOT SCALE - 48.52941211.0000000

PLOTTED FROM - TRRC15324

FILE - U:\REGIONRC\PRJ\2009\REGMAINT\PLANS\OELRICHS YARD\_119U\EFILE.DGN PLOT NAME - 3