

STATE OF SOUTH DAKOTA	PROJECT	SHEET NO.	TOTAL SHEETS
	410 D301	1	3

Plotting Date: 10-AUG-2009

PROJECT 410 D301 LEMMON MAINTENANCE YARD PERKINS COUNTY

ASPHALT CONCRETE SURFACING
PCN I1L1

INDEX OF SHEETS

SHEET 1:	TITLE SHEET
SHEET 2:	ESTIMATE OF QUANTITIES AND PLAN NOTES
SHEET 3:	PROJECT LAYOUT

PLOT SCALE - 200,000000:1,000000

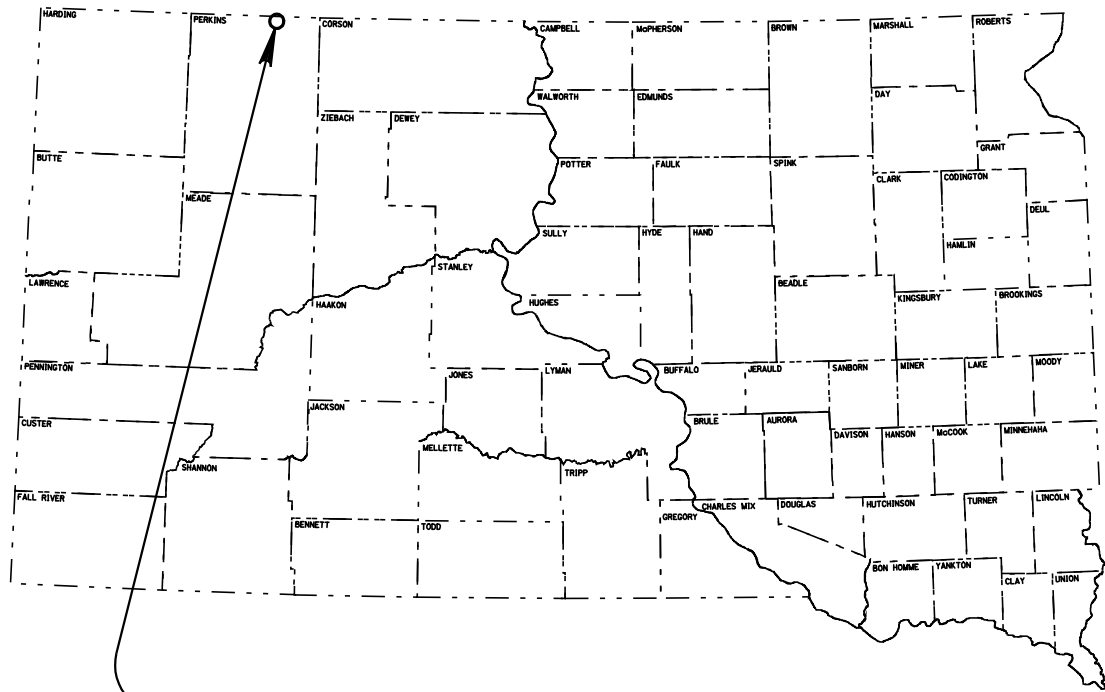

PROJECT

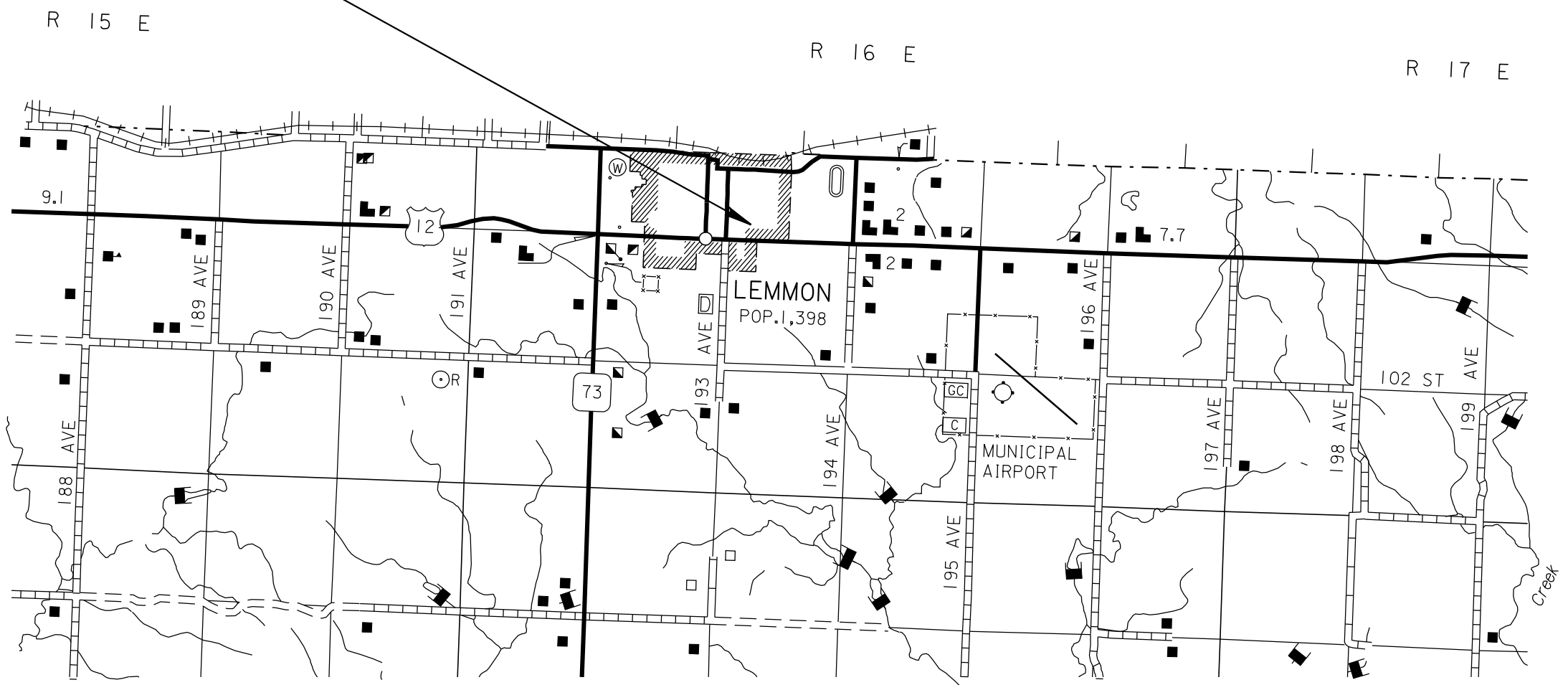

T 23 N

PLOTTED FROM - TRBEINT18

FILE - U:\REGIONRC\PR\2009\RCREGMAINT\PLANS\LEMMON YARD I1L1\TITLEC.DGN PLOT NAME - TITLE

ESTIMATE OF QUANTITIES

Bid Item Number	Item	Quantity	Unit
009E0010	Mobilization	Lump Sum	LS
320E1200	Asphalt Concrete Composite	432.0	Ton

Alternate Bid Items

Alternate Bid Item Number	Item	Quantity	Unit
320E1200	Asphalt Concrete Composite (Alternate #1)	211.0	Ton
320E1200	Asphalt Concrete Composite (Alternate #2)	144.0	Ton
320E1200	Asphalt Concrete Composite (Alternate #3)	214.0	Ton

SPECIFICATIONS

Standard Specifications for Roads and Bridges, 2004 Edition and Required Provisions, Supplemental Specifications and/or Special Provisions as included in the Proposal.

UTILITIES

The Contractor will be responsible for locating (SD One-Call 1-800-781-7474) and protecting all utilities within the project limits. Any damage done to a utility will be the Contractor's responsibility to repair at no cost to the State.

WORK DESCRIPTION

Work under this project will include the following:

- Asphalt concrete paving of Lemmon Maintenance Yard.

The overall completion date for this project is June 4, 2010.

ASPHALT CONCRETE COMPOSITE

Asphalt Concrete Composite shall be furnished by the Contractor.

Mineral aggregate for the Asphalt Concrete Composite shall conform to the requirements of the Standard Specifications for Class E, Type 1 or Class Q2.

All other requirements in the Standard Specifications for Asphalt Concrete Composite shall apply.

The asphalt binder used in the mixture shall be PG 64-22, PG 64-28 or PG 64-34 Asphalt Binder.

Asphalt Concrete Composite shall be applied at a thickness of 2 inches over existing asphalt and 4 inches over gravel. The maximum thickness of each lift is specified in Section 324.3B.

The seasonal limitations of Section 320.3.A shall be waived provided the minimum temperature requirements are met.

Location and quantity shown in the plans are approximate. Exact locations are to be set by the Engineer. The Engineer reserves the right to adjust quantities and/or add locations dependent on the condition of the Yard at the time of the work.

TRAFFIC CONTROL

Work activities during non-daylight hours are subject to prior approval. Daylight hours are considered to be ½ hour before sunrise until ½ hour after sunset.

To allow for employee parking modifications, a 24 hour advanced notice of work is required.

Access to fuel pumps is required at all times.

STATE OF SOUTH DAKOTA	PROJECT	SHEET	TOTAL SHEETS
	410 D301	2	3

SITE PREPARATION

Site preparation will be completed by the SDDOT. The Contractor shall give a minimum of two weeks notice to Joel Larson, phone number 892-5501, prior to the start of paving.

EXPLANATION OF ALTERNATES

The Contractor shall provide a unit price added to the base bid that it would cost to provide all materials, labor, equipment, etc. to pave the alternate areas shown in these plans.

Method of Award

If the combined bid consisting of the base bid plus the alternate additive bids is within the amount of funds available to finance the full, combined construction contract, and the State wishes to accept the alternate additive bids, then award will be made to that responsible bidder submitting the low combined bids.

If the combined bid consisting of the base bid plus the alternate additive bids is not within the amount of funds available to finance the full construction contract, the State reserves the right to make an award based on the low base bid only, and reject the alternate additive bids. The contract award will then be made to that responsible bidder submitting the low base bid.

If the base bid alone is not within the amount of funds available to construct the project, the State reserves the right to reject the base bid.

STATE OF SOUTH DAKOTA	PROJECT 410 D301	SHEET NO. 3	TOTAL SHEETS 3
-----------------------	---------------------	----------------	-------------------

Plotting Date: 26-AUG-2009

PROJECT LAYOUT



PLOT SCALE - 40.501201:1.000000

PLOTTED FROM - TRRC11951

FILE - U:\REGION\RC\PR\2009\RCREGMAINT\PLANS\LEMMON YARD ILL\PROJECTLAYOUT.PDW NAME - 3

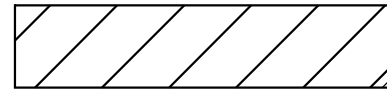

4" ASPHALT CONCRETE COMPOSITE (NEW)
(approx. 17,500 sqft)

Alternate Area #1 (124' x 69') = 8556 sqft.
Alternate Area #2 (124' x 47') = 5828 sqft.
Alternate Area #3 (70' x 124') = 8680 sqft.
Total = 23,064 sqft.

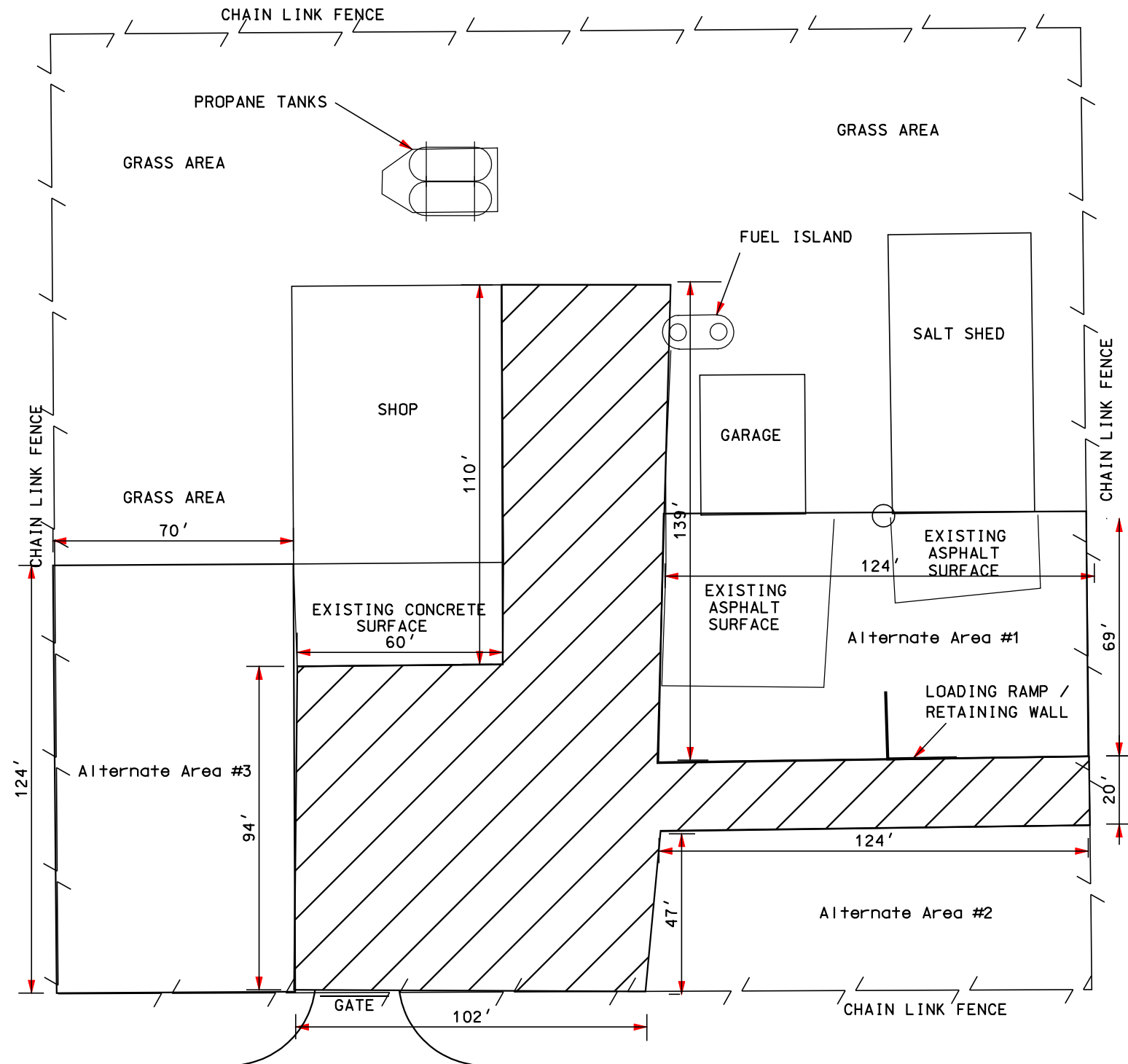

US Highway 12