

STATE OF SOUTH DAKOTA  
DEPARTMENT OF TRANSPORTATION  
PLANS FOR PROPOSED

**PROJECTS 3781C, 3763C & 3733C**  
**SDDOT ISABEL MAINTENANCE YARD,**  
**SELBY STOCKPILE SITE,**  
**MCINTOSH STOCKPILE SITE**  
**DEWEY, WALWORTH AND CORSON COUNTIES**

COVER AGGREGATE STOCKPILES

PCN I2K5, I2K6 & I2K4

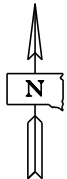
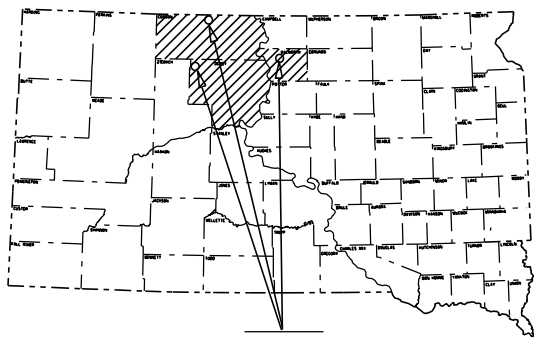

NO SCALE

Isabel Maintenance Yard  
Stockpile Number 3781C  
Dewey County  
(SE1/4 SEC 32 T17N R22E)

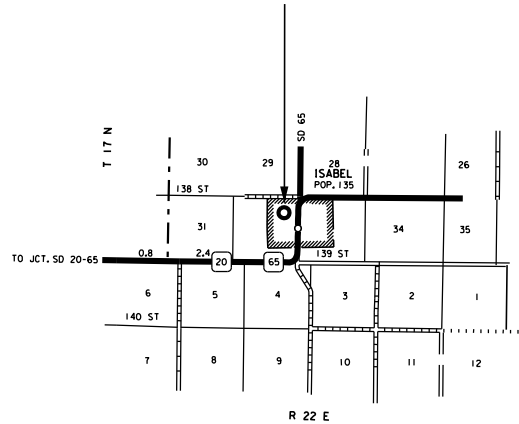

Selby Stockpile Site  
Stockpile Number 3763C  
Walworth County  
(NW1/4 SEC 32 T124N R76W)

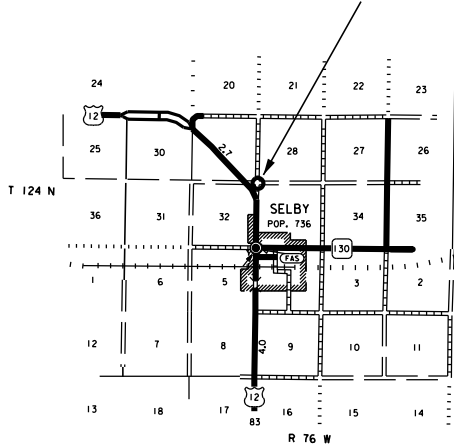

McIntosh Stockpile Site  
Stockpile Number 3733C  
Corson County  
(NE1/4 SEC 25 T23N R22E)

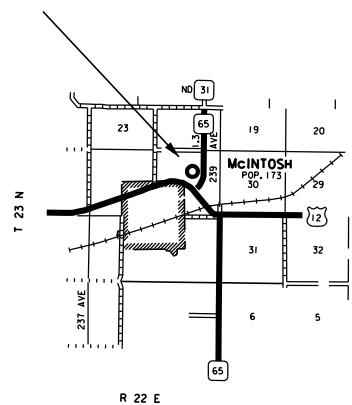

## **INDEX OF PLAN SHEETS**

SHEET NO. 1	LAYOUT MAPS
SHEET NO. 2	INDEX OF PLAN SHEETS AND ESTIMATE OF QUANTITIES
SHEET NO. 3	SPECIFICATIONS & NOTES
SHEET NO. 4	STANDARD PLATES

## **ESTIMATE OF QUANTITIES**

<b>Bid Item Number</b>	<b>Item</b>	<b>Quantity</b>	<b>Unit</b>
<b>009E0010</b>	<b>Mobilization</b>	<b>Lump Sum</b>	<b>LS</b>
<b>360E1200</b>	<b>Modified Cover Aggregate</b> (Isabel Maintenance Yard) Stockpile # 3781C	<b>3000</b>	<b>Ton</b>
<b>360E1200</b>	<b>Modified Cover Aggregate</b> (1 Mi. N. of Selby on US12-83) Stockpile # 3763C	<b>3000</b>	<b>Ton</b>
<b>360E1200</b>	<b>Modified Cover Aggregate</b> (1 Mi. E. of McIntosh & 0.5 N. on SD 65) Stockpile # 3733C	<b>3000</b>	<b>Ton</b>

## **SPECIFICATIONS**

Standard Specifications for Roads and Bridges, 2004 Edition and Required Provisions, Supplemental Specifications and/or Special Provisions as included in the Proposal.

### **MODIFIED COVER AGGREGATE**

Aggregate for Cover Aggregate shall conform to the following gradation requirements:

Passing a 3/8 Inch Sieve	100%
Passing a No. 4 Sieve	0-75%
Passing a No. 8 Sieve	0-30%
Passing a No. 40 Sieve	0-6%
Passing a No. 200 Sieve	0-3.0%

Aggregate may be crushed or uncrushed.

All other requirements of the Standard Specifications (Section 881) for Type 1B shall apply.

The contract unit price per ton shall include all costs for furnishing and stockpiling the modified cover aggregate.

### **MAINTENANCE OF TRAFFIC**

The Contractor shall furnish and install 48" x 48" TRUCK CROSSING signs, W8-6, to be placed on State or County highways or other well-traveled roadways. The signs shall be located a minimum of 550' in advance of intersections and approaches to the highway where the haul route crosses or turns onto/from the highway. The TRUCK CROSSING signs shall be installed for both directions of traffic travel. The exact number and location of the signs will be determined based on the pit location and haul road approved for use.

The TRUCK CROSSING signs shall be displayed at all times when the haul vehicles are hauling material from the pit to the stockpile site. During non-working hours, the signs shall be covered or removed from view. Hinged signs may be used. There will be no direct payment for the TRUCK CROSSING signs. All costs for furnishing, installation, maintenance and removal of the signs shall be absorbed in the various contract items.

### **HAUL ROADS**

The Contractor shall be responsible for any haul roads used to transport material to the stockpile site. The State will not participate in the cost of restoration of any haul roads used by the Contractor.

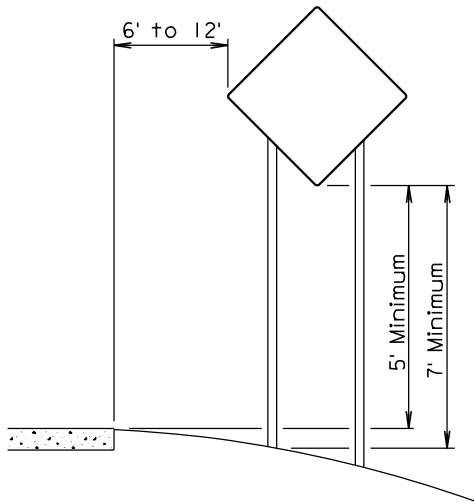

RURAL DISTRICT

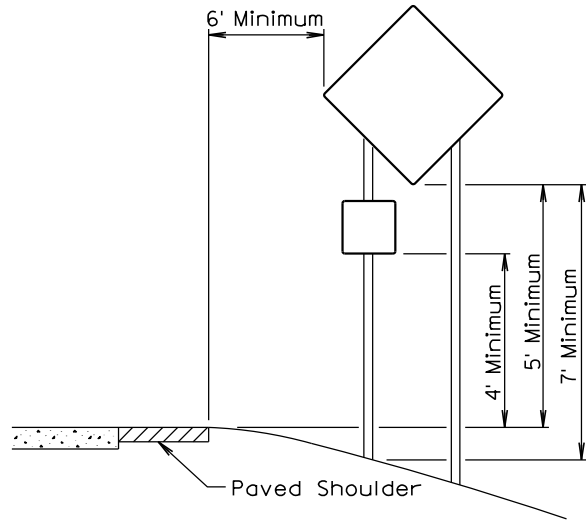

RURAL DISTRICT WITH  
SUPPLEMENTAL PLATE

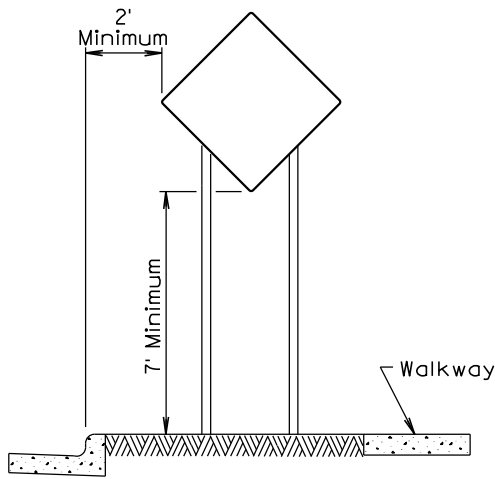

URBAN DISTRICT

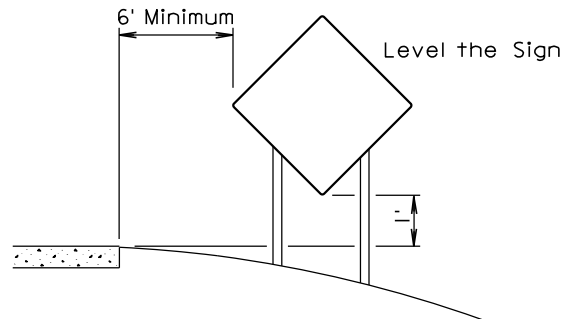

RURAL DISTRICT  
3 DAY MAXIMUM

February 14, 2011

Published Date: 2nd Qtr. 2012

**S  
D  
D  
O  
T**

**CRASHWORTHY SIGN SUPPORTS**  
(Typical Construction Signing)

PLATE NUMBER  
**634.85**

Sheet 1 of 1