

STATE OF SOUTH DAKOTA
 DEPARTMENT OF TRANSPORTATION
 PLANS FOR PROPOSED

STATE OF SOUTH DAKOTA	PROJECT	SHEET NO.	TOTAL SHEETS
	410D358	1	3

Plotting Date: 03/15/2013

PROJECT 410D358
SPEARFISH MAINTENANCE YARD
LAWRENCE COUNTY

ASPHALT CONCRETE SURFACING
 PCN 12U7

INDEX OF SHEETS

- Sheet No. 1: Title Sheet
- Sheet No. 2: Estimate of Quantities and Plan Notes
- Sheet No. 3: Plan Sheet

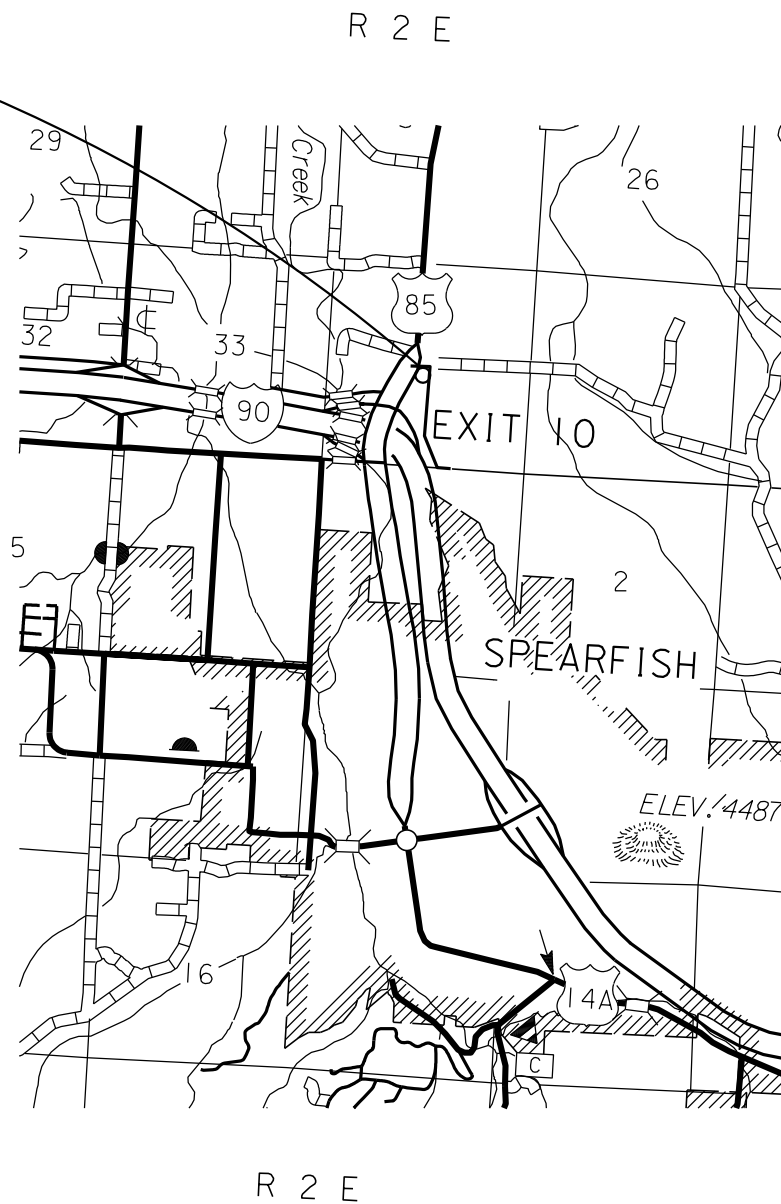
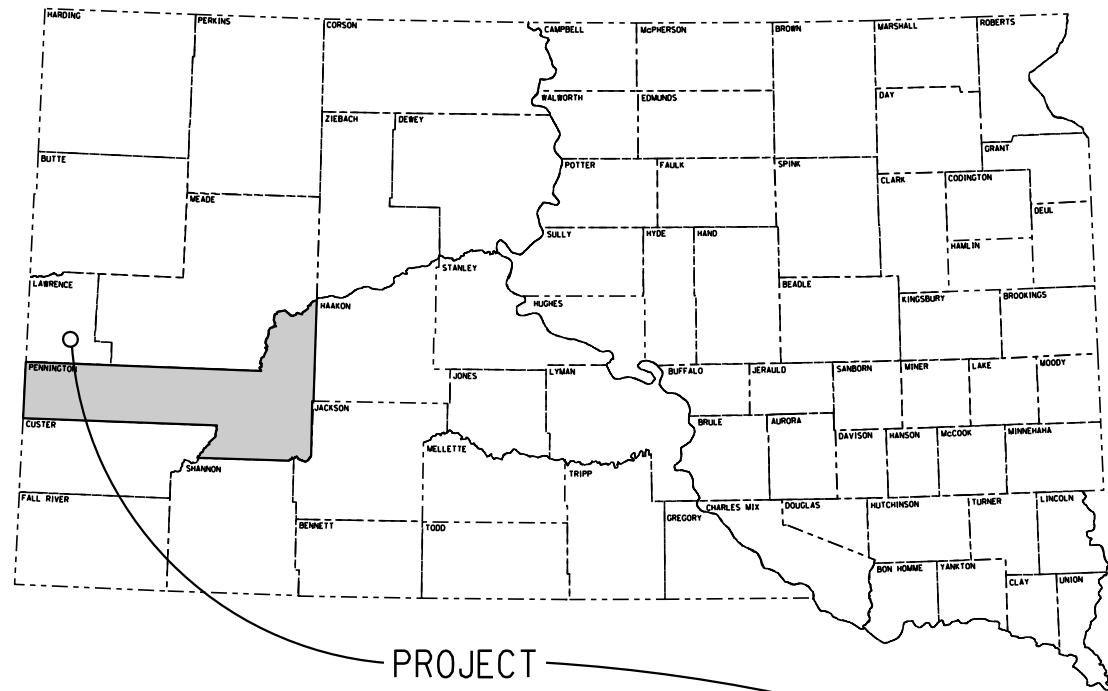

Plot Scale - 1:200

Plotted From - trcs11640

File - ...Title.dgn

ESTIMATE OF QUANTITIES

STATE OF SOUTH DAKOTA	PROJECT	SHEET	TOTAL SHEETS
	410D358	2	3

Bid Item Number	Item	Quantity	Unit
009E0010	Mobilization	Lump Sum	LS
320E1200	Asphalt Concrete Composite	824.0	Ton

SPECIFICATIONS

Standard Specifications for Roads and Bridges, 2004 Edition and Required Provisions, Supplemental Specifications and/or Special Provisions as included in the Proposal.

WORK DESCRIPTION

Work on this project includes asphalt concrete paving of the Spearfish DOT Maintenance Yard and approach road.

The overall completion date for this project is September 1, 2013.

ASPHALT CONCRETE COMPOSITE

Asphalt Concrete Composite shall be furnished by the Contractor.

Mineral aggregate for the Asphalt Concrete Composite shall conform to the requirements of the Standard Specifications for Class E, Type 1. The Asphalt Concrete Composite shall be placed in 2 – 2" lifts for a total thickness of 4" in the main yard and 1 – 1 1/2" lift placed on the approach road.

All other requirements in the Standard Specifications for Asphalt Concrete Composite shall apply.

The asphalt binder used in the mixture shall be PG 64-22, PG 64-28 or PG 64-34 Asphalt Binder.

SS1-h or CSS1-h Emulsified Asphalt for Tack shall be applied to the first lift of Asphalt Concrete Composite in the main yard and on the existing approach road prior to the overlay at a rate of 0.05 gallons per square yard.

Location and quantity shown in the plans are approximate. Exact locations are to be set by the Engineer. The Engineer reserves the right to adjust quantities and/or add location dependent on the condition of the Yard at the time of the work.

TRAFFIC CONTROL

Work activities during non-daylight hours are subject to prior approval. Daylight hours are considered to be ½ hour before sunrise until ½ hour after sunset.

A 2 week advanced notice of work is required.

SITE PREPARATION

Site preparation will be completed by the SDDOT.

STATE OF SOUTH DAKOTA	PROJECT	SHEET	TOTAL SHEETS
	410D358	3	3

Plotting Date: 03/14/2013

SPEARFISH MAINTENANCE SHOP

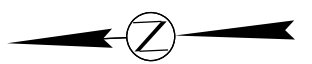

PLOT SCALE - 1:48

PLOT NAME - 1

FILE - ... \PLAN.DGN

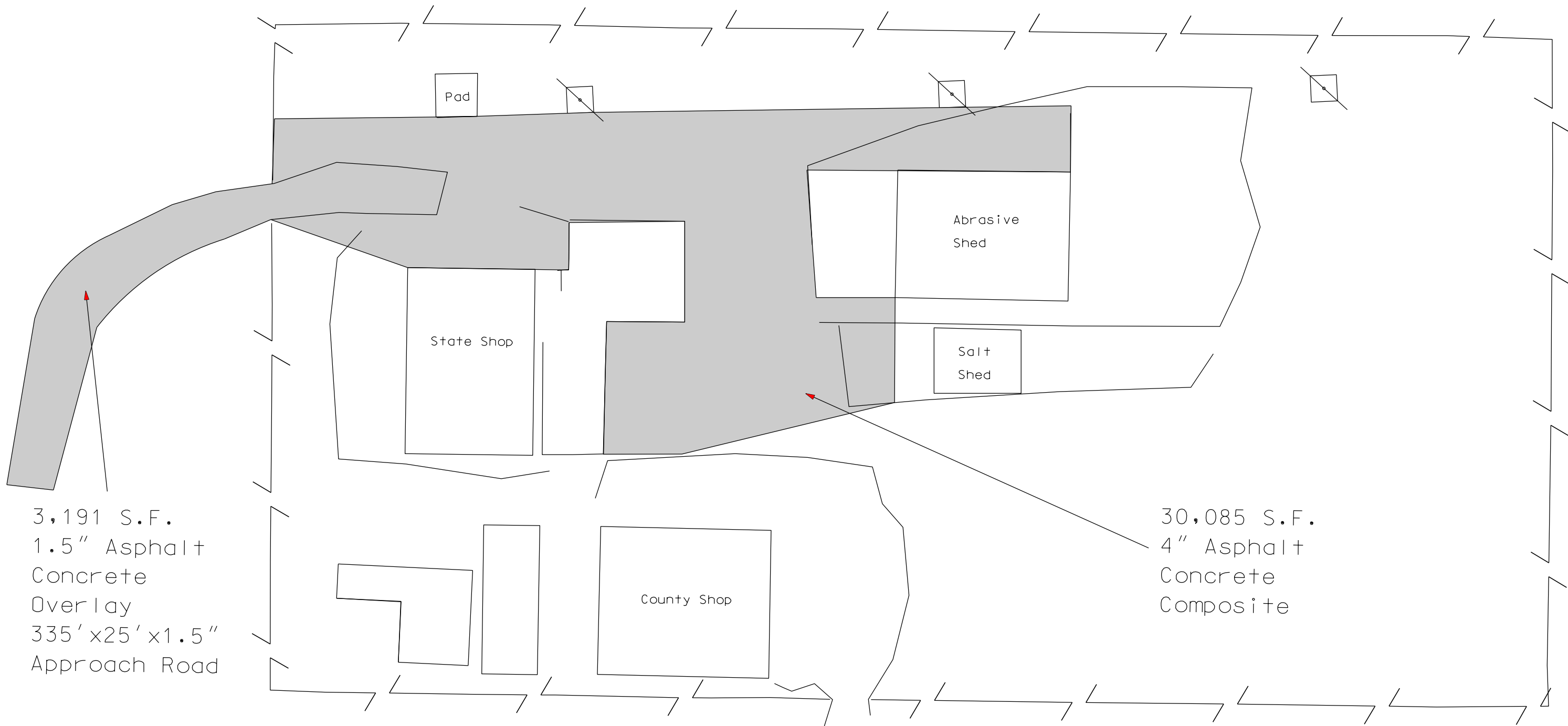

3,191 S.F.
1.5" Asphalt
Concrete
Overlay
335' x 25' x 1.5"
Approach Road

30,085 S.F.
4" Asphalt
Concrete
Composite

PLOTTED FROM - TRRC11640