

STATE OF SOUTH DAKOTA	PROJECT	SHEET NO.	TOTAL SHEETS
	410D373	1	3

Plotting Date: 05/13/2014

INDEX OF SHEETS

- Sheet 1: Title Sheet
- Sheet 2: Estimate of Quantities & General Notes
- Sheet 3: Plan View

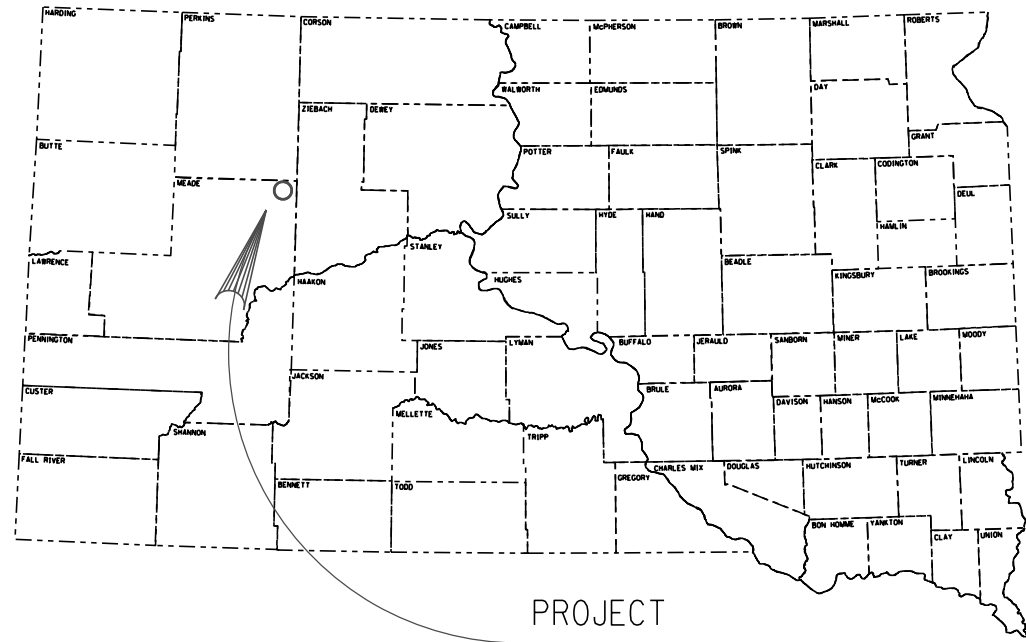

STATE OF SOUTH DAKOTA  
DEPARTMENT OF TRANSPORTATION  
PLANS FOR PROPOSED  
**PROJECT NO. 410D373**  
**FAITH MAINTENANCE YARD**  
**MEADE COUNTY**  
ASPHALT CONCRETE OVERLAY  
PCN i3e6



SD DEPARTMENT OF TRANSPORTATION  
BELLE FOURCHE AREA  
FAITH MAINTENANCE YARD

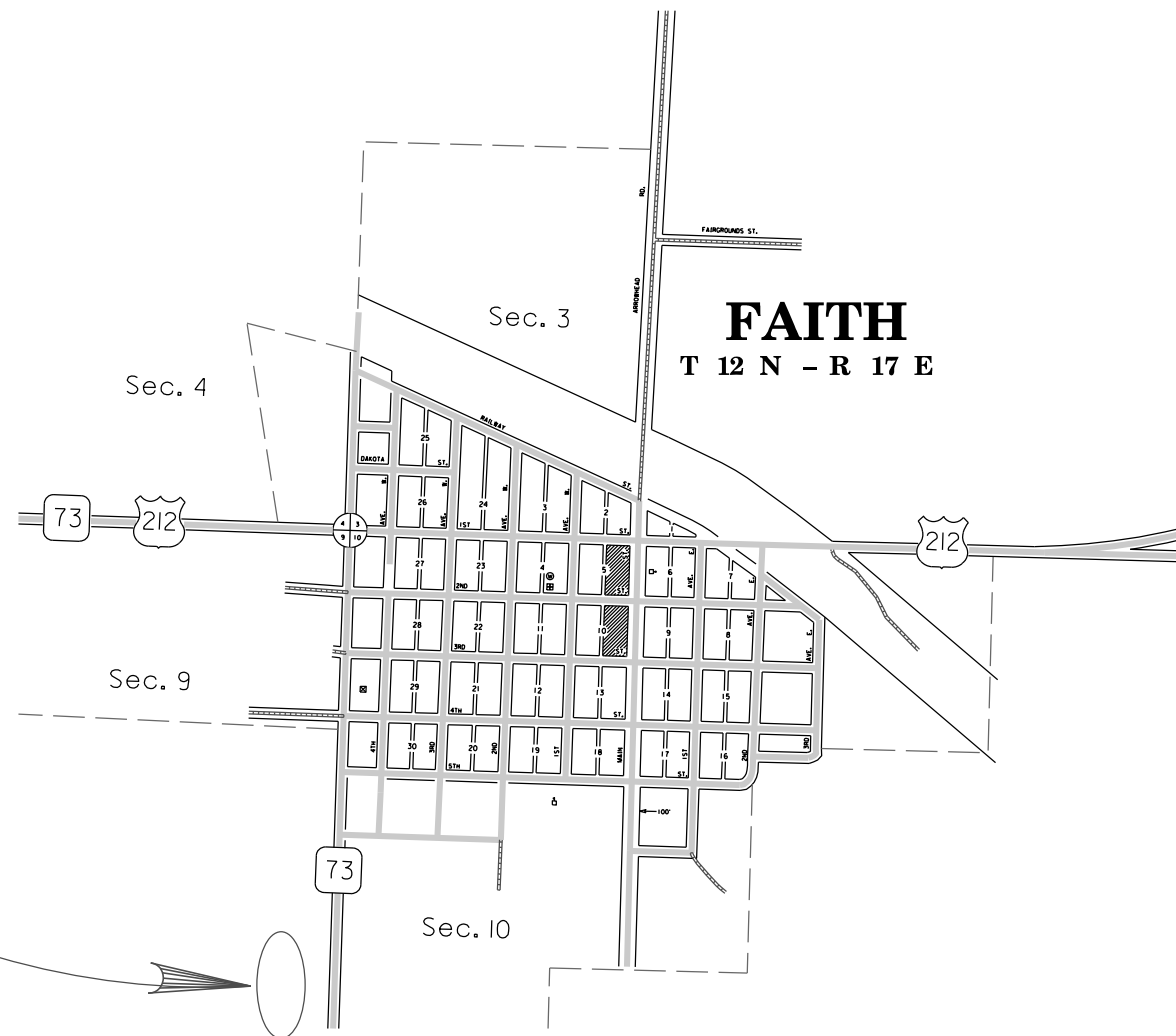

## ESTIMATE OF QUANTITIES

Bid Item Number	Item	Quantity	Unit
009E0010	Mobilization	Lump Sum	LS
320E1200	Asphalt Concrete Composite	1,204.0	Ton
634E0100	Traffic Control	68	Unit

## SPECIFICATIONS

Standard Specifications for Roads and Bridges, 2004 Edition and Required Provisions, Supplemental Specifications and/or Special Provisions as included in this Proposal.

## UTILITIES

The Contractor will be responsible for locating (SD One-Call 1-800-781-7474) and protecting all utilities within the project limits. Any damage done to a utility will be the Contractor's responsibility to repair at no cost to the State.

## WORK DESCRIPTION

Work on this project includes an asphalt concrete overlay of the Faith Maintenance Yard.

## ASPHALT CONCRETE COMPOSITE

The estimated square footage of Asphalt Concrete Composite as per these plans is 50,291 square feet of which 2,285 square feet will be a 2" overlay and 48,006 square feet will be a 4" overlay.

Asphalt Concrete Composite shall be furnished and placed by the Contractor.

Mineral aggregate for the Asphalt Concrete Composite shall conform to the requirements of the Standard Specifications for Class E, Type 1. The Asphalt Concrete Composite shall be placed in 1-2" lift for a total thickness of 2" or 2 - 2" lifts for a total thickness of 4".

All other requirements in the Standard Specifications for Asphalt Concrete Composite shall apply.

The asphalt binder used in the mixture shall be PG 58-28, PG 64-22, PG 64-28 or 64-34 Asphalt Binder.

SS-1h or CSS-1h Emulsified Asphalt for Tack shall be applied to the existing surfacing at the rate of 0.05 gallons per square yard.

Location and quantity shown in the plans are approximate. Exact locations are to be set by the Engineer. The Engineer reserves the right to adjust quantities and/or add location dependent on the condition of the yard at the time of the work.

## TRAFFIC CONTROL

Work activities during non-daylight hours are subject to prior approval. Daylight hours are considered to be ½ hour before sunrise until ½ hour after sunset.

A 48 hour advanced notice of work is required.

## TABLE OF TRAFFIC CONTROL DEVICES

The quantity of signs on portable or temporary supports paid for will be for the greatest number of installations per sign in place at any one time regardless of the number of set-ups for the entire project.

SIGN CODE	DESCRIPTION	NUMBER REQUIRED	CONVENTIONAL ROAD		EXPRESSWAY/ INTERSTATE*		UNITS PER SIGN	UNITS
			SIGN SIZE	UNITS PER SIGN	NUMBER REQUIRED	SIGN SIZE		
W8-6	TRUCK CROSSING	2	48" x 48"	34		48" x 48"	34	68
<b>TOTAL UNITS</b>								<b>68</b>

## SITE PREPARATION

Site preparation will be completed by the SDDOT. The Contractor shall give a 2 week notice prior to starting to allow SDDOT time to complete milling and grading the salvaged base.

STATE OF SOUTH DAKOTA	PROJECT	SHEET NO.	TOTAL SHEETS
	410D373	3	3

Plotting Date: 04/02/2014

# FAITH OVERLAY PLAN

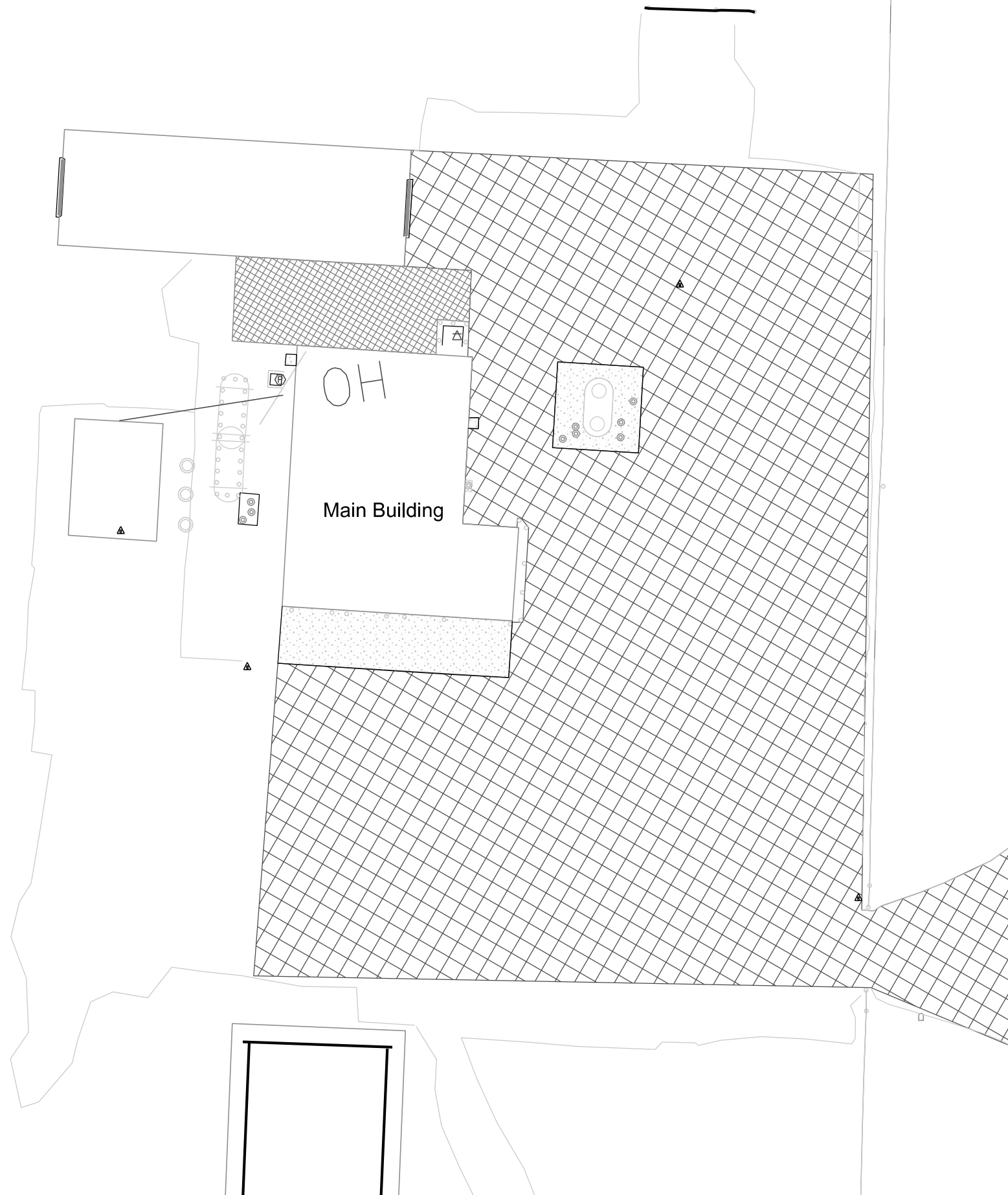

2" Overlay Area

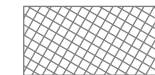

4" Overlay Area

