

March 31, 2016

NOTICE TO CONTRACTORS

Sealed bids will be received by the **South Dakota Department of Transportation, P.O. Box 1767, Aberdeen, SD, 57402-1767** or may be hand delivered to the Aberdeen Area Office located at **2735 West Highway 12 in Aberdeen** until 1:30 pm, **Friday, April 15, 2016** at which time they will be opened for the following project(s):

(Those sending bid via couriers such as UPS and FedEx should use the hand delivery address above.)

Project Number	PCN	County	Type of Work	Area Engineer
000N-151, 000N-152, 000P-151, 000P-152	i49L, i49M, i49N, i49P	Brown	Weed Spraying	Phil Dwight (605-626-7885)
000N-151, 000P-151	i49Q, i49R	Day	Weed Spraying	Phil Dwight (605-626-7885)
000N-152, 000P-152	i49T, i49U	Edmunds	Weed Spraying	Phil Dwight (605-626-7885)
000N-152, 000P-152	i49V, i49W	Faulk	Weed Spraying	Phil Dwight (605-626-7885)
000N-151	i49X	Marshall	Weed Spraying	Phil Dwight (605-626-7885)
000N-152, 000N-371	i49Y, i4A0	McPherson	Weed Spraying	Phil Dwight (605-626-7885)

Should you have questions you are encouraged to contact Area Engineer listed for the project.

AVAILABILITY OF PLANS AND PROPOSALS:

Specifications and proposal forms are available at the Aberdeen Area Office and at the following website:
<http://sddot.com/business/contractors/bid/region/default.aspx>

The DOT-123 form provided within the proposal document is for information only. Do not use for bidding purposes. Bids submitted on the enclosed DOT-123 form will be considered void and will not be accepted by the department. Please email the Aberdeen Area office for the DOT-123 form that can be used for bidding purposes to the following:

Phil.Dwight@state.sd.us and Robert.Ward@state.sd.us

The email request for the DOT-123 form shall include the following information, so that the SDDOT can maintain a list of prospective bidders for this project and to maintain a contact list for future region lettings:

Company Name
Mailing Address
Phone Number

Addendums, if any, will be made available on-line at the above website, no later than **48 hours** prior to opening bids. It will be the Contractor's responsibility to check for addendums prior to submitting bids.

CONTENT OF PROPOSALS:

Returned Proposals shall include the following items all signed in ink:

1. A notarized Contract Proposal (DOT-123). Non-signature items shall be typed or completed in ink.

Proposals shall be in sealed envelopes and clearly marked on the outside as to the content when delivered to the Area Office by the time indicated for Opening. Proposals faxed to the office will not be accepted.

Bidders will be required to fill out the blank spaces in the proposal form correctly. The bidder must fill in a unit price for each bid item shown on the proposal form. Bidders will also be required to carry out extensions and determine the "Total or Gross Sum Bid" as indicated in the proposal. The total of any proposal, as determined by the bidder, will be used only for a comparison when bids are publicly opened and read, and any errors noted in extensions or totals will be corrected to determine the "Total or Gross Sum Bid" of any proposal.

Failure to properly carry out any of the above requirements is deemed as sufficient reason to reject any proposal.

MISCELLANEOUS:

Any person engaged in highway construction work in the State of South Dakota must obtain a motor fuel highway contractor tax license.

The Department of Transportation in accordance with Title VI of the Civil Rights Act of 1964, 78 Stat. 252, 42 U.S.C. 2000d to 2000d-4 and Title 49, Code of Federal Regulations, Department of Transportation, Subtitle A, Office of the Secretary, Part 21, Nondiscrimination in Federally-assisted programs of the Department of Transportation issued pursuant to such Act, hereby notifies all bidders that it will affirmatively insure that in any contract entered into pursuant to this advertisement, minority business enterprises will be afforded full opportunity to submit bids in response to this invitation and will not be discriminated against on the grounds of race, color, religion, national origin, sex, age or disability in consideration for an award.

The Contractor, by signing and submitting a bid or proposal, agrees to provide services in compliance with the Americans with Disabilities Act of 1990.

The Department of Transportation reserves the right to reject any and all bids.

Sincerely,

DEPARTMENT OF TRANSPORTATION



Jeff Senst, P.E.
Aberdeen Region Engineer

cc:
J. Humphrey
P. Dwight
File

**SOUTH DAKOTA DEPARTMENT OF TRANSPORTATION
CONTRACT PROPOSAL**

DOT-123
(5/05)
1 of 1

CODE	PROJECT			MAINT UNIT	CONTROL REFERENCE	AFE	FUNCTION	BEGIN MRM	END MRM
	PRE	ROUTE	AGR						
		000N		151		i49L	2305		
		000N		151		i49L	2305		
		000P		151		i49L	2305		
		000P		152		i49P	2305		

CITY AND/OR COUNTY: Brown County BUDGET SOURCE: FY 2016 Contract Maintenance

FINALS ENGINEER REVIEW REQUIRED: ☐ YES ☒ NO
 REGION MATERIALS CERTIFICATION REQUIRED: ☐ YES ☒ NO
 CERTIFIED INSPECTORS/TESTERS REQUIRED: ☐ YES ☒ NO
 TO BE INSTALLED ON CM&P: ☒ YES ☐ NO

TYPE, PURPOSE AND LOCATION OF WORK: Control the growth of declared noxious weeds, aquatic vegetation and growth suppression within the right-of-way of all maintained highway routes as shown on Exhibit "A" of this contract.

BID ITEM NUMBER	ITEM	QUANTITY	UNIT	UNIT PRICE	AMOUNT
	2,4-d	100	Gal		
	Tordon 22K	50	Gal		
	Sahara	150	Lb		
	Surfactant	1500	Oz		
	MileStone	1800	Oz		
	Roundup	20	Gal		
	Escort	15	Oz		
	ATV/Sprayer	800	Hr		
	Labor	800	Hr		
TOTAL					

* Nonparticipating to FHWA

CONTRACTOR'S PROPOSAL STATEMENT

The undersigned does hereby agree to furnish the labor and/or material in the quantities, at the unit price, for the purpose, in the place and in accordance with attached provisions upon approval of this Proposal by the State Transportation Commission. This document becomes the Contract when signed by the Contractor and a Department of Transportation Representative. The Contractor agrees to provide services in compliance with the Americans with Disabilities Act of 1990. The Contractor agrees to provide a certificate of insurance prior to commencing work, for liability coverage for the duration of the work as per the current edition of the SDDOT Standard Specifications for Roads and Bridges.

PROPOSED START DATE 5/1/16 OVERALL COMPLETION DATE 10/15/16

SUBSCRIBED AND SWORN TO BEFORE ME THE _____ SIGNATURE _____
 _____ COMPANY _____
 _____ ADDRESS _____

NOTARY - My Commission Expires _____ FEDERAL TAX ID NUMBER _____

RECOMMENDED FOR APPROVAL:

CONSTRUCTION & MAINTENANCE ENGINEER _____ DATE _____

REGION ENGINEER _____ DATE _____ DIRECTOR OF OPERATIONS _____ DATE _____

APPROVED FOR THE TRANSPORTATION COMMISSION _____

NAME _____ TITLE _____ DATE _____

APPROVED as per Federal Highway Stewardship Provisions this _____ day of _____, 20__.

PROJECT DEVELOPMENT ENGINEER _____

Weed Spraying Specifications

The contractor does hereby agree to furnish the necessary equipment, materials and labor to control the growth of declared noxious weeds within the right-of way of state routes as shown on the attached map (Exhibit A).

Spraying

The spraying shall consist of spot treatments and shall be accomplished by using the herbicides specified on the contract (or equivalent) with applicable rates as recommended by the manufacturer. If herbicide is needed that is not on this contract, the type and price shall be negotiated and added by Change Order, prior to use of the herbicide.

The contractor agrees to indemnify, save, and hold harmless the Department and all its employees and agents, from any and all claims, demands, actions or cause of action of whatsoever nature or character arising out of, or by reason of, the execution of performance of the work provided for under the contract whether or not the Contractor itself is negligent or otherwise culpable. The Contractor further agrees to defend at its own sole cost and expense any action or proceeding commenced for the purpose of asserting any claim on whatsoever nature or character arising under this contract whether or not the Contractor is itself negligent or otherwise culpable. This section does not require the Contractor to be responsible for or defend against claims or damages arising solely from acts or omissions of the State, its officers or employees.

The spraying shall be accomplished by personnel properly licensed by the South Dakota Department of Agriculture.

The Contractor shall advise the local Maintenance Supervisor of his intent to spray, 48 hours prior to doing so.

The Contractor shall complete the attached daily form (DOT 820) "Contract Daily Pesticide Application Record" (Exhibit B), furnished by the Department, after each day of spraying.

The Contractor shall provide the Maintenance Supervisor with a complete copy of the daily form (DOT 820) within One week after completing the spraying.

The Contractor shall submit an invoice for payment to the Area Engineer or Maintenance Supervisor (as instructed). The invoice shall be accompanied by the completed original daily form(s) DOT 820. Separate invoices may be submitted for the spring and fall sprayings, if the Contractor desires to do so.

The herbicide selected for use will dictate frequency and timing of application. If two applications are required per growing season, the first shall be made in the spring of the year while the second shall be made in the late summer or early fall as directed by the Maintenance Supervisor. For herbicides requiring a single application, the application shall be made in accordance with the label for the product being used.

Equipment used for spraying shall be an ATV capable of navigating the highway ditches to allow for identification and direct treatment of weeds. Support vehicles shall be equipped with flashing amber lights. The lights shall be turned on and used at all times when the vehicle is on the roadway.

Growth Suppression

The following locations shall be treated for growth suppression:

1. 6 foot radius around all sign and delineator posts.
2. Underneath and 3 foot behind guide rail.

Herbicides shall be applied uniformly with properly calibrated equipment using manufacturers recommended rates and concentration.

Herbicides for growth suppression shall be applied in the spring of the year. Herbicides shall not be applied to vegetation that has exceeded 8" in height.

SOUTH DAKOTA DEPARTMENT OF TRANSPORTATION

DOT 820 Modified - Aberdeen Area
Rev 03/15

PCN: _____ DATE: _____

WEATHER ☐ CLOUDY ☐ PARTLY CLOUDY ☐ MOSTLY SUNNY ☐ CLEAR

COUNTY ☐ MCPHERSON ☐ FAULK ☐ DAY
☐ EDMUNDS ☐ BROWN ☐ MARSHALL

TIME _____
TEMP °F _____
WIND - Direction _____
WIND - Speed _____

START	END

COMMENTS: _____

APPLICATION

LOCATION

HWY# _____
DITCH _____

N S E W Median

MRM START _____
MRM END _____

SPRAY
☐ CONTINUOUS
☐ SPOT

CHEMICAL

TYPE _____
BRAND _____
UNIT _____
QUANTITY _____

2-4,D

oz

Tordon 22K

oz

LABOR	NAME	START	STOP	HOURS

LABOR
TOTAL
HOURS

EQUIP	TYPE	START	STOP	HOURS

EQUIP
TOTAL
HOURS

Operator - Applicator _____ D.O.A. License # _____

Address _____

This form shall be completed in duplicate for each route after completion of your daily pesticide application. One copy is to be kept on file for a period of three (3) years, and the other copy is to be forwarded to the Area Engineer.

Brown County (North Half)

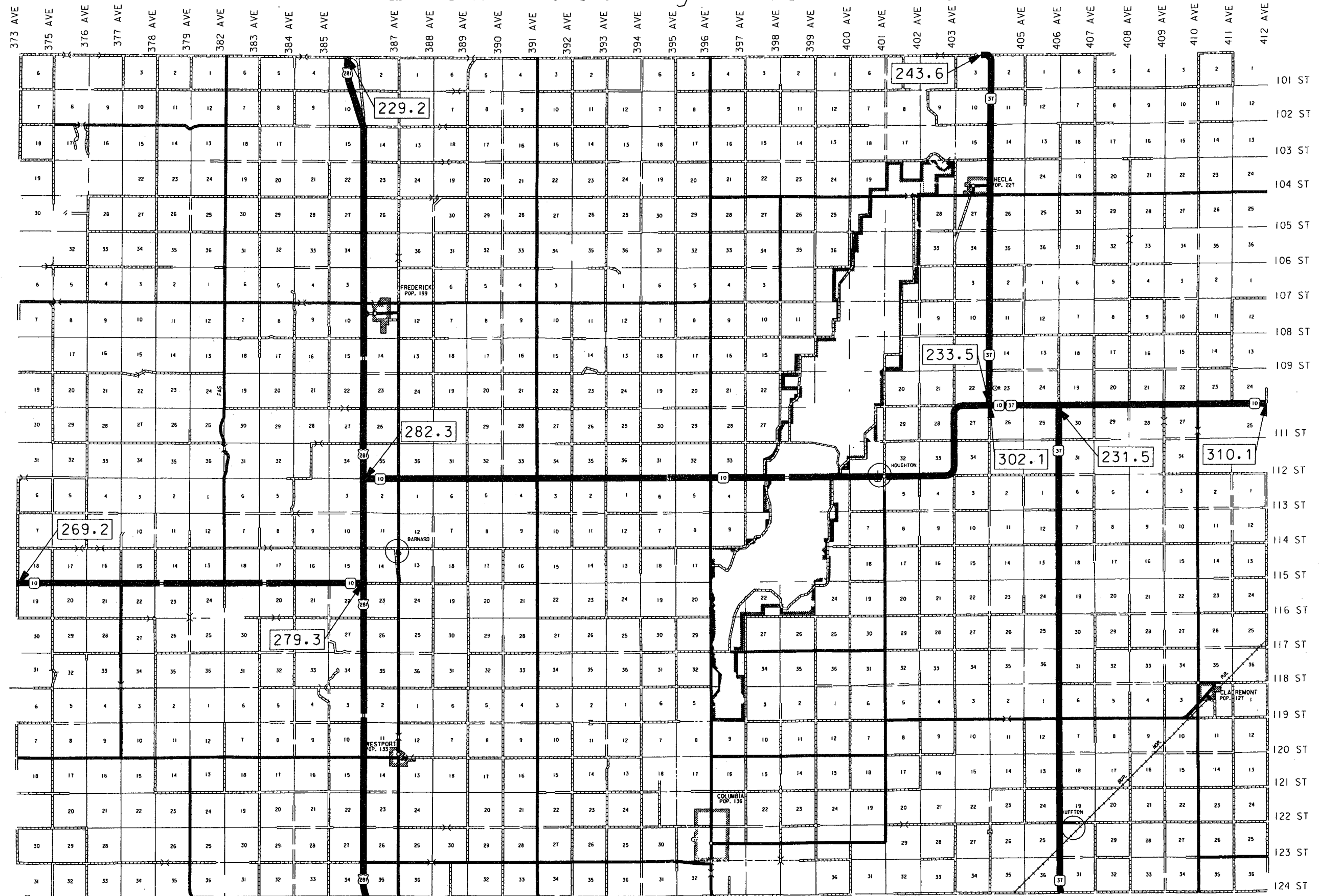

SD 10 010-152 MRM 269.2 to 279.3
SD 10 010-151 MRM 282.3 to 302.1

SD 10 010-151 MRM 302.1 to 310.1
SD 37 037-151 MRM 233.5 to 243.69

Brown County (South Half)

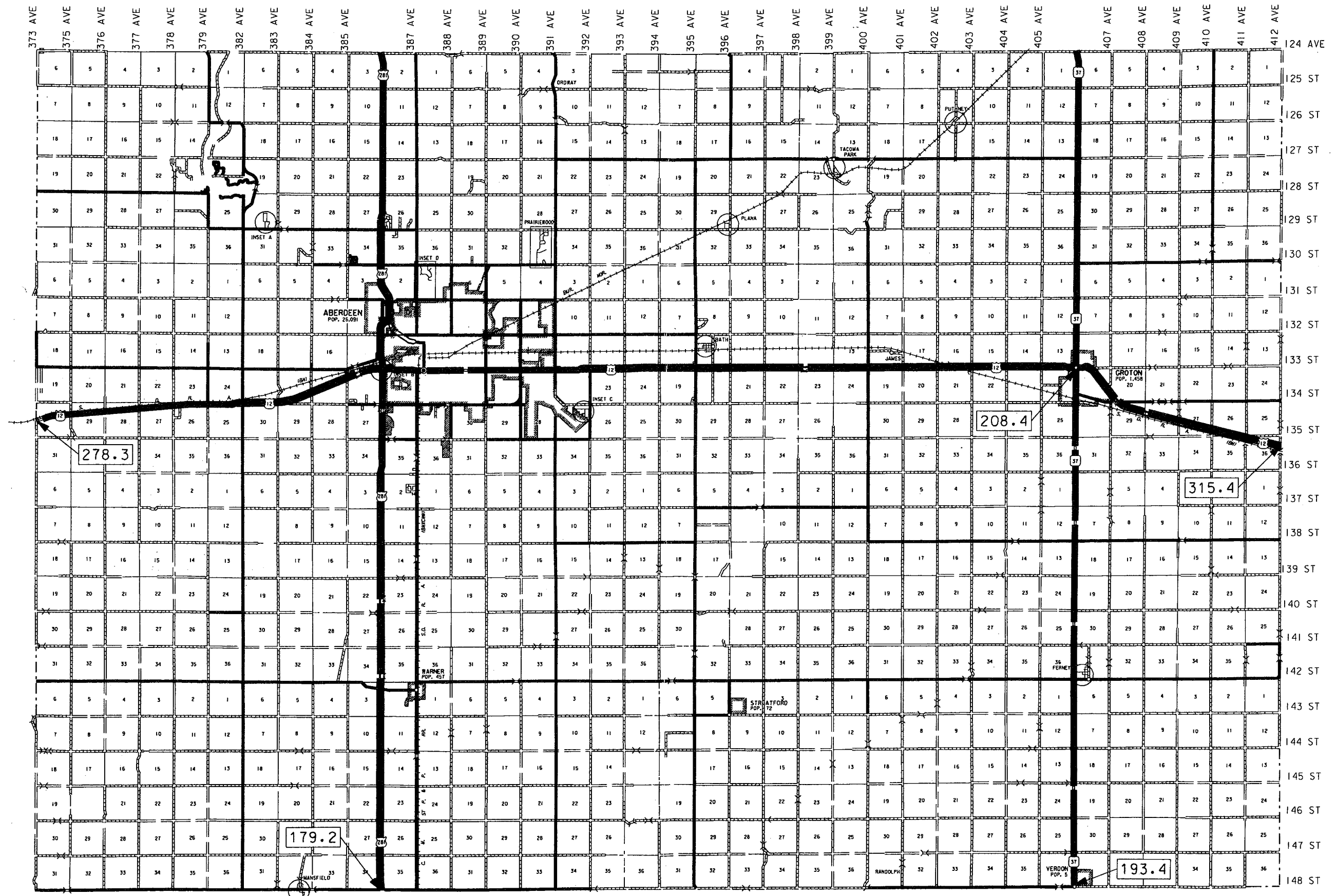

US 12 012-151 MRM 278.3 to 315.5
 SD 37 037-151 MRM 193.4 to 231.5
 US 281 281-151 MRM 179.2 to 229.2