

Plot Scale - 1:200

Plotted From - jrw1m20

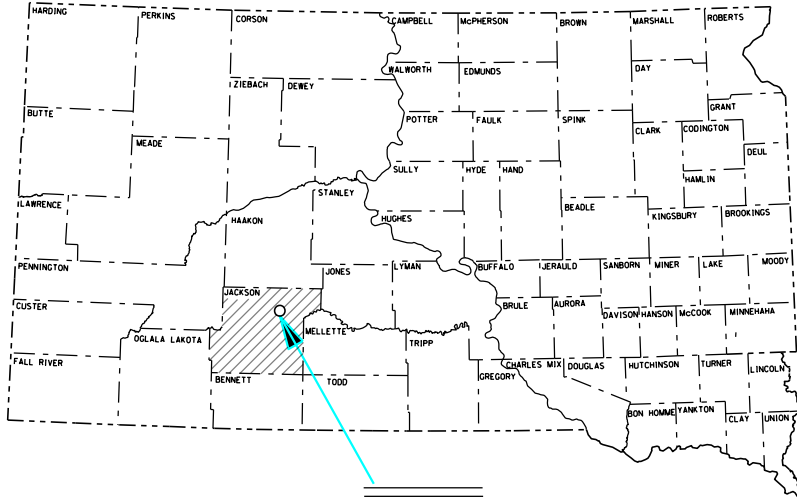

PROJECT

STATE OF SOUTH DAKOTA
DEPARTMENT OF TRANSPORTATION

PLANS FOR PROPOSED
PROJECT 410 C294
KADOKA MAINTENANCE YARD
JACKSON COUNTY

COLD MILLING ASPHALT CONCRETE
& ASPHALT CONCRETE RESURFACING

IPCN i4u2

STATE OF SOUTH DAKOTA	PROJECT	SHEET	TOTAL SHEETS
	410 C294	1	4

Plotting Date: 05/12/2017

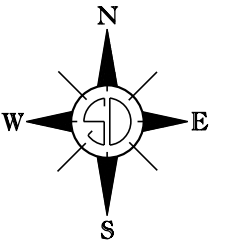

INDEX OF SHEETS

Sheet No. 1	Title Sheet
Sheet No. 2	Kadoka Yard Layout Map
Sheet No. 3	Estimate of Quantities
Sheet Nos. 3-4	Environmental Commitments
Sheet No. 4	Plan Notes

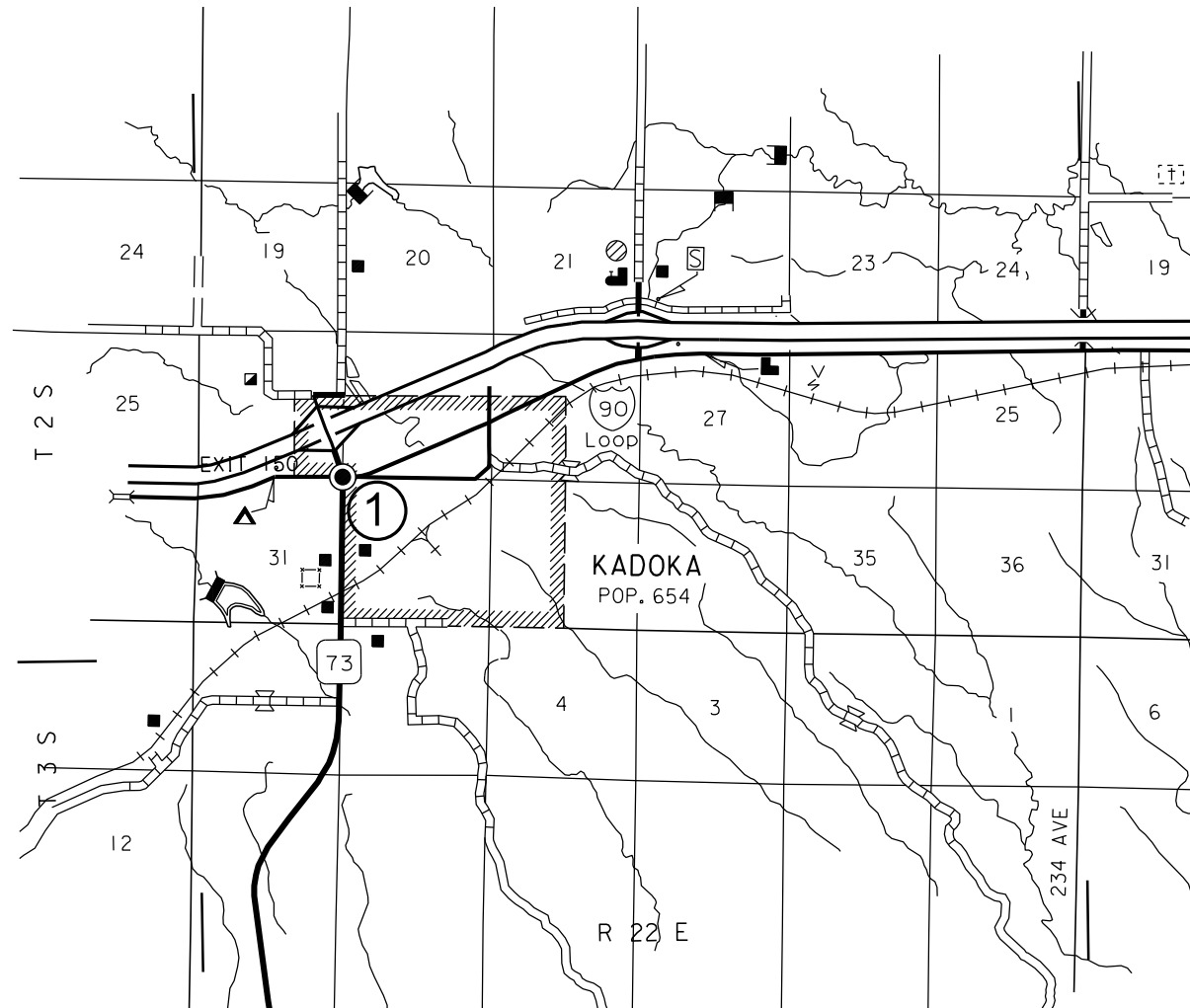

PROJECT LOCATION IS DESIGNATED BY A CIRCLED NUMBER AND DESCRIBED BELOW.

① = KADOKA MAINTENANCE SHOP IN KADOKA, SD

STORM WATER PERMIT
NO PERMIT REQUIRED

Plot Scale - 1:200

Plotted From - tw11m20

STATE OF SOUTH DAKOTA	PROJECT	SHEET	TOTAL SHEETS
	410 C294	2	4

Plotting Date: 05/12/2017

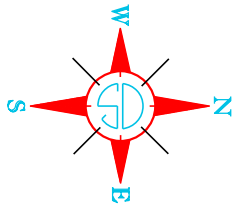

KADOKA MAINTENANCE YARD PAVING LAYOUT

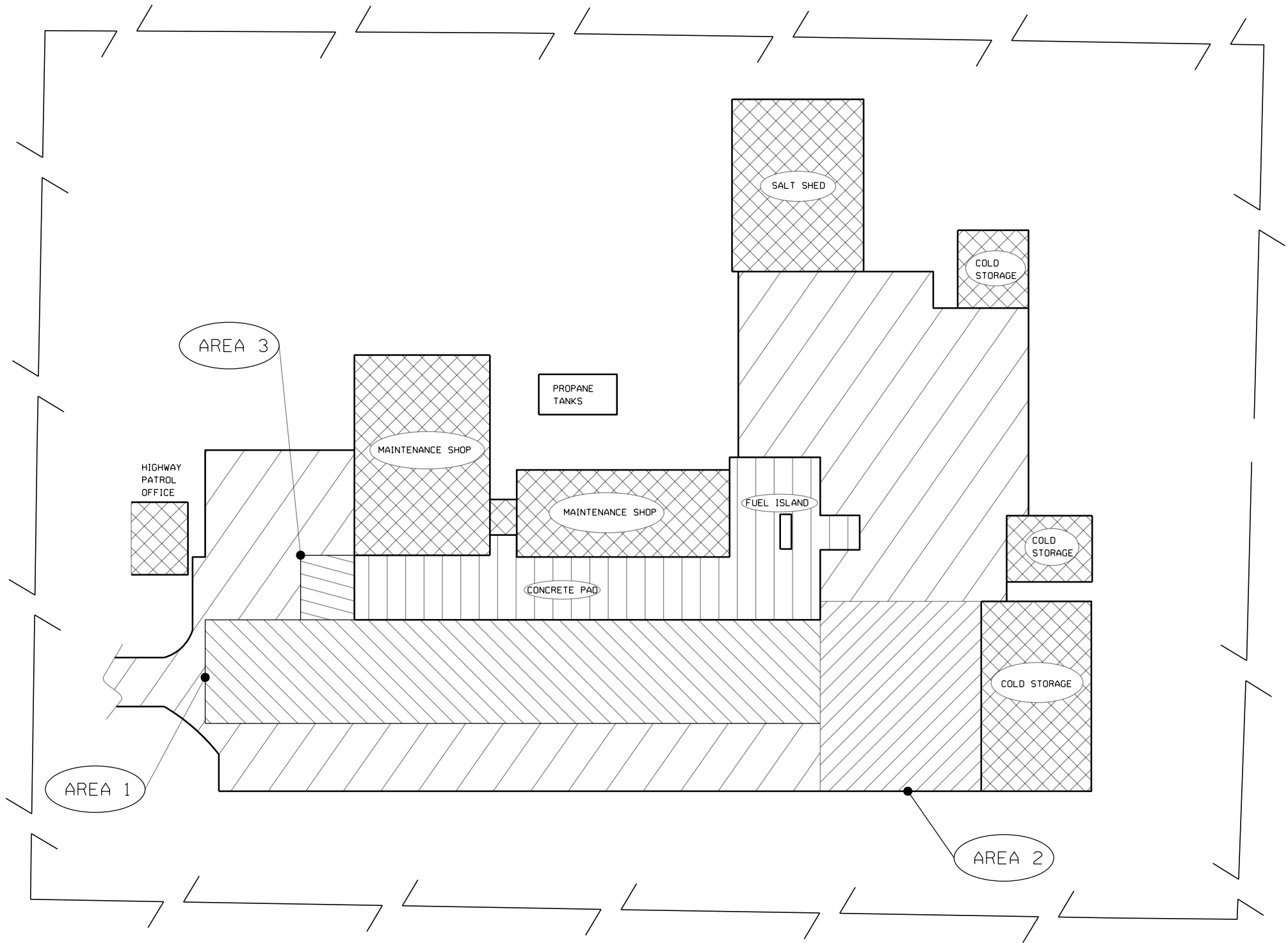

	EXISTING ASPHALT
	AREA 1
	AREA 2
	AREA 3
	BUILDINGS
	CONCRETE PAD
	DOT YARD

1:200
Plot Scale -
trw1m20
- Plotted From -

STATE OF SOUTH DAKOTA	PROJECT	SHEET	TOTAL SHEETS
	410 C294	3	4

Plotting Date: 05/18/2017

ESTIMATE OF QUANTITIES

Bid Item Number	Item	Quantity	Unit
009E0010	Mobilization	LS	Lump Sum
320E1200	Asphalt Concrete Composite	355	Ton
332E0010	Cold Milling Asphalt Concrete	1152	SqYd

SPECIFICATIONS

Standard Specifications for Roads & Bridges, 2015 Edition and Required Provisions, Supplemental Specifications and Special Provisions as included in the Proposal.

UTILITIES

Utilities are not planned to be affected on this project. If utilities are identified near the improvement area through SD One Call Process as required by South Dakota Codified Law 49-7A and Administrative Rule Article 20:25, the Contractor shall contact the Engineer to determine modifications that will be necessary to avoid utility impacts.

ENVIRONMENTAL COMMITMENTS

An Environment Commitment is a measure that SDDOT commits to implement in order to avoid, minimize, and/or mitigate a real or potential environmental impact. Environmental commitments to various agencies and the public have been made to secure approval of this project. An agency mentioned below with permitting authority can influence a project if perceived environmental impacts have not been adequately addressed. Unless otherwise designated, the Contractor's primary contact regarding matters associated with these commitments will be the Project Engineer. These environmental commitments are not subject to change without prior written approval from the SDDOT Environmental Office. The environmental commitments associated with this project are as follows:

COMMITMENT H: WASTE DISPOSAL SITE

The Contractor shall furnish a site(s) for the disposal of construction and/or demolition debris generated by this project.

Action Taken/Required:

The waste disposal site(s) shall be managed and reclaimed in accordance with the following from the General Permit for Construction/Demolition Debris Disposal Under the South Dakota Waste Management Program issued by the Department of Environment and Natural Resources.

The waste disposal site(s) shall not be located in a wetland, within 200 feet of surface water, or in an area that adversely affects wildlife, recreation, aesthetic value of an area, or any threatened or endangered species, as approved by the Project Engineer.

If the waste disposal site(s) is located such that it is within view of any ROW, the following additional requirements shall apply:

- Construction and/or demolition debris consisting of concrete, asphalt concrete, or other similar materials shall be buried in a trench completely separate from wood debris. The final cover over the construction and/or demolition debris shall consist of a minimum of 1 foot of soil capable of supporting vegetation. Waste disposal sites provided outside of the Public ROW shall be seeded in accordance with Natural Resources Conservation Service recommendations. The seeding recommendations may be obtained through the appropriate County NRCS Office. The Contractor shall control the access to waste disposal sites not within the Public ROW through the use of fences, gates, and placement of a sign or signs at the entrance to the site stating "No Dumping Allowed".
- Concrete and asphalt concrete debris may be stockpiled within view of the ROW for a period of time not to exceed the duration of the project. Prior to project completion, the waste shall be removed from view of the ROW or buried and the waste disposal site reclaimed as noted above.

The above requirements will not apply to waste disposal sites that are covered by an individual solid waste permit as specified in SDCL 34A-6-58, SDCL 34A-6-1.13, and ARSD 74:27:10:06.

Failure to comply with the requirements stated above may result in civil penalties in accordance with South Dakota Solid Waste Law, SDCL 34A-6-1.31.

All costs associated with furnishing waste disposal site(s), disposing of waste, maintaining control of access (fence, gates, and signs), and reclamation of the waste disposal site(s) shall be incidental to the various contract items.

COMMITMENT I: HISTORICAL PRESERVATION OFFICE CLEARANCES

The SDDOT has obtained concurrence with the State Historical Preservation Office (SHPO or THPO) for all work included within the project limits and all department designated sources and designated option material sources, stockpile sites, storage areas, and waste sites provided within the plans.

Action Taken/Required:

All earth disturbing activities not designated within the plans require review of cultural resources impacts. This work includes, but is not limited to: Contractor furnished material sources, material processing sites, stockpile sites, storage areas, plant sites, and waste areas.

The Contractor shall arrange and pay for a cultural resource survey and/or records search. The Contractor has the option to contact the state Archaeological Research Center (ARC) at 605-394-1936 or another qualified archaeologist, to obtain either a records search or a cultural resources survey. A record search might be sufficient for review; however, a cultural resources survey may need to be conducted by a qualified archaeologist.

The Contractor shall provide ARC with the following: a topographical map or aerial view on which the site is clearly outlined, site dimensions, project number, and PCN. If applicable, provide evidence that the site has been previously disturbed by farming, mining, or construction activities with a landowner statement that artifacts have not been found on the site.

File - ...Review 1\Kadoka AC plan.dgn

Plot Scale - 1:200

Plotted From - tw1m20

STATE OF SOUTH DAKOTA	PROJECT	SHEET	TOTAL SHEETS
	410 C294	4	4

Plotting Date: 05/18/2017

COMMITMENT I: HISTORICAL PRESERVATION OFFICE CLEARANCES (CONTINUED)

The Contractor shall submit the records search or cultural resources survey report and if the location of the site is within the current geographical or historic boundaries of any South Dakota reservation to SDDOT Environmental Engineer, 700 East Broadway Avenue, Pierre, SD 57501-2586 (605-773-3180). SDDOT will submit the information to the appropriate SHPO/THPO. Allow **30 Days** from the date this information is submitted to the Environmental Engineer for SHPO/THPO review.

If evidence for cultural resources is uncovered during project construction activities, then such activities shall cease and the Project Engineer shall be immediately notified. The Project Engineer will contact the SDDOT Environmental Engineer in order to determine an appropriate course of action.

SHPO/THPO review does not relieve the Contractor of the responsibility for obtaining any additional permits and clearances for Contractor furnished material sources, material processing sites, stockpile sites, storage areas, plant sites, and waste areas that affect wetlands, threatened and endangered species, or waterways. The Contractor shall provide the required permits and clearances to the Project Engineer at the preconstruction meeting.

SEQUENCE OF WORK

1. Mill existing asphalt to grade
2. Shape and compact in-place salvaged material
3. Place tack
4. Place Asphalt Concrete Composite

Work shall be coordinated with Tim Huffman, Highway maintenance Supervisor at Kadoka (605-669-2371), and Sgt. Slade Ross (605-381-7090), with the Highway Patrol to ensure that construction has minimal interference with normal operations for SD DOT and Highway Patrol.

SCOPE OF WORK

Area 1: Currently this area consists of several inches of in-place asphalt concrete. The Contractor is to mill the asphalt concrete to the desired grade prior to paving this area. Then, the Contractor is to place 2 inches of Asphalt Concrete Composite in this area. The Asphalt Concrete Composite shall be placed in one lift. Care is to be taken to ensure that positive drainage in the Kadoka Yard exists as per direction of the Engineer. Area 1 contains 1,520 Square Yards. Dimensions are 285 ft X 48 ft. The area for Cold Milling Asphalt Concrete located inside Area 1 along the length of the concrete pad in front of the building is 1152 Square Yards. Dimensions are 216 ft X 48ft.

Area 2: Currently this area consists of several inches of in-place salvaged asphalt material. The Contractor is to lightly shape and compact the salvaged asphalt material surface to make sure the surface is tightened up prior to paving this area. Then, the Contractor is to place 3 inches of Asphalt Concrete Composite in this area. The Asphalt Concrete Composite shall be placed in one lift. Care is to be taken to ensure that positive drainage in the Kadoka Yard exists as per direction of the Engineer. Area 2 contains 734 Square Yards. Dimensions are 75 ft X 88 ft.

Area 3: Currently this area consists of several inches of in-place salvaged asphalt material. The Contractor is to lightly shape and compact the salvaged asphalt material surface to make sure the surface is tightened up prior to paving this area. Then, the Contractor is to place 3 inches of Asphalt Concrete Composite in this area. The Asphalt Concrete Composite shall be placed in one lift. Care is to be taken to ensure that positive drainage in the Kadoka Yard exists as per direction of the Engineer. Area 3 contains 84 Square Yards. Dimensions are 25 ft X 30 ft.

If additional asphalt quantity remains after the completion of areas 1, 2, & 3; it shall be place as directed by the Engineer.

The Contractors attention is drawn to the fact that buildings, concrete pads, the fuel island & fuel fills are present within the vicinity of Areas 1, 2, & 3. Care is to be taken to avoid damaging the items in these areas. Any damage to the concrete fueling island, buildings, or concrete pads will be repaired by the Contractor, to the satisfaction of the Engineer, at no expense to the State.

ASPHALT CONCRETE COMPOSITE

All work shall be done in accordance with section 324 of the Standard Specifications for Roads & Bridges, 2015 Edition.

In place field densities will not be taken. Specified Roller Coverage shall apply.

Placement of Asphalt Concrete Composite will be accomplished with a self-propelled paver in all Areas except for areas adjacent to the building. The Engineer may allow alternate methods in the smaller areas provided a steel faced vibratory roller is used for compaction.

The Contractor shall furnish, install and maintain “TRUCK CROSSING” signs. The location for this pair of signs will be determined in the field. Payment for these signs shall be incidental to the various contract items.

File - ...Review 1Kadoka AC plan.dgn