

STATE OF SOUTH DAKOTA
 DEPARTMENT OF TRANSPORTATION
 PLANS FOR PROPOSED
PROJECT 044-452
PENNINGTON COUNTY
SD HIGHWAY 44
 ASPHALT REPAIR
 PCN i5ny

STATE OF SOUTH DAKOTA	PROJECT	SHEET	TOTAL SHEETS
	044-452	1	9

Plotting Date: 05/04/2020

INDEX OF SHEETS

- 1 General Layout with Index
- 2-4 Estimate with General Notes & Tables
- 5-7 Special Details
- 8-9 Standard Plates

Plot Scale - 1:200

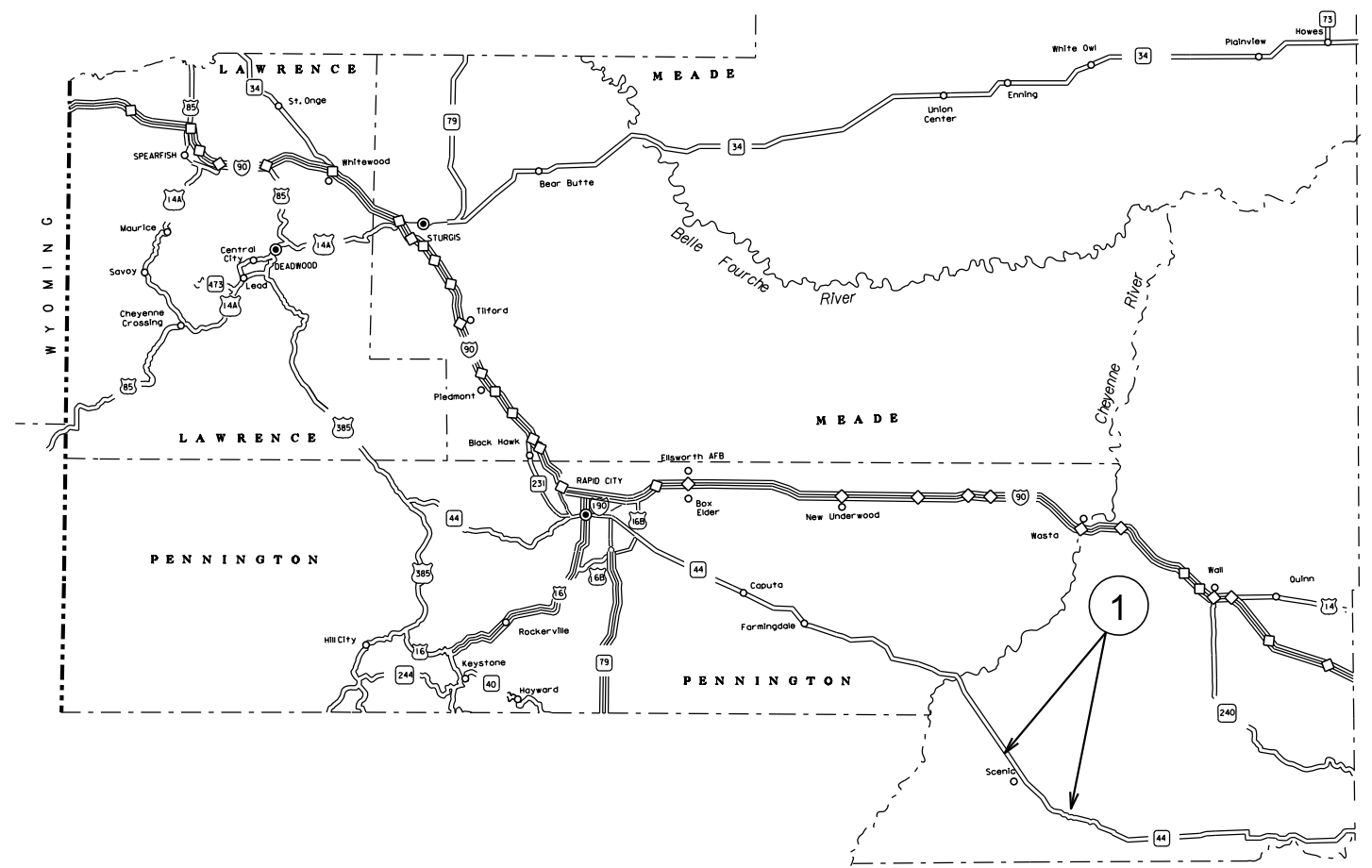
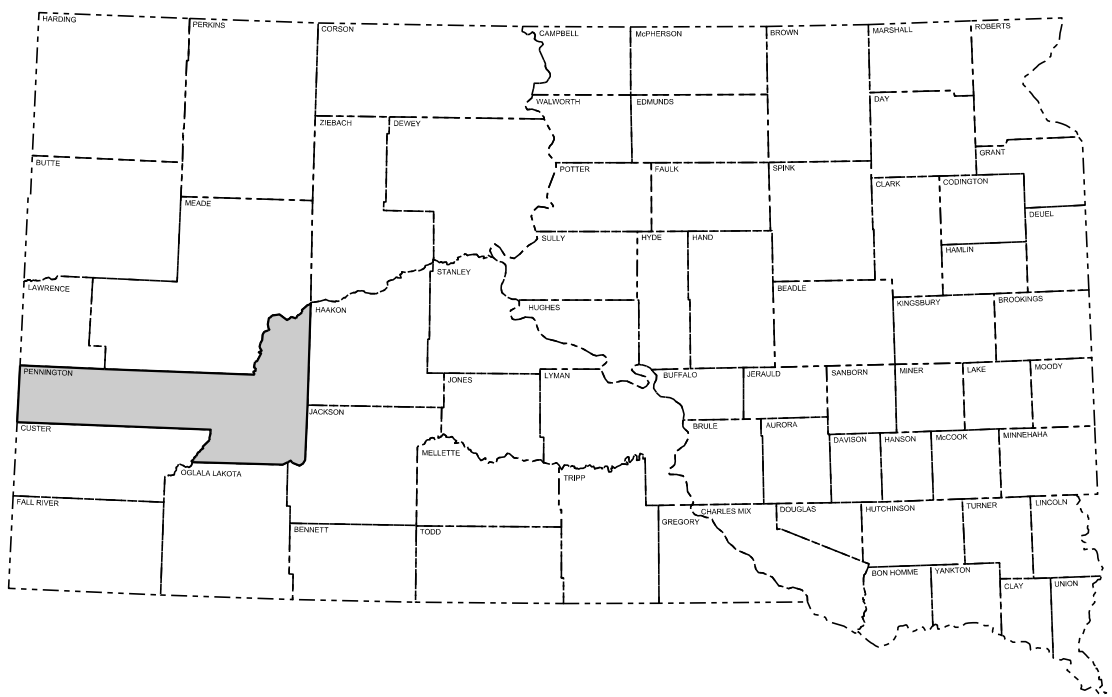

① MRM 87 - MRM 92.67



STORM WATER PERMIT
 None Required

DESIGN DESIGNATION

AADT (2018)	836
AADT (2038)	1212
DHV	143
D%	51%
DHV T%	2.4%
AADT T%	5.2%
V mph	65

Plotted From - TRRC12608

File - ...SD 44 AC Repair111111.dgn

ESTIMATE OF QUANTITIES

BID ITEM NUMBER	ITEM	QUANTITY	UNIT
009E0010	Mobilization	Lump Sum	LS
120E0100	Unclassified Excavation, Digouts	76	CuYd
260E1010	Base Course	100.7	Ton
320E1200	Asphalt Concrete Composite	716.6	Ton
633E1220	High Build Waterborne Pavement Marking Paint, 4" White	5,464	Ft
633E1222	High Build Waterborne Pavement Marking Paint, 4" Yellow	3,465	Ft
634E0010	Flagging	300.0	Hour
634E0020	Pilot Car	150.0	Hour
634E0110	Traffic Control Signs	201.0	SqFt
634E0120	Traffic Control, Miscellaneous	Lump Sum	LS
634E0640	Temporary Pavement Marking	11,088	Ft

SPECIFICATIONS

Standard Specifications for Roads and Bridges, 2015 Edition and Required Provisions, Supplemental Specifications, and Special Provisions as included in the Proposal.

ENVIRONMENTAL COMMITMENTS

The SDDOT is committed to protecting the environment and uses Section A Environmental Commitments as a communication tool for the Engineer and Contractor to ensure that attention is given to avoid, minimize, and/or mitigate an environmental impact. Environmental commitments to various agencies and the public have been made to secure approval of this project. An agency with permitting authority can delay a project if identified environmental impacts have not been adequately addressed. Unless otherwise designated, the Contractor's primary contact regarding matters associated with these commitments will be the Project Engineer. These environmental commitments are not subject to change without prior written approval from the SDDOT Environmental Office.

Additional guidance on SDDOT's Environmental Commitments can be accessed through the Environmental Procedures Manual found at: <https://dot.sd.gov/media/documents/EnvironmentalProceduresManual.pdf>

For questions regarding change orders in the field that may have an effect on an Environmental Commitment, the Project Engineer will contact the Environmental Office at 605-773-3098 or 605-773-4336 to determine whether an environmental analysis and/or resource agency coordination is necessary.

COMMITMENT B2: WHOOPING CRANE

The Whooping Crane is a spring and fall migratory bird in South Dakota that is about 5 feet tall and typically stops on wetlands, rivers, and agricultural lands along their migration route. An adult Whooping Crane is white with a red crown and a long, dark, pointed bill. Immature Whooping Cranes are cinnamon brown. While in flight, their long necks are kept straight and their long dark legs trail behind. Adult Whooping Cranes' black wing tips are visible during flight.

Action Taken/Required:

Harassment or other measures to cause the Whooping Crane to leave the site is a violation of the Endangered Species Act. If a Whooping Crane is sighted roosting in the vicinity of the project, borrow pits, or staging areas associated with the project, cease construction activities in the affected area until the Whooping Crane departs and immediately contact the Project Engineer. The Project Engineer will contact the Environmental Office so that the sighting can be reported to USFWS.

COMMITMENT E: STORM WATER

Construction activities constitute less than 1 acre of disturbance.

Action Taken/Required:

At a minimum and regardless of project size, appropriate erosion and sediment control measures must be installed to control the discharge of pollutants from the construction site.

WASTE DISPOSAL SITE

The Contractor will furnish a site(s) for the disposal of construction and/or demolition debris generated by this project.

Action Taken/Required:

Construction and/or demolition debris may not be disposed of within the Public ROW.

The waste disposal site(s) will be managed and reclaimed in accordance with the following from the General Permit for Construction/Demolition Debris Disposal Under the South Dakota Waste Management Program issued by the Department of Environment and Natural Resources.

The waste disposal site(s) will not be located in a wetland, within 200 feet of surface water, or in an area that adversely affects wildlife, recreation, aesthetic value of an area, or any threatened or endangered species, as approved by the Environmental Office and the Project Engineer.

If the waste disposal site(s) is located such that it is within view of any ROW, the following additional requirements will apply:

1. Construction and/or demolition debris consisting of concrete, asphalt concrete, or other similar materials will be buried in a trench completely separate from wood debris. The final cover over the construction and/or demolition debris will consist of a minimum of 1 foot of soil capable of supporting vegetation. Waste disposal sites provided outside of the Public ROW will be seeded in accordance with Natural Resources Conservation Service recommendations. The seeding recommendations may be obtained through the appropriate County NRCS Office. The Contractor will control the access to waste disposal sites not within the Public ROW with fences, gates, and placement of a sign or signs at the entrance to the site stating, "No Dumping Allowed".
2. Concrete and asphalt concrete debris may be stockpiled within view of the ROW for a period of time not to exceed the duration of the project. Prior to project completion, the waste shall be removed from view of the ROW or buried, and the waste disposal site reclaimed as noted above.

STATE OF SOUTH DAKOTA	PROJECT	SHEET	TOTAL SHEETS
	044-452	2	9

The above requirements will not apply to waste disposal sites that are covered by an individual solid waste permit as specified in SDCL 34A-6-58, SDCL 34A-6-1.13, and ARSD 74:27:10:06.

Failure to comply with the requirements stated above may result in civil penalties in accordance with South Dakota Solid Waste Law, SDCL 34A-6-1.31.

All costs associated with furnishing waste disposal site(s), disposing of waste, maintaining control of access (fence, gates, and signs), and reclamation of the waste disposal site(s) will be incidental to the various contract items.

COMMITMENT I: HISTORICAL PRESERVATION OFFICE CLEARANCES

State Historical Preservation Office (SHPO or THPO) concurrence has not been obtained for this project.

Action Taken/Required:

All earth disturbing activities not designated within the plans require a cultural resource review prior to scheduling the pre-construction meeting. This work includes, but is not limited to: Contractor furnished material sources, material processing sites, stockpile sites, storage areas, plant sites, and waste areas.

The Contractor will arrange and pay for a record search and when necessary, a cultural resource survey. The Contractor has the option to contact the state Archaeological Research Center (ARC) at 605-394-1936 or another qualified archaeologist, to obtain either a records search or a cultural resources survey. A record search might be sufficient for review if the site was previously surveyed; however, a cultural resources survey may need to be conducted by a qualified archaeologist.

The Contractor will provide ARC with the following: a topographical map or aerial view of which the site is clearly outlined, site dimensions, project number, and PCN. If applicable, provide evidence that the site has been previously disturbed by farming, mining, or construction activities with a landowner statement that artifacts have not been found on the site.

The Contractor will submit the cultural resources survey report to SDDOT Environmental Office, 700 East Broadway Avenue, Pierre, SD 57501-2586. SDDOT will submit the information to the appropriate SHPO/THPO. Allow **30 Days** from the date this information is submitted to the Environmental Engineer for SHPO/THPO review.

In the event of an inadvertent discovery of human remains, funerary objects, or if evidence of cultural resources is identified during project construction activities, then such activities will immediately cease and the Project Engineer will be immediately notified. The Project Engineer will contact the SDDOT Environmental Office to determine an appropriate course of action.

The Contractor is responsible for obtaining any additional permits and clearances for Contractor furnished material sources, material processing sites, stockpile sites, storage areas, plant sites, and waste areas that affect wetlands, threatened and endangered species, or waterways. The Contractor will not utilize a site known or suspected of having contaminated soil or water. The Contractor will provide the required permits and clearances to the Project Engineer at the preconstruction meeting.

ASPHALT CONCRETE COMPOSITE

STATE OF SOUTH DAKOTA	PROJECT	SHEET	TOTAL SHEETS
	044-452	3	9

Locations and quantities of asphalt repair are subject to change. The exact locations within MRM ranges will be determined in the field by the Engineer. The Engineer reserves the right to adjust quantities and/or add locations at no additional cost to the state

SURFACING THICKNESS DIMENSIONS

Plans tonnage will be applied even though the thickness may vary from that shown in the plans. At those locations where material must be placed to achieve a required elevation for smoothness, plans tonnage may be varied to achieve the required elevation.

EXCAVATION OF UNSTABLE MATERIAL

Digouts will be to a depth of 1.5 feet.

The in-place asphalt concrete will be sawcut to a vertical face at the limits of the digout as directed by the Engineer prior to removal of material.

Backfill of digouts shall be 12" of Base Course and 6" Asphalt Concrete Composite. The Asphalt Concrete Composite will be placed in two 3" lifts. Base Course and Asphalt Concrete Composite will be paid for at the contract unit price per ton.

Compaction of Base Course shall be to the Satisfaction of the Engineer.

Table of Material Quantities												
MRM	to	MRM	Type of Repair	Length	Width	Unclassified Excavation, Digouts	Base Course	Asphalt Concrete Composite	Temporary Pavement Marking	High Build Waterborne Pavement Marking Paint, 4" White	High Build Waterborne Pavement Marking Paint, 4" Yellow	Description
				Ft	Ft	(CuYd)	(Ton)	(Ton)	(Ft)	(Ft)	(Ft)	
87		87.3	AC Overlay	1000	28			247.0	4000	2000	1250	
88		88.25	AC Overlay	1000	28			247.0	4000	2000	1250	
88.4		88.5	AC Overlay	692	28			170.9	2768	1384	865	
92.63 EB		92.63 EB	Digout	80	17	75.6	100.7	51.7	320	80	100	Digout depth 1.5'
Total				2772		75.6	100.7	716.6	11088	5464	3465	

GENERAL TRAFFIC CONTROL

Existing guide, route, informational logo, regulatory, and warning signs will be temporarily reset and maintained during construction. Removing, relocating, covering, salvaging, and resetting of existing traffic control devices, including delineation, will be the responsibility of the Contractor. Cost for this work will be incidental to the contract unit prices for the various items unless otherwise specified in the plans. Any delineators and signs damaged or lost will be replaced by the Contractor at no cost to the State.

All temporary traffic control sign locations will be set in the field by the Contractor and verified by the Engineer prior to installation.

All construction operations will be conducted in the general direction of traffic movement.

If there is a discrepancy between the traffic control plans, standard plates, and the MUTCD, whichever is more stringent will be used, as determined by the Engineer.

Unless otherwise stated in these plans, work will not be allowed during hours of darkness.

Traffic Control Signs, as shown in the Estimate of Quantities, are estimates. Contractor's operation may require adjustments in quantities, either more or less. Payment will be for those signs actually ordered by the Engineer and used.

Fixed location signing placed more than 4 calendar days prior to the start of construction will be covered or laid down until the time of construction. The covers must be approved by the Engineer prior to installation. The cost of materials, labor, and equipment necessary to complete this work will be incidental to other contract items. No separate payment will be made.

All fixed location signs, sign posts, and breakaway bases will be removed within 7 calendar days following pavement marking.

All haul trucks will be equipped with an additional flashing amber light that is visible from the backside of the haul truck. The costs for the flashing amber lights will be incidental to the various related contract bid items.

Traffic will be maintained on the driving lanes. Use of the shoulder as a driving lane will not be permitted. Any damage to the shoulder due to rerouted traffic or Contractor's equipment will be repaired at no expense to the Department.

A mobile work operation will be allowed provided the rumble strip or rumble stripe grooving, flush sealing, and pavement marking can be completed satisfactorily by a continuously moving work operation. A mobile work operation will require approval by the Engineer.

The Contractor will be required to have one work zone to encompassing the three overlay locations. A separate work zone will be required for the digout area

The digout will be completed by the Contractor entirely in one day (removal, digout, base course, and asphalt)

FLAGGING

Operations will be conducted so that the traveling public will not have to wait longer than 15 minutes at the flagger station.

It is required that the flaggers and pilot car operators be able to communicate with one another. If an emergency vehicle needs to pass through the project, the Contractor will be required to expedite traffic movement. All costs associated with this will be incidental to the contract unit price per hour for Flagging.

ITEMIZED LIST OF TRAFFIC CONTROL DEVICES

SIGN CODE	SIGN DESCRIPTION	CONVENTIONAL ROAD			
		NUMBER	SIGN SIZE	SQFT PER SIGN	SQFT
W3-4	BE PREPARED TO STOP	2	48" x 48"	16.0	32.0
W8-11	UNEVEN LANES	2	48" x 48"	16.0	32.0
W20-1	ROAD WORK AHEAD	2	48" x 48"	16.0	32.0
W20-4	ONE LANE ROAD AHEAD	2	48" x 48"	16.0	32.0
W20-7	FLAGGER (symbol)	2	48" x 48"	16.0	32.0
W21-1	WORKERS (symbol)	2	48" x 48"	16.0	32.0
G20-2	END ROAD WORK	2	36" x 18"	4.5	9.0
CONVENTIONAL ROAD					
TRAFFIC CONTROL SIGNS SQFT					201.0

TEMPORARY PAVEMENT MARKING

Temporary flexible vertical markers (tabs) will be used to mark dashed centerline, No Passing Zones, and applicable lane lines. Paint will not be allowed for temporary pavement marking on the asphalt concrete wear course or after application of the flush seal.

Covers on the tabs will be sufficiently secured to prevent traffic from dislodging the cover and when removed, the covers will be properly disposed of. The Contractor will remove and properly dispose of the tabs after permanent pavement marking is applied. Method of removal will be nondestructive to the road surface and will be accomplished within one week of completion of the permanent pavement marking.

Any temporary flexible vertical markers (tabs) with covers removed before the flush seal will be replaced prior to application of the flush seal. Full reflectivity of all temporary flexible vertical markers (tabs) is required at all times. The Contractor will be required to replace any missing or non-reflective tabs at no additional cost to the State.

Quantities of Temporary Pavement Markings consist of:

- One pass on the top lift of asphalt concrete
- One pass on top of the flush seal

In the absence of a signed lane closure or pilot car operation, FLAGGER (W20-7) symbol signs and flaggers, or a shadow vehicle with rotating yellow lights or strobe lights will be positioned on the shoulder in advance of workers for both directions of traffic during the installation and removal of the temporary flexible vertical markers (tabs). The traffic control device used will be moved intermittently to provide proper warning of the work operation. A ROAD WORK AHEAD (W20-1) sign, a WORKER (W21-1) symbol sign or a BE PREPARED TO STOP (W3-4) sign will be mounted on the rear of the shadow vehicle. The method of traffic control used by the Contractor for this work must be approved by the Engineer.

STATE OF SOUTH DAKOTA	PROJECT	SHEET	TOTAL SHEETS
	044-452	4	9

PERMANENT PAVEMENT MARKING

The Contractor will be required to repaint all existing pavement markings including centerline, edge line, and lane lines. The cost to duplicate the existing marking locations will be incidental to the contract unit prices for High Build Waterborne Pavement Marking Paint.

The application of permanent pavement marking will begin no sooner than 7 calendar days following completion of the fog or flush seal. Application of permanent pavement marking will be completed within 14 calendar days following completion of the final surfacing.

HIGH BUILD WATERBORNE PAVEMENT MARKING PAINT

All materials will be applied as per manufacturer's recommendations.

This material will consist of a durable high build, low VOC, fast drying, waterborne traffic paint with a 100% acrylic polymer (Arkema DT-400, Dow HD-21A, or equivalent). The Contractor will provide certification that the material is one of the following products or an equivalent as approved by the Operations Traffic Engineer:

- Diamond Vogel's Waterborne High Build Polymer Marking Paint
- Ennis-Flint's High Build Polymer Marking Paint

No further testing of this material will be required. Reflective media will consist of glass beads.

High Build Waterborne Pavement Marking Paint applied after October 15 must be formulated as cold-weather waterborne paint. Cold weather waterborne paint will meet the requirements of Section 980.1 B.

RATES OF MATERIALS FOR HIGH BUILD WATERBORNE PAVEMENT MARKING PAINT

- Solid 4" line = 22.5 Gals/Mile
- Glass Beads = 8 Lbs/Gal.

All cost for materials, labor and equipment necessary to furnish and install the pavement markings will be incidental to the contract unit price for the respective High Build Waterborne Pavement Marking Paint items.

TYPICAL ASPHALT REPAIR SECTION

STATE OF SOUTH DAKOTA	PROJECT	SHEET NO.	TOTAL SHEETS
	044-452	5	9

Plotting Date: 05/04/2020

See Table for Locations

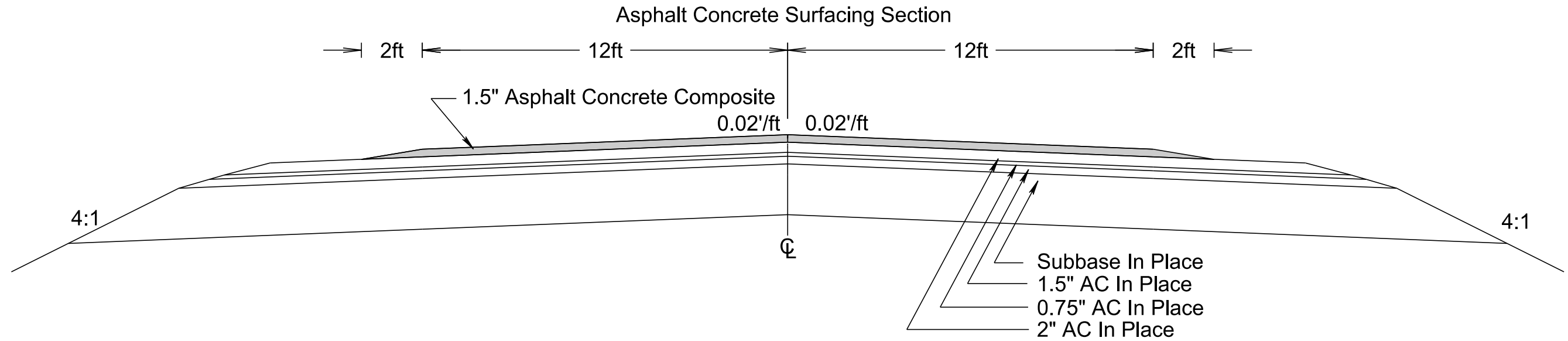
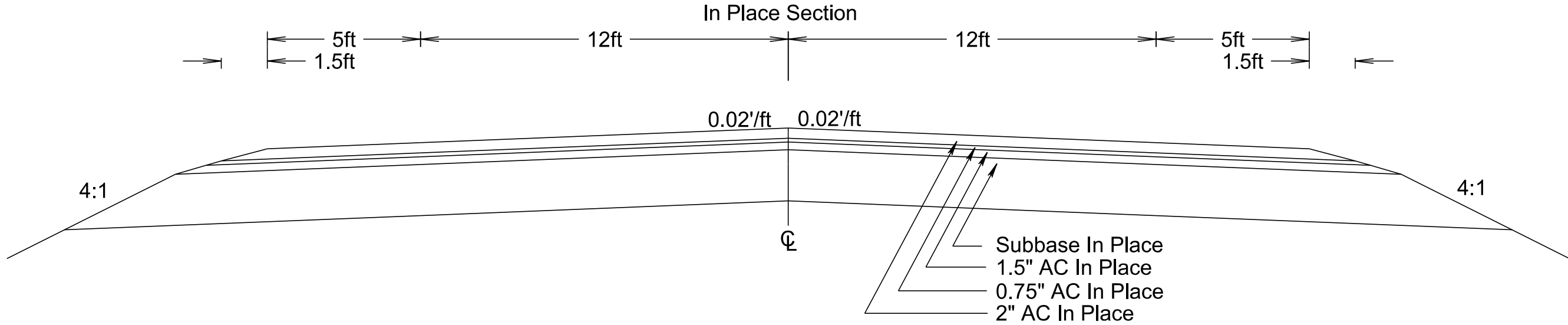

PLOT SCALE - 1:3.69056

PLOT NAME - 2

FILE - ... \SD 44 AC REPAIR\15NY TYP.DGN

PLOTTED FROM - TRRC12508

STATE OF SOUTH DAKOTA	PROJECT 044-452	SHEET 6	TOTAL SHEETS 9
-----------------------	--------------------	------------	-------------------

Plotting Date: 05/04/2020

ASPHALT CONCRETE PROFILE AT BEGIN AND END OF REPAIR

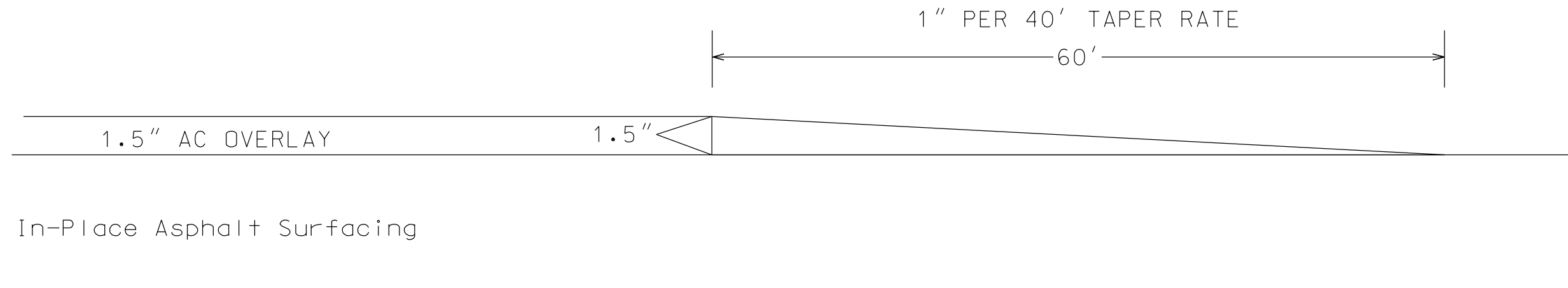

PLOT SCALE - 1:200

PLOT NAME - 3

FILE - ... \AC TAPERS AT ENDS.DGN

PLOTTED FROM - TRRC12508

TYPICAL PAVEMENT MARKING LAYOUT

STATE OF SOUTH DAKOTA	PROJECT	SHEET	TOTAL SHEETS
	044-452	7	9

Plotting Date: 05/04/2020

Plot Scale - 1:20

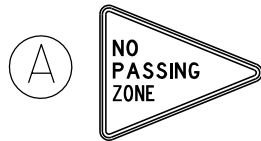

(B) End of Zone Marker

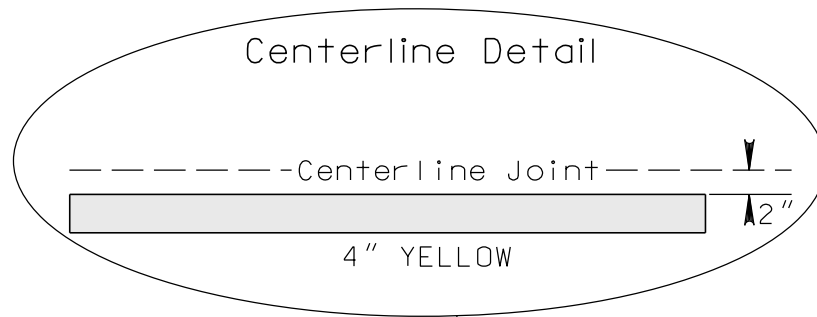
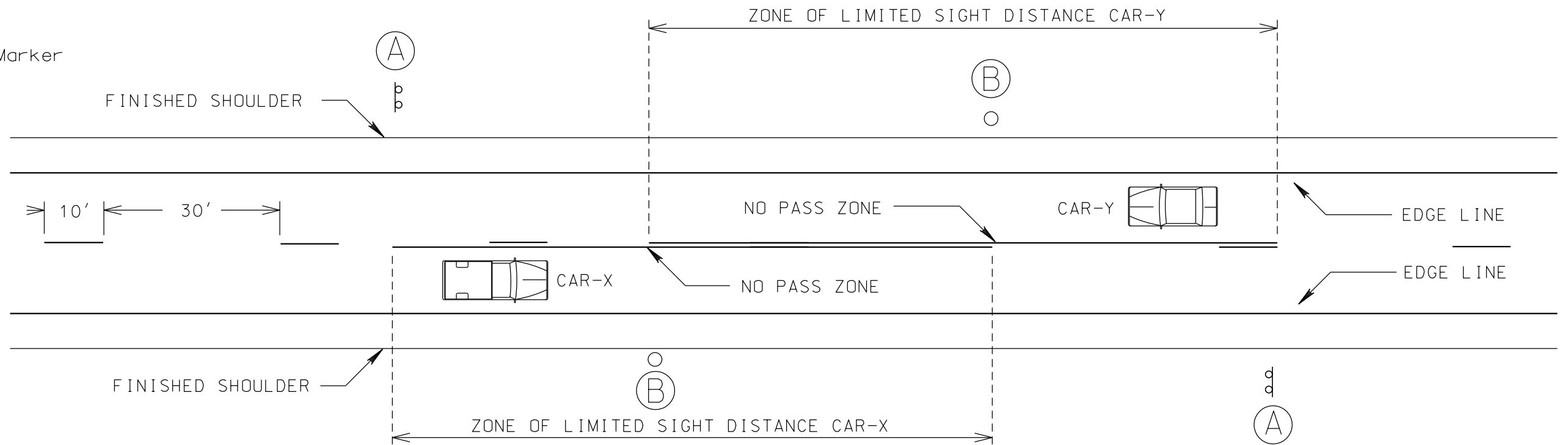

NOTE: A TWO "GUN" SYSTEM SHALL BE USED TO OBTAIN THIS PATTERN.

WHEN A SINGLE SKIP LINE EXISTS, THE SKIP SHALL BE PLACED TO THE SOUTH OR EAST OF THE CENTERLINE JOINT.

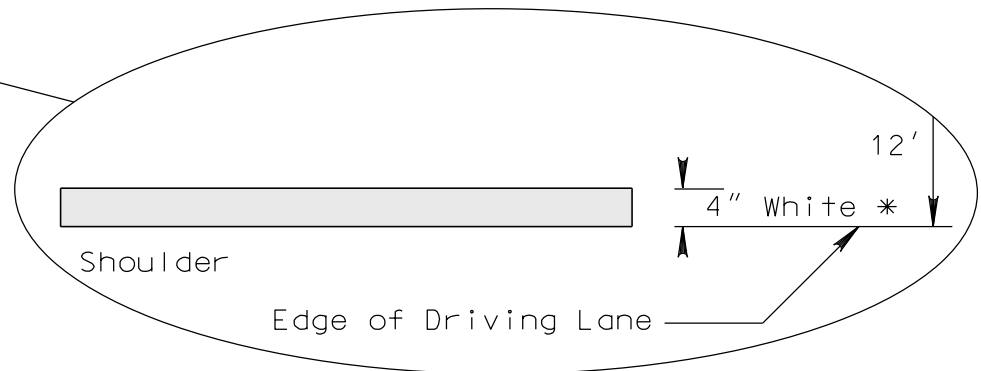
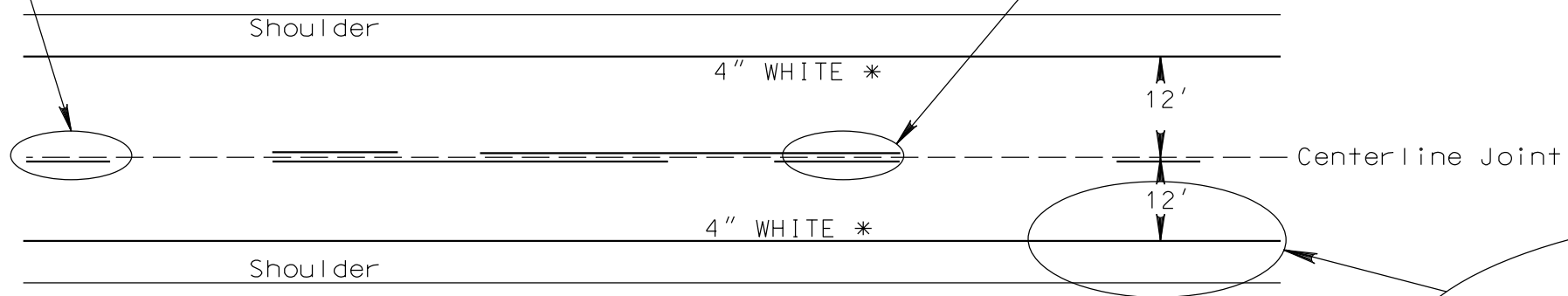
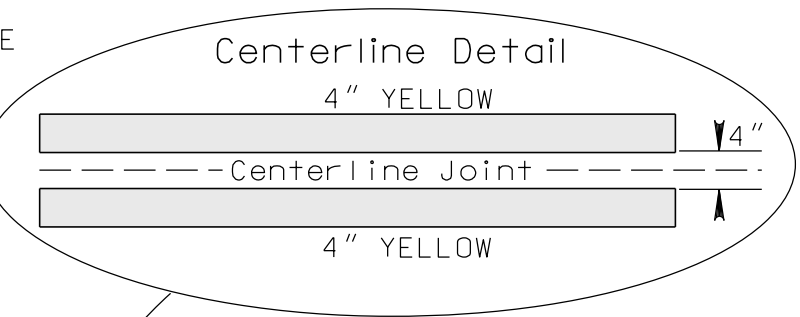

* 8" WHITE - As per locations in plans with shoulders less than 2' width.

Plotted From - TRRC12608

File - ...PavementMarkingDetails.dgn

Plot Scale - 1:200

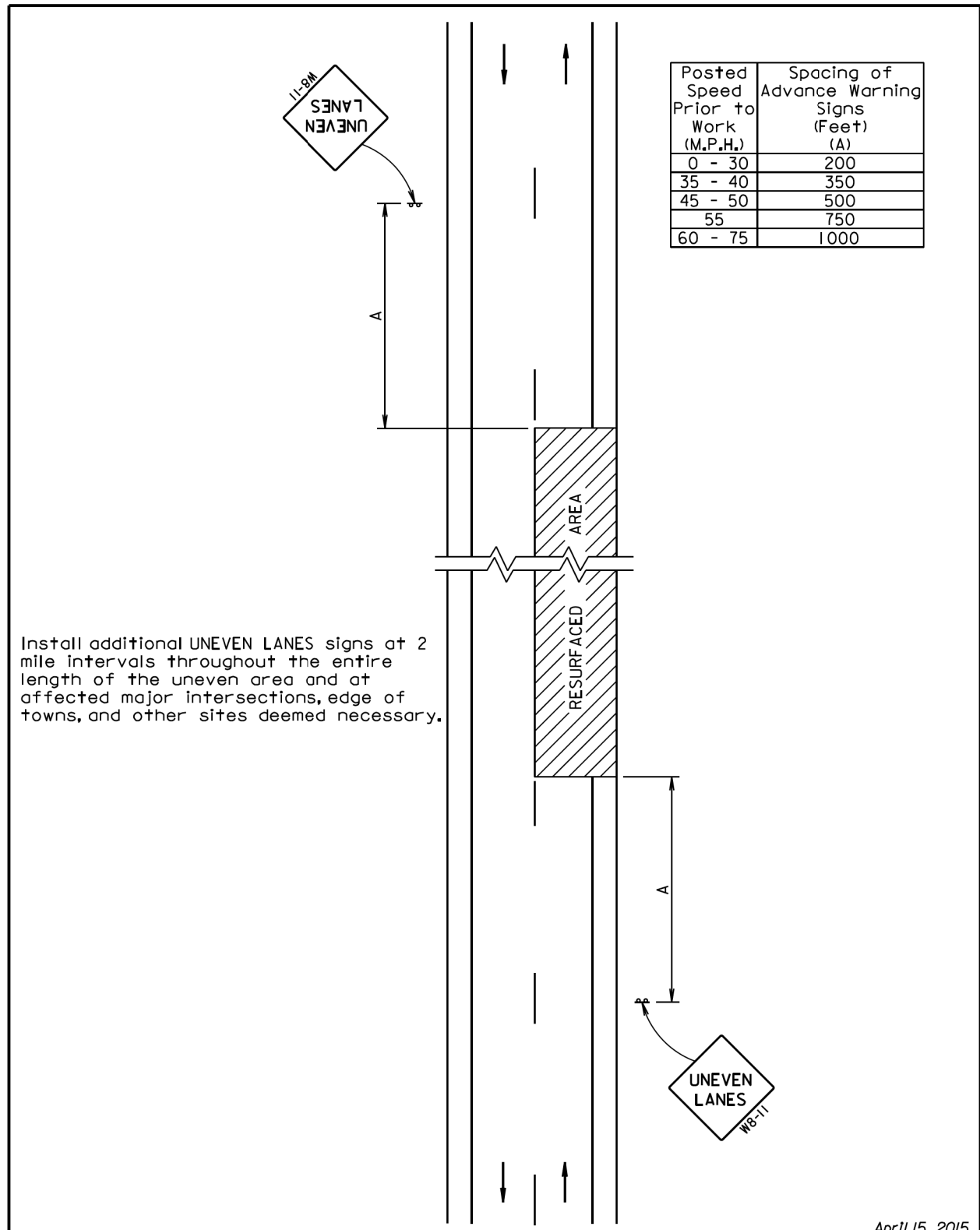

April 15, 2015

S D D O T	GUIDES FOR TRAFFIC CONTROL DEVICES UNEVEN ROAD SURFACE	PLATE NUMBER 634.22
		Sheet 1 of 1

Published Date: 2nd Qtr. 2020

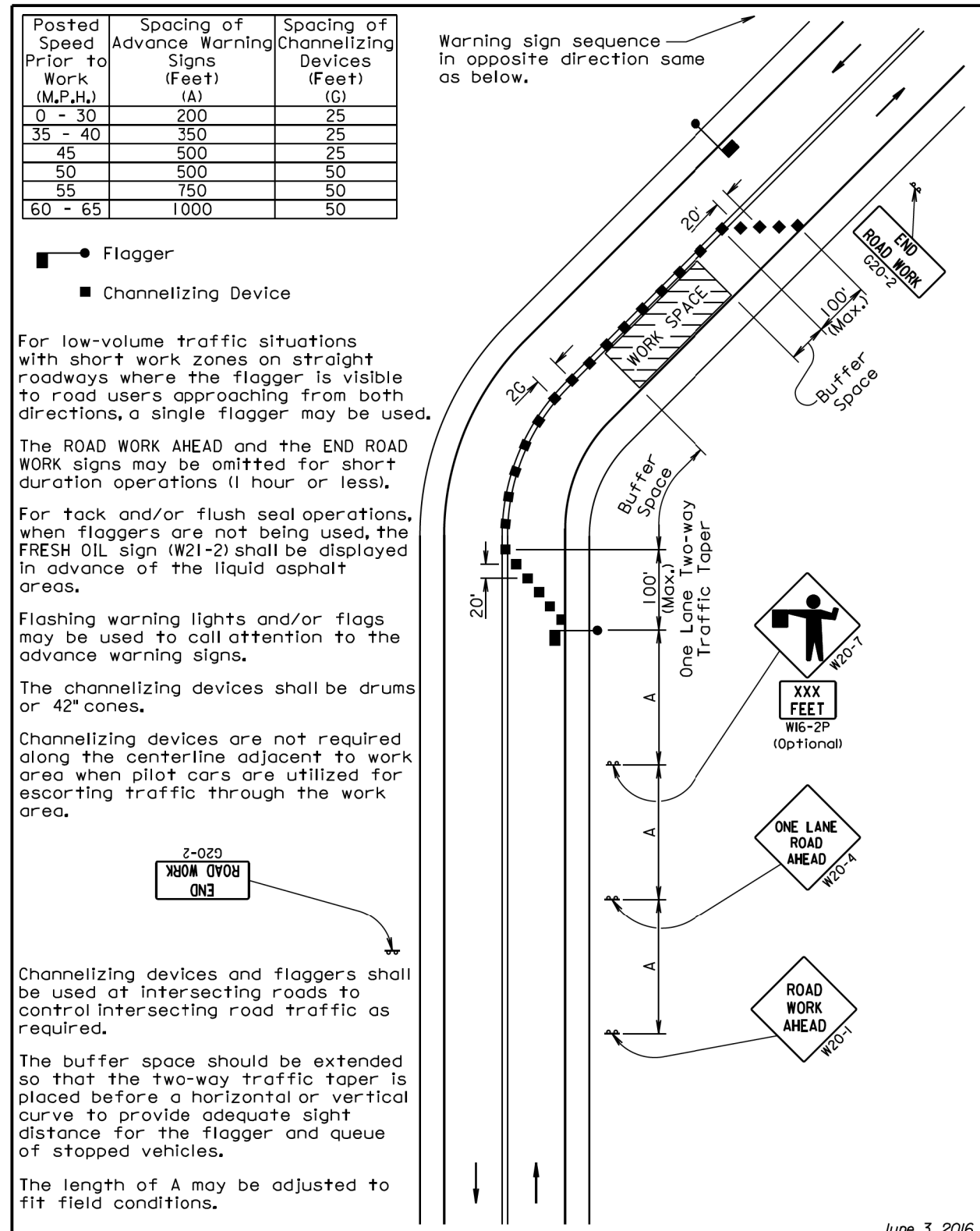

June 3, 2016

S D D O T	GUIDES FOR TRAFFIC CONTROL DEVICES LANE CLOSURE WITH FLAGGER PROVIDED	PLATE NUMBER 634.23
		Sheet 1 of 1

Published Date: 2nd Qtr. 2020

- Plotted From - TRRC12608

File - ...1634_15ny_1_Alternate.dgn

Plot Scale - 1:200

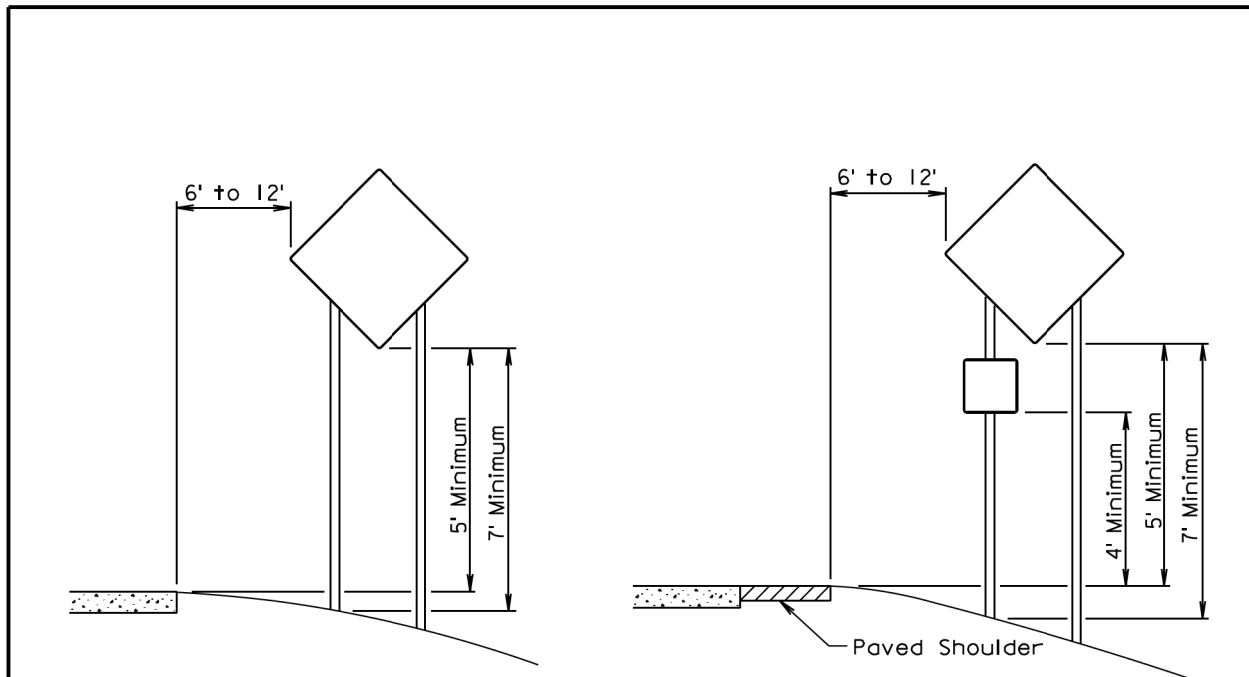

RURAL DISTRICT

RURAL DISTRICT WITH SUPPLEMENTAL PLATE

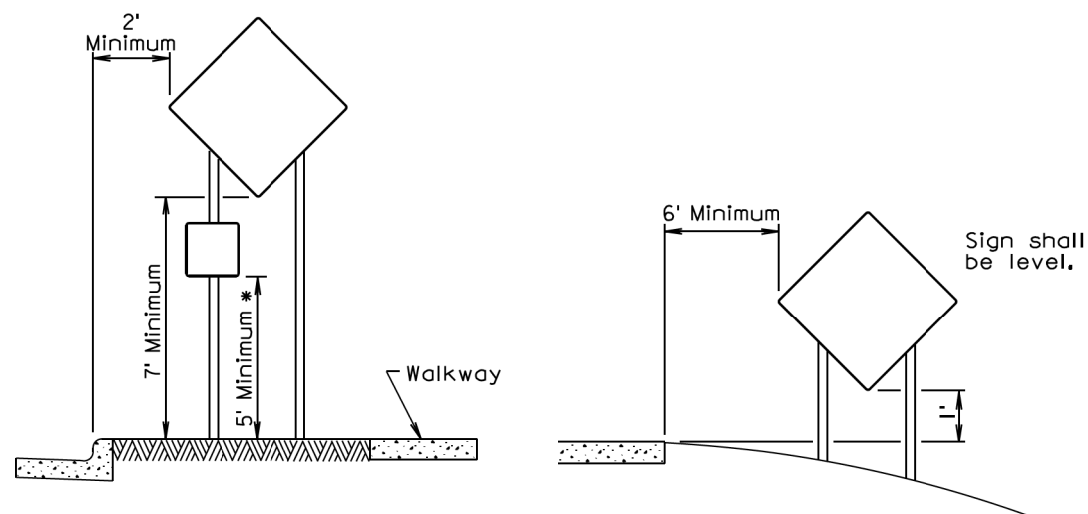

URBAN DISTRICT

RURAL DISTRICT 3 DAY MAXIMUM

* If the bottom of supplemental plate is mounted lower than 7 feet above a pedestrian walkway, the supplemental plate should not project more than 4" into the pedestrian facility.

(Not applicable to regulatory signs)

September 22, 2014

Published Date: 2nd Qtr. 2020	S D D O T	CRASHWORTHY SIGN SUPPORTS (Typical Construction Signing)	PLATE NUMBER 634.85
			Sheet 1 of 1

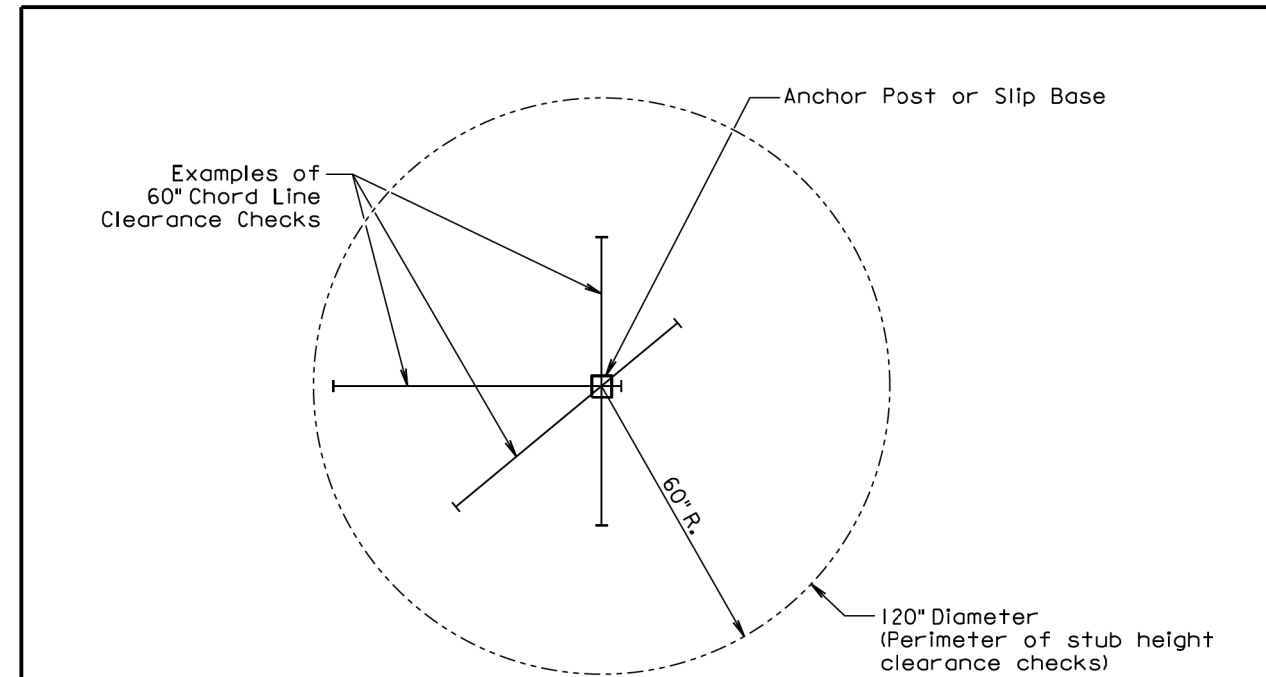

PLAN VIEW
(Examples of stub height clearance checks)

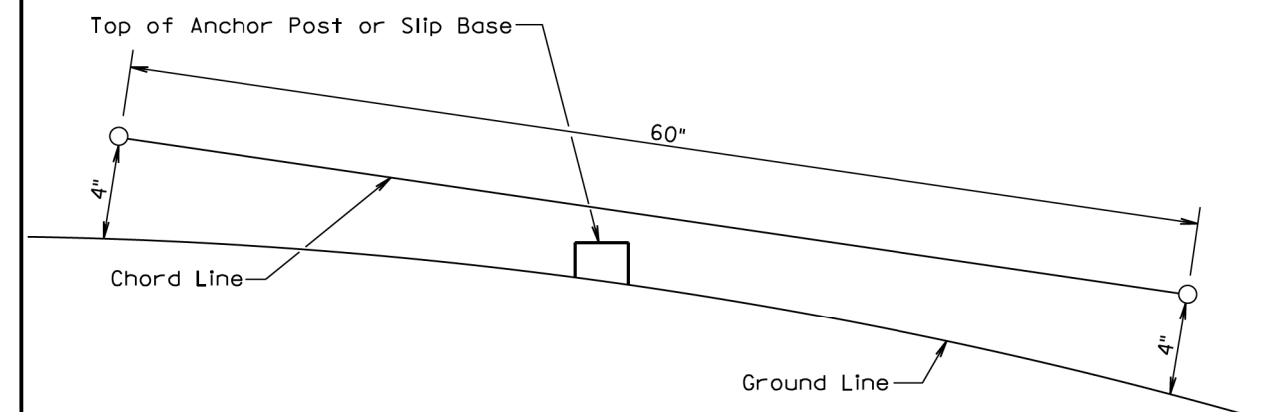

ELEVATION VIEW

GENERAL NOTES:

The top of anchor posts and slip bases SHALL NOT extend above a 60" chord line within a 120" diameter circle around the post with ends 4" above the ground.

At locations where there is curb and gutter adjacent to the breakaway sign support, the stub height shall be a maximum of 4" above the ground line at the localized area adjacent to the breakaway support stub.

The 4" stub height clearance is not necessary for U-channel lap splices where the support is designed to yield (bend) at the base.

July 1, 2005

Published Date: 2nd Qtr. 2020	S D D O T	BREAKAWAY SUPPORT STUB CLEARANCE	PLATE NUMBER 634.99
			Sheet 1 of 1

- Plotted From - TRRC12608

File - ...ISD 44 AC Repair634_5.dgn