

PLOT SCALE - 1"=40'

PLOTTED FROM - TRAB17879

STATE OF SOUTH DAKOTA
 DEPARTMENT OF TRANSPORTATION
 PLANS FOR PROPOSED

PROJECT 000P-151
BROWN COUNTY

Pre-purchase Signal Pole
 PCN i7PW

STATE OF SOUTH DAKOTA	PROJECT	SHEET NO.	TOTAL SHEETS
	000P-151	1	4

Plotting Date: 12/30/2024

INDEX OF SECTIONS

- Sheets 1 Title Sheet and Layout Maps
- Sheets 2 Estimate of Quantities and Plan Notes
- Sheets 3 Signal Layout
- Sheet 4 Standard Plates

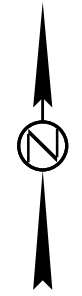
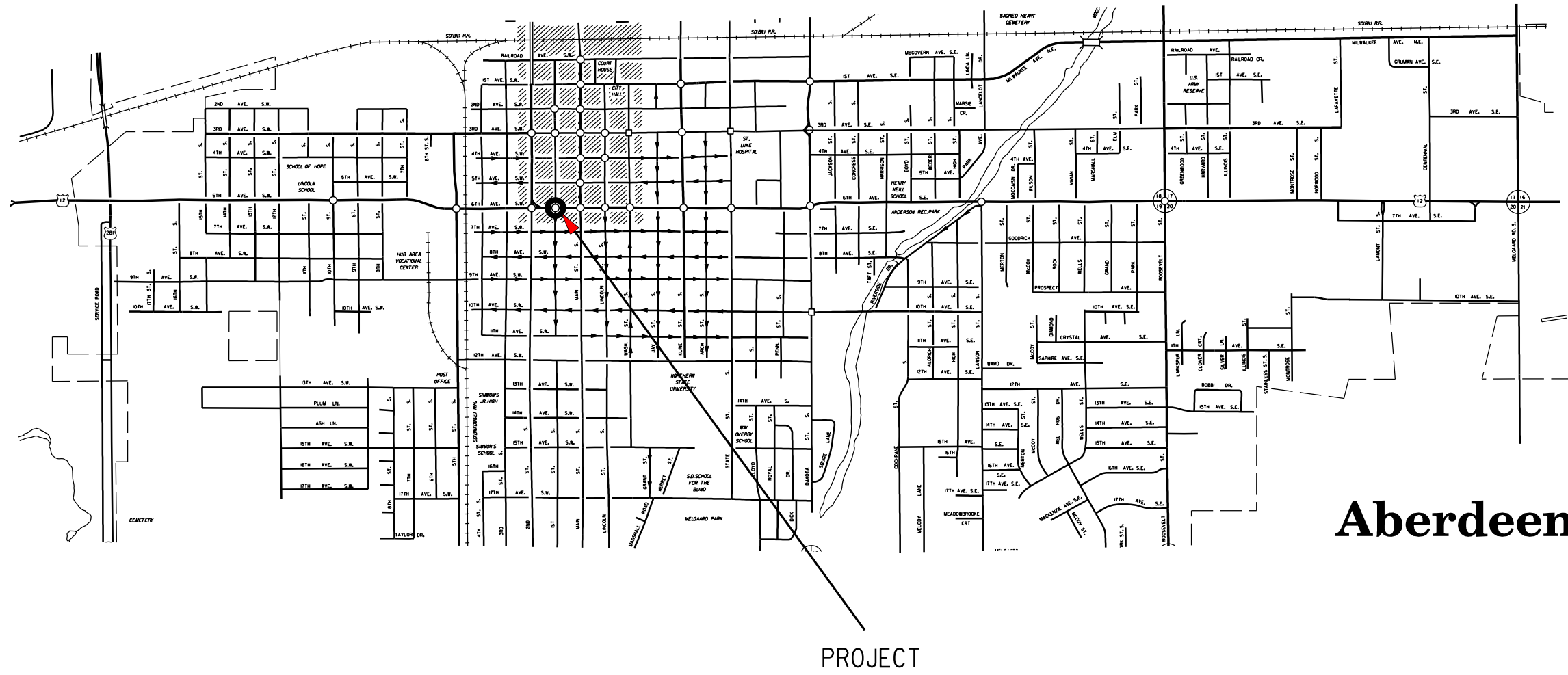
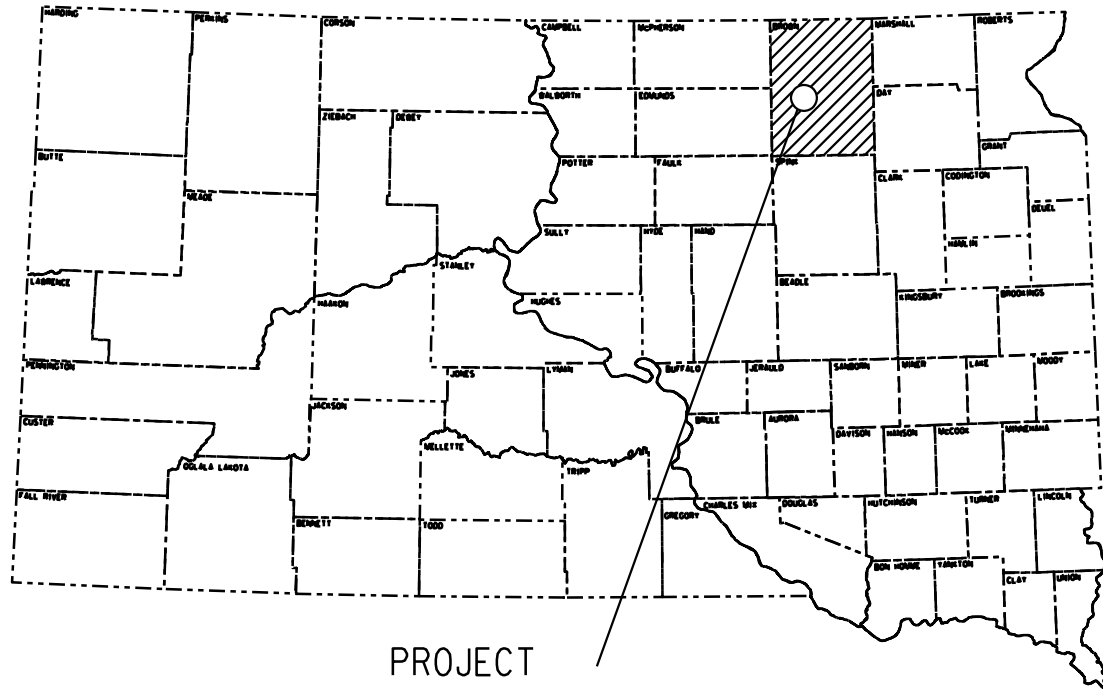

Aberdeen

STORM WATER PERMIT:
 None Required

FILE - ...PRJ\BRWN17PW\17PW_TITLE.DGN

PLOT NAME - 1

ESTIMATE OF QUANTITIES

BID ITEM NUMBER	ITEM	QUANTITY	UNIT
009E0010	Mobilization	Lump Sum	LS
635E7017	Furnish Signal Pole with Mast Arm and Luminaire Arm	1	Each

SPECIFICATIONS

Standard Specifications for Roads and Bridges, 2015 Edition and Required Provisions, Supplemental Specifications, and Special Provisions as included in the Proposal.

TAX LIABILITY

The SD Department of Transportation is a South Dakota sales tax-exempt government entity. Therefore, a Certificate of Exemption will be provided to the successful bidding party which excuses the party from paying sales tax on the materials being furnished to the SDDOT. It is the responsibility of bidding parties to contact the SD Department of Revenue @ 1-800-829-9188 to determine tax licensure requirements.

SHOP DRAWING AND CATALOG CUTS SUBMITTALS

The Contractor will submit shop drawings and catalog cuts in accordance with Section 985 of the Specifications.

PDF submittals will be sent to the following email addresses:

Dan.Martell@state.sd.us
Matt.Dorfschmidt@state.sd.us

FURNISH SIGNAL POLE WITH MAST ARM AND LUMINAIRE ARM

The Contract will furnish a mast arm and luminaire extension to fit an existing pole. The existing pole was purchase on PO# 4703521628, Drawing number SD 13-SIGONLY-1545.

Millerbernd Manufacturing
P.O. Box 98
Winsted, MN 55395
Phone: (320) 485-2111

Mast arm length will be 40 feet in length.
Luminaire extension(s) will have a 50-foot mounting height with 8' foot arm.

Cantilever traffic signal supports, will be designed for fatigue in accordance with Fatigue Importance Category III without galloping and truck induced gusts.

GENERAL NOTES

The Contractor will furnish and deliver the mast arm and luminaire extension to the South Dakota Department of Transportation (SDDOT) Aberdeen Region located 2735 Highway 12 West, Aberdeen, SD. SDDOT staff will assist in unloading. Contact Matt Dorfschmidt 5 business day in advance of the delivery to make arrangements for assistance in unloading,

All cost for furnishing and delivery of the mast arm and luminaire extension will be incidental tp the contract unit price per each for "Furnish Signal Pole with Mast Arm and Luminaire arm.

SIGNAL LAYOUT

US HWY 12/6TH AVE SW & MAIN ST S

STATE OF SOUTH DAKOTA	PROJECT	SHEET NO.	TOTAL SHEETS
	000P-151	3	4
Plotting Date: 12/30/2024			

SCALE
1" = 40'



ESTIMATE OF QUANTITIES			
KEY	ITEM	EST QUANT	UNIT
⊕	Furnish Signal Pole with Mast Arm and Luminaire Arm (E3)	1	EACH

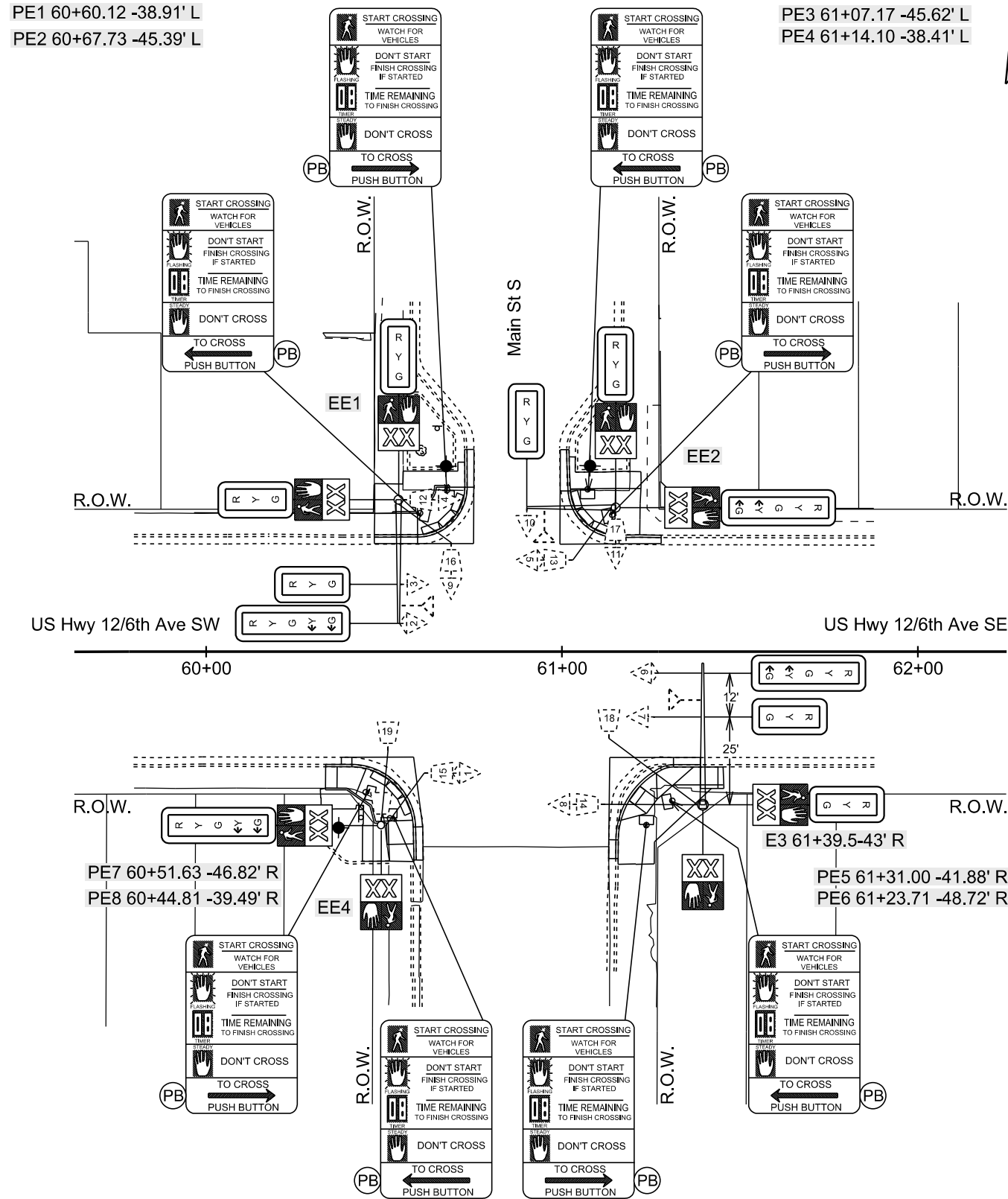

PLOT SCALE - 1:40.1478

PLOTTED FROM - TRAB17879

PLOT NAME - 2

FILE - ... \REGIONAL\PRJ\BRWN17PW\0615.DGN

PLOT SCALE - 1:200

PLOT NAME - 3

FILE - ... \REGIONAL\PR\BRWN17PW\BLANK.DGN

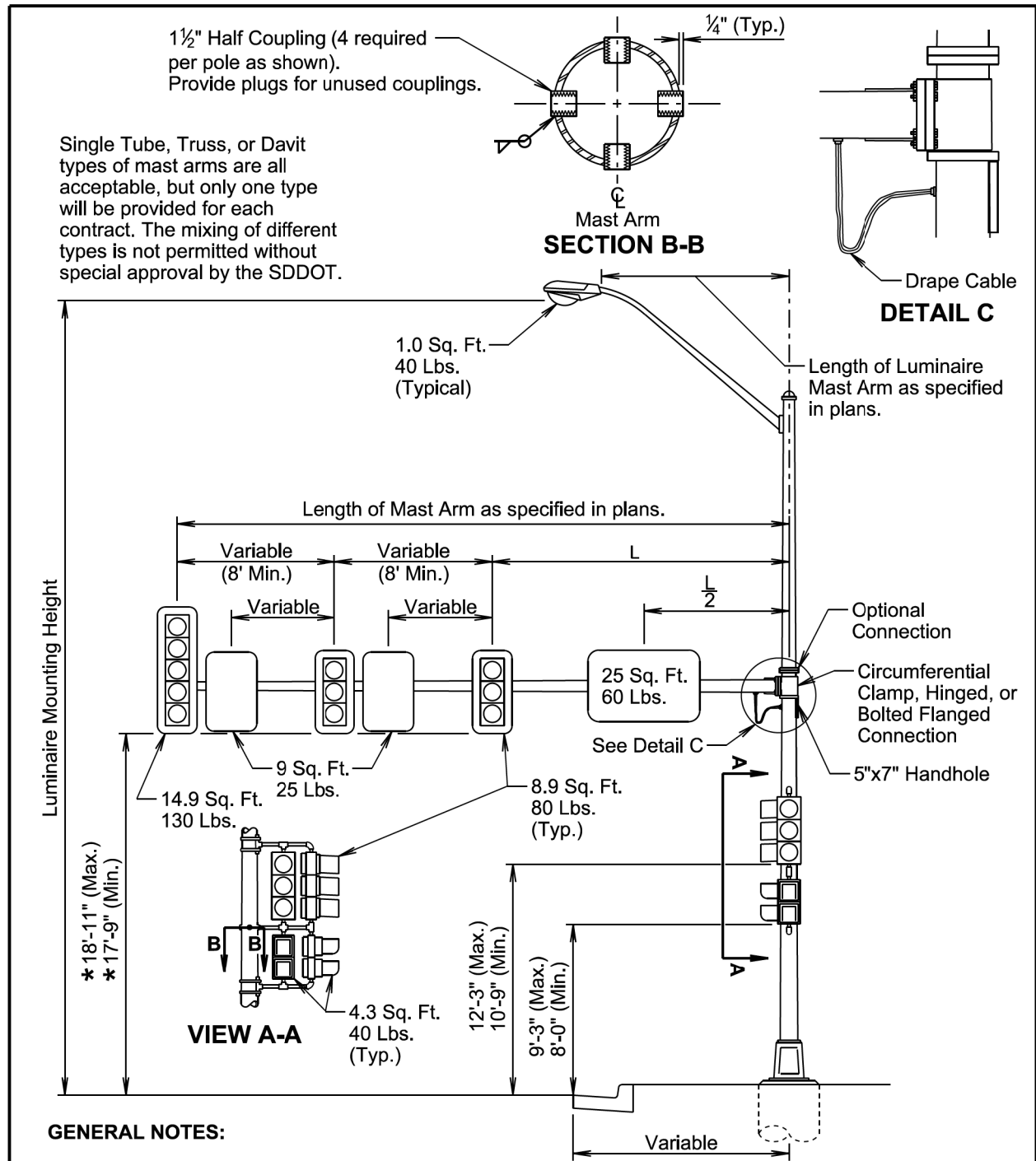

Single Tube, Truss, or Davit types of mast arms are all acceptable, but only one type will be provided for each contract. The mixing of different types is not permitted without special approval by the SDDOT.

1 1/2" Half Coupling (4 required per pole as shown). Provide plugs for unused couplings.

Mast Arm
SECTION B-B

DETAIL C

GENERAL NOTES:

Some of the signal heads are shown with backplates removed so that the mounting hardware is visible.

* The signal height allowances shown above are based on a horizontal distance greater than 53' between the signals and stop line. For horizontal distance of 53' and less between the signals and the stop line, the height allowances will be as specified in Section 4D.15 of the MUTCD.

November 19, 2022

Published Date: 2025	S D D O T	SIGNAL POLE (WITH MAST ARM AND LUMINAIRE EXTENSION)	PLATE NUMBER 635.32
			Sheet 1 of 1