

# HIGHWAY 071

Beginning MRM = 0.00  
Ending MRM = 7.06

# RURAL



# HIGHWAY 071

Beginning MRM = 0.00  
Ending MRM = 7.06

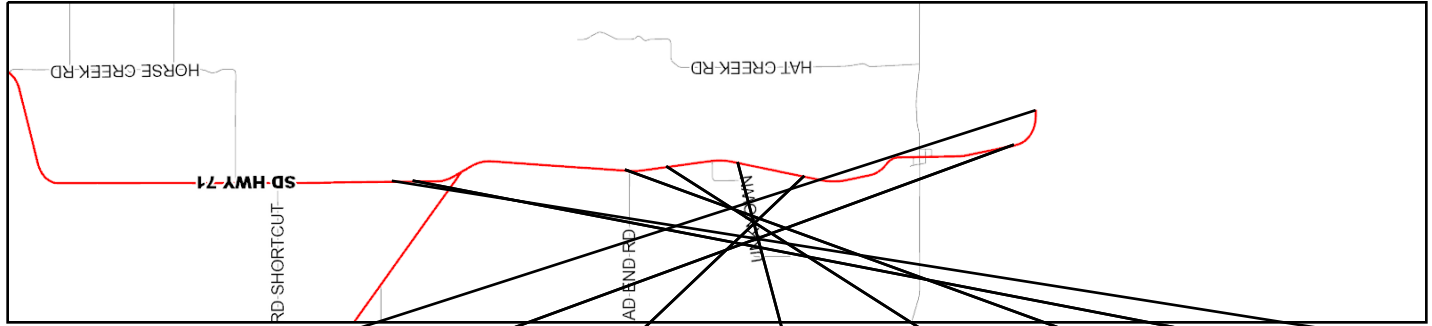

IDENTIFICATION								
Federal Aid System	STP	STP	STP	STP	STP	STP	STP	STP
Funding Category	SEC	SEC	SEC	SEC	SEC	SEC	SEC	SEC
Functional Classification	R-MA C	R-MA C	R-MA C	R-MA C	R-MA C	R-MA C	R-MA C	R-MA C
Direction								
Beginning MRM	000.00	000.00	002.00	003.21	004.00	005.00	007.06	
MRM Displacement	0.000	0.450	0.839	0.420	0.545	0.097	0.605	
Segment Length	0.450	2.585	0.817	0.867	0.501	2.596	0.252	
Year Built	2010	1937	2008	1937	1992	1937	1991	
Year Last Improved	2019	2019	2019	2019	2019	2019	2019	
Year Last Sealed								
ROADWAY CONDITIONS								
Surface Condition Index	4.84	4.80	4.79	4.82	4.76	4.81	4.77	
Roughness Index	4.82 (21)	4.80 (21)	4.83 (21)	4.85 (21)	4.70 (21)	4.84 (21)	4.72 (21)	
ASPHALT INDEX VALUES								
Transverse Cracking	5.00 (21)	4.98 (21)	4.97 (21)	4.97 (21)	4.95 (21)	4.97 (21)	5.00 (21)	
Fatigue Cracking	5.00 (21)	4.87 (21)	5.00 (21)	5.00 (21)	5.00 (21)	5.00 (21)	5.00 (21)	
Patching/Patch Deterioration	5.00 (21)	5.00 (21)	5.00 (21)	5.00 (21)	5.00 (21)	5.00 (21)	5.00 (21)	
Block Cracking	5.00 (21)	5.00 (21)	4.79 (21)	5.00 (21)	5.00 (21)	5.00 (21)	5.00 (21)	
Rut Index	4.84 (21)	4.82 (21)	4.85 (21)	4.79 (21)	4.83 (21)	4.78 (21)	4.82 (21)	
Rut Depth(Inches) AVG/MAX	0.00 / 0.10	0.10 / 0.10	0.00 / 0.10	0.10 / 0.10	0.00 / 0.10	0.10 / 0.20	0.10 / 0.10	
CONCRETE INDEX VALUES								
D-Cracking/ASR								
Joint Spalling								
Corner Cracking								
Faulting / CRCP Block Cracking								
Joint Seal Damage								
Punchouts								
STRUCTURAL DESCRIPTION								
Surface Type	TONS	TONW	THK	TONW	TONS	TONW	TONS	
Shoulder Type - Primary/Secondary	AC/GRVL	NONE/N/D	AC/NONE	NONE/N/D	AC/NONE	NONE/N/D	AC/NONE	
Surface Width	24 (024)	22 (022)	24 (024)	22 (022)	24 (024)	22 (022)	24 (024)	
Left Shoulder Width-Prim/Sec	2 (02) / 4 (4)	0 (00) / 0 (0)	5 (05) / 0 (0)	0 (00) / 0 (0)	5 (05) / 0 (0)	0 (00) / 0 (0)	7 (07) / 0 (0)	
Right Shoulder Width-Prim/Sec	2 (02) / 4 (4)	0 (00) / 0 (0)	5 (05) / 0 (0)	0 (00) / 0 (0)	5 (05) / 0 (0)	0 (00) / 0 (0)	7 (07) / 0 (0)	
Widths-RDWY/ROW/Min	036/100/100	022/66/066	034/108/108	022/66/066	034/150/150	022/66/066	038/66/066	
Roadbed Layer 1	2019/AW3/2.0	2019/AW3/2.0	2019/AW3/2.0	2019/AW3/2.0	2019/AW3/2.0	2019/AW3/2.0	2019/AW3/2.0	
Roadbed Layer 2	2012/TS3/0.4	2012/TS3/0.4	2012/TS3/0.4	2015/PA5/2.0	2012/TS3/0.4	2012/TS3/0.4	2012/TS3/0.4	
Roadbed Layer 3	2012/PA9/2.0	2012/PA2/2.0	2011/PA2/2.0	2012/TS3/0.4	2009/TS3/0.4	2009/TS3/0.4	2009/TS3/0.4	
Roadbed Layer 4	2010/TG5/0.6	2011/PA3/2.0	2009/TS3/0.4	2009/TS3/0.4	1992/TG5/0.6	1981/TS3/0.5	1991/TG3/0.5	
Roadbed Layer 5	2010/BU4/7.0	2009/TS3/0.4	2008/AE3/1.5	1981/TS3/0.5	1992/BU4/10.0	1963/TS3/0.5	1991/BU5/10.0	
Roadbed Layer 6	2010/BS4/3.0	1981/TS3/0.5	2008/AE3/1.5	1963/TS3/0.5		1958/TG4/0.7		
Roadbed Layer 7		1963/TS3/0.5	2008/BU4/10.0	1958/TG4/0.7		1958/BU5/5.0		
Roadbed Layer 8		1958/TG4/0.7		1958/BU5/5.0		1937/BU8/0.0		
Roadbed Layer 9		1958/BU5/5.0		1937/BU8/0.0				
Roadbed Layer 10		1937/BU8/0.0						
Roadbed Layer 11								
Roadbed Layer 12								
Number Of Structures	0	0	1	0	1	0	0	
Number Of Box Culverts	0	0	0	0	0	1	1	
3 YR AVG MAINTENANCE COSTS								
Mainline	\$238	\$239	\$411	\$1878	\$1878	\$1878	\$1877	
Shoulders	\$0	\$0	\$0	\$0	\$0	\$0	\$0	
Structure	\$0	\$0	\$53	\$37	\$36	\$37	\$36	
Other	\$4302	\$4303	\$11305	\$4128	\$4128	\$4129	\$4127	
Total	\$4542	\$4541	\$11769	\$6043	\$6042	\$6042	\$6044	
Total 3 Year Main Contract Amount	\$338	\$338	\$884	\$319	\$319	\$319	\$317	
TRAFFIC								
Current ADT	155	155	155	155	155	160	178	
Projected 20 Year ADT	230	230	230	230	230	238	265	
Number Of Trucks	18	18	18	18	18	18	18	
CRASHES								
Weighted Crash Rate	0.00	4.10	10.61	3.54	0.00	3.96	0.00	
Number Of Fatal	0	0	0	0	0	0	0	
Number Of Injury	0	1	1	0	0	1	0	
Number Of Property Damage	0	0	0	1	0	0	0	
MAINLINE IMPROVEMENTS								
Project Programmed	YES	YES	YES	YES	YES	YES	YES	
PCN								
Improvement Type	ROUTE/SEAL	ROUTE/SEAL	ROUTE/SEAL	ROUTE/SEAL	ROUTE/SEAL	ROUTE/SEAL	ROUTE/SEAL	
Estimated Improvement Cost	\$2	\$10	\$3	\$3	\$2	\$10	\$1	
Improvement Year	2022	2022	2022	2022	2022	2022	2022	
PCN								
Improvement Type	CHIP SEAL	CHIP SEAL	CHIP SEAL	CHIP SEAL	CHIP SEAL	CHIP SEAL	CHIP SEAL	
Estimated Improvement Cost	\$15	\$85	\$27	\$29	\$17	\$86	\$8	
Improvement Year	2023	2023	2023	2023	2023	2023	2023	

# HIGHWAY 071

Beginning MRM = 7.77  
Ending MRM = 19.00

## RURAL



# HIGHWAY 071

Beginning MRM = 7.77  
Ending MRM = 19.00

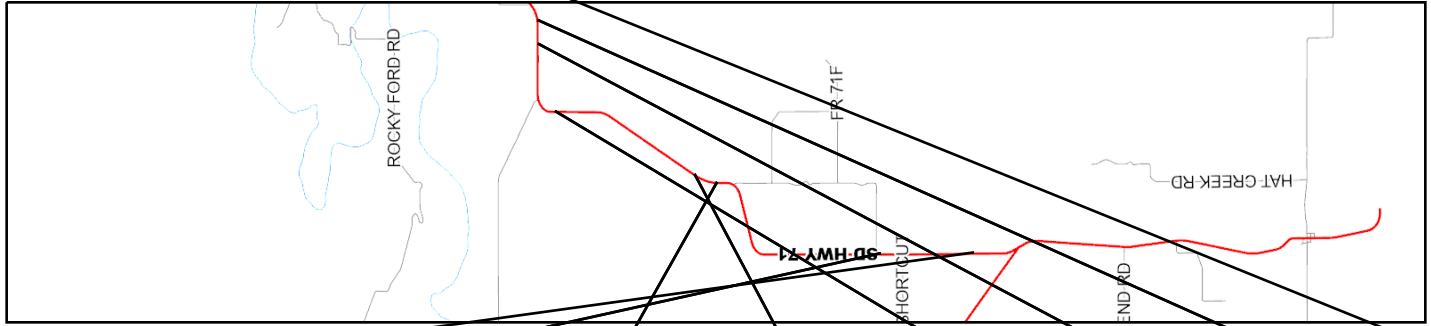

IDENTIFICATION								
Federal Aid System	STP	STP	STP	STP	STP	STP	STP	STP
Funding Category	SEC	SEC	SEC	SEC	SEC	SEC	SEC	SEC
Functional Classification	R-MA C	R-MA C	R-MA C	R-MA C	R-MA C	R-MA C	R-MA C	R-MA C
Direction								
Beginning MRM	007.77	009.00	014.00	014.00	017.00	018.00	019.00	019.00
MRM Displacement	0.154	0.710	0.231	0.685	0.568	0.731	0.060	0.060
Segment Length	1.789	3.768	0.454	2.883	1.165	0.329	1.187	1.187
Year Built	1937	2000	1991	2000	2000	2000	1946	1946
Year Last Improved	2019	2019	2019	2019	2006	2003	2003	2003
Year Last Sealed					2014	2014	2014	2014
ROADWAY CONDITIONS								
Surface Condition Index	4.79	4.81	4.82	4.77	4.13	4.24	4.13	4.13
Roughness Index	4.90 (21)	4.92 (21)	4.91 (21)	4.85 (21)	4.73 (21)	4.69 (21)	4.58 (21)	4.58 (21)
ASPHALT INDEX VALUES								
Transverse Cracking	5.00 (21)	5.00 (21)	5.00 (21)	5.00 (21)	4.88 (21)	4.92 (21)	4.79 (21)	4.79 (21)
Fatigue Cracking	5.00 (21)	5.00 (21)	5.00 (21)	5.00 (21)	4.43 (21)	4.67 (21)	4.09 (21)	4.09 (21)
Patching/Patch Deterioration	5.00 (21)	5.00 (21)	5.00 (21)	5.00 (21)	5.00 (21)	5.00 (21)	5.00 (21)	5.00 (21)
Block Cracking	5.00 (21)	5.00 (21)	5.00 (21)	5.00 (21)	4.19 (21)	4.30 (21)	4.30 (21)	4.30 (21)
Rut Index	4.71 (21)	4.74 (21)	4.75 (21)	4.70 (21)	4.13 (21)	4.22 (21)	4.49 (21)	4.49 (21)
Rut Depth(Inches) AVG/MAX	0.10 / 0.20	0.10 / 0.20	0.10 / 0.10	0.10 / 0.20	0.20 / 0.40	0.20 / 0.40	0.10 / 0.30	0.10 / 0.30
CONCRETE INDEX VALUES								
D-Cracking/ASR								
Joint Spalling								
Corner Cracking								
Faulting / CRCP Block Cracking								
Joint Seal Damage								
Punchouts								
STRUCTURAL DESCRIPTION								
Surface Type	TONW	TONS	TONS	TONS	TONS	TONS	TONS	TONS
Shoulder Type - Primary/Secondary	NONE/N/D	AC/NONE	AC/NONE	AC/NONE	AC/NONE	AC/NONE	AC/NONE	AC/NONE
Surface Width	22 (022)	24 (024)	24 (024)	24 (024)	24 (024)	24 (024)	24 (024)	24 (024)
Left Shoulder Width-Prim/Sec	0 (00) / 0 (0)	1 (01) / 0 (0)	1 (01) / 0 (0)	1 (01) / 0 (0)	1 (01) / 0 (0)	2 (02) / 0 (0)	2 (02) / 0 (0)	2 (02) / 0 (0)
Right Shoulder Width-Prim/Sec	0 (00) / 0 (0)	1 (01) / 0 (0)	1 (01) / 0 (0)	1 (01) / 0 (0)	1 (01) / 0 (0)	2 (02) / 0 (0)	2 (02) / 0 (0)	2 (02) / 0 (0)
Widths-RDWY/ROW-Predom/Min	022/66/066	026/150/150	026/150/150	026/150/150	026/150/150	028/150/150	028/150/150	028/150/150
Roadbed Layer 1	2019/AW3/2.0	2019/AW3/2.0	2019/AW3/2.0	2019/AW3/2.0	2014/TS3/0.4	2014/TS3/0.4	2014/TS3/0.4	2014/TS3/0.4
Roadbed Layer 2	2012/TS3/0.4	2012/TS3/0.4	2012/TS3/0.4	2016/PA2/2.0	2007/TS3/0.4	2007/TS3/0.4	2007/TS3/0.4	2007/TS3/0.4
Roadbed Layer 3	2009/TS3/0.4	2009/TS3/0.4	2009/TS3/0.4	2015/PA6/2.0	2006/AM3/1.5	2003/AM3/1.5	2003/AM3/1.5	2003/AM3/1.5
Roadbed Layer 4	1981/TS3/0.5	2000/TG3/0.5	1991/TG4/0.5	2012/TS3/0.4	2000/TG3/0.5	2000/BU4/10.0	2000/BU4/4.0	2000/BU4/4.0
Roadbed Layer 5	1963/TS3/0.5	2000/BU4/10.0	1991/BU5/10.0	2009/TS3/0.4	2000/BU4/10.0		1988/BU8/3.0	1988/BU8/3.0
Roadbed Layer 6	1958/TG4/0.7			2000/TG3/0.5			1946/BU8/4.0	1946/BU8/4.0
Roadbed Layer 7	1958/BU5/5.0			2000/BU4/10.0				
Roadbed Layer 8	1937/BU8/0.0							
Roadbed Layer 9								
Roadbed Layer 10								
Roadbed Layer 11								
Roadbed Layer 12								
Number Of Structures	0	0	0	0	0	0	0	1
Number Of Box Culverts	0	2	0	0	0	0	0	0
3 YR AVG MAINTENANCE COSTS								
Mainline	\$1878	\$1877	\$1877	\$1877	\$685	\$684	\$685	\$685
Shoulders	\$0	\$0	\$0	\$0	\$0	\$0	\$0	\$0
Structure	\$37	\$37	\$37	\$37	\$18	\$18	\$19	\$19
Other	\$4129	\$4129	\$4128	\$4129	\$5209	\$5210	\$5210	\$5210
Total	\$6042	\$6042	\$6042	\$6042	\$5913	\$5912	\$5913	\$5913
Total 3 Year Main Contract Amount	\$319	\$319	\$319	\$319	\$408	\$407	\$408	\$408
TRAFFIC								
Current ADT	178	178	178	178	178	178	178	178
Projected 20 Year ADT	265	265	265	265	265	265	265	265
Number Of Trucks	18	18	18	18	18	18	18	18
CRASHES								
Weighted Crash Rate	0.00	2.45	3.08	1.07	0.00	0.00	0.00	0.00
Number Of Fatal	0	0	0	0	0	0	0	0
Number Of Injury	0	1	0	0	0	0	0	0
Number Of Property Damage	0	0	1	1	0	0	0	0
MAINLINE IMPROVEMENTS								
Project Programmed	YES	YES	YES	YES	YES	YES	YES	YES
PCN								
Improvement Type	ROUTE/SEAL	ROUTE/SEAL	ROUTE/SEAL	ROUTE/SEAL	CHIP SEAL	CHIP SEAL	CHIP SEAL	CHIP SEAL
Estimated Improvement Cost	\$7	\$14	\$2	\$11	\$41	\$12	\$42	\$42
Improvement Year	2022	2022	2022	2022	2022	2022	2022	2022
PCN								
Improvement Type	CHIP SEAL	CHIP SEAL	CHIP SEAL	CHIP SEAL	ROUTE/SEAL	CHIP SEAL	CHIP SEAL	CHIP SEAL
Estimated Improvement Cost	\$59	\$124	\$15	\$95	\$9	\$0	\$0	\$0
Improvement Year	2023	2023	2023	2023	2035	2022	2022	2022

# HIGHWAY 071

Beginning MRM = 20.13  
Ending MRM = 30.00

## RURAL



# HIGHWAY 071

Beginning MRM = 20.13  
Ending MRM = 30.00

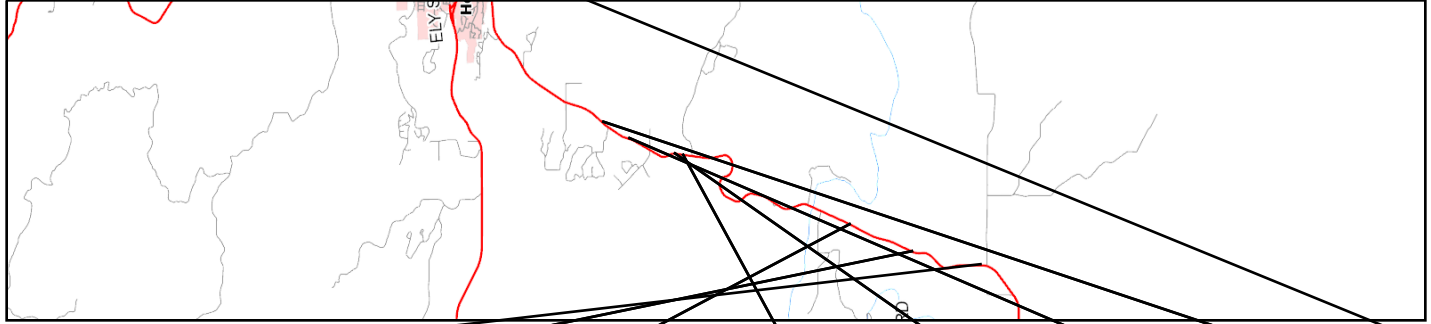

IDENTIFICATION								
Federal Aid System	STP	STP	STP	STP	STP	STP	STP	STP
Funding Category	SEC	SEC	SEC	SEC	SEC	SEC	SEC	SEC
Functional Classification	R-MA C	R-MA C	R-MA C	R-MA C	R-MA C	R-MA C	R-MA C	R-MA C
Direction								
Beginning MRM	020.13	021.00	023.00	028.46	028.88	030.00	030.00	030.00
MRM Displacement	0.116	0.950	0.503	0.222	0.000	0.023	0.707	0.707
Segment Length	1.703	1.553	5.157	0.203	1.151	0.684	4.441	4.441
Year Built	1998	1998	1998	2004	2004	1986	2004	2004
Year Last Improved	2003	2014	2005	2005	2005	2005	2005	2005
Year Last Sealed	2014	2014	2014	2014	2014	2014	2014	2014
ROADWAY CONDITIONS								
Surface Condition Index	4.19	4.15	4.47	4.48	4.60	4.55	4.39	4.39
Roughness Index	4.84 (21)	4.72 (21)	4.81 (21)	4.92 (21)	4.83 (21)	4.94 (21)	4.87 (21)	4.87 (21)
ASPHALT INDEX VALUES								
Transverse Cracking	4.86 (21)	4.87 (21)	4.98 (21)	5.00 (21)	5.00 (21)	5.00 (21)	4.99 (21)	4.99 (21)
Fatigue Cracking	4.48 (21)	4.54 (21)	4.81 (21)	5.00 (21)	5.00 (21)	5.00 (21)	4.89 (21)	4.89 (21)
Patching/Patch Deterioration	4.88 (21)	5.00 (21)	5.00 (21)	5.00 (21)	5.00 (21)	5.00 (21)	5.00 (21)	5.00 (21)
Block Cracking	4.09 (21)	3.96 (21)	4.35 (21)	4.30 (21)	4.62 (21)	4.49 (21)	4.34 (21)	4.34 (21)
Rut Index	4.38 (21)	4.56 (21)	4.67 (21)	4.74 (21)	4.59 (21)	4.60 (21)	4.44 (21)	4.44 (21)
Rut Depth(Inches) AVG/MAX	0.20 / 0.40	0.10 / 0.40	0.10 / 0.40	0.10 / 0.20	0.10 / 0.30	0.10 / 0.30	0.20 / 0.50	0.20 / 0.50
CONCRETE INDEX VALUES								
D-Cracking/ASR								
Joint Spalling								
Corner Cracking								
Faulting / CRCP Block Cracking								
Joint Seal Damage								
Punchouts								
STRUCTURAL DESCRIPTION								
Surface Type	TONS	BLOT	TONS	TONS	TONS	TONS	TONS	TONS
Shoulder Type - Primary/Secondary	AC/NONE	AC/NONE	AC/NONE	AC/NONE	AC/NONE	AC/NONE	AC/NONE	AC/NONE
Surface Width	24 (024)	24 (024)	24 (024)	24 (024)	24 (024)	24 (024)	24 (024)	24 (024)
Left Shoulder Width-Prim/Sec	6 (06) / 0 (0)	6 (06) / 0 (0)	7 (02) / 0 (0)	6 (06) / 0 (0)	6 (06) / 0 (0)	6 (06) / 0 (0)	6 (06) / 0 (0)	6 (06) / 0 (0)
Right Shoulder Width-Prim/Sec	6 (06) / 0 (0)	6 (06) / 0 (0)	7 (02) / 0 (0)	6 (06) / 0 (0)	6 (06) / 0 (0)	6 (06) / 0 (0)	6 (06) / 0 (0)	6 (06) / 0 (0)
Widths-RDWY/ROW-Predom/Min	036/150/150	036/150/150	038/150/150	036/150/150	036/150/150	036/150/150	036/150/150	036/150/150
Roadbed Layer 1	2014/TS3/0.4	2014/TS3/0.4	2014/TS3/0.4	2014/TS3/0.4	2014/TS3/0.4	2014/TS3/0.4	2014/TS3/0.4	2014/TS3/0.4
Roadbed Layer 2	2007/TS3/0.4	2007/TS3/0.4	2007/TS3/0.4	2007/TS3/0.4	2007/TS3/0.4	2007/TS3/0.4	2007/TS3/0.4	2007/TS3/0.4
Roadbed Layer 3	2003/AM3/1.5	2000/PA1/1.5	2005/AL3/1.5	2005/AL3/1.5	2005/AL3/1.5	2005/AL3/1.5	2005/AL3/1.5	2005/AL3/1.5
Roadbed Layer 4	1998/TG5/0.6	1998/TG5/0.6	2005/AL3/2.0	2005/AL3/2.0	2005/AL3/2.0	2005/AL3/2.0	2005/AL3/2.0	2005/AL3/2.0
Roadbed Layer 5	1998/BU4/10.0	1998/BU4/10.0	1998/TG5/0.6	2004/BU4/8.5	2004/BU4/8.5	2004/BU4/2.0	2004/BU4/8.5	2004/BU4/8.5
Roadbed Layer 6			1998/BU4/10.0	2004/BS4/3.5	2004/BS4/3.5	2004/BS4/3.5	2004/BS4/3.5	2004/BS4/3.5
Roadbed Layer 7								
Roadbed Layer 8						1986/BU5/6.0		
Roadbed Layer 9								
Roadbed Layer 10								
Roadbed Layer 11								
Roadbed Layer 12								
Number Of Structures	0	0	2	0	0	0	0	0
Number Of Box Culverts	0	0	1	0	0	0	0	0
3 YR AVG MAINTENANCE COSTS								
Mainline	\$685	\$1457	\$197	\$197	\$196	\$197	\$197	\$197
Shoulders	\$0	\$0	\$0	\$0	\$0	\$0	\$0	\$0
Structure	\$18	\$0	\$21	\$20	\$21	\$20	\$21	\$21
Other	\$5210	\$7429	\$5595	\$5596	\$5595	\$5595	\$5595	\$5595
Total	\$5913	\$8886	\$5812	\$5813	\$5812	\$5813	\$5812	\$5812
Total 3 Year Main Contract Amount	\$408	\$585	\$439	\$438	\$440	\$439	\$439	\$439
TRAFFIC								
Current ADT	178	178	348	417	417	417	885	885
Projected 20 Year ADT	265	265	517	620	620	620	1316	1316
Number Of Trucks	18	18	22	24	24	24	46	46
CRASHES								
Weighted Crash Rate	0.00	23.79	1.22	0.00	2.28	2.63	1.53	1.53
Number Of Fatal	0	1	0	0	0	0	0	0
Number Of Injury	0	0	0	0	0	0	0	0
Number Of Property Damage	0	0	4	0	2	2	11	11
MAINLINE IMPROVEMENTS								
Project Programmed	YES	YES	YES	YES	YES	YES	YES	YES
PCN								
Improvement Type	CHIP SEAL	CHIP SEAL	CHIP SEAL	CHIP SEAL	CHIP SEAL	CHIP SEAL	CHIP SEAL	CHIP SEAL
Estimated Improvement Cost	\$60	\$55	\$181	\$7	\$40	\$24	\$156	\$156
Improvement Year	2022	2022	2022	2022	2022	2022	2022	2022
PCN								
Improvement Type	ROUTE/SEAL	NOT OPTIMIZED	CHIP SEAL	CHIP SEAL	CHIP SEAL	CHIP SEAL	CHIP SEAL	CHIP SEAL
Estimated Improvement Cost	\$14	\$0	\$0	\$0	\$0	\$0	\$0	\$0
Improvement Year	2037	0	2022	2022	2022	2022	2022	2022