

HIGHWAY 324
Beginning MRM = 357.41
Ending MRM = 357.62

RURAL

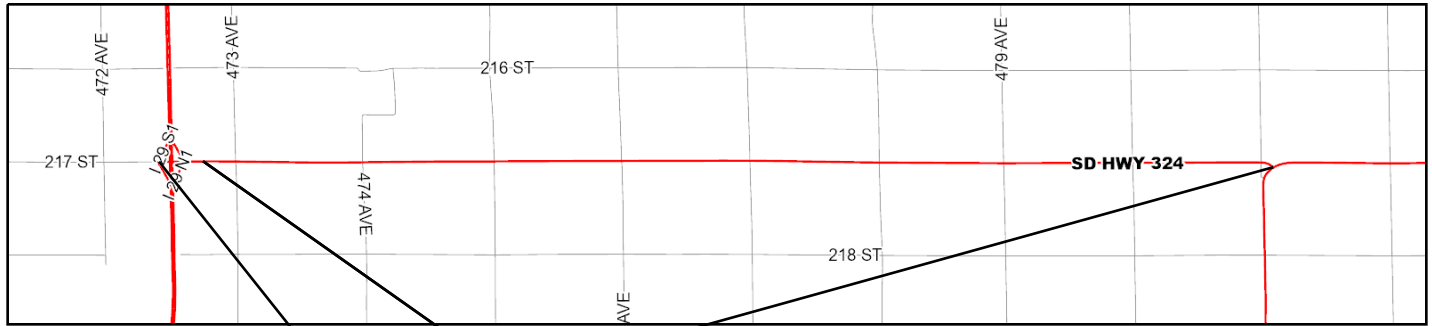

HIGHWAY 324
Beginning MRM = 357.41
Ending MRM = 357.62



IDENTIFICATION			
Federal Aid System	STP	STP	
Funding Category	SEC	SEC	
Functional Classification	R-MA C	R-MA C	
Direction			
Beginning MRM	357.41	357.62	
MRM Displacement	0.000	0.143	
Segment Length	0.348	8.332	
Year Built	1968	1975	
Year Last Improved	2013	2019	
Year Last Sealed			
ROADWAY CONDITIONS			
Surface Condition Index	2.47	4.80	
Roughness Index	3.80 (21)	4.93 (21)	
ASPHALT INDEX VALUES			
Transverse Cracking	3.50 (21)	4.80 (21)	
Fatigue Cracking	3.40 (21)	4.98 (21)	
Patching/Patch Deterioration	5.00 (21)	5.00 (21)	
Block Cracking	2.10 (21)	5.00 (21)	
Rut Index	4.37 (21)	4.81 (21)	
Rut Depth(Inches) AVG/MAX	0.20 / 0.40	0.10 / 0.20	
CONCRETE INDEX VALUES			
D-Cracking/ASR			
Joint Spalling			
Corner Cracking			
Faulting / CRCP Block Cracking			
Joint Seal Damage			
Punchouts			
STRUCTURAL DESCRIPTION			
Surface Type	THK	THK	
Shoulder Type - Primary/Secondary	AC/N/D	AC/N/D	
Surface Width	24 (024)	24 (024)	
Left Shoulder Width-Prim/Sec	4 (04) / 0 (0)	4 (04) / 0 (0)	
Right Shoulder Width-Prim/Sec	4 (04) / 0 (0)	4 (04) / 0 (0)	
Widths-RDWY/ROW-Predom/Min	032/145/145	032/145/145	
Roadbed Layer 1	2021/TC/0.0	2021/TC/0.0	
Roadbed Layer 2	2013/AU3/1.5	2019/AJ3/2.0	
Roadbed Layer 3	2009/TS3/0.4	1999/AL3/1.0	
Roadbed Layer 4	2002/TS3/0.4	0/AA/0.5	
Roadbed Layer 5	2001/TC/0.0	1989/TS3/0.5	
Roadbed Layer 6	1999/AL3/2.0	1981/TS3/0.5	
Roadbed Layer 7	0/AA/2.0	1976/AG3/1.5	
Roadbed Layer 8	1968/AD3/3.0	1975/AE3/3.0	
Roadbed Layer 9	1968/BU5/4.0	1975/BL4/6.0	
Roadbed Layer 10			
Roadbed Layer 11			
Roadbed Layer 12			
Number Of Structures	1	2	
Number Of Box Culverts	0	0	
3 YR AVG MAINTENANCE COSTS			
Mainline	\$43	\$42	
Shoulders	\$0	\$0	
Structure	\$187	\$188	
Other	\$5009	\$5007	
Total	\$5236	\$5237	
Total 3 Year Main Contract Amount	\$1523	\$1524	
TRAFFIC			
Current ADT	1407	1203	
Projected 20 Year ADT	2116	1809	
Number Of Trucks	135	138	
CRASHES			
Weighted Crash Rate	1.17	2.41	
Number Of Fatal	0	1	
Number Of Injury	0	3	
Number Of Property Damage	3	23	
MAINLINE IMPROVEMENTS			
Project Programmed	YES	YES	
PCN			
Improvement Type	CHIP SEAL	CHIP SEAL	
Estimated Improvement Cost	\$11	\$275	
Improvement Year	2022	2022	
PCN			
Improvement Type	CHIP SEAL	ROUTE/SEAL	
Estimated Improvement Cost	\$0	\$69	
Improvement Year	2022	2039	